

I. Package List

Check that you have all parts for this model **BEFORE** assembling your product. If any parts are missing, please contact customer service:

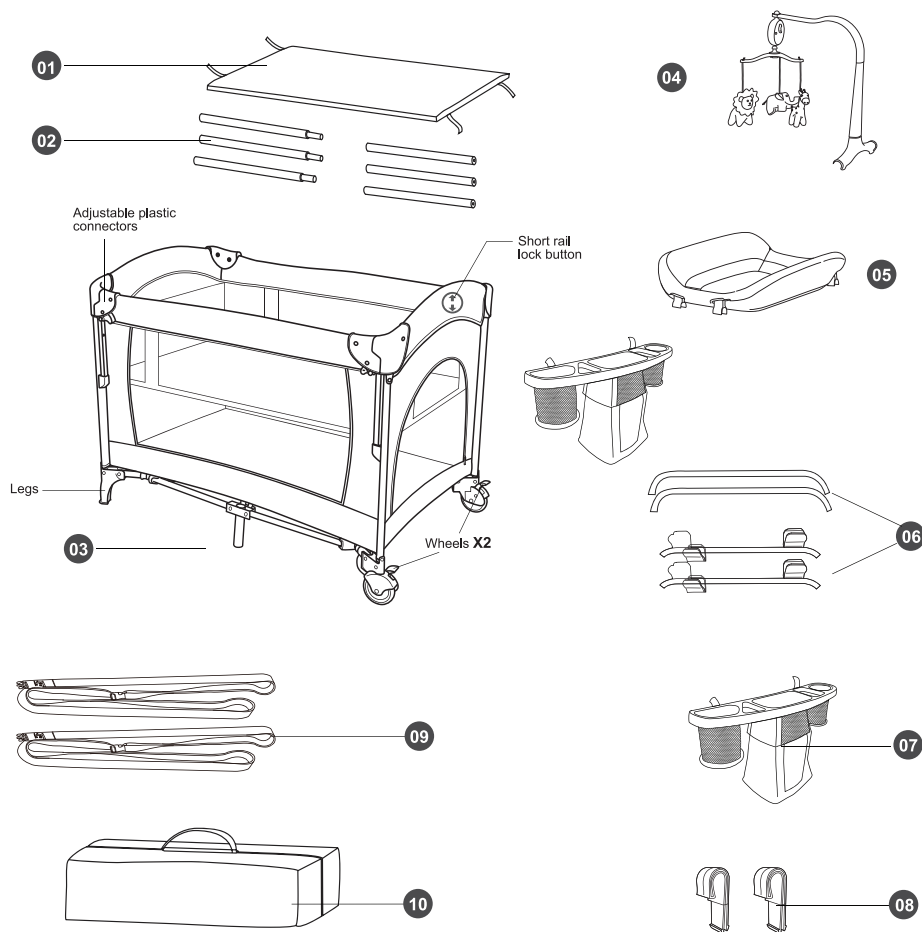

01	Mattress x1	06	Diaper changing fixed bar x4
02	Mattress support bars x6	07	Storage rack body x1
03	Main Body x1	08	Storage rack fixing buckle x2
04	Musical toy rack x1	09	Strap x2
05	Diaper changing table x1	10	Carry bag x1

Read all instructions **BEFORE** assembly and **USE** of product. **KEEP INSTRUCTIONS FOR FUTURE USE.**

II. Assembly instructions

How to set up the bassinet

Please follow the instructions step by step.
Do not push down the center bottom base until all top bars are locked and rigid.

STEP1 ▶

Remove product from carry bag and undo the velcro straps of mattress.

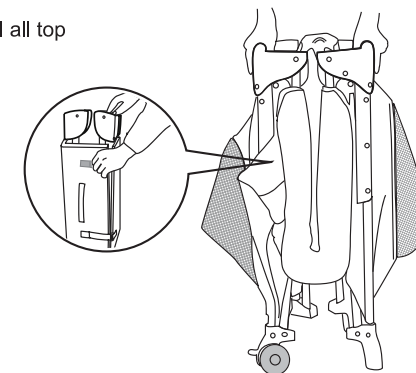

STEP2 ▶

When setting up, pull up short top rails in a quick upward motion to lock before lowering center.

Be sure short top rails have become rigid. If not, pull up again until they are rigid. If top rails do not latch, lift the center of the floor higher.

DO NOT push center down yet.

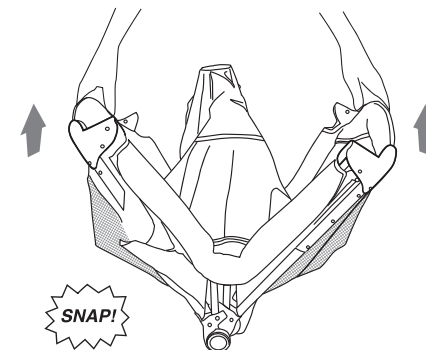

Note: There are two unlocking mechanisms on each bar, please try to pull it quickly and avoid grabbing the center unlocking mechanisms.

STEP3 ▶

While keeping the bassinet center base high, pull up long top rails in a quick upward motion.

Be sure long top rails become rigid. If not, pull up again until they are rigid. If top rails do not latch, lift the center of the floor higher.

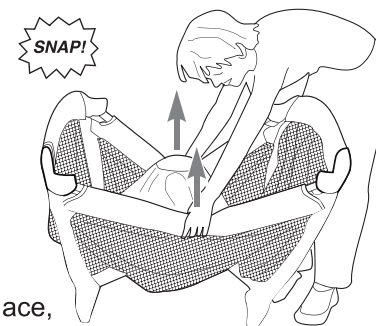

Note: If a top bar does not lock into place, pull the base higher and try again.

STEP4 ▶▶

After four top bars are locked and rigid, reach through the access hole on sleeping nest bottom and gently push down the bottom base until it is locked.

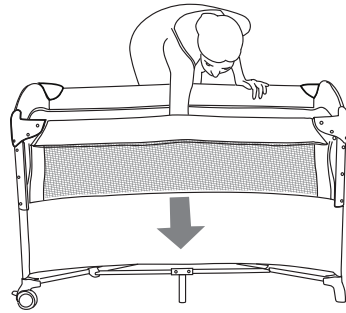

Note: Tap the four rails to make sure they're locked in place and the base is pushed to the bottom.

HOW TO FIX THIS SITUATION?

If any side rails collapses and cannot be locked in place, please pull up the center base and pull all four side rails straight and level and then push down the center base again.

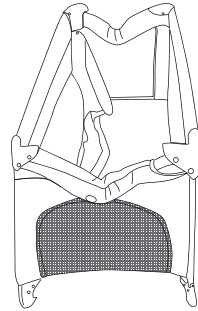

NOTA:

- Rotate the center handle counter-clockwise 90 degrees and raise the center as high as the top rails. Gather the Legs and Wheels together towards the center as close as possible so that they nearly touch.

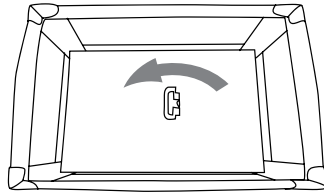

Rotate before lifting

STEP5 ▶▶▶

A
Please check and make sure zippers on perimeter and side rails are zipped up.

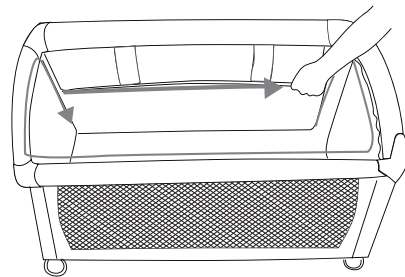

B

Install six mattress support bars into fabric tunnels on the second sleeping layer.

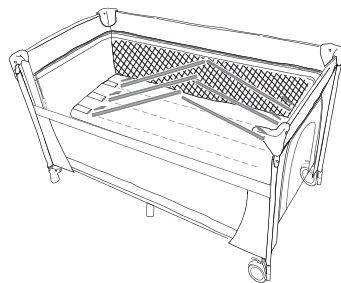

STEP6 ▶▶▶

A
Put the two Velcro fasteners at each end of the mattress through the holes in the sheet.

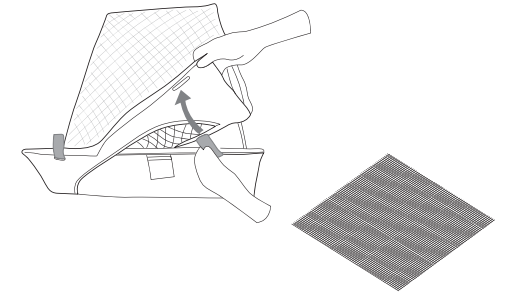

B
Put two tapes under mattress/pad through **lock hole**, open the zipper on each side mesh and fasten all tapes with velcro on the back of second layer through the door on side mesh.
Never use a water mattress with this product.

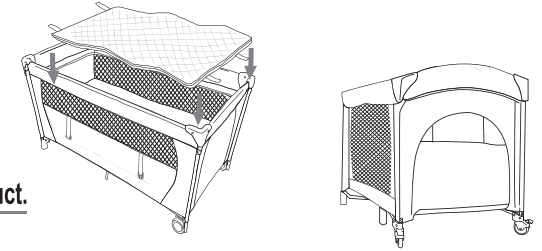

STEP7 ▶▶▶▶

A Insert two holding bars. **B** Connect two locker bars with holding bars.

C Connect the locker bars on the bassinet bars and push down to lock.
Please make sure that the buckle is installed when the baby is lying on the changing table.

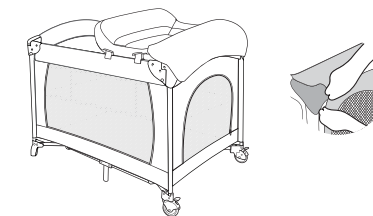

D You can close the zipper on the side of the changing table and the side of the bassinet for storage of the table or Safety usage.

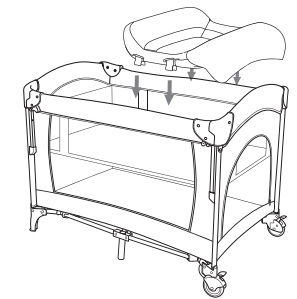

STEP8 ▶

Attach the shelf to the side of the long or short armrest position you like.

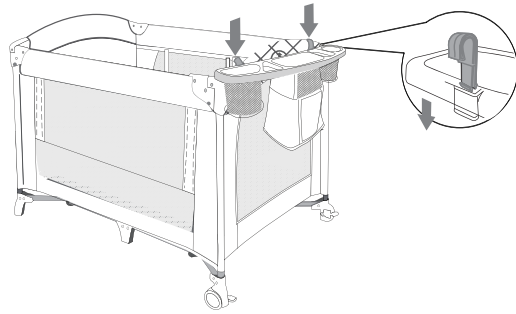

Attach the plastic clips to handrail of the playpen as shown.

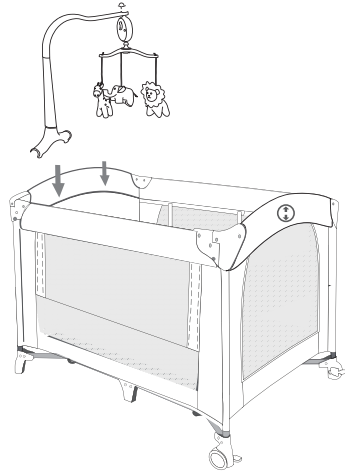

! WARNING

Possible entanglement or strangulation injury. Keep out of baby's reach. Remove toy when baby begins to push up on hands and knees. Recommended use from birth to 5 months.

This toy is not intended to be "mouthed" by the baby and should be positioned clearly out of reach of the baby's face and mouth.

On cribs with adjustable mattress levels, the highest position may allow the toy to be too close to the baby. The second or lower position is more appropriate.

Always attach all provided fasteners (strings, straps, clamps, etc.) tightly to a crib or playpen according to the instructions. Check frequently.

Do not add additional strings or straps to attach to a crib or playpen.

The drop side of the crib should never be lowered with the toy in place and the baby left unattended.

Intended for visual stimulation and not to be grasped by the child.

Mount on wall or ceiling clearly out of a standing baby's reach.

III. How to use as Co-sleeping bassinet

2-POSITION HEIGHT ADJUSTMENT

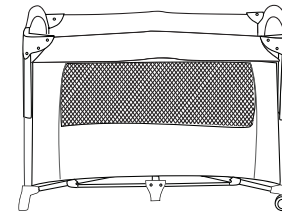

Highest Position

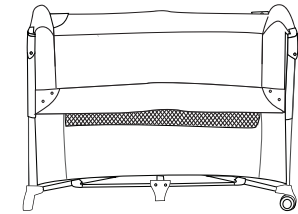

Lowest Position

NOTE:

When it's in the state of using the second sleeping layer, the zipper of second sleeping layer must be pulled to prevent the child from falling the bed.

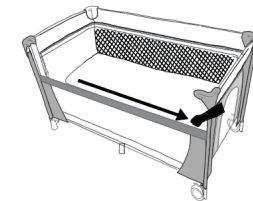

Find the RED locking button 1 under the plastic connectors on the left and right sides. **Press the button 1, then pull up button 2** of the both sides at the same time, then push down the top rail to lower position.

Note: The left and right side plastic connector pieces must be slid down at the same time, so that the top rail can be lowered smoothly.



IV. How to attach the bedside bassinet to adult bed

! WARNING

The attachment system must **ALWAYS** be used in bedside sleeper mode.

Entrapped Hazard

- Never leave the second sleeping layer in place when child is in play yard
- Use only the one provided by the bassinet or cradle manufacturer or one specifically designed to fit the dimension of the bassinet or cradle mattress

Mattress, Boxsprings &
Frame aligned

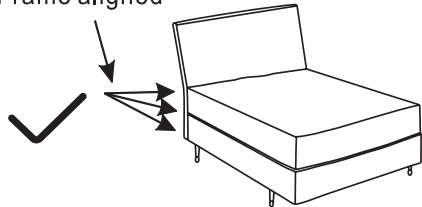

ACCEPTABLE ADULT BED
CONDITIONS FOR Co-SLEEPING
MODE (BEDFRAME IN-LINE)

Frame Extended

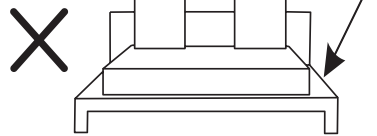

UNACCEPTABLE ADULT BED
CONDITIONS FOR Co-SLEEPING
MODE (BEDFRAME NOT IN-LINE)

Not suitable for use next to water beds or children's beds.

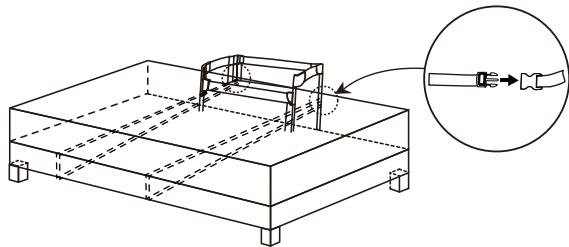

Assemble the buckle as shown in the picture and adjust the length of the strap according to the size of the adult bed.

V. How to use as baby play yard

Take out the mattress, remove the mattress support bar and the second sleeping layer, and then place the mattress on the bottom layer.

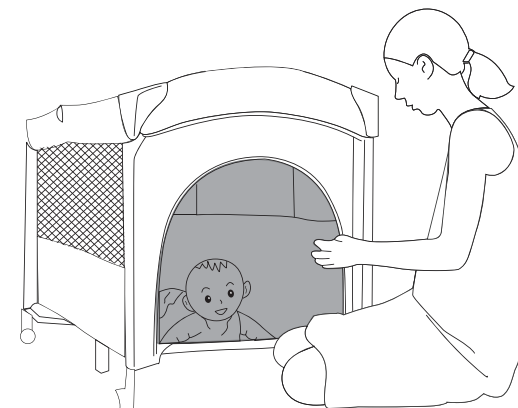
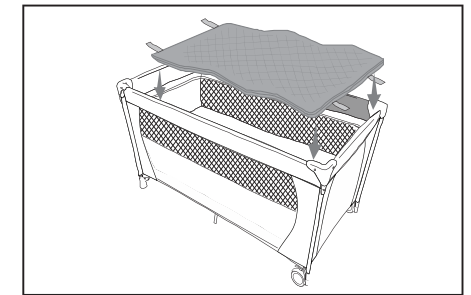
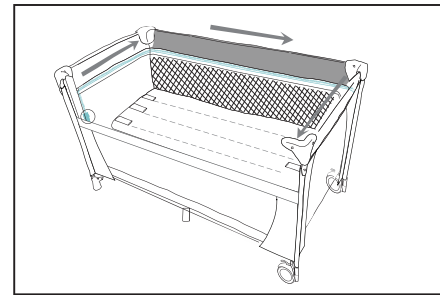
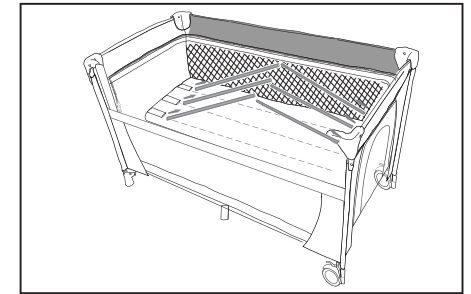
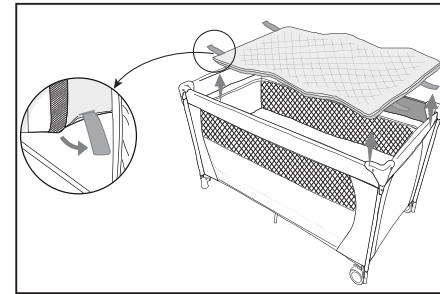

VI. How to fold the play yard

STEP 1

Release mattress.

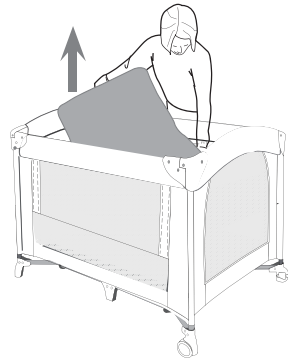

STEP 2

- Release the hook and loop fastener holding the Mattress from underneath the playard floor or the bassinet and set the mattress aside.
- Do not unlock top rails yet, center of floor must be raised before top rails will unlock.
- Rotate the center handle counter-clockwise 90 degrees and raise the center as high as the top rails. Gather the Legs and Wheels together towards the center as close as possible so that they nearly touch.

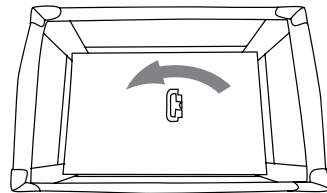

Rotate before lifting

STEP 3

TIPS: Bottom base MUST be up.

- ① Lift up the top rail slightly
- ② Keep pressing the button and push down the top rail

DO NOT FORCE. Lift the bottom base higher if the top rail cannot be unlatched

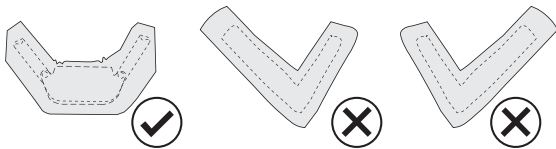
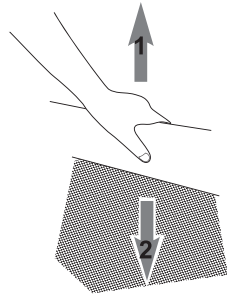

Both tubes must be released in right position for the top rail to fold

STEP 4

Fold the bassinet.

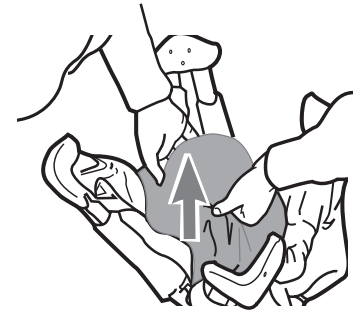

STEP 5

If unit will not fold, **DO NOT FORCE.** Please look for the partially latched top rail, squeeze the latch button to release the rail again.

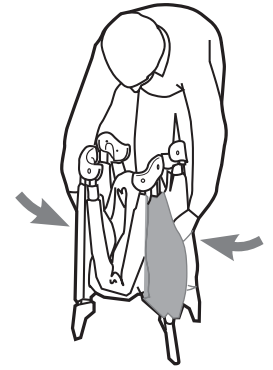

STEP 6

Wrap the mattress around the unit. There are Velcro straps that feed through plastic loops attached to the back side of the mattress. Pull taut.

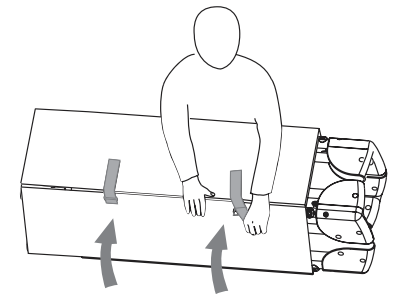

NOTE: Do not cover the top corner plastic brackets inside the mattress, do as shown.

STEP 7

Put into carry bag.

Do as shown

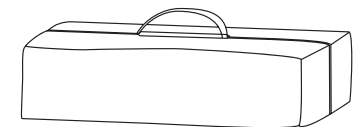
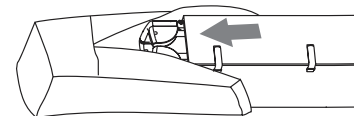

VII. Care & Cleaning

Spot clean with soft clean damp cloth.

Musical toys rack: Wipe clean with a damp cloth and mild soap, Air dry.

Don't immerse in water.

Dolls: Hand wash, air dry

Frame: Wipe the metal frame with soft, clean cloth and mild soap.

VIII WARNING

Failure to follow these warnings and the instructions could result in serious injury or death.

Read all instructions before assembling and using the product.

SUFFOCATION HAZARD

Discard all packing materials immediately after opening. Plastic bags and ties may cause suffocation or choking.

Infants have suffocated

- In gaps between extra padding and side of the bassinet, and
- On soft bedding

Use only the pad provided by manufacturer. **NEVER** add a pillow, comforter, or another mattress for padding. The side rails can only be lowered when the bassinet in bedside sleeper mode.

Please keep the side rails on top position while in bassinet and play yard mode.

WARNING

Strangulation Hazard

Never leave the changing table in place when child is in non-full size crib/play yard.

Never leave the second layer in place when child is in non-full size crib/play yard.

Read all instruction before use of the changing table.

Do not use the changing table if it is damaged or broken.

WARNING

HORIZONTAL RAIL installed in the upper most position, unless securely attached to the adult bed. Always check to be sure that the upper locking bars and the lower locking bars are in their "locked position" before placing the infant in the bedside bassinet.

To reduce the risk of SIDS, pediatricians recommend healthy infants be placed on their backs to sleep, unless otherwise advised by your physician.

FALL HAZARD-Always check that the bassinet is securely locked on the base/stand pulling upwards on the bassinet bed.

Do not place any cord, strap or similar item in or near this accessory that could become wrapped around a child's neck.

If a sheet is used with the pad, use only the one provided by the bassinet or cradle manufacturer or one specifically designed to fit the dimension of the bassinet or cradle mattress.

 WARNING This beside sleeper is designed for use only with adult beds that are between 20.67 and 29.83 inches from floor to top of adult mattress.

 WARNING To avoid death from the infant's neck being caught on the top rail on the side that is next to the adult bed, the top rail must be no higher than the adult bed mattress.

FALL HAZARD-To help prevent falls, do not use this product when the infant begins to push up on hands and knees or has reached 19.8lbs(9KG), whichever comes first.

Strings can cause strangulation! Do not place items with a string around a child's neck, such as hood strings or pacifier cords. Do not suspend strings over a bassinet or cradle or attach strings to toys.

 WARNING **Entrapment Hazard** - To prevent death from entrapment, beside sleeper must be properly secured to adult bed using the attachment system.

(1). There must be no more than ½ in. (13mm) gap between beside sleeper and adult bed.

(2). Check tightness before each use by pulling beside sleeper in a direction away from adult bed.

(3). If gap exceeds ½ in. (13mm). DO NOT use product. Do not fill the gap with pillows, blankets or other items that are suffocation hazards.

 WARNING Always use ALL required parts for each use mode. Check instruction manual for a list of required parts. Periodically check product for loose, damaged, or missing parts.

 WARNING Always read and follow assembly instructions for each product use mode (bedside sleeper, bassinet, playyard).

⚠️ WARNING DO NOT use bedside sleeper if any parts are missing, damaged, or broken. Contact manufacturer for replacement parts and instructional literature if needed. DO NOT substitute parts.

⚠️ WARNING Keep instructions for future use.

⚠️ WARNING Assemble product according to manufacturer's instructions for ANY use mode-bedside sleeper as well as the bassinet or play yard modes, or both.

⚠️ WARNING A bedside sleeper is designed to provide a sleeping area for an infant until he or she begins to push up on hands and knees or approximately 5 months of age. Move your child to another sleeping product when your child reaches this stage.

⚠️ WARNING-NEVER LEAVE INFANT IN PRODUCT WITH SIDES DOWN.

Infant may roll into space between pad and loose mesh side causing suffocation.

Failure to follow these warnings and the instructions could result in serious injury or death.

The product, including side rails, must be fully erected prior to use.

Strings can cause strangulation!

Never place items with a string around a child's neck such as hood strings or pacifier cords.

Never suspend strings over product or attach strings to toys.

Discontinue use of the product when child is able to climb out or reaches the height of 35 in. (890mm).

Child can become entrapped and die when improvised netting or covers are placed on top of product.

Never add such items to confine child in product.

When child is able to pull to standing position, remove bumper pads, large toys, and other objects that could serve as steps for climbing out.

Never place product near a window where cords from blinds or drapes can strangle a child.

Use ONLY mattress provided by manufacturer (which must be at least 41.7 in. long by 23.6 in. wide and not more than 0.6 in. thick).

Always provide the supervision necessary for the continued safety of your child.

When used for playing, never leave child unattended.

To reduce the risk of SIDS pediatricians recommend healthy infants be placed on their back to sleep, unless otherwise advised by your physician.

⚠️ WARNING

Never leave child in product with side lowered, Be sure side is in raised and locked position whenever child is in product.

Never use plastic shipping bags or other plastic film as mattress cover not sold and intended for that purpose. They can cause suffocation.

Never use a water mattress with this product.

⚠️ WARNING

FALL HAZARD: Children have suffered serious injuries after falling from changing tables. Falls can happen quickly.

- **STAY** in arm's reach of your child.

- **ALWAYS** secure this product to the support frame by (manufacturer's instructions for securing the changing table accessory). See instructions.

SUFFOCATION HAZARD: Babies have suffocated while sleeping in changing areas. Changing areas are not designed for safe sleeping.

- **NEVER** allow baby to sleep in changing area.

The changing table is intended for children from birth to 12 months and maximum weight up to 11 kgs.

⚠️ WARNING

Never use this product if there are any loose or missing fasteners, loose joints, broken parts, or torn mesh/fabric. Check before assembly and periodically during use. Contact Shenzhen Guiyang Network Technology Co., Ltd for replacement parts.

Never substitute parts.

⚠️ WARNING

Strangulation Hazard

Always attach mattress securely. If mattress is not secured, child in play yard can lift or shift mattress and get neck trapped between mattress and play yard frame.

WARNING

- Never place a child in the playpen when in bassinet mode.
- Ensure that the sides and bottom of this playpen are properly latched or locked in the appropriate position before placing a child in it. Never leave infant in product with sides down.
- NEVER use plastic shipping bags or other plastic film as mattress covers not sold and intended for that purpose. They can cause suffocation.
- Strings can cause strangulation! Never place items with string around a child's neck such as hood strings or pacifier cords. Never suspend strings over product or attach strings to toys.
- NEVER place more than one child in the playpen. Only one child can use playpen at anytime.
- This product is not intended for commercial use.
- Discontinue use of the product when child is able to climb out or reaches the height of 35 in(890mm) When child is able to pull to standing position, remove bumper pads, large toys, and other objects that could serve as steps for climbing out.
- Use ONLY mattress provided by manufacturer(which must be at least 41.7 in. long by 23.6in. wide and not more than 0.6 in. thick).
- Always provide the supervision necessary for the continued safety of your child. When used for playing, never leaved child attended.

WARNING

NEVER LEAVE INFANT IN PRODUCT WITH SIDES DOWN.

Infant may roll into space between mattress and loose mesh side cause suffocation Inant can suffocate

In gaps between a mattress too small or too thick and product sides. On soft bedding. NEVER add a mattress, pillow, comforter, or padding. See long top rail and instruction for warnings.

WARNING

Failure to follow these warnings and the instructions could result in serious injury or death.

SUFFOCATION HAZARD INFANTS HAVE SUFFOCATED:

- In gaps between extra padding and side of the bassinet / Cradle, and on soft bedding.
- Use ONLY the pad provided by manufacturer. NEVER add a pilow comforter or another mattres for padding.
- FALL HAZARD-To help prevent falls. do not use this product when the infant begins to push up on hands and knees or has reached 19.8 bs. whichever comes first.
- Entrapment Hazard-To prevent death from entrapment, bedside sleeper must be properly securedto adult bed using the attachment system.
 - (1)There must be no more than 1/2 in. (13mm) gap between bedside sleeper and adult bed.
 - (2)Check tightness before each use by pulling bedside sleeper in a direction away from adult bed.
 - (3)If gap exceeds 1/2 in. (13mm), DO NOT use product. Do not fill the gap with pillows, blankets or other items that are suffocation hazards.
- Always read and follow assembly instructions for each product use mode (bedside sleeper, bassinet, play yard).
- If a sheet is used with the pad, use only the one provided by the bassinet or cradle manufacturer or one specifically designed to fit the dimension of the bassinet or cradle mattress.

WARNING

- To avoid death from the infant's neck being caught on the top rail on the side that is next to the adult bed, the top rail must be no higher than the adult bed mattress.
- The product, including side rails, must be fully erected prior to use.
- Make sure latches are secure.
- Strings can cause strangulation! Never place items with string around a child's neck such as hood strings or pacifier cords. Never suspend strings over product or attach strings to toys.
- Child can become entrapped and die when improvised netting or covers are placed on top of product. Never add such items to confine child in product.
- Never place product near a window where cords from blinds or drapes can strangle a child.
- To reduce the risk of SIDS, pediatricians recommend healthy infants must be placed on their back to sleep, unless otherwise advised by your physician.
- Never use this product if there are any loose or missing fasteners, loose joints, broken parts, or torn mesh/fabric. Check before assembly and periodically during use. Contact manufacturer for replacement parts.
- Never place a child under the changing product.
- Failure to follow these warnings and the instructions could result in death or serious injury.

SUFFOCATION HAZARD

Babies have suffocated:

WARNING

- **On** pillows, comforters, and extra padding.
- **In** gaps between a wrong-size mattress, or extra padding and product sizes.
- **NEVER** add soft bedding or padding.
- **Use ONLY** mattress provided by manufacturer.
- Always place baby on back to sleep to reduce the risk of SIDS and suffocation.
- **FALL HAZARD —To** help prevent falls, do not use this product when the infant begins to push up on hands and knees or has reached insert manufacturer's recommended weight of 19.8lbs(9KG), whichever comes first.
- Always check that the bassinet is securely locked on the base/stand by pulling upwards on the bassinet bed.
- Always read and follow assembly instructions for bassinet. Check instruction manual for a list of required parts. Periodically check product for loose, damaged, or missing parts.
- Assemble product according to manufacturer's instructions for bassinet.
- **DO NOT** use bassinet if any parts are missing, damaged, or broken. Contact manufacturer for replacement parts and instructional literature if needed. **DO NOT** substitute parts.
- If a sheet is used with the mattress, use only the one provided by the product manufacturer or one specifically designed to fit the dimension of the product mattress.
- Strings can cause strangulation! Do not place items with a string around a child's neck, such as hood strings or pacifier cords.
- **DO NOT** suspend strings over a bassinet or cradle or attach strings to toys.