

# SFW - HA6 SERIES SAFE DEPOSIT BOX INSTRUCTION GUIDE

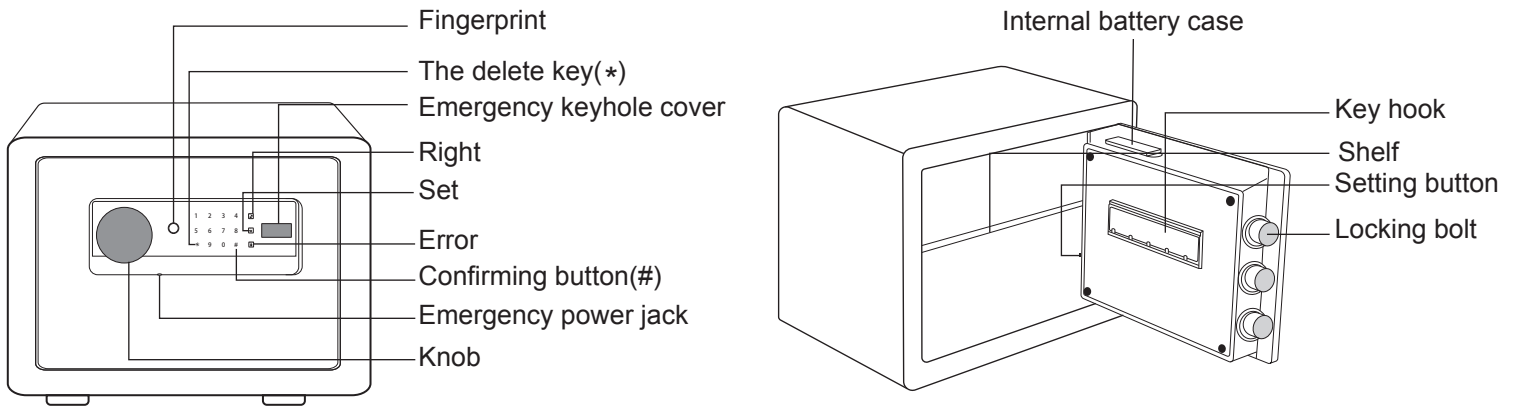

## ACCESSORIES

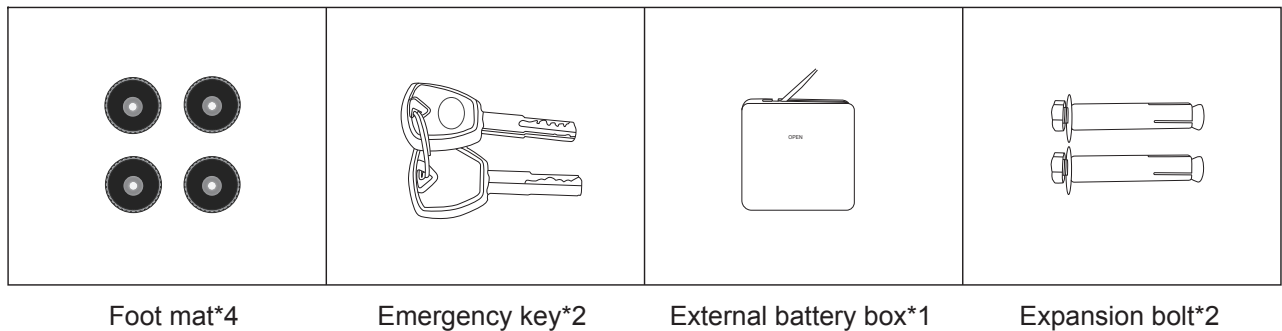

## WARNINGS

- ⚠ 1. Do not lock the emergency key or external battery box into the cabinet.
- ⚠ 2. If the safe box is not used for a long time, please remove its battery.
- ⚠ 3. Purchase 4 AA batteries in advance, this safe does not contain batteries.

## HOW TO USE YOUR SAFE BOX?

### Step1 Open the safe for the first time

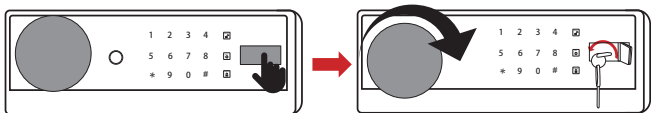

Press the keyhole, insert the emergency key, and turn it counterclockwise. Press the knob, it will be pop up, turn the knob clockwise to open the door successfully for the first time.

### Step2 Insert the battery

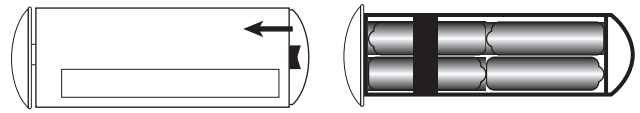

Remove the internal battery box cover and install the 4 AA 1.5 Volt alkaline batteries, the system will power on. (rechargeable battery is not recommended as it may destroy safe box's internal electronic components)

### ➤ Step3 Set the password

Short press the setting button inside the door, enter the management password (initial management password "123456"), press # to confirm, you can enter the management mode. To set the user password, please press "1", enter a new password with 4-8 digits, press # to confirm, then enter the same password again, press # to confirm, the password is set successfully.

**⚠ Tip: Please verify the passwords after done the passwords setting, and lock the door after verification.**

### ➤ Step4 Set fingerprint

To set the fingerprint, please press "2", the light of the fingerprint reader will light up, put your finger on the fingerprint reader, remove your finger and press again. Repeat 4 times to set the fingerprint successfully. (20 fingerprints can be stored, in order to better improve the verification pass rate, it is recommended to enter multiple angles with one finger)

(1) Delete fingerprints, press "3" to delete the entered fingerprints;

(2) To set the management password, please press "4", enter a new password with 4-8 digits, press # to confirm, and then enter the same password again, press # to confirm, and the management password is set successfully.

### ➤ Step5 Restore factory Settings

Long press the red button for 2-3 seconds, you will hear the long sound beep. The initial password is 123456, and the fingerprint is cleared.

## VIBRATION ALARM MODE SETTING

In standby state, press the \* button, all the lights are on at the same time, and then you will hear a beep of Di, the vibration alarm mode is turned on. If the box is shaken or tilted, it will alarm immediately, at this point, enter the correct password.

## ERROR ALARM FUNCTION

After 3 consecutive time of wrong code, your safe will activate the alarm system, the alarm will sound, then enter the correct password and the alarm will be stopped.

## UNDER-VOLTAGE WARNING

When the voltage is around 4.8V, after opening the door, the buzzer 'beep' will ring 9 times, reminding the user that the battery power is low and the user needs to replace the battery.

## HOW TO USE EMERGENCY BATTERY BOX

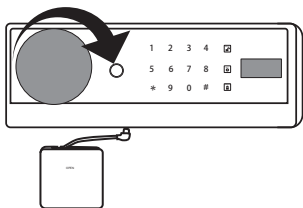

When the safe box's battery is too low to open the door, insert 4AA 1.5 batteries in the emergency battery box, plug the emergency power cord into the emergency power jack on the bottom edge of the panel, then enter the correct password to open the door.

### How to install foot mat?

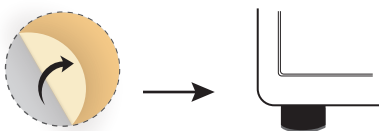

Remove the sticker of the foot mat and install it on the bottom of the safe

### How to mount the safe?

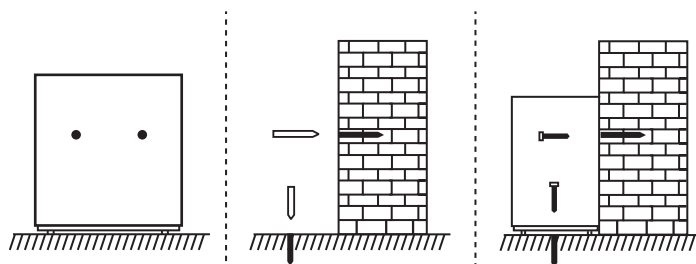

1. Place the safe on the installation location, find the installation holes from the inside of the safe, mark the drilling points from the inner installation holes, then remove the safe and drill two holes.
2. Take the expansion bolt out of the casing and put it into the drilled hole, then align the pre-drilled hole with the inner hole of the safe, and then insert the expansion bolt into the casing from the inside of the safe.