

Sonoma Conner Cabinet

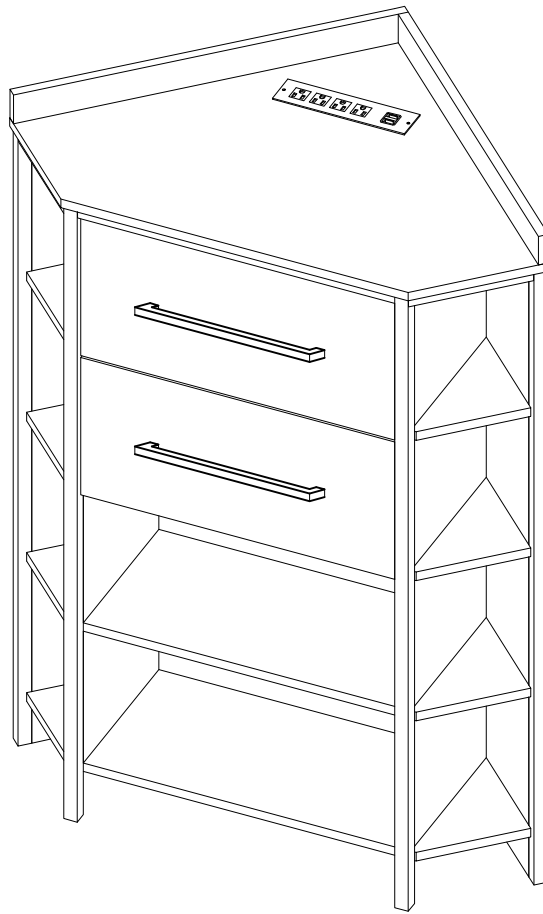



Estimated time for assembly:

120 mins



Weight limitations are as follows:

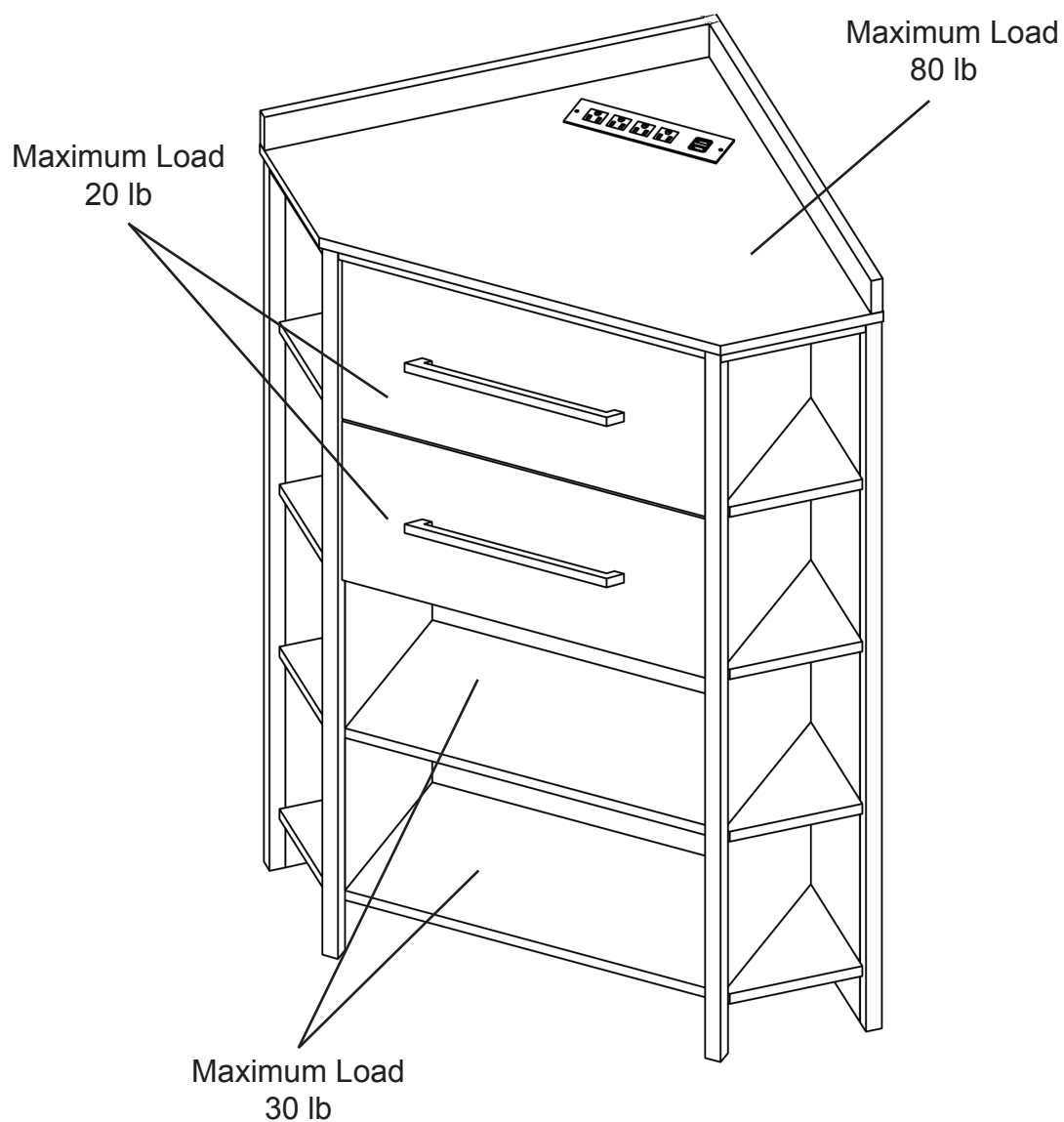

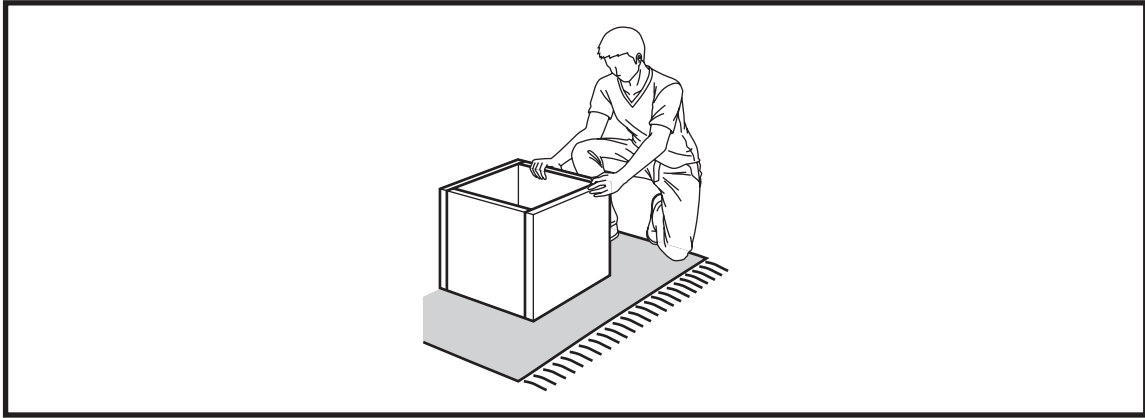

Assemble the furniture on an empty carton, carpet, or rug to prevent scratches or damage.

For safety, please keep pets and children away from the assembly area.

Ensure the product is fully assembled before use. If you are missing any hardware or products, do not use it until you have restored the missing parts.

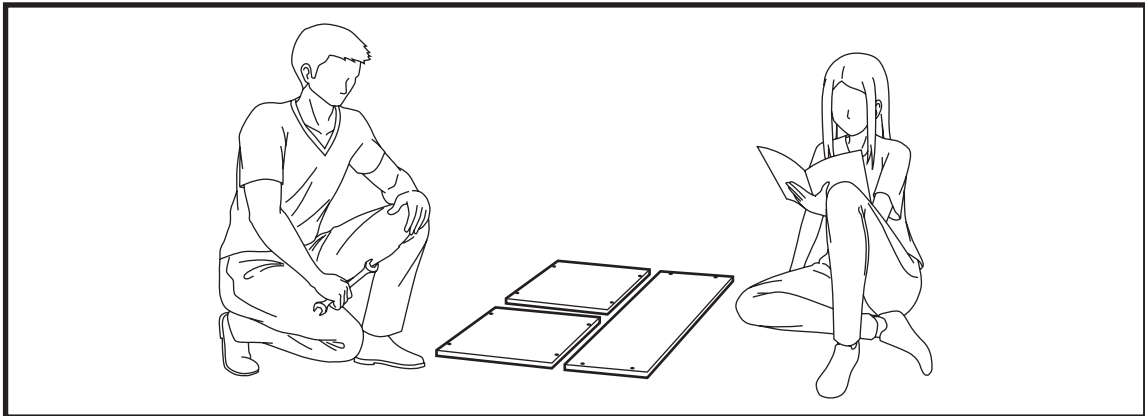

This furniture requires 2 people for assembly.

Read this instruction manual prior to assembly to familiarize yourself with the various steps.

Lay out all components and hardware separately on a flat surface and make sure that no parts are missing or damaged before assembly. Do not destroy or discard any packaging until you are certain that you have all the necessary parts for assembly.

Hand tight all hardware and careful not to over tighten to avoid damaging the product.

CAUTION

There are small components used in the construction of this product. Loose items should be kept away from pets and children to avoid a choking hazard.

Keep all plastic bags and packaging film away from pets and children to avoid suffocation.

PACKAGE CONTENTS

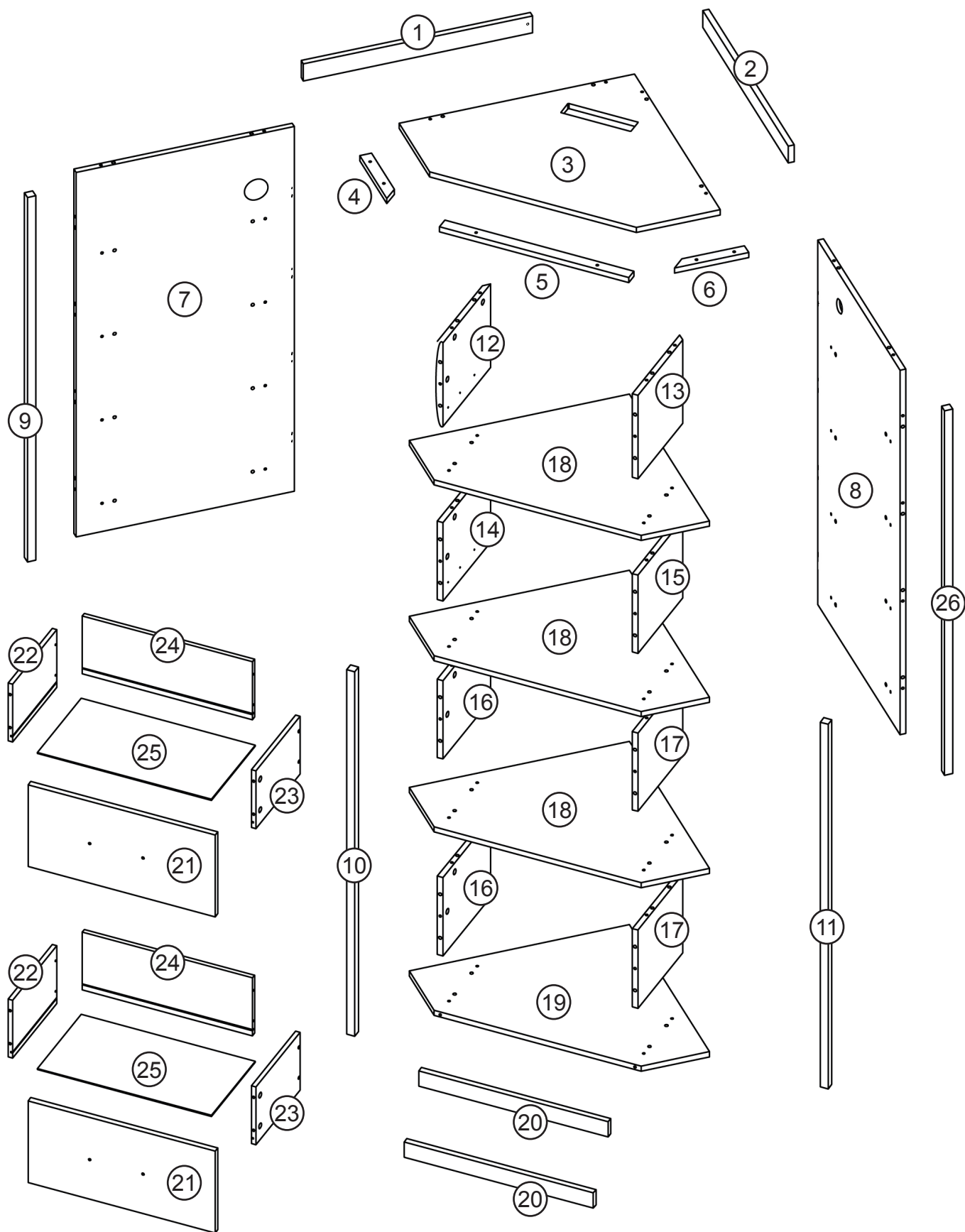

PACKAGE CONTENTS

CODE	DESCRIPTION	QTY
1	Top Left Backsplash Panel	1
2	Top Right Backsplash Panel	1
3	Top Panel	1
4	Left Decoration Strip	1
5	Center Decoration Strip	1
6	Right Decoration Strip	1
7	Left Back Panel	1
8	Right Back Panel	1
9	Left Side Support Strip	1
10	Front Left Support Strip	1
11	Front Right Support Strip	1
12	Top Left Divider Panel	1
13	Top Right Divider Panel	1
14	Middle Left Divider Panel	1
15	Middle Right Divider Panel	1
16	Bottom Left Divider Panel	2
17	Bottom Right Divider Panel	2
18	Shelf Panel	3
19	Bottom Panel	1
20	Shelf Baffle	2
21	Drawer Front Panel	2
22	Drawer Left Panel	2
23	Drawer Right Panel	2
24	Drawer Back Panel	2
25	Drawer Bottom Panel	2
26	Right Side Support Strip	1

PACKAGE CONTENTS



46x + 4x

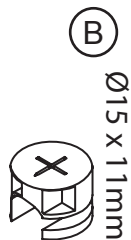

46x + 4x

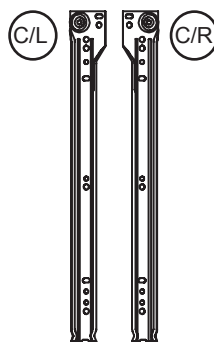

2x

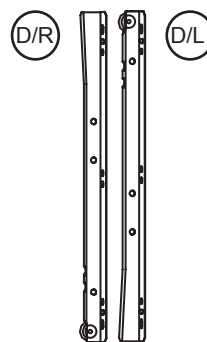

2x



41x + 4x



8x



22x + 2x



6x

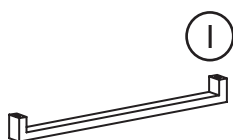

2x



4x



76x + 7x



1x

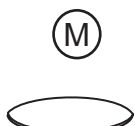

26x + 2x



1x



2x



2x



2x



2x



Install all hardware perpendicular to the opening.

Required tools for assembly (Not included)

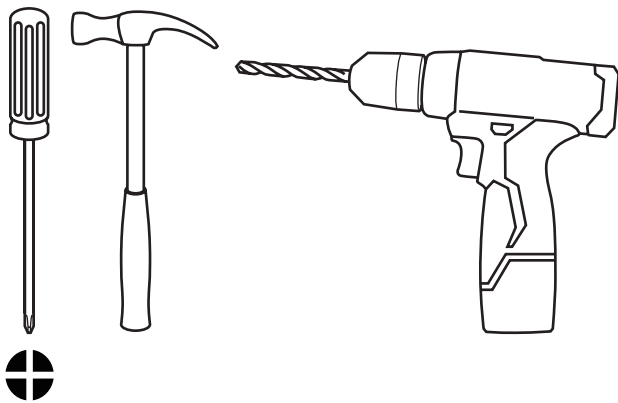

1

Assemble the drawer back panel (24) between the drawer left and right panel (22, 23).



(F) 8x

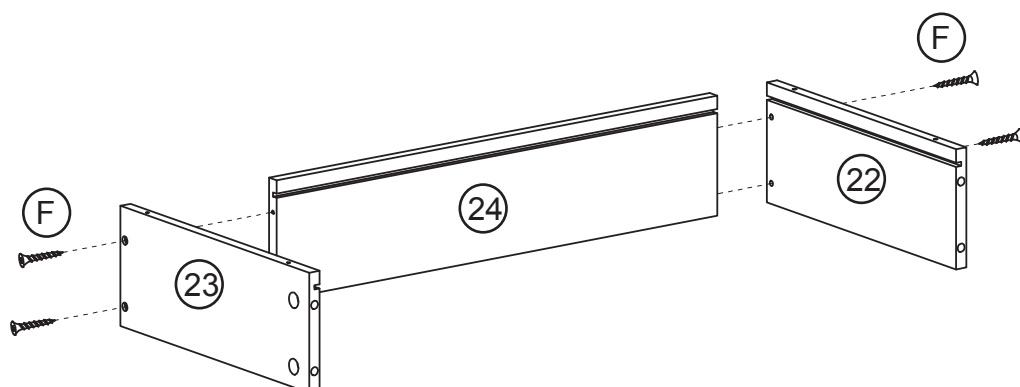

x2

2

Attach cam Bolts and drawer handle to the drawer front panel (21).

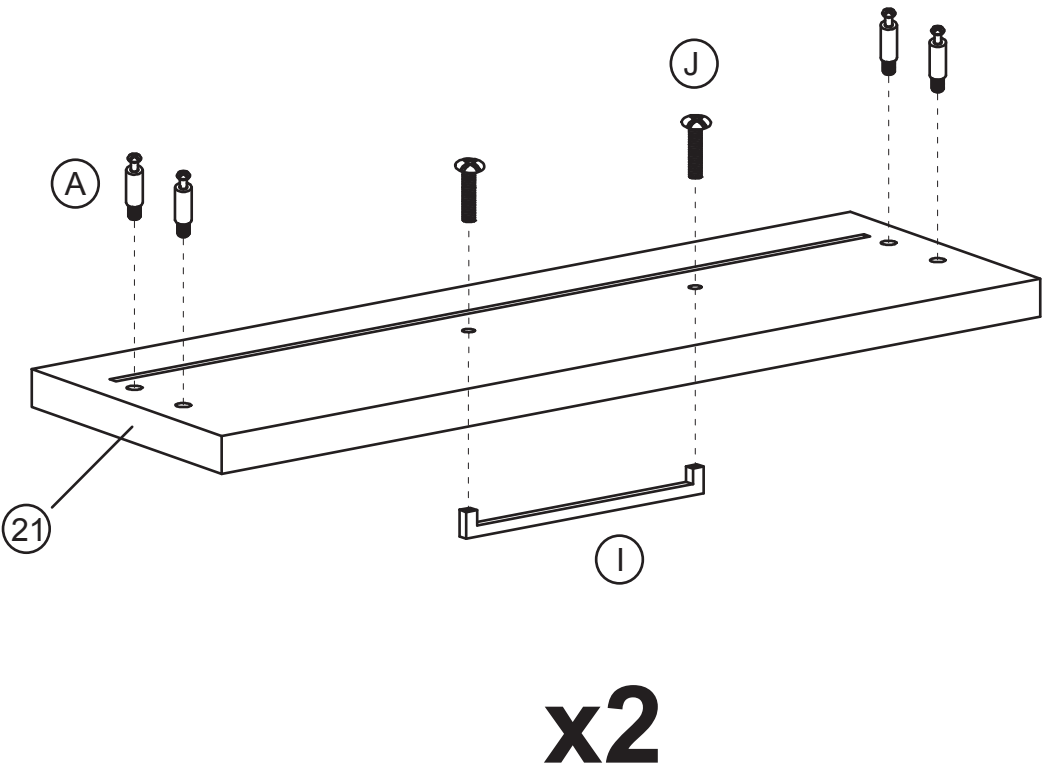
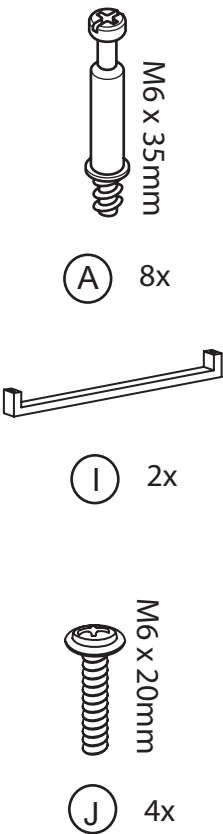

3

Assemble the drawer bottom panel (25) and the drawer front panel (21) to the drawer assembly.

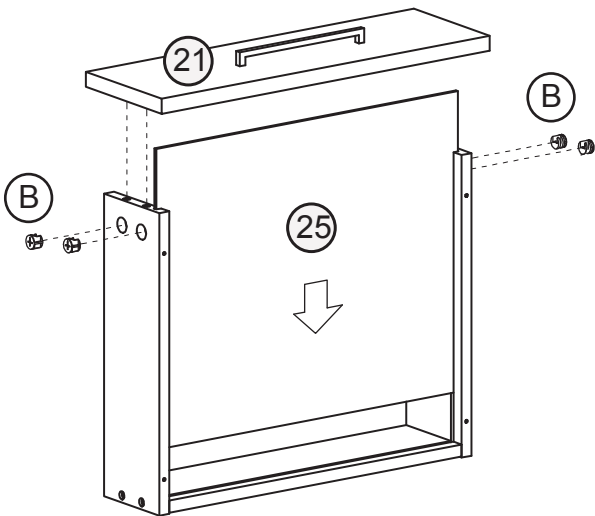
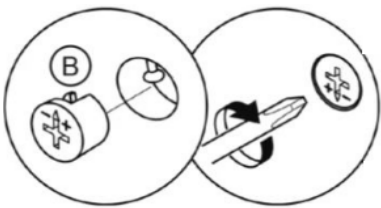

4

Attach drawer slides to the sides of the drawer.

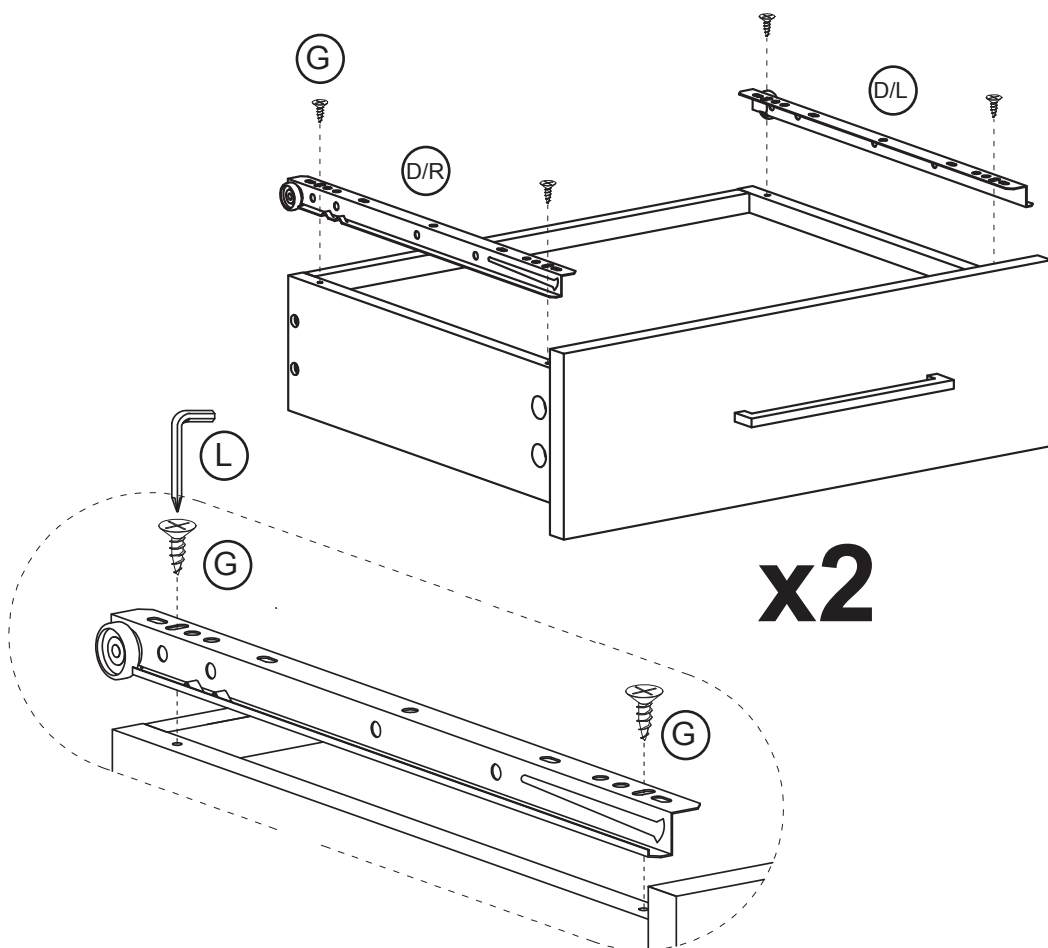
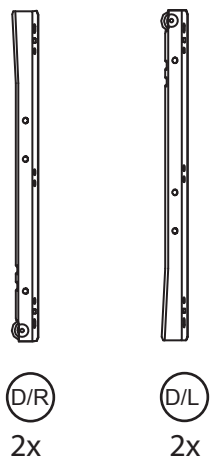

5

Assemble the drawer slider bracket to the top left divider panels (12).

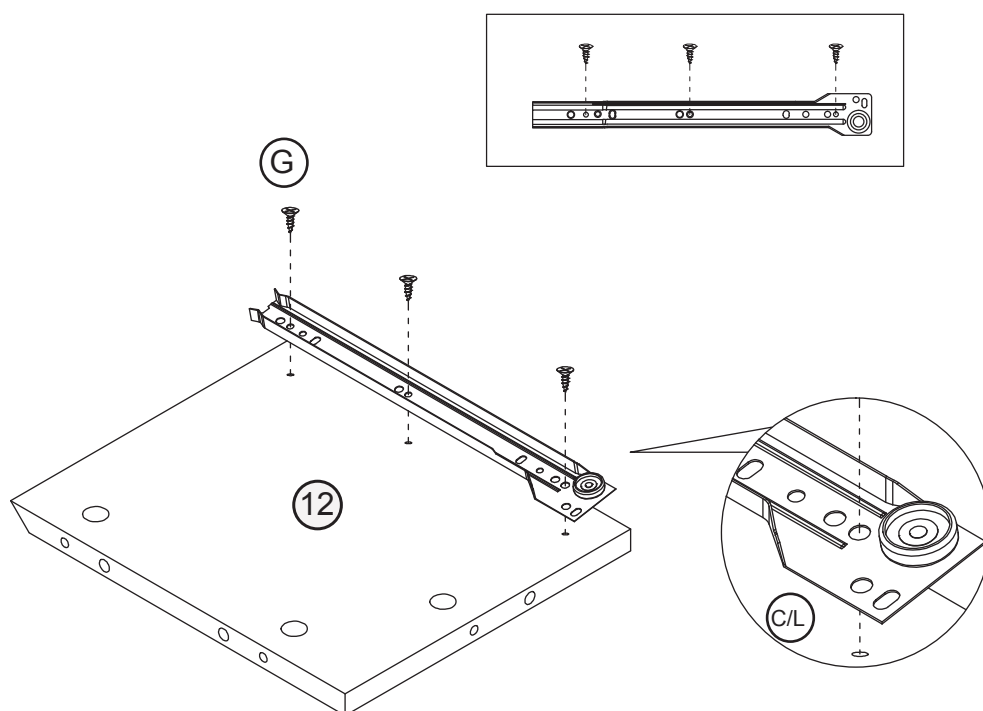
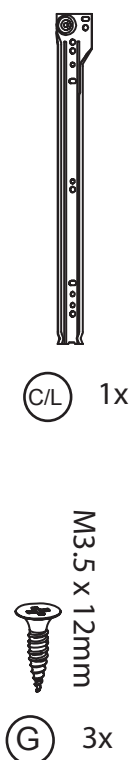

6

Assemble the drawer slider bracket to the top right divider panels (13).



(C/R) 1x



(G) 3x

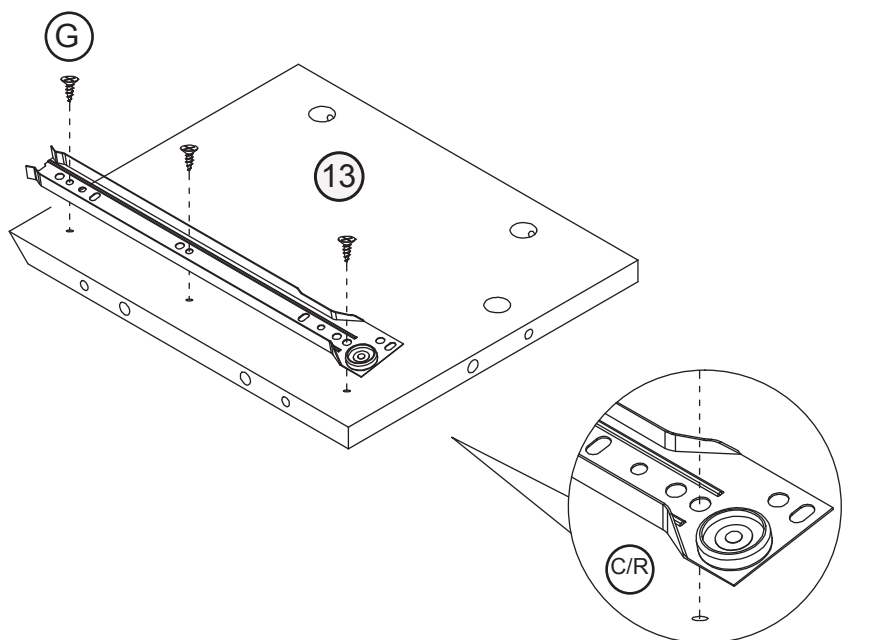

7

Assemble the drawer slider bracket to the middle left divider panels (14).



(C/L) 1x



(G) 3x

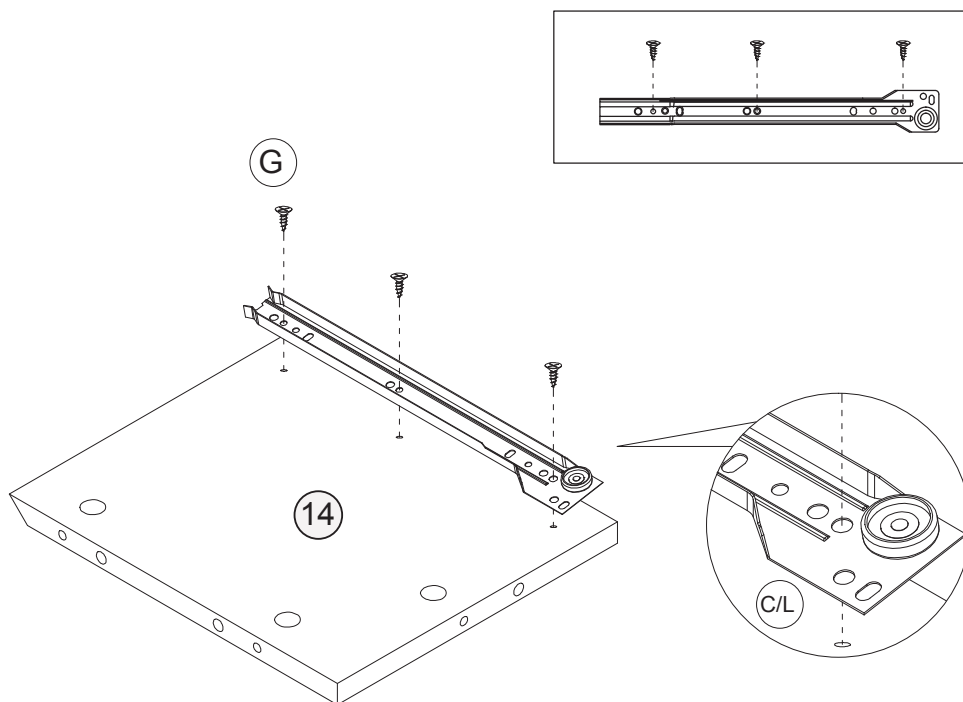

8

Assemble the drawer slider bracket to the middle right divider panels (15).

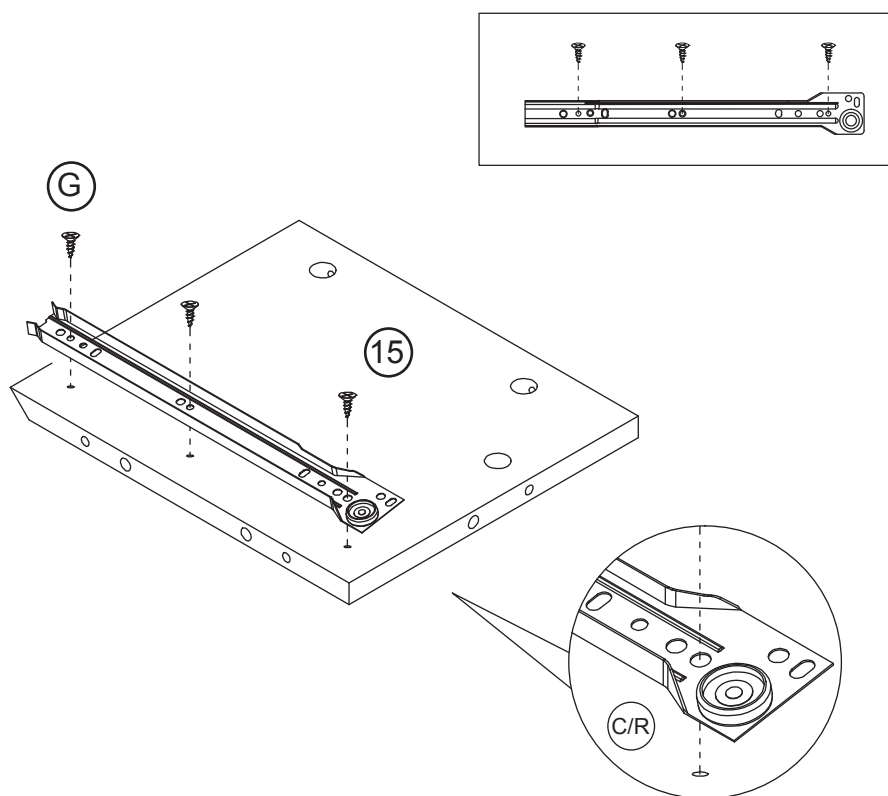
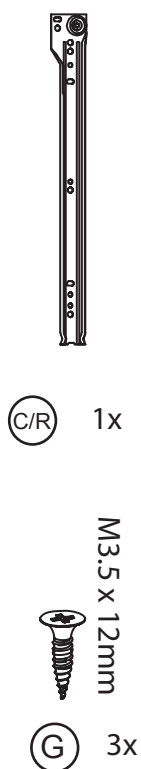

9

Insert wood dowels into the top left and right divider panels (12, 13).
Assemble the top left and right divider panels (12, 13) on top of a shelf panel (18).

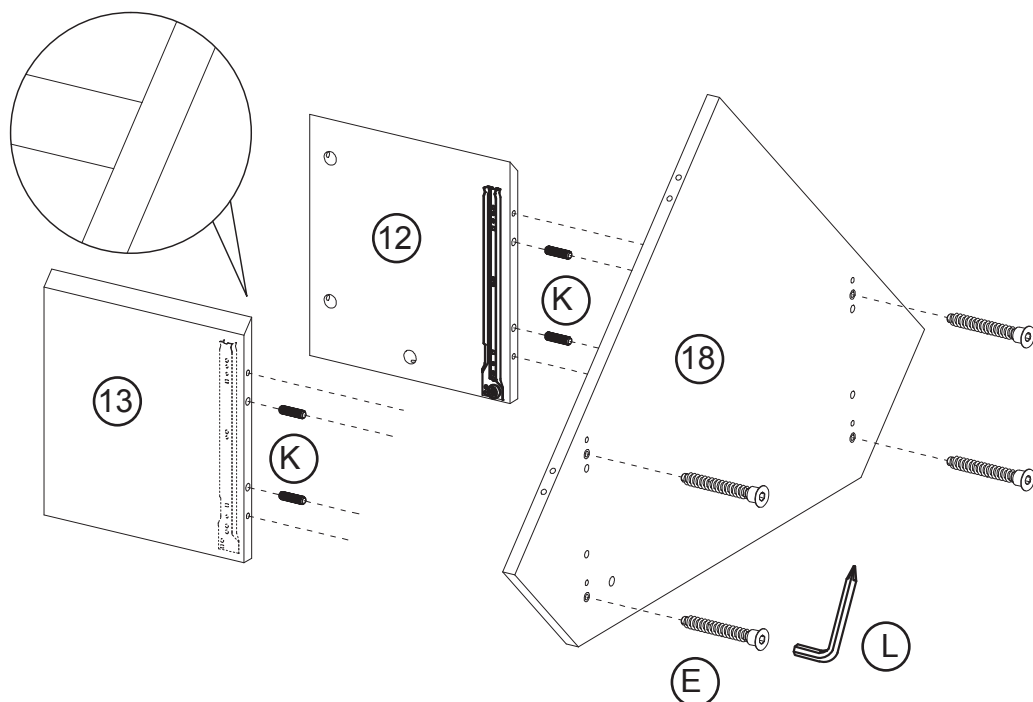
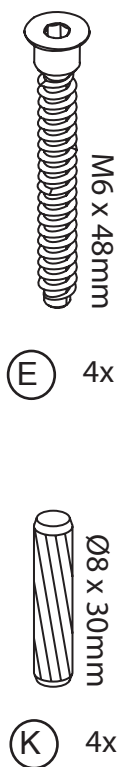

10

Attach cam bolts and wood dowels to the shelf panel (18).



(A) 4x



(K) 4x

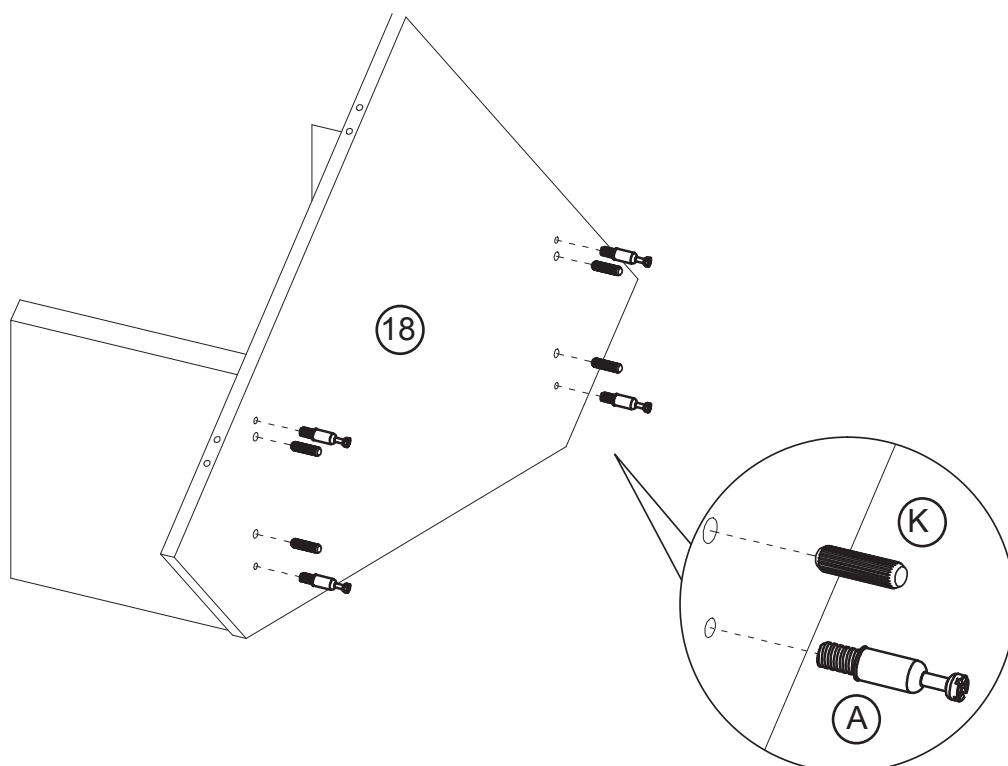

11

Assemble middle left and right divider panel (14, 15) underneath the shelf panel (18).



(B) 4x

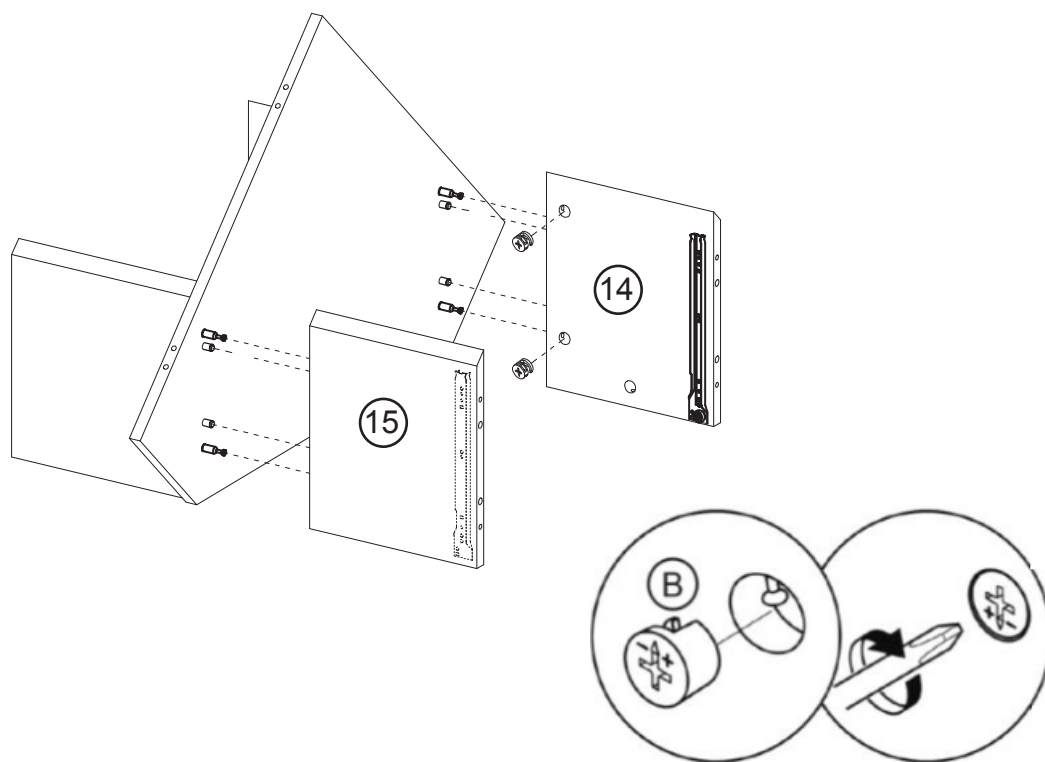

12

Assemble another shelf panel (18) to the assembly.



(E) 4x



(K) 4x

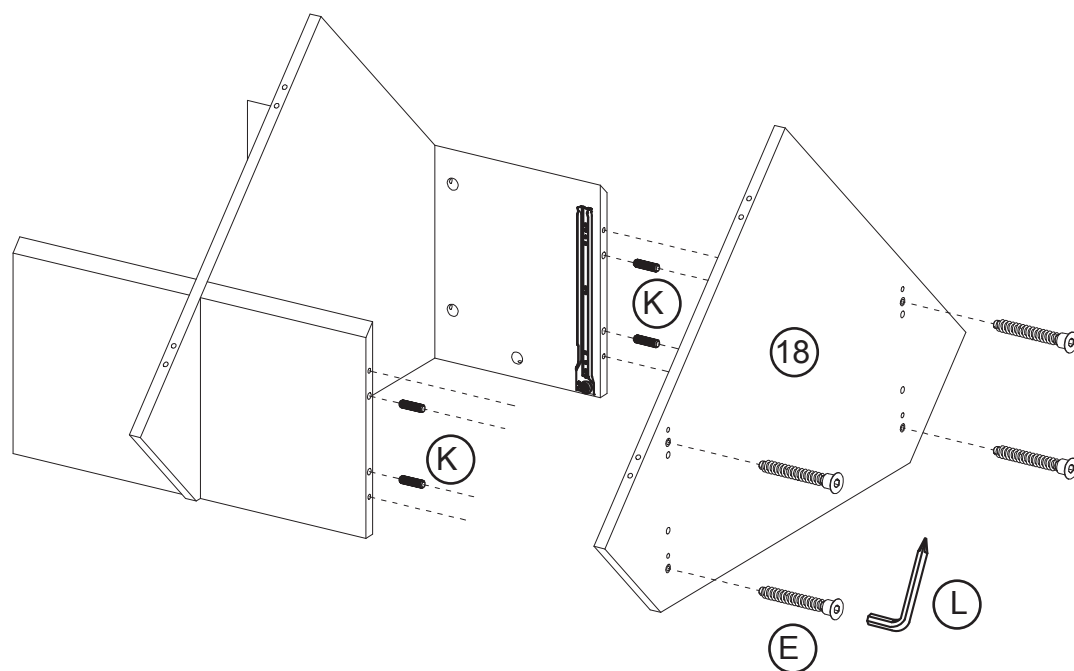

13

Attach cam bolts and wood dowels to the shelf panel (18).



(A) 4x



(K) 4x

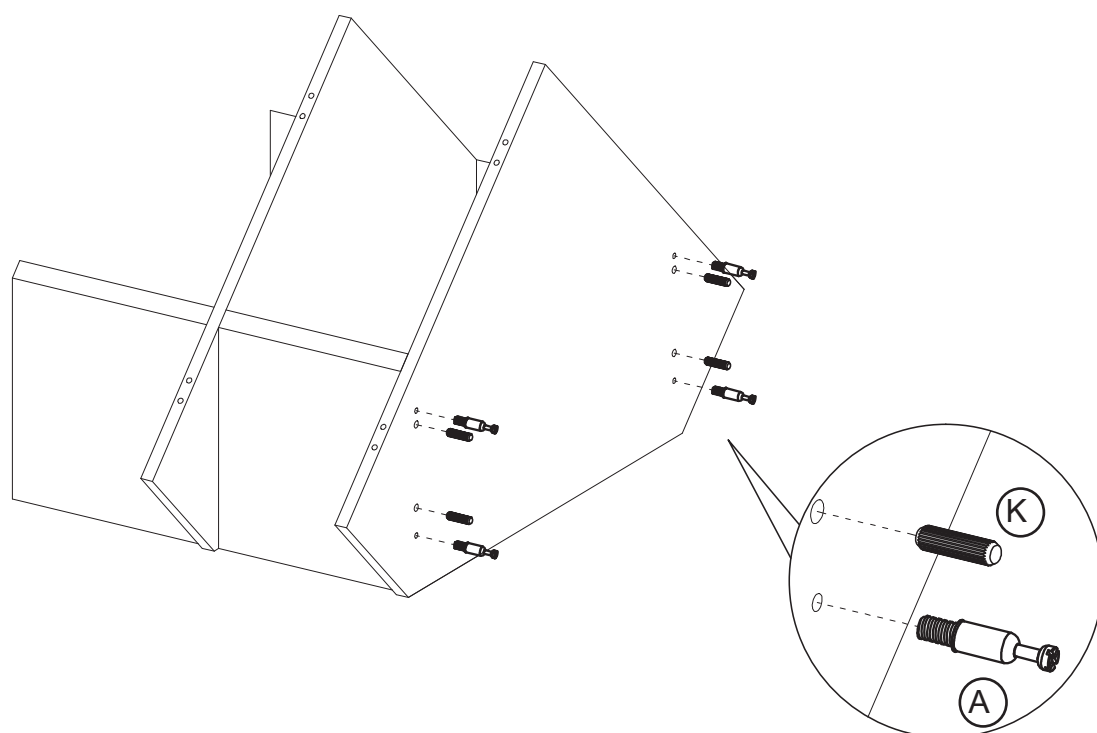

14

Assemble another set of bottom left and right divider panel (16, 17) underneath the shelf panel (18).



(B) 4x

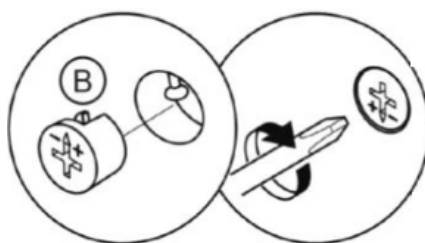
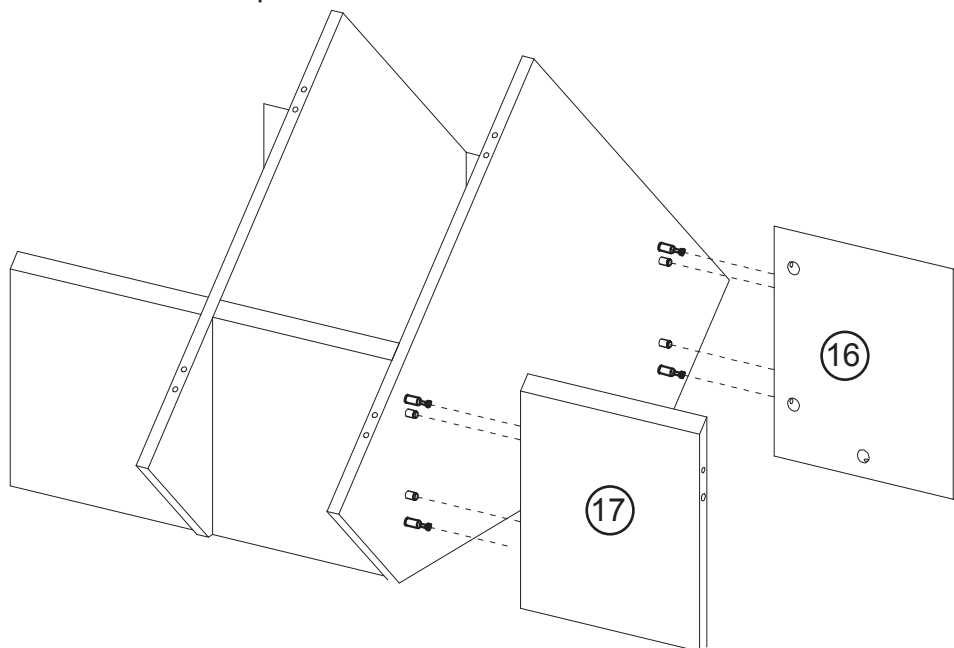

15

Insert wood dowels to the bottom left and right divider panel (16, 17). Assemble another shelf panel (18) to the assembly.



(E) 4x



(K) 4x

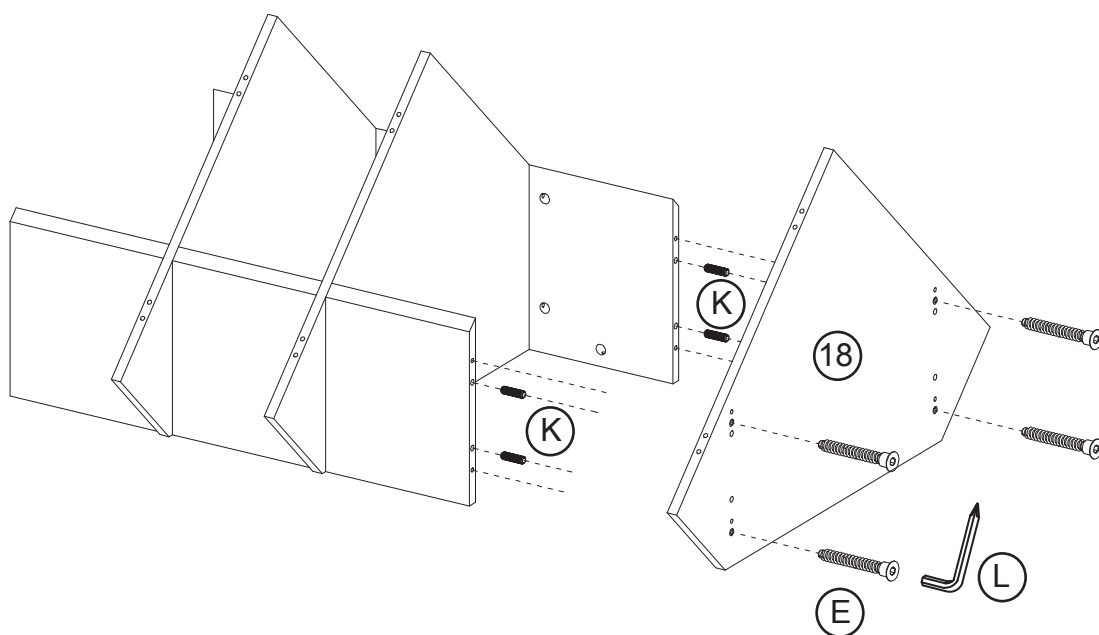

16

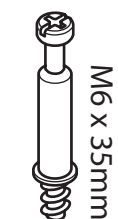

M6 x 35mm

(A) 4x



Ø15 x 11mm

(B) 4x



Ø8 x 30mm

(K) 4x

Attach cam bolts and wood dowels to the shelf panel (18).
Assemble another set of bottom left and right divider panel (16, 17) underneath the shelf panel (18).

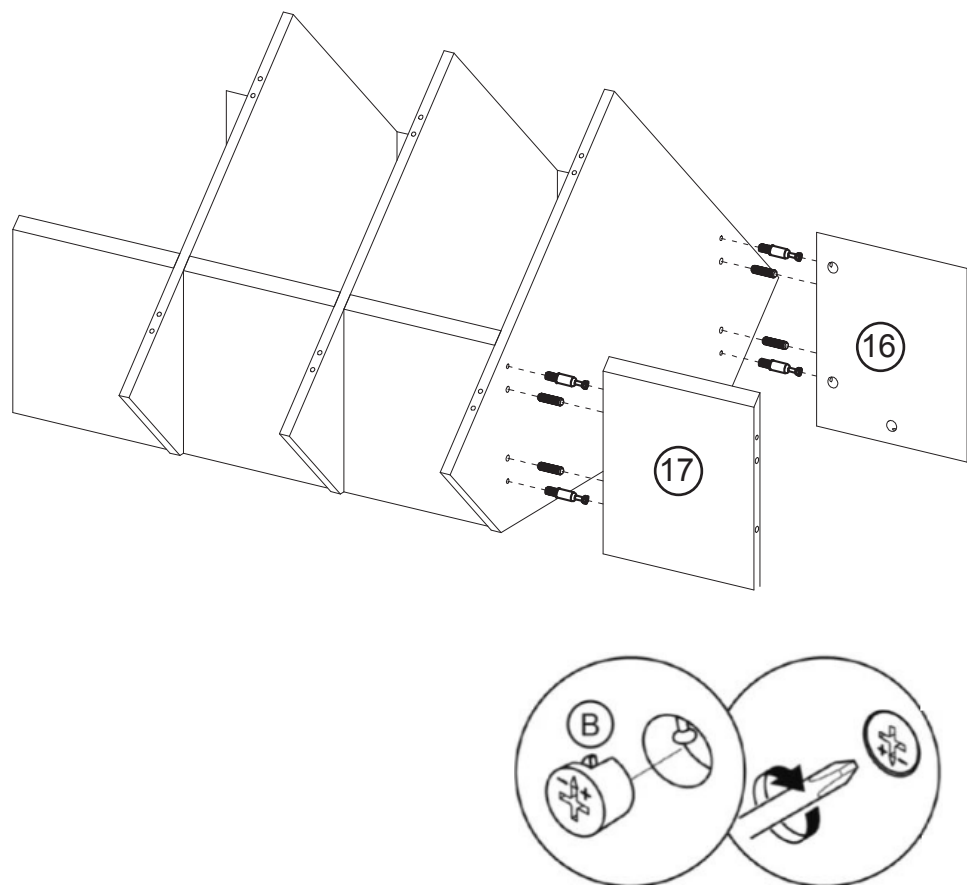

17



M6 x 48mm

(E) 4x



Ø8 x 30mm

(K) 4x

Attach wood dowels to the shelf panel (16, 17).
Assemble the bottom panel (19) underneath the bottom left and right divider panel (16, 17).

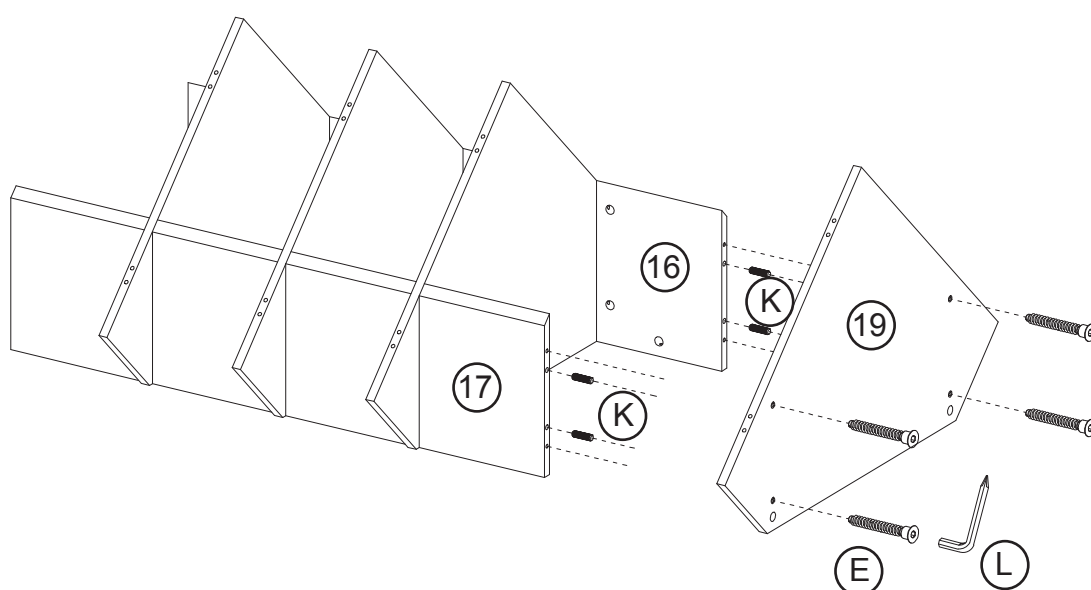

18

Attach cam bolts to the left and right side support strips (9,26), the front left support strip (10) and the front right support strip (11).



(A) 18x

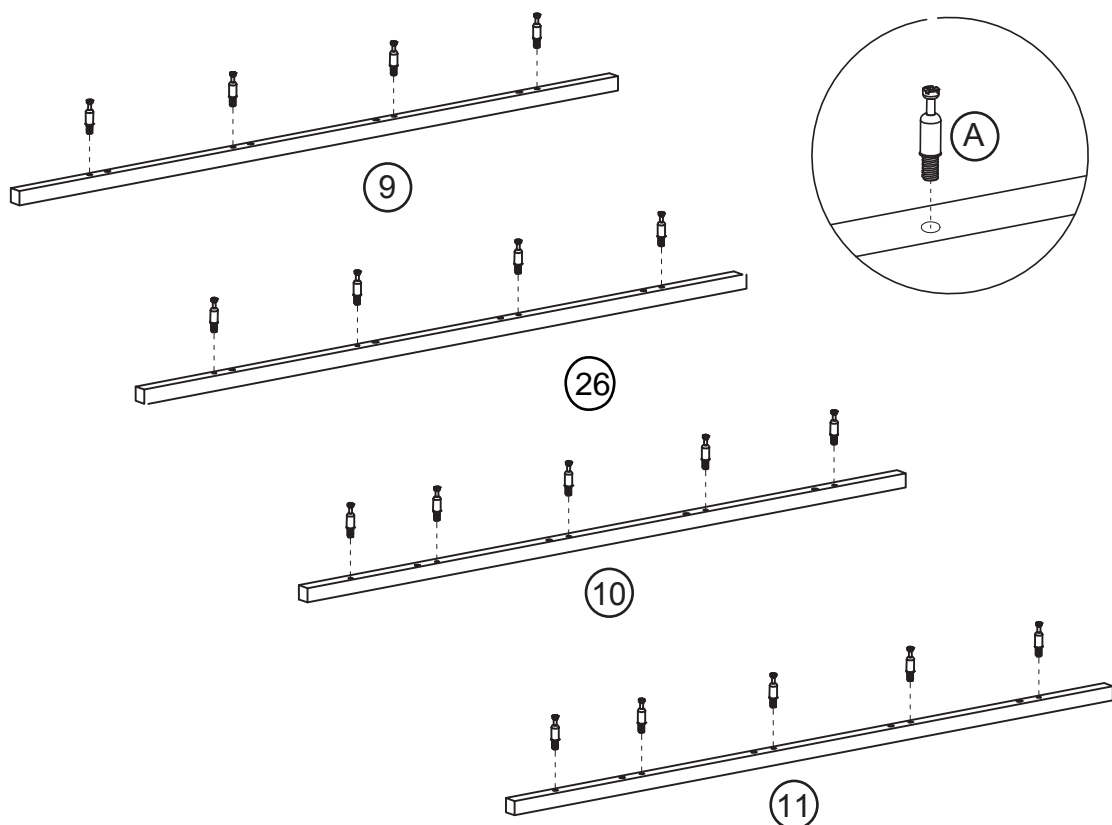

19

Insert wood dowels to the side of the shelf panels (18) and the bottom panel (19).



(K) 8x

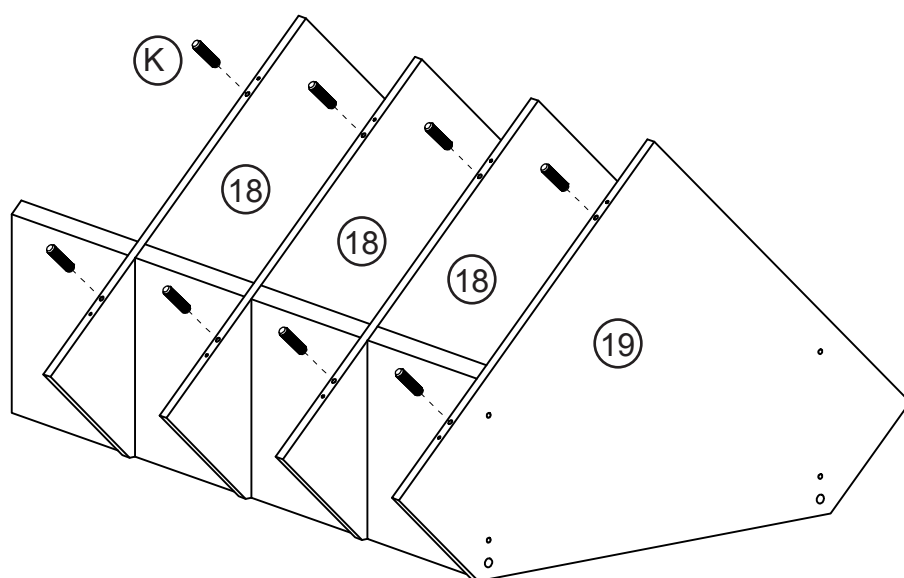

20

Assemble the right back panel (8) to the shelf assembly.

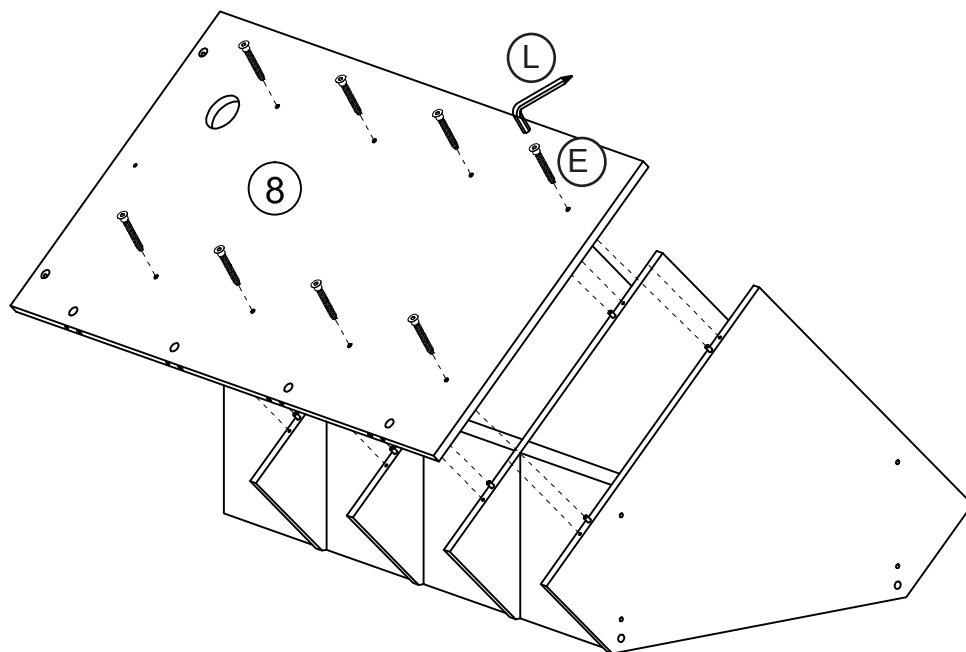

21

Assemble a right side support strip (26) to the right back panel (8).

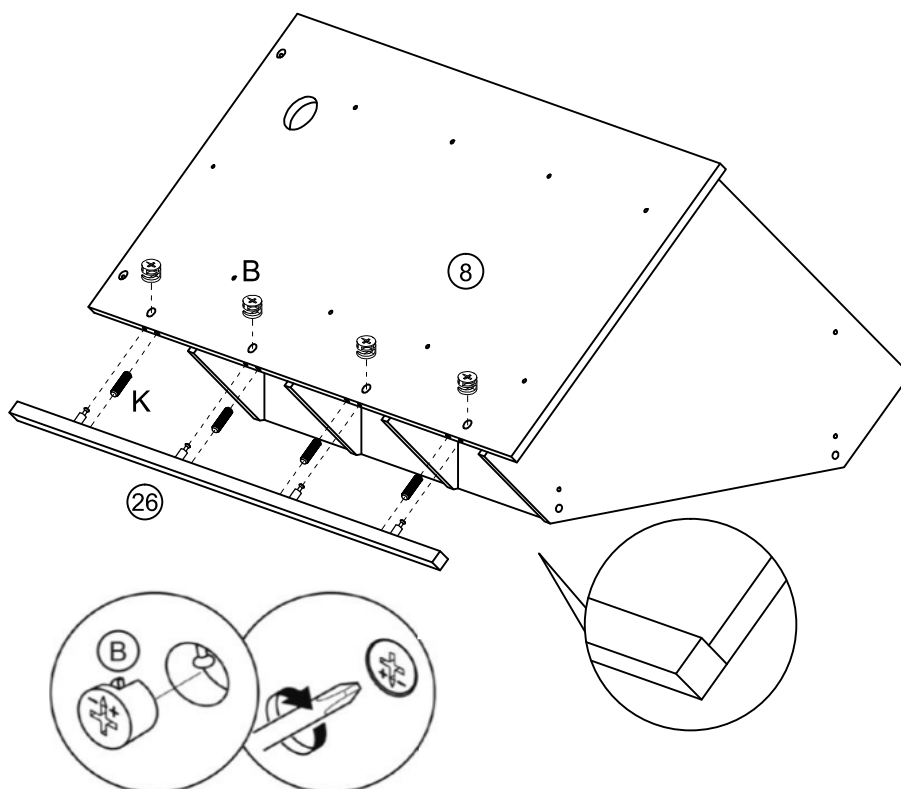

22

Insert wood dowels to the side of the shelf panels (18) , the bottom panel (19) and the right back panel (8).

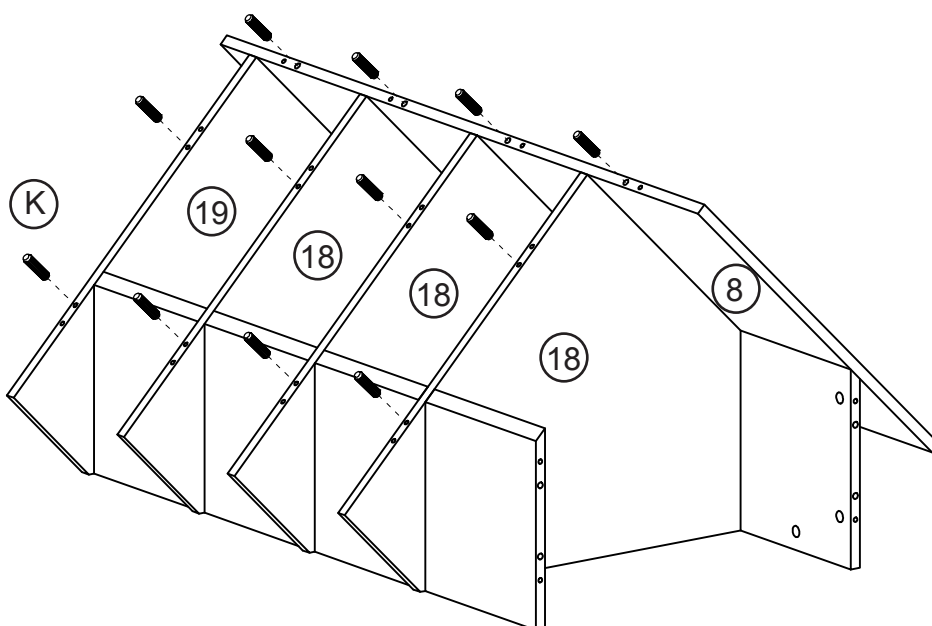

23

Attach the left back panel (7) to the shelf assembly.

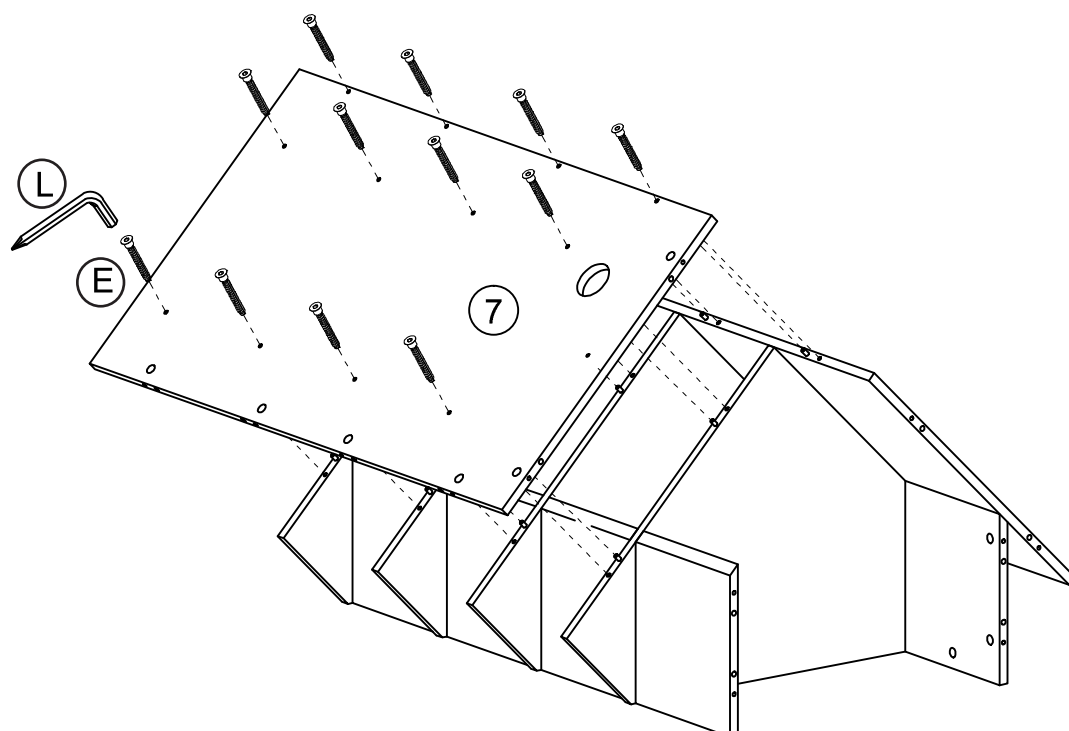

24

Assemble a left side support strip (9) to the left back panel (7).



(B) 4x



(K) 4x

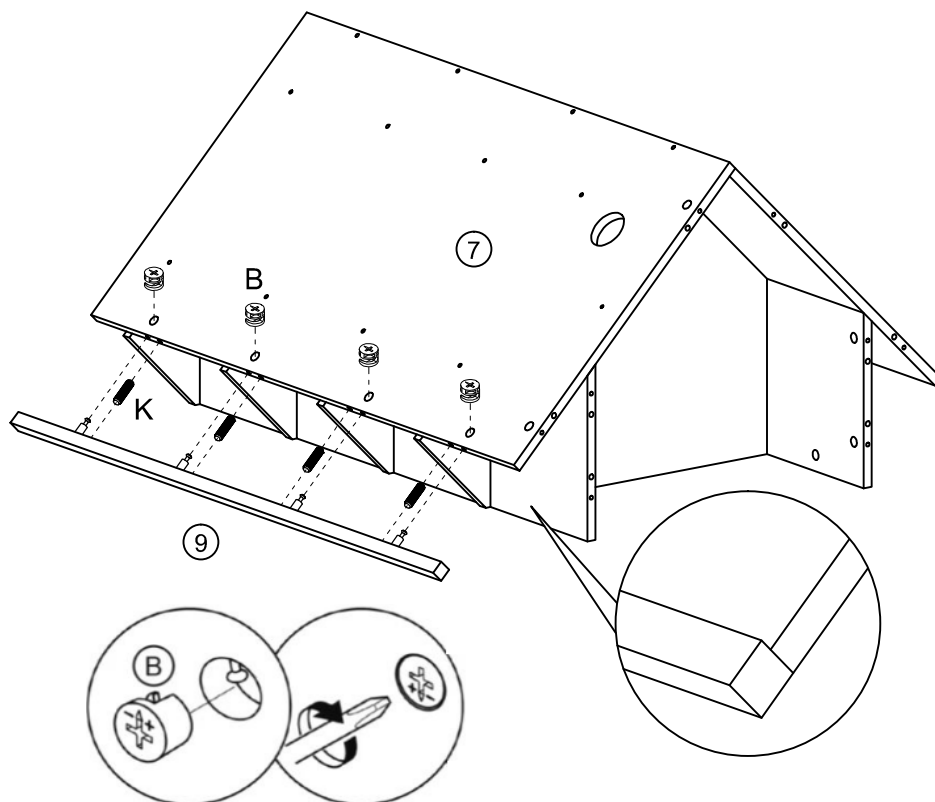

25

Assemble the front left and right support strip (10, 11) to the assembly.



(B) 10x



(K) 8x

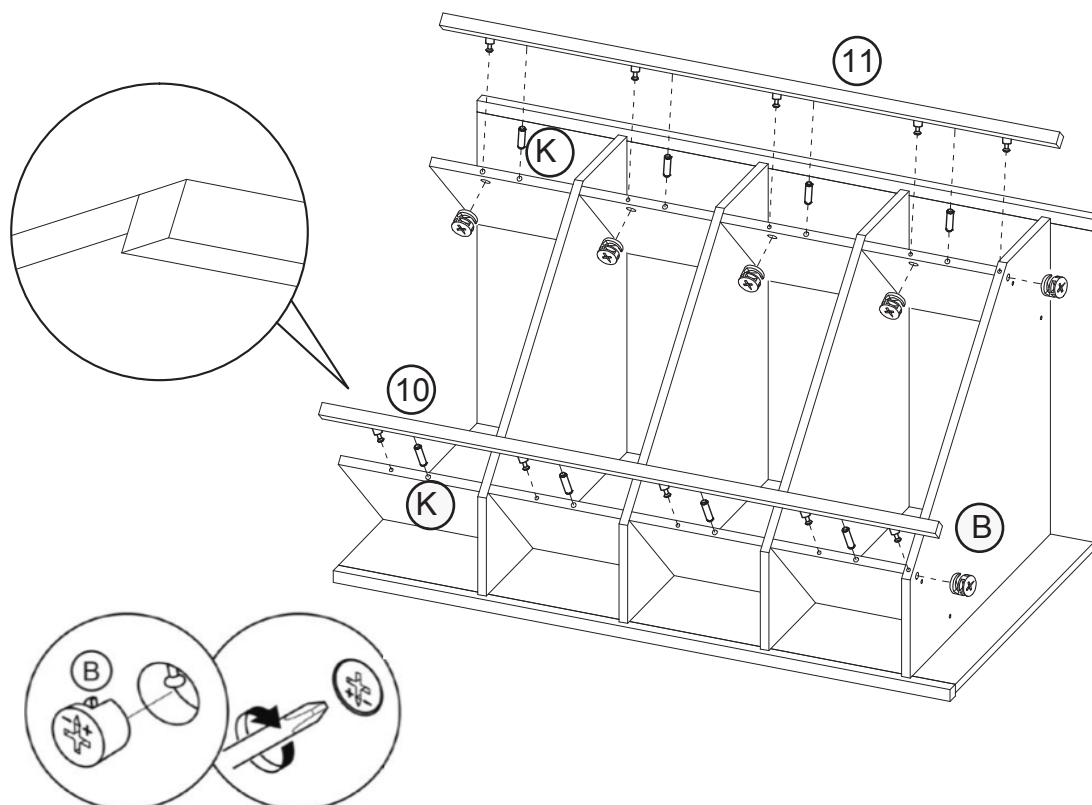

26

Insert wood dowels to the top backsplash panels (1, 2).
Assemble the top left and right backsplash panels (1, 2).

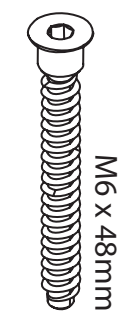

(E) 1x

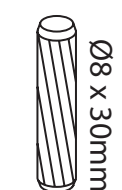

(K) 4x

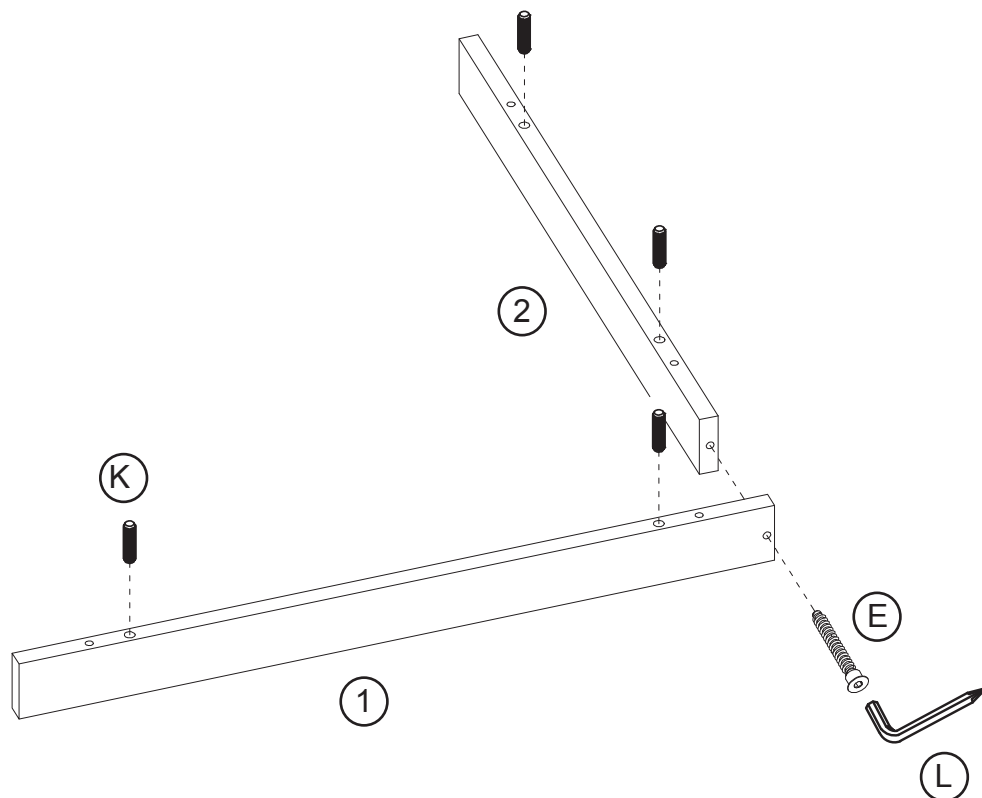

27

Assemble the top backsplash assembly to the top of the top panel (3).

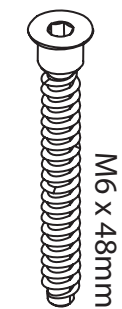

(E) 4x

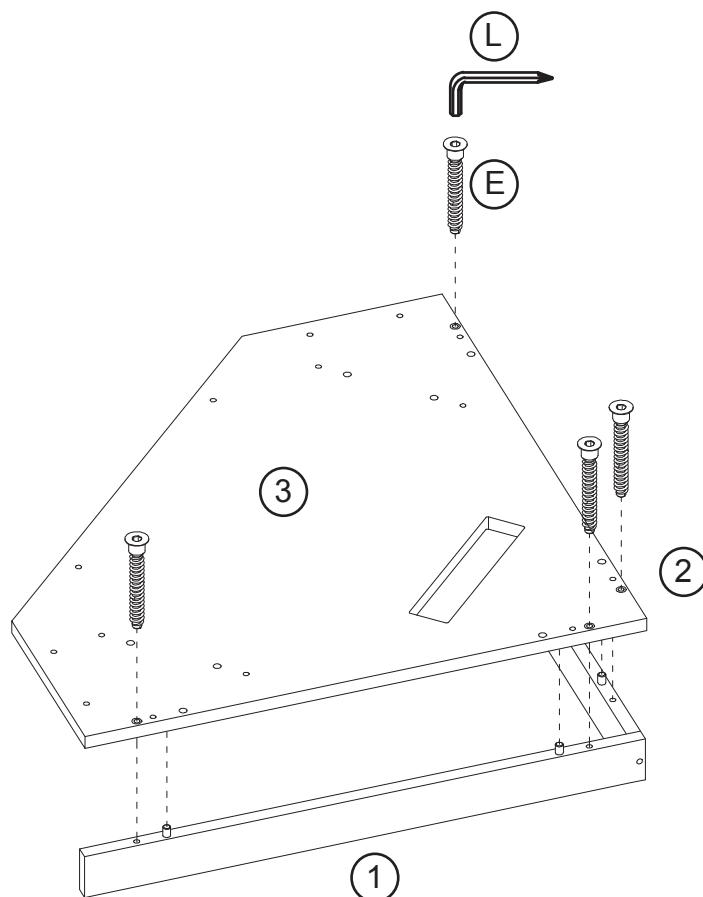

28



(A) 8x

Insert cam bolts to the underside of the top panel (3).

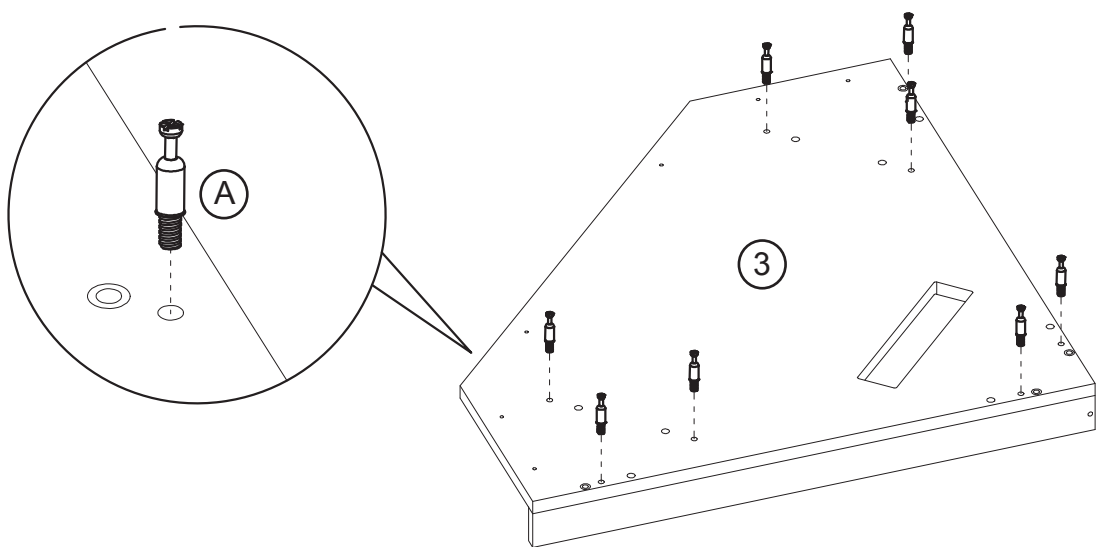

29



(B) 8x

Assemble the top panel on top of the cabinet assembly.

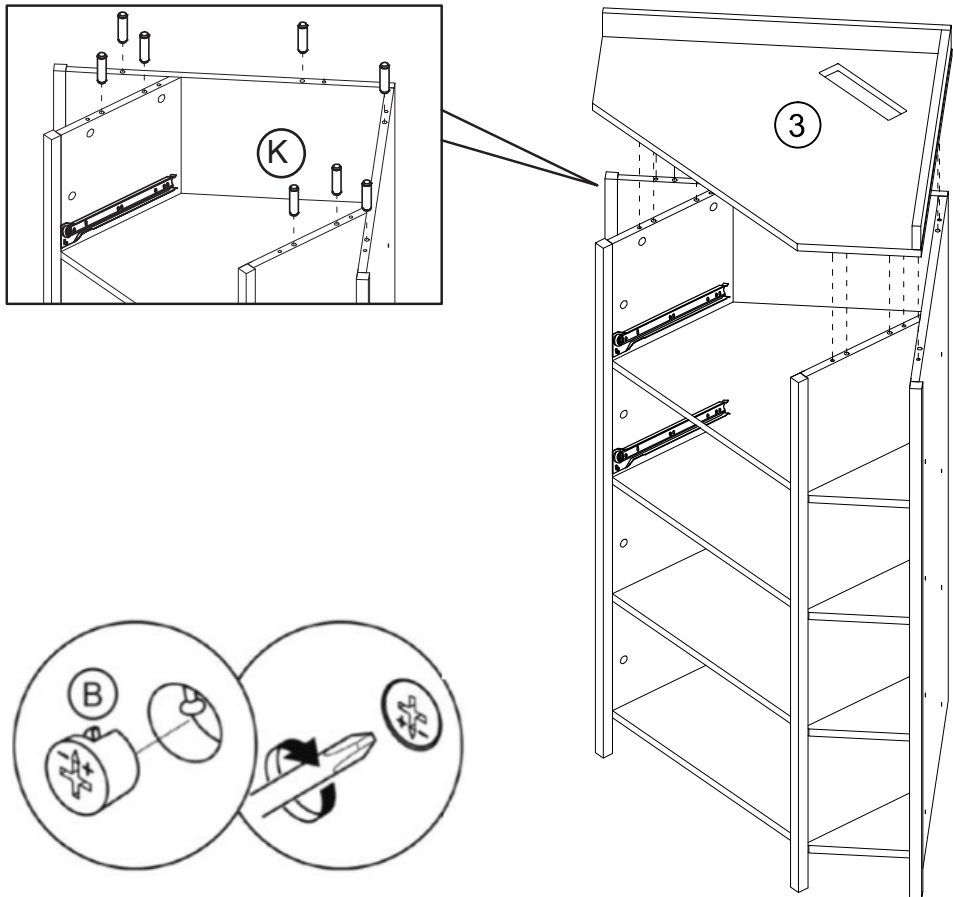

30

Assemble the left, center, and right decoration strips (4, 5, 6) to the underside of the top panel (3).



(H) 6x

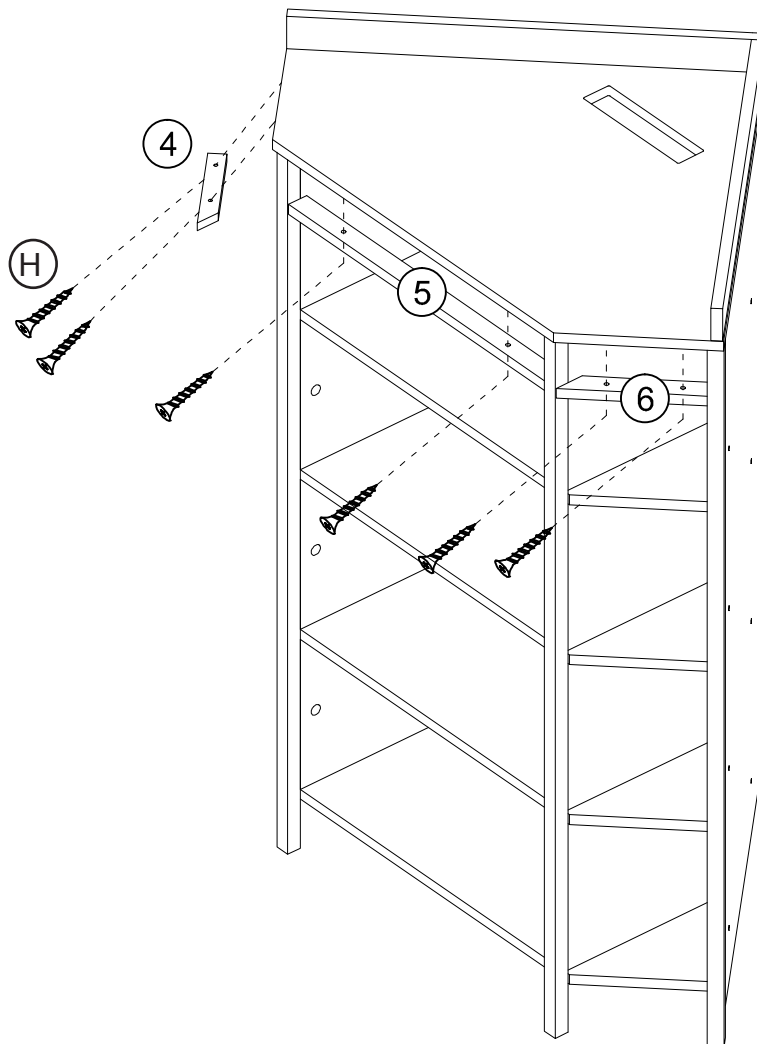

Attach usb Interface to the cabinet top panel (3).

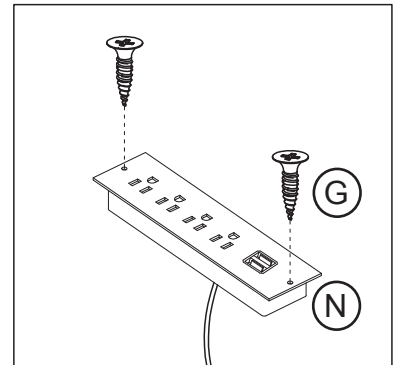
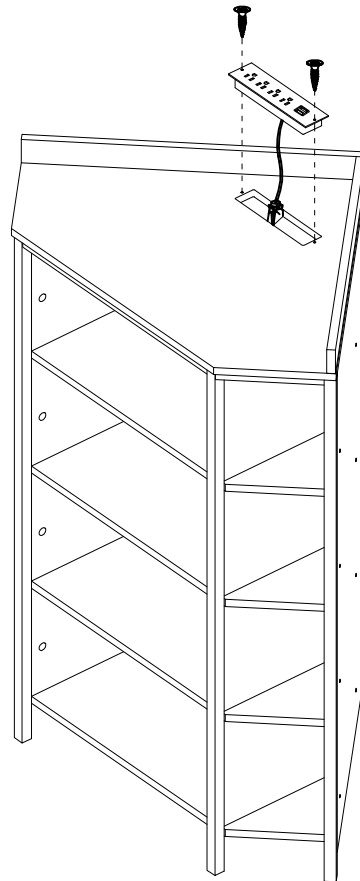
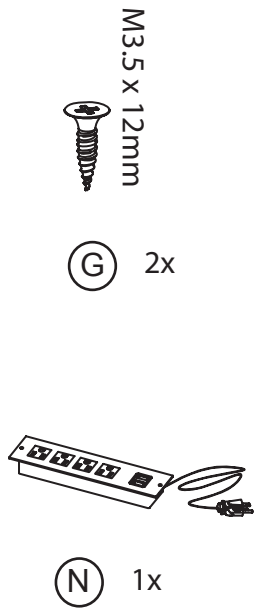

Slide the drawer into the cabinet and put the shelf baffles (20) into the shelf.

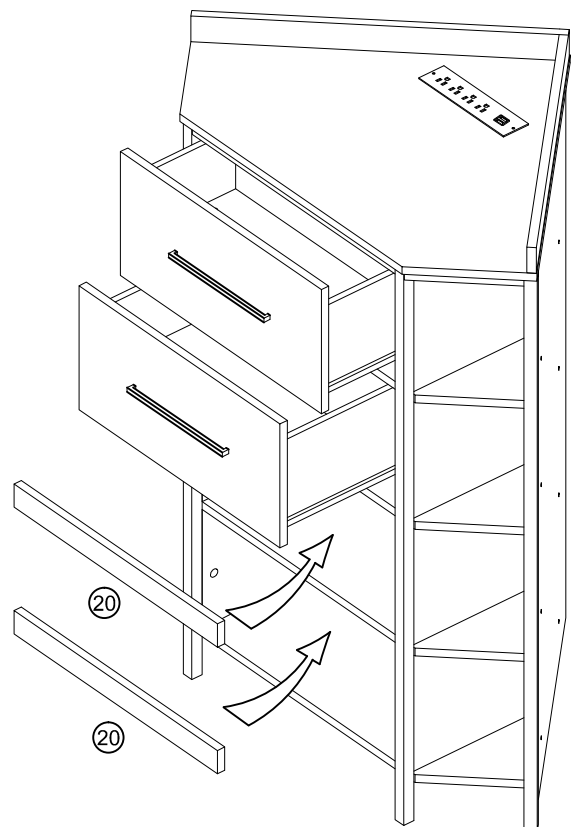
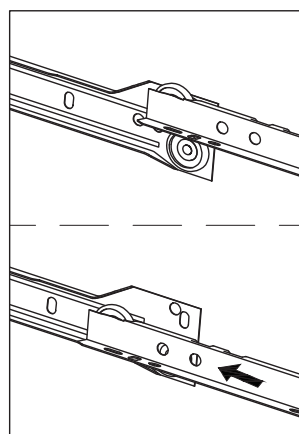

The shelf baffle (20) is designed to keep the items you place organized. It's up to you to install it or not.

32

Attach decorative covers on all cam locks.



Ø30

(M) 26x

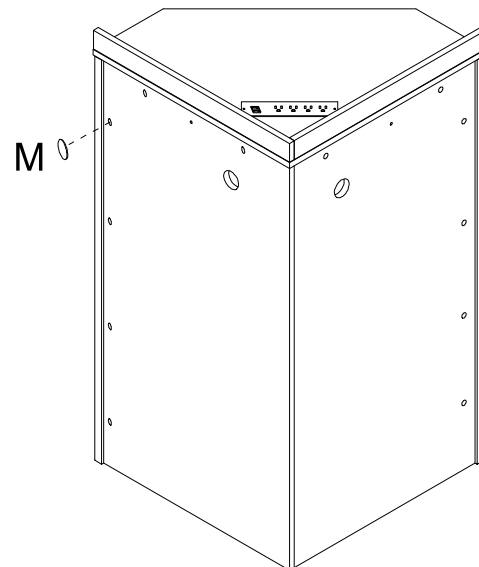
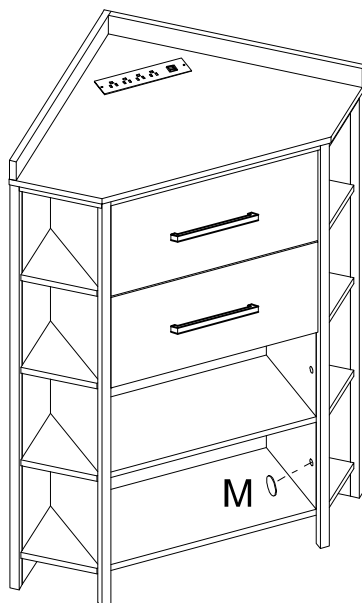

33

Attach anti-tipping strap behind the cabinet.

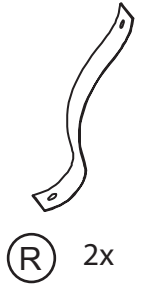

(R) 2x



(P) 2x

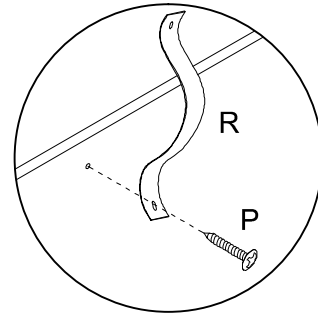
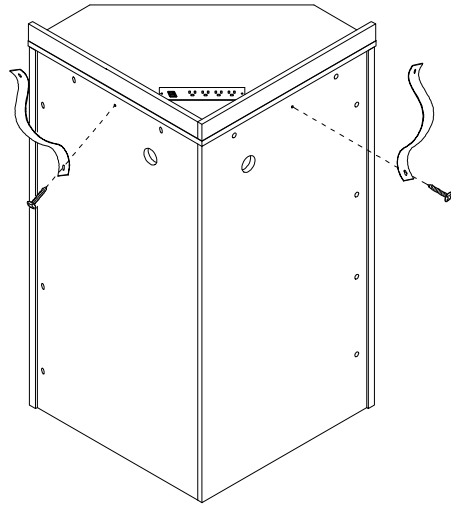

34

Affix the cabinet to the wall.



(O) 2x



(Q) 2x

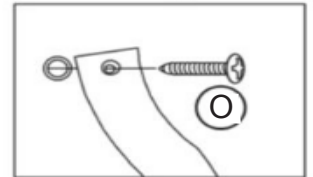
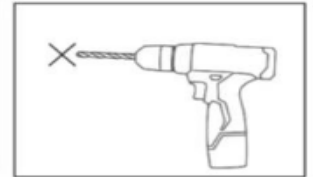
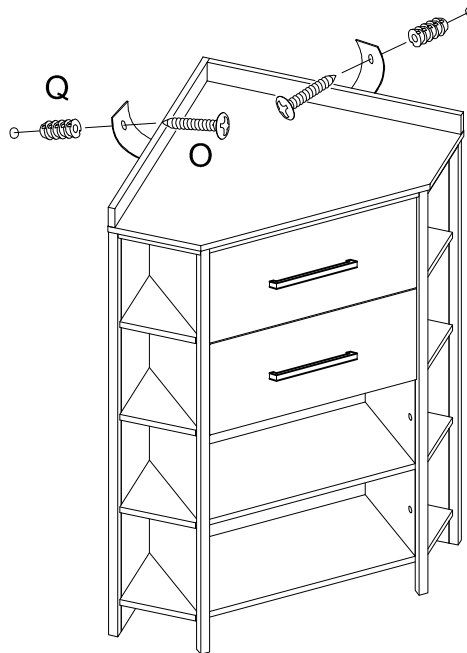

Furniture must permanently fixed to the wall stud with included anti-tipping device to prevent the furniture from tipping over.

- Mark the drill position on the wall with a pencil.
- Drill a small hole on the marked position.
- Insert a wall anchor into the drilled hole.
- Fixed the anti-tipping strap to the wall with provided screws.

YOU'RE FINISHED!

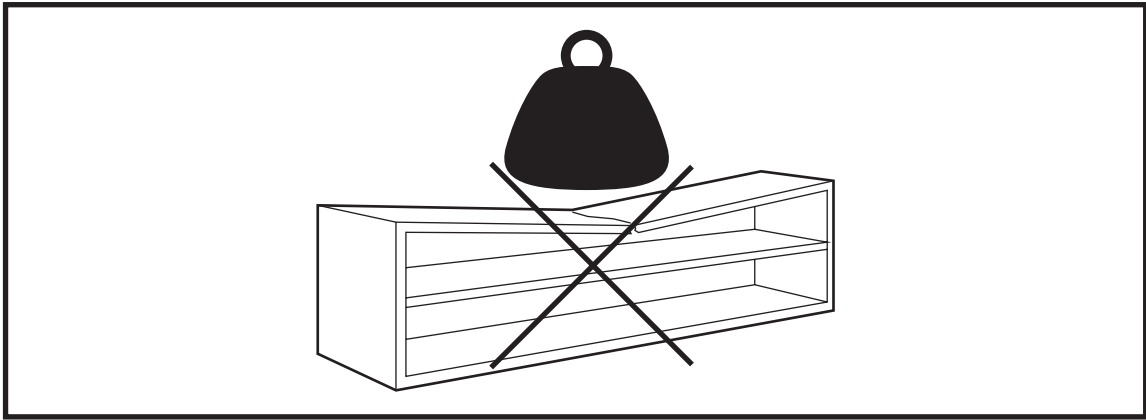

Warning

Only place items on top of the product if they meet the recommended size and weight limits.

Climbing on, stepping on, or placing overweighted objects on the product may cause property damage and/or injuries.

Items placed onto this product must be resting on a support surface without hanging over the edges.

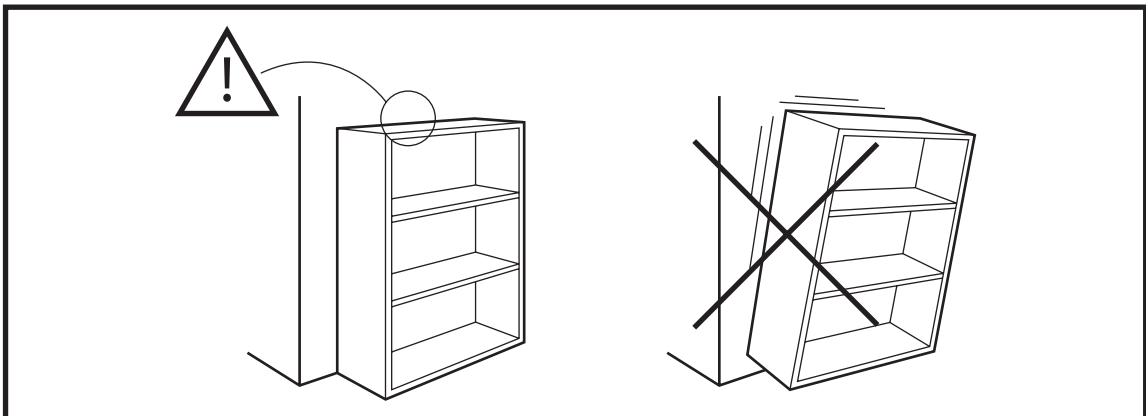

Warning

Serious or fatal crushing injuries may occur if the furniture tip-over. Furniture must permanently affixed to the wall with included anti-tipping device in order to prevent the furniture from tipping over.

Different wall materials requires different types of wall anchors or screws. Use a suitable wall anchors or screws for your specific wall in order to secure the stability and load bearing capacity of the furniture. If you are uncertain about which type of device to use, please contact us or your local hardware store.

FURNITURE CARE AND MAINTENANCE

Medium - Density Fiberboard

Thank you for your purchase. We want your item to last as long as possible. To ensure the product gives you years of longevity, please follow the recommendations in this care and maintenance guide.



MAINTENANCE

- Tighten all bolts and screws again within the first 2 weeks of assembly.
- Check the tightness of all bolts every 2 months and tighten them if necessary.



CLEANING

- Clean the surface of the MDF (medium - density fiberboard) with a lightly dampened cloth.
- A small amount of mild soap can be used if necessary.
- Dry the surface immediately after cleaning.

- ⚠ DO NOT use bleach or alcohol to clean the surface.
- ⚠ DO NOT apply wood treatment on parts made with MDF.

MDF will swell and distort when exposed to water damage. Make sure to dry the furniture immediately after cleaning.

⚠ WARNING

The manufacturer and seller are not responsible for any and all liability relating to personal injury, property damage or losses, whether direct, indirect, or incidental, resulting from the incorrect attachment, improper use, inadequate maintenance, unapproved modification or neglect of this product.

WARRANTY

products come with a 1-year warranty from the date of delivery.
Register your product on our website to enjoy our limited lifetime warranty!

AFTER-SALE SERVICE



Encounter any difficulties or missing parts?



Contact us .



We will send you replacement.



Hassle free!
No need to worry about repackaging and sending your item back.