

Arched Cabinet

Y-C146

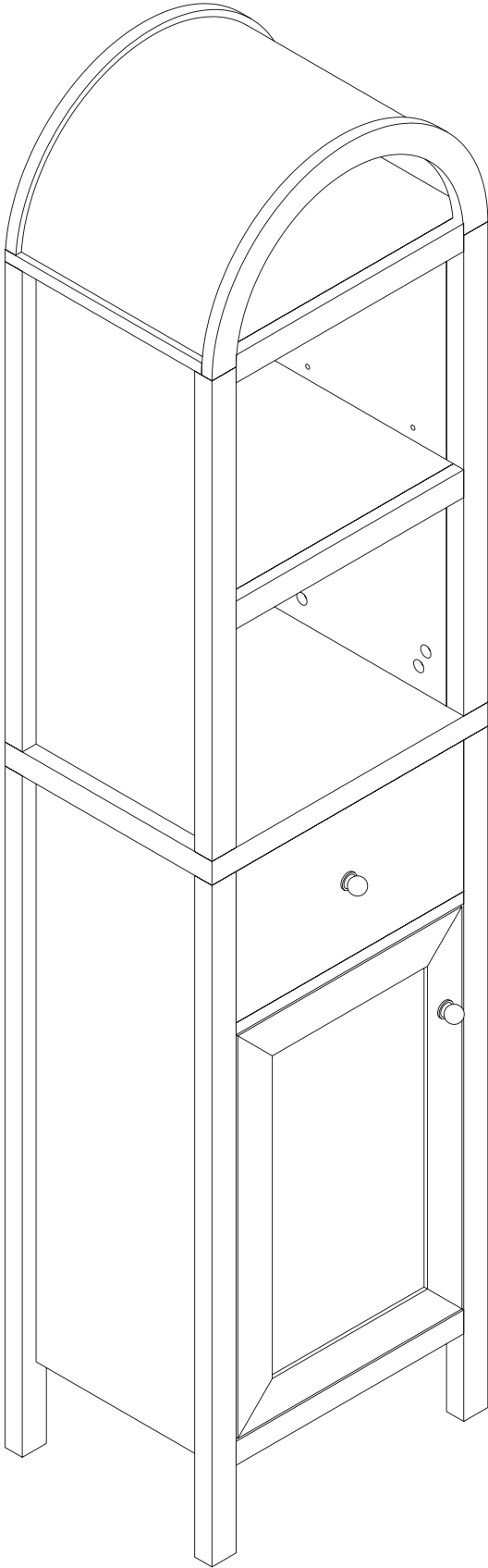

ASSEMBLY INSTRUCTIONS

parts

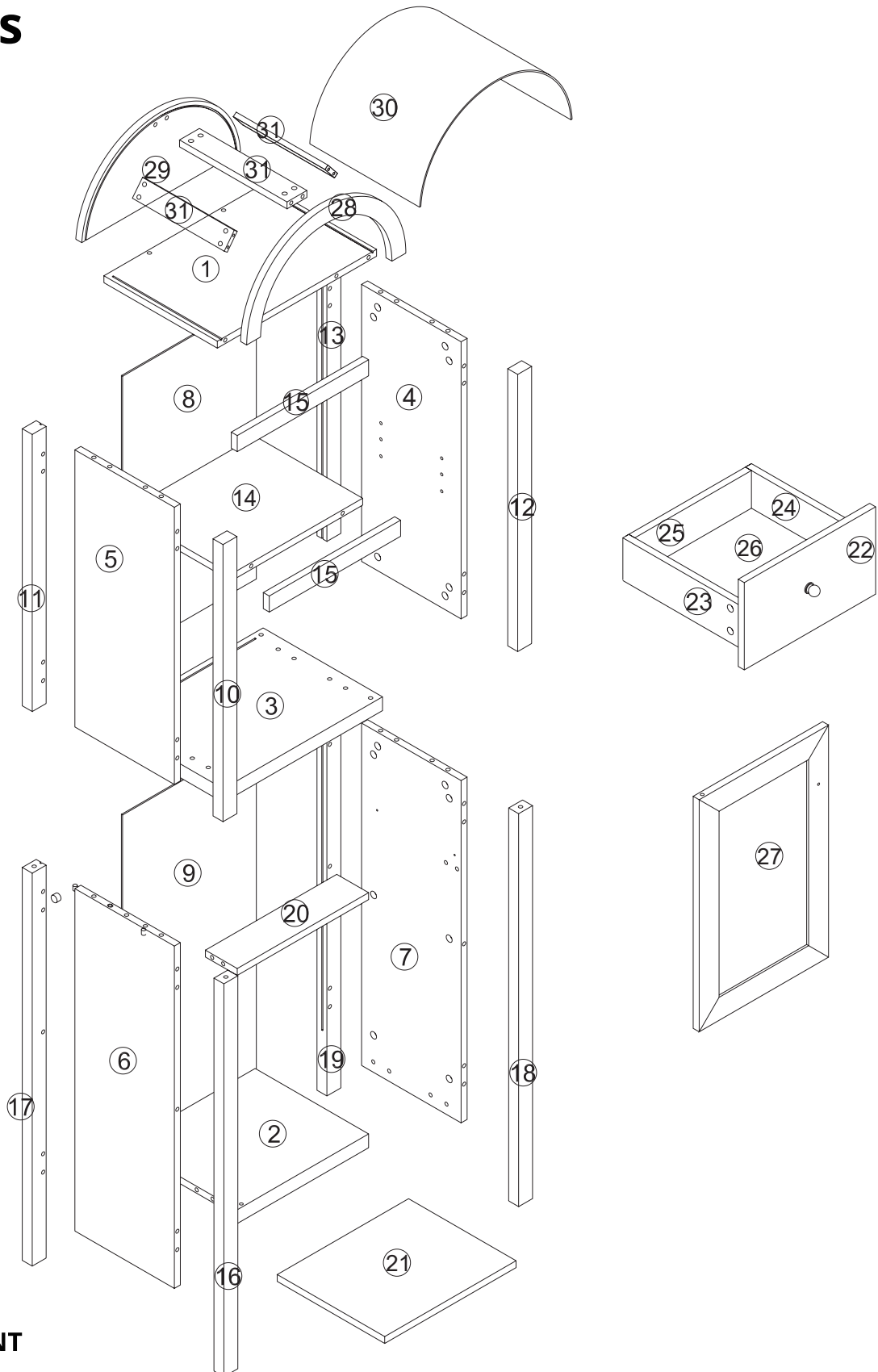

IMPORTANT

1. Do not tighten bolts/screws completely until all bolts/screws are lined up and inserted into holes.
2. Do not over-tighten screws and bolts to avoid stripping.
3. Please use hand tools to assemble this product. Do not use power tools.

Hardware

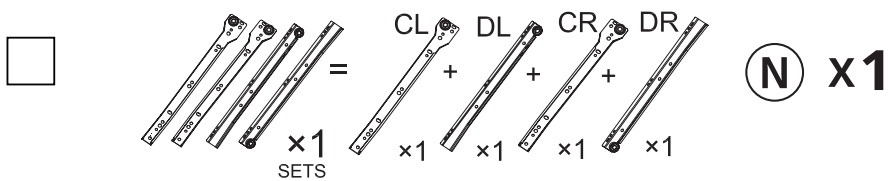
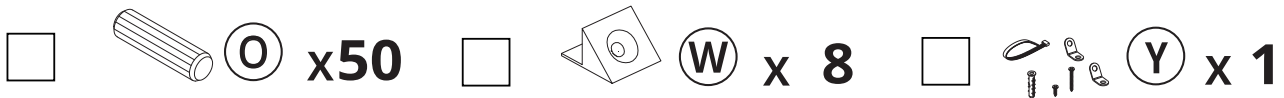

Before discarding the packaging, please use the checklist to ensure you have all the parts required to assemble your product. Please kindly note you will need the original package if you want to return the product later.



If parts are missing or damaged, we will gladly ship your replacements parts free of charge.



x2



120 mins



x1

Step 1

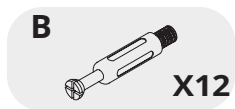
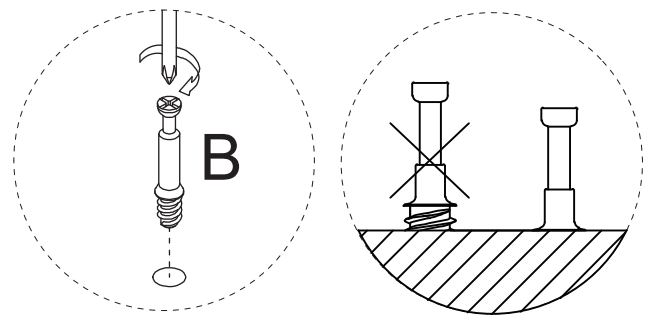
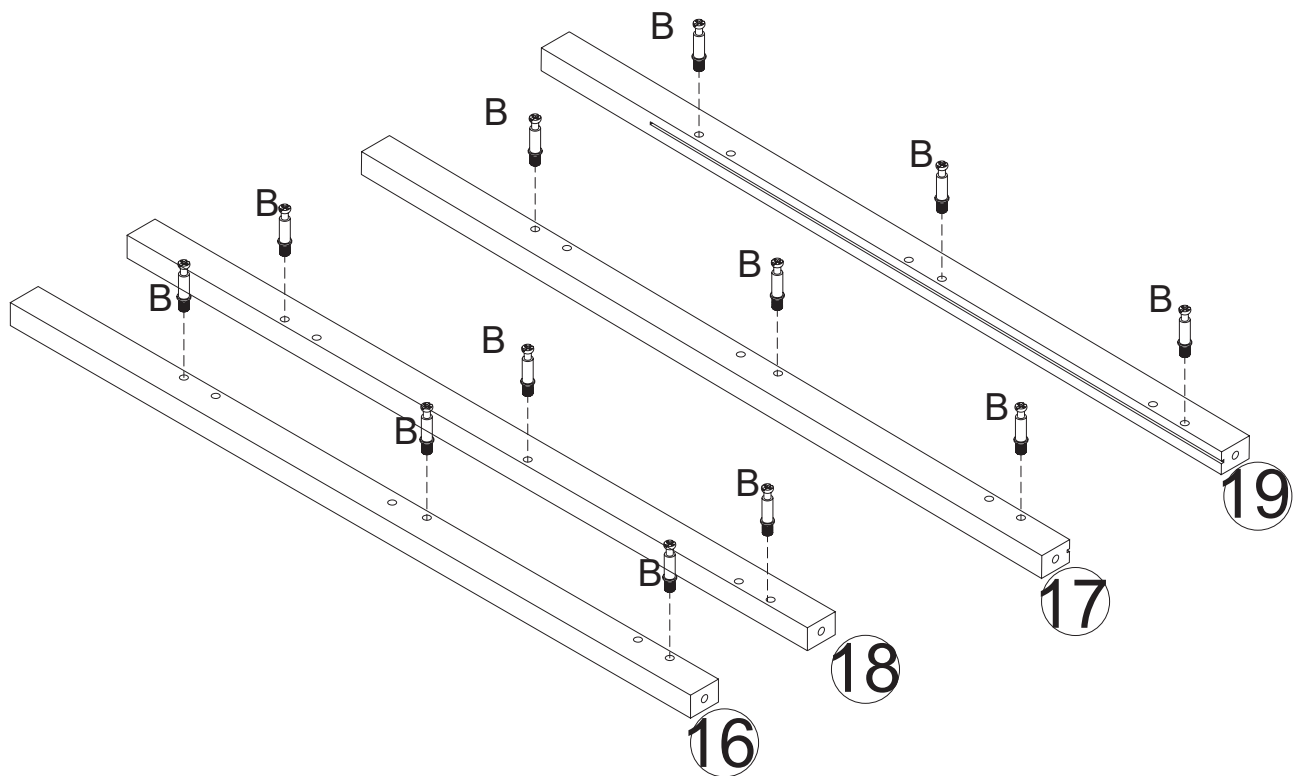

Step 2

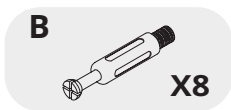
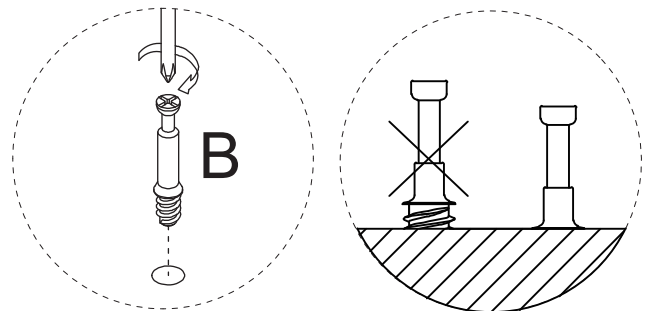
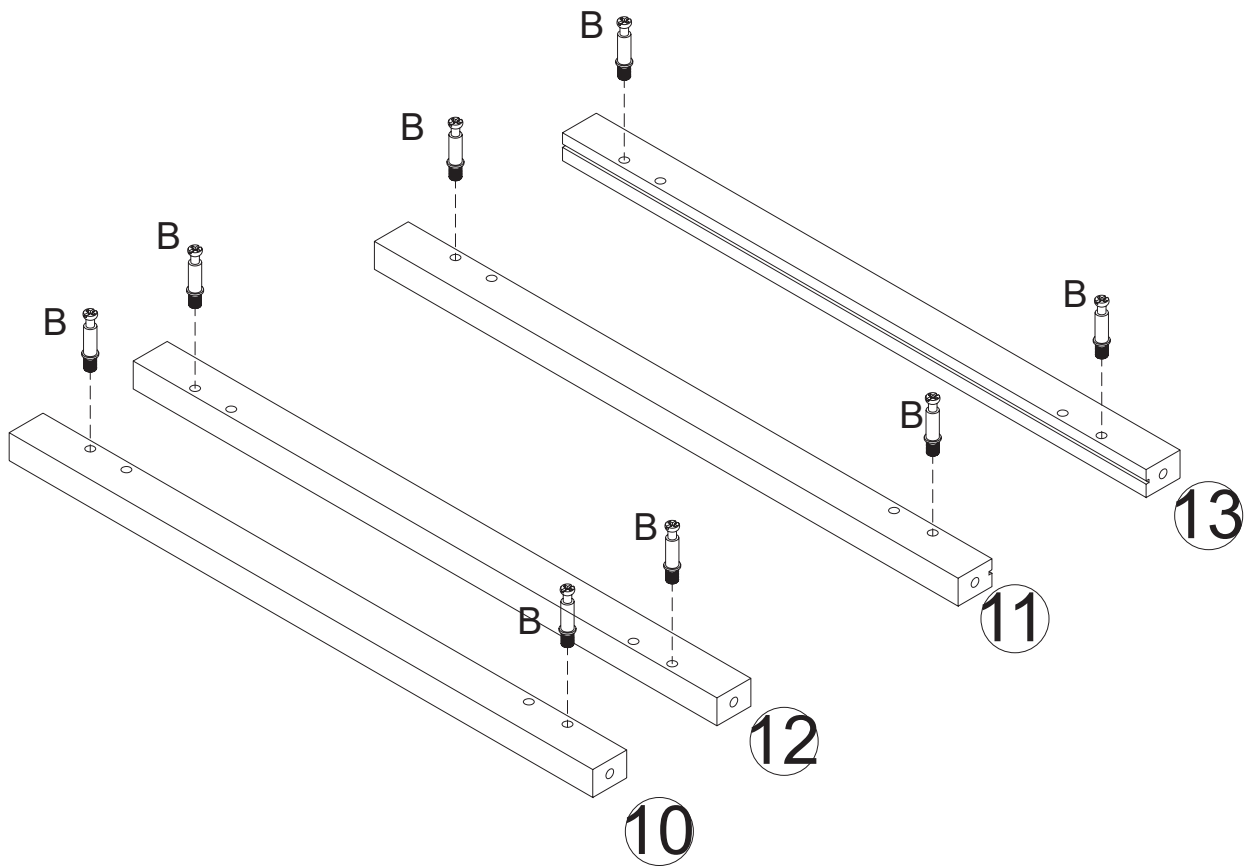

Step 3

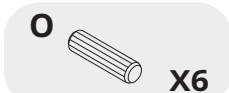
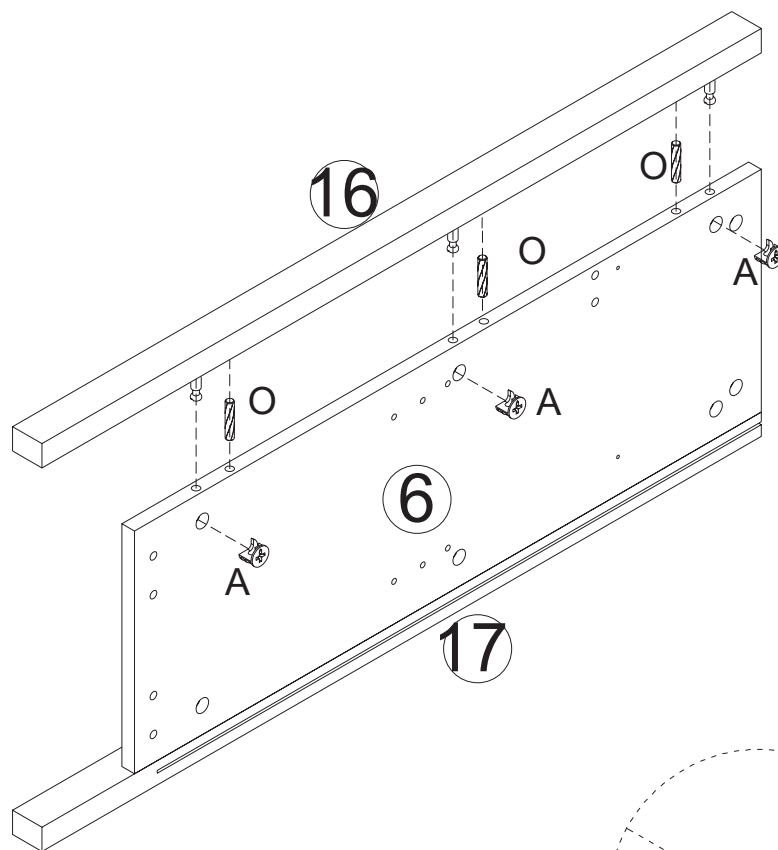
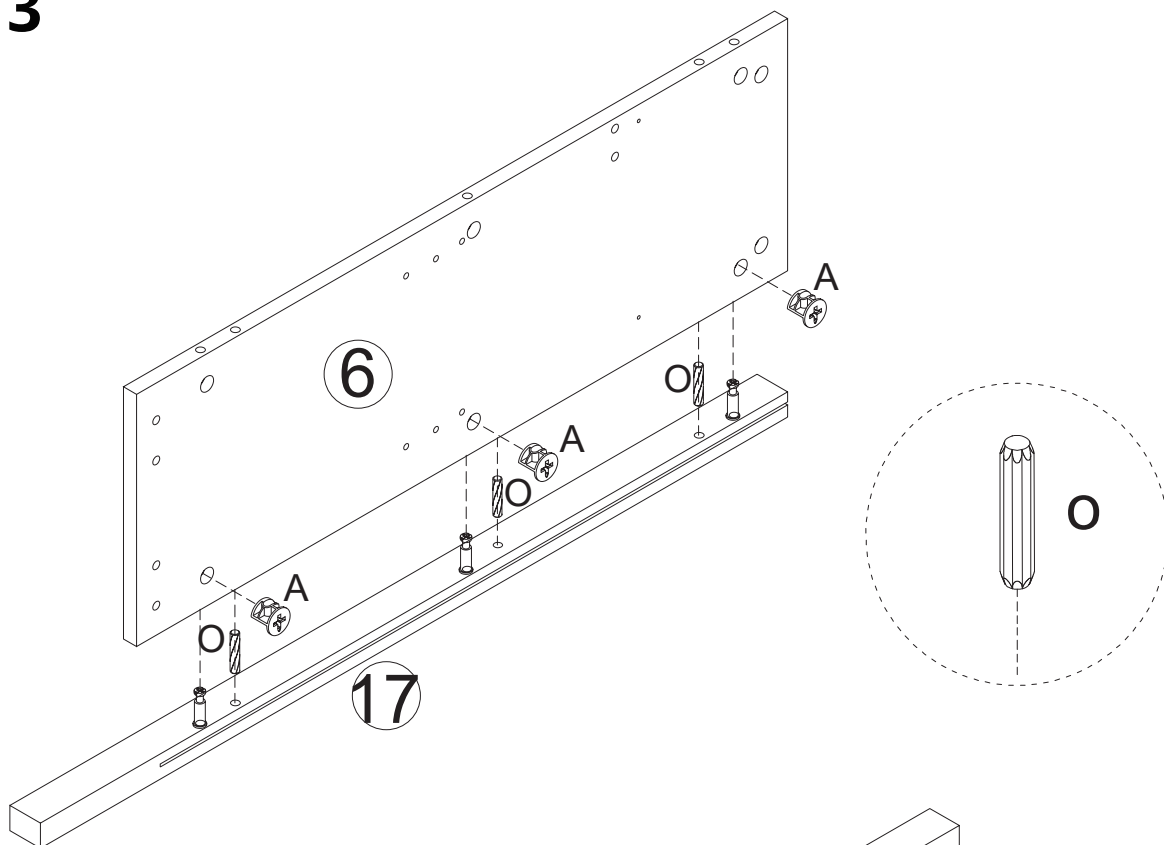

Step 4

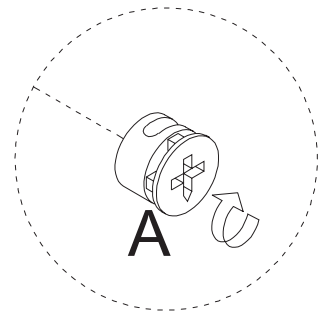
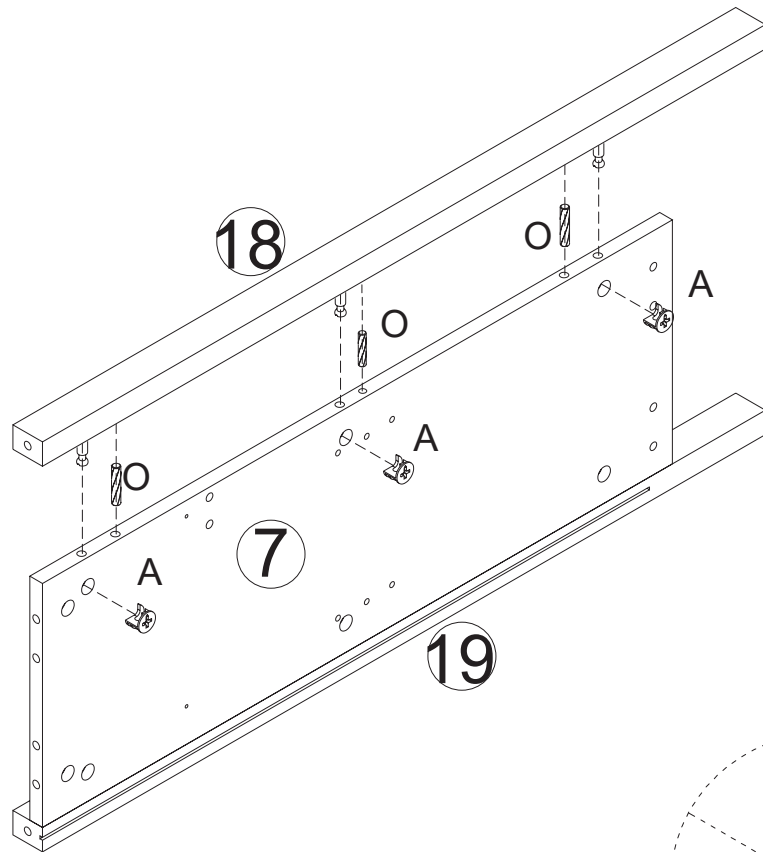
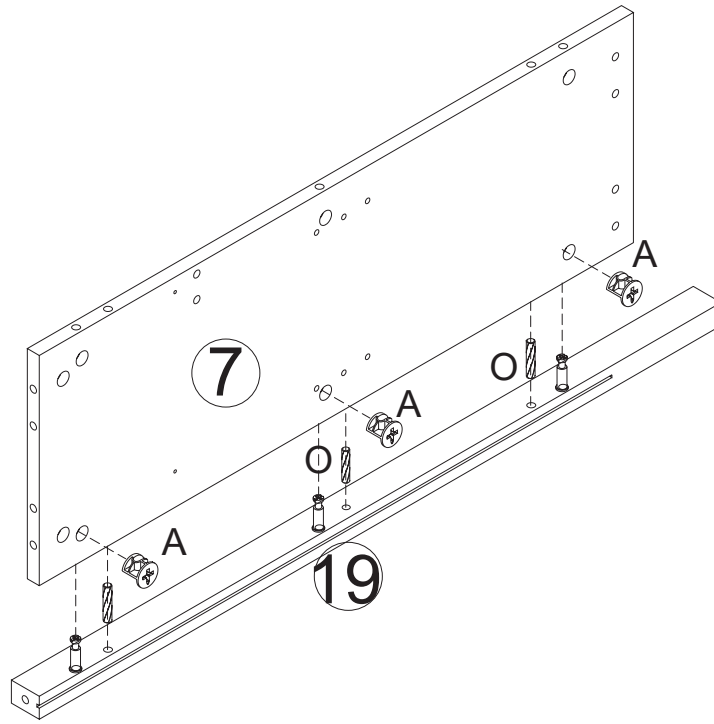
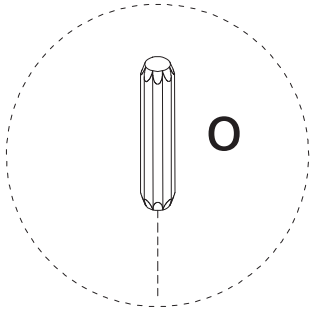

Step 5

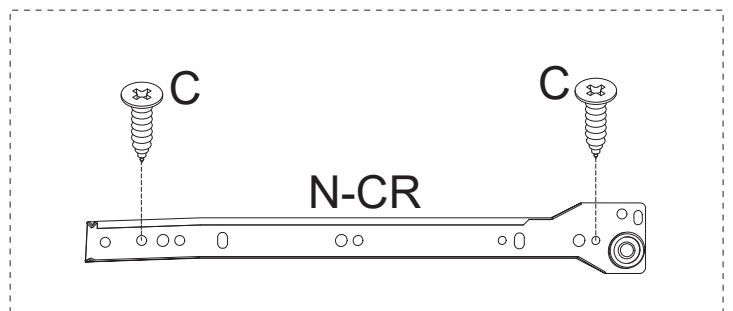
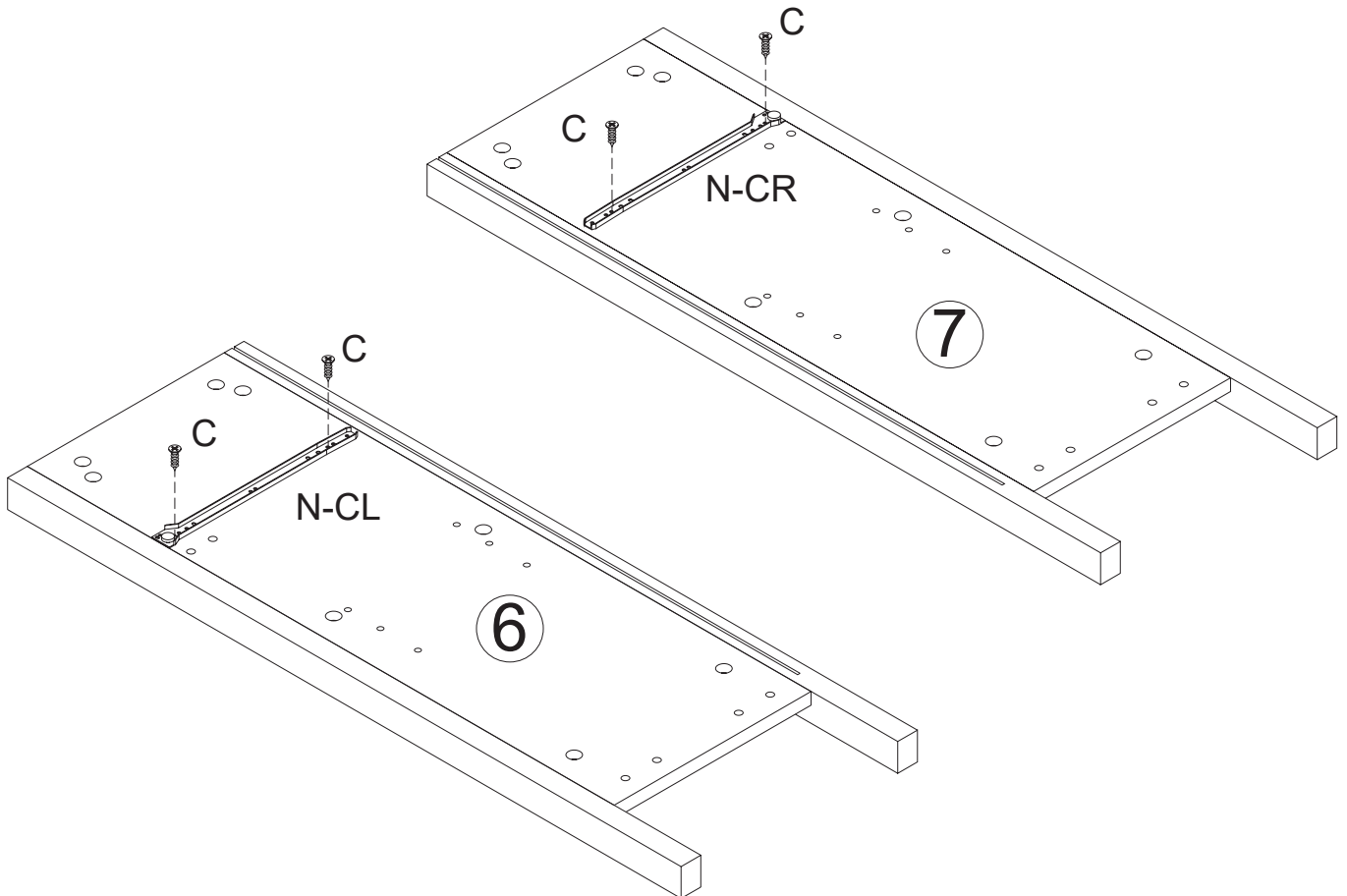
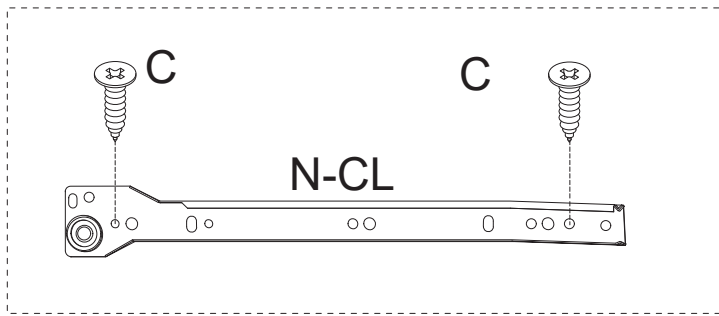

Step 6

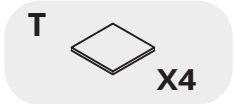
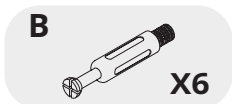
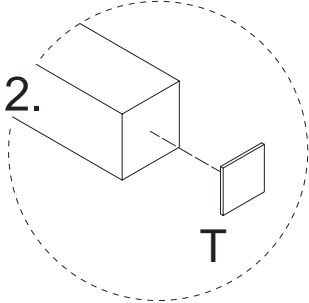
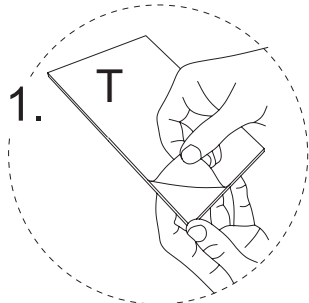
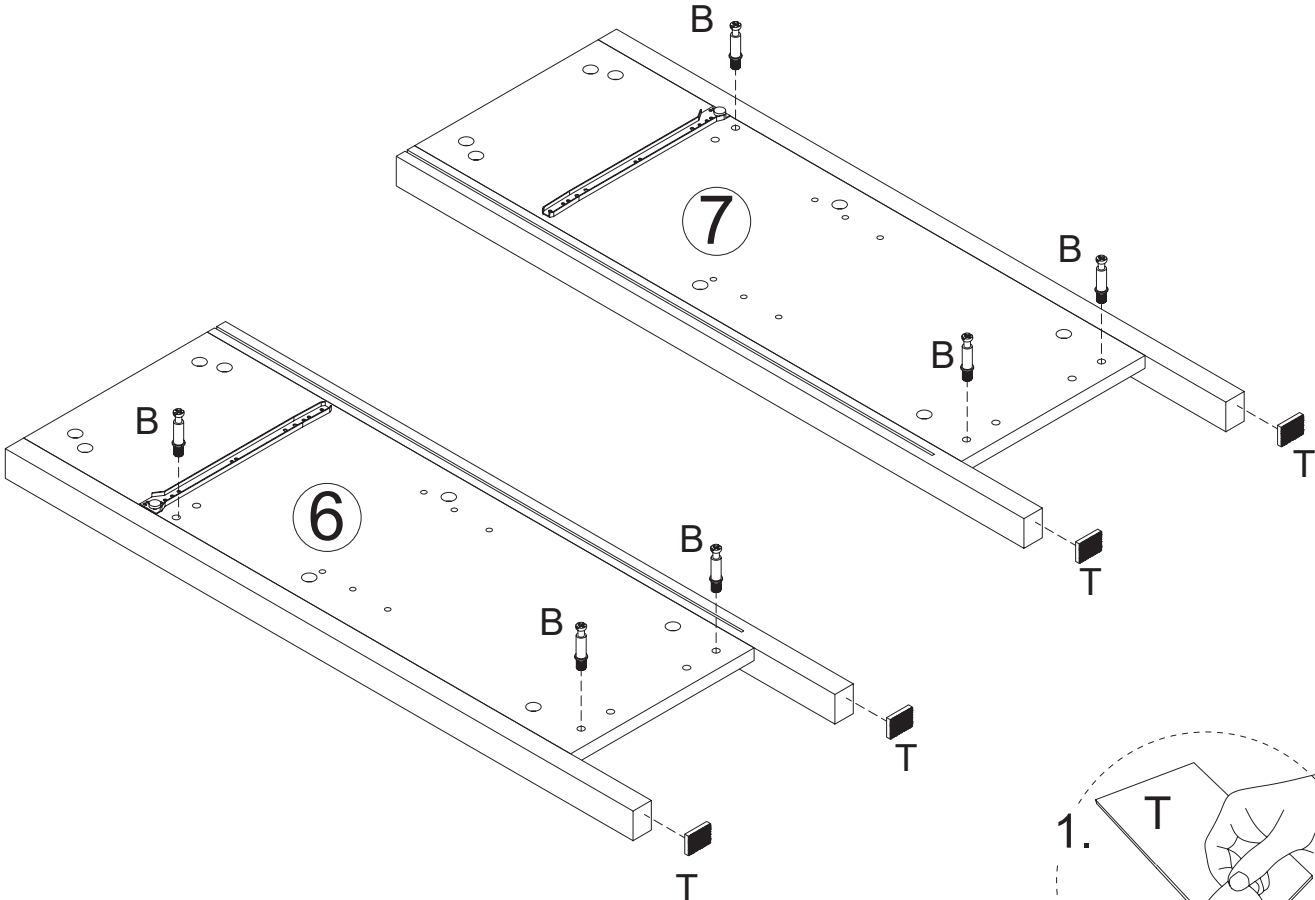
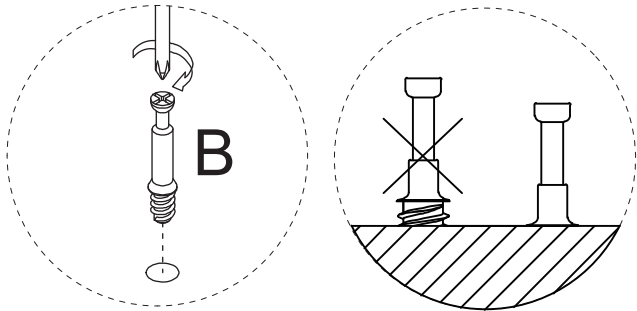

Step 7

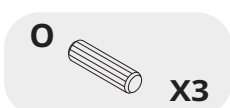
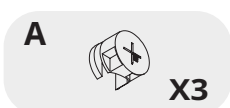
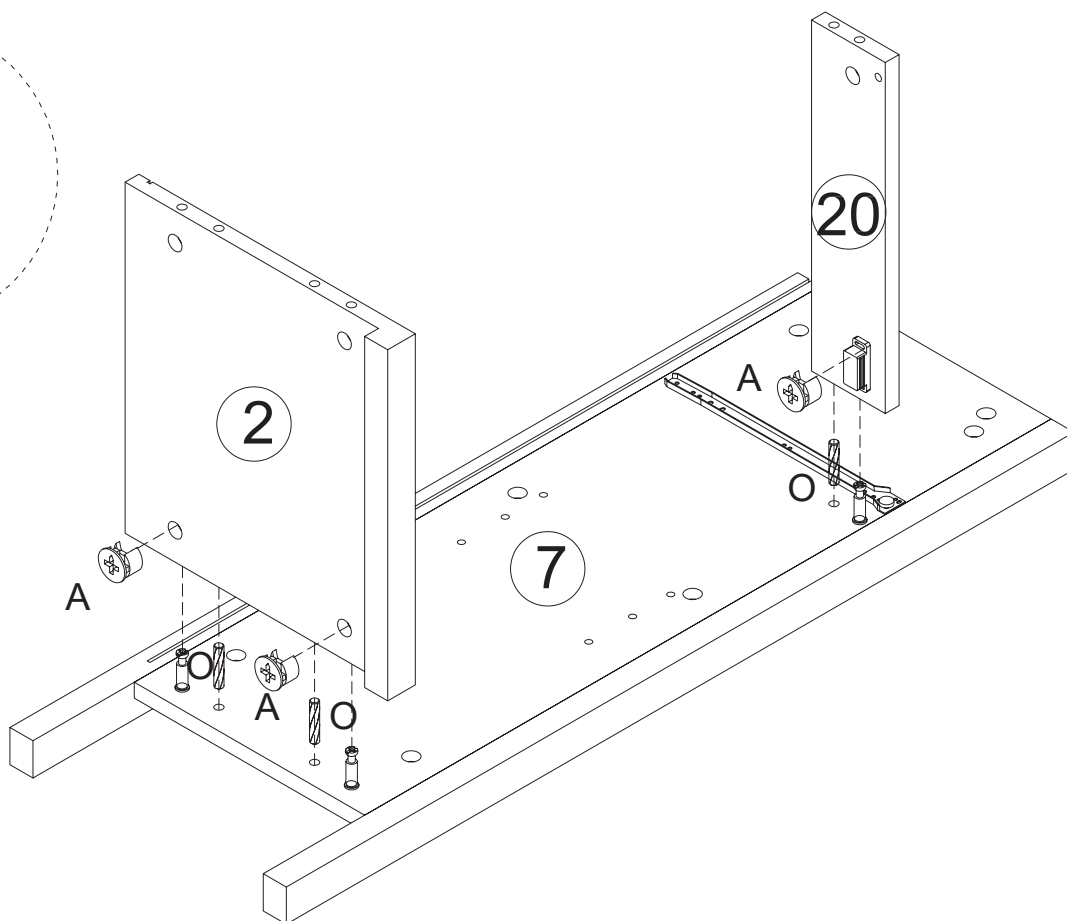
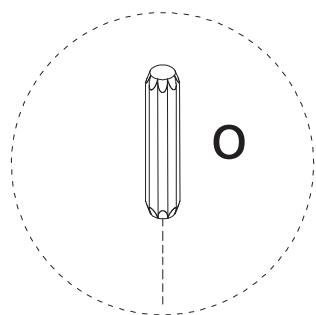
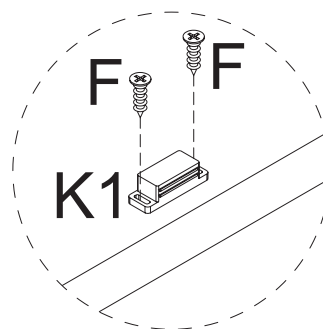
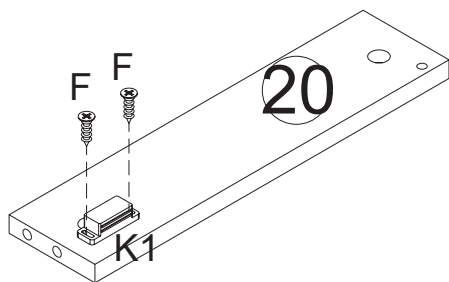

Step 8

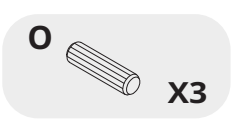
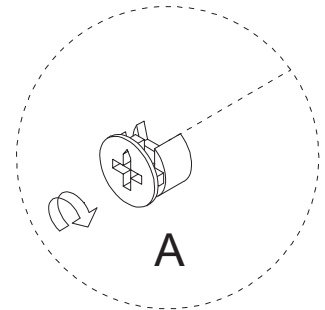
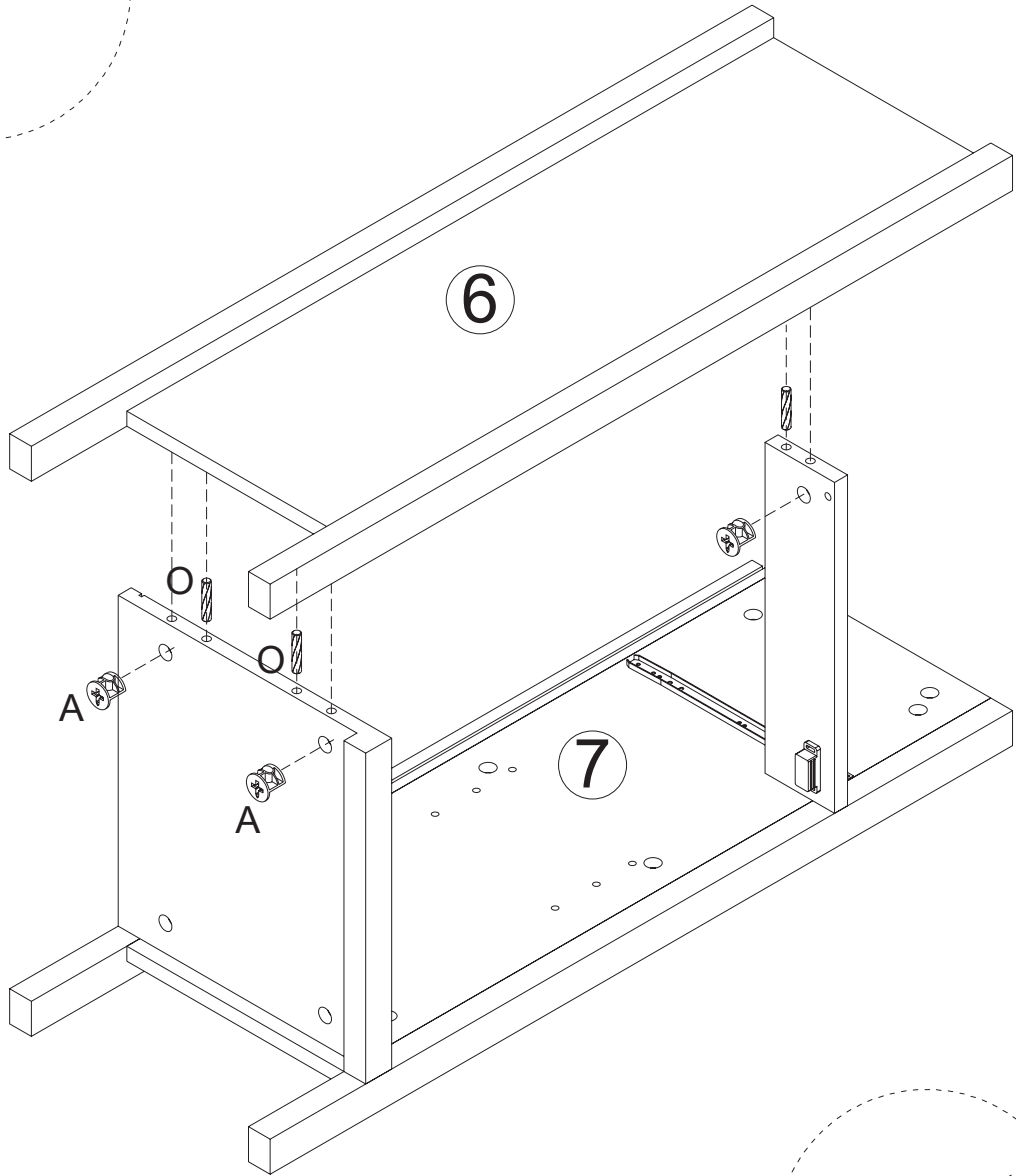
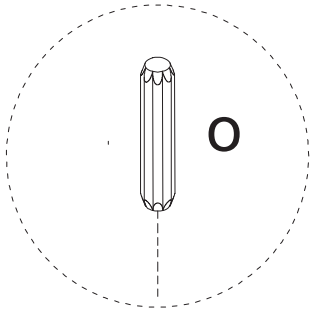

Step 9

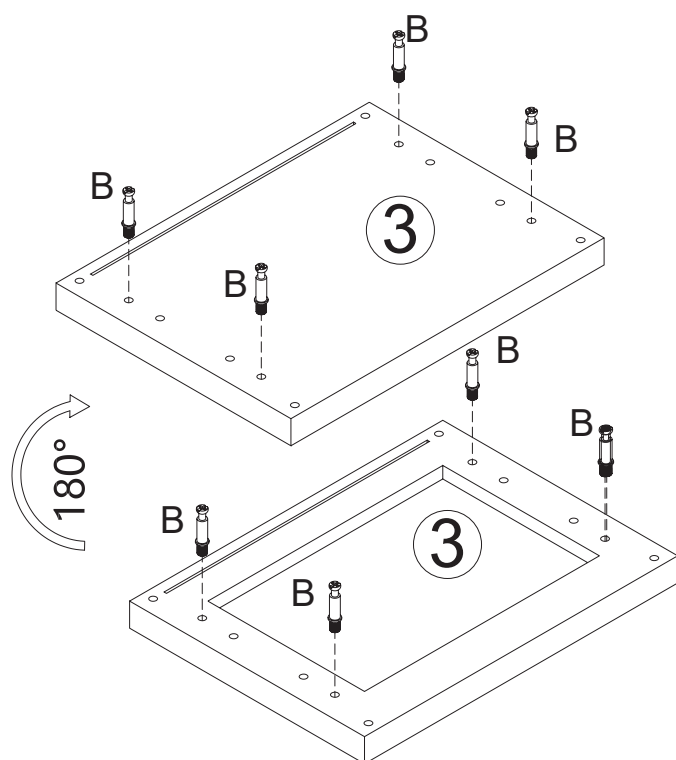
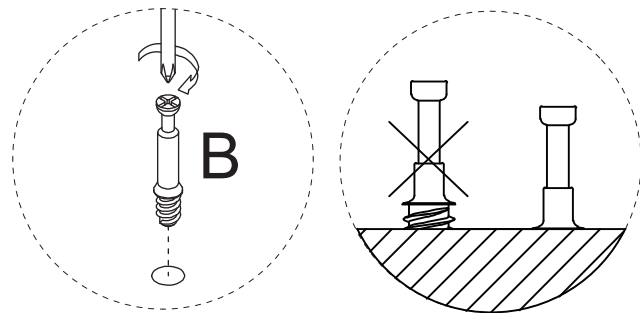
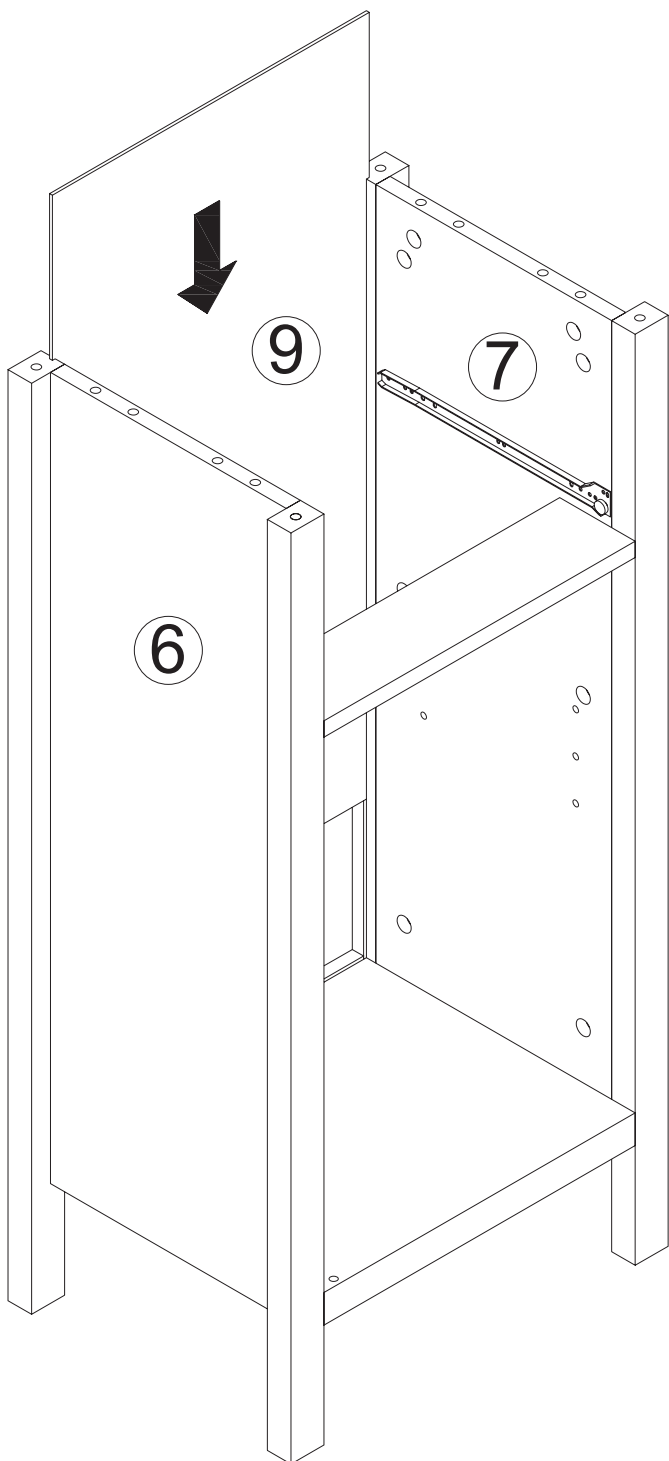

Step 10

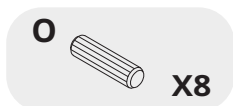
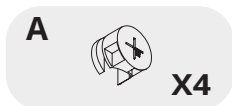
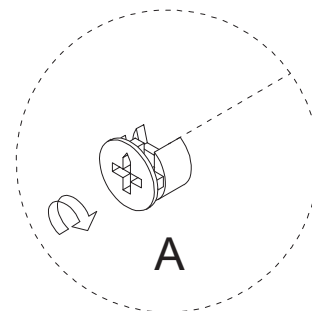
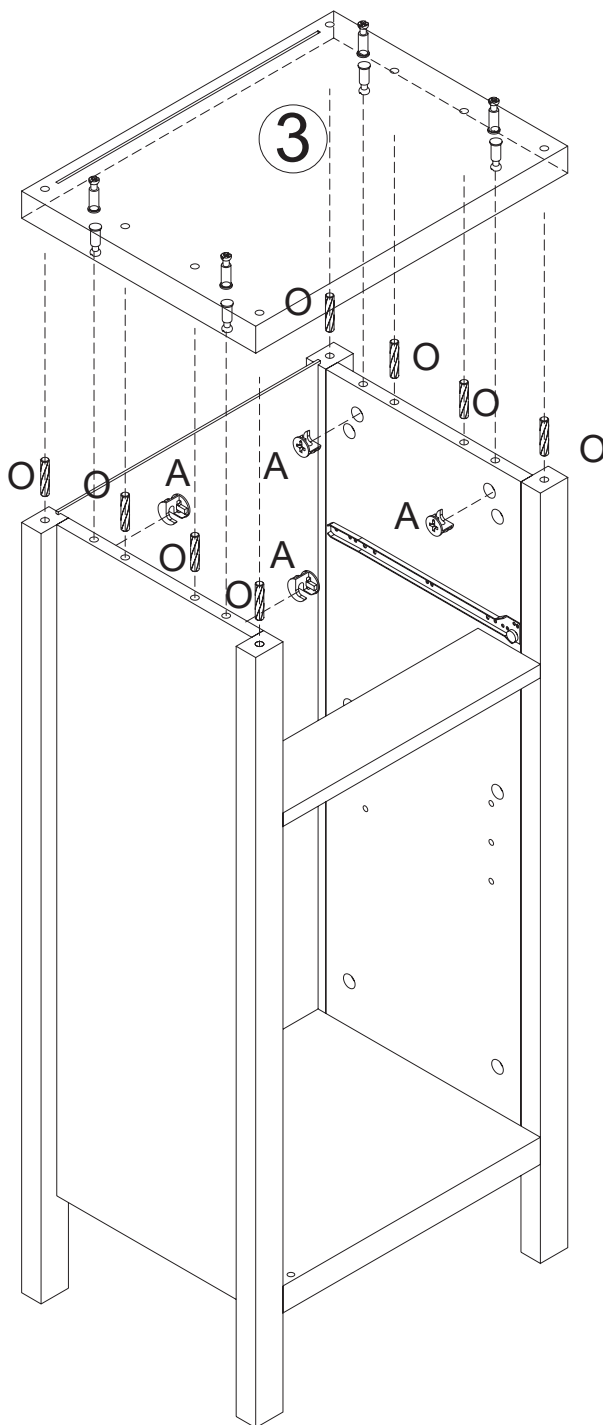
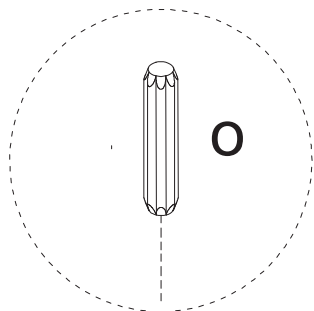

Step 11

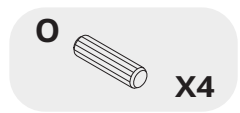
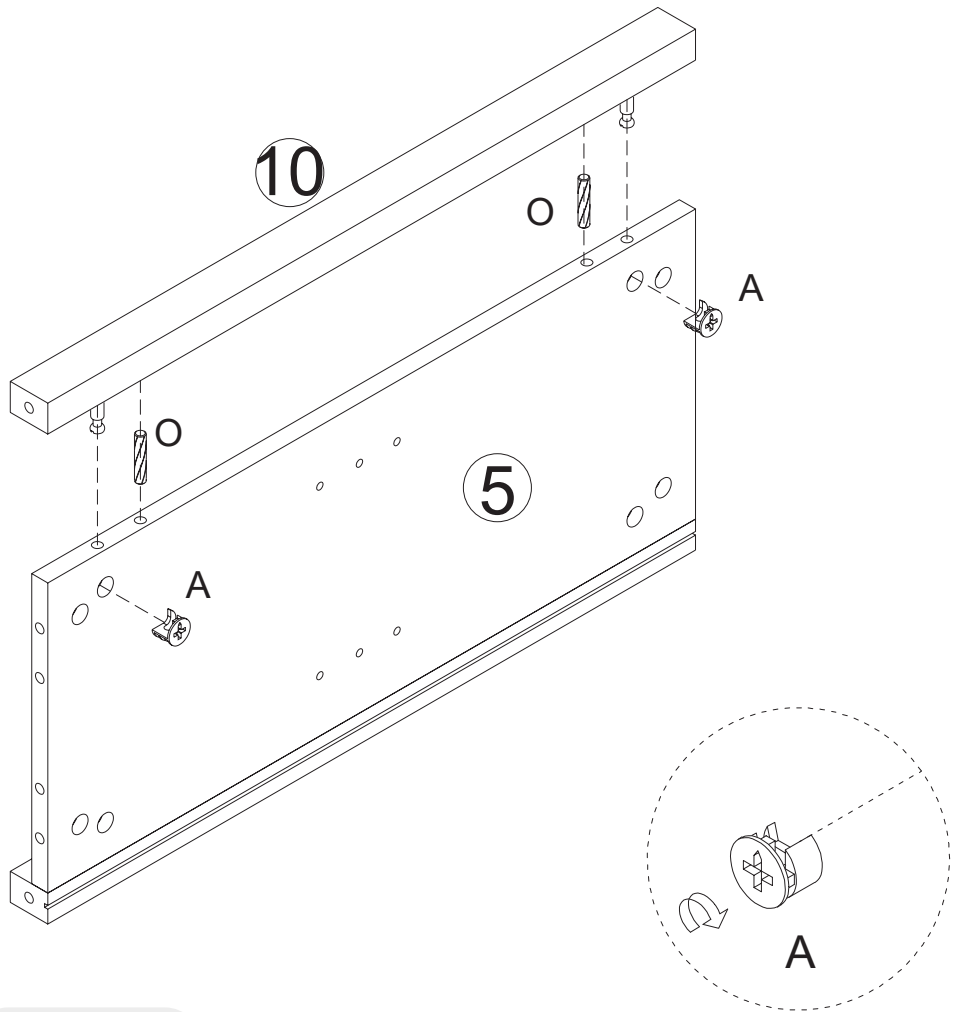
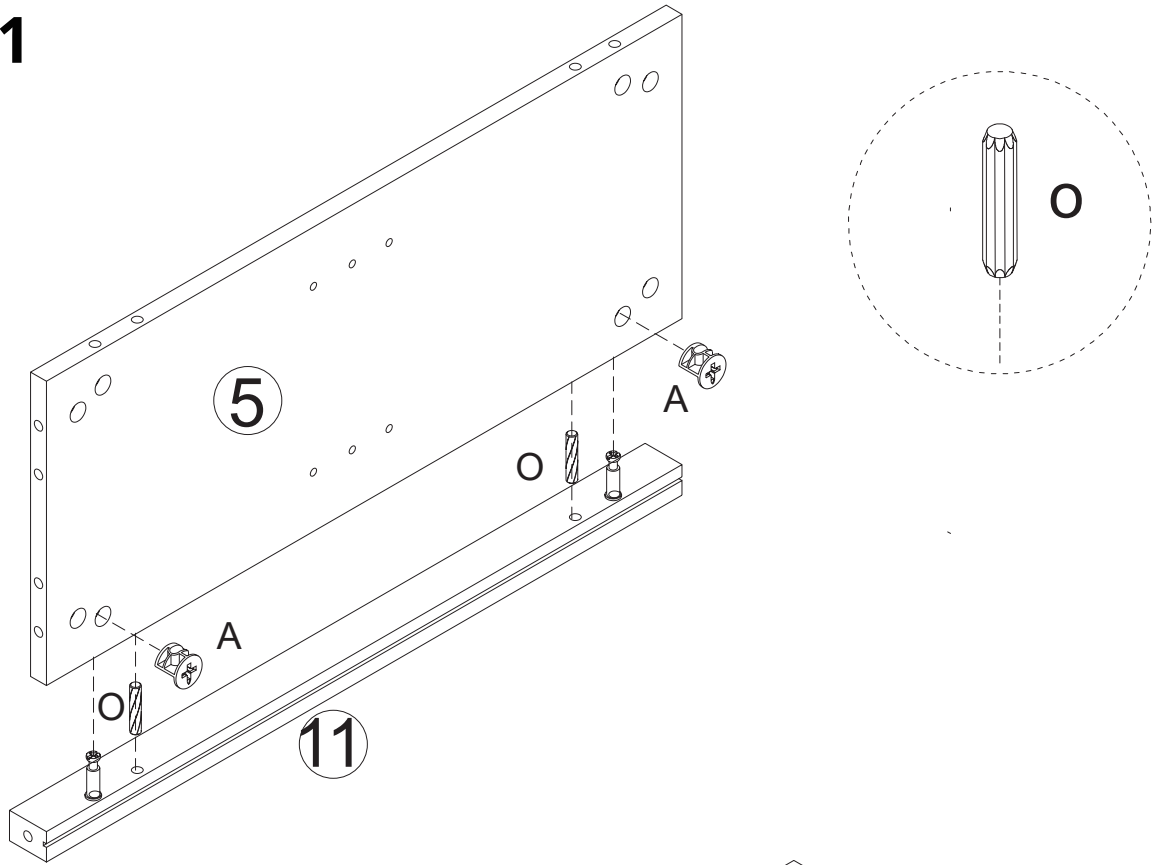

Step 12

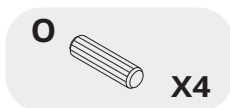
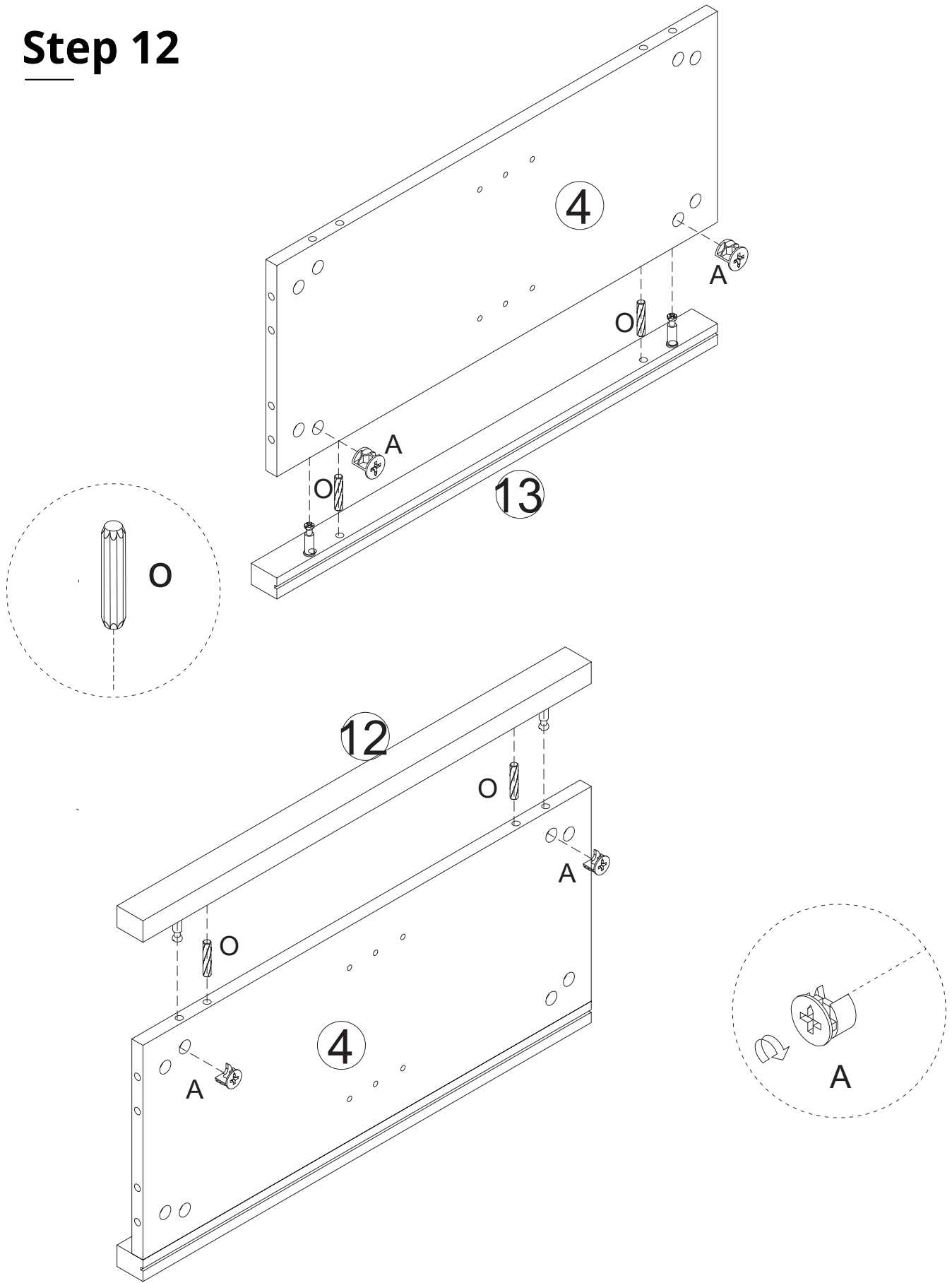

Step 13

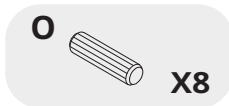
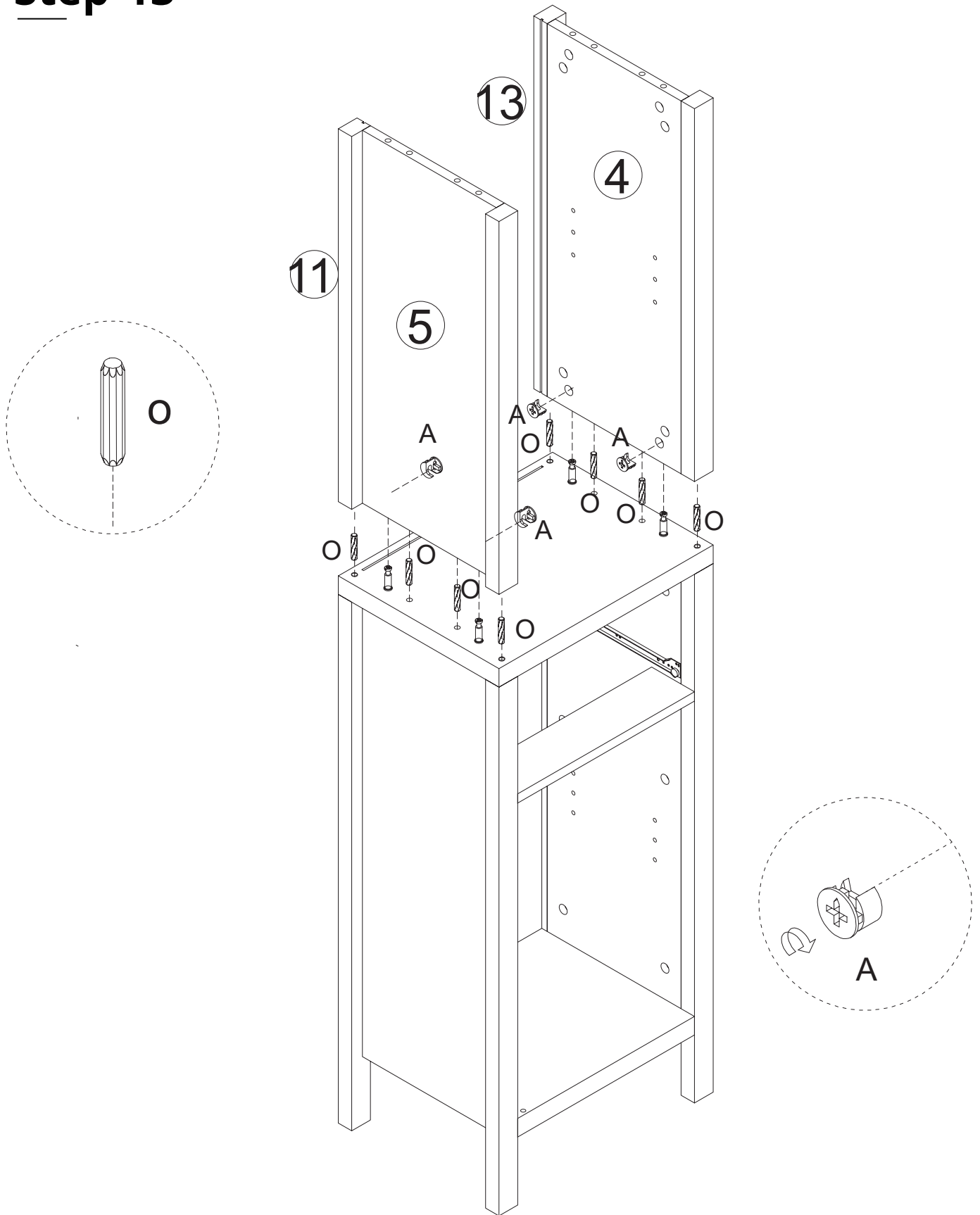

Step 14

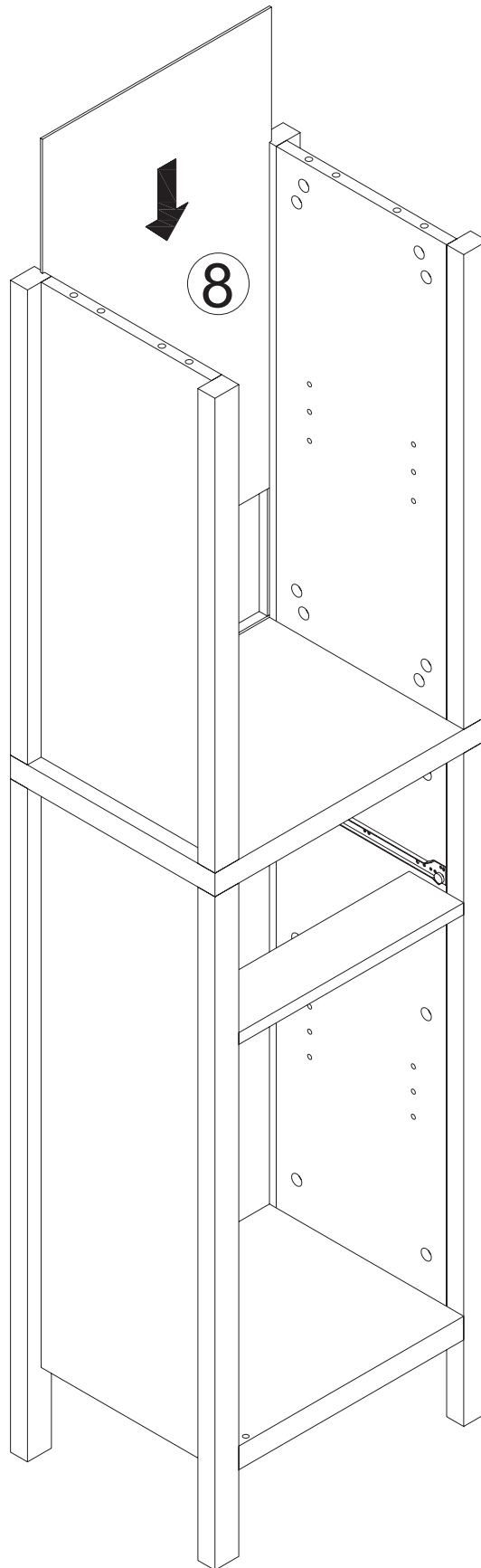

Step 15

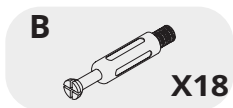
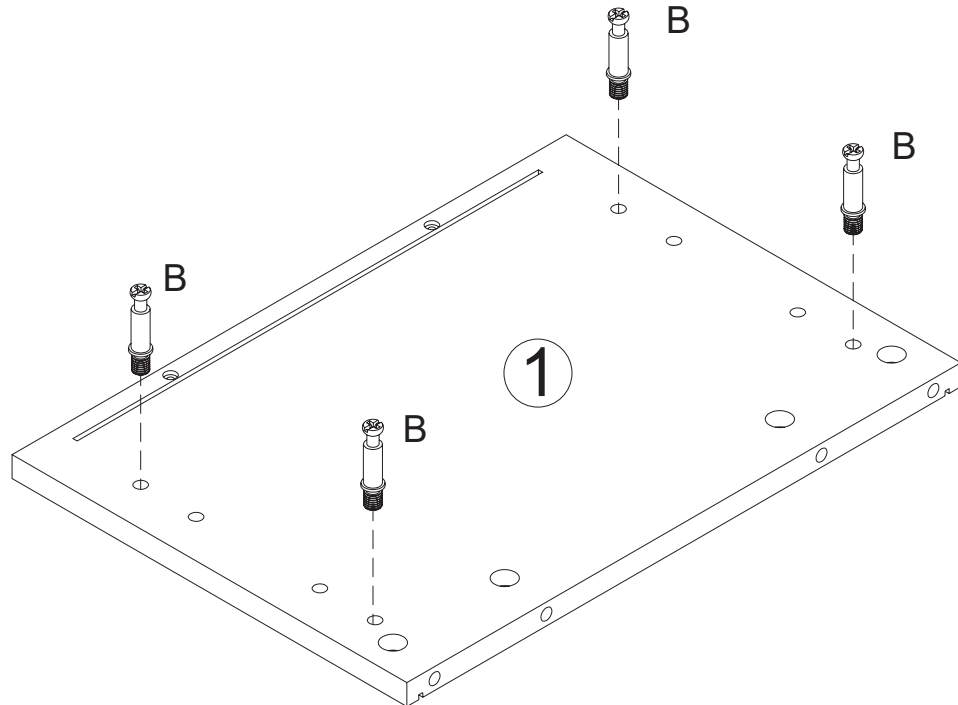
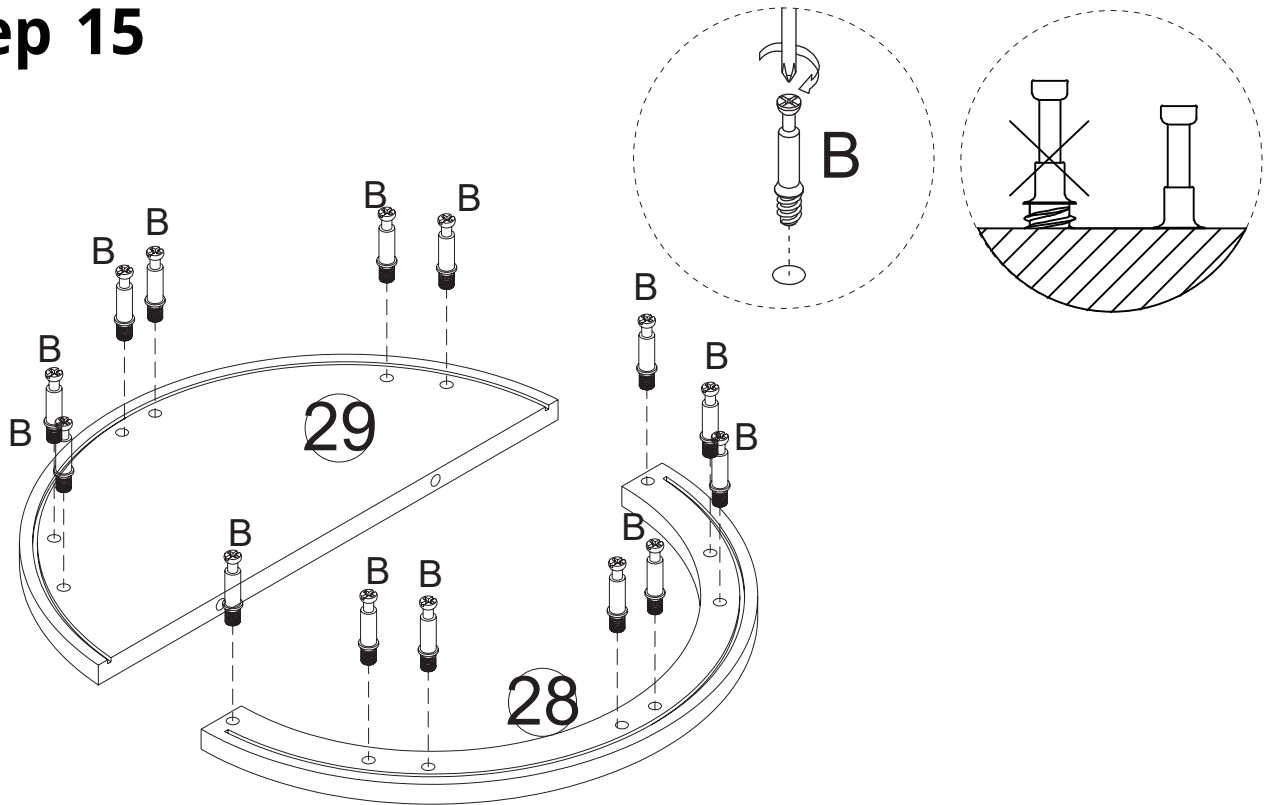

Step 16

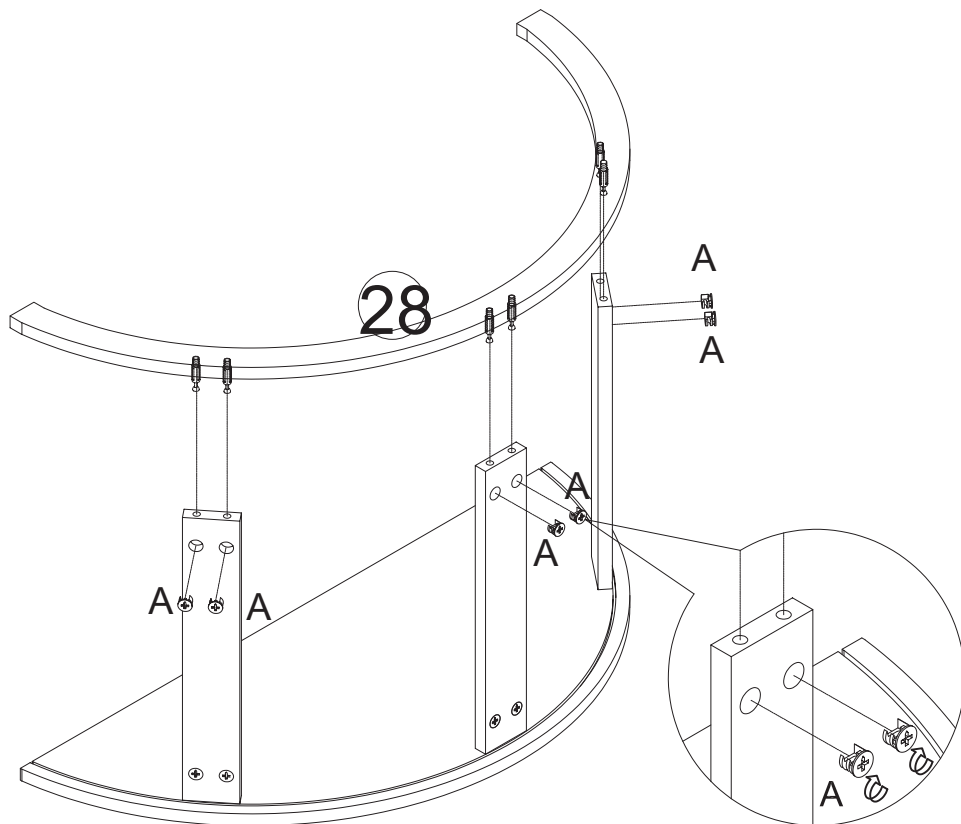
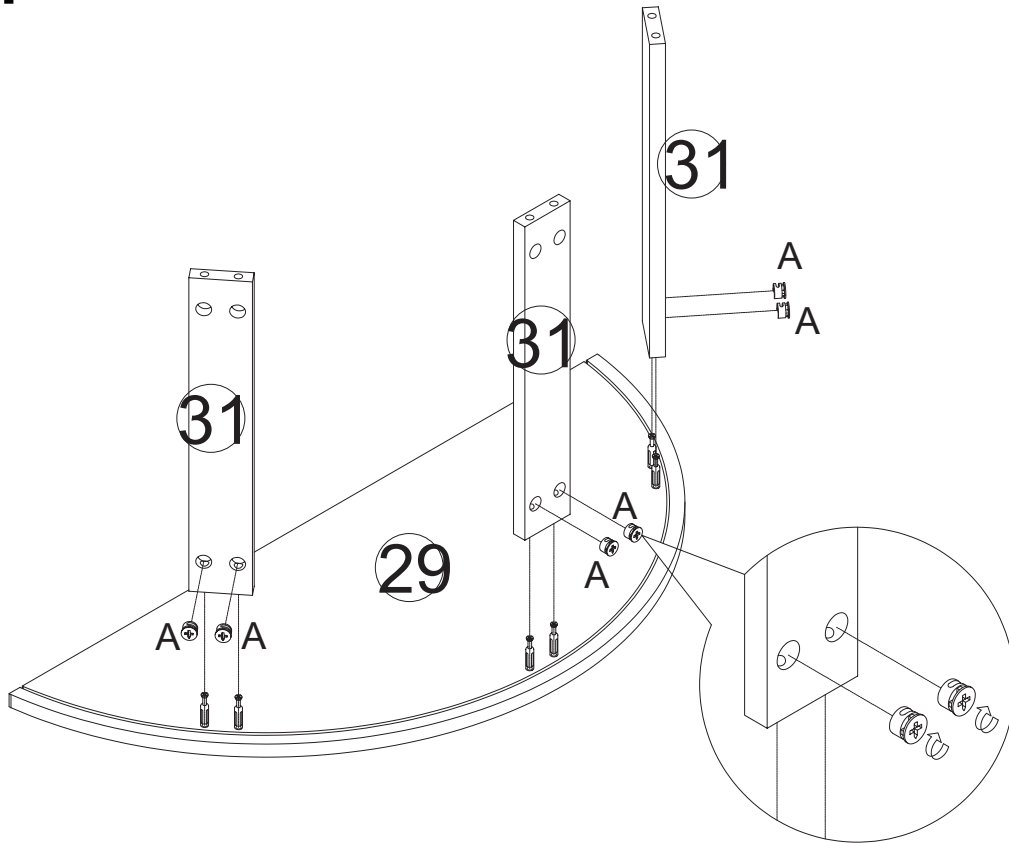

Step 17

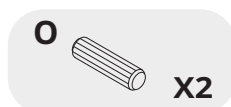
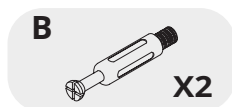
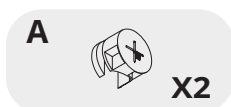
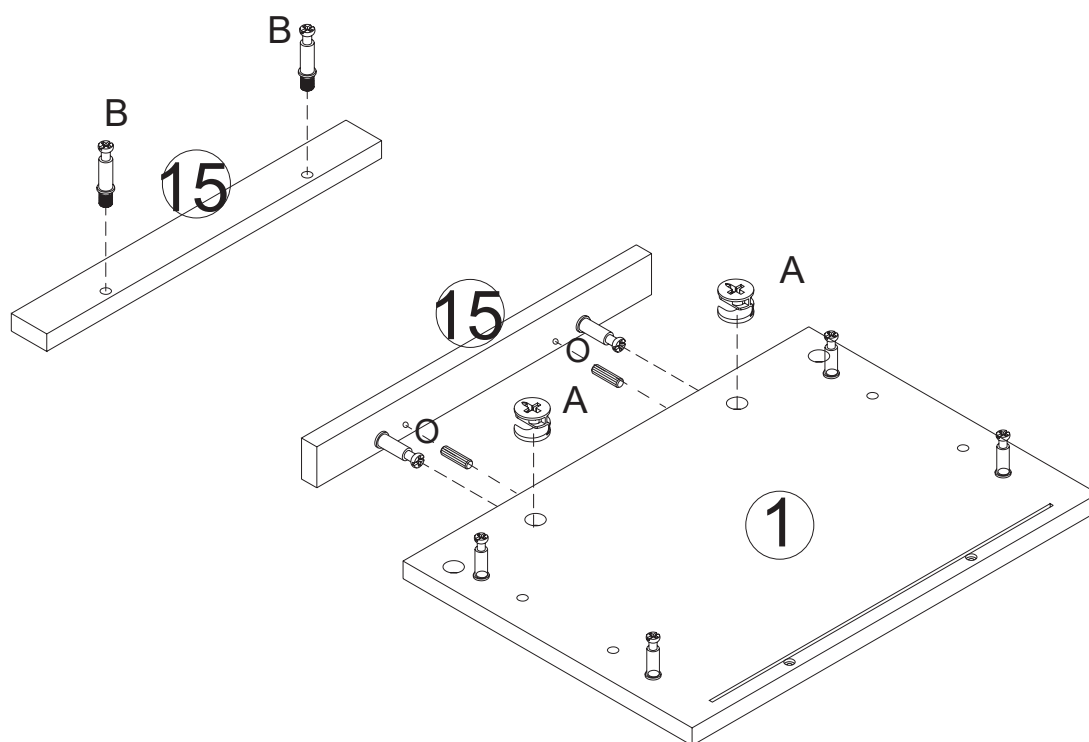
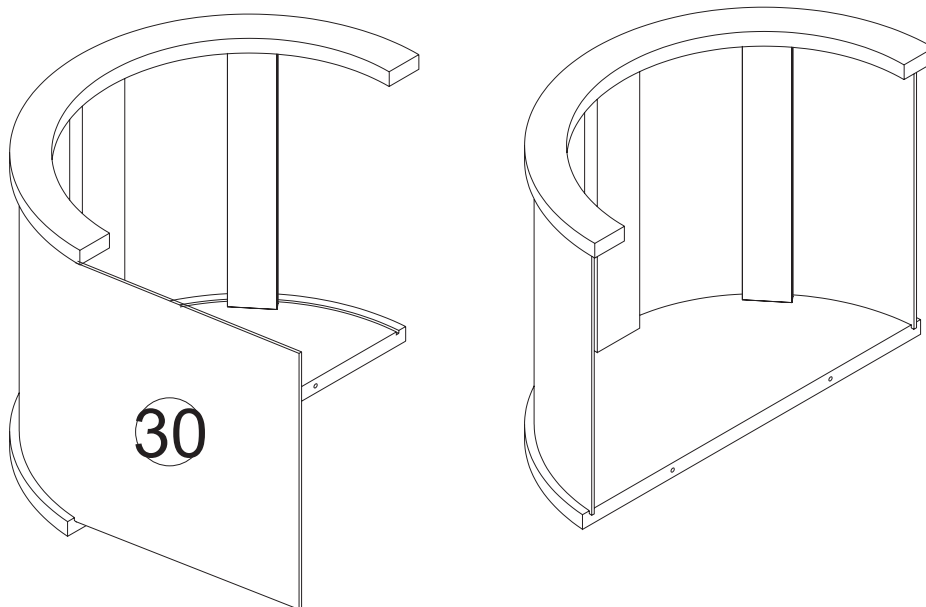

Step 18

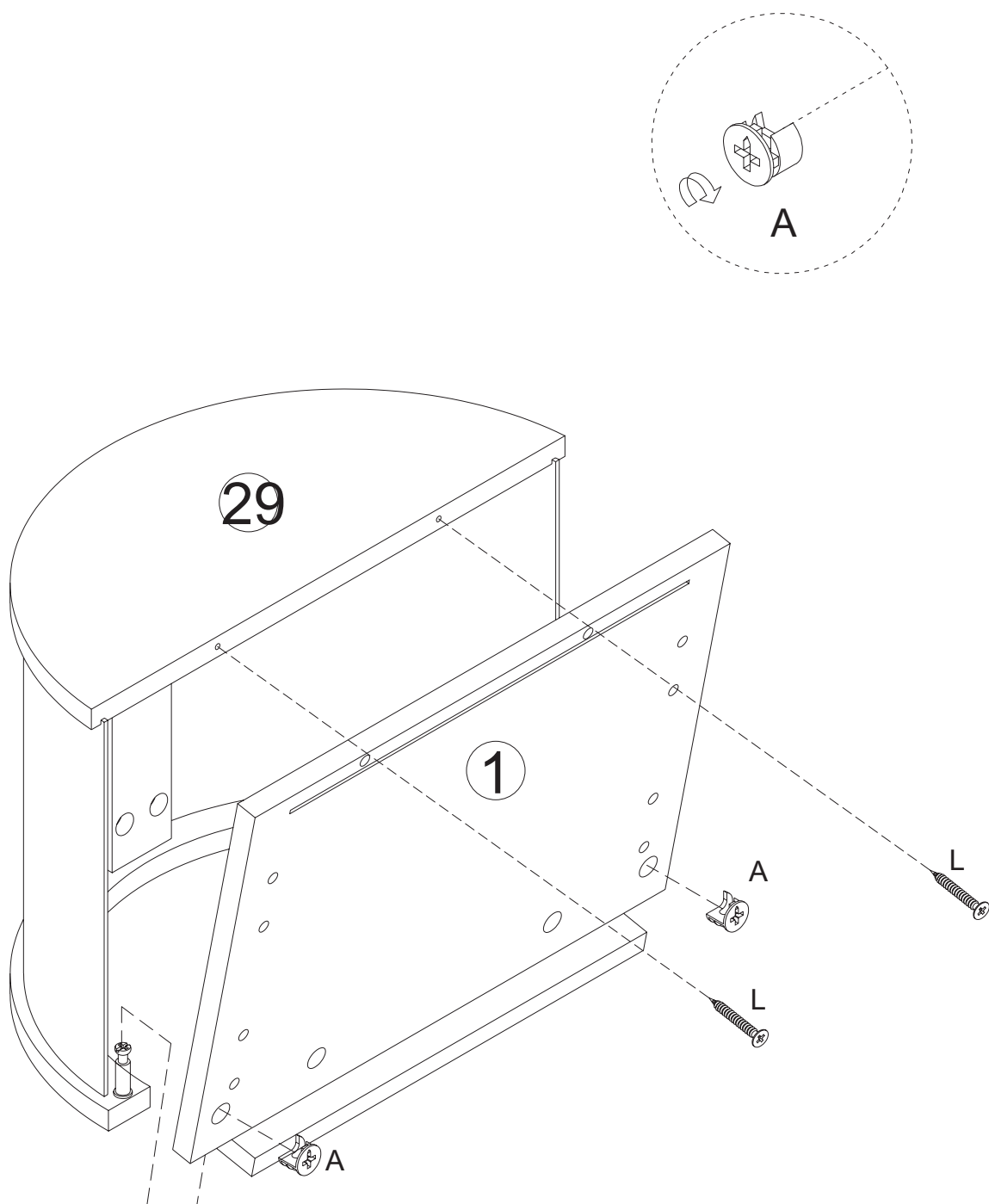

Step 19

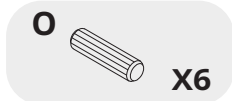
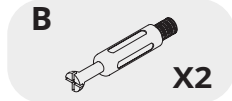
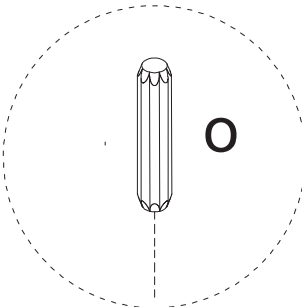
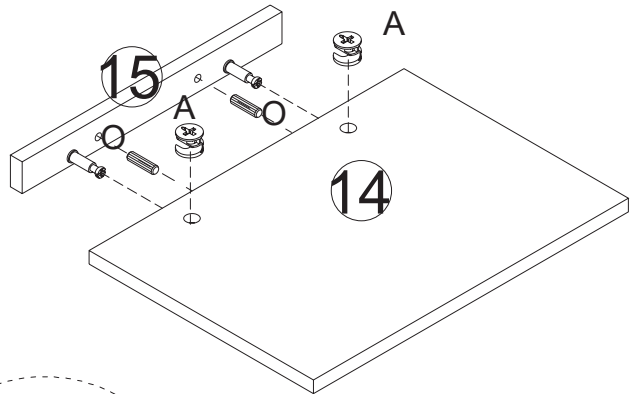
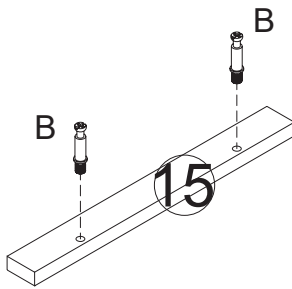
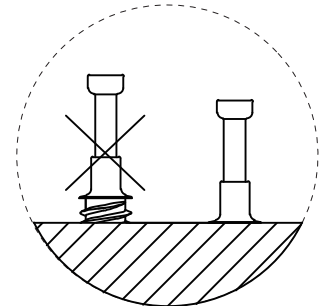
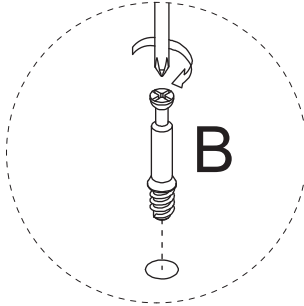
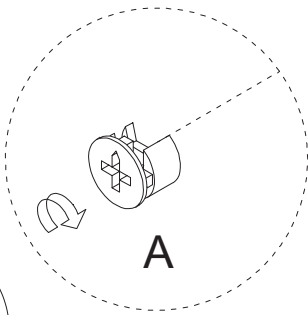
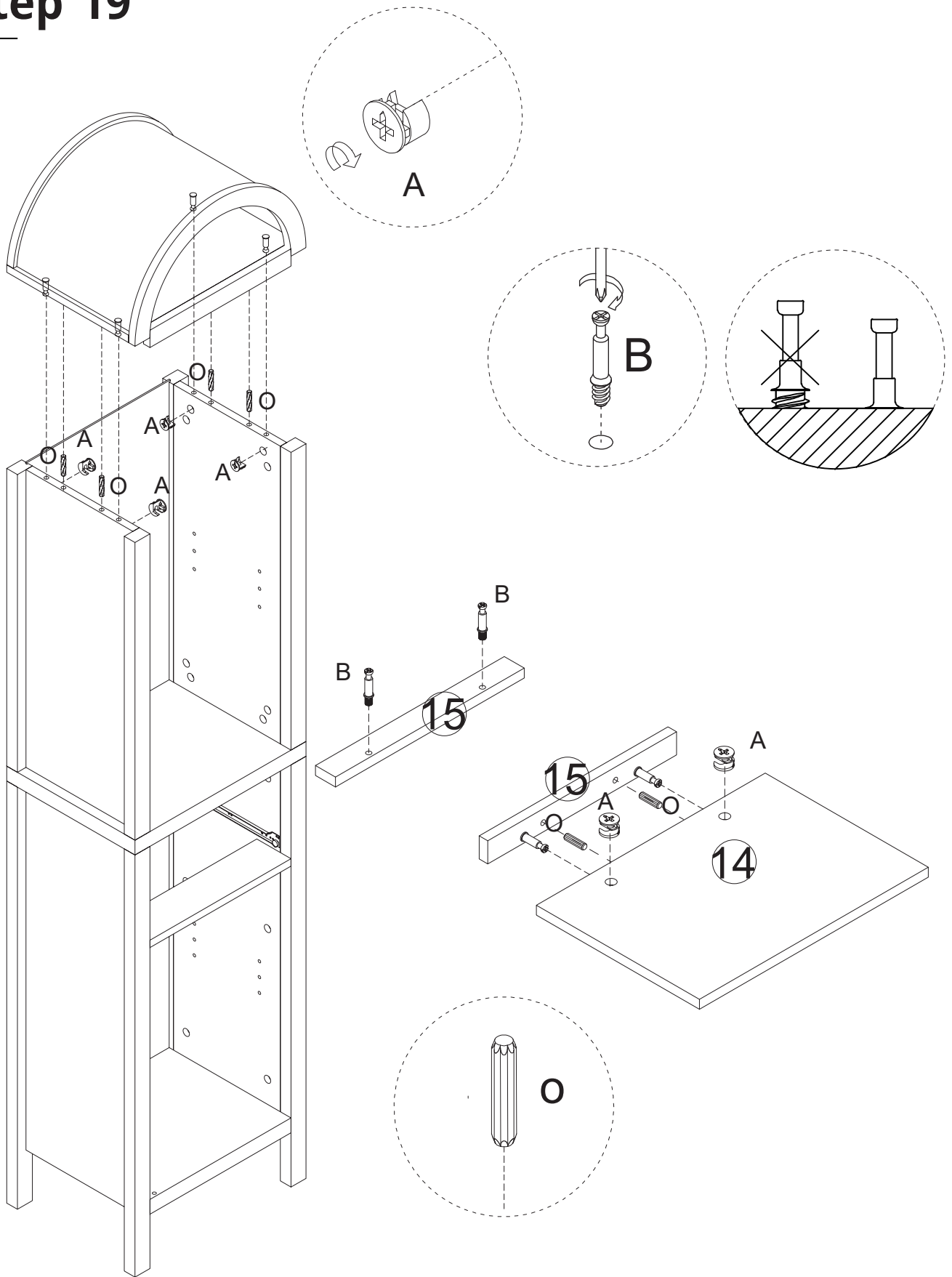

Step 20

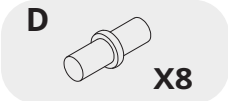
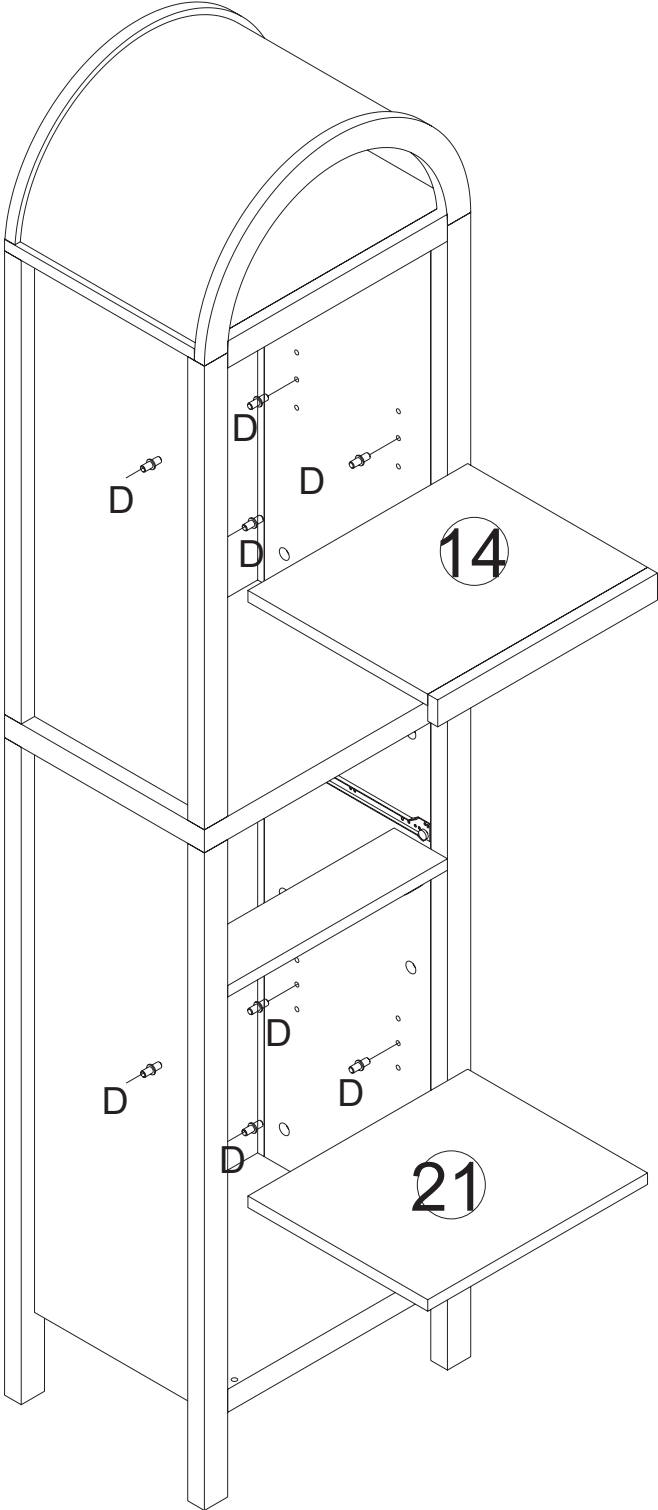
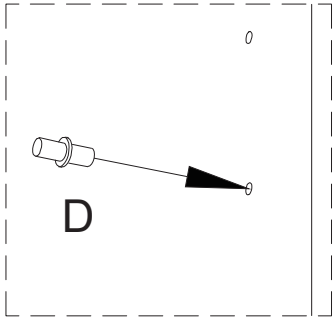

Step 21

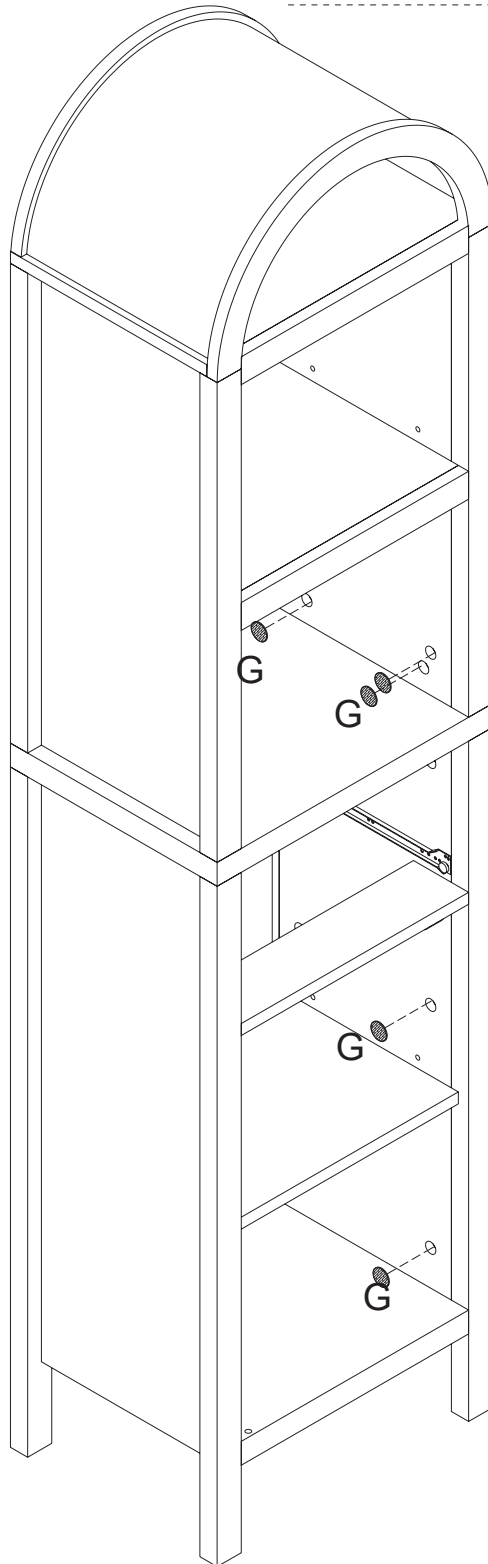
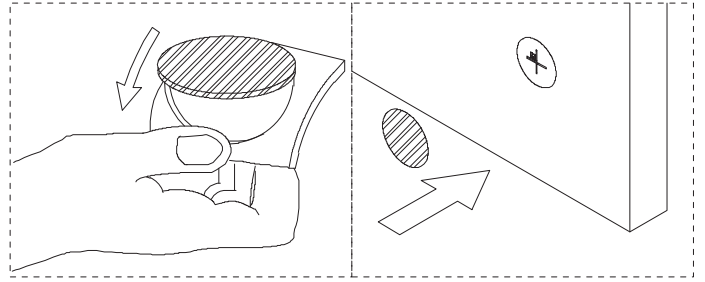

Step 22

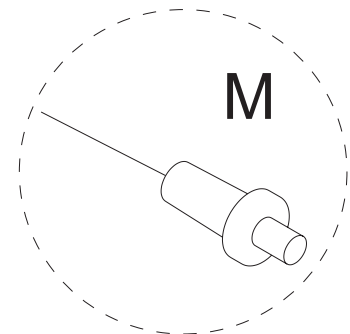
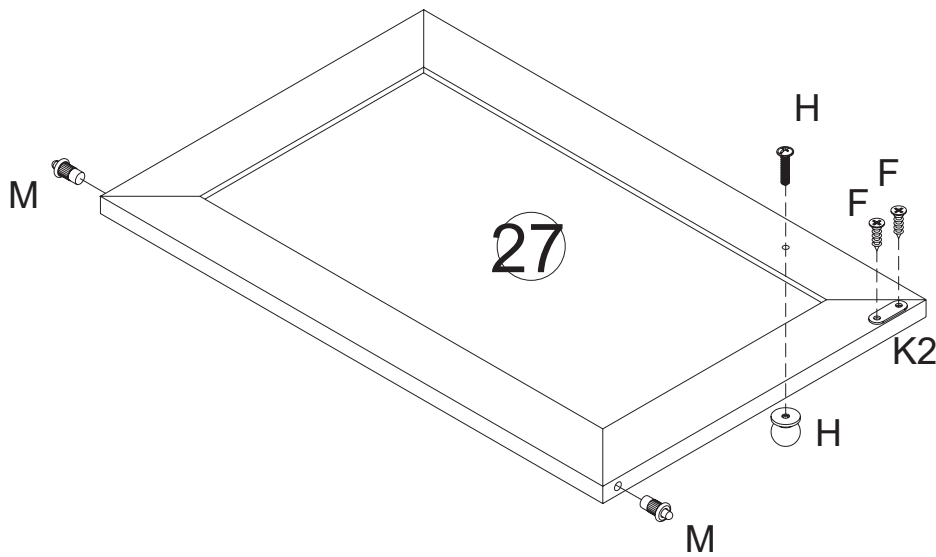
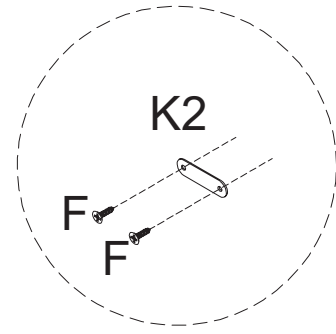

Step 23

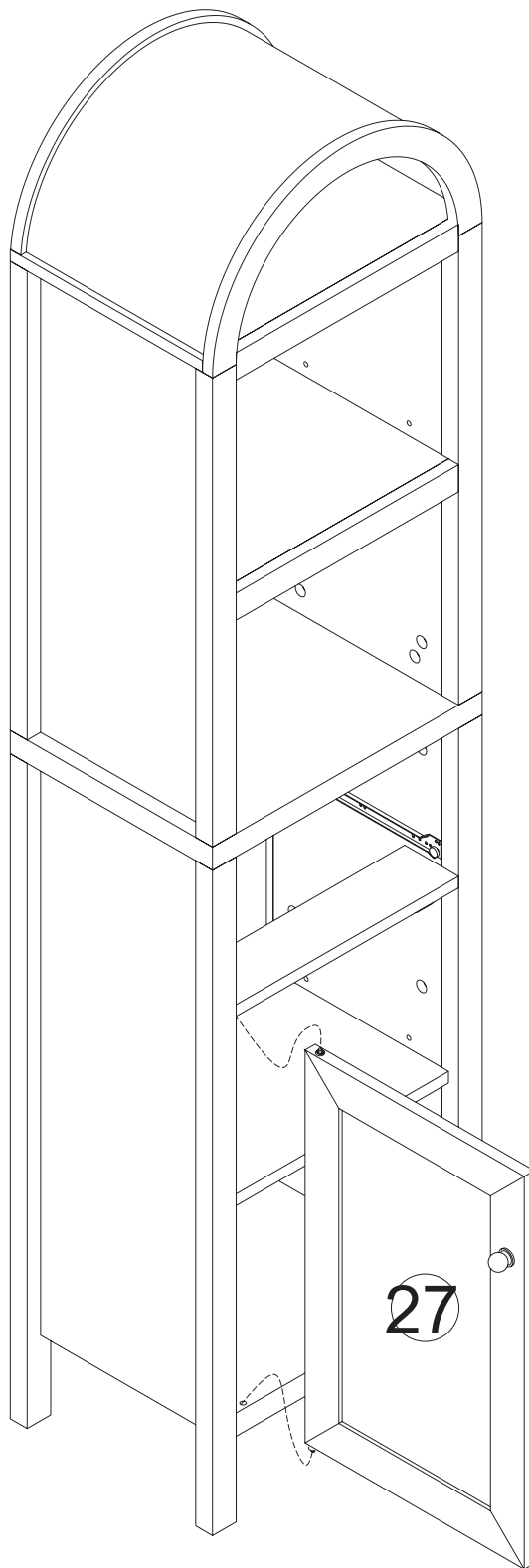

Step 24

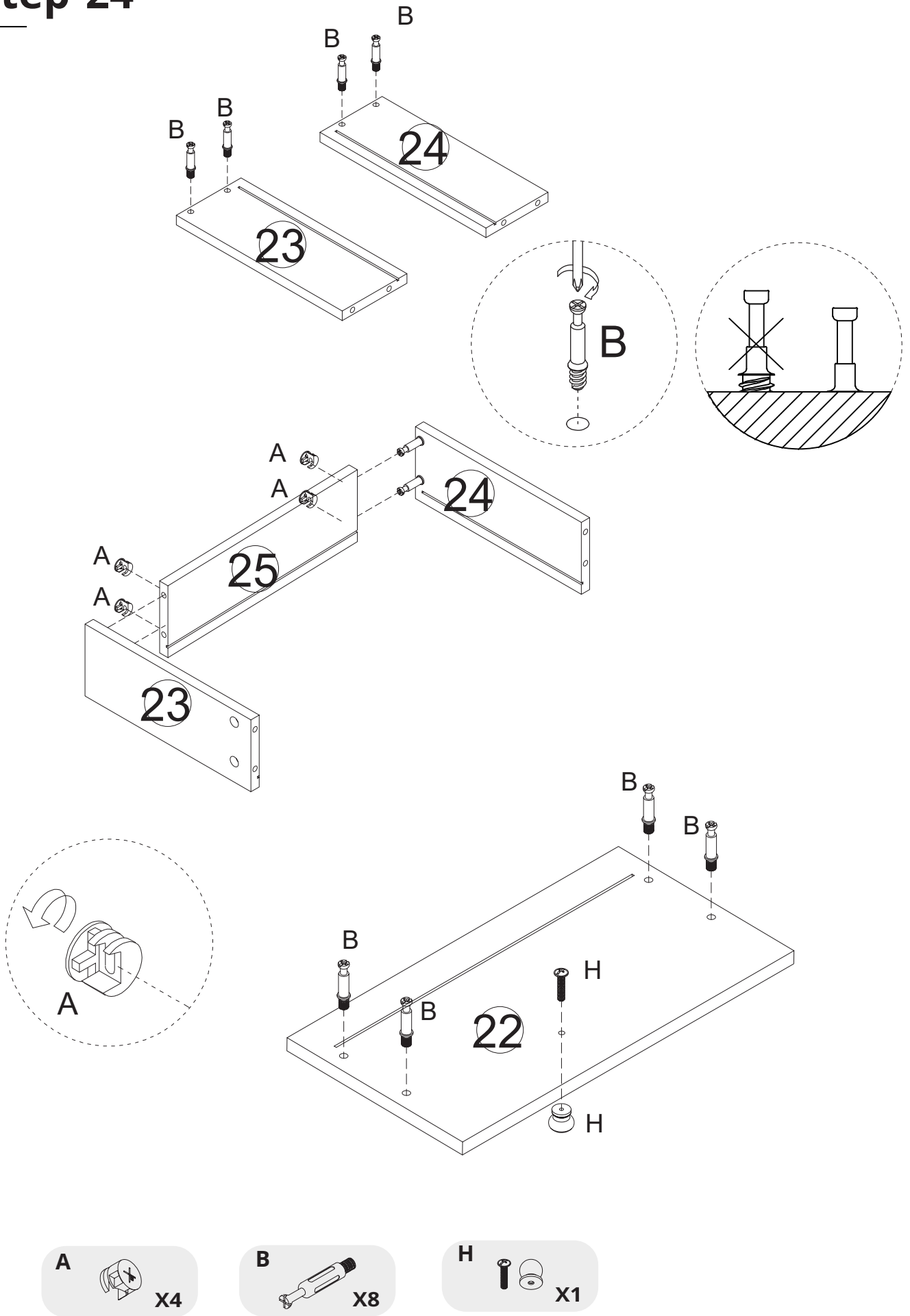

Step 25

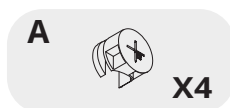
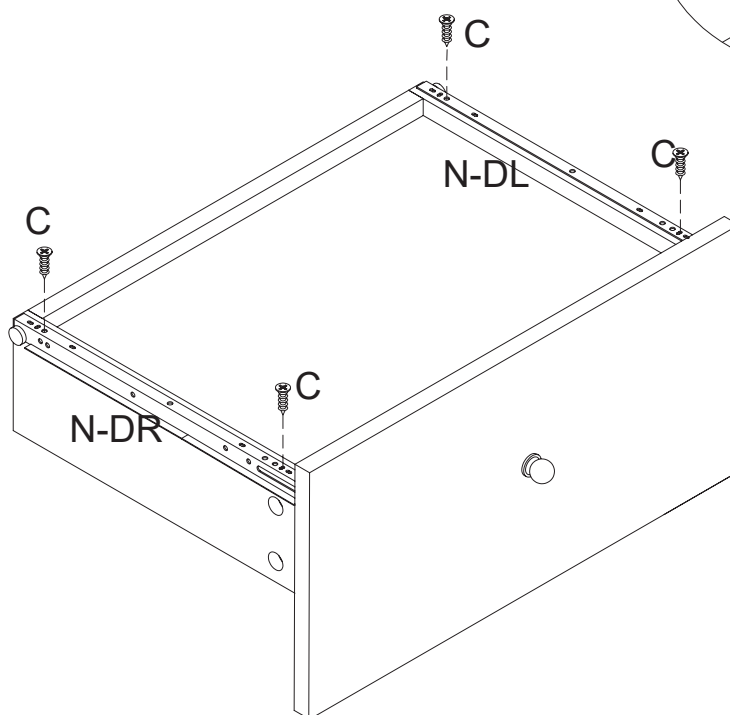
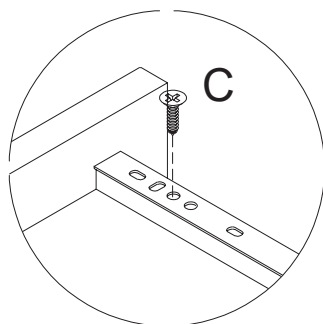
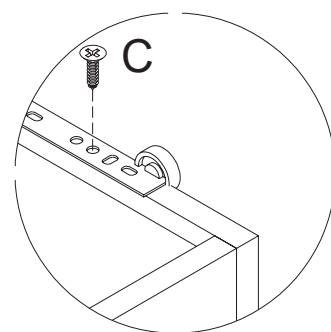
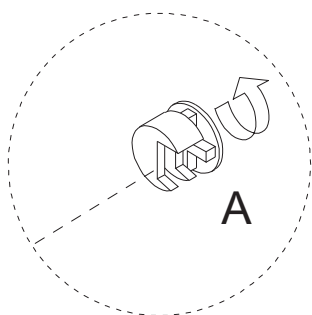
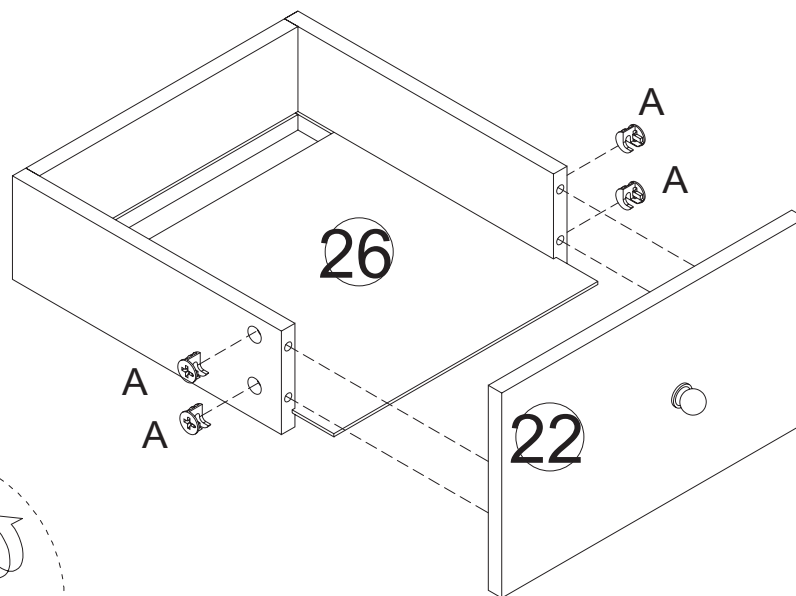

Step 26

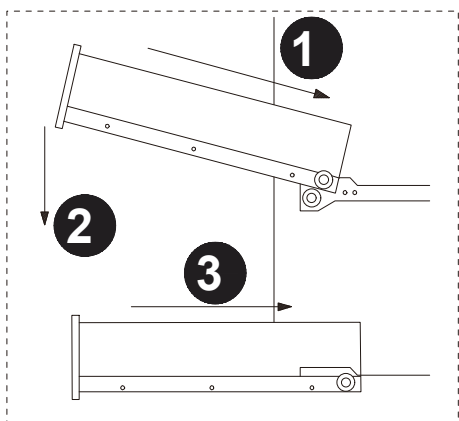
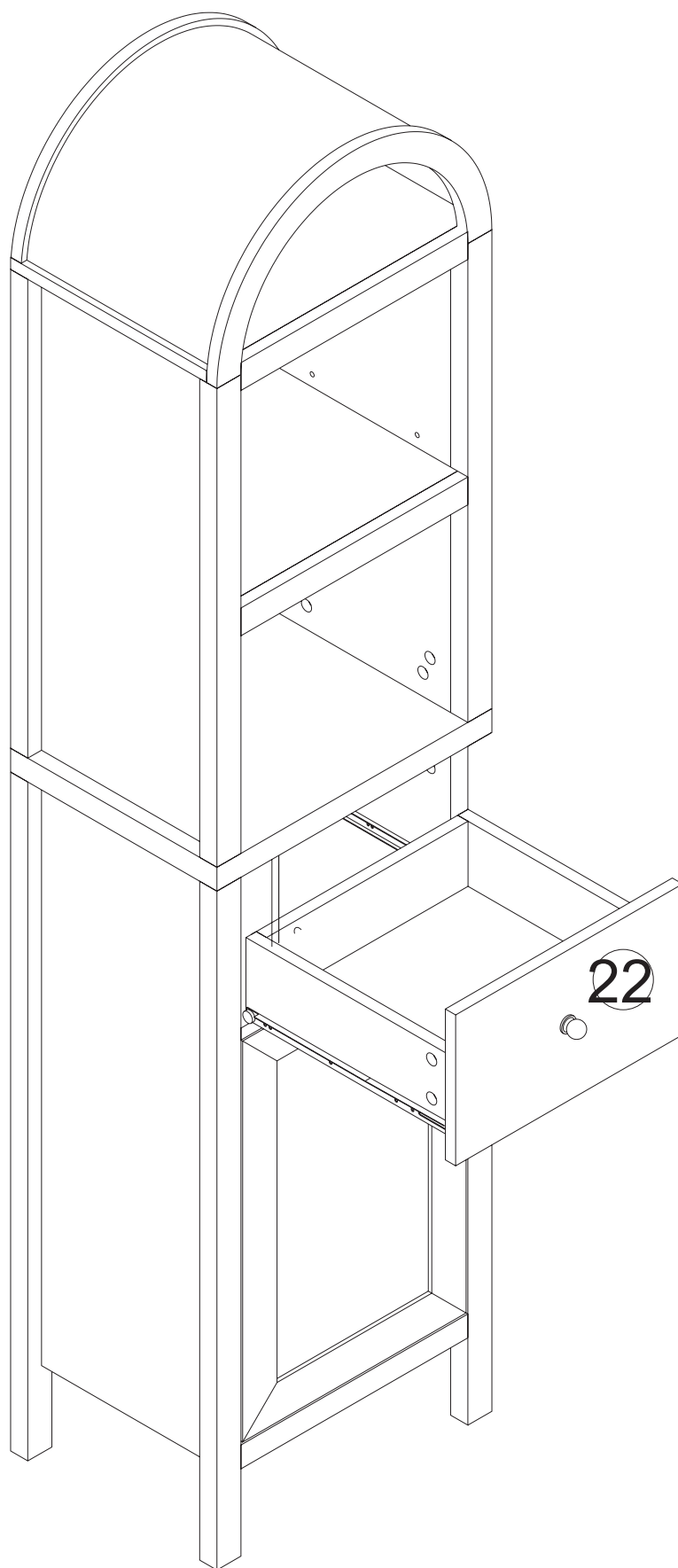

Step 27

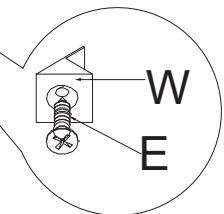
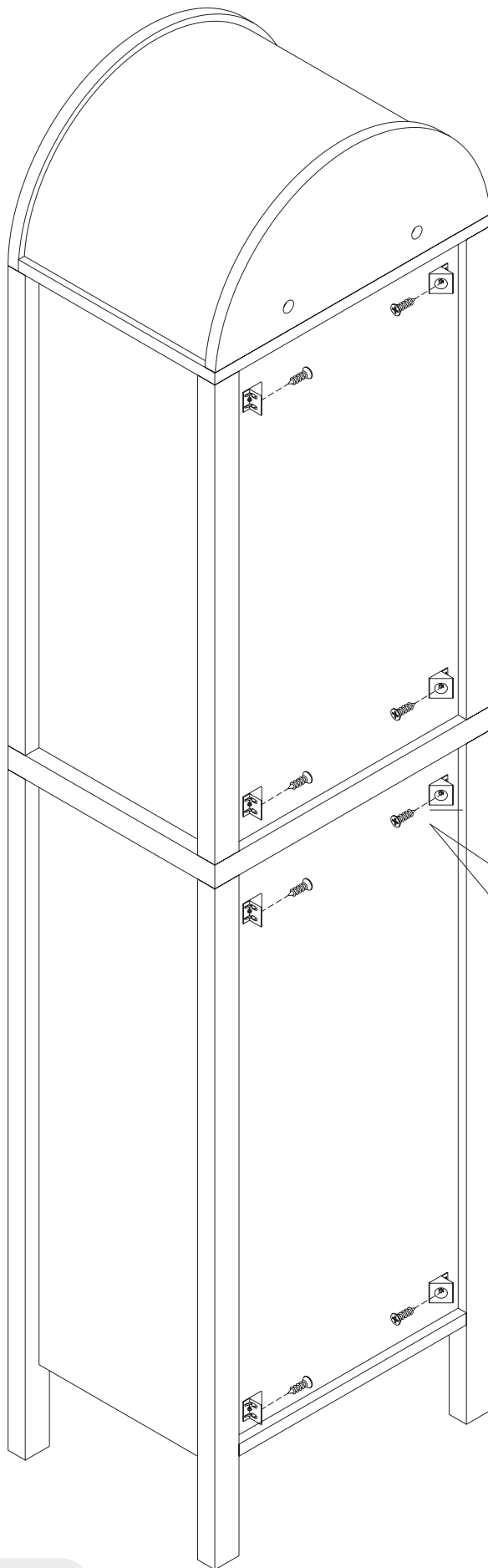
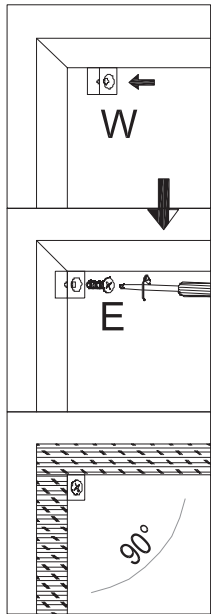

Step 28

have included a tipping restraint hardware for this unit. You must install this hardware to prevent accidents or injuries resulting from the unit falling. When properly installed, the restraint can protect against the unexpected tipping of the unit due to small tremors, bumps, or climbing. We strongly recommend mounting this hardware to a wall stud in your unit.

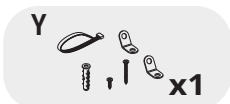
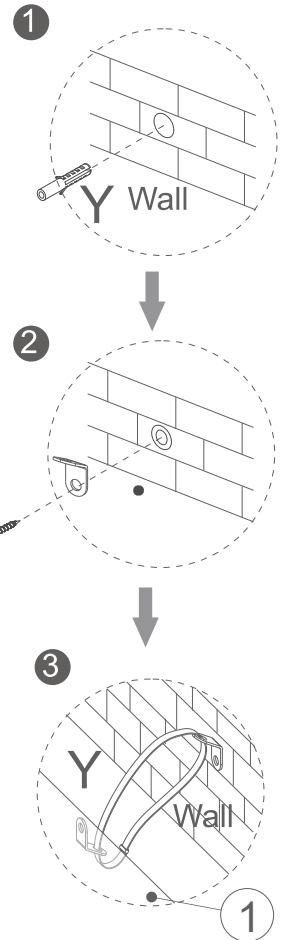
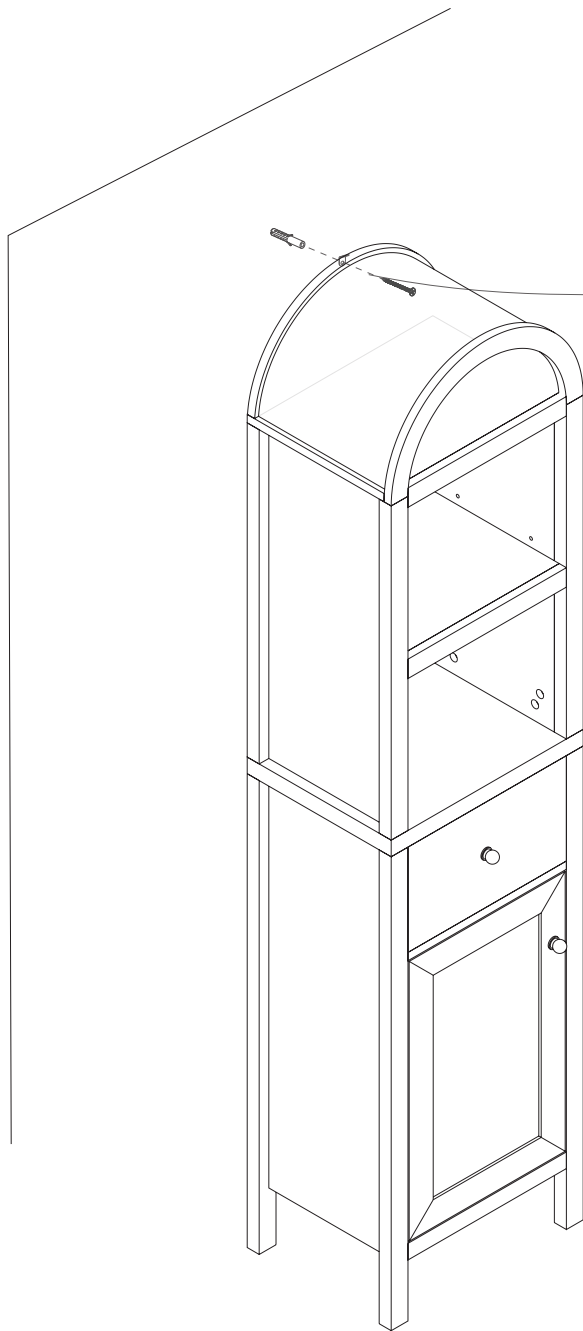

CARE INSTRUCTIONS

If treated with respect and love, your furniture will last you a long time. Each piece requires light maintenance to maximize its longevity.

Here are a few quick tips before using this product:

- The recommended weight limit is 100 lbs for each storage compartment.
- Avoid uneven weight distribution for a long time as it may cause damage to the product's shape.
- Check and tighten the camlock and screw periodically, as it may lose over time.

How to take care of it?

- Avoid direct sunlight or use curtains or blinds to limit sun exposure to the product.
- Clean the product regularly with a dry, soft cloth.
- Avoid using the abrasive or liquid cleanser.
- Spillage may damage the surface. Clean immediately with a dry cloth.
- We recommend using placemats or coasters underneath glasses, cups, bowls, or plates to prevent scratches to the table surface.

Follow the care instructions and look after your furniture, in return, your furniture will look after you.