

## ASSEMBLY INSTRUCTIONS

# EEI-6857

V0.01.01.24

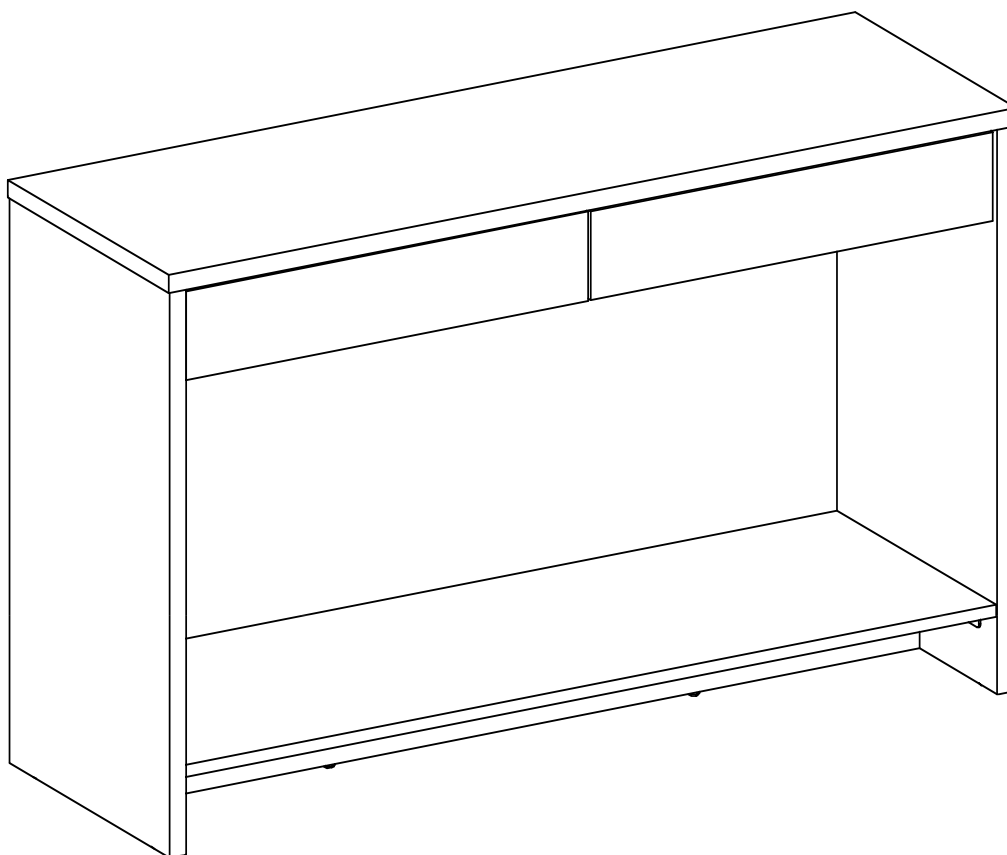

### Questions? Contact us!

609.256.9000 • [cs@modway.com](mailto:cs@modway.com)  
[www.modway.com](http://www.modway.com)

**\*modway**

# Let's get started!

**\*modway**



Read through all of the instructions before starting



Care instructions are listed in the last step of this manual



Approx. 60 minutes assembly time



Make sure you have all parts and components before discarding any packing materials



2 people recommended for assembly

**Only use hand tools to assemble this item.** Do not use power tools.

Do not tighten bolts or screws completely until all hardware is lined up and inserted into the holes.

Do not over-tighten screws and bolts to avoid stripping the hardware or cracking the item.

Assemble your item on a flat, carpeted area, with plenty of space to work. This will prevent damage and scratches to your floors or the item while you're assembling the product.

Keep all components and packaging out of reach of children or animals to avoid risk of choking or suffocation.

## Furniture components:

1	Top Board	x1	9	Rear Drawer	x2
2	Bottom Board	x1	10	Left Drawer	x2
3	Left Board	x1	11	Right Drawer	x2
4	Right Board	x1	12	Bottom Drawer	x2
5	Drawer Divider	x1	13	Metal Support	x1
6	Drawer Support	x1	14	Top Rear Board	x1
7	Left Front Drawer	x1	15	Bottom Rear Board	x1
8	Right Front Drawer	x1			

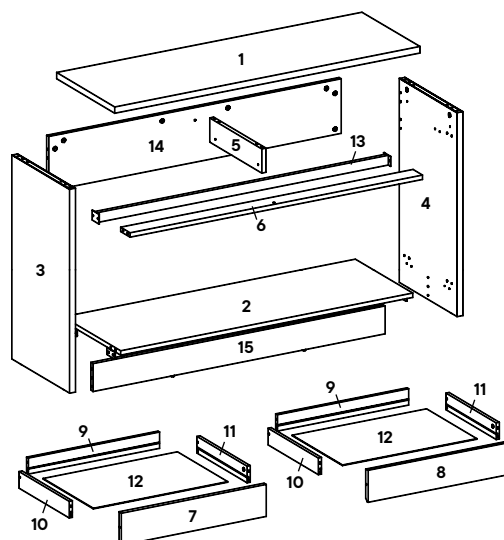

## Provided hardware:

A		Cam Lock Ø15 mm	x28
B		Cam Bolt Ø7.5 x 32 mm	x32
C		Cam Cover Ø17 mm	x24
D		Plastic Dowel M8 x 32 mm	x22
E		Screw M6 x 8 mm	x8
F		Screw M6 x 13 mm	x8
G		Screw M4 x 19 mm	x8
H		Screw M10 x 33.5 mm	x5
I		Screw M4 x 10 mm	x20

J		Backply Stopper	x8
K		L Plate	x4
L		Allen Key	x1
M		Drawer Rail	x2
N		Cam Lock Ø12 mm	x4
O		Cam Cover Ø15 mm	x4
P		Screw M6.3 x 50 mm	x1
Q		Plastic Dowel M6 x 30 mm	x8

## What you need:



**Wait!**

**Missing parts or hardware? Need assistance?**

Contact us before returning your item. We're here to help!

609.256.9000 • [cs@modway.com](mailto:cs@modway.com)

# Step 1

## HARDWARE

- B** Cam Bolt Ø7.5 x 32 mm x13
- D** Plastic Dowel M8 x 32 mm x8

## COMPONENTS

- 1** Top Board x1
- 2** Bottom Board x1
- 15** Bottom Rear Board x1

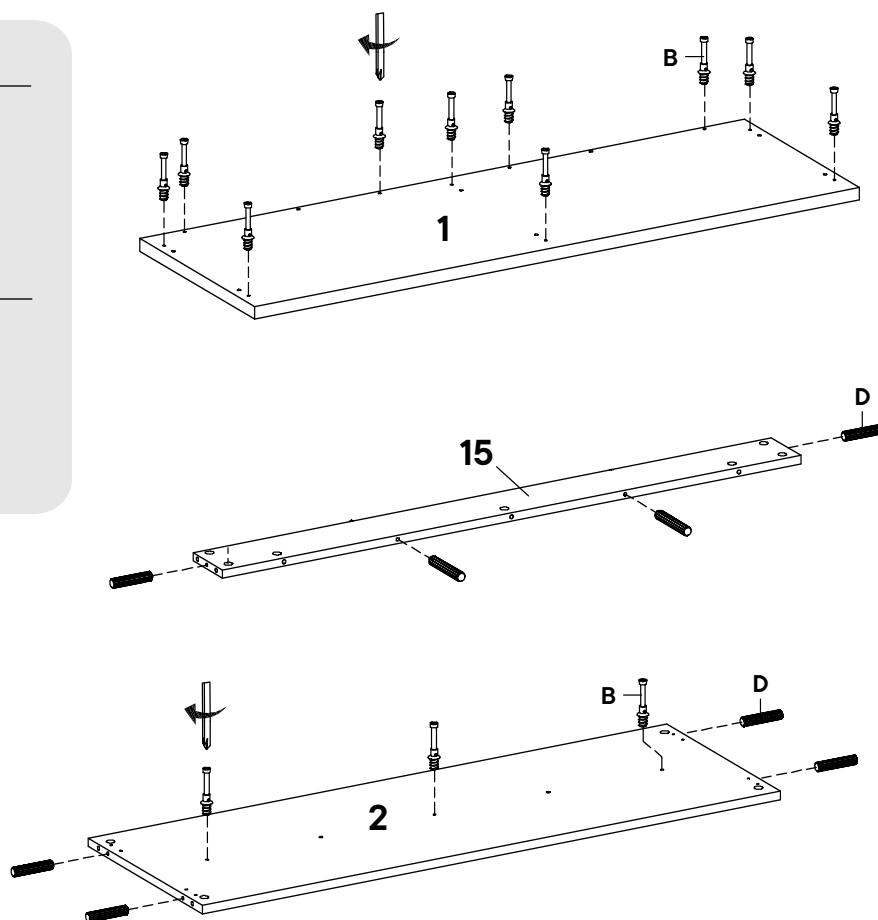

# Step 2

## HARDWARE

- B** Cam Bolt Ø7.5 x 32 mm x1
- D** Plastic Dowel M8 x 32 mm x8

## COMPONENTS

- 6** Drawer Support x1
- 14** Top Rear Board x1

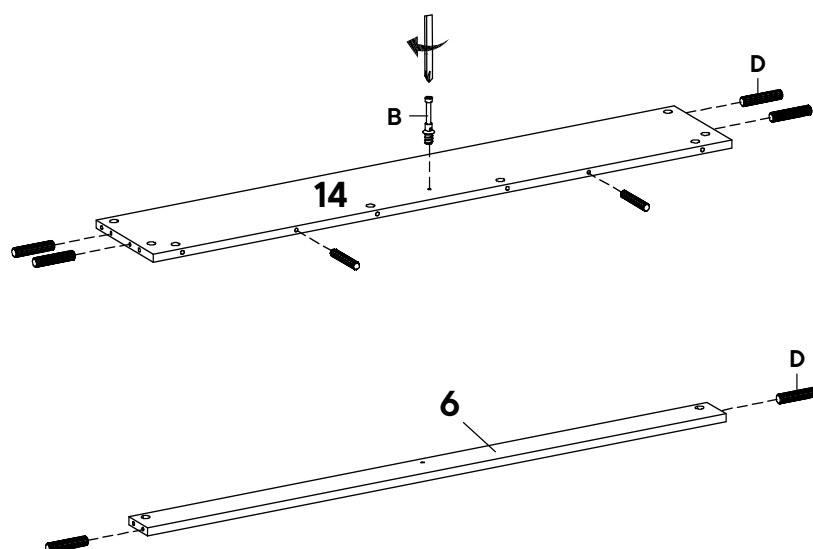

## Step 3

### HARDWARE

<b>B</b>	Cam Bolt Ø7.5 x 32 mm	x14
<b>D</b>	Plastic Dowel M8 x 32 mm	x4
<b>E</b>	Screw M6 x 8 mm	x4
<b>M</b>	Drawer Rail	x1

### COMPONENTS

<b>3</b>	Left Board	x1
<b>4</b>	Right Board	x1

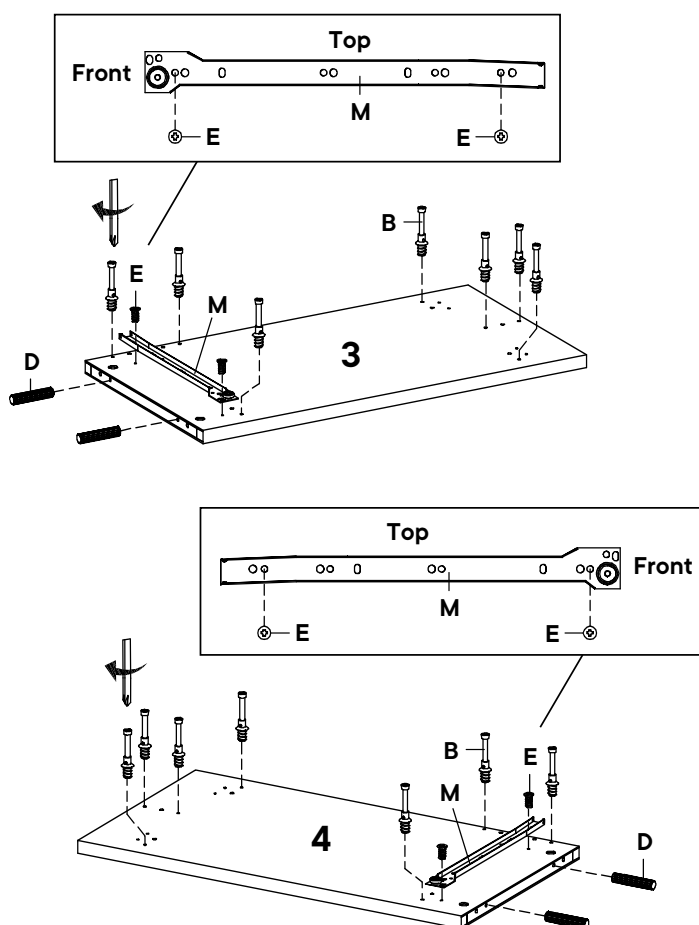

## Step 4

### HARDWARE

<b>D</b>	Plastic Dowel M8 x 32 mm	x2
<b>E</b>	Screw M6 x 8 mm	x4
<b>M</b>	Drawer Rail	x1

### COMPONENTS

<b>5</b>	Drawer Divider	x1
----------	----------------	----

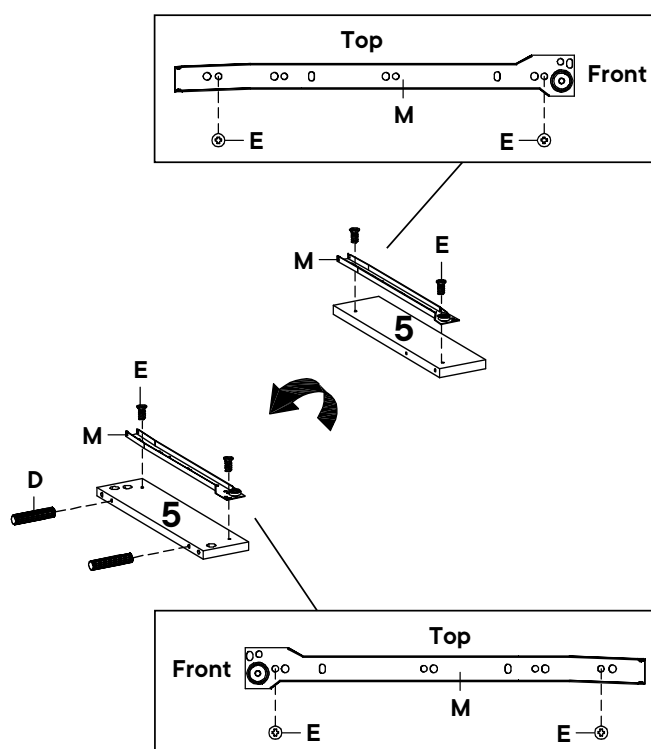



## Step 5

### HARDWARE

- |          |                  |    |
|----------|------------------|----|
| <b>A</b> | Cam Lock Ø15 mm  | x3 |
| <b>C</b> | Cam Cover Ø17 mm | x3 |

### COMPONENTS

- |           |                   |    |
|-----------|-------------------|----|
| <b>2</b>  | Bottom Board      | x1 |
| <b>15</b> | Bottom Rear Board | x1 |

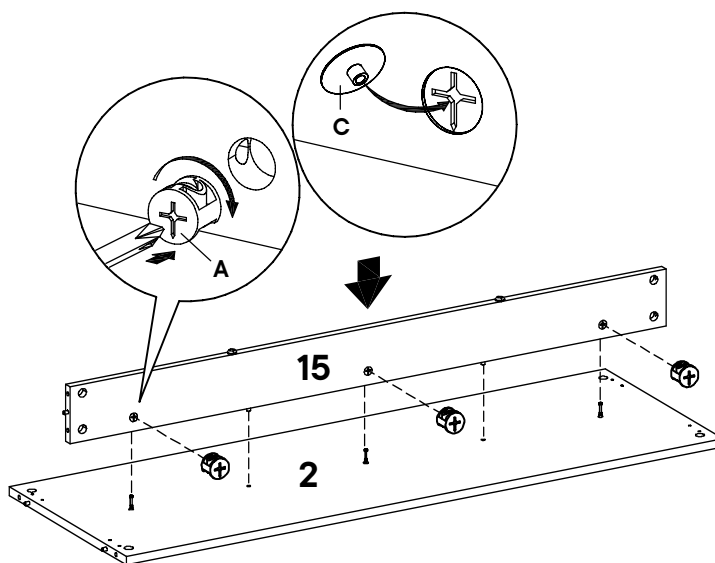

## Step 6

### HARDWARE

- |          |                  |     |
|----------|------------------|-----|
| <b>A</b> | Cam Lock Ø15 mm  | x14 |
| <b>C</b> | Cam Cover Ø17 mm | x10 |
| <b>I</b> | Screw M4 x 10 mm | x4  |

### COMPONENTS

- |           |                   |    |
|-----------|-------------------|----|
| <b>2</b>  | Bottom Board      | x1 |
| <b>3</b>  | Left board        | x1 |
| <b>4</b>  | Right Board       | x1 |
| <b>6</b>  | Drawer Support    | x1 |
| <b>13</b> | Metal Support     | x1 |
| <b>14</b> | Top Rear Board    | x1 |
| <b>15</b> | Bottom Rear Board | x1 |

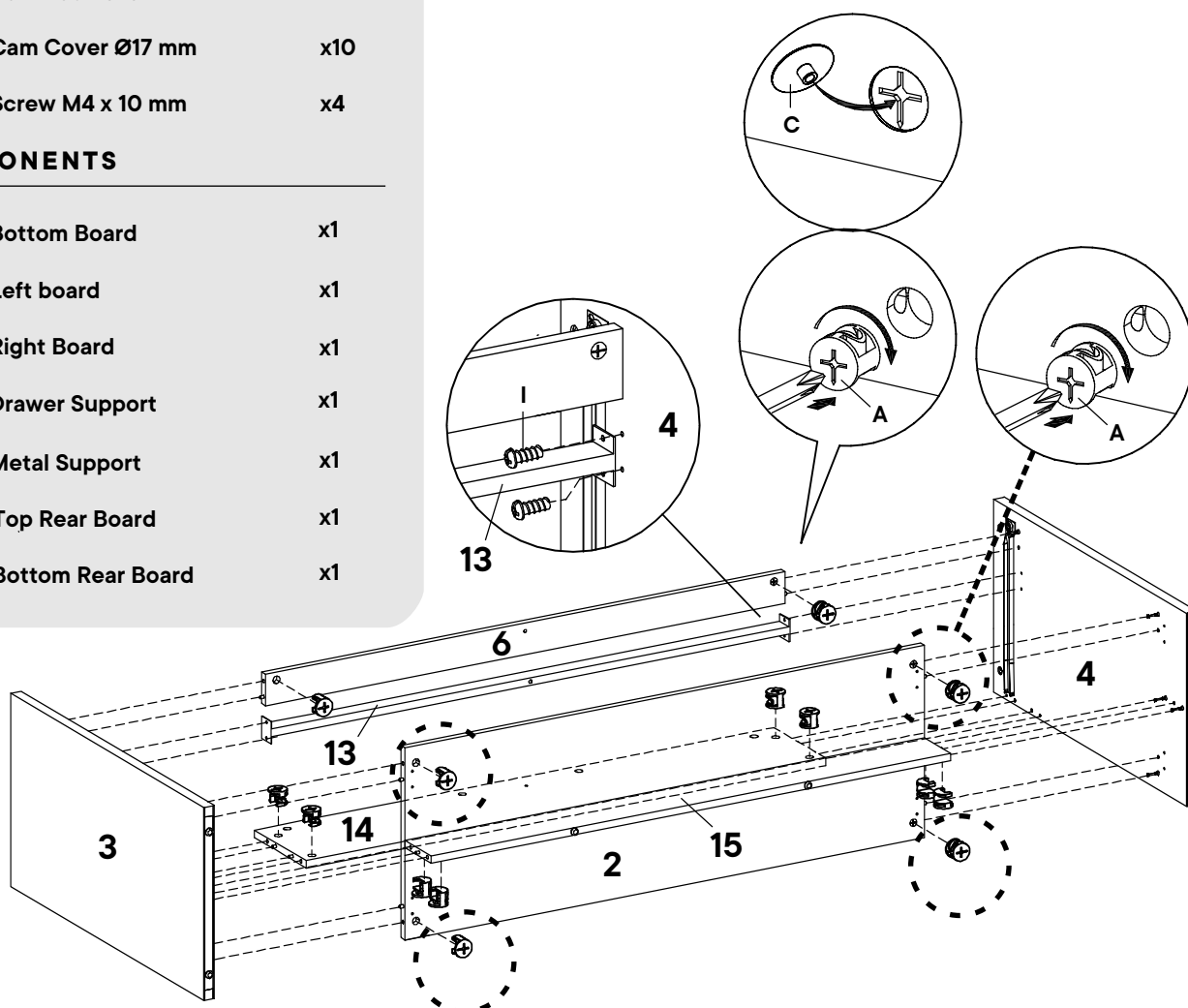

## Step 7

### HARDWARE

<b>I</b>	Screw M4 x 10 mm	x16
<b>K</b>	L Plate	x4

### COMPONENTS

<b>2</b>	Bottom Board	x1
<b>3</b>	Left Board	x1
<b>4</b>	Right Board	x1

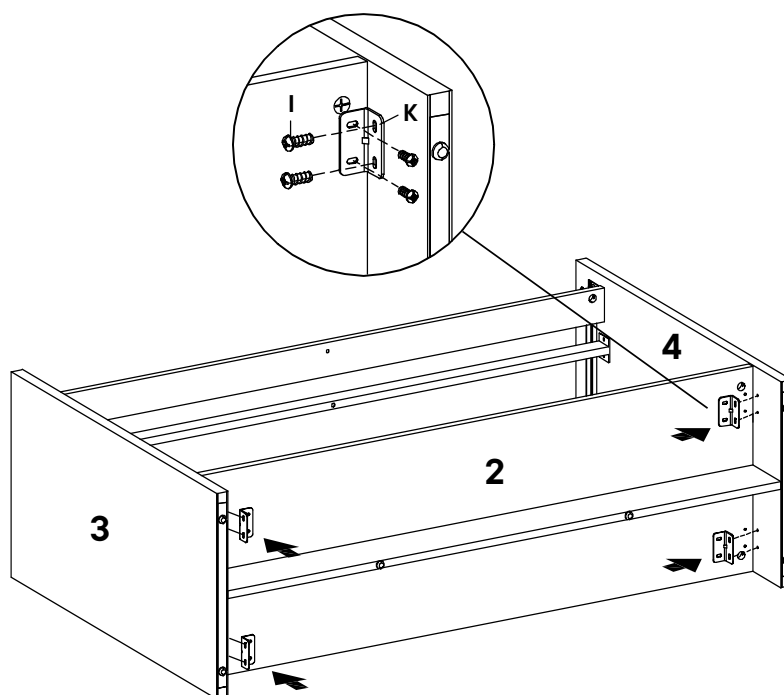

## Step 8

### HARDWARE

<b>A</b>	Cam Lock Ø15 mm	x1
<b>C</b>	Cam Cover Ø17 mm	x1
<b>H</b>	Screw M10 x 33.5 mm	x1
<b>L</b>	Allen Key	x1
<b>P</b>	Screw M6.3 x 50 mm	x1

### COMPONENTS

<b>5</b>	Drawer Divider	x1
<b>6</b>	Drawer Support	x1
<b>13</b>	Metal Support	x1
<b>14</b>	Top Rear Board	x1

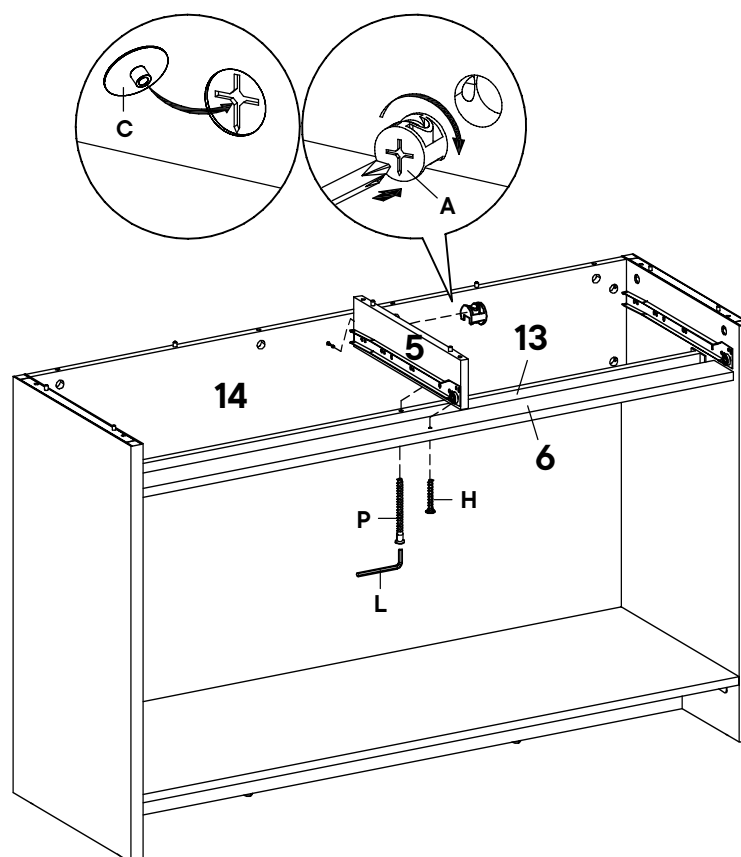

## Step 9

### HARDWARE

<b>A</b>	Cam Lock Ø15 mm	x10
<b>C</b>	Cam Cover Ø17 mm	x10

### COMPONENTS

<b>1</b>	Top Board	x1
<b>3</b>	Left Board	x1
<b>4</b>	Right Board	x1
<b>5</b>	Drawer Divider	x1
<b>14</b>	Top Rear Board	x1

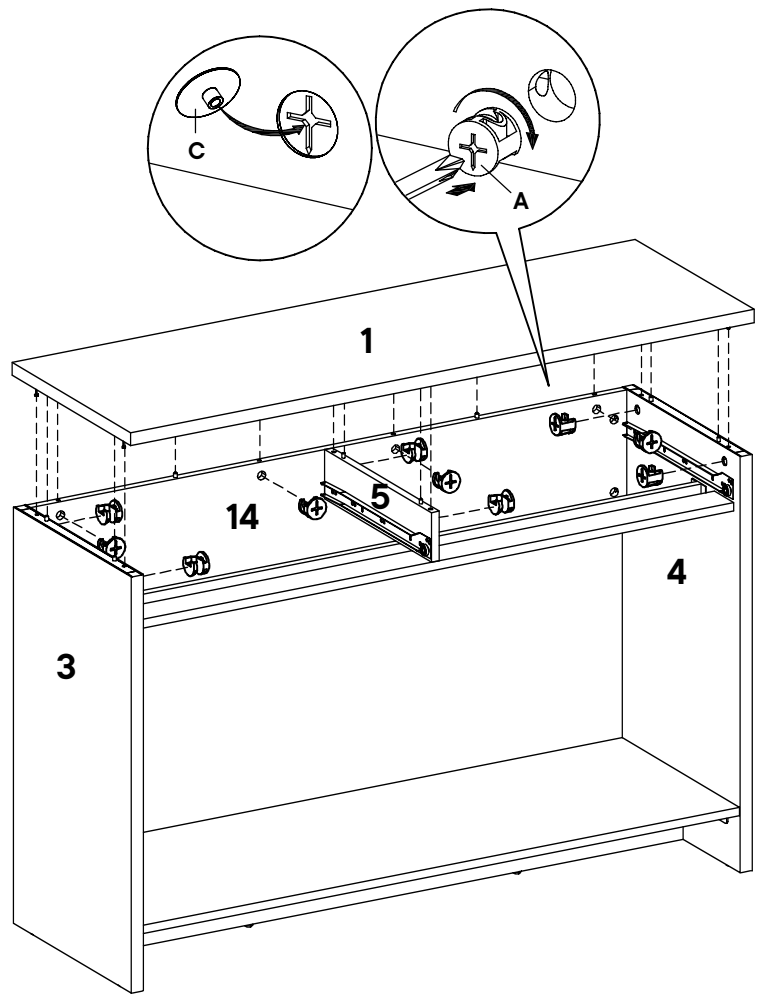

## Step 10

### HARDWARE

<b>B</b>	Cam Bolt Ø7.5 x 32 mm	x4
<b>Q</b>	Plastic Dowel M6 x 30 mm	x8

### COMPONENTS

<b>7</b>	Left Front Drawer	x1
<b>8</b>	Right Front Drawer	x1
<b>9</b>	Rear Drawer	x2
<b>10</b>	Left Drawer	x2
<b>11</b>	Right Drawer	x2

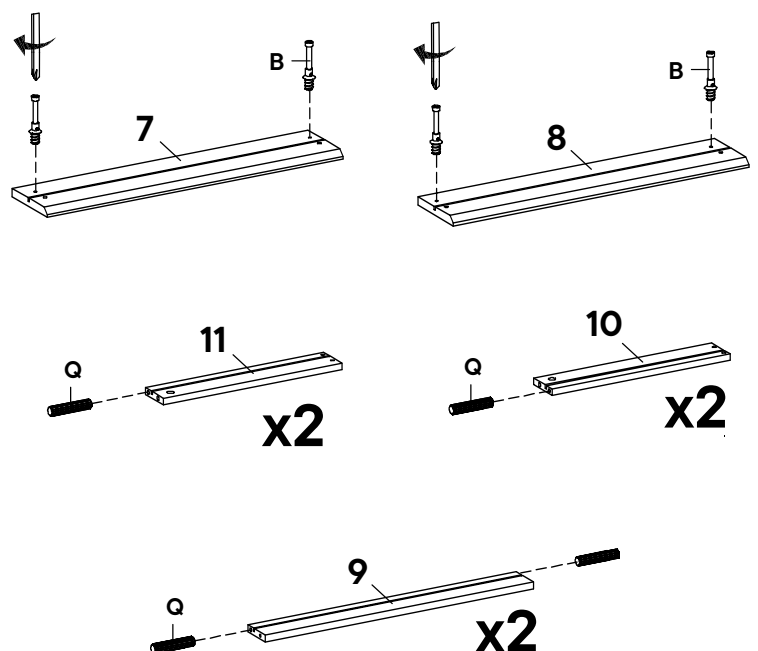

## Step 11

### HARDWARE

- H** Screw M10 x33.5 mm x4

### COMPONENTS

- 9** Rear Drawer x2  
**10** Left Drawer x2  
**11** Right Drawer x2  
**12** Bottom Drawer x2

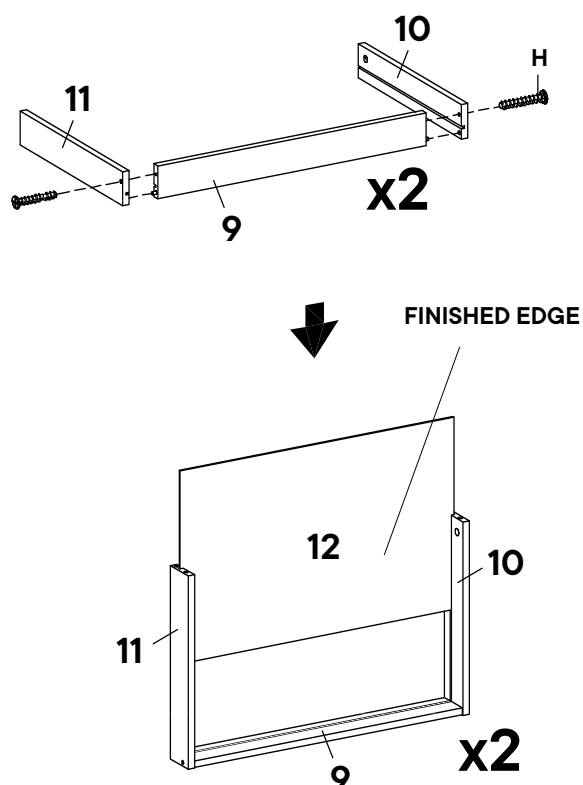

## Step 12

### HARDWARE

- N** Cam Lock Ø12 mm x4  
**O** Cam Cover Ø15 mm x4

### COMPONENTS

- 7** Left Front Drawer x1  
**8** Right Front Drawer x1  
**10** Left Drawer x2  
**11** Right Drawer x2  
**12** Bottom Drawer x2

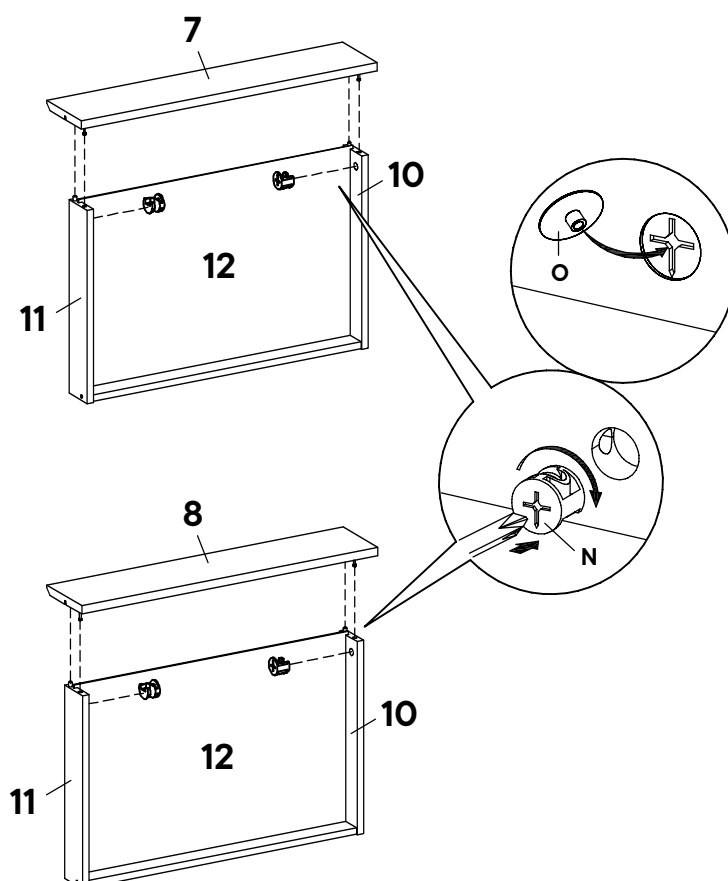

## Step 13

### HARDWARE

<b>G</b>	Screw M4 x 19 mm	x8
<b>J</b>	Backply Stopper	x8

### COMPONENTS

<b>7</b>	Left Front Drawer	x1
<b>8</b>	Right Front Drawer	x1
<b>10</b>	Left Drawer	x2
<b>11</b>	Right Drawer	x2
<b>12</b>	Bottom Drawer	x2

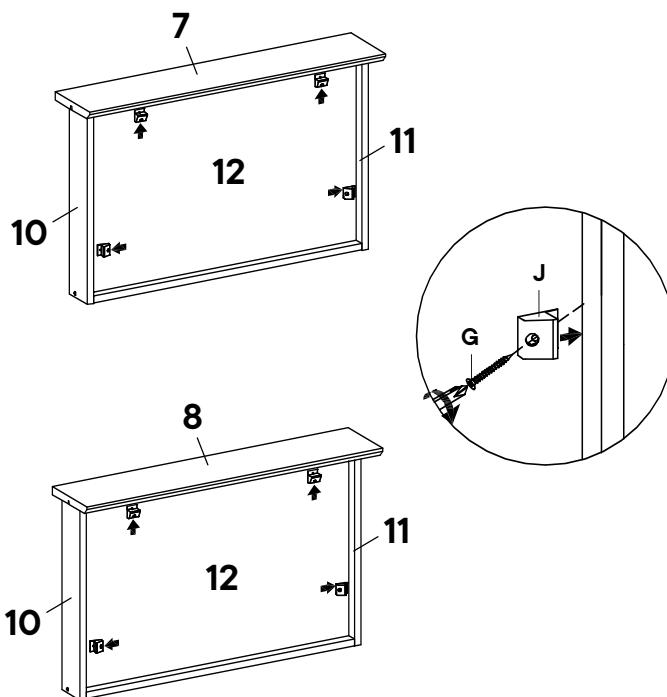

## Step 14

### HARDWARE

<b>F</b>	Screw M6 x 13 mm	x8
<b>M</b>	Drawer Rail	x2

### COMPONENTS

<b>7</b>	Left Front Drawer	x1
<b>8</b>	Right Front Drawer	x1
<b>10</b>	Left Drawer	x2
<b>11</b>	Right Drawer	x2

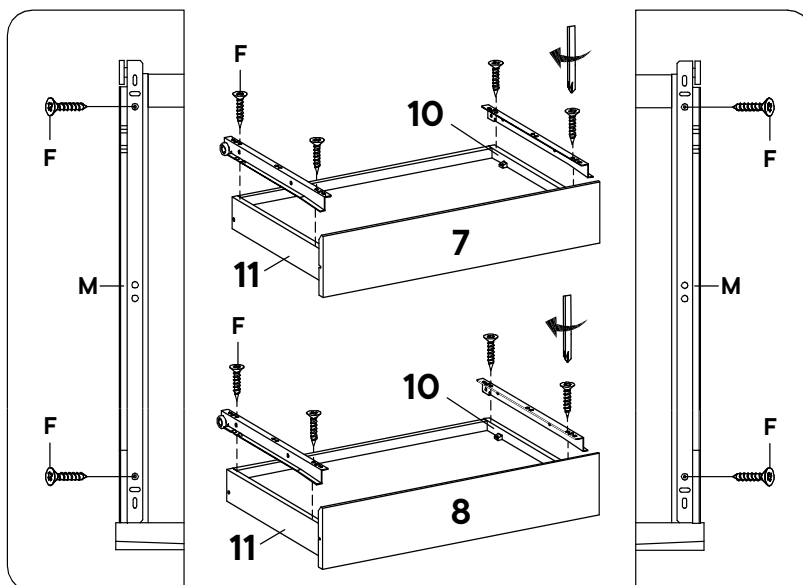

## Step 15

### COMPONENTS

- |   |                    |    |
|---|--------------------|----|
| 7 | Left Front Drawer  | x1 |
| 8 | Right Front Drawer | x1 |

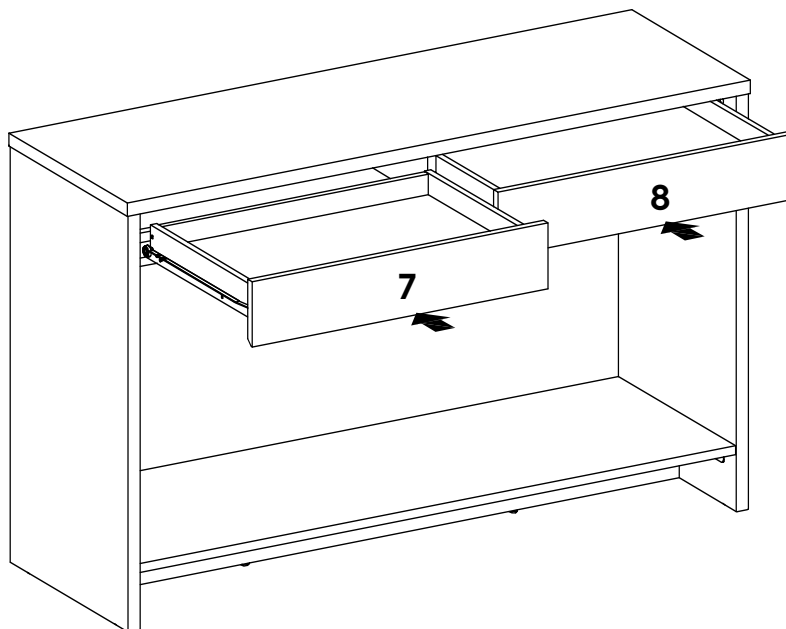

# Great job!

Console Table assembly is complete.



## CARING FOR YOUR ITEM

Indoor use only.

Not contract grade.

Clean using a non-abrasive cloth and a mild cleaner.

Never use harsh chemicals, as they could damage the finish or integrity of the item.

## CONNECT WITH US!



Tag us @modway\_furniture and #modway for a chance to be featured.

