

ASSEMBLY INSTRUCTIONS-PLEASE KEEP FOR FUTURE REFERENCE



Important-please read these instructions fully before starting assembly

Safety and Care Advice

Important – Please read these instructions fully before starting assembly

- Check you have all the components and tools listed on pages 2 and 3.
- Remove all fittings from the plastic bags and separate them into their groups.
- Make sure you have enough space to layout the parts before starting.
- Keep children and animals away from the work area, small parts could choke if swallowed.

- Do not stand or put weight on the product during assembly, this could cause damage.
- Assemble the item as close to its final position (in the same room) as possible.
- Assemble on a soft level
- Parts of the assembly will be easier with 2 people.

surface to avoid damaging the unit or your floor.



- We do not recommend the use of power drill/drivers **for inserting screws**, as this could damage the unit. Only use hand screwdrivers.
- Dispose of all packaging carefully and responsibly.

Care and maintenance

- Only clean using a damp cloth and mild detergent, do not use bleach or abrasive cleaners.
- From time to time check that there are no loose screws on this unit.

- Do not stand on the chair.
- Do not use this chair as step ladder.

This product should not be discarded with household

waste. Take to your local authority waste disposal centre.

Handy Hints

- Assemble all parts and bolts loosely during assembly, only once the product is complete should you fully tighten the bolts.
- Regularly check and ensure that all bolts and fittings are tightened properly.

Components - Parts



1. Back x 1



2. Seat x 1

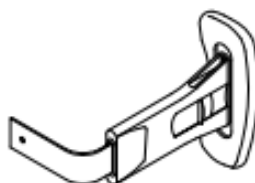

3. Armrest x 2

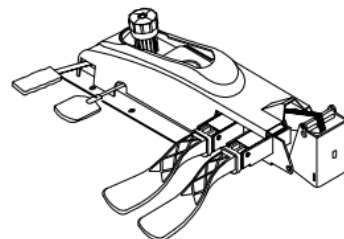

4. Mechanism x 1



5. Gas lift x 1



6. Gas lift cover x 1



7. Backstrap x 1

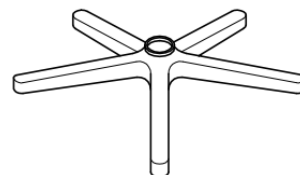

8. Base x 1

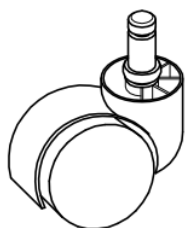

9. Castors x 5

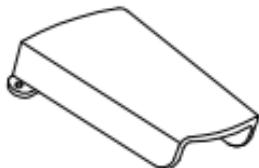

10. Backstrap cover x 1



11. M5 Allen key



12. M6 Allen key

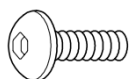

M8 10mm

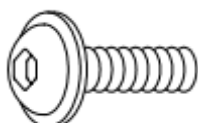

M10 23mm

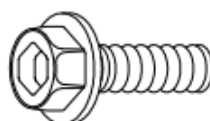

M6 25mm

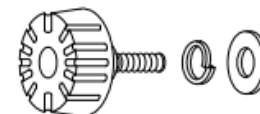

16. Arm Fittings x 2

13. Back screw x 1

14. Backstrap screw x 1

15. Mech screw x 6

Note: The quantities below are the correct amount to complete the assembly. In some cases more fittings may be supplied than are required. Components may look different than the pictures.

Assembly Instructions

STEP 1

Fitting castors

Insert the castors (9) into the at the bottom of the five-star base (8).

Fitting Gas and gas lift cover

Insert gas lift (5) into five-star base (8).
Push the gas lift cover (6) onto the gas lift (5)

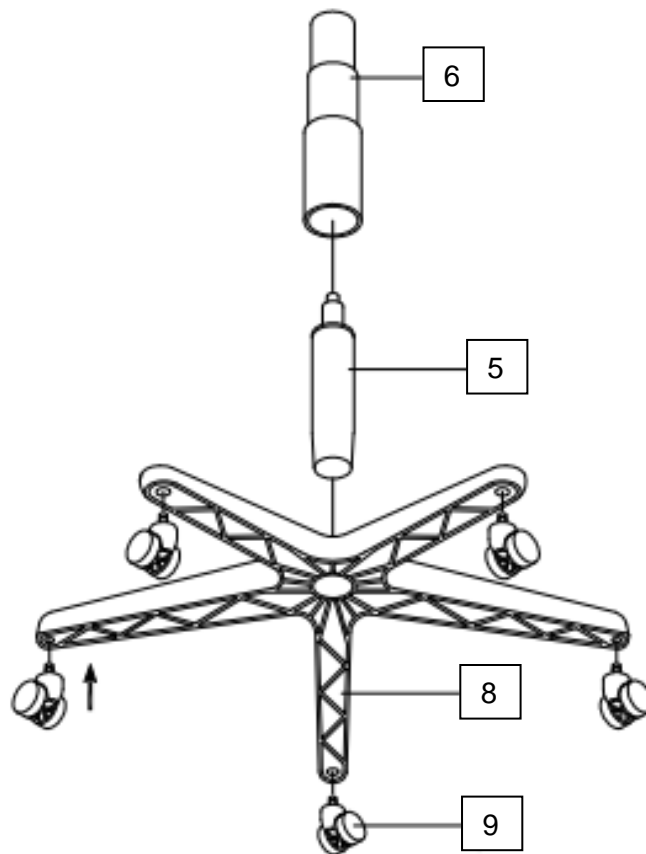

STEP 2

Fitting the backstrap

Insert the backstrap (7) into the back (1).

OUTWARD on the back of the backstrap needs to be facing away from the front of the back.

Fix the back (1) to the backstrap (7) using the back screw (13) and the 5mm allen key (11)

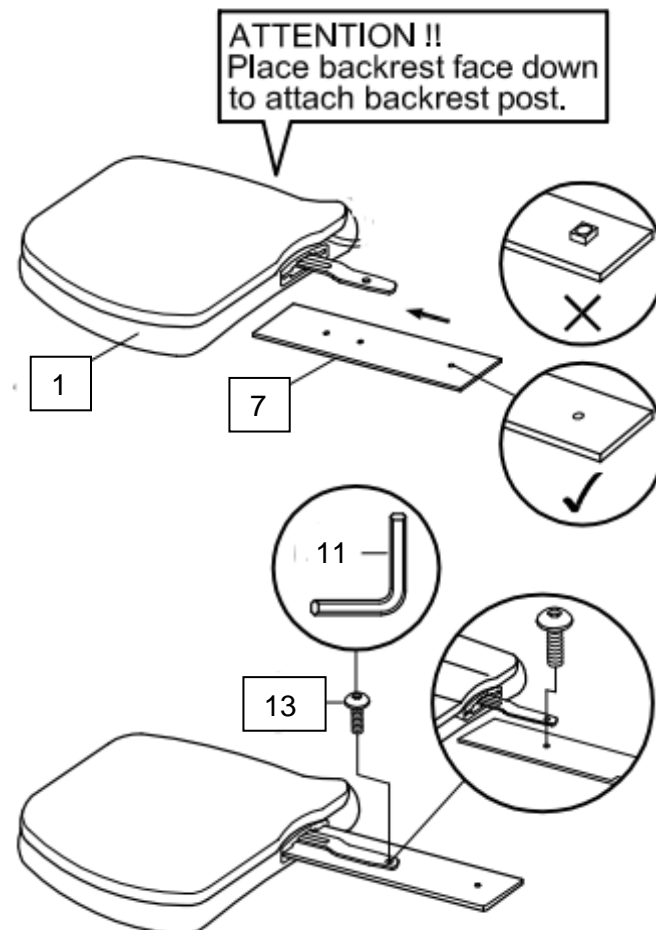

Assembly Instructions

STEP 3

Fitting the Mechanism

Attach the mechanism (4) to the seat (2) using mech screws (15) and the M5 allen key (11)

Torsion knob must be facing to the front of the seat

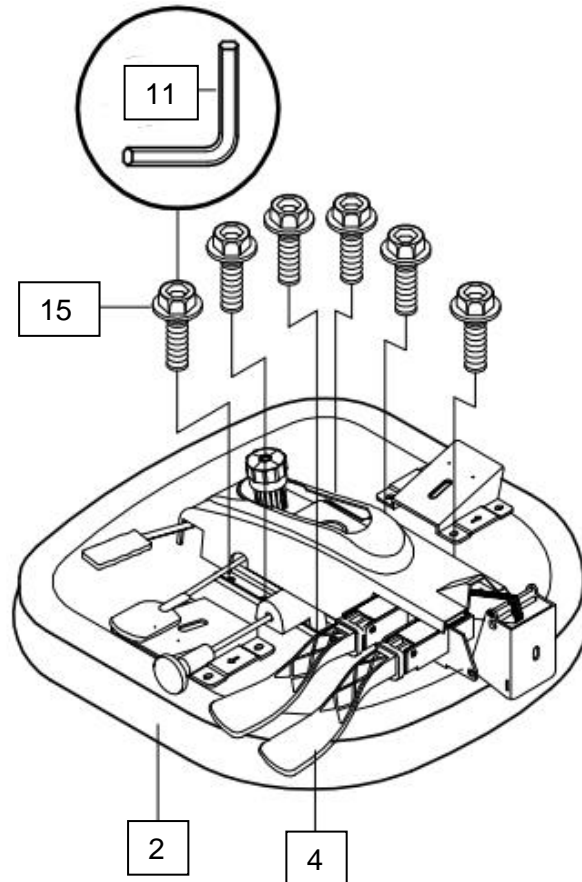

STEP 4

Fitting the arms

Insert arm (3) into the bracket attached to the seat (2) using the handwheels (16).

Attach left and right arm in the same way.

Penny and spring washers must be used

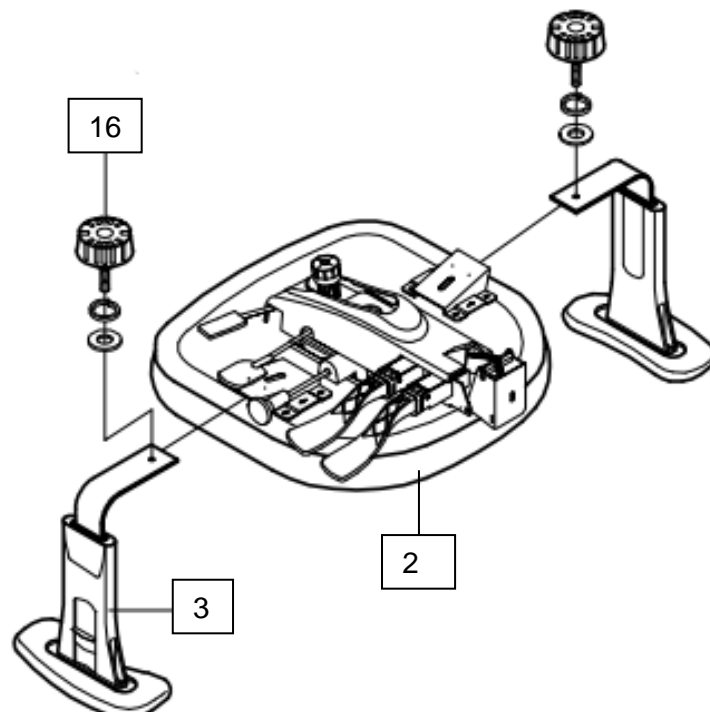

Assembly Instructions

STEP 5

Fitting the back to the seat

Attach the backstrap (7) to the Mechanism (5) using the backstrap screw (14) and the M6 allen key (12)

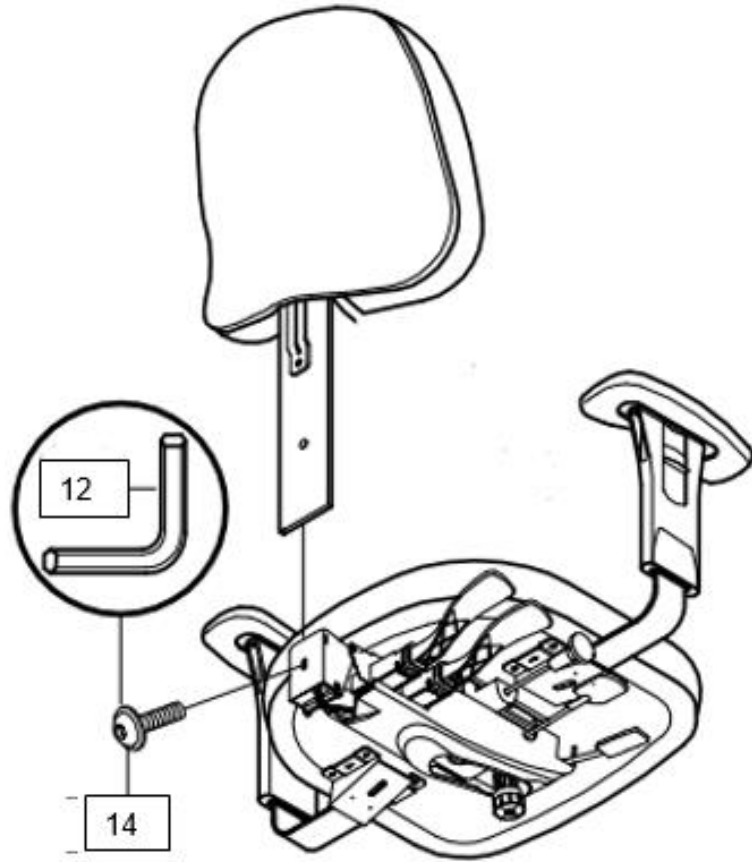

STEP 6

Fitting the backstrap cover

Attach the backstrap cover (10) to the back using the hooks on the backstrap cover (10)

The back plastic may need to be pulled out slightly to make room for the hooks

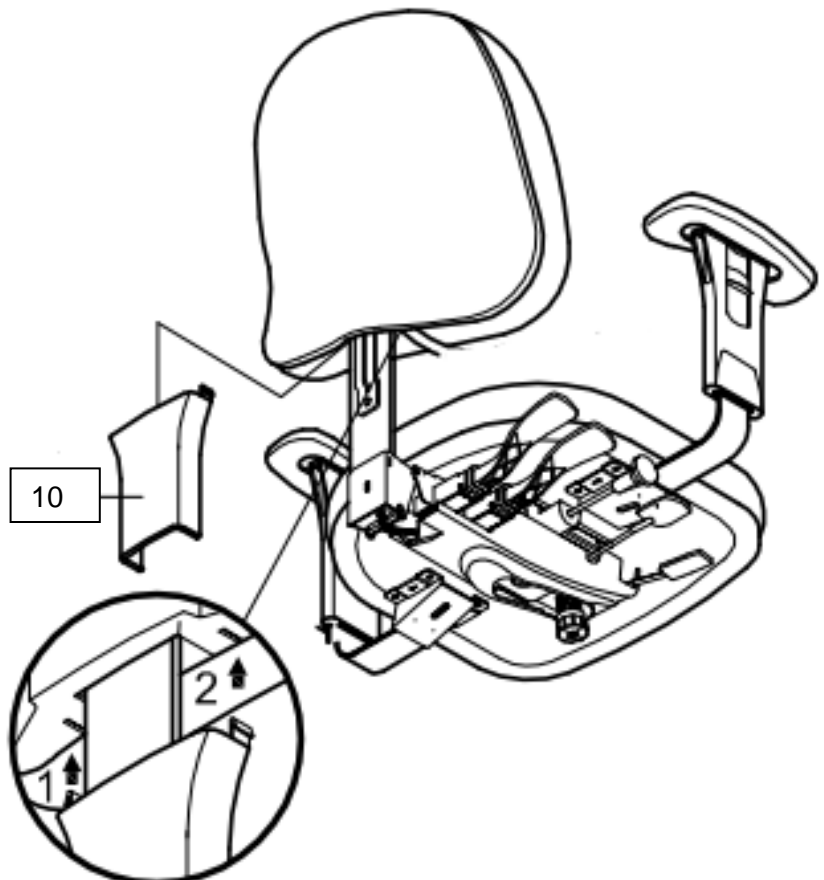

Assembly Instructions

STEP 7

Fitting the chair body to the gas lift

Attach the mechanism (4) to the gas lift (5)

We recommend that two people are used for this action

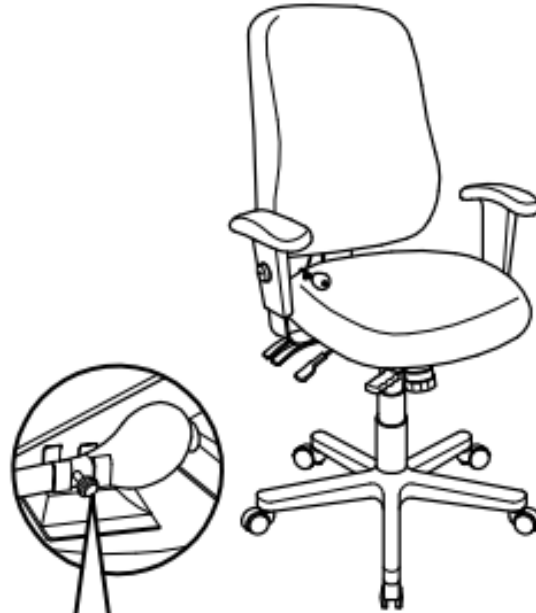

For lumbar support, inflate back airbag by pumping air through the air pump. To discharge air, turn releasing knob of the air pump counterclockwise.

MECHANISM INSTRUCTIONS

- (A) Back angle adjustment lever.
- (B) Combination seat / back angle adjustment lever with infinite lock.
- (C) Seat height adjustment lever.
- (D) Forward tilt lever
 - *While seated, lift lever B and then lean back to activate locking mechanism;
 - *Pull lever D backward to allow seat to tilt forward-or-push lever D forward to straighten seat;
 - *To lock in desired position, push lever B downward.
- (E) Tension control knob-Turn clockwise to increase tension and counter-clockwise to decrease tension.
- (F) Sliding seat:
 - Seat depth adjusts for different user leg lengths.

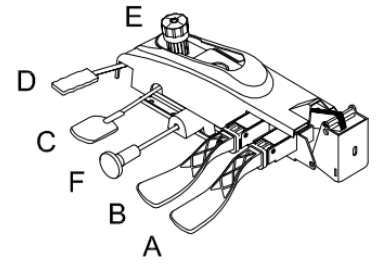

Handy Hints

- Assemble all parts and bolts loosely during assembly, only once the product is complete should you fully tighten the bolts .
- Regularly check and ensure that all bolts and fittings are tightened properly.