

Instruction Manual

Note:

- This spin mop is not a toy — keep away from children.
 - To tighten the components, attach them together turning in a clockwise direction.
 - To loosen, turn the components counter-clockwise.
 - Assure that all mop-head fibers are within the spin bucket when ringing out water. Any loose pieces of material may splatter unwanted contents.
 - This manual shows the purple model. Other colors and material are available.
-
- Assure that all parts are present prior to assembly.

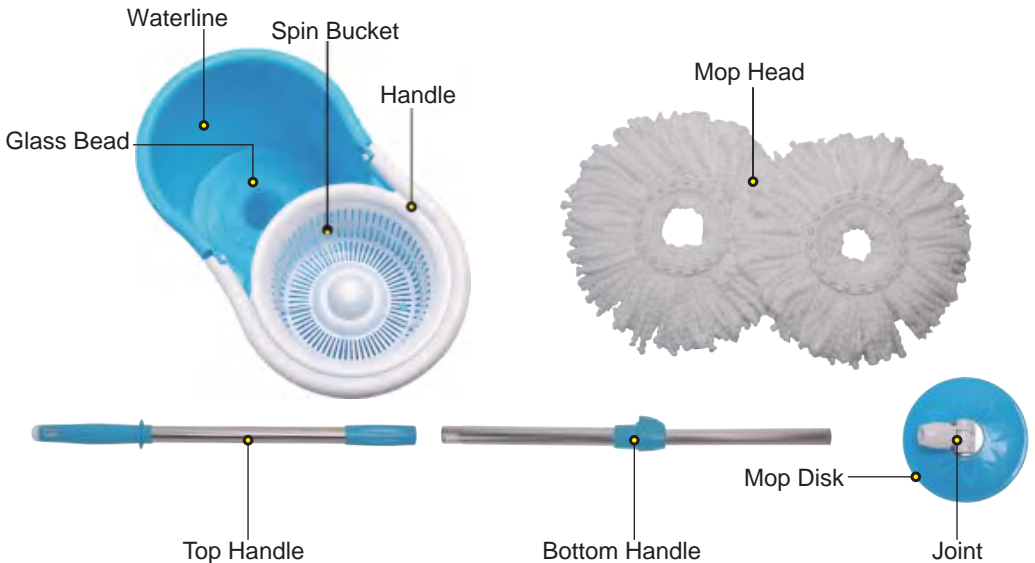

The length of the bottom handle could be adjusted by turning to the off position with the handle partially extended.

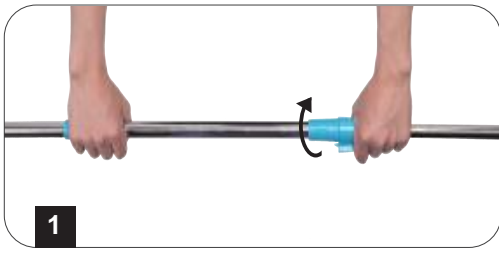

Fasten top and bottom handles with a clockwise motion until they are secure.

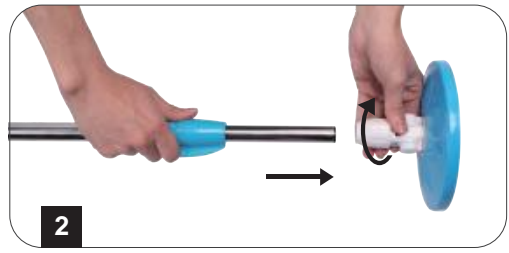

Loosen the joint about half way by turning it counterclockwise. Push the bottom handle into the joint.



Attach the joint of the mop disk and the handle in a clockwise motion.



Place the mop disk directly over the mop head and attach by applying pressure with a foot until it clicks into place.

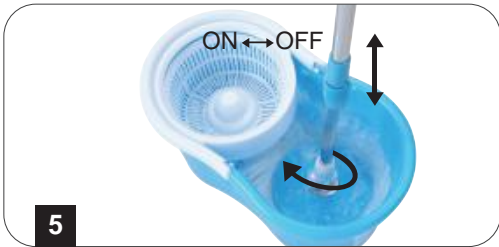

Add water to the mop bucket, the water level must be higher than waterline and flooded glass bead, but lower than spin bucket, then turn the handle to the "on" position. Wet the mop by placing it on to the agitator (with the handle in a vertical position) and using an up and down motion.



Spin excess water from the mop head by placing it into the spin bucket (with the handle in a vertical position) using an up and down motion.



To begin mopping, hold the handle in a vertical position and turn it to "off." The angle of the handle can be adjusted by stepping on the mop disk and tilting the handle to the desired position.



To remove the mop head for cleaning or replacement, step on the fibers and tilt the handle to the side.