

End Table

Package Content

Wood slab x 1 Metal leg x 3 Screw x 12
Rubber feet x 3

Tools Needed

Screwdriver

INSTRUCTION

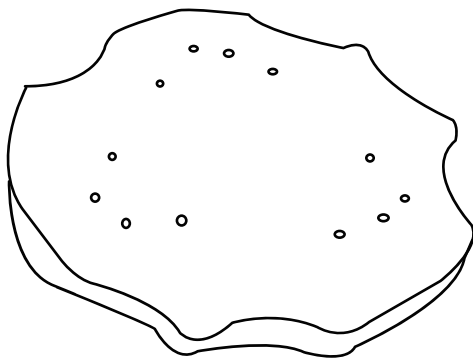

1.

Turn your table top upside-down on a scratch free surface.

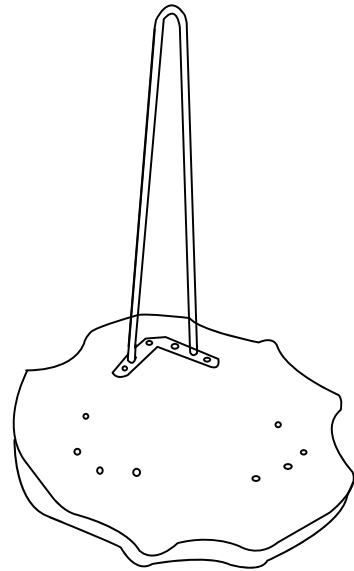

2.

Line up one leg at a time to the holes in the mounting plate or marked lines.

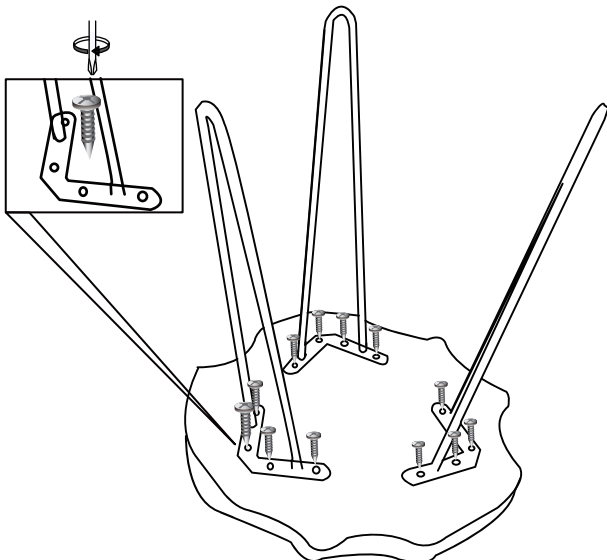

3.

Attach the legs with the screws provided.

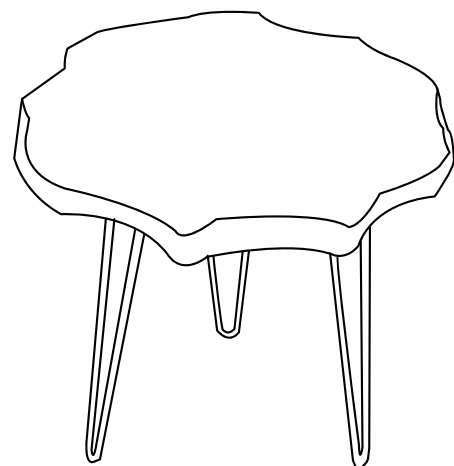

4.

Flip your completed table over and enjoy!

DISCLAIMER: Install shelf and shelving units according to instructions provided. Our company and its related companies are not responsible for injury or damage resulting from incorrect installation or use. Our products are for use only as shelves units and are not intended for any other purposes.

* The emission of the chemicals listed in Prop 65 in this product has been tested to meet the standard of CARB ATCM.