

# ASSEMBLY INSTRUCTIONS

---

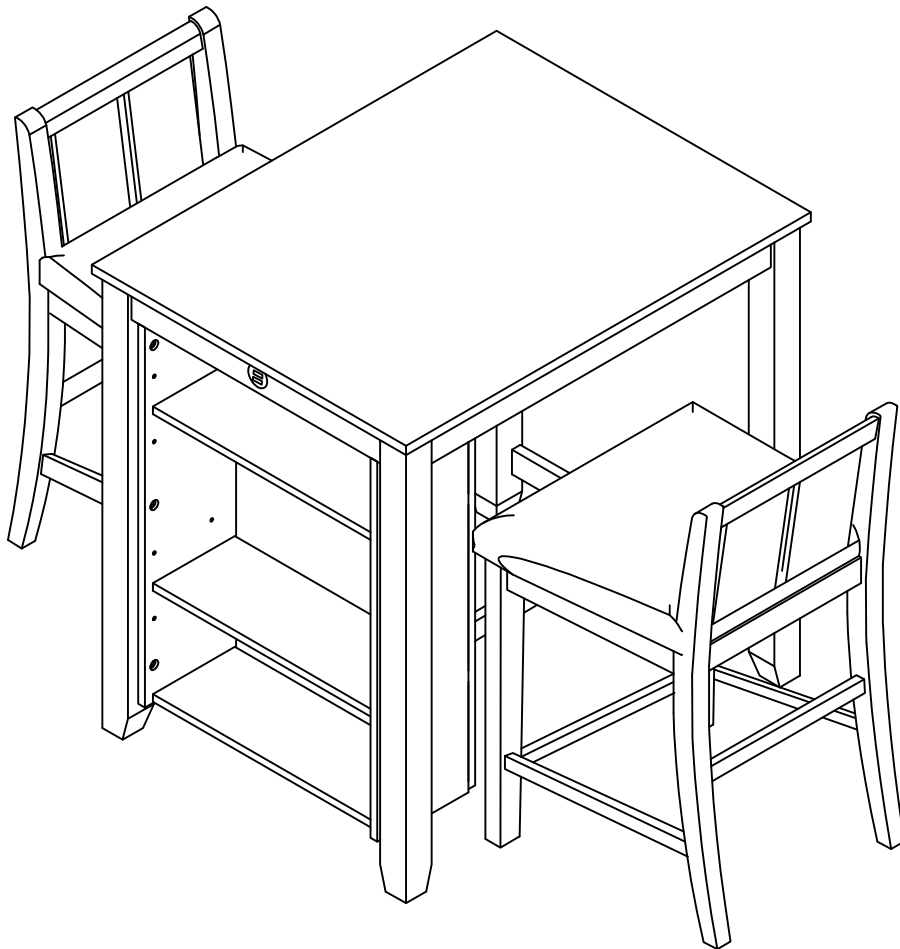

## TOOLS REQUIRED



Screwdriver  
( Not included)

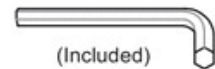

(Included)  
Allen Wrench

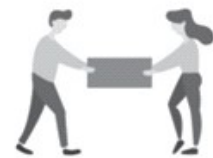

2 - People

## ASSEMBLY RATING



EASY —————> DIFFICULT

The Assembly Rating is a 5-point system showing the level of effort needed to assemble a specific product.

---

# TABLE



- Please keep instructions for future reference.
- Check the quantity and irregularity of parts and hardware before you start.

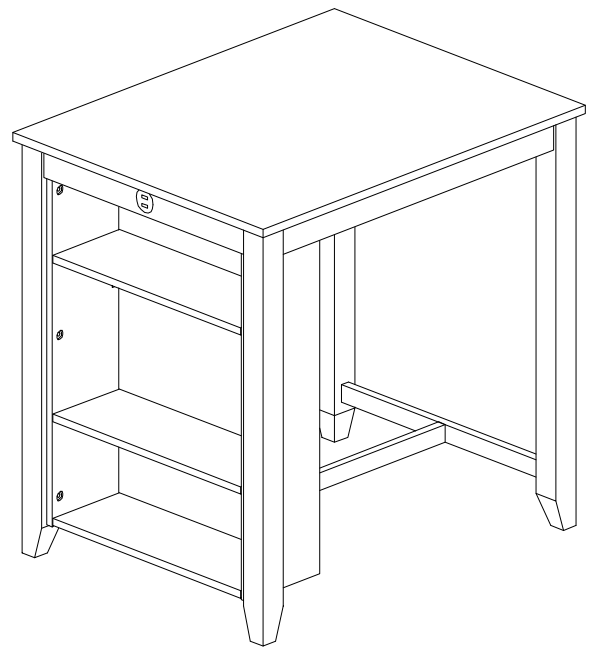

## PARTS

#1

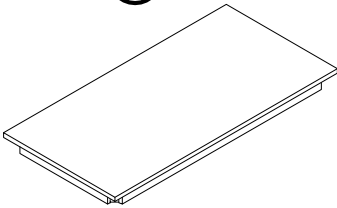

**Table Top**  
1pc.

#2

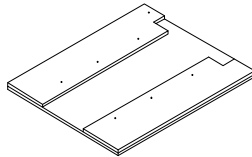

**Cabinet Frame**  
1pc.

#3

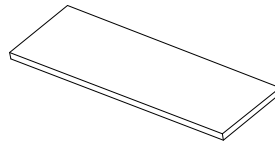

**Shelf**  
3pcs.

#4

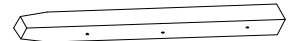

**Left Front Leg**  
1pc.

#5

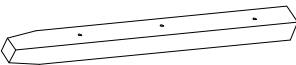

**Right Front Leg**  
1pc.

#6

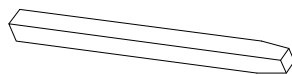

**Left Back Leg**  
1pc.

#7

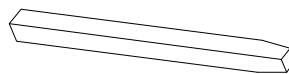

**Right Back Leg**  
1pc.

#8



**Center Cross Bar**  
1pc.

#9

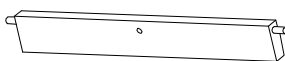

**Side Cross Bar**  
1pc.

## HARDWARE

#A

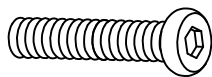

Bolt Ø1/4" x 1-1/4"  
8pcs.

#B

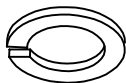

Lock Washer Ø1/4"  
8pcs.

#C



Flat Washer Ø1/4"x16mm  
8pcs.

#D

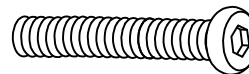

Bolt Ø5/16" x 2-3/8"  
8pcs.

#E

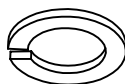

Lock Washer Ø5/16"  
8pcs.

#F

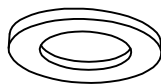

Flat Washer Ø5/16"x19mm  
8pcs.

#G

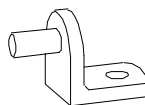

Shelf Pin Ø6  
12pcs.

#H

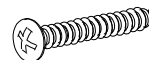

Wood Screw #6x1/2"  
12pcs.

#I

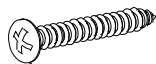

Wood Screw #8x1-1/2"  
4pcs.

#J

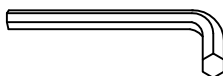

Allen Wrench 4mm  
1pc.

# ASSEMBLY INSTRUCTIONS

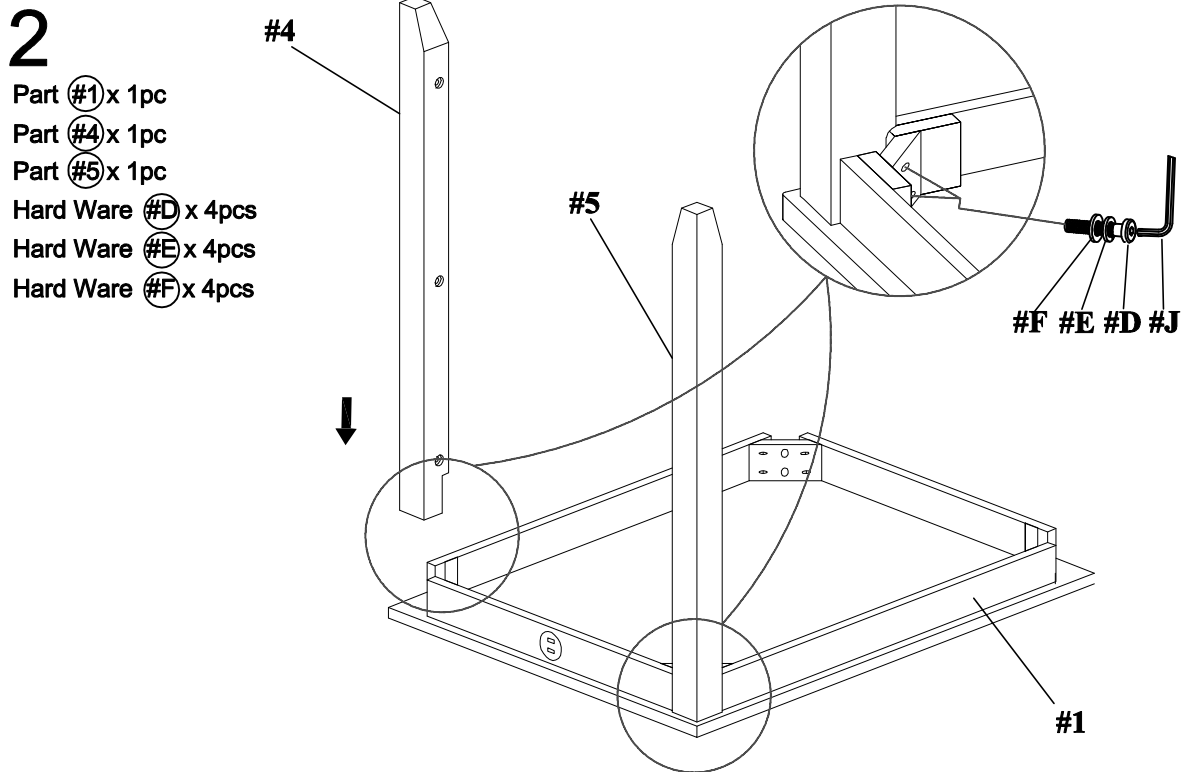
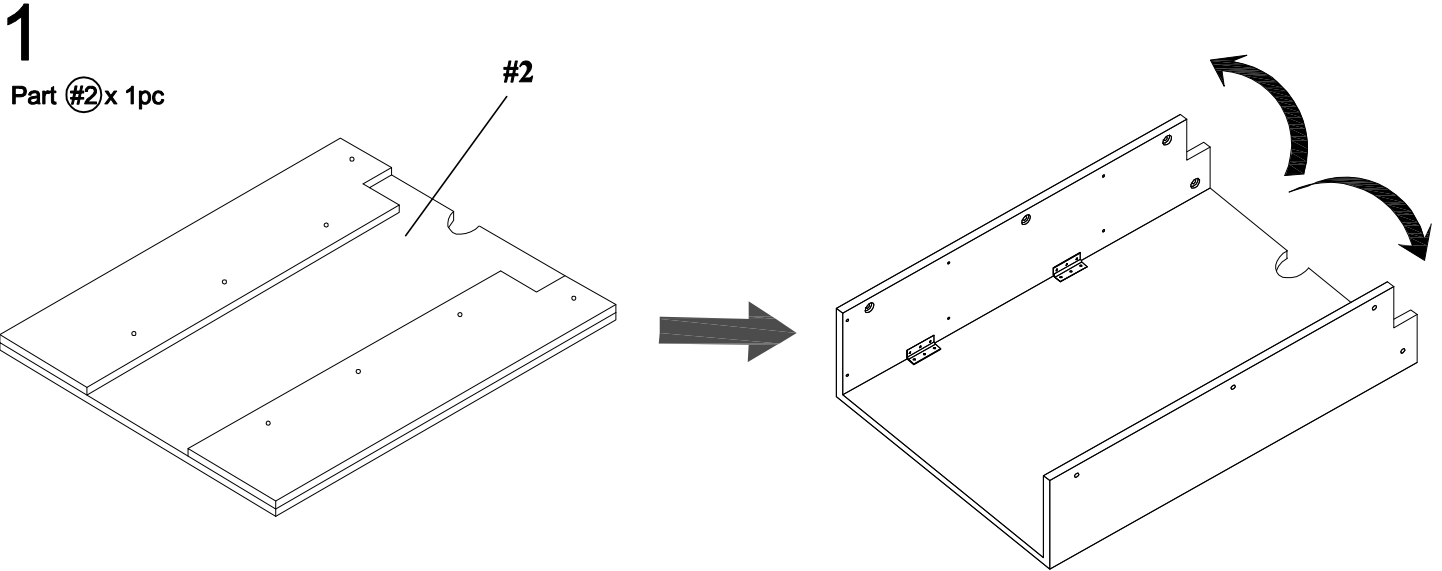

# ASSEMBLY INSTRUCTIONS

## 3

Hard Ware **#A** x 8pcs

Hard Ware **#B** x 8pcs

Hard Ware **#C** x 8pcs

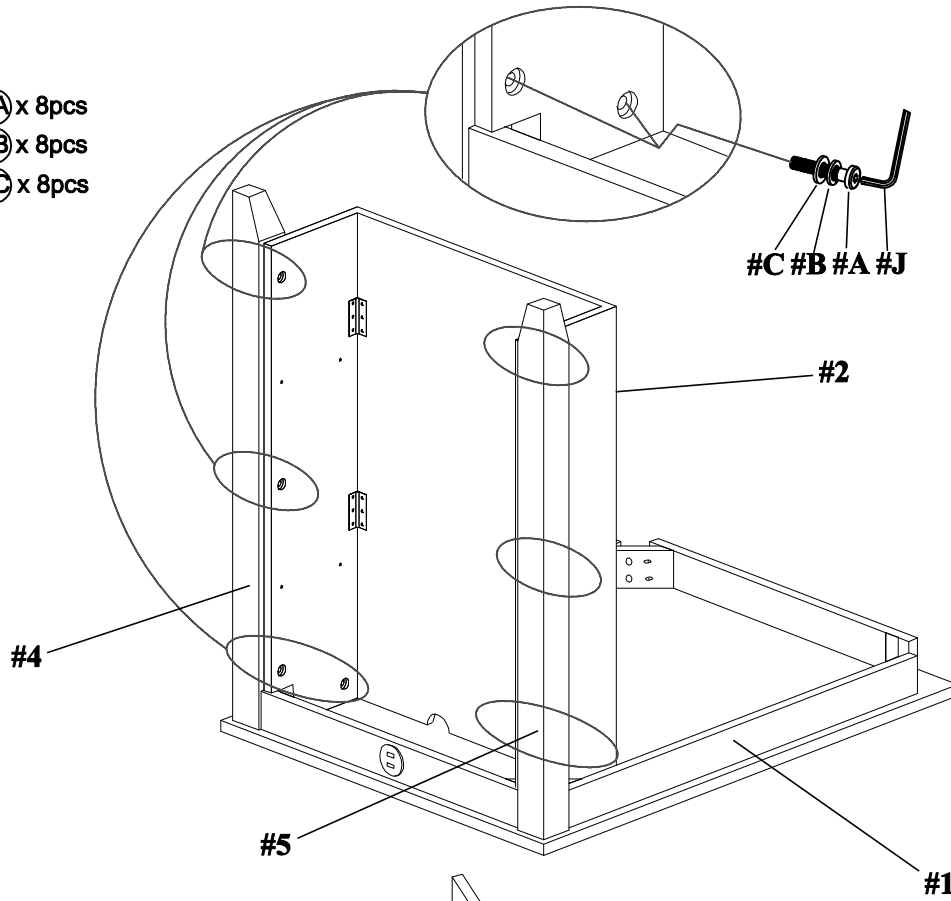

## 4

Part **#3** x 3pcs

Hard Ware **#G** x 12pcs

Hard Ware **#H** x 12pcs

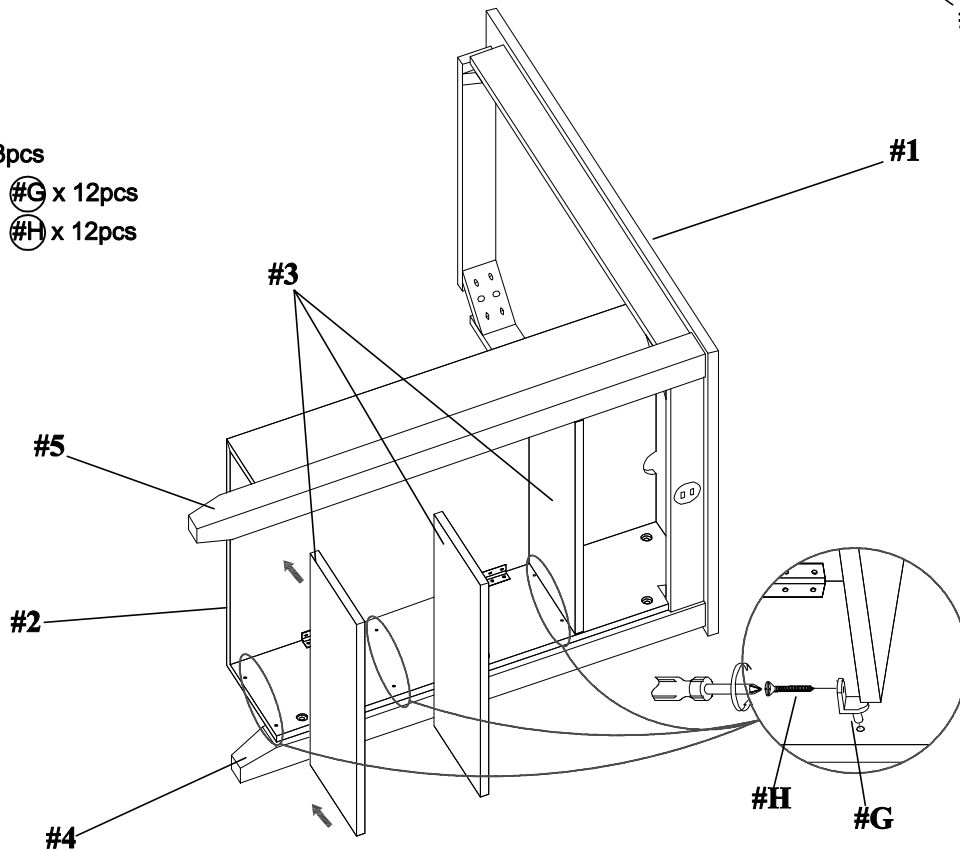

# ASSEMBLY INSTRUCTIONS

## 5

Part #6 x 1pc

Part #7 x 1pc

Part #8 x 1pc

Part #9 x 1pc

Hard Ware #D x 4pcs

Hard Ware #E x 4pcs

Hard Ware #F x 4pcs

Hard Ware #I x 4pcs

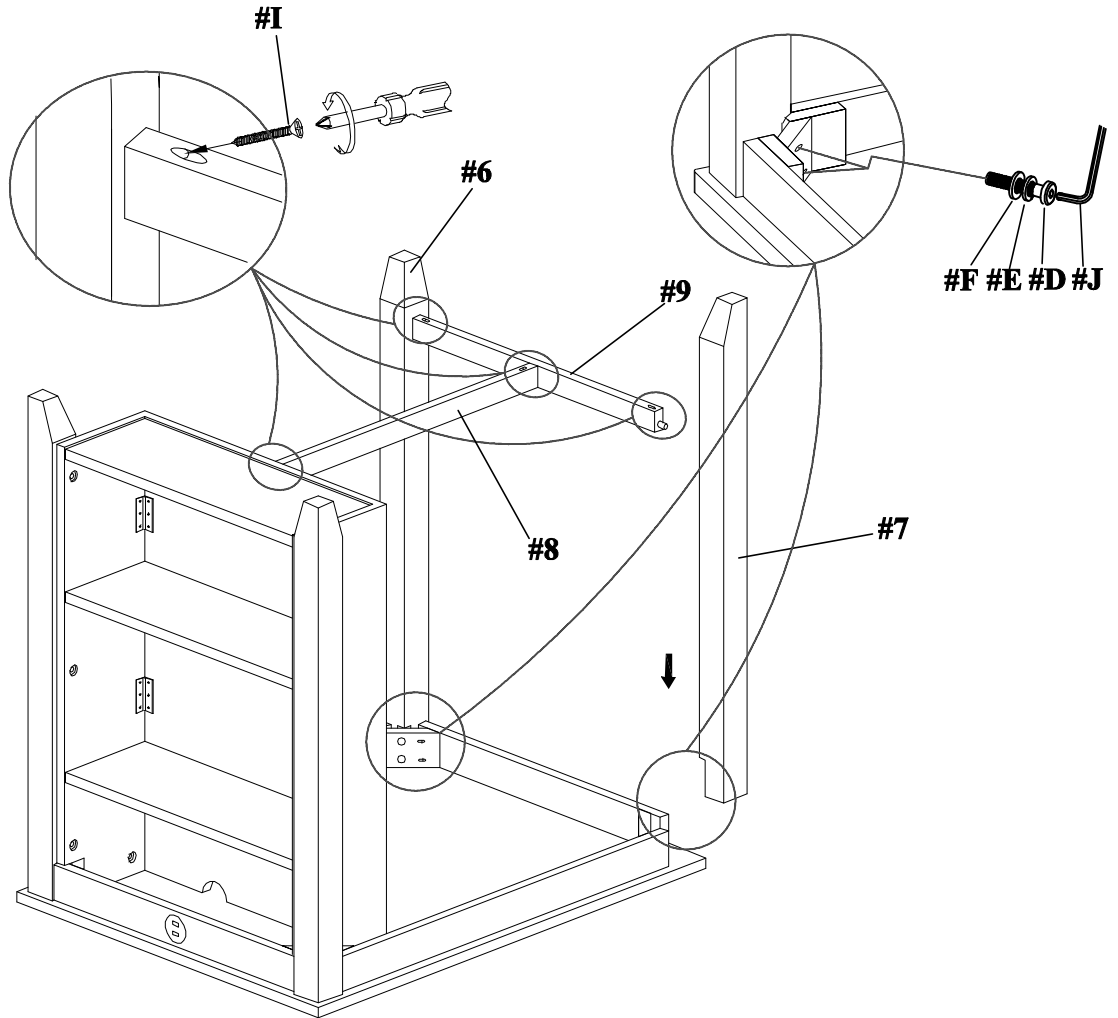

## 6

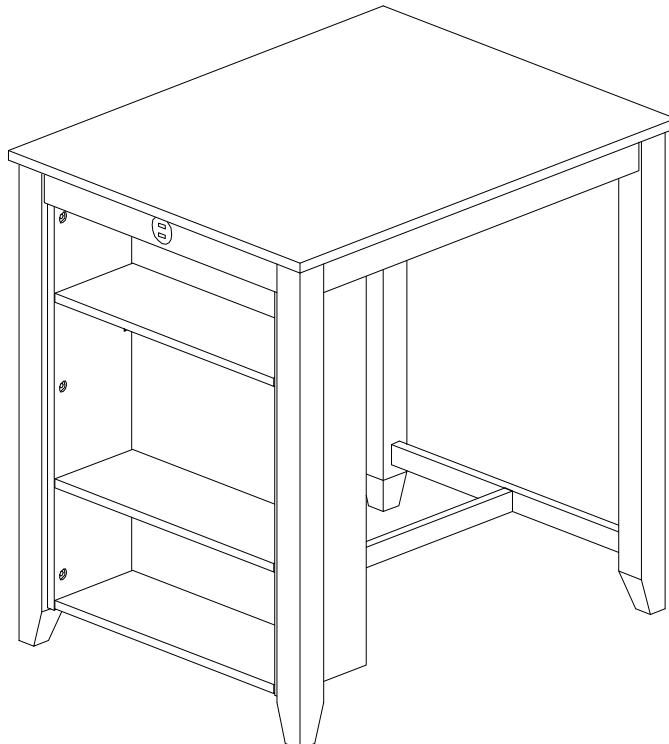

### ASSEMBLY COMPLETED



Please ensure the furniture rests on an even and flat surface. If the product wobbles or feels loose, double-check all bolts and/or screws are properly tightened and secured.



#### Keep this handy!

Please retain this instruction manual and any order-related information for future reference.



#### Lift, don't drag!

To avoid damage to product please always LIFT the product when transporting or adjusting the placement.

This product is intended for RESIDENTIAL USE ONLY and not for commercial use.

# CHAIR



- Please keep instructions for future reference.
- Check the quantity and irregularity of parts and hardware before you start.

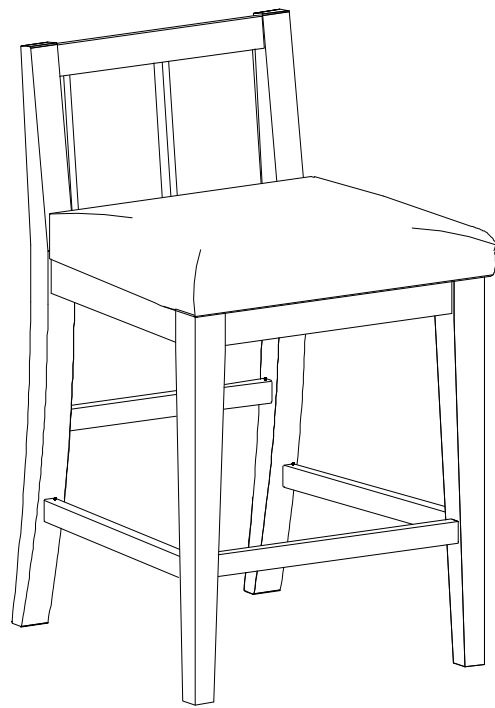

## PARTS

#1

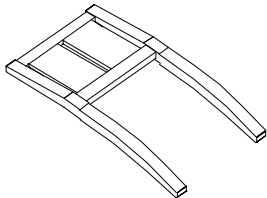

**Chair Back**  
1pc x 2.

#2

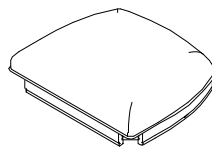

**Seat Frame With Cushion**  
1pc x 2.

#3



**Left Leg**  
1pc x 2.

#4



**Right Leg**  
1pc x 2.

#5

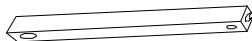

**Left Stretcher**  
1pc x 2.

#6



**Right Stretcher**  
1pc x 2.

#7

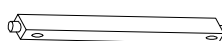

**Front Stretcher**  
1pc x 2.

## HARDWARE

#A

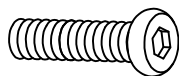

Bolt Ø1/4" x 1-1/2"  
2pcs x 2.

#B

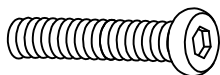

Bolt Ø1/4" x 2-3/8"  
4pcs x 2.

#C

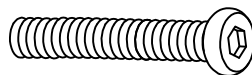

Bolt Ø1/4" x 3-1/4"  
4pcs x 2.

#D

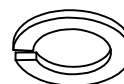

Lock Washer Ø5/16"  
10pcs x 2.

#E



Flat Washer Ø1/4"x19mm  
10pcs x 2.

#F



Wood Screw #8x1-1/2"  
6pcs x 2.

#G



Allen Wrench 4mm  
1pc x 2.



# ASSEMBLY INSTRUCTIONS

## 1

- Part #1 x 1pc
- Part #2 x 1pc
- Hard Ware #A x 2pcs
- Hard Ware #C x 4pcs
- Hard Ware #D x 6pcs
- Hard Ware #E x 6pcs

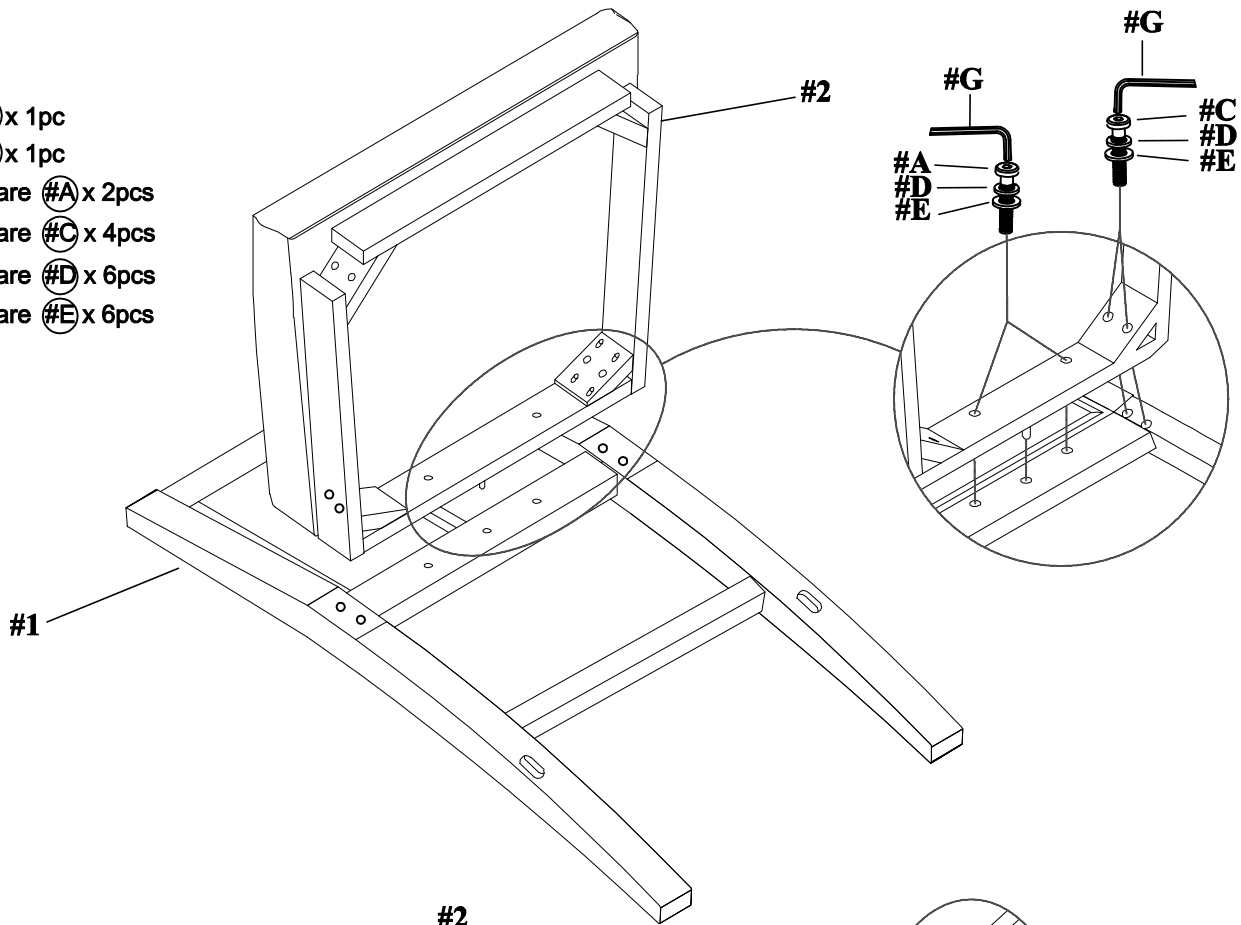

## 2

- Part #3 x 1pc
- Part #4 x 1pc
- Hard Ware #B x 4pcs
- Hard Ware #D x 4pcs
- Hard Ware #E x 4pcs

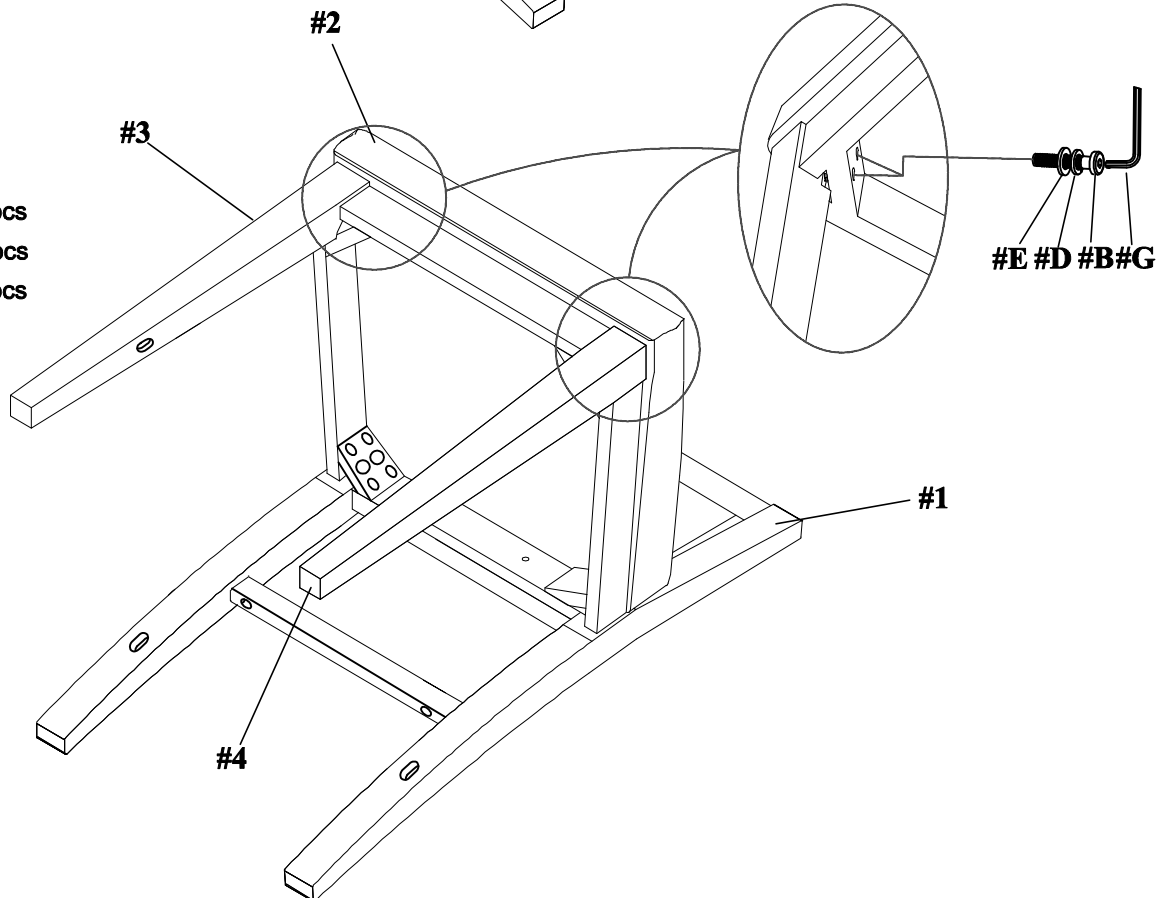

# ASSEMBLY INSTRUCTIONS

## 3

Part #5 x 1pc  
Part #6 x 1pc  
Part #7 x 1pc  
Hard Ware #F x 6pcs

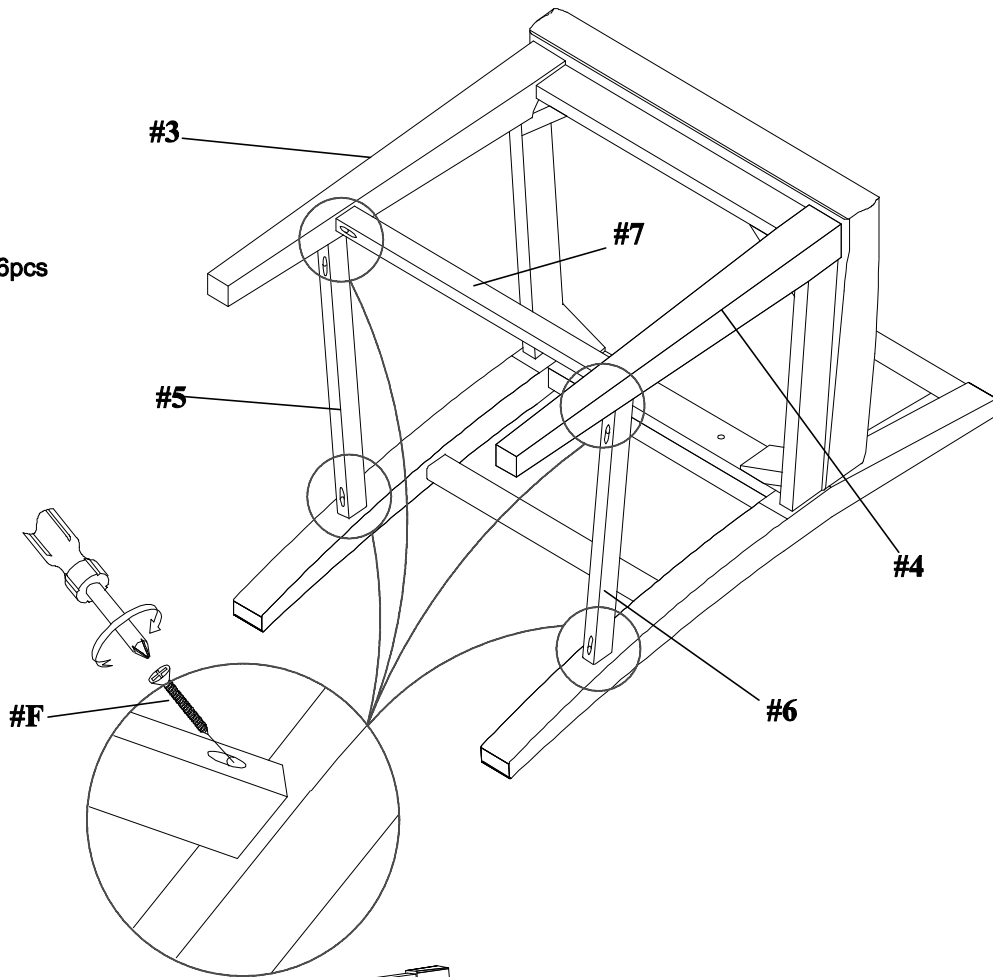

## 4

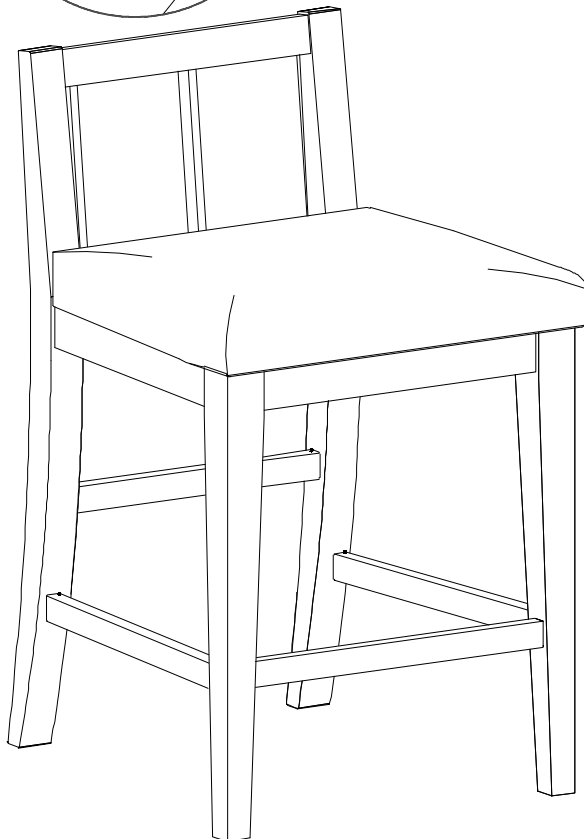

### ASSEMBLY COMPLETED



Please ensure the furniture rests on an even and flat surface. If the product wobbles or feels loose, double-check all bolts and/or screws are properly tightened and secured.



#### Keep this handy!

Please retain this instruction manual and any order-related information for future reference.



#### Lift, don't drag!

To avoid damage to product please always LIFT the product when transporting or adjusting the placement.

This product is intended for RESIDENTIAL USE ONLY and not for commercial use.