

ELKAY[®]

SPECIFICATIONS

Harmony™ Undermount Single Bowl Sink Model ELUH1716

IMPORTANT! ELU / ELUH Update

ELUH models have been redesigned to accommodate 1/2" reveal and no reveal installation options. ELU models should be ordered as ELUH.

GENERAL

Highest quality sink formed of #18 (1.2mm) gauge, type 304 (18-8) nickel bearing stainless steel. Undermount.

DESIGN FEATURES

Bowl Depth: 7-1/2" (191mm).

Finish: Exposed surfaces are hand blended to a Lustrous Highlighted Satin finish.

Underside: Underside of sink is fully protected by heavy duty Sound Guard® undercoating to reduce condensation and dampen sound.

OTHER

Drain Opening: 3-1/2" (89mm).

Note: All Elkay undermount sinks are designed to affix to the underside of any solid surface countertop.

Installation: See illustrated profile below.

Sink complies with ASME A112.19.3/ CSA B45.4



Sinks are listed by IAPMO® as meeting the applicable requirements of the Uniform Plumbing Code®, International Plumbing Code®, and National Plumbing Code of Canada.

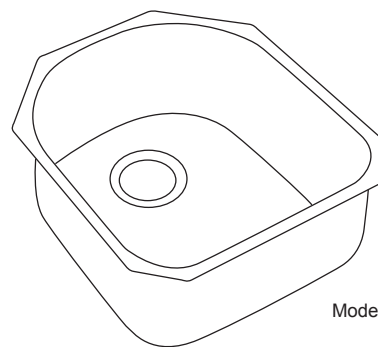

Model ELUH1716



OPTIONAL ACCESSORIES

Bottom Grid: LKWOBG1617SS

Cutting Board: (Reveal mount only) CB1713

Drain: LK99

Mounting Clip: LKUCLIP8

Rinsing Baskets: LKW RB1617SS, LKWERBSS

Utensil Caddy for Rinsing Basket: LKWUCSS

SINK PACKAGE(S)

MODEL	SINK	BOTTOM GRID	QTY	DRAIN	QTY
ELUH1716DBG	ELUH1716	LKWOBG1617SS	1	LK99	1

Installation Profile

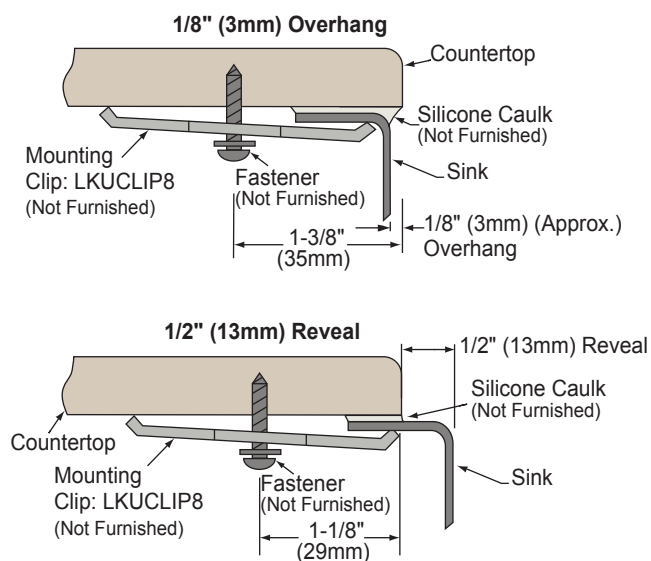

In keeping with our policy of continuing product improvement, Elkay reserves the right to change product specifications without notice. Please visit elkay.com for the most current version of Elkay product specification sheets.

This specification describes an Elkay product with design, quality, and functional benefits to the user. When making a comparison of other producers' offerings, be certain these features are not overlooked.

ELKAY[®]

SPECIFICATIONS

Harmony™ Undermount Single Bowl Sink Model ELUH1716

SINK DIMENSIONS*

Model Number	Overall		Inside Bowl			Cutout in Countertop	Minimum Cabinet Size
	L	W	L	W	D		
ELUH1716	18½" (470mm)	20" (508mm)	16" (406mm)	17½" (445mm)	7½" (191mm)	Template**	24" (610mm)

*Length is left to right. Width is front to back.

**Template #1000001502 is packed with every sink.

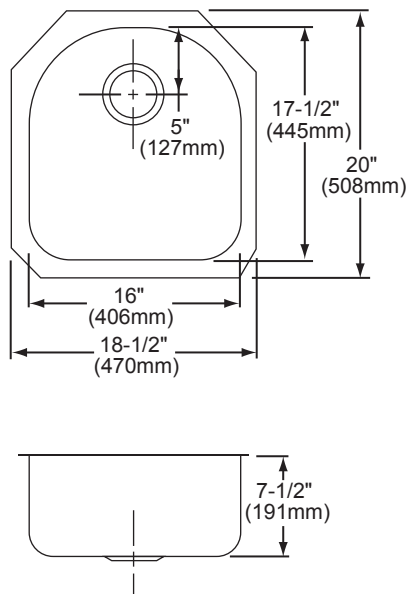

Model ELUH1716 Illustrated

In keeping with our policy of continuing product improvement, Elkay reserves the right to change product specifications without notice. Please visit elkay.com for the most current version of Elkay product specification sheets.

This specification describes an Elkay product with design, quality, and functional benefits to the user. When making a comparison of other producers' offerings, be certain these features are not overlooked.