

# Installation Guide

## Tools Required

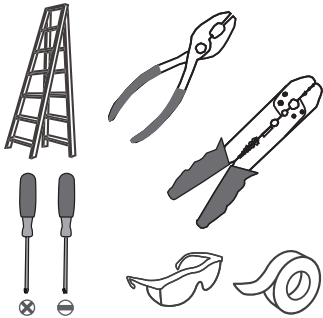

## Light Source

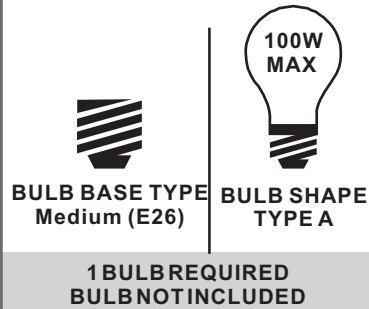

## Warnings and Cautions

Turn off the electricity at the circuit breaker before installation. Consult a licensed electrician if in doubt about installation.

Turn off power to the fixture and allow the bulbs to cool before replacing.

## Package Contents

**Preparation:** Identify and inspect all parts before beginning the installation.

Missing or damaged parts? Contact your original place of purchase.

### PARTS BAG

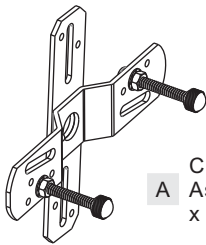

**A** Crossbar Assembly x 1



**B** Alternate Mounting Screw x 2



**C** Outlet Box Screw x 2



**D** Wire Connector x 3



**E** Fixture Loop x 1

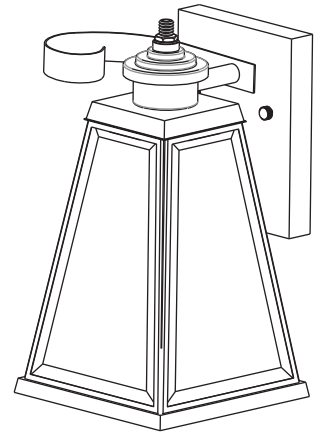

**F** Fixture Body x 1

## Table of Contents

### Fixture Loop & Scroll



STEP 1

### Alternate Mounting Screw



STEP 2

### Crossbar Assembly

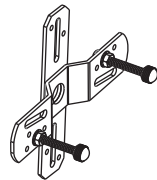

STEP 3

### Wiring

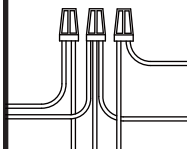

STEP 4

### Fixture Body

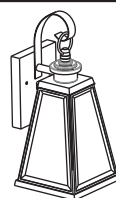

STEP 5

### Bulb



STEP 6

### Caulk

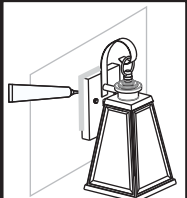

STEP 7

## STEP 1

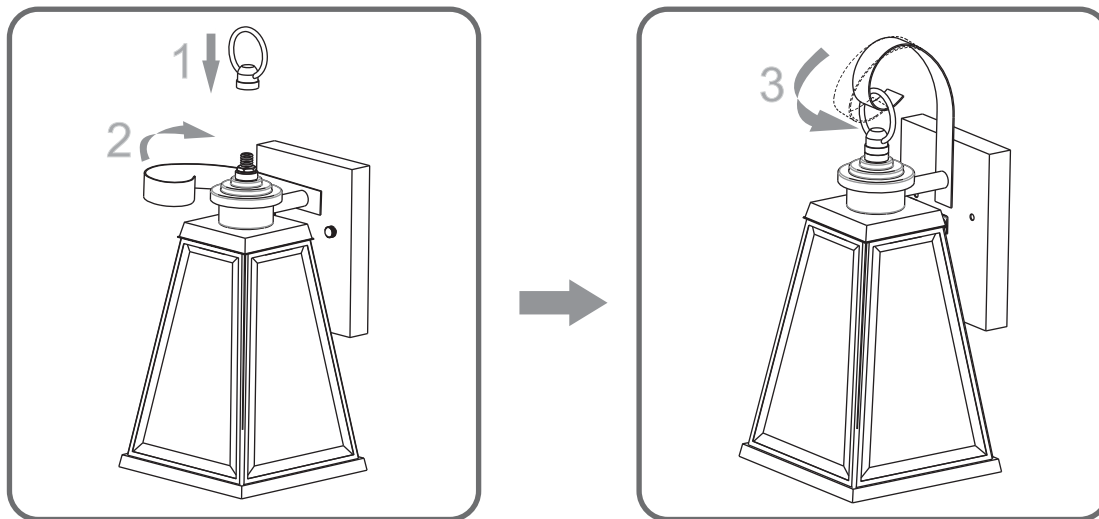

## STEP 2

OPTION 1

Standard  
Mounting  
Screw

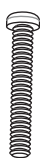

Included  
(Pre-assembled)

OPTION 2

Alternate  
Mounting  
Screw



Included

skip to next page

1

2

3

Steps 1-3 to remove standard mounting screws

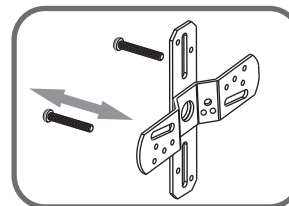
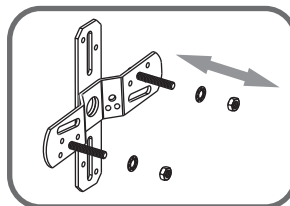
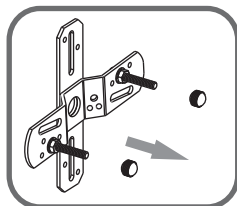

4

Steps 4-6 to reassemble with alternate mounting screws

6

5

## STEP 3

1

2

3

Step 1  
Install crossbar assembly

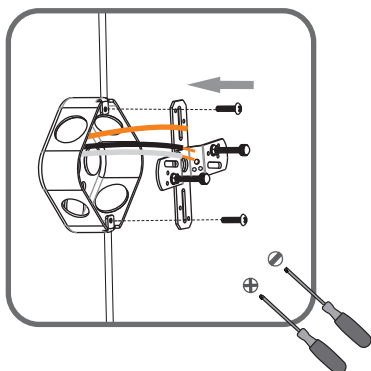

Step 2 - 3  
Test fitting backplate to mounting screws

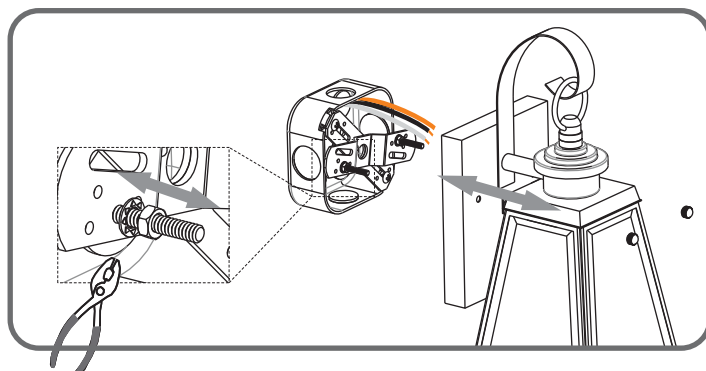
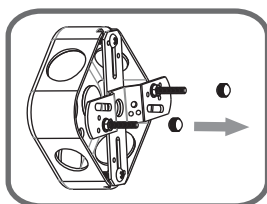

## STEP 4

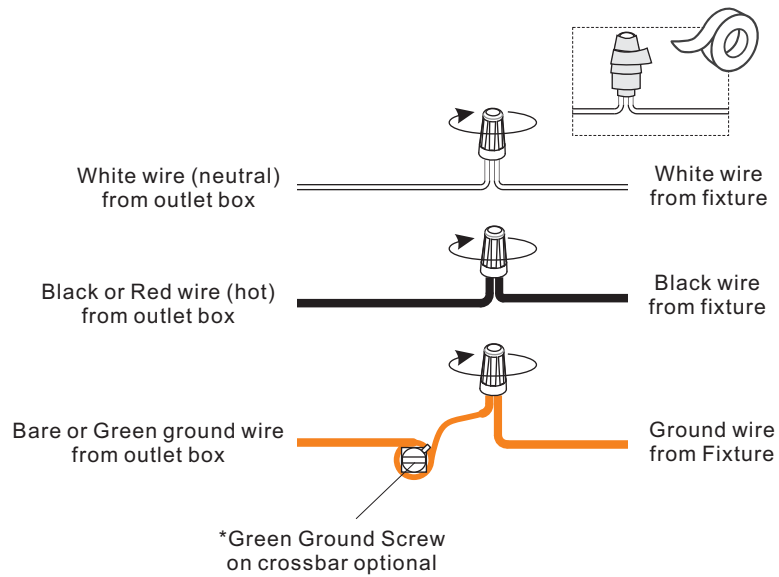

## STEP 5

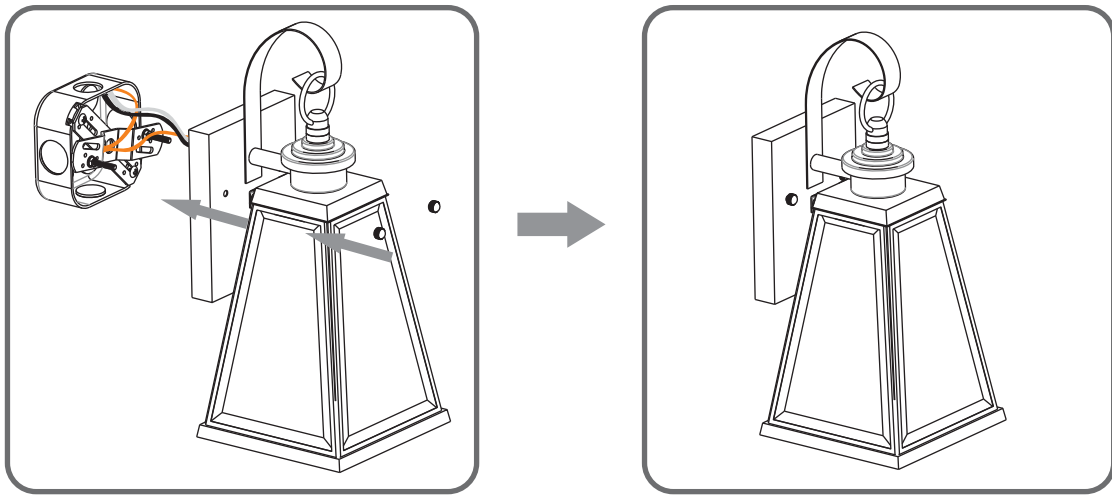

## STEP 6

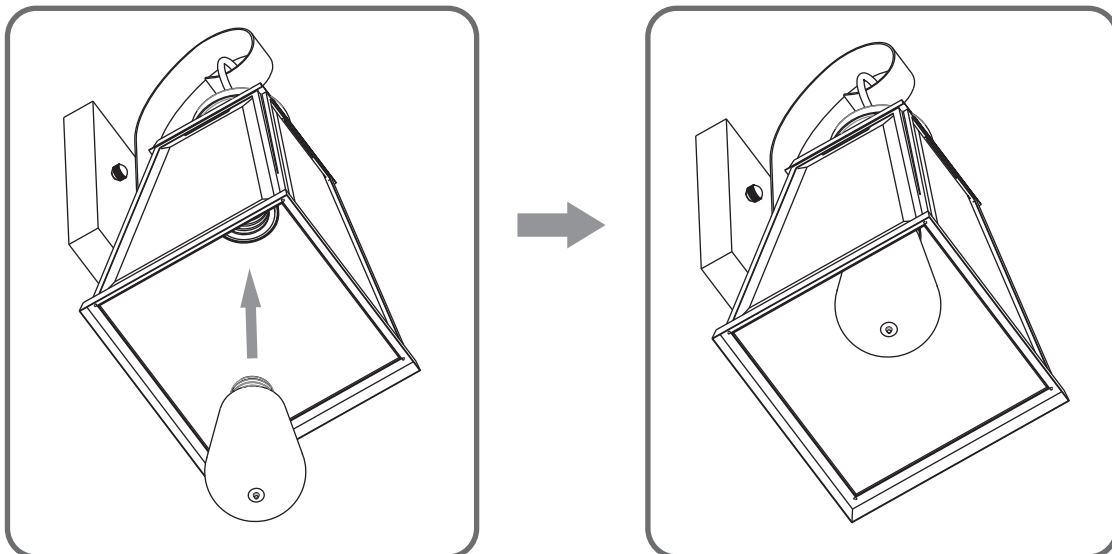

**STEP 7**

