

## Directions

1. Please cut off the electricity supply and press the “off” button before installing this item.
2. This item should be installed by electrician.
3. Except the accessory accessories, can not put any other accessories or Insulation accessories on the lighting
4. Can not install extra bulbs.
5. The lighting will getting hot after turning on, please caution.
6. The lighting should be installed on non conductive surface.

## Installation Directions

Step1 Use plank to find the suitable holes for installing the lighting on the mixed soil ceiling

Step2 Make holes with a hole punch, then put the expansion bolt inside

Step3 install the plank smoothly, then put the flat gasket and spring shim on the expansion bolt, then screw tie.

Step4 connect to the home use Power Cord and earth wire

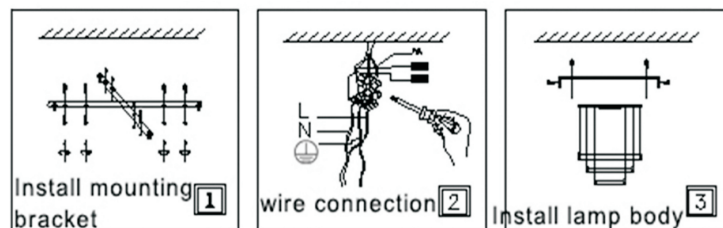

Note:

1. If the ceiling is made of wood, there is no need to make holes with hole punch.
2. This lighting can not installed on plaster ceiling!
3. After installed, should try test some stuff which 4 times heavier than this lighting.

