

Assembly Instructions

NOTE: THIS ITEM NOT RECOMMENDED FOR COMMERCIAL USE
 KEEP THIS DOCUMENT FOR REFERENCE IN CASE PARTS ARE NEEDED
 DO NOT TIGHTEN SCREWS UNTIL COMPLETELY ASSEMBLED!!

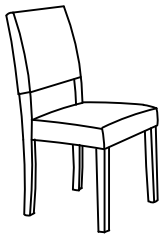

PARTS LIST

NO.	DESCRIPTION	Q' ty
A	Seat Frame	1
B	Chair Back	1
C	Front Leg	2

HARDWARE LIST

NO.	DESCRIPTION	Q' ty
D	Flat washer $\Phi \frac{5}{16} * 22MM$	9
E	Lock washer $\Phi 5/16$ "	9
F	BOLT $\Phi 5/16 * 1-3/4$ " L	1
G	BOLT $\Phi 5/16 * 3-1/2$ " L	4
H	BOLT $\Phi 5/16 * 2$ " L	4
I	Allen Wrench $5/16$ "	1

STEP 2

STEP 1

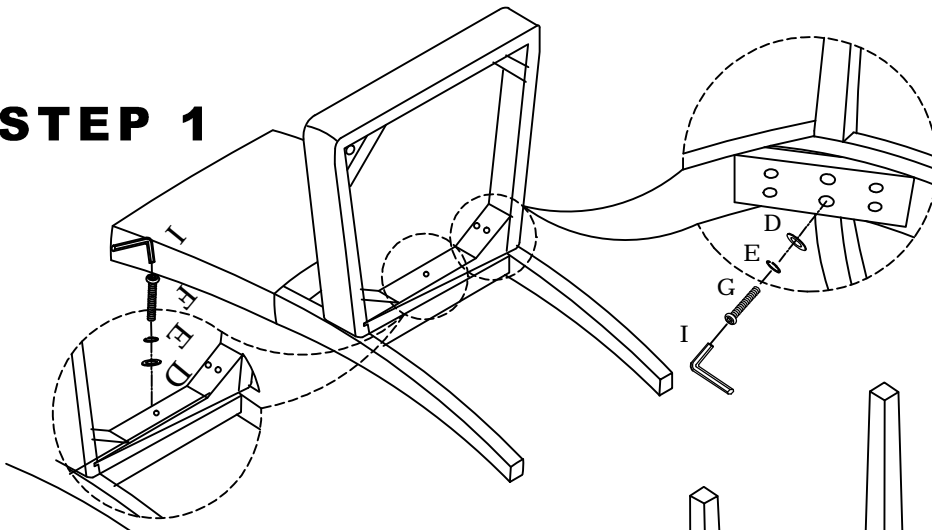

STEP 3

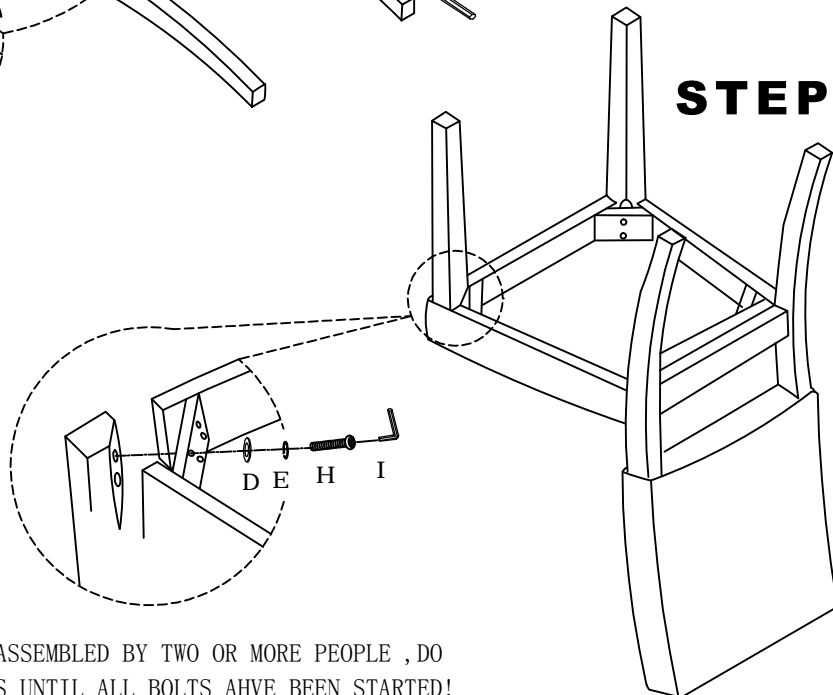

NOTE: UNIT SHOULD BE ASSEMBLED BY TWO OR MORE PEOPLE, DO NOT TIGHTEN ANY BOLTS UNTIL ALL BOLTS HAVE BEEN STARTED!
 LEVEL THE CHAIR AND TIGHTEN ALL BOLTS WITH THE ALLEN WRENCH