

TOOLS REQUIRED



Screwdriver
(Not Included)



(Included)
Allen Wrench

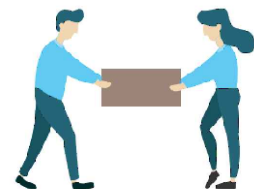

2 - People

ASSEMBLY RATING



EASY ————— DIFFICULT

The Assembly Rating is a 5-point system showing the level of effort needed to assemble a specific product.

QUEEN/ FULL BED



- Please keep instructions for future reference.
- Check the quantity and irregularity of parts and hardware before you start.

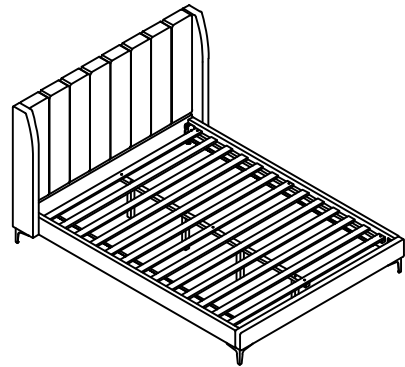

PARTS

1

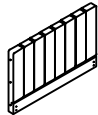

Headboard
1pc

2



Left Wing
1pc

3



Right Wing
1pc

4

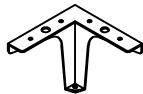

Leg
4pcs

5

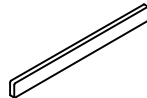

Footboard
1pc

6

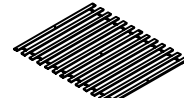

Slat
1set

7



Side Rail
2pcs

8

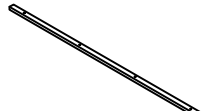

Middle slat
1pc

9



Support Leg
4pcs

HARDWARE

A



Bolt Ø5/16"x1"
16pcs

B



Bolt Ø5/16"x1-1/2"
6pcs

C



Flat Washer
Ø5/16"x19mm
22pcs

D



Spring Washer
22pcs

E



Allen Key
1pc

F

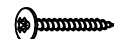

Screw M4x30mm
9pcs

Exploded View

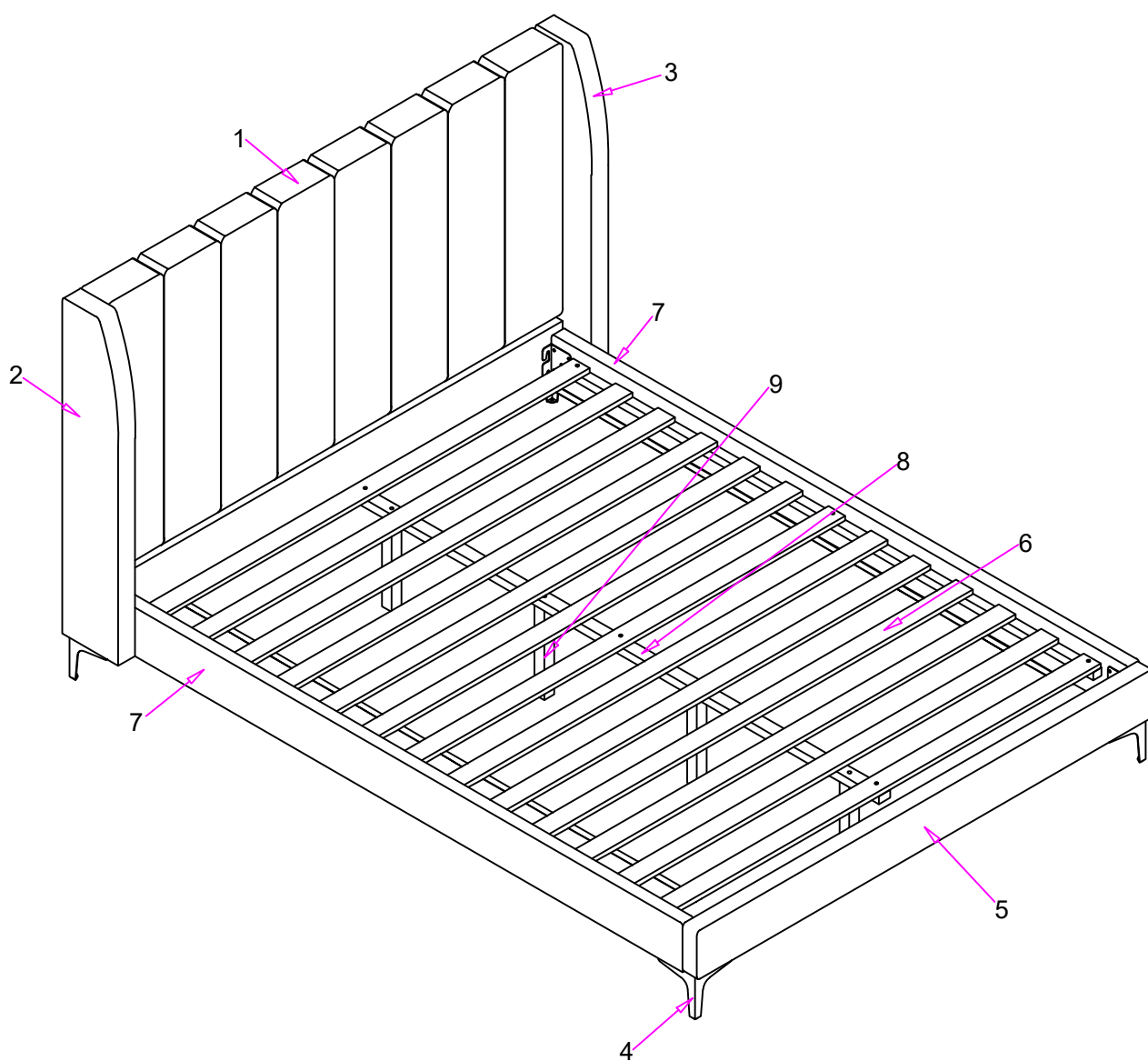

ASSEMBLY INSTRUCTIONS

1

Part 1 x1pc

Part 2 x1pc

Part 3 x1pc

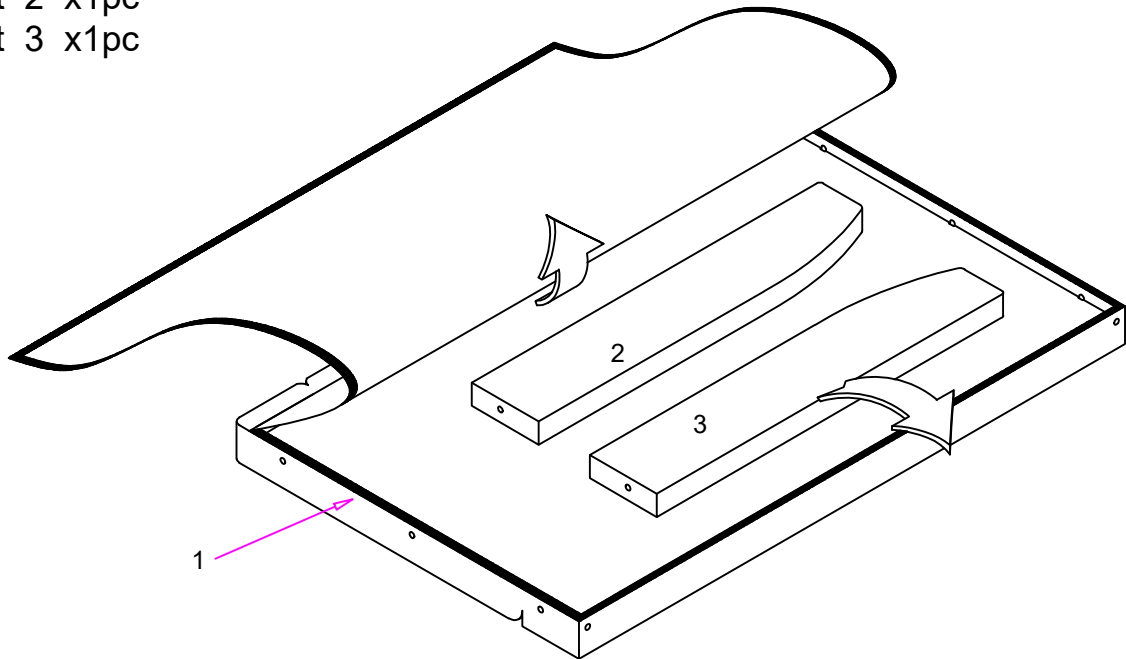

2

Part 1 x1pc

Part 2 x1pc

Part 3 x1pc

Hardware B x6pcs

Hardware C x6pcs

Hardware D x6pcs

Hardware E x1pc

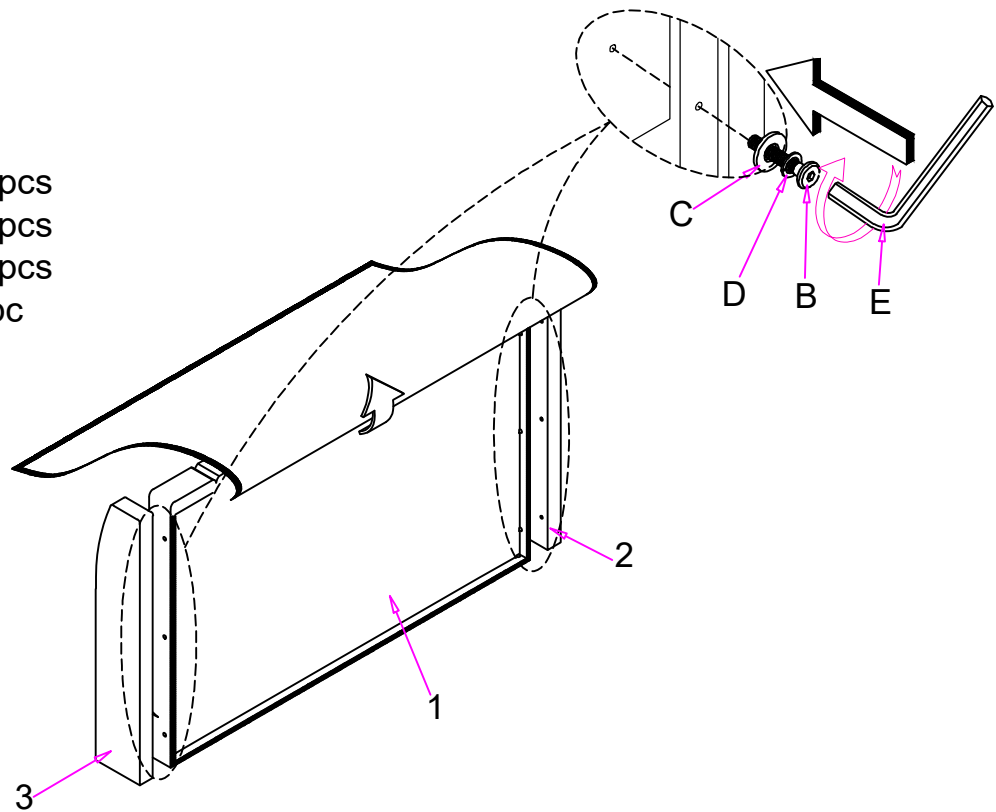

ASSEMBLY INSTRUCTIONS

3

- Part 2 x1pc
- Part 3 x1pc
- Part 4 x4pcs
- Part 5 x1pc
- Hardware A x6pcs
- Hardware C x6pcs
- Hardware D x6pcs
- Hardware E x1pc

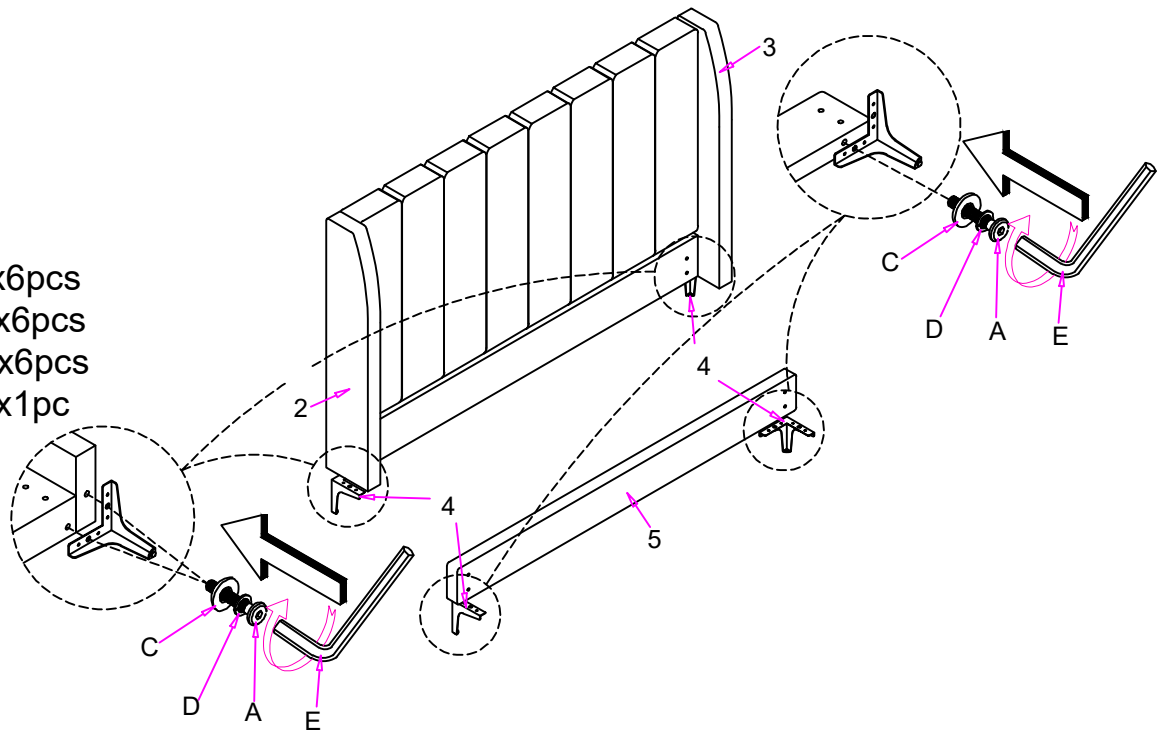

4

- Part 1 x1pc
- Part 4 x4pcs
- Part 5 x1pc
- Part 7 x2pcs
- Hardware A x10pcs
- Hardware C x10pcs
- Hardware D x10pcs
- Hardware E x1pc

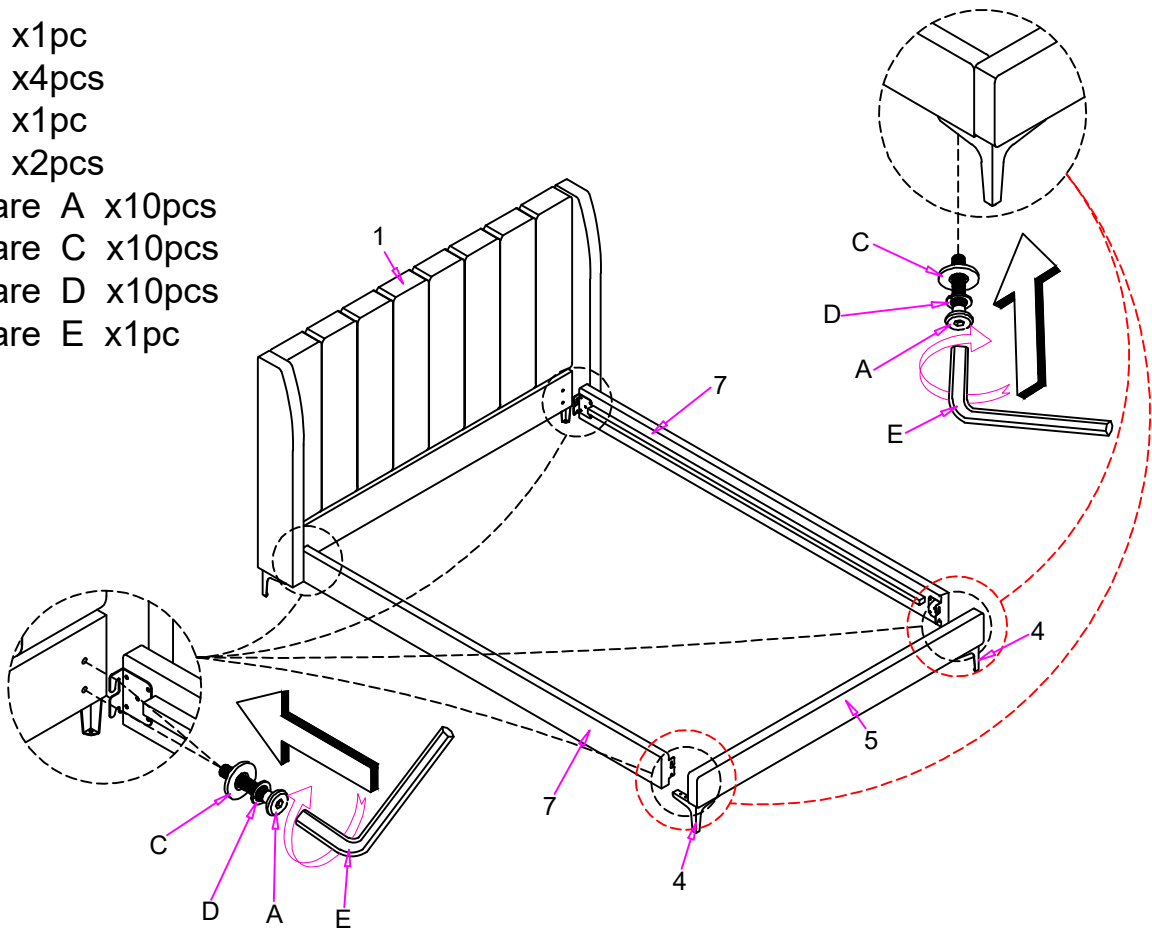

ASSEMBLY INSTRUCTIONS

5

Part 8 x1pc
Part 9 x4pcs

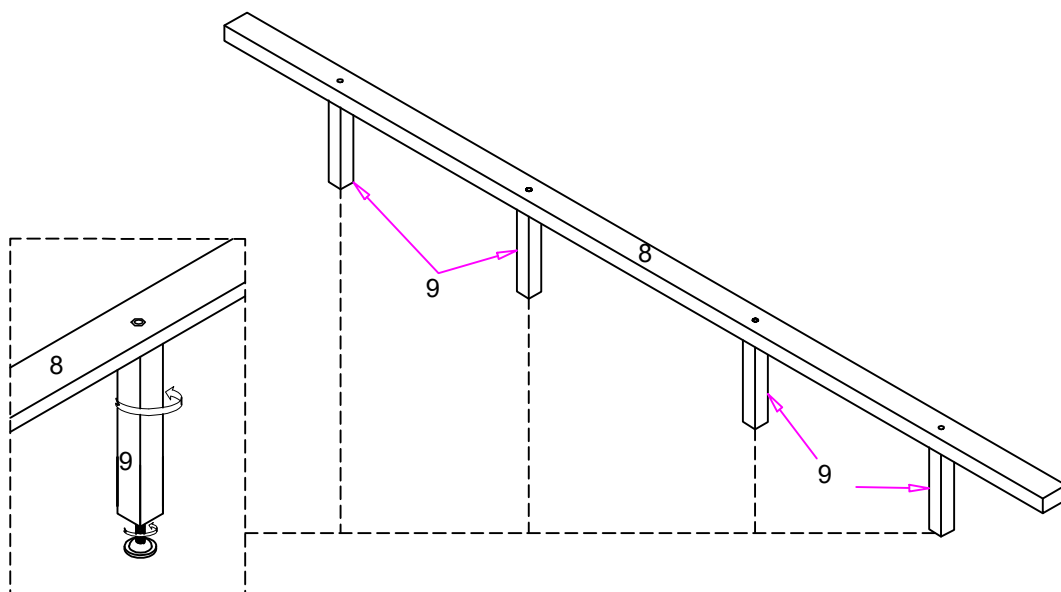

6

Part 6 x1set
Part 8 x1pc
Hardware F x3pcs

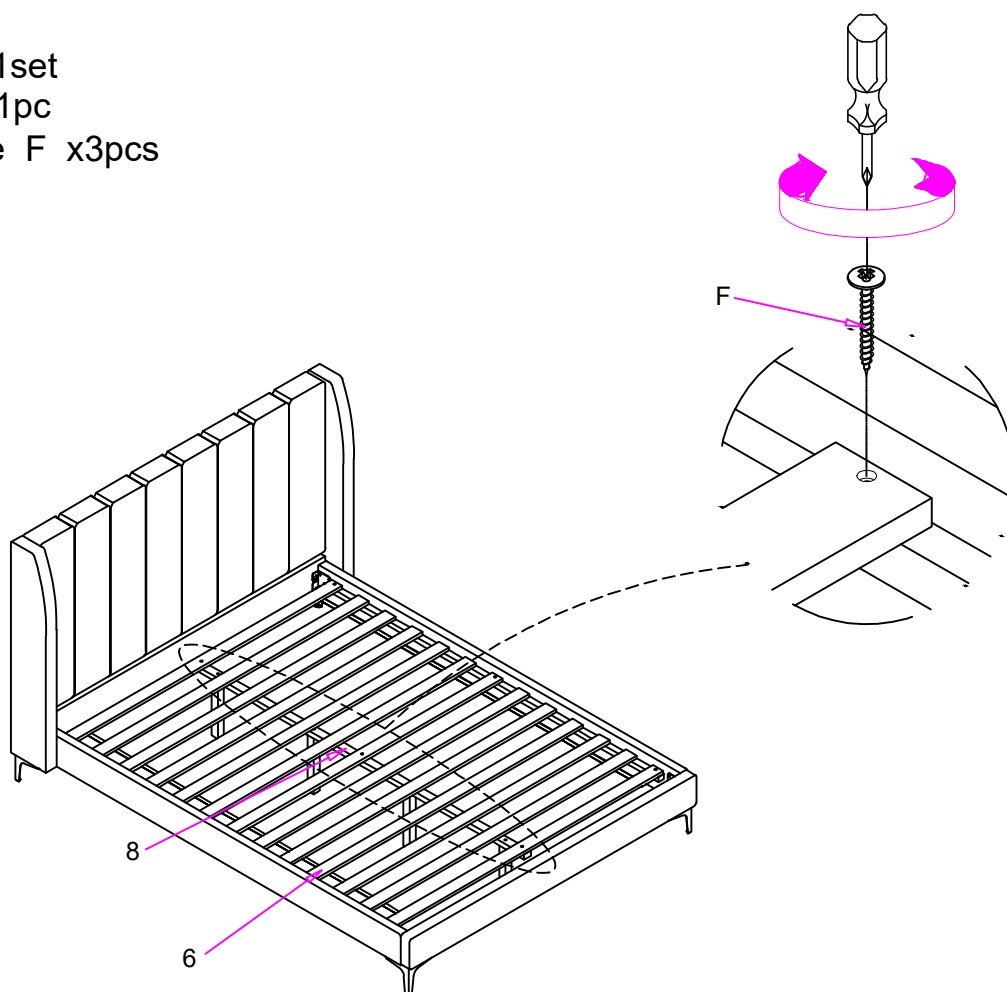

ASSEMBLY INSTRUCTIONS

7

Part 6 x1set
Part 7 x2pcs
Hardware F x6pcs

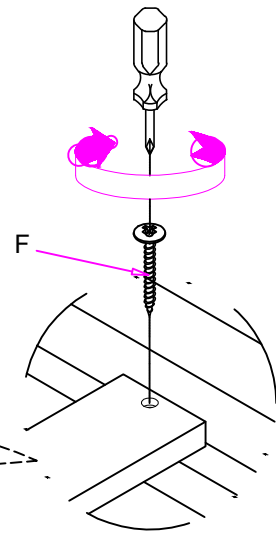
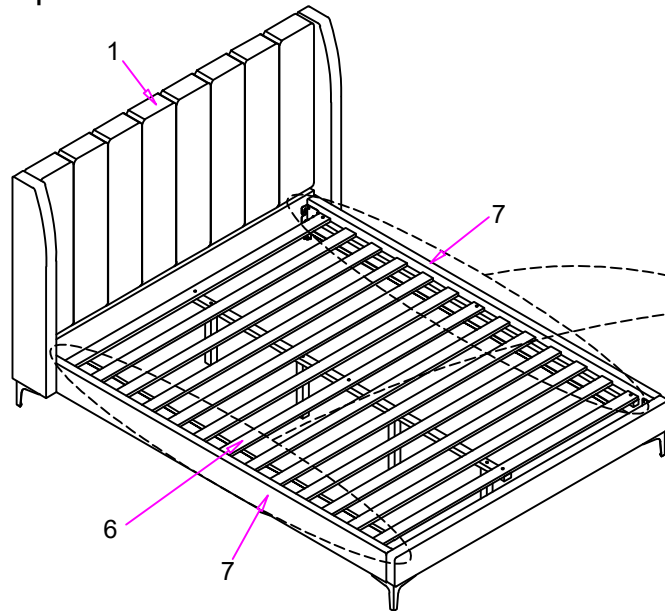

8

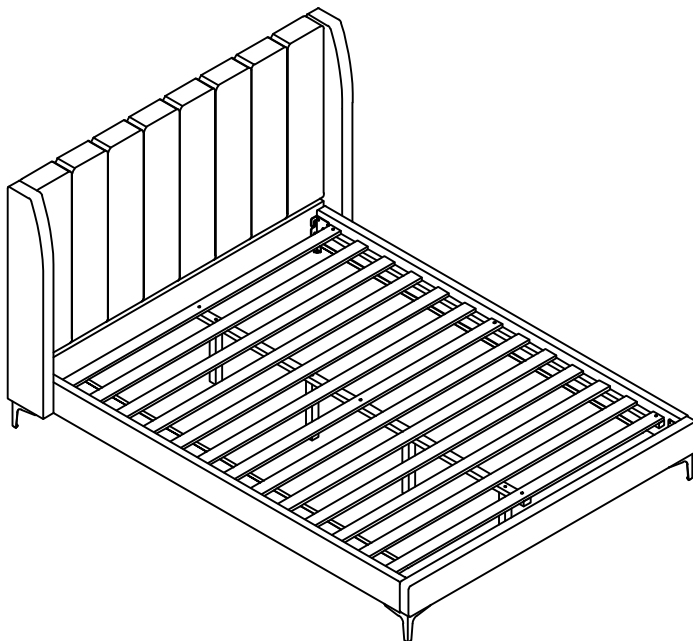

ASSEMBLY COMPLETED



Please ensure the furniture rests on an even and flat surface. If the product wobbles or feels loose, double-check all bolts and/or screws are properly tightened and secured.



Keep this handy!

Please retain this instruction manual and any order-related information for future reference.



Lift, don't drag!

To avoid damage to product please always LIFT the product when transporting or adjusting the placement.

This product is intended for RESIDENTIAL USE ONLY and not for commercial use.