

# Handle Assembly

## Parts Description

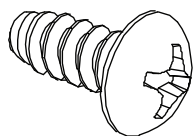

SCREW x2

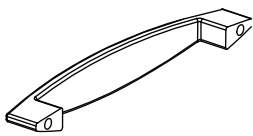

HANDLE

Note: Parts may be located inside the product drawer or attached to the inside of the drawer front.

## Tools For Assembly

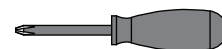

Phillips Screwdriver

1

## Attach Handle

## Parts Description

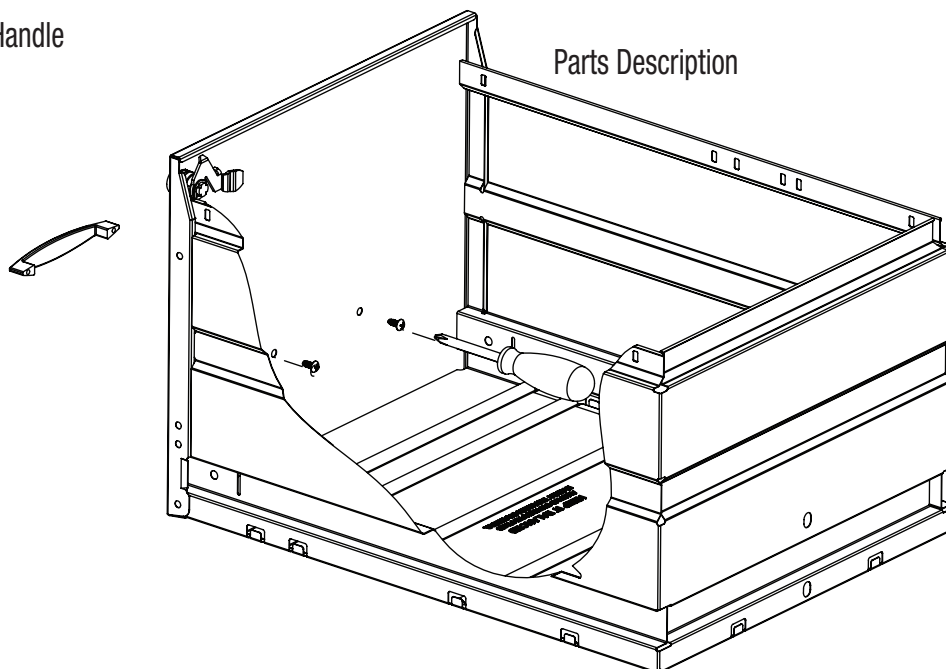

Use a Phillips screwdriver to insert two screws into the pre-drilled holes on the inside of the drawer front. Align the handle holes with the screws and tighten with a Phillips screwdriver.