

likein

User Manual

Air Purifier

Thank you for purchasing the Likein AP01 PLUS Air Purifier. Please read this user manual carefully and keep it for future reference. If you need any assistance, please contact our support team with your product model number .

Package Contents

- Air Purifier
- Filter (Pre-installed)
- Power Adapter
- User Manual







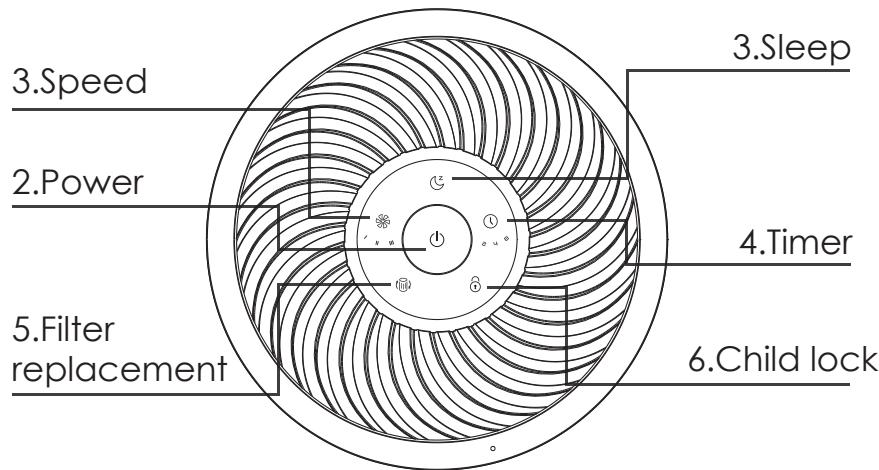

Technical Specification

| | |
|---------------------|---|
| Product Name | Air Purifier |
| Model | AP01 PLUS |
| Adspter | Input:100-240V 50/60HZ Output:DC12V/2A |
| Rated Power | 13W |
| Maximum Noise Level | < 40dB |
| Dimensions | 205*205*385mm 8.07" x 8.07" x 15.2" |
| Net Weight | 2.1kg / 74oz |
| Power Cord Length | 4ft (1.2m) |

Operating Instruction



1. Connect the adapter to the machine to enter the standby state.
2. When the machine is in standby state, Tap the “ ⏻ ” button and the appliance will turn on, and when it is in working state, tap “ ⏻ ” button and it will enter stand by state.
3. There are “ 🌙 ” button and “ 🌀 ” button. In standby status, tap the “ 🌀 ” button to select the corresponding wind speed from low, medium to high. Tap the “ 🌙 ” button to enter sleep mode. In sleep mode, the fan runs at the lowest speed. 2h, 4h, and 8h auto shut-off.
4. 3 timer settings. Tap the “ 🕒 ” button to select 2h, 4h, and 8h auto shut-off.

5. The filter lifespan is up to 2200 hours at high wind speed. When the working hour of the filter is more than its lifespan, the “” button will flash with 8 beeps. Tap the “” button once, the purifier will stop beeping but the “” button will still be flashing, and the machine can work normally. The filter replacement reminder will be issued after the next startup until the filter is replaced. When the filter is replaced, please tap and hold the “” button for 3 sec, the “” button will stop flashing. The machine will recalculate the filter replacement time.
6. When the machine is in working state, tap and hold “” button for 3 sec and the machine will enter the child lock state. The “” button will be lit on, and the functions of all operation buttons will be invalid. When the machine is in child lock state, tap and hold “” button for 3 sec to unlock the child lock state, the “” button will be lit off, and the functions of all operation buttons will be recovered.
7. This air purifier has a memory function, which can remember the state of the last use. For example: the wind speed I was set last time, the machine will directly enter the wind speed I working state after the next start.

Product Diagram

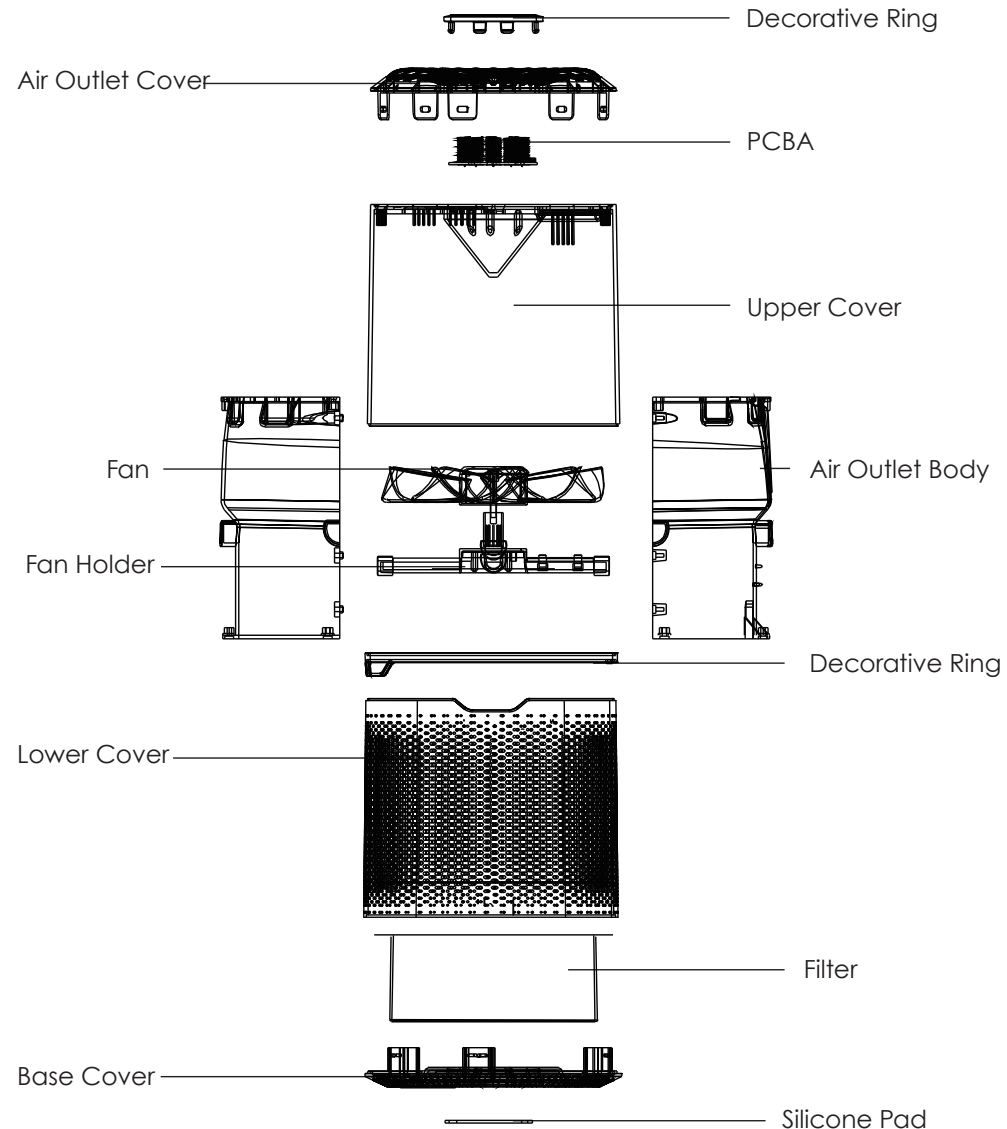

Full-Effect Purification Function

For dust, mites, pollen, smoke, fiber, animal dandruff, etc. This purifier can effectively remove PM2.5 (smoke, dust, pollen, etc.) from room air; it can purify the air by removing formaldehyde, VOC and other harmful gaseous pollutants to create a fresh space.



Major Functions

Pre-filter: Block the hairs, fibers, big particulate matters, scurf, etc.

True HEPA filter: Efficiently filter out the particles as small as 0.01 microns, e.g. PM2.5, smog, pollen, acarid and other pollutants.

Activated carbon filter: High-quality modified activated carbon and catalyst are adopted, and they are modified with special proprietary technology, and can efficiently purify methanol, benzene series, VOC and other odorous pollutants.

Notice Before Use

1. Ensure the appliance is unplugged before maintaining or moving.
2. It is strictly prohibited to rinse the appliance with water. Do not use the appliance near water or volatile flammable items.
3. Do not place any object into the power input port, otherwise machine cannot be operated.
4. Do not place any object into the air outlet area in order to prevent malfunction.
5. Suggested to place the unit in the area that children cannot easily touch.
6. Do not use a wet hand to insert or remove the power plug. Do not cleanse the appliance with any type of acid-base

Maintenance & Filter Change

1. Make sure the device has been turned off and unplugged to the power supply before changing the filter.
2. Turn the device upside down, then turn the base cover counterclockwise and remove it.
3. Remove the old filter and put in the new filter.
4. Lock the new filter by turning clockwise.

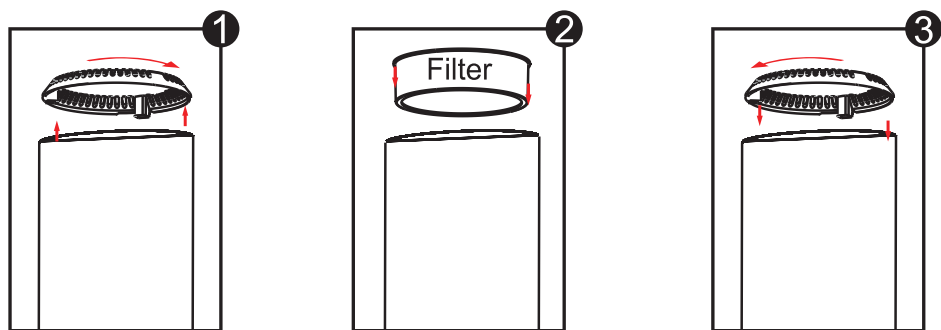

Trouble Shooting

| Malfunction | Checked items | Solutions |
|----------------------------|--|---|
| The machine is not working | Is the power switched on? | Switch on the power |
| | Is the adapter loose? | Connect the adapter well |
| Odors from the wind outlet | Filters carrying too many odors or dusts | Replace the filters |
| | Filter lifespan expired | Replace the filters |
| Poor purifying efficiency | The machine is placed in an unventilated place or is blocked by a barrier. | Change its location and remove the barrier. |
| Significant noise | Is there anything stuck on the fan in the air outlet. | Clean foreign items |

C E FC

RoHS
Made in China

