

**IMPORTANT!! PLEASE READ ENTIRE
INSTRUCTION SHEET BEFORE ASSEMBLY!!**

Floating Faucet and Barrel Tabletop Fountain w/ LED Light



Step 1:
Take the fountain out of the box. Plug the LED light into the adaptor that is connected to the pump

Step 2:
Connect the pump to the tubing inside the fountain.

Step 3:
Insert the acryl tube in the middle of the LED light.

Step 4:
Connect the faucet to the acryl tube, make sure the the acryl tube is tightly inserted into the faucet.

Step 5:
Put water (1300 ml approx.) in the fountain (about 1/2 way full) take all cords and pump and place it in the water, be sure to make sure there is enough water in the bottom of the fountain so that the pump will be completely submersed

Step 6:
Connect the adaptor to the pump cable.

Step 7:
Plug the pump in and enjoy.

PARTSLIST					
A	Faucet	1pc	B	Acryl tube	1pc
C	Fountain	1pc	D	Water pump	1pc
E	Adaptor	1pc			

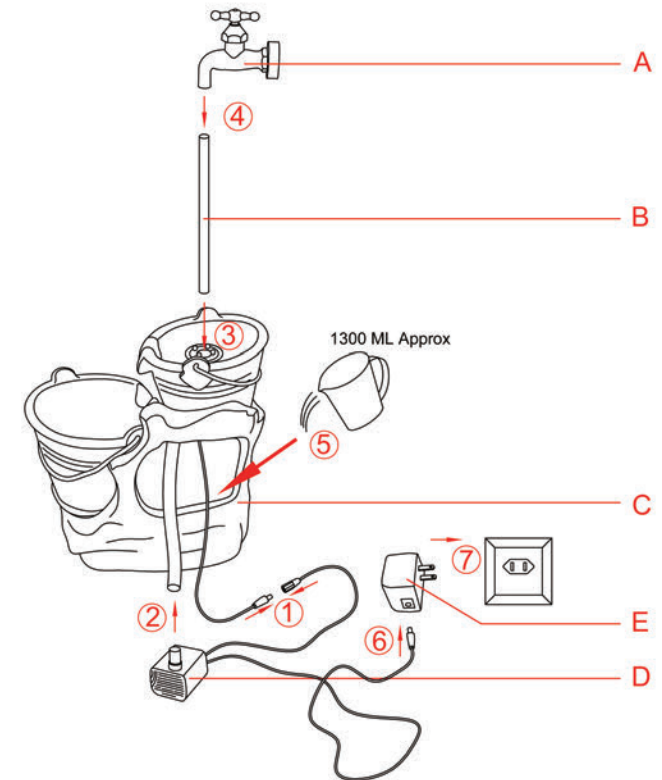

**Be careful not to spill water onto the plug of the pump.
DO NOT allow the pump to run dry!**