

senelux

INSTRUCTION MANUAL

12 Inch **Chrome Desk Fan**

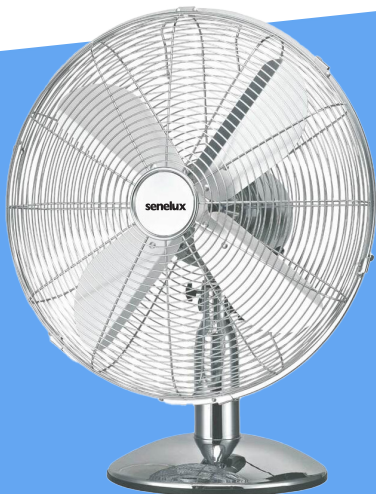

Model: FT-30MC

ENGLISH

TABLE OF CONTENTS

i.	Points For Attention	02
ii.	Instruction For Safe Operation	03
iii.	Product Specification	04
iv.	Parts Description	05
v.	Assembly Guide	06
vi.	Operation Instructions	07
vii.	Maintenance Instructions	07
viii.	Warranty	08
ix.	Information	08

1. POINTS FOR ATTENTION

Before using the product, it is essential to carefully read and follow the instructions provided in this user manual. Additionally, it is recommended to keep the manual in a safe place for future reference.

Warning

1. Avoid electrical shock and fire: Ensure that water, other liquids, and flammable cleaning agents do not enter the product.
2. Prevent combustion: Refrain from spraying any combustible materials, such as insecticides or perfumes, in the vicinity of the product.
3. Check power supply compatibility: Before connecting the product to the power supply, verify whether the product's voltage requirement aligns with the local power supply voltage.
4. Secure placement: Always place and use this product on a stable, flat, and level surface.
5. To avoid damage to the product and ensure its optimal performance, please refrain from inserting fingers or objects into the front cover.

2. INSTRUCTION FOR SAFE OPERATION

1. The fan should be used only at its rated voltage. This fan is designed for a 220-240V~ 50Hz electrical supply.
2. Never insert fingers or any other objects through the fan guard while the fan is running.
3. Unplug the fan when not in use, when moving it from one location to another, before attaching or removing parts, and before cleaning.
4. Regularly check the power cord and plug for damage. If damaged, the power cord or plug must be replaced by the manufacturer or a qualified expert/agency to avoid hazards.
5. Do not insert your fingers into the openings. Do not allow children to insert any objects into the front casing.
6. Do not use this fan outdoors or in damp areas, such as bathrooms.
7. Do not place the electrical cord under a carpet or cover. Do not lay anything over the cord. Position the cord in an area where it does not pose a tripping hazard.
8. The fan must always be unplugged when not in use. To unplug the fan, first switch all controls to the "OFF" position, then disconnect the plug from the outlet.
9. Do not operate the fan near gasoline, paint, or other flammable liquids.
10. If you need to move the fan, first switch it off and unplug it.
11. Users must not replace any parts of this fan themselves.
12. The fan should not be disassembled by the user.
13. Ensure that water or other liquids do not enter the interior of the motor.

14. The fan must be properly grounded.
15. Place the fan on a stable, flat surface.
16. Ensure that the fan does not come into contact with any obstructions while oscillating.
17. This appliance is not intended for use by individuals (including children) with reduced physical, sensory, or mental capabilities, or those lacking experience and knowledge, unless they are under the supervision or have been instructed on the use of the appliance by a person responsible for their safety. Children should be supervised to prevent them from playing with the appliance.

3. PRODUCT SPECIFICATION

Product Name	12 Inch Chrome Desk Fan
Fan Size	12 Inch (30cm)
Voltage	220-240V 50Hz
Power	35W
Oscillating Degree	75°
Vertical Tilt Degree (manual)	20°
Product Size	33.5*26.0*40.0cm
Packaging Size	35.0*21*35.0cm
Gross Weight	3.15kg
Net Weight	2.65kg

4. PARTS DESCRIPTION

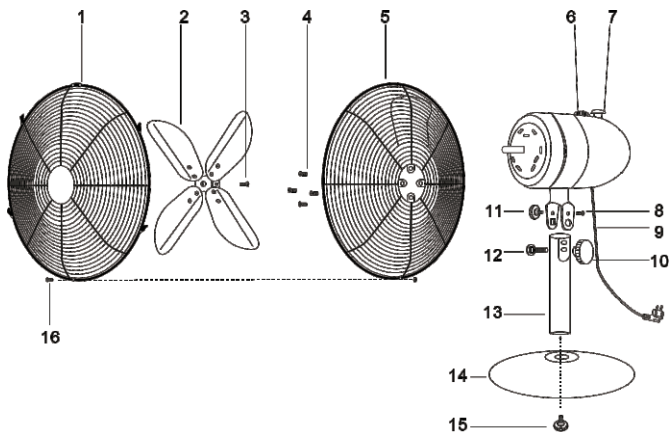

- | | |
|-----------------------------|--------------------------|
| 1. Front Grille | 9. Power cord |
| 2. Blade | 10. Screw knob |
| 3. Blade fixing screws | 11. Adjustable tilt knob |
| 4. Rear grill fixing screws | 12. Motor fixing bolt |
| 5. Rear grille | 13. Rod |
| 6. Speed control switch | 14. Base |
| 7. Oscillation knob | 15. Base fixing screw |
| 8. Tilt range fixing screw | 16. Grille fixing screw |

5. ASSEMBLY GUIDE

Body Assembly:

1. Unscrew the Base Fixing Screw from the Rod.
2. Insert the Rod through the hole in the center of the Base and twist it into position.
3. Secure the Rod to the Base using the Base Fixing Screw.
4. Place the Fan Head onto the Rod, then tighten the Screw Knob, Motor Fixing Bolt, Tilt range fixing screw and the Adjustable tilt knob to fix the Fan Head and Pipe.

Fan Grille Assembly:

1. Align the Rear Grille with the motor, then secure it in place by screwing in the 4x Rear Grille Fixing Screws.
2. Install the Blade onto the motor by tightening the Blade Fixing Screw.
3. Center the Front Grille by aligning the central logo. Then, attach the Front and Rear Grilles by snapping the 5x grille clips into place. Finally, tighten the Grille Locking Screws at the bottom of the Rear Grille.

6. OPERATION INSTRUCTIONS

1. Ensure that the mains voltage matches the voltage specified on the product.
2. Adjust the fan speed using the switch located on the motor housing:
 - 0 - Stop
 - 1 - Low
 - 2 - Medium
 - 3 - High
3. Push the OSCILLATION KNOB on the motor housing to activate the oscillation function. Pull the OSCILLATION KNOB to deactivate it.

7. MAINTENANCE INSTRUCTIONS

1. Before cleaning, turn the fan off and unplug it from the power supply.
2. Use a soft cloth to wipe off any dust from the fan. If the fan is very dirty, use a slightly damp cloth, then wipe it dry. Avoid using cleaning detergents, sprays, or other chemicals, as they may damage the fan.
3. Store the fan in its original packaging in a well-ventilated, dry area.
4. The motor bearings are permanently sealed and do not require additional lubrication.
5. Prevent water from dripping on or entering the fan housing.

8. WARRANTY

All Senelux products come with an 18-month warranty from the original date of purchase. To activate your warranty and secure protection for your products, please register within 30 days of purchase by visiting www.senelux.co.uk. For extended coverage, additional protection plans are also available on our website.

If you encounter any manufacturing defects, please contact our customer service team at support@senelux.co.uk. Be sure to include your order number, product serial number, and any relevant details regarding your issue. For further assistance, FAQs and helpful guides for all our products are available on our website and YouTube channel.

Please note: Any unauthorised repairs will void the warranty.

9. INFORMATION

If you want further information regarding using this product or any of our products, don't hesitate to contact us via the details below.

Senelux U.K. Limited
Unit 9 Wareing Road
Liverpool, L9 7AU
United Kingdom
Email - info@senelux.co.uk
Website - www.senelux.co.uk



Be sure to tag us in your photos on social media using #seneluxathome to be featured

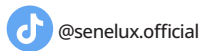

Thank you very much for using our products.
Please read the user manual carefully before use and keep it for future reference.