

Round Dining Table

Assembly Instruction

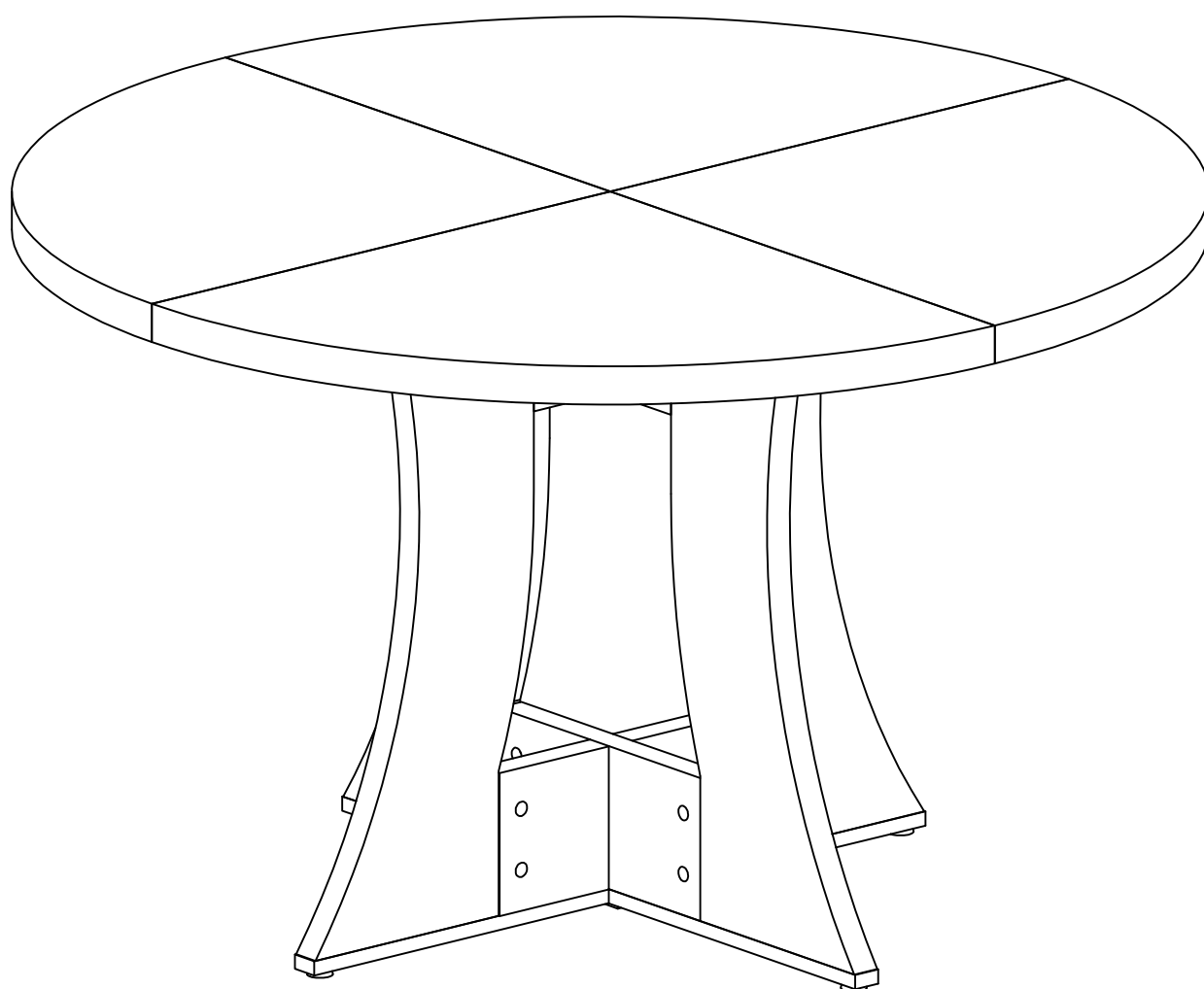

INTRODUCTION

Thank you for purchasing our products. Please read the instructions carefully before installation and keep it in a safe place for future reference. If you need any assistance or support, please feel free to contact our customer support team.

PRECAUTIONS

1. There are many components and accessories in the package. Each component and accessory is labeled with a letter or a number, check carefully before using any of them. Keep them away from children to prevent accidents.
2. Please install the product on a clean and soft underlay (such as carpet or cardboard) to avoid scratching or damaging the surface of the product.
3. The main components of the product is relatively heavy. Please pay attention to safety during installation.
4. The product is not stable during installation. Please do not move it randomly before it is completely installed.
5. If you have any questions during installation, please contact the customer service in time.

***PLEASE BE SURE TO FOLLOW THE INSTALLATION STEPS IN THE MANUAL TO AVOID UNNECESSARY LOSSES CAUSED BY IMPROPER INSTALLATION.**

***IF YOU NEED FURTHER ASSISTANCE, PLEASE CONTACT THE CUSTOMER SERVICE ONLINE.**

Parts List

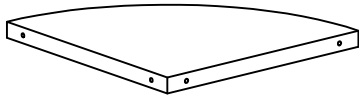

① 4pcs

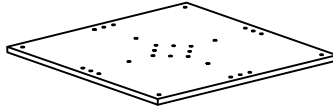

② 1pc



③ 4pcs

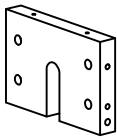

④ 1pc

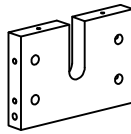

⑤ 1pc

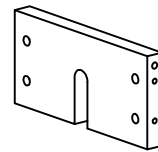

⑥ 1pc

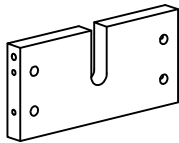

⑦ 1pc

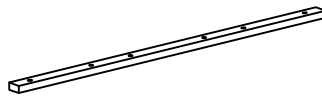

⑧ 1pc

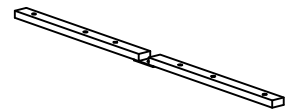

⑨ 1pc

Hardware List

A	X16	B	X16	C	X16	D	X24	E	X1
Ø6X35mm		Ø15X12mm		Ø10X50mm		Ø7X47mm		M4X64mm	
F	X1	G	X8	H	X16	I	X4	J	X4
M6X12mm		M6X18mm		M6X30mm		M6XØ25mm		40X20X2mm	

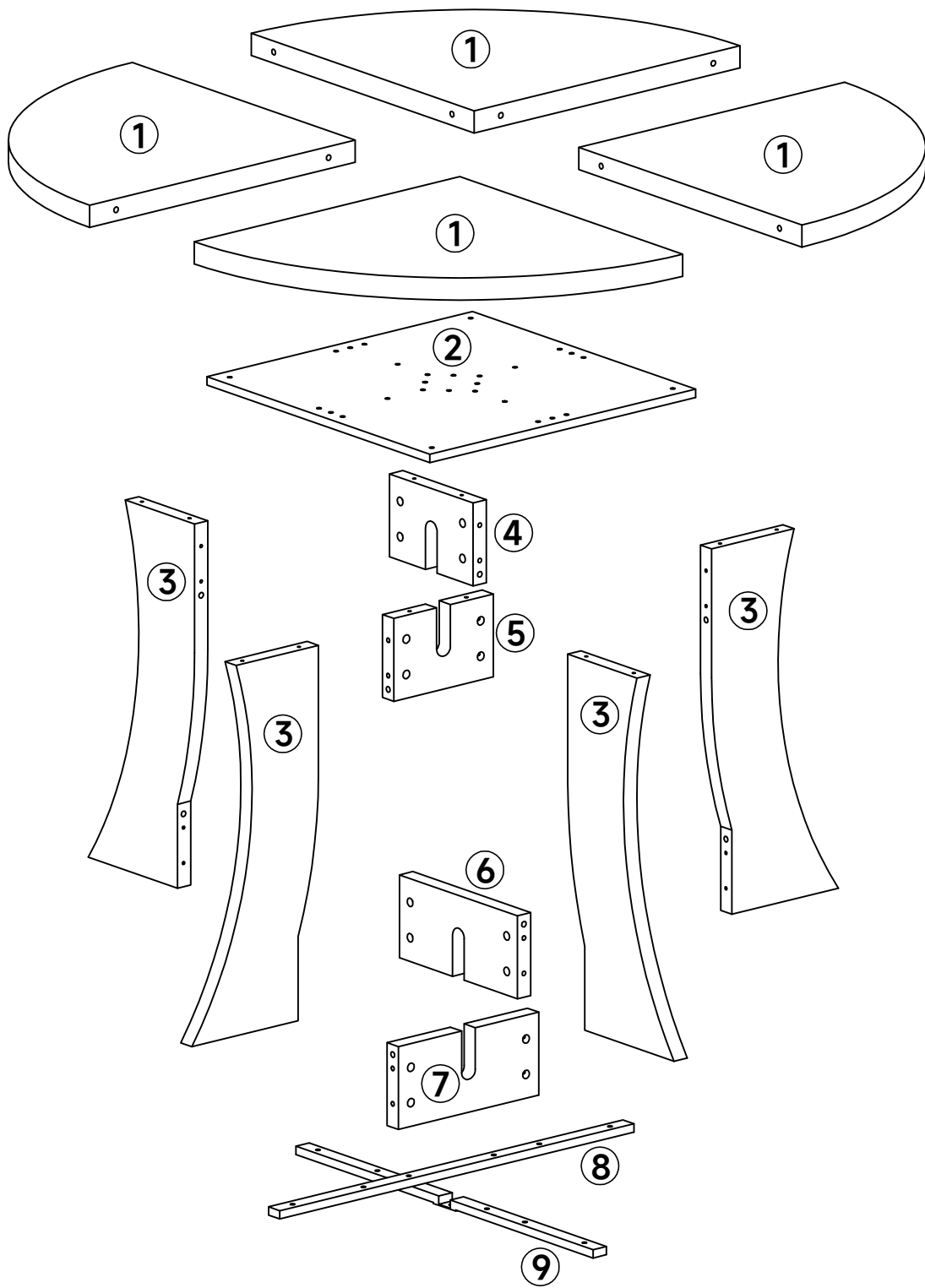

Installation of Cams and Pins

Screw the pin into the hole. To set the cams correctly, ensure that the arrow on the cam is opening to the hole of the pin it is locking. Lock the cam by turning the cam head with a screwdriver until it is tightened. Please do not use an electric screwdriver to assemble the unit.

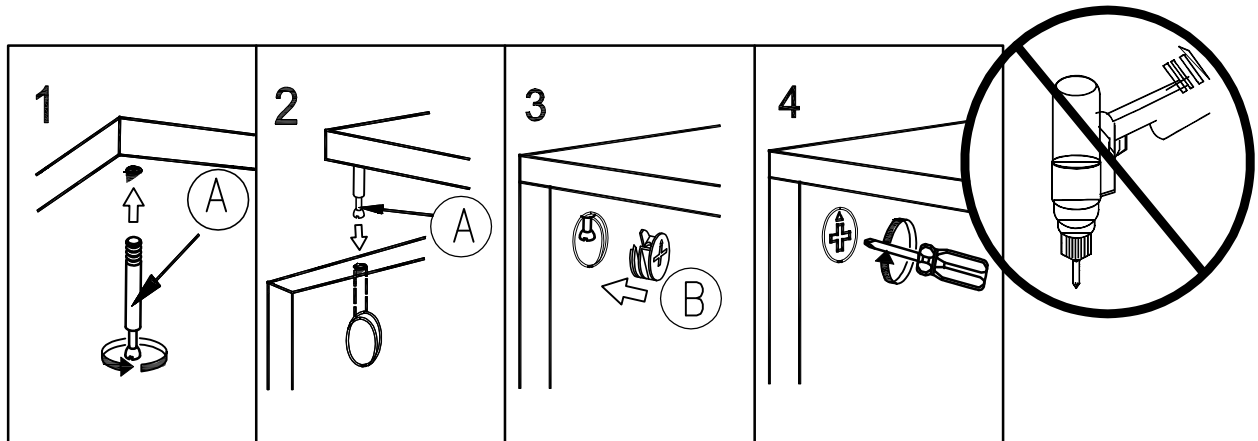

Read each step carefully before starting. It is very important that each step of instruction is performed in the correct order. If these steps are not followed in sequence, assembly difficulties will occur.

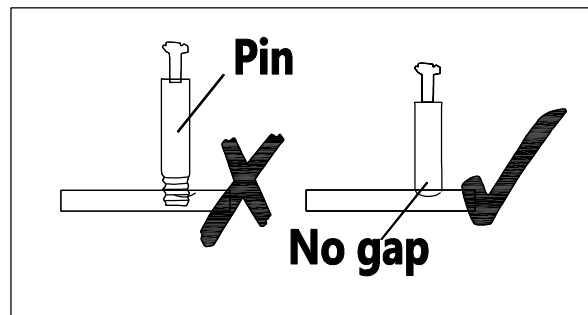

STEP 1

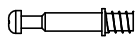

AX16



BX8



CX4

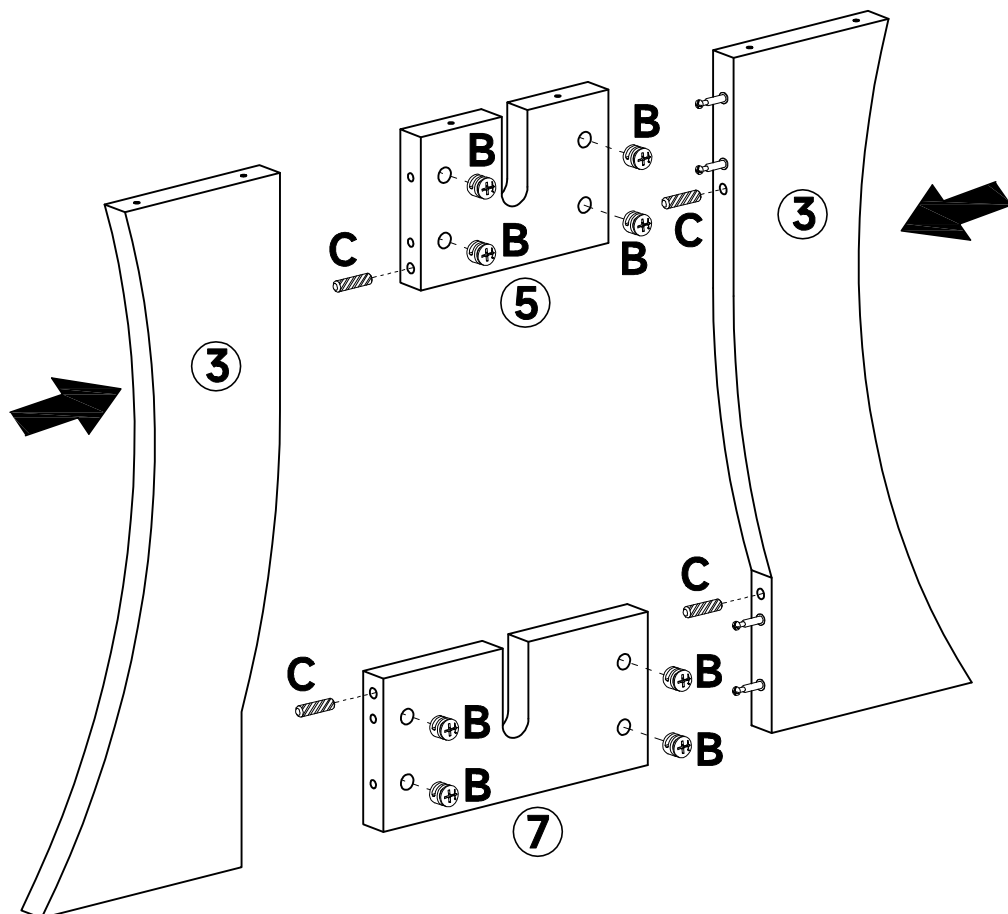
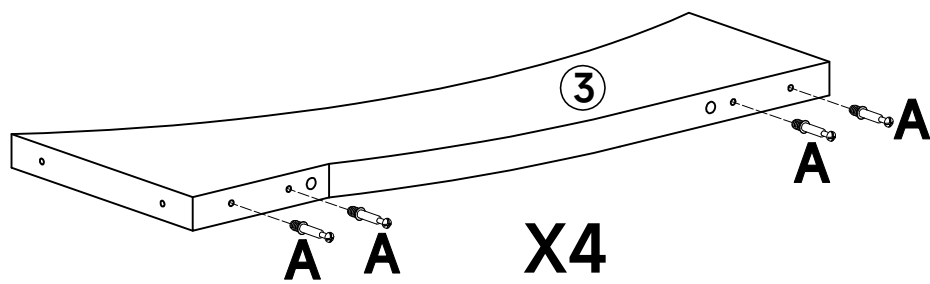
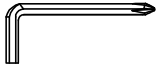

STEP 2

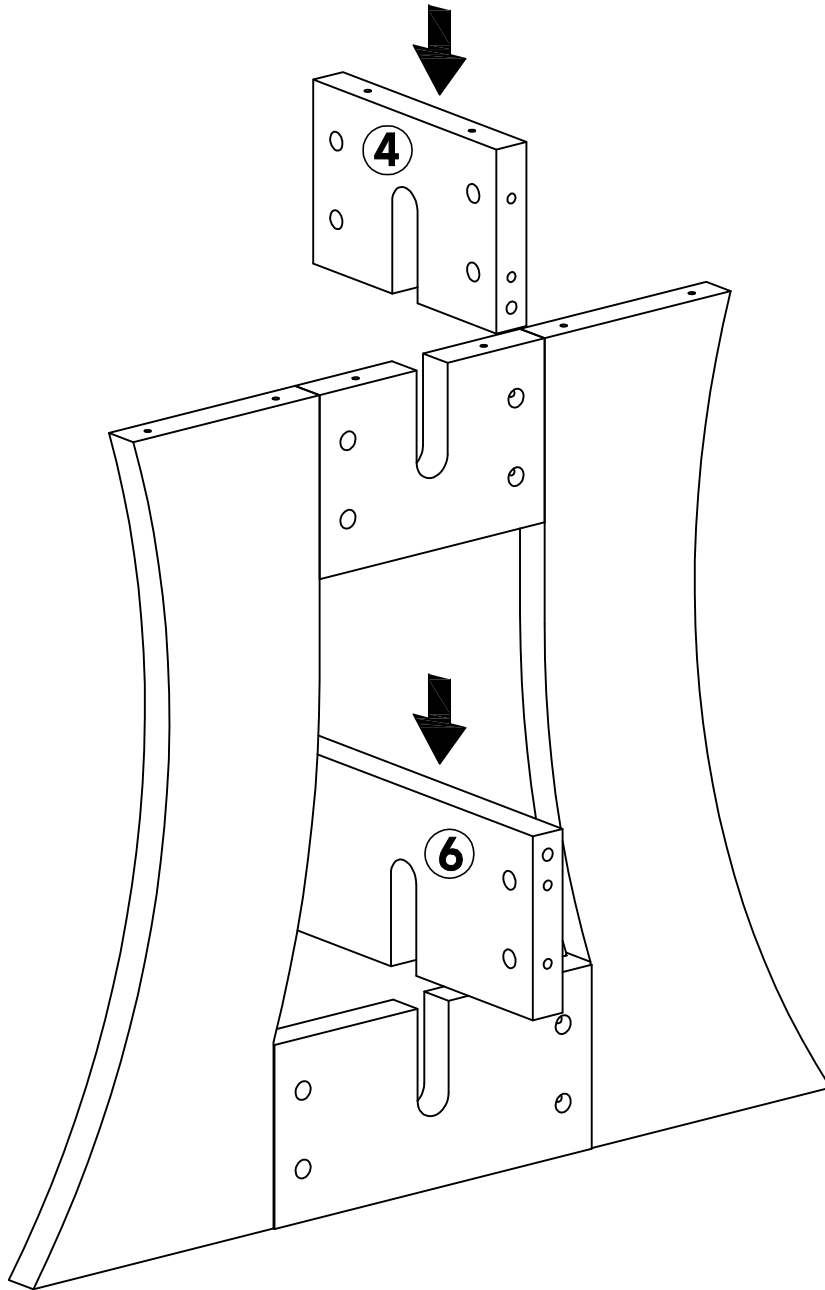

STEP 3



BX8

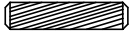

CX4

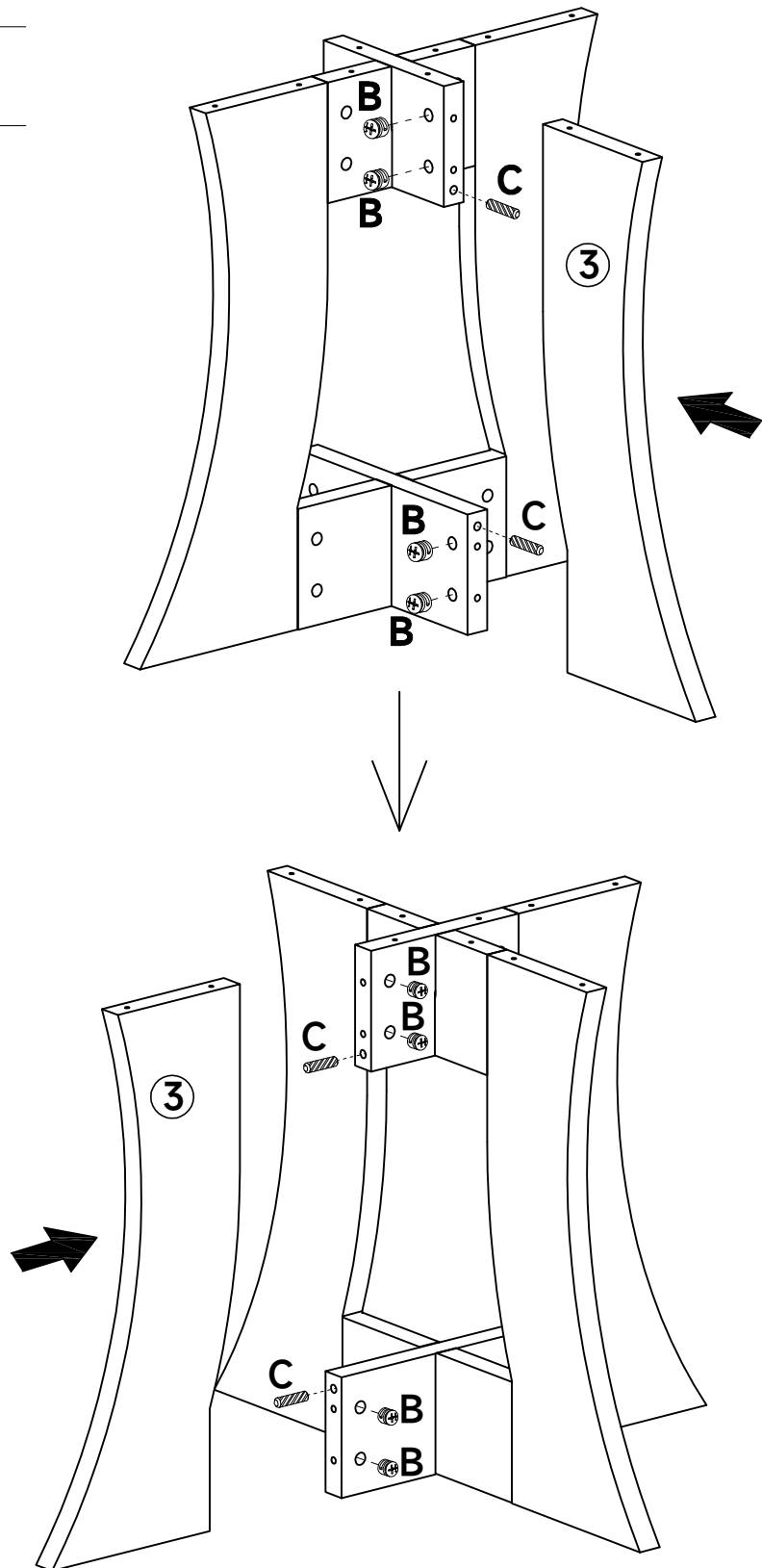

STEP 4

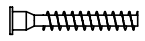

DX12

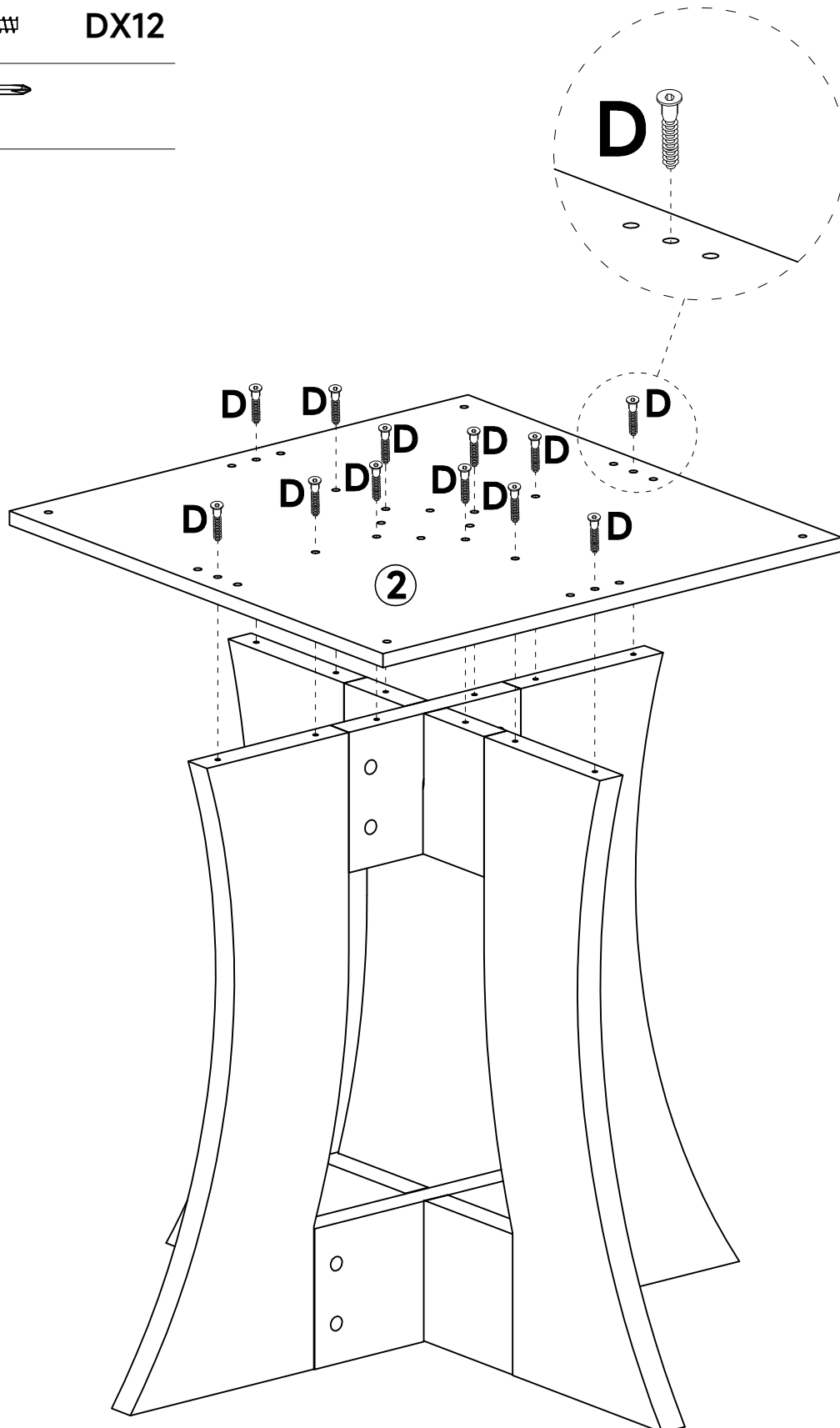

STEP 5

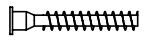

DX12



FX1

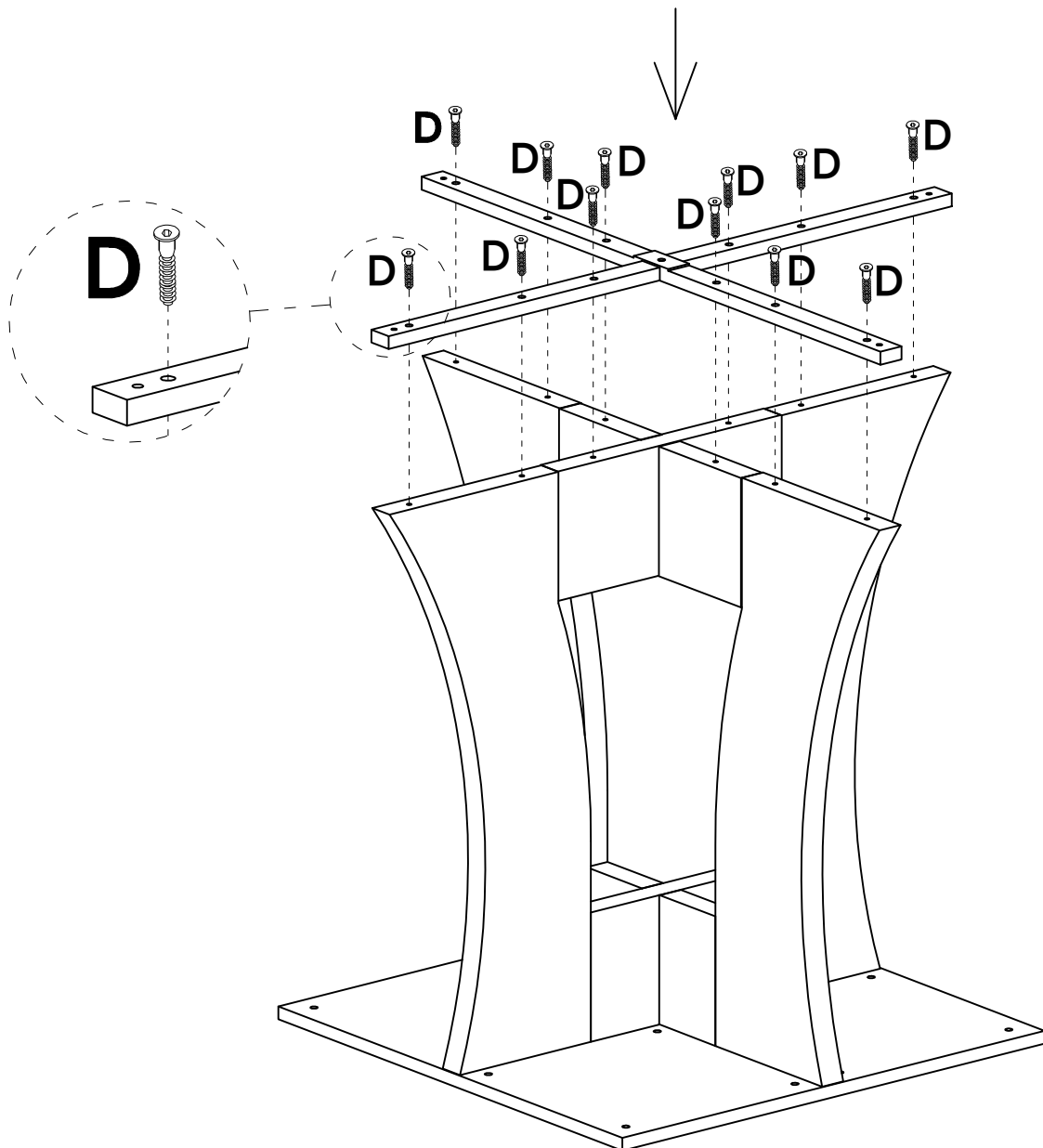
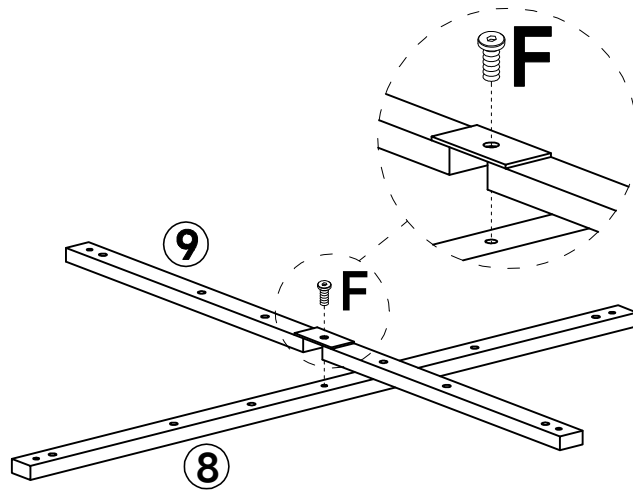

STEP 6



IX4

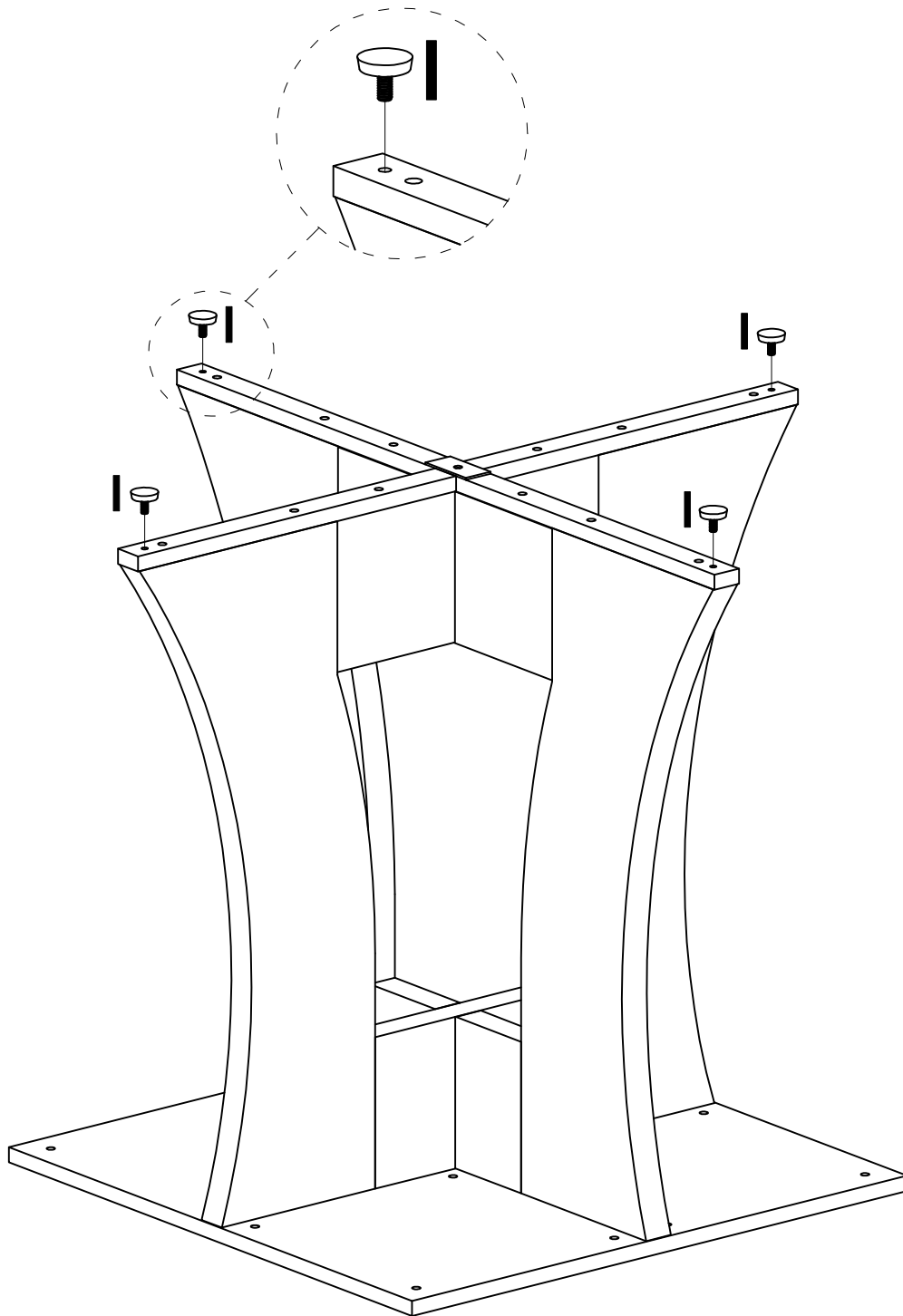

STEP 7



CX8



GX8



JX4

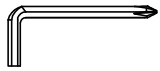

X2

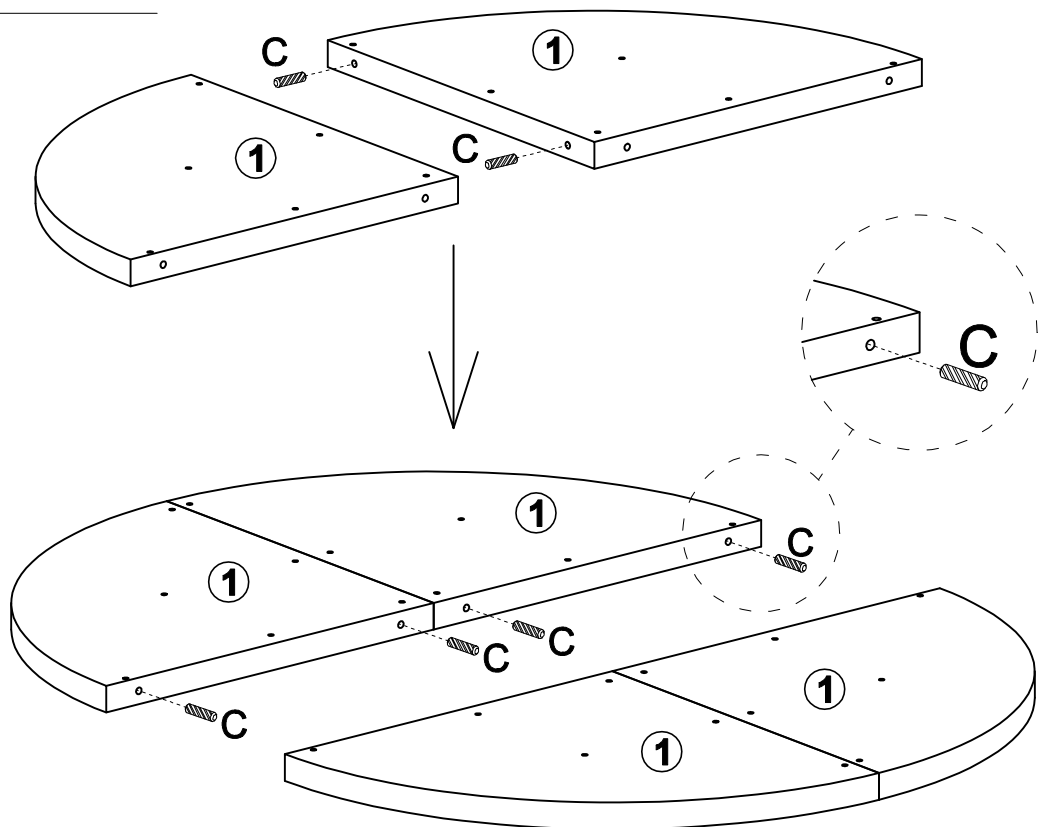

Put together the four pieces table top closely,
then tight the steel plates

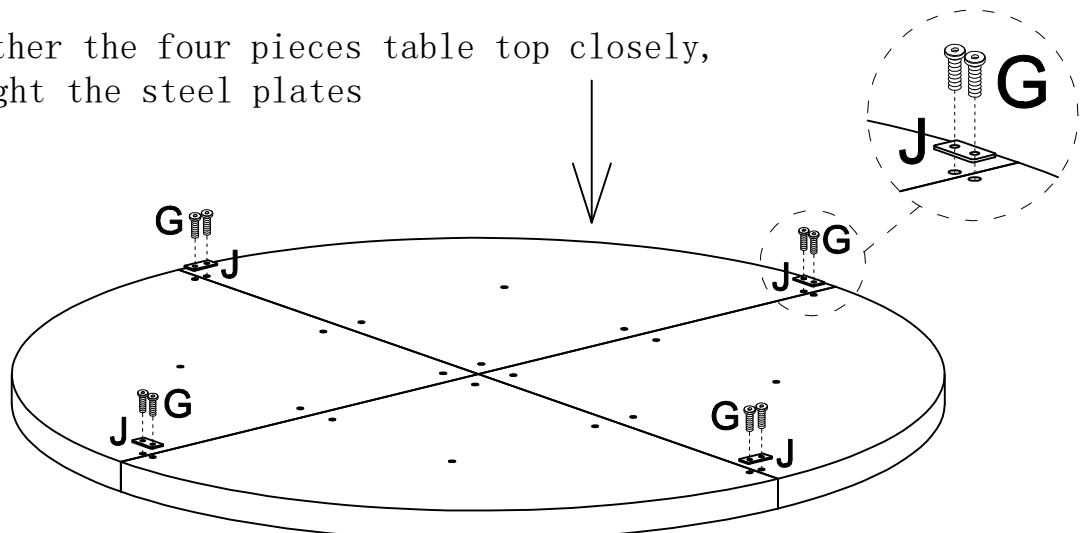

STEP 8

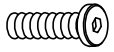

HX16

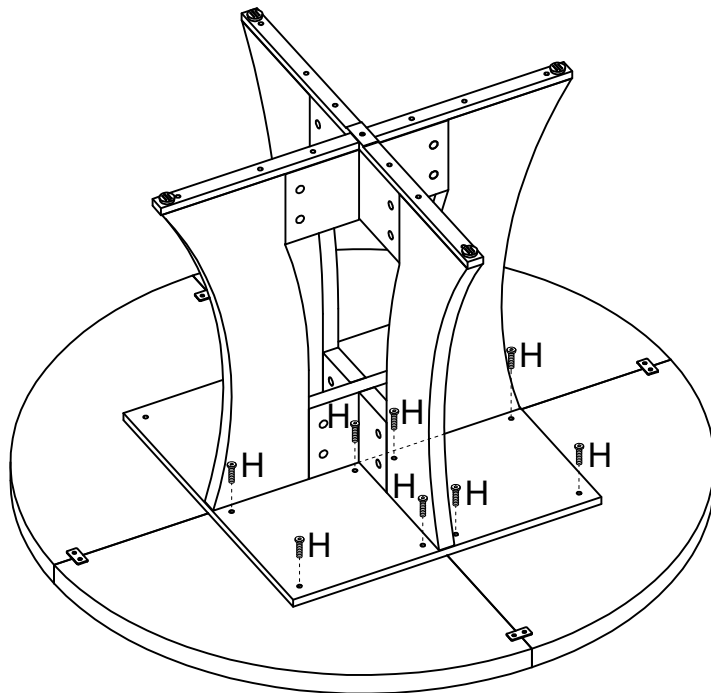
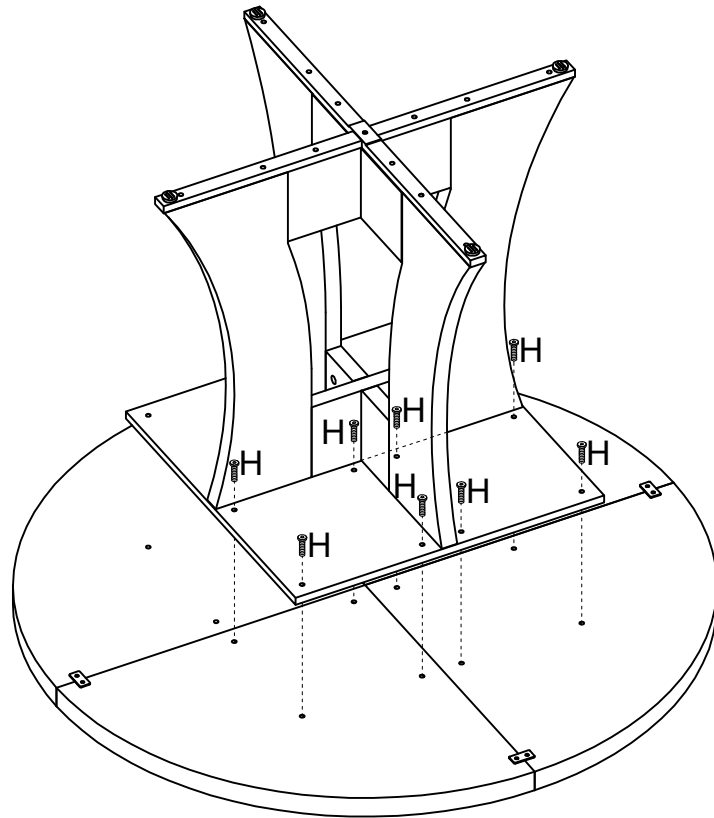

STEP 9

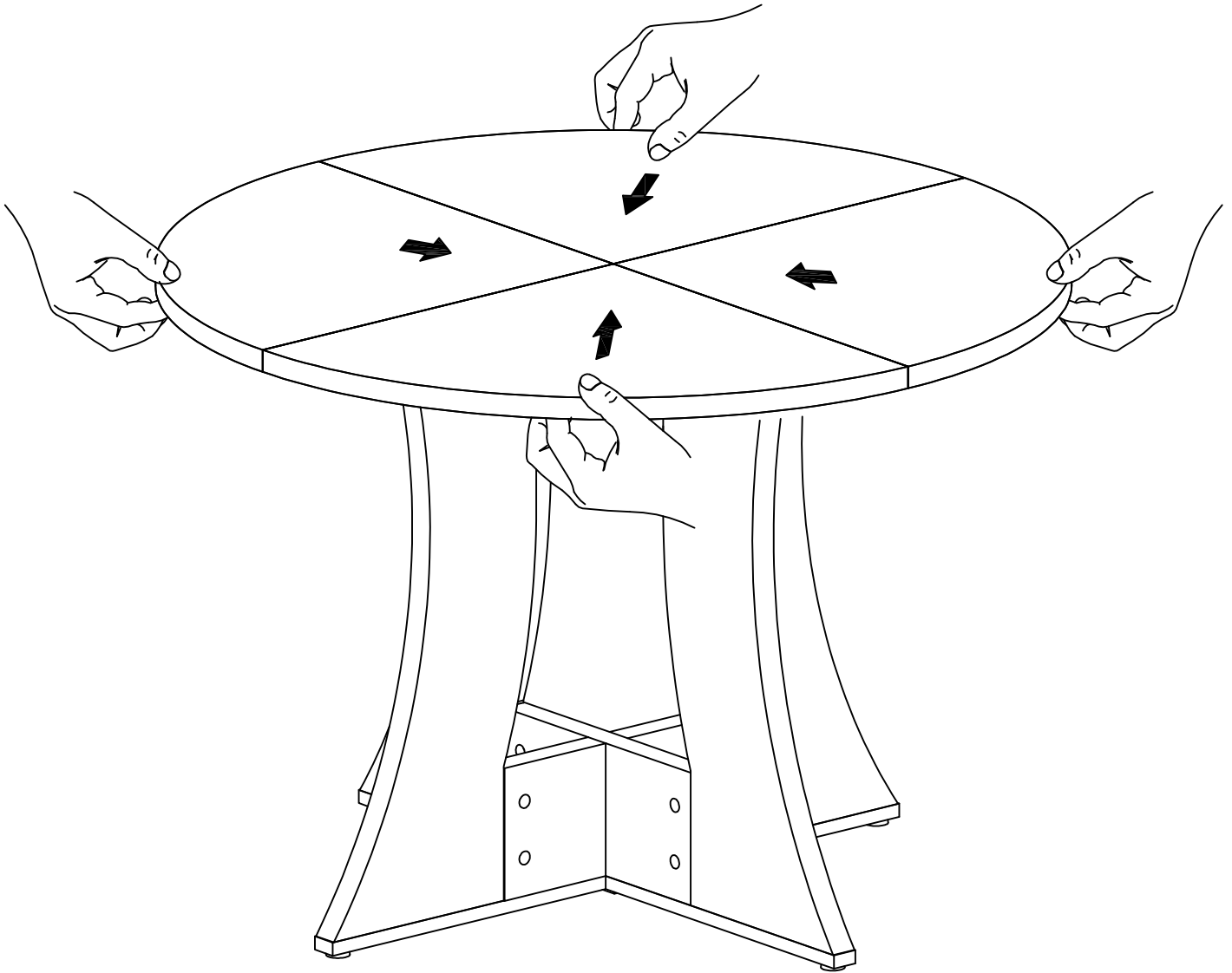

After assembly, if there is a gap on the table top, please loosen the screws at the bottom, two people press the table top tightly, and then lock the screws, it will solve the gap problem.