

GREYFIELD

THERMOSTATIC SHOWER VALVE

SKU: 948556



CONTENTS

TRIM	PAGE 2
VALVE	PAGE 3

FEATURES

- Shape: Round
- Handle Type: Lever
- Features: Thermostatic
- Assembly Required: No
- Installation Type: Wall
- Metal Handle
- Mounting Hardware Included: Yes
- For Proper Installation, Requires Use of Volume Control Valve and Trim
- Temperature Outlet Factory Preset to 104 Degrees Fahrenheit
- Temperature Can Be Easily Adjusted Up and Down to User's Comfort Level
- Scald Guard Protection
- High Temperature Limit Stop
- Thermostatic Technology Keeps Shower Temperature Within 1 Degree Celsius
- Optional Rough-in Valve

SIGNATURE HARDWARE Lifetime Warranty

See website for detailed warranty information.

REVISED 01/21/2020

GREYFIELD

THERMOSTATIC SHOWER VALVE

SKU: 948556

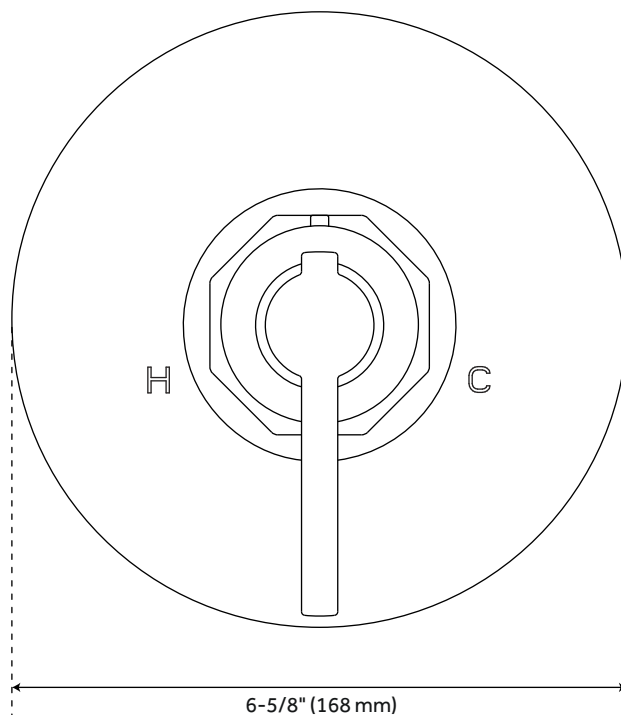
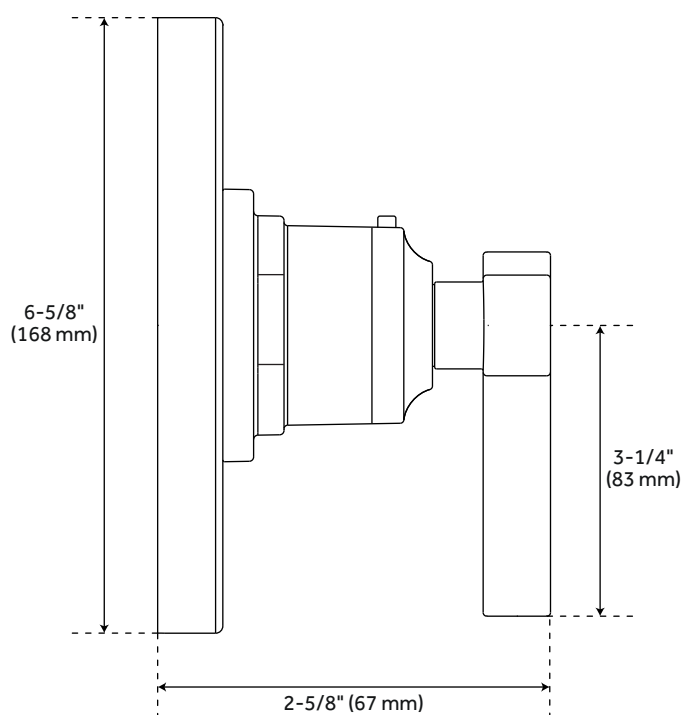

FEATURES

Material: Brass
Diameter: 6-5/8"
Depth: 2-5/8"
Wall Thickness Range: 1" to 1-3/4"

CODES/STANDARDS

cUPC
ASME A112.18.1/CSA B125.1
Massachusetts Accepted

SIGNATURE HARDWARE LIFETIME WARRANTY

See website for warranty information



All dimensions and specifications are nominal and may vary. Use actual products for accuracy in critical situations.

PAGE 2
Code: SHGF9009BN/SHGF9009CP/SHGF9009PN

GREYFIELD

OPTIONAL THERMOSTATIC VALVE WITH 1/2" -OR- 3/4" CONNECTION

SKU: 948556

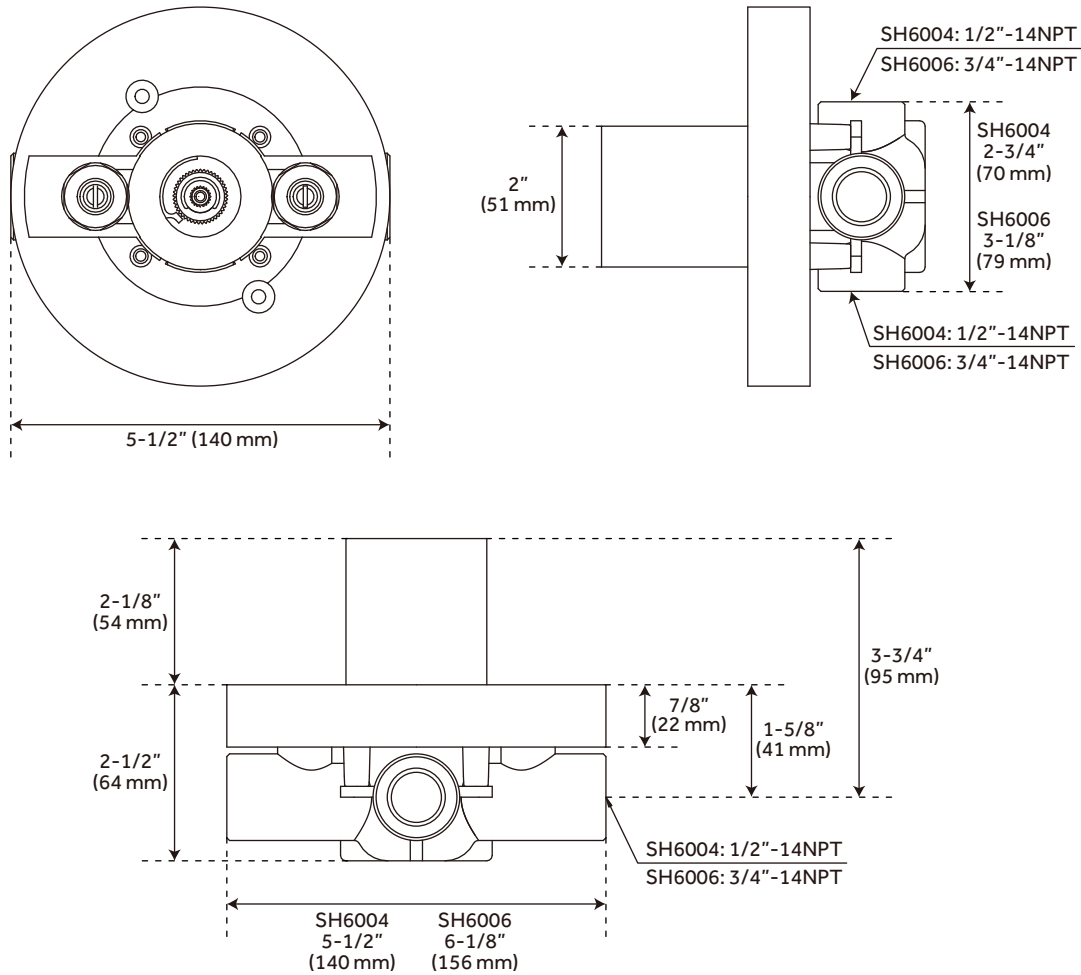

FEATURES

- Bronze Valve Body
- Ceramic Cartridge
- Integral Water Stops and Check Valve
- Recommended Valve Installation Depth 1-5/8" to 2-3/8"
- Must Be Installed in Accordance With Provided Installation Instructions

CODES/STANDARDS

- cUPC
- ASME A112.18.1/CSA B125.1
- ASSE 1016 Type T

SIGNATURE HARDWARE LIFETIME WARRANTY

See website for warranty information

