

W3887P459986 60*72inch

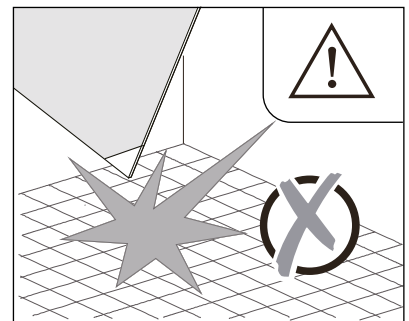

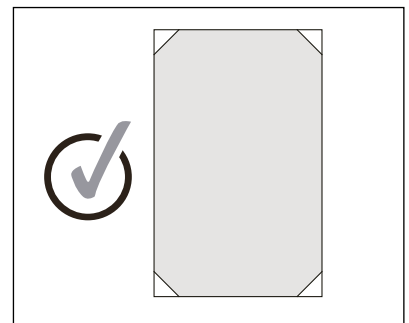

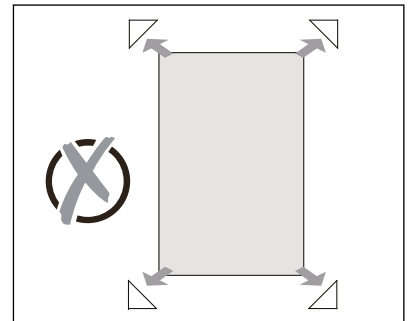
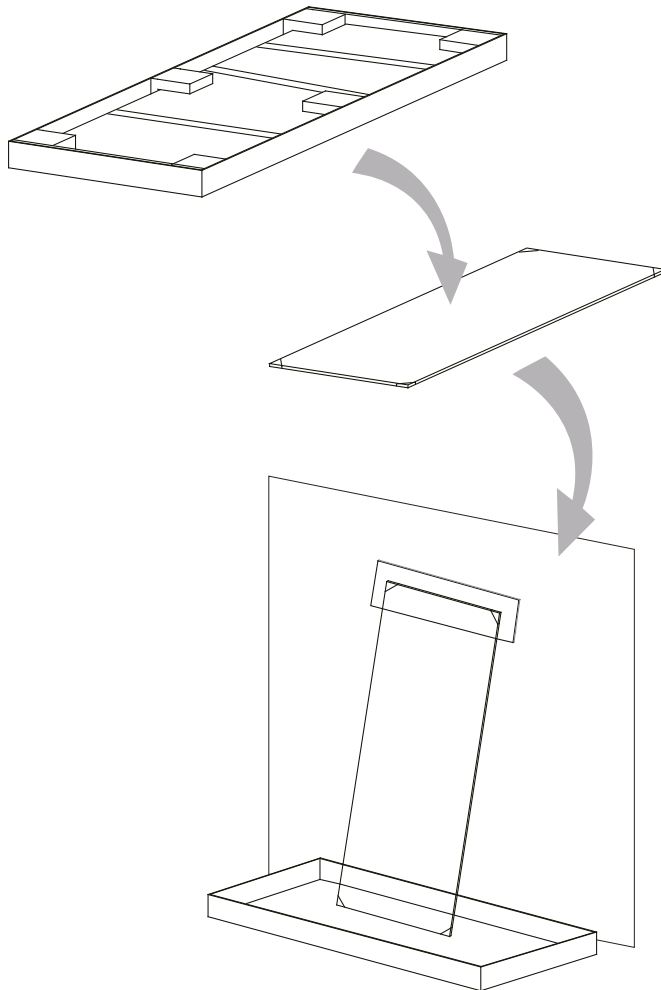
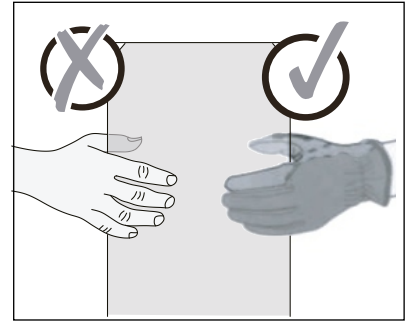
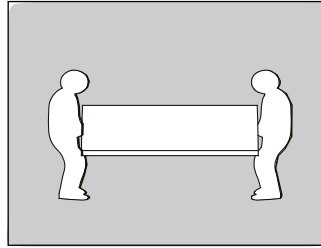
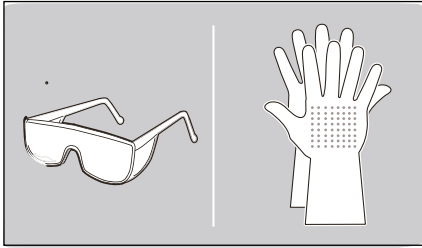
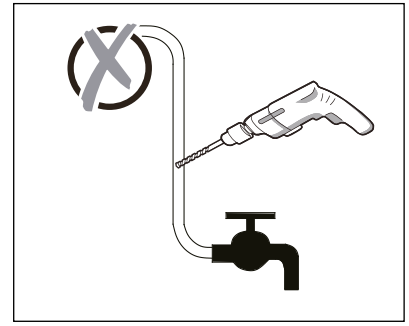
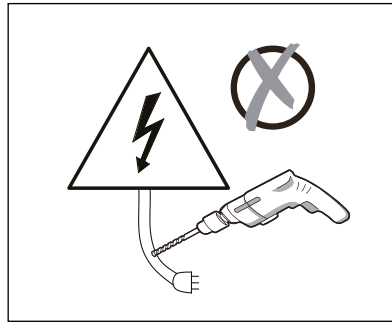
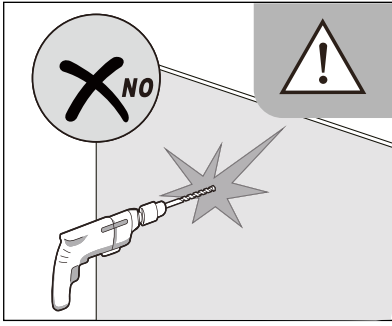
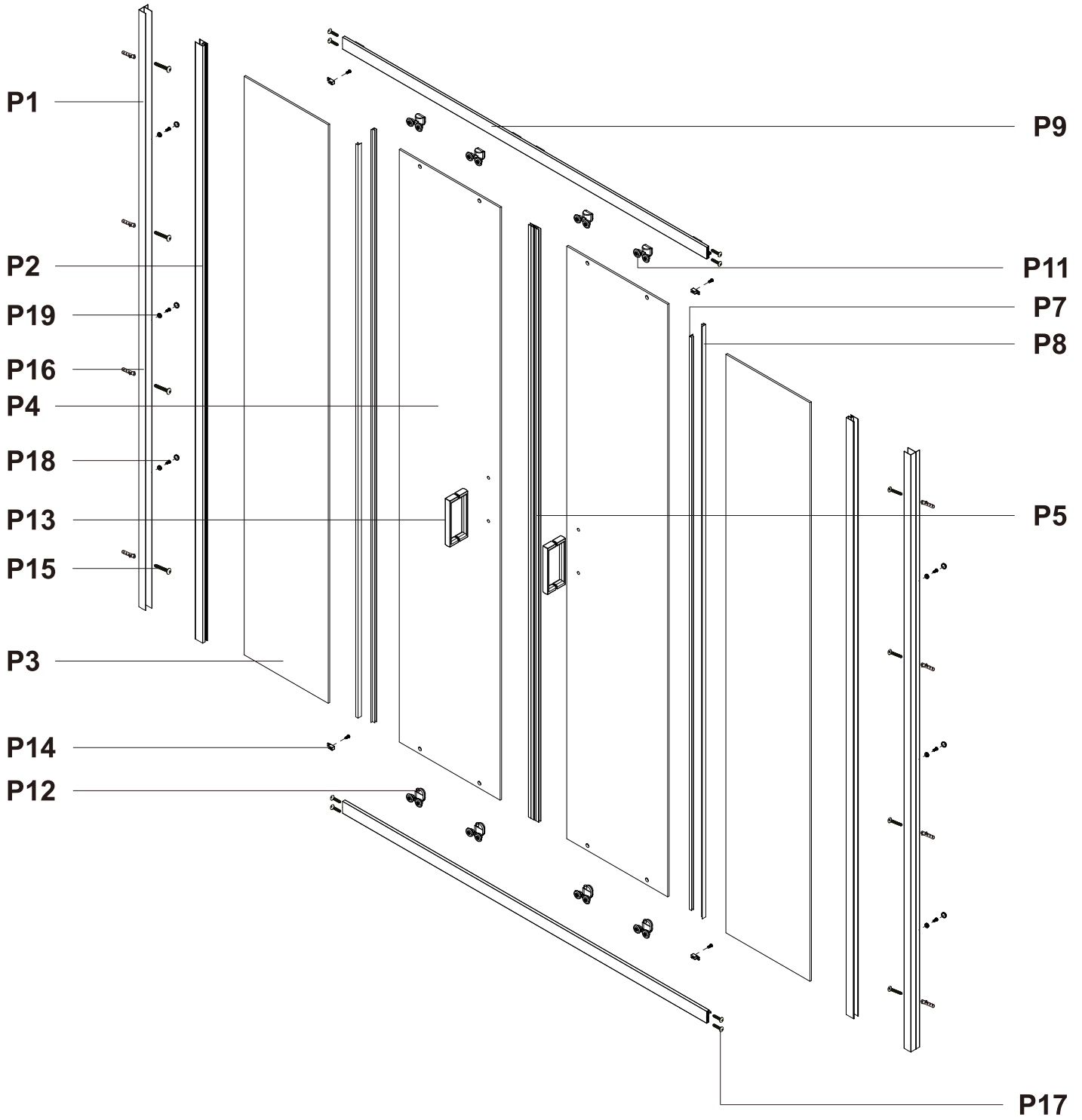
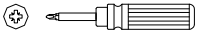

1

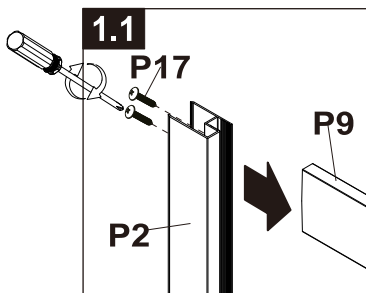
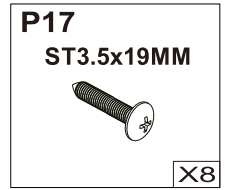
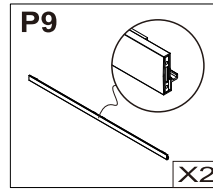
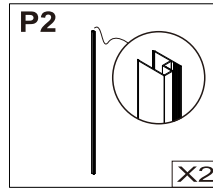
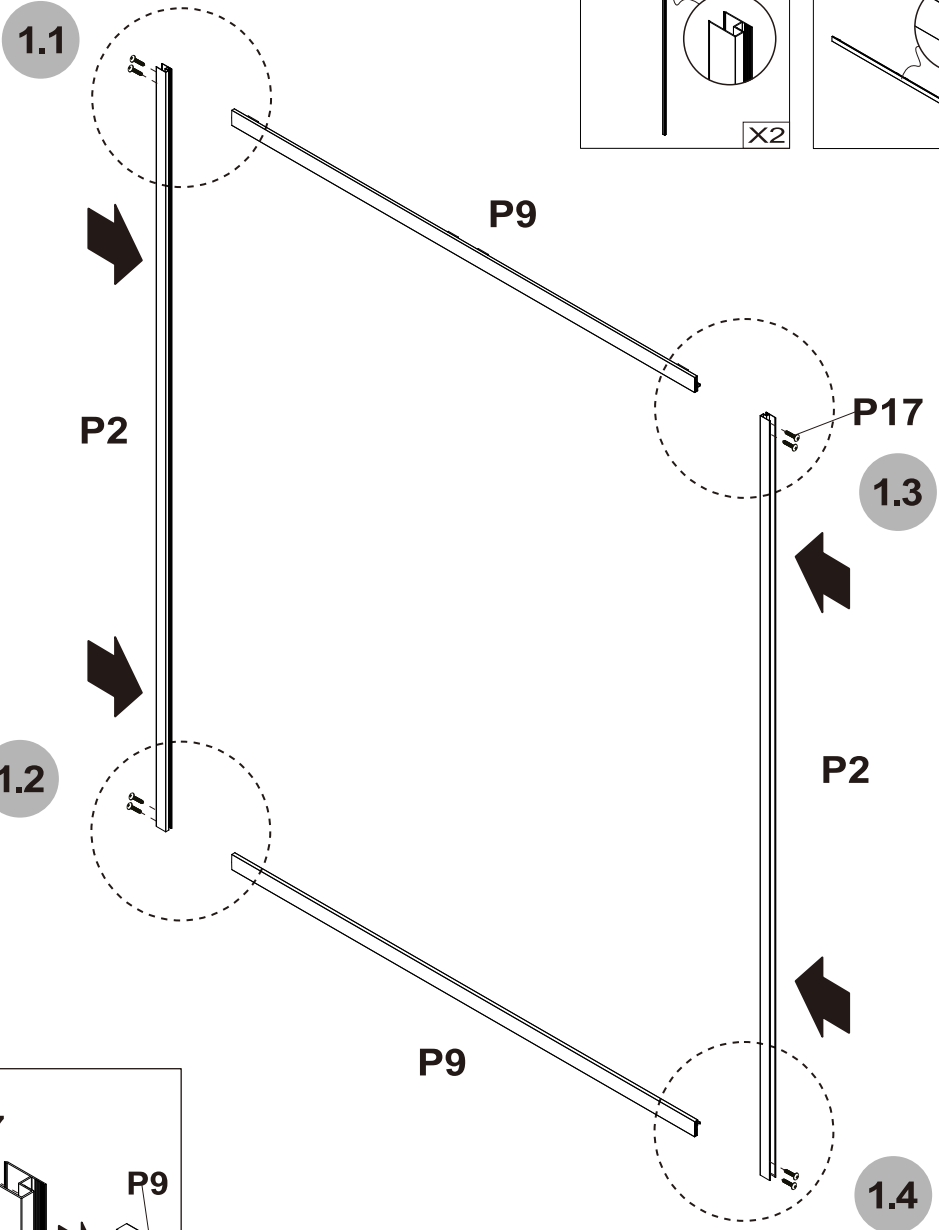

First, install the edge trim and track.

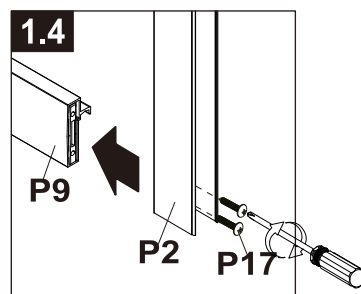
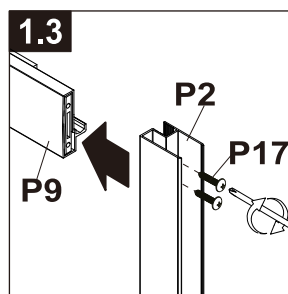
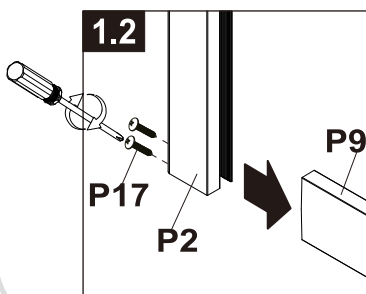

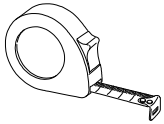
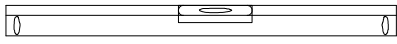

2

2.1

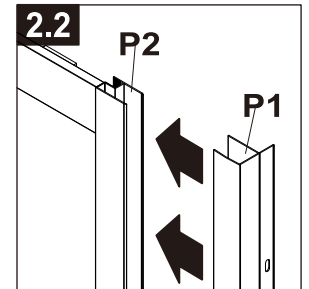
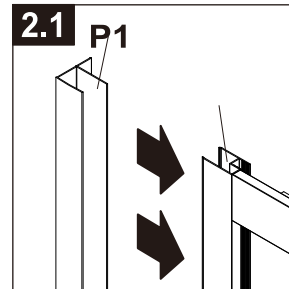
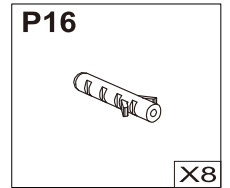
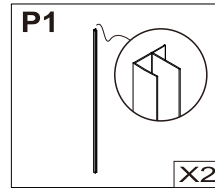
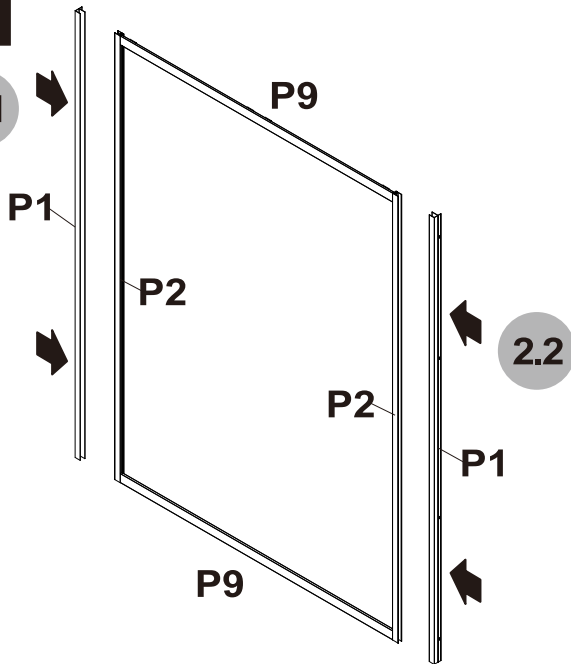

1480-1520
1180-1220

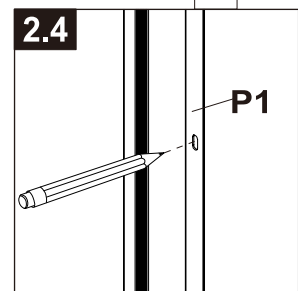
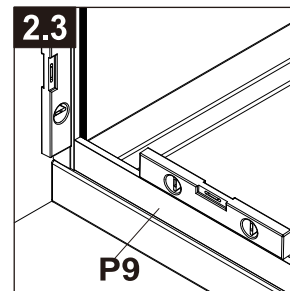
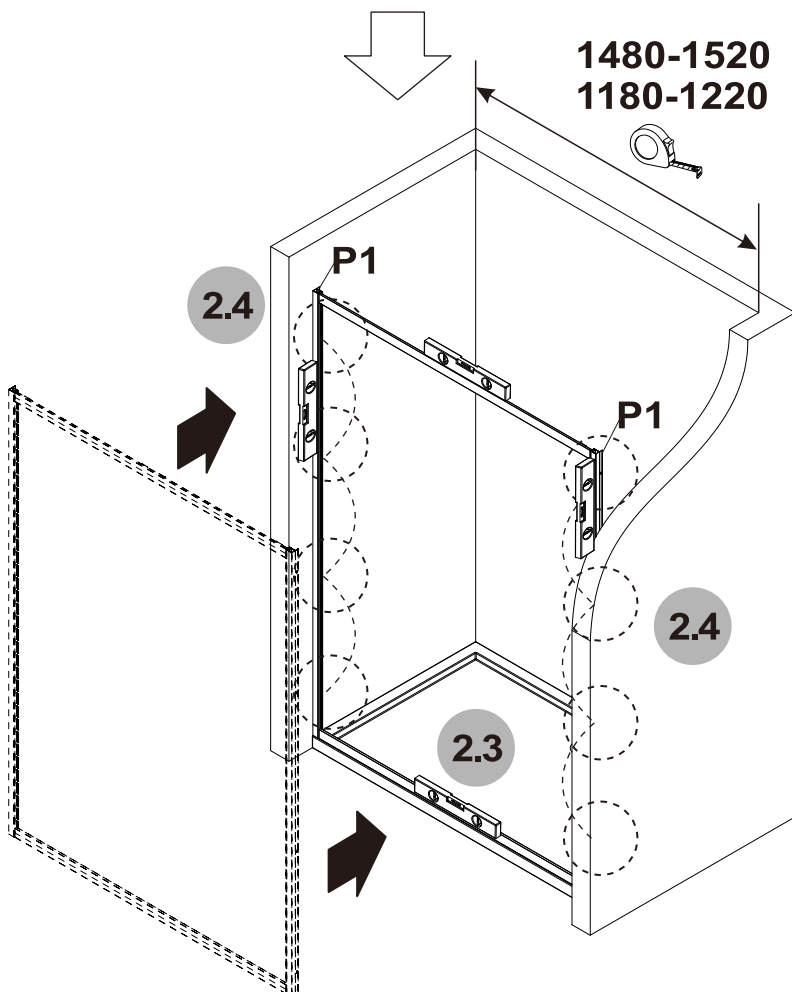

X8

Assemble side strips to the frame without permanent installation. Verify positioning and mark drilling points prior to final mounting.

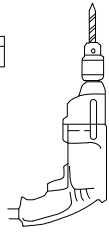
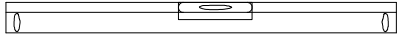

6mm

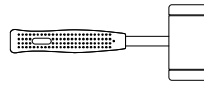

3

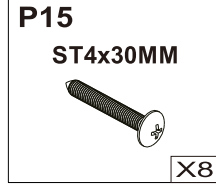
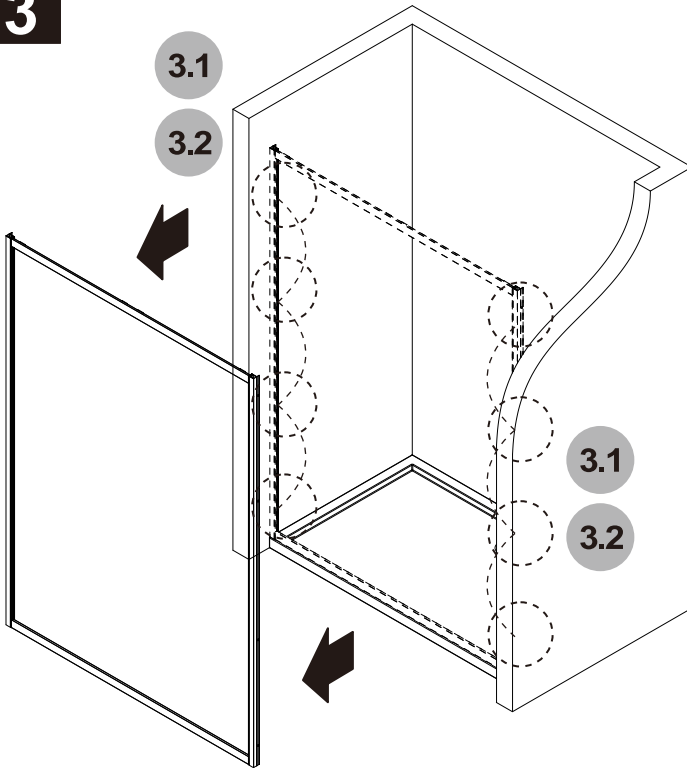

X8

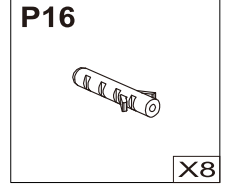

X8

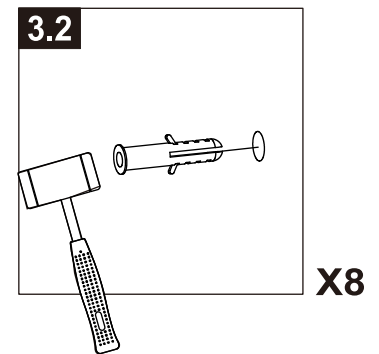
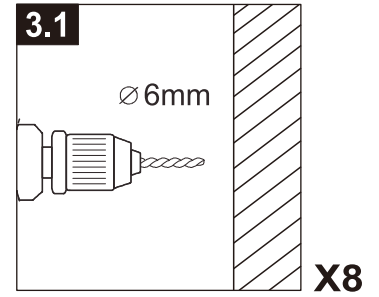

Remove the assembly components and set them aside; then, use an electric drill to create holes at the marked positions; insert the expansion tubes into the drilled holes.

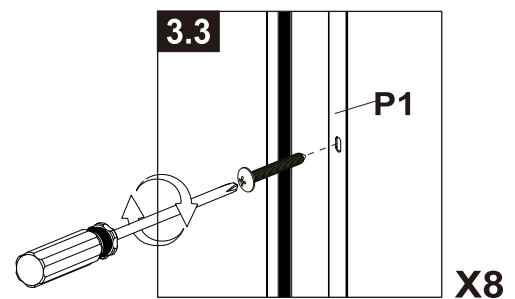
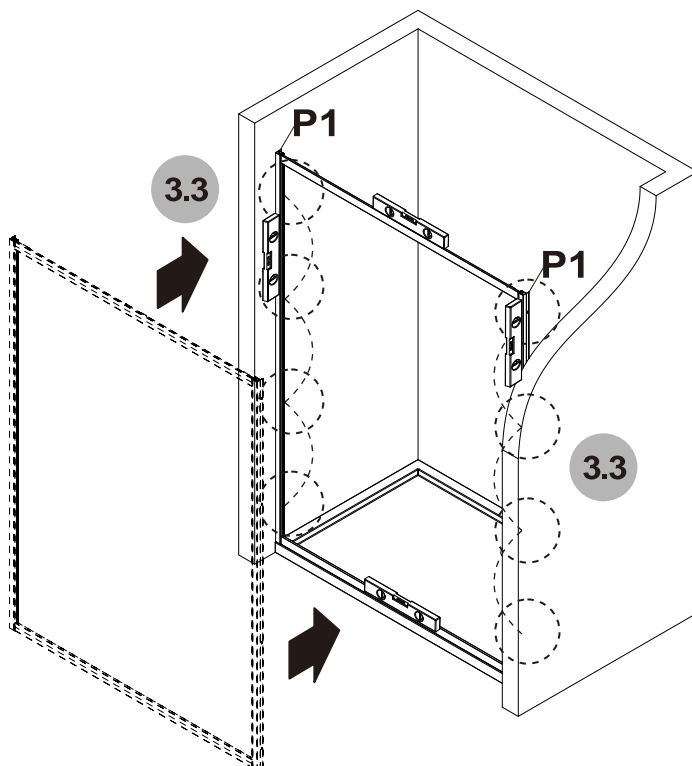

Reposition the assembly components to the previously aligned location; secure them to the wall with screws.

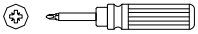

4

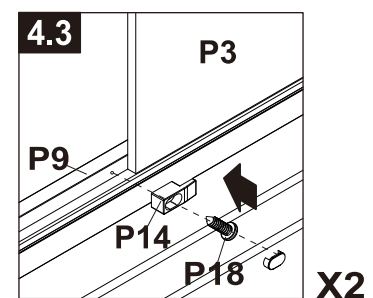
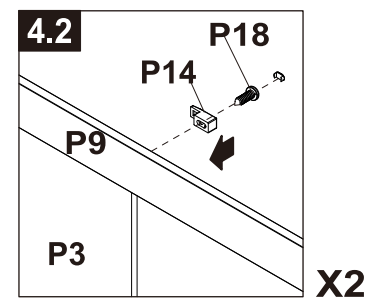
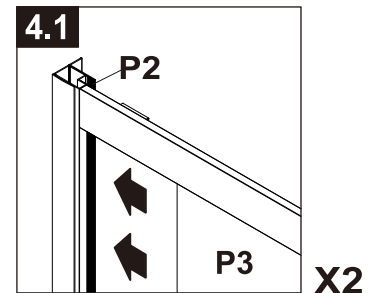
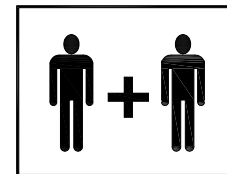
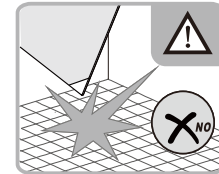
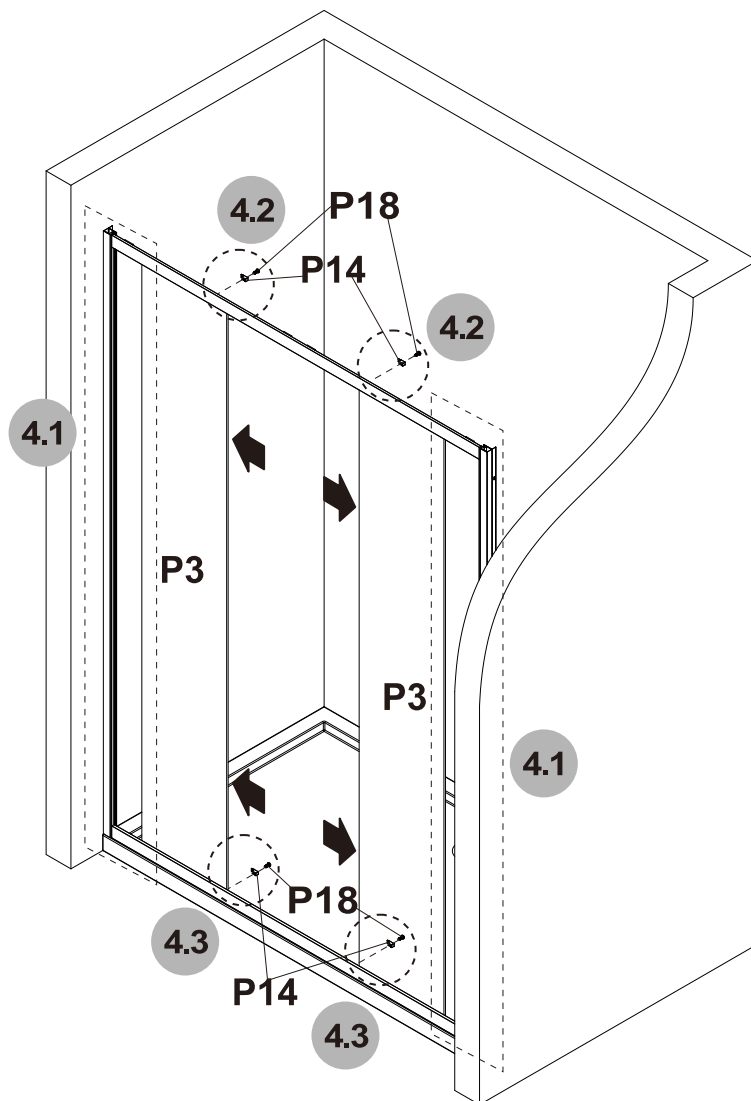
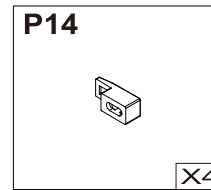
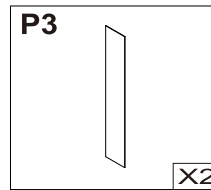

Install the fixed glass panels;
secure them with 6mm retainer strips.

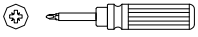

5

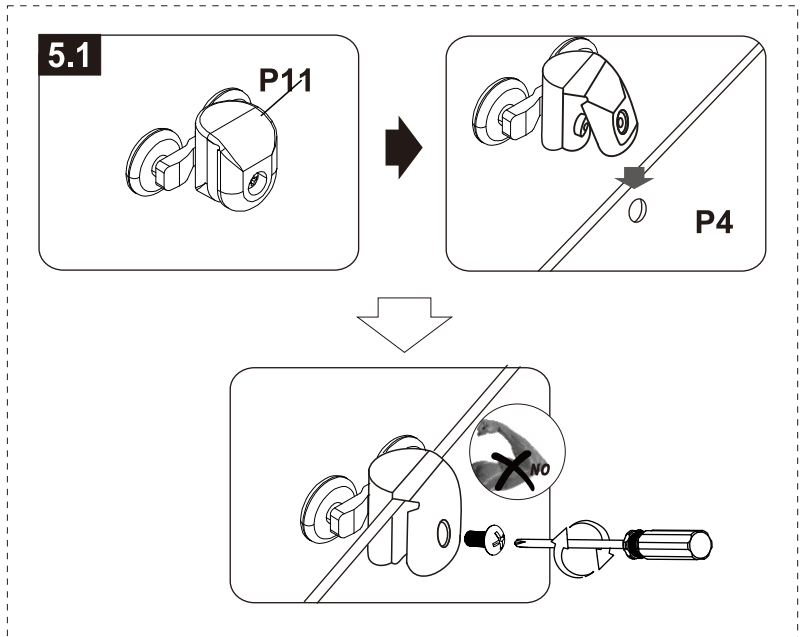
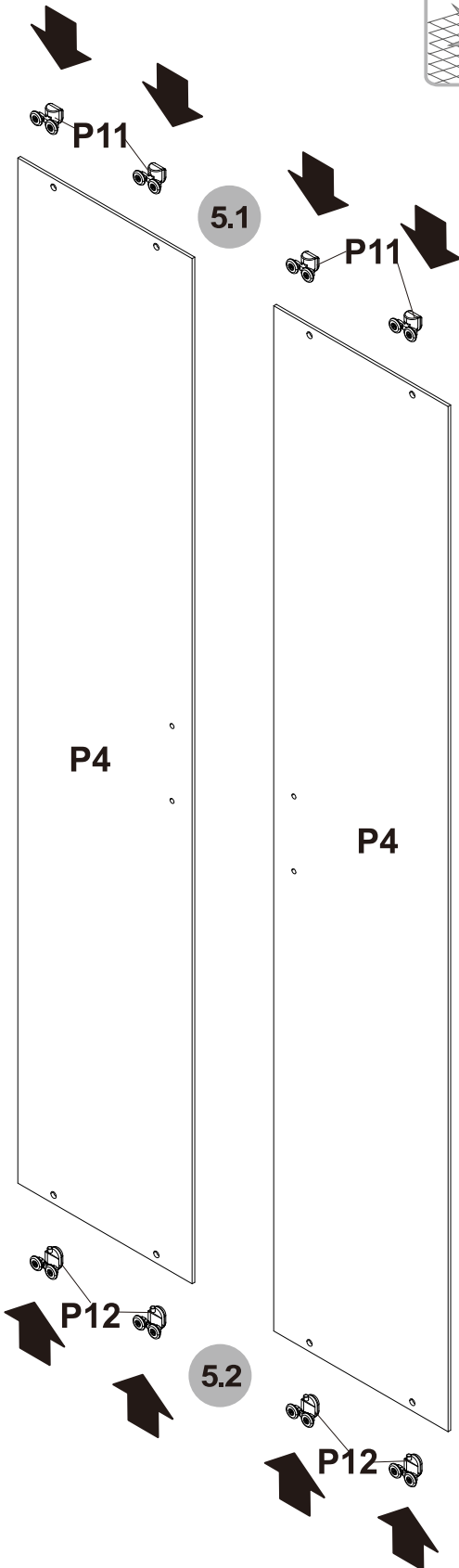
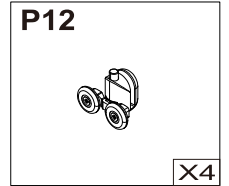
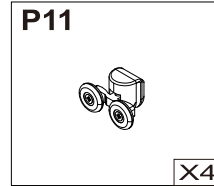
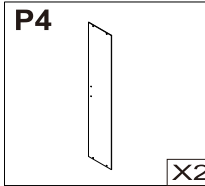
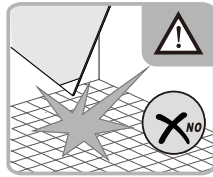

X4

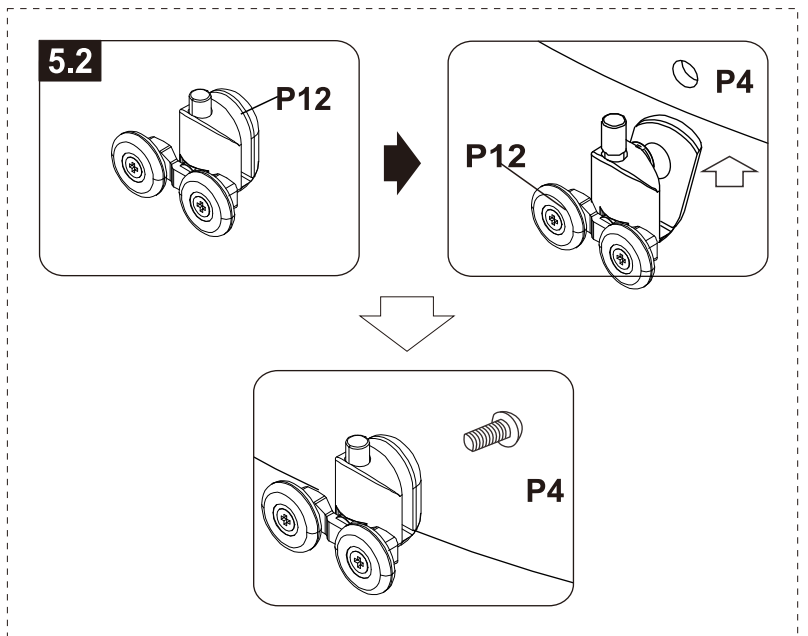

X4

**Install the upper and lower pulleys;
assemble with two movable glass panels.**

6

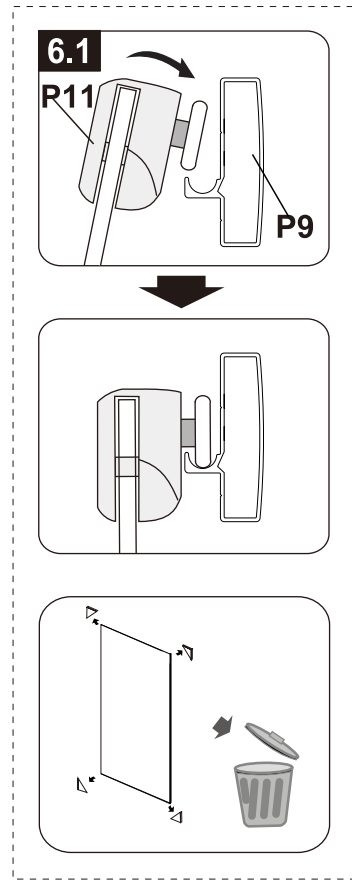
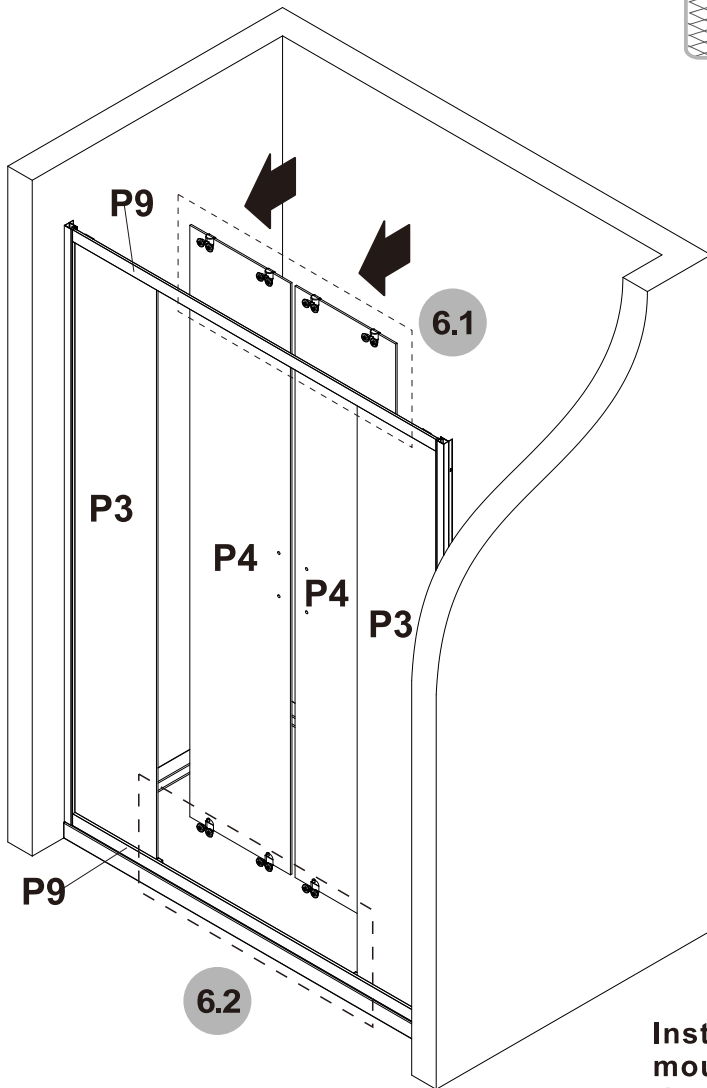
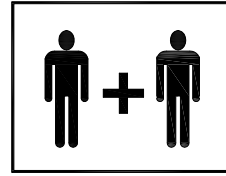
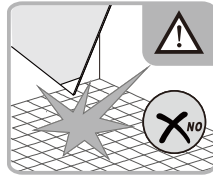

Install the movable glass panels; mount the upper pulleys onto the upper track first; then install the lower pulleys into the lower track while pressing the pulley release buttons.

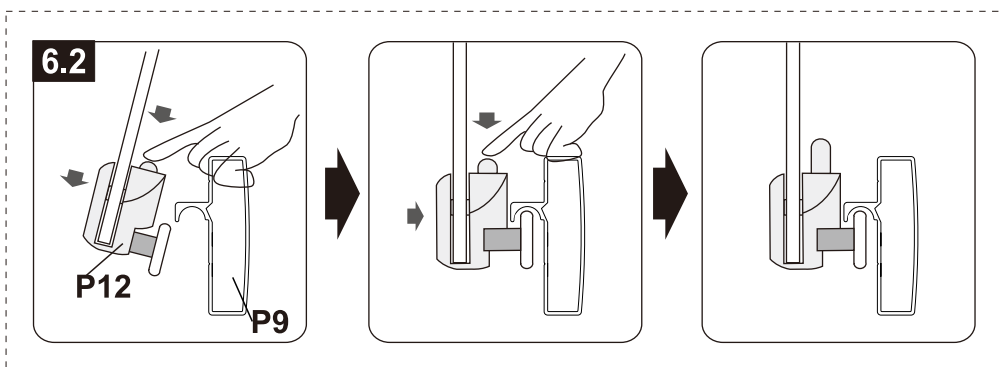

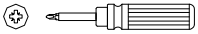

7

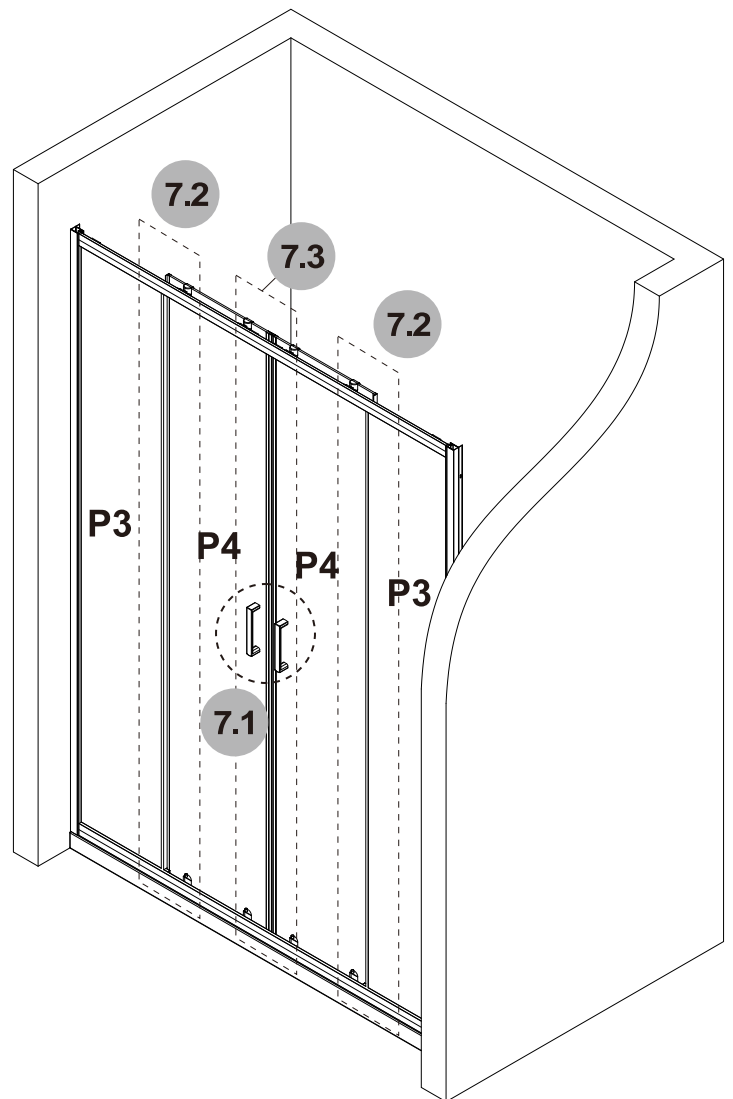
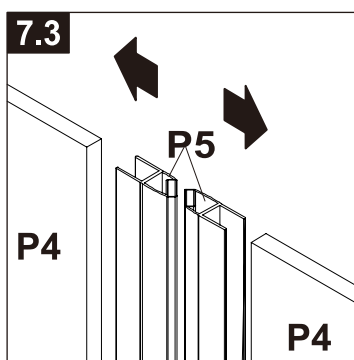
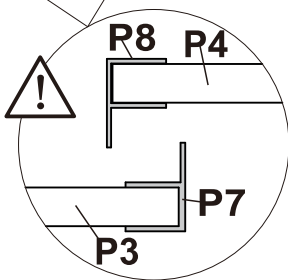
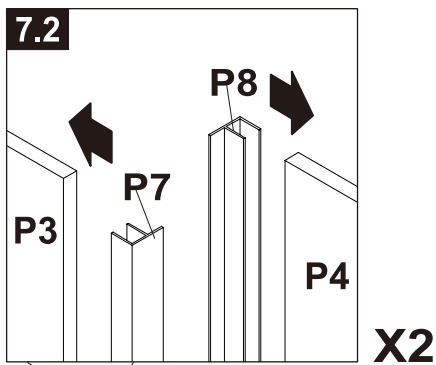
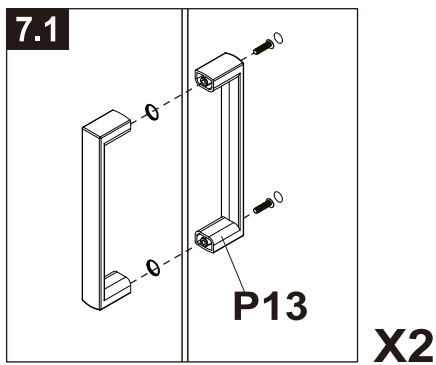
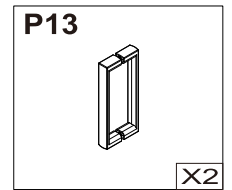
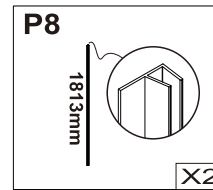
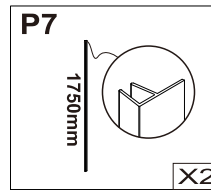
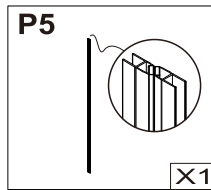

Install the handle onto the movable glass; assemble the waterstop strip according to product codes; then mount both magnetic strips.

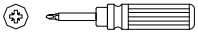

8

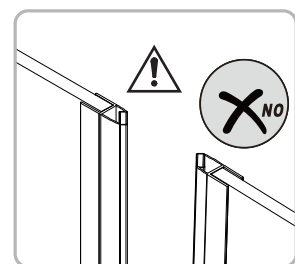
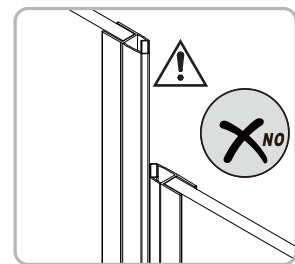
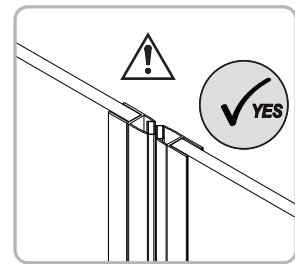
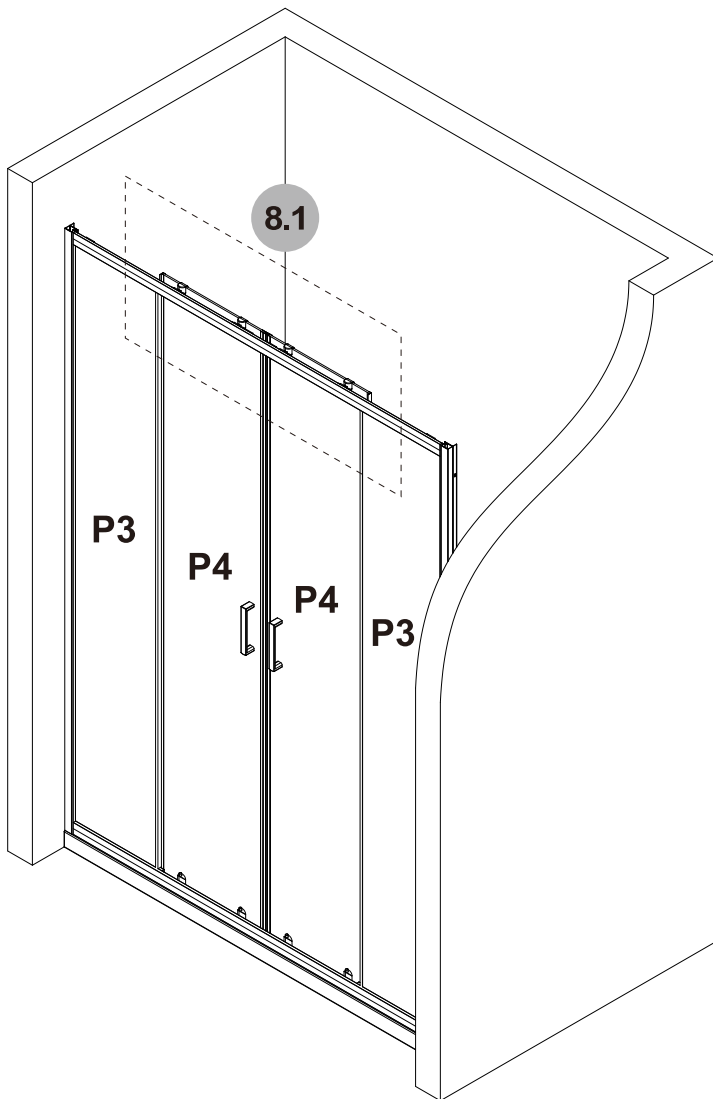
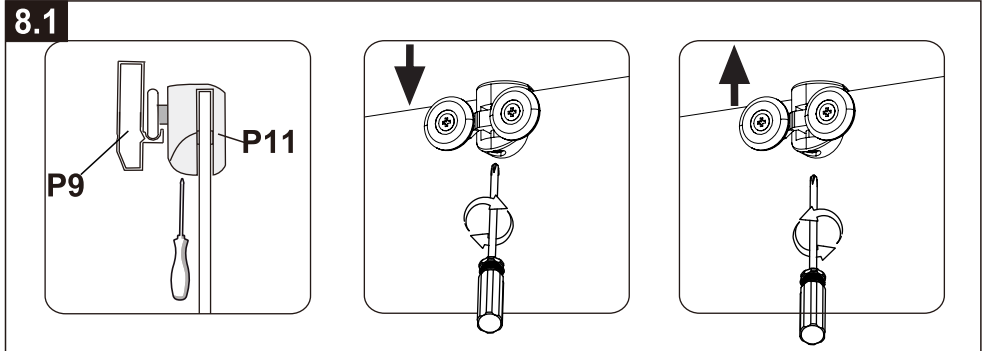

Adjust the screws on the upper pulleys with a screwdriver to fine-tune the position of the movable glass panels; align both sliding door panels.



9

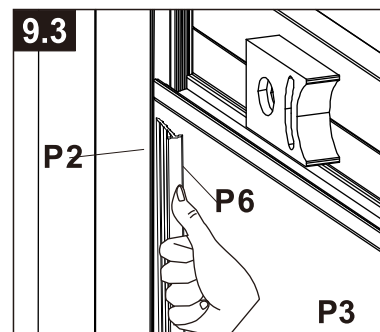
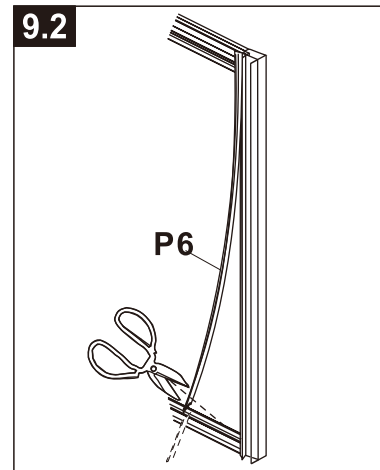
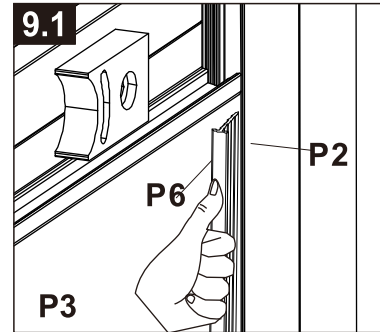
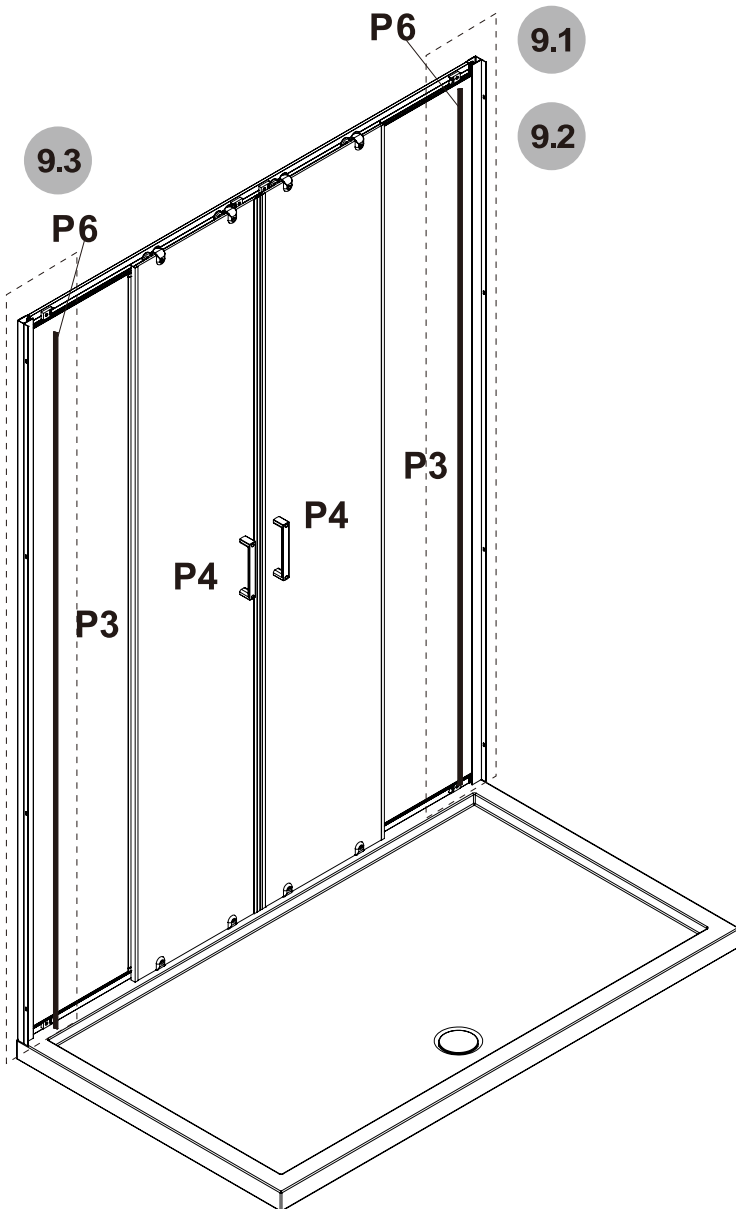
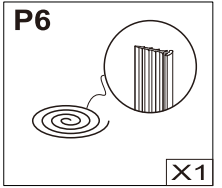

Insert the weatherstrip into the frame gap; trim the excess with scissors; insert into the opposite frame gap.

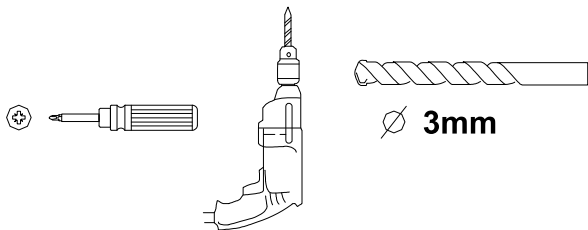

10

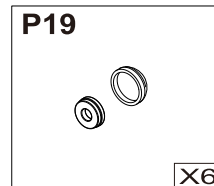
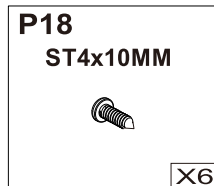

Position the frame strip and edge profile within their adjustable range; drill holes at designated points on the shower-side profile and strip to the specified depth; install screws with concealing caps.

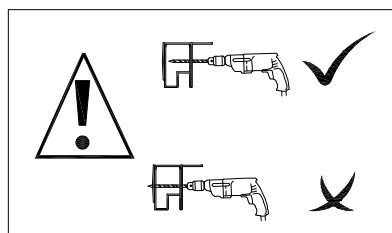
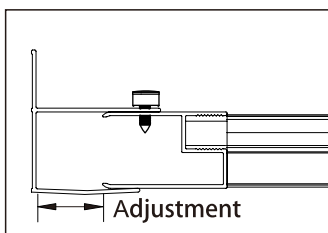
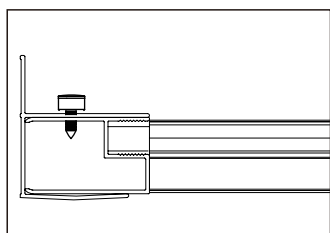
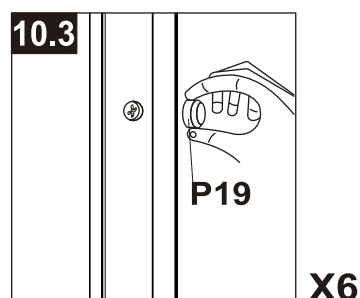
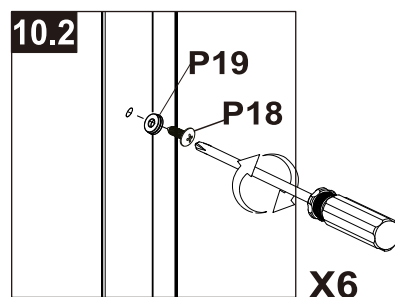
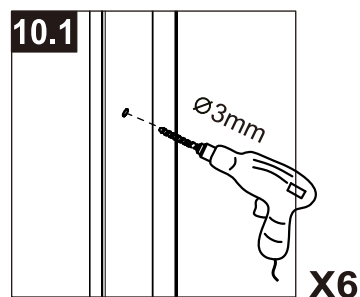
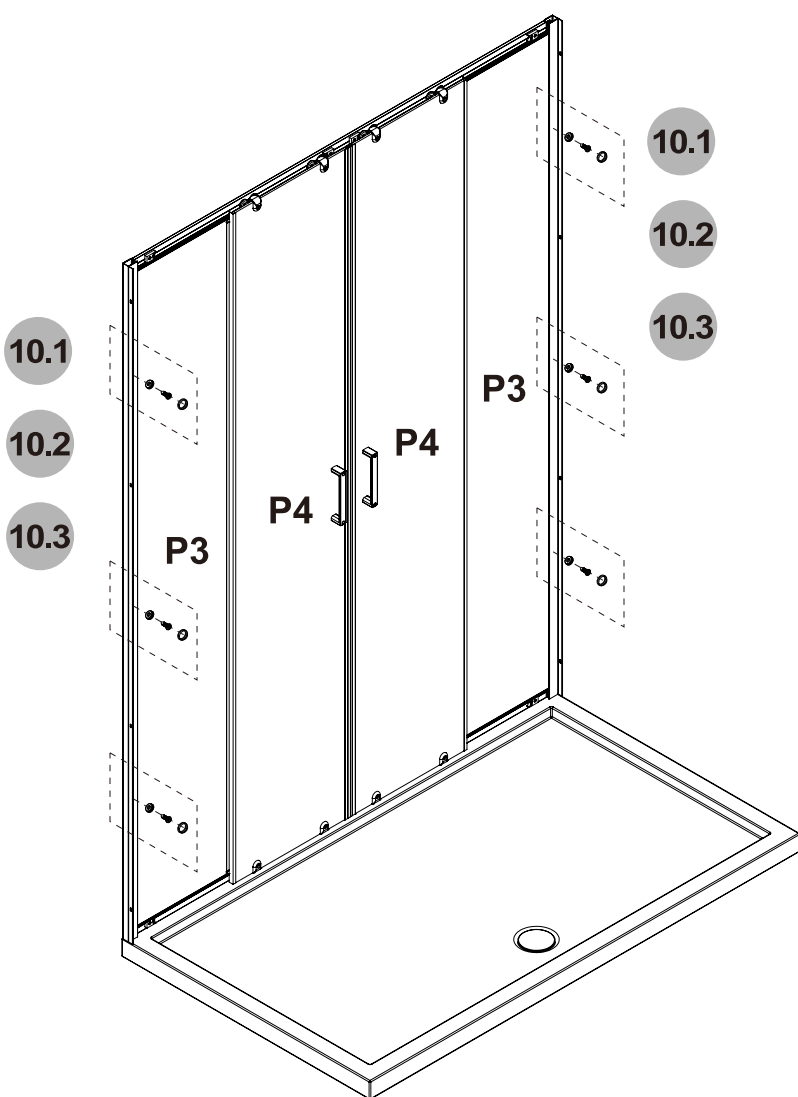

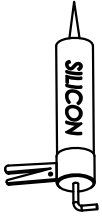

11

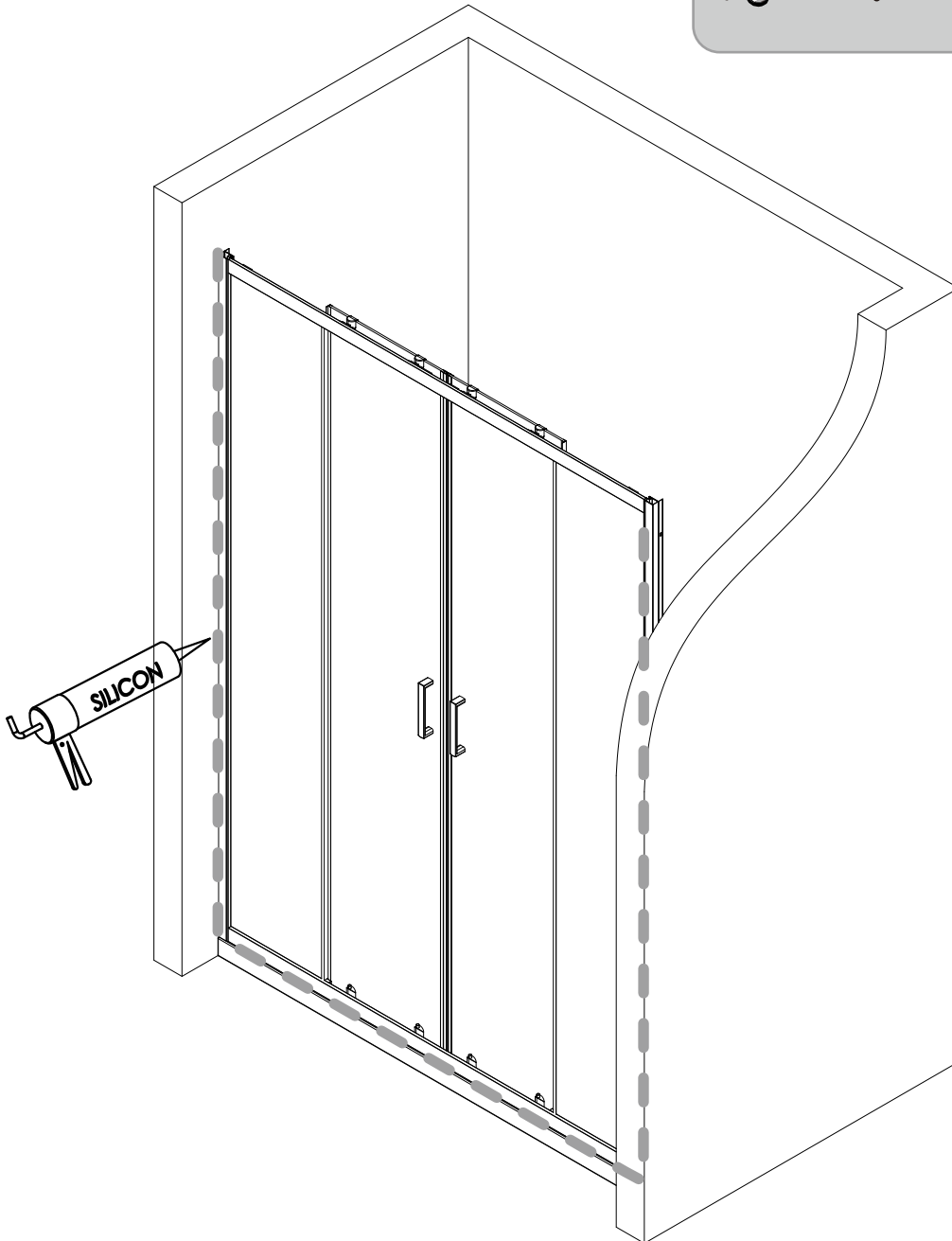
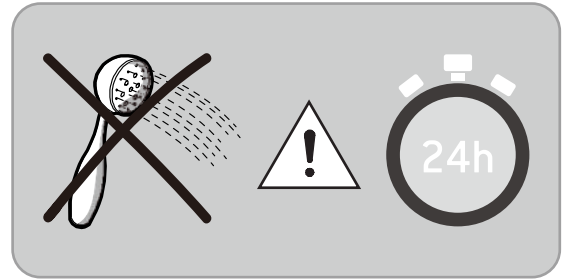

Apply silicone sealant to gaps between the outer frame, wall, and shower tray; allow 24 hours curing time before water exposure.