

Customize Your Look

Add an insert to your Tailor™ farmhouse sink with five easy steps.*

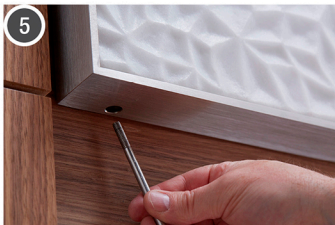
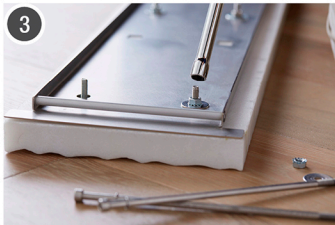

1

INSTALL STUDS

Place the insert face down. Thread in the six studs.

2

POSITION CARRIER

Align the carrier over the insert so the studs go through the holes.

3

TIGHTEN FASTENERS

Place a washer and then a locknut onto each stud. Tighten securely.

4

POSITION INSERT

Gently place the insert into the apron pocket.

5

SECURE INSERT

Slide a bolt with lock washer through each of the pocket holes. Ensure each bolt engages with the threads at the top of the pocket and tighten with Allen wrench (provided). Ensure insert is centered in apron.

* Steps may vary based on materials. Please refer to installation instructions for complete details.

THE BOLD LOOK
OF **KOHLER**®