

Installation instructions

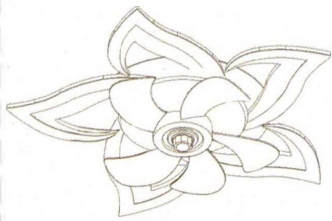

Effect picture after installation

This is the central point of the lamp

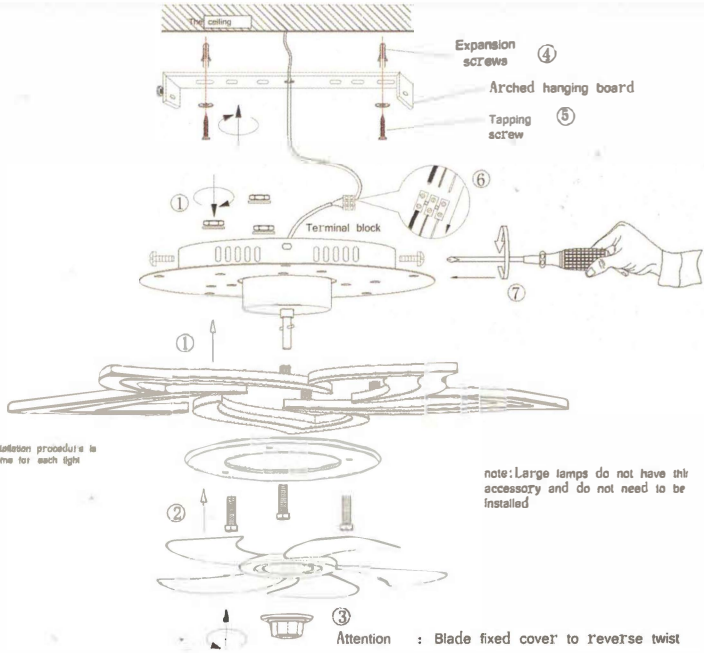
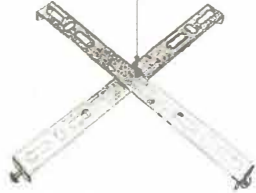

Schematic diagram of cross hanging plate

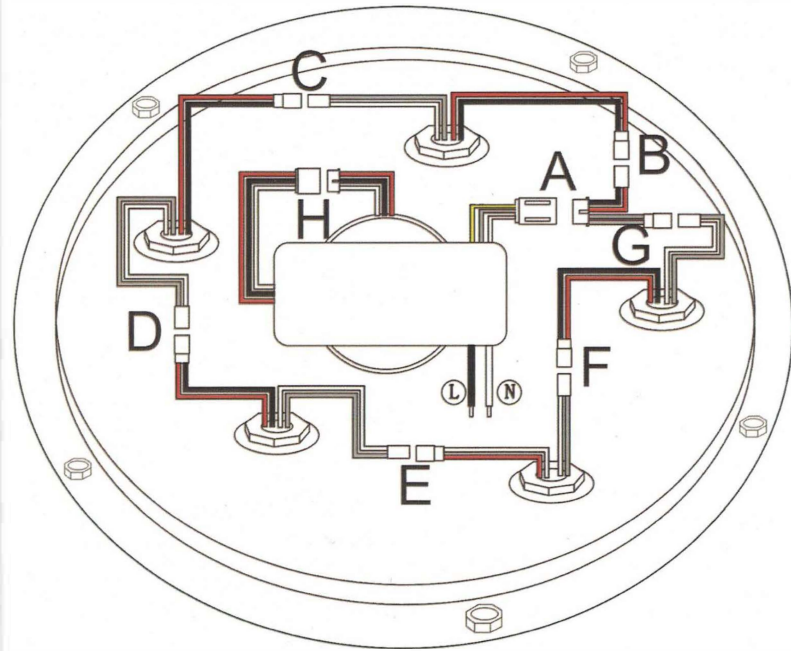

2.4G DC Fan Light Controller Specifications

Production process

This product adopts 2.4G digital remote control wireless technology, one-to-one remote control, simple and convenient operation, strong anti-interference ability

Technical Parameters :

Model: .4G AC Fan Light Controller

Wall switch sequence: full light/white light/yellow light

Input voltage: AC100-240V 50/60Hz

Output voltage: DC70-110V

LED output power: 25-36W

Rated motor power: <25W

Wind speed: 1-6 gears

Duration: 1 hour/2 hours

Receiving mode: RF2.4G

Remote control distance: 8-20 meters

Remote control battery 7 1.5V X2

Remote control matching code:

Turn on the power and press and hold the pairing button of the light within 5 seconds, when you hear a "beep" or the light flashes, the code matching is successful. If you need to match the code a second time, wait 30 seconds before turning on the power and repeat the above operation.

Warning:

The electronic switch is not an insulated product and must be handled by a professional when installed. The electronic switch is activated by the remote control, which has a transmitter with a radio frequency of 2.4 GHz.



APP Operation

1. Download APP Scan the QR code → open the browser → >select the version to be downloaded
2. Open APP → select room → click + to select "Fan Lamp" → enter device name (e.g. Fan Lamp) → OK
3. Click to input
 1. Language (Chinese and English are optional)
 2. Scanning (scan each other's QR code to share device control)
 3. My 1 QR code (can share with each other)
 4. room management (can add room name)
 5. Instructions (select the second interface fan light, various device symbols of the use of instructions)
 6. check for updates
 7. Input feedback points

