

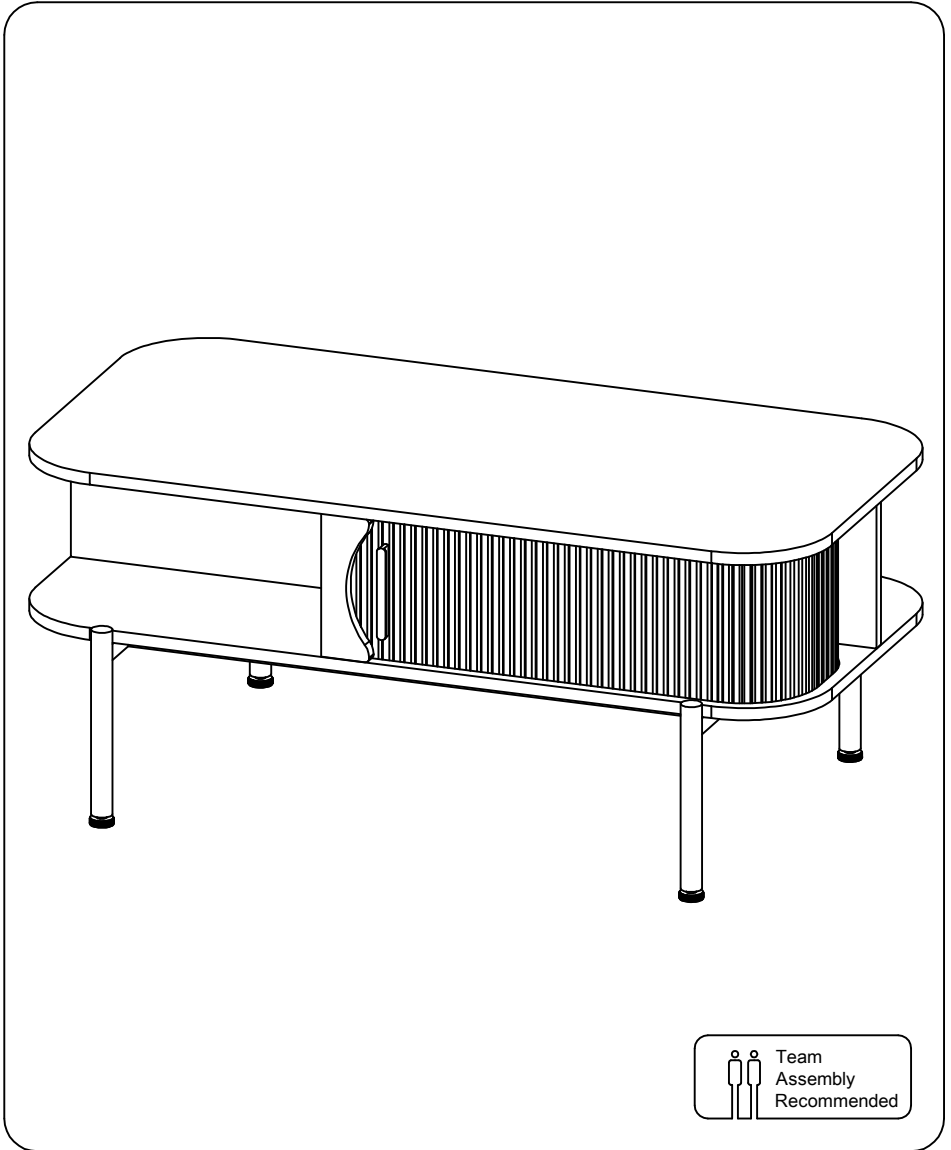

USER'S MANUAL



 Team
Assembly
Recommended

Before You Start



1. Read each step carefully and follow the correct order.

2. Separate and count all parts and hardware.

3. Leave enough space for the assembly process.



4. Prepare the following tools: Flat Head Screwdriver, Cross Head Screwdriver and Hammer.



5. Note: If you use an electric drill or electric screwdriver to tighten the screws, please be careful to slow down and stop when tightening the screws. Otherwise, the screws may fall off.

(Using an electric screwdriver can increase assembly speed).

Useful Tips

Assembly Personnel Required: 1-2 People

- Unpack the item in the area where you plan to store it to avoid excessive lifting.



- Identify, sort, and count the parts before attempting assembly.

- Use a hammer to gently tap in the compression pins.



- The sliders are marked with R (right) and L (left) for proper placement.



- Make sure to always point the tip of the top of the cam lock toward the outer edge.



- If there is a back panel in the package, install it to ensure your unit is complete and sturdy.



- Tighten all the screws provided for the back panel, which can enhance the stability of the product. If it is difficult to tighten, you can use a hammer to secure it and then tighten it.



- Do not use harsh chemicals or abrasive cleaners on this item.

- Never push, pull, or drag your furniture.

Board Identification

Not actual size

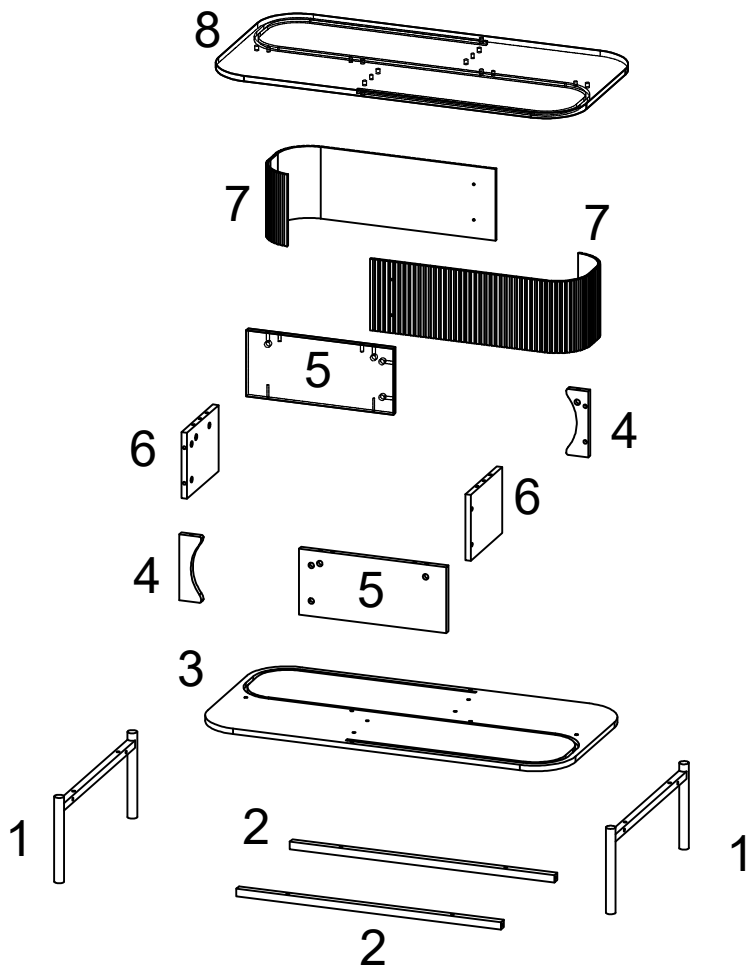

Note: Don't tighten all screws during installation.

Board Identification

Not actual size

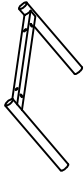

1

Qty:2

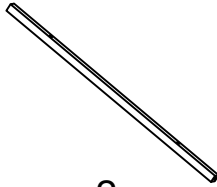

2

Qty:2

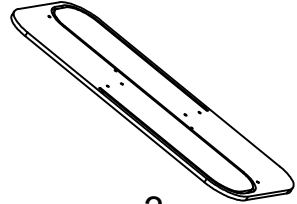

3

Qty:1



4

Qty:2

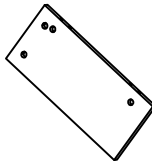

5

Qty:2



6

Qty:2

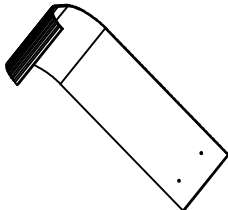

7

Qty:2

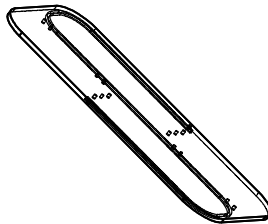

8

Qty:1

4

Parts List



M6

(A)

X4



(B)

X2



Ø4mm

(C)

X4



M6*40mm

(D)

X18

spare:1



Ø15mm

(E)

X18



M6*35mm

(F)

X4



Ø8*30mm

(G)

X6



M4*8mm

(H)

X4

spare:1

spare:1

spare:1



M6*40mm

(J)

X10



M6*30mm

(K)

X8



M4

X1

spare:1

spare:1

Parts List

Cam Lock Fastening System

insert the cam bolt into
the hole first, then insert
the cam lock and lock it.

1

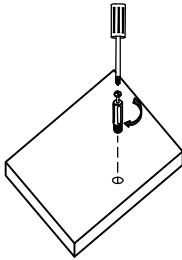

2

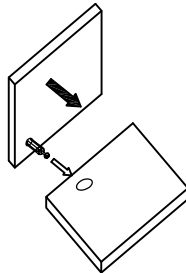

3

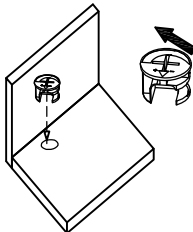

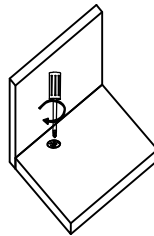

The opening must point toward
the edge of the board

4



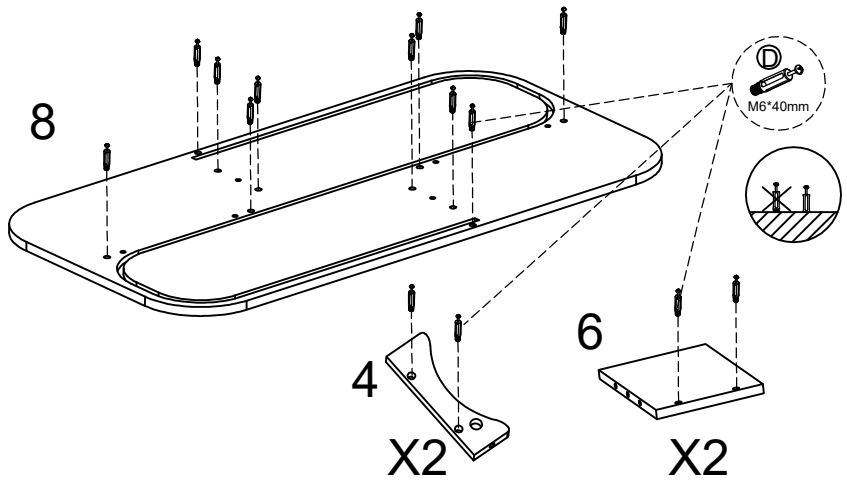

Step 1

	M6*40mm		M4
ⓑ	X18		X1



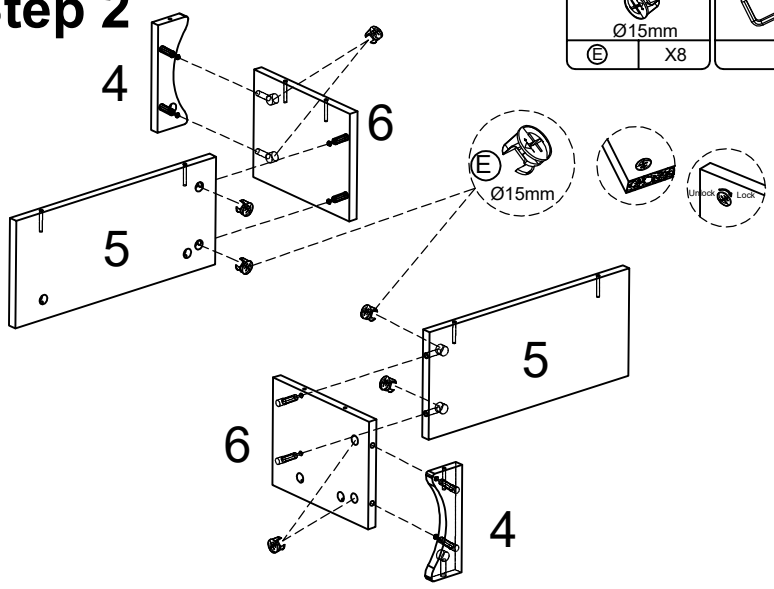

Step 2

	Ø15mm		M4
ⓔ	X8		X1



Step 3

	Ø8*30mm
Ⓒ	X6

	Ø15mm
Ⓔ	X10

	M4
	X1

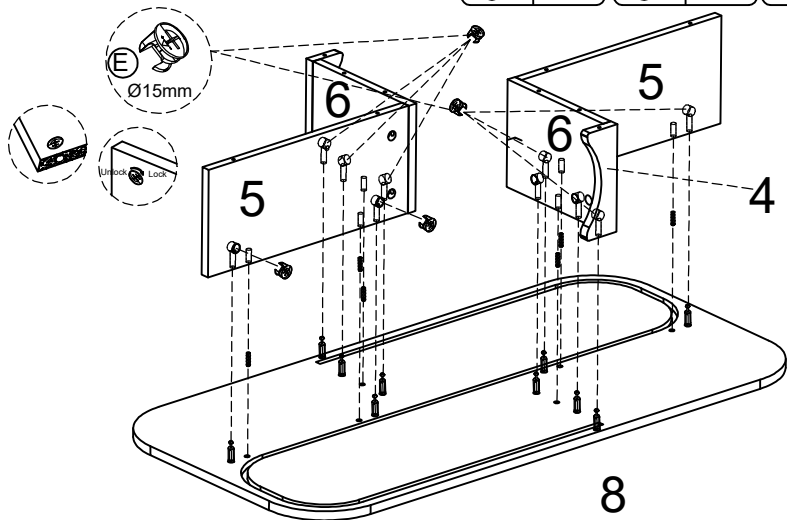

Step 4

	Ø4mm
Ⓐ	X4

	M4*8mm
Ⓕ	X4

	M4
	X1

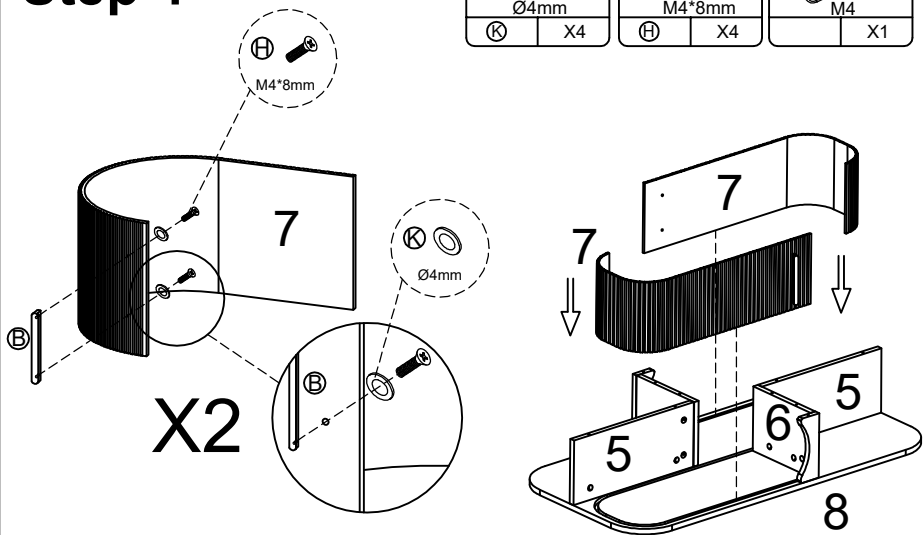

Step 5

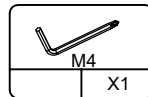
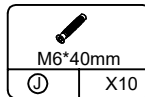
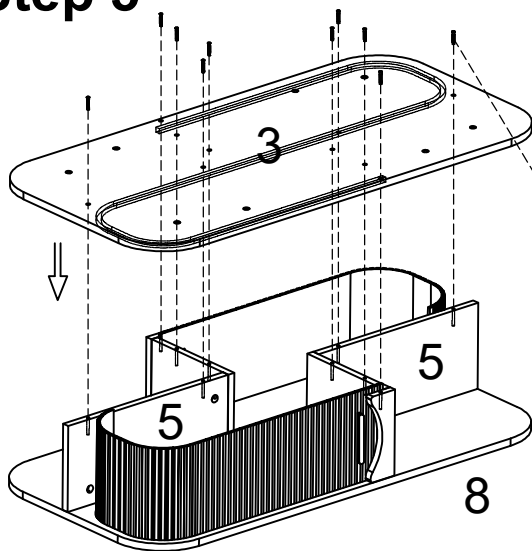

Step 6

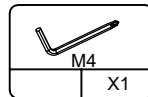
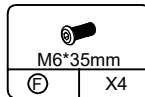
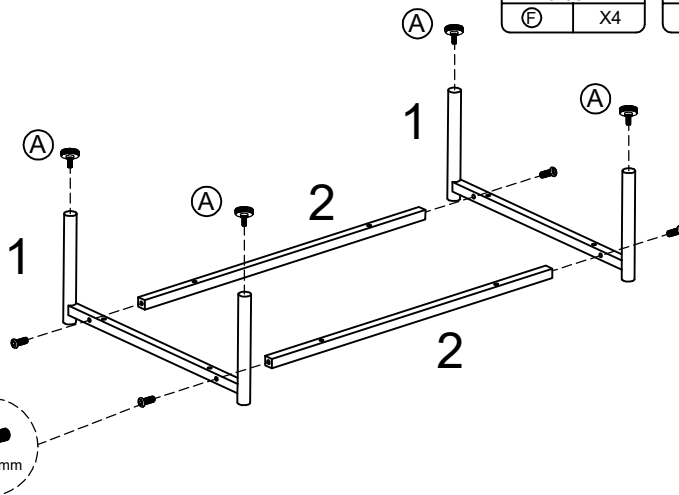

Step 7

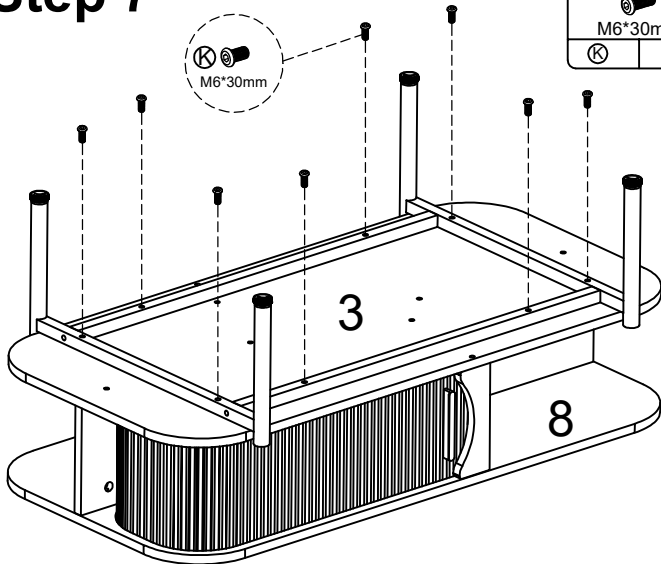

Step 8

