



**Assembly Instructions**  
**SKU#M5132**

Thank you for your purchase. Before discarding packaging material be sure you have located all the parts including the necessary hardware and tools listed on the instructions below.  
**Caution:** Read before unpacking assembly parts. Sharp exposed staple tips can cause injury. For your protection please remove any exposed staples used in packaging.

**HARDWARE LIST**

	
<b>AX2</b>	<b>BX2</b>
<b>SCREWS</b>	<b>PLASTIC CORK</b>

**WARNING**

**For Wood or Studs**



**Plaster or Sheet Rock**

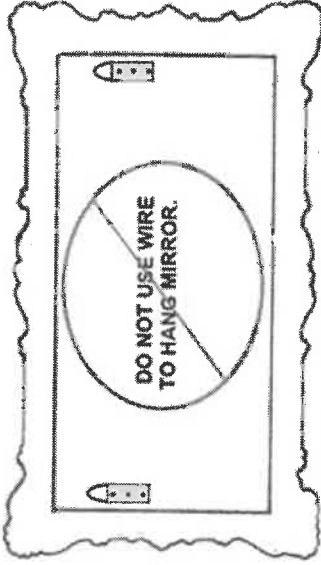
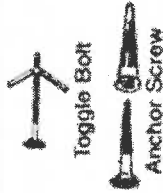

To avoid damage to Mirror please do not use wire, use the 2 hanger method.

**The Two Hanger Method**  
 All Bassett Mirror frames are of sturdy construction, but to protect your wall and extend the life of your mirror always use the two hanger method.

**CUSTOMER HELP LINE FOR ASSEMBLY**

(276) 629-3341 EXT 3206  
 THANK YOU FOR YOUR PURCHASE

**Assembly Instructions**  
**SKU#M5132**

Thank you for your purchase. Before discarding packaging material be sure you have located all the parts including the necessary hardware and tools listed on the instructions below.  
**Caution:** Read before unpacking assembly parts. Sharp exposed staple tips can cause injury. For your protection please remove any exposed staples used in packaging.

**DIAGRAM ASSEMBLY**

**A: CEMENT WALL / DRY WALL**

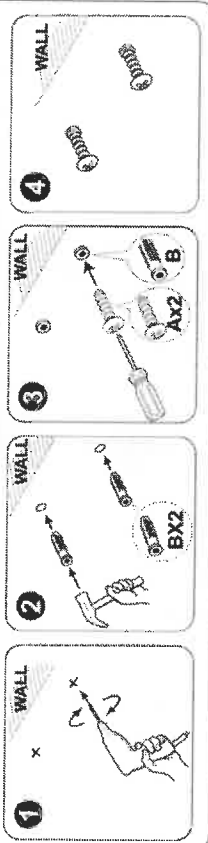

**B: WOOD WALL**

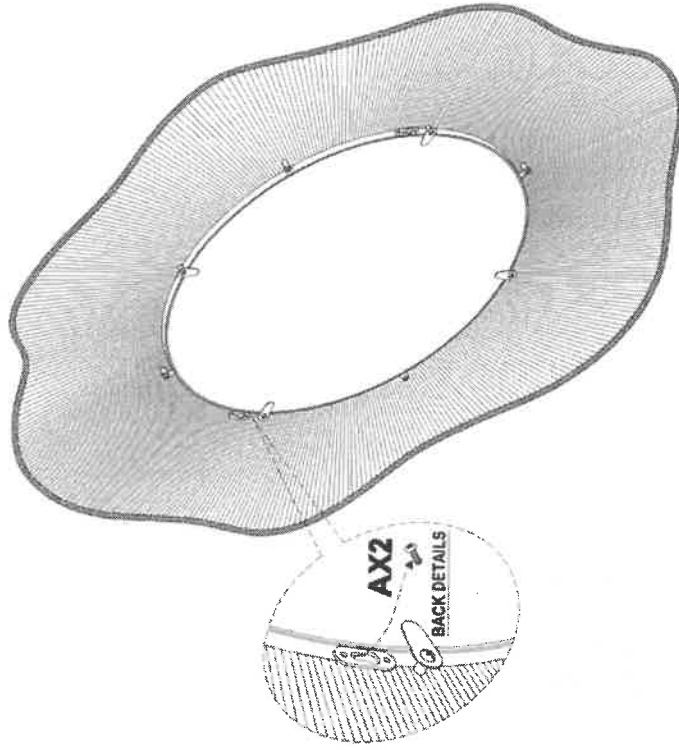
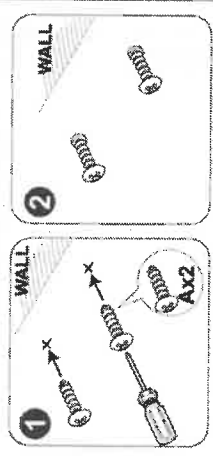

**CUSTOMER HELP LINE FOR ASSEMBLY**

(276) 629-3341 EXT 3206

THANK YOU FOR YOUR PURCHASE