

design TOSCANO®

INSTRUCTIONS FOR PRODUCT

Thank you for your recent purchase of this Design Toscano hand crafted piece of sculptural art. We have taken great care to create this piece especially for you. Please review these instructions and assemble this piece with care.

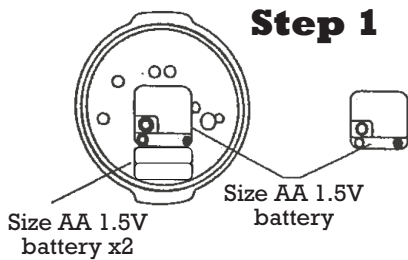

Step 1

Size AA 1.5V
battery x2

Size AA 1.5V
battery

Step 1

Unclip battery cover.
Insert batteries (not supplied)
as shown and adjust time, then
replace the battery cover.

Step 2

Unscrew the fastening nut (B) from
the base of the support bracket (A)
and then put the bracket through the
arm on the statue and fasten nut (B)
finger tight.

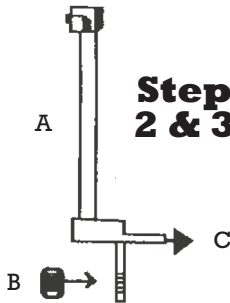

Step 2 & 3

Step 3

Unscrew nut (C) from front of
support bracket and position the
pendulum onto the 2 cups provided
(take care to position correctly) and
refasten the nut (C) back into place.

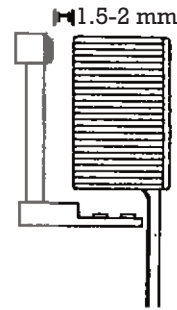

Step 4

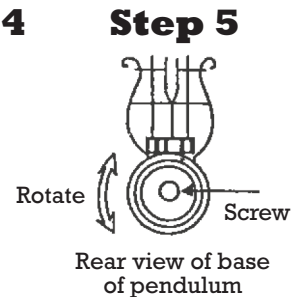

Step 5

Step 5

Gently push the pendulum to start the
swinging action. There is an additional
adjustment at the base of the pendulum
to "balance the pendulum."

The back of the base of the pendulum
rotates to adjust the counterbalance
weight - if required. This can be rotated
to help equalize the swing.
(NOTE: It may be necessary to slacken
the securing screw on the rear of the
pendulum before doing this.)

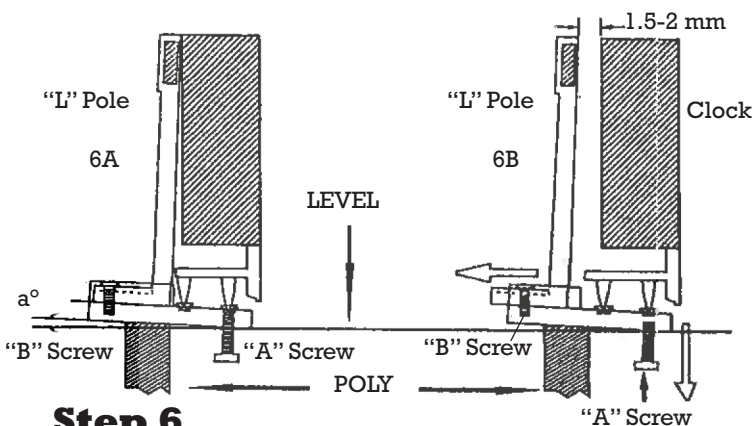

Step 6

If the pendulum is not level as shown in picture 6A then you may need to move the "L" pole slightly left. This is achieved by screwing down screw "B" to make the pole "L" vertical and the gap to the clock 1.5-2mm. You can also slide the pole "L" back and forth to achieve the correct gap as shown in picture 6B.

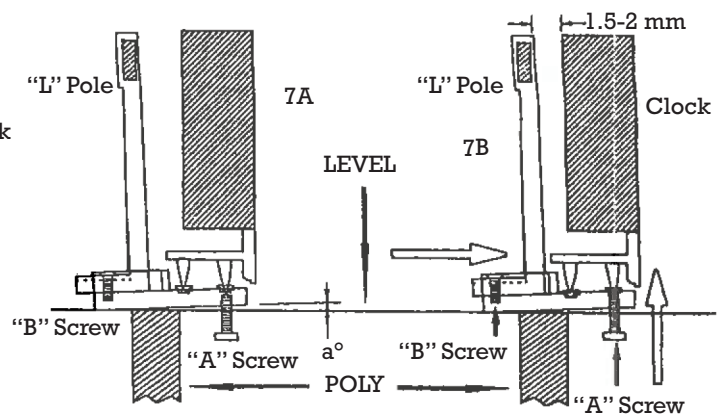

Step 7

If the pendulum is not level and looks similar to picture 7A then the pendulum may not swing properly. You need to adjust screw "A" to make the pendulum look like picture 7B with a gap of approximately 1.5-2mm. Note screw "B" should be adjusted to make sure the "L" pole is absolutely vertical.