

How make this handheld holder angle work properly if my water outlet is flat or vertical?

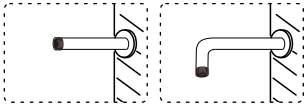

2mm Hex driver

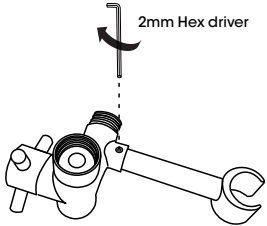

Please Scan QR Code to Watch Video

1. Remove the original shower head and clean shower arm.

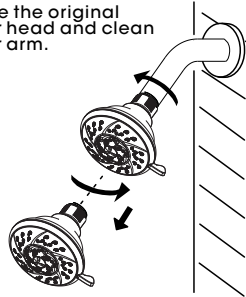

2. Wrap the shower arm with teflon tape.

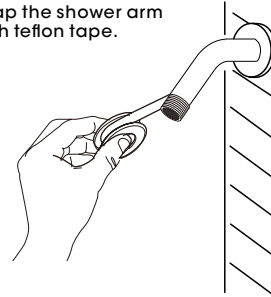

3. Put the washer on diverter. Connect the diverter and shower arm on horizontal position.

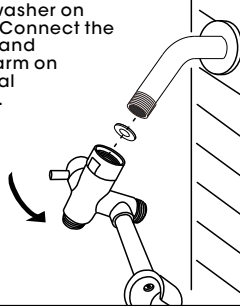

4. Tighten free spinning nut clockwise with wrench. Tighten the hex nut on free spinning nut for stability.

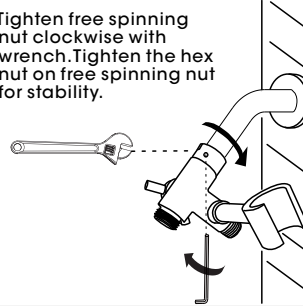

5. Preset washer, fix shower head connect diverter.

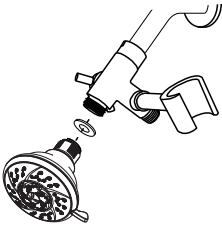

6. Hex nut connect diverter, conical nut connect handheld shower head.

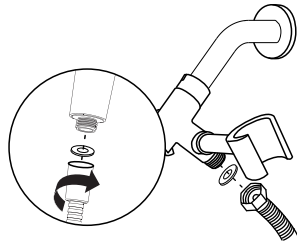

7. Turn on water supply and check all threaded connections for leaks. If leaks occur, tighten connection with an Adjustable Wrench or by hand. Check Diverter for proper operation by turning the side handle backward and forward to activate the Fixed or Hand Showers.

SHOWER DIVERTER

Installation instruction

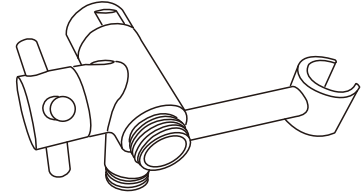

MB/BN/CH

CARE INSTRUCTIONS

Rinse the product with clear water. Dry the product with a soft cloth.

DO NOT:

Use abrasive cleansers, cloths, or paper towels. Use any cleaning agents containing acid, polish, wax, alcohol, ammonia, bleach, solvent or any other corrosive or harsh chemical cleansers.

