

FINGERPRINT CABINET LOCK

USER MANUAL

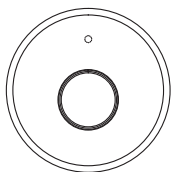

Feature

1. Biometric sensor, high sensitive and rapid responsive
2. Max 10 fingerprints to hold for multiple users
3. E-Key for emergency key and management
4. PC panel with elegant design
5. Surface mounted, widely used in drawer, cabinet, wardrobe etc.

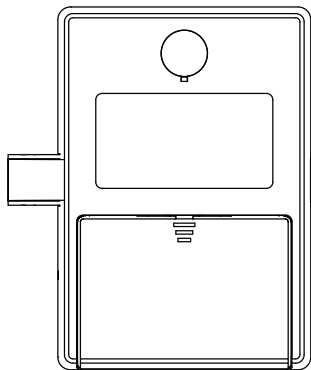

Automatic Mode

1. How to add new fingerprints

- Put a registered finger on sensor, green light and latch retracts, holding, green light and latch comes out, keep holding, green light on, then remove
- Blue light, put a finger on, green light then remove
- Put the finger on, green light then remove; repeat until a long green light for 2 seconds (The fingerprint is registered)
- Blue light, add more new fingerprints

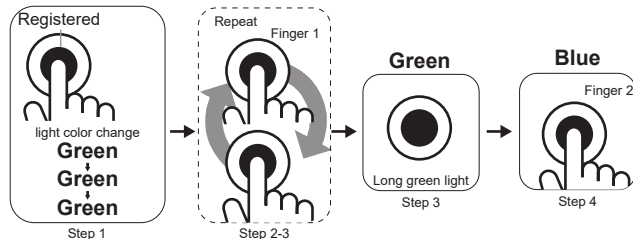

Note

- 1). Make sure add the fingerprint before using. Any finger can unlock in the factory setting
- 2) In order to keep the lock work well, to add no less than 3 fingerprints

2. How to delete fingerprints

- Put any registered on sensor, green light, holding, green light again, keep holding, green light then red light flashed, then remove
- green light for 2 seconds, all the fingerprints deleted



3. How to lock

- Push the door closed, door lock automatically

4. How to unlock

- Put any registered fingerprint on sensor
- Green light, unlocked
- Pull the door open

Other Function

E-Key

1. Insert E-Key
2. Put any finger on sensor, green light on, unlocked
3. Pull the door open



2. Low battery warning

In case of low battery, to put on the registered fingerprint, green light flashes once, and red light flashes thrice, then a long green light, unlocked. To change the battery immediately after door open

Note: Use 3XAAA alkaline battery, not take carbon battery

3. Outer Power Supply

When low battery, can connect power bank or mobile plug for outer power supply

After unlocked, change the battery immediately

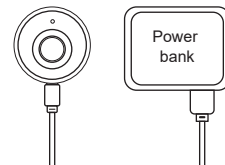

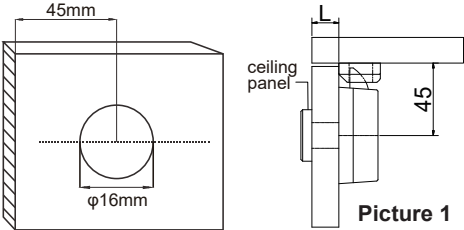

Installation Instructions

1. Put the installation drawing on the door, approx. 45mm between the door frame and center hole (Picture 1), then drill the hole

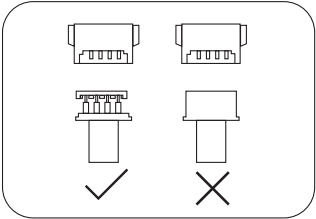

wire connection



	Door Thickness (mm)	Screw
	16mm~20mm	ST3*14

2.1)Insert connecting wire(See picture 2) into the front panel,then wire goes through the centre hole;fix up the panel by screw ST3*14MM.

2.2)Insert connecting wire(See picture 2) into lock case,then fix up by screw ST3.5*18MM.Make sure the distance is 45MM between the centre of lock case and opening wall.

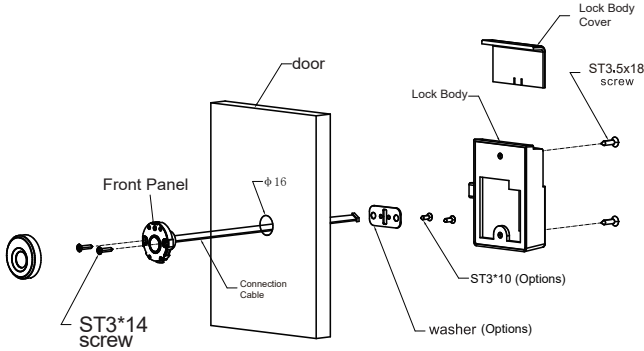

Picture 2

3. Fix the striking plate by screw ST3.5X18 (Make sure latch works well)

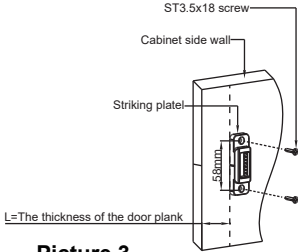

Picture 3

COMPONENT

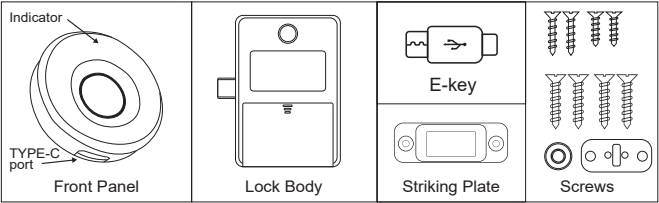

INSTALLATION DRAWING

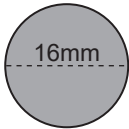

Follow the drawing to drill the hole