

# ASSEMBLY INSTRUCTIONS

## SQUARE EXTENSION TABLE

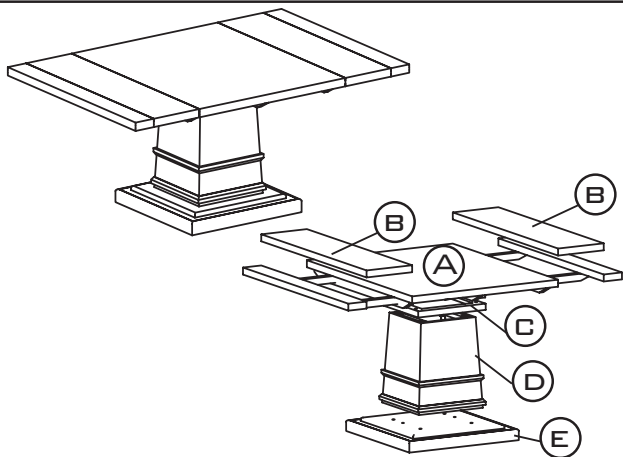

### PARTS CHECK LIST

| CODE | COMPONENTS | QTY |
|------|------------|-----|
| (A)  | TABLE TOP  | X1  |
| (B)  | LEAF       | X2  |
| (C)  | TOP FRAME  | X1  |
| (D)  | CENTER LEG | X1  |
| (E)  | BASE       | X1  |

### FITTINGS CHECK LIST

| CODE | COMPONENTS    | QTY |
|------|---------------|-----|
| 01   | ALLEN BOLT    | X12 |
| 02   | SPRING WASHER | X12 |
| 03   | FLAT WASHER   | X12 |
| 04   | DOWEL         | X06 |
| 05   | ALLEN KEY     | X01 |

- PLEASE DO NOT DISCARD ANY OF THE PACKAGING UNTIL YOU HAVE CHECKED ALL THE PARTS AND THE PACKS OF FITTINGS.
- BEFORE YOU BEGIN TO ASSEMBLE YOUR NEW PIECE OF FURNITURE, PLEASE CHECK TO ENSURE THAT ALL PARTS HAVE BEEN SUPPLIED.
- FOLLOW INSTRUCTIONS CLOSELY AS DEVIATION FROM THEM MAY VOID YOUR WARRANTY AND PRESENT A POSSIBLE SAFETY RISK.
- IT IS RECOMMENDED THAT ASSEMBLY IS DONE ON A SOFT SURFACE LIKE CARPET TO AVOID ANY DAMAGE.
- PERIODICALLY CHECK AND RE-TIGHTEN ANY FASTENERS. WIPE DOWN ALL SURFACES WEEKLY WITH A CLEAN CLOTH. DO NOT CLEAN ANY SURFACES WITH HARSH ABRASIVES OR CHEMICALS.

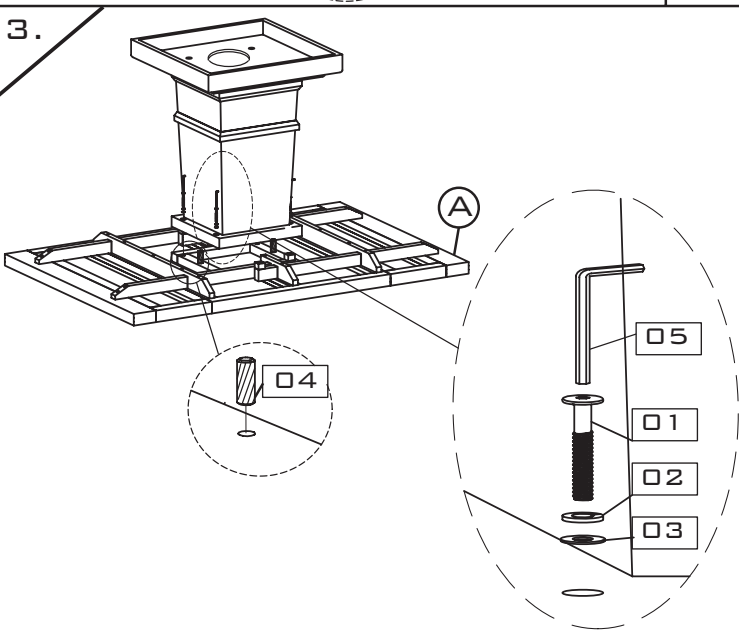
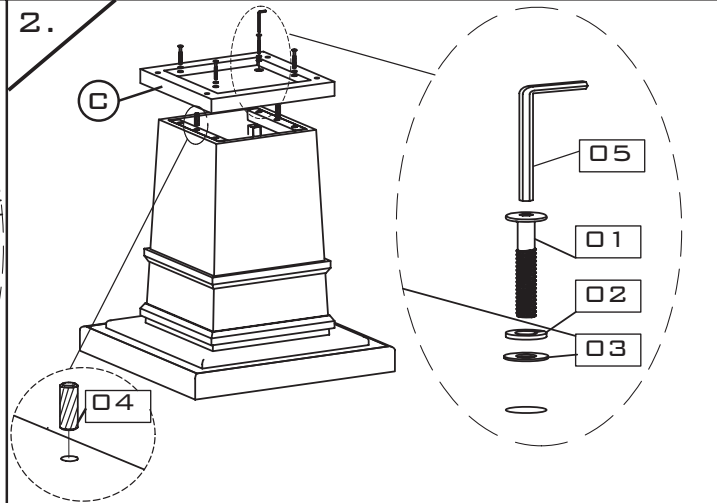
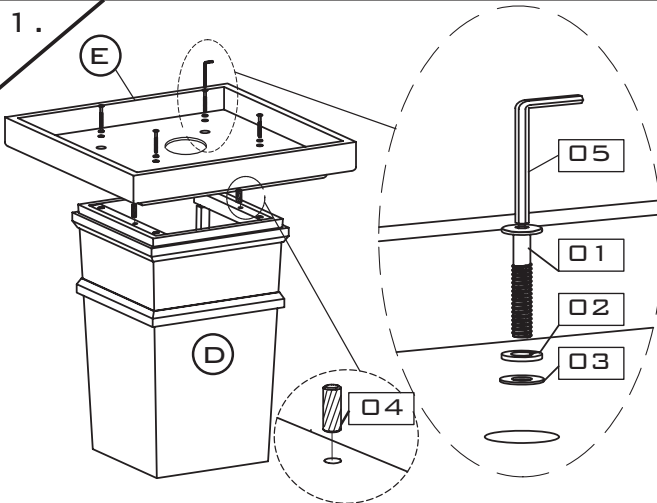

### FINISH

NOTICE:  
DO NOT LIFT TABLE BY THE END CAPS AND WITH OR WITHOUT THE EXTENSION LEAVES IN PLACE

