

Thank you for your purchase! It is our desire to make your entire experience from purchase to installation as easy as possible. We ask that you read each step of this installation manual thoroughly to ensure proper installation of your new Shelf. Our installation techniques are very important. Installing your Shelf in any manner other than the steps outlined in this manual may lead to structural failure of your Shelf.

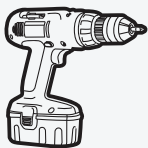

It is your responsibility to see that your Fab Glass Momento Shelf is properly assembled, installed, and cared for. Failure to follow instructions in this manual could result in serious injury. Use this product with Shelf cautions.

**REQUIRED AND RECOMMENDED TOOLS**



Drill/Driver

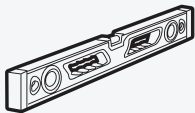

Level



Tape Measure



Screw Driver



Hammer



Lead Pencil

**HARDWARE INCLUDED PER YOUR ORDER**



Bracket  
(Upper Part)



Bracket  
(Lower Part)



Anchor  
(Qty - 4/6)



Screw  
(Qty - 4/6)

1

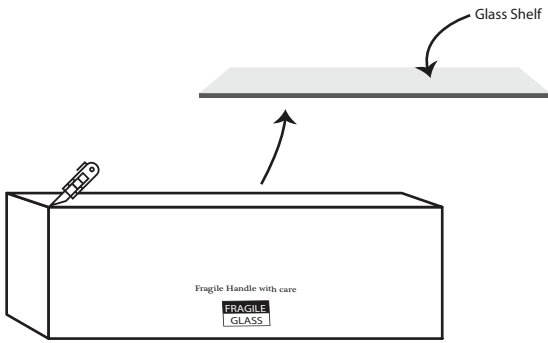

Take your Momento Shelf out of the packaging.

2

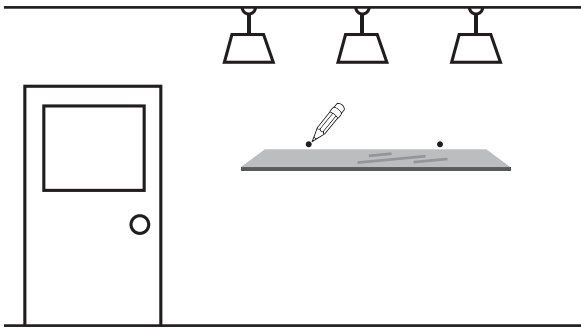

Place Shelf on wall you want to install and mark two holes upper side of shelf.

3

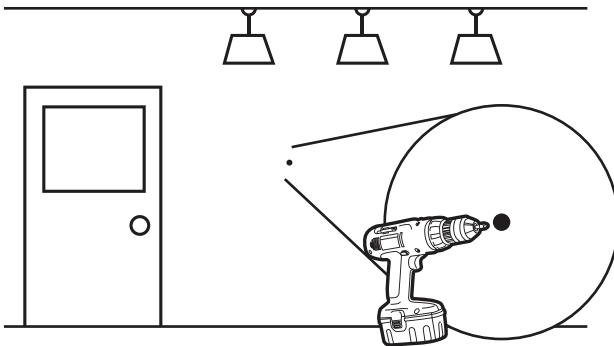

Now remove Shelf and drill the marked holes by drill machine.

4

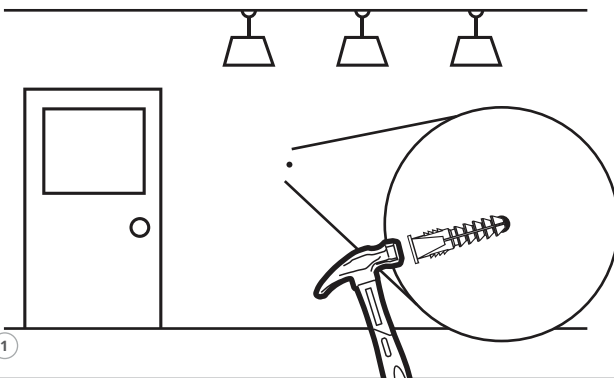

After drilling insert anchor in both holes by using hammer.

5

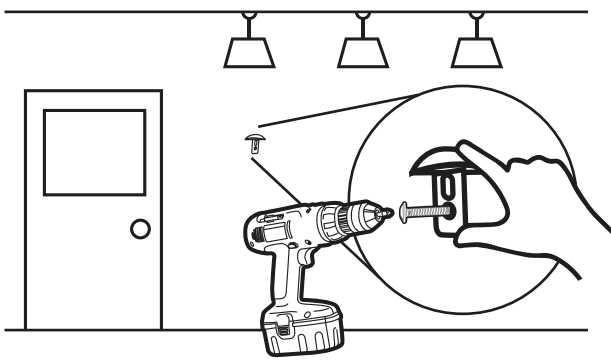

Now place the bracket upper part on anchor and insert screw through it's hole.

6

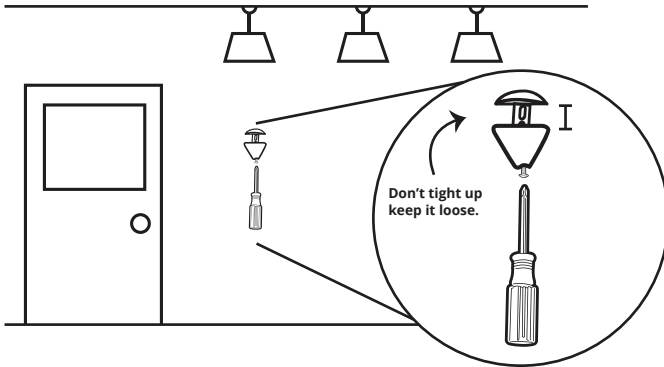

Insert the bottom part of bracket, Tight the screw with some space.

7

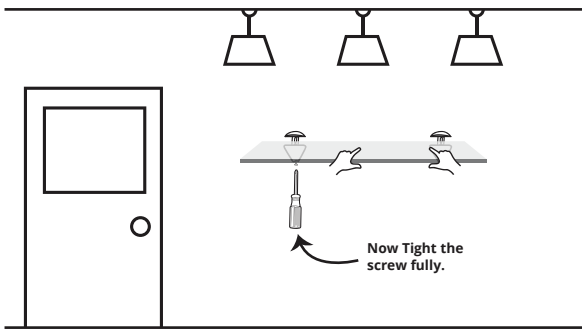

Insert the shelf and fully tight the screws and make sure that brackets tightly grip with shelf.

8

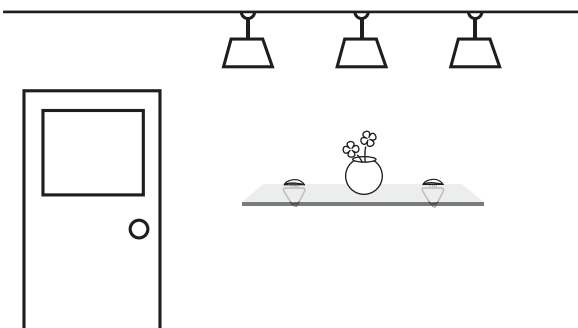

**Congratulations!**

You have successfully installed your Memento Shelf.