

*Ceiling Light*

## General Guidelines

- Please pay attention to the warning signs.
- Please read the instructions with caution before operating and keep it properly.
- This summary may not include every detail of all variations and considered steps. Please feel free to contact us if further information and help are needed.

## Warning

1. Inspect the wire insulation for any cuts, abrasions, or exposed copper that may have resulted during shipping. If there is a defect in the wire, do not attempt installation.
2. Before starting installation of this fixture or removal of a previous fixture, disconnect the power by turning off the circuit breaker or by removing the fuse at the fuse box.

*Please follow the below steps:*

*FIG. 1.* Place the wall switch to the "OFF" position.

Depending on which type of fuse box you have in your home.

*FIG. 2.* Place either the main (Master) switch to the "OFF" position, cutting off power to your entire home OR turn off the individual switch that provides power to where the fixture will be installed.

OR

*FIG. 3.* Place either the main (Master) switch to the "OFF" position, cutting off power to your entire home OR unscrew the fuse that provides power to where the fixture will be installed.

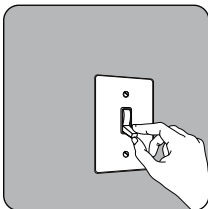

FIG.1 WALL SWITCH

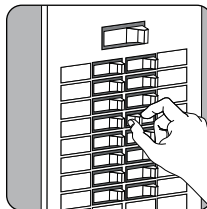

FIG.2 BREAKER PANEL

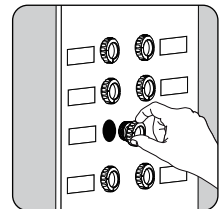

FIG.3 FUSE BOX

3. Before cleaning the fixture, turn off the switch or power source. Wipe the fixture with a soft and dry cloth.

- 4. DO NOT try to repair or disassemble the unit. Doing so could damage the unit and cause possible electrical shock. Consult a qualified electrician if needed. Seller assumes no responsibility or liability for any damage caused by incorrect assembly, improper operation or improper use.
- 5. Keep packing materials away from children to prevent choking and suffocation.

**WARNING** - If any special control devices are used with this fixture, follow the instructions carefully to ensure full compliance with National Electrical Code (N.E.C.) requirements. If any questions arise, contact a qualified electrical contractor.

**WARNING** -This product contains chemicals known to the State of California to cause cancer, birth defects and/or other reproductive harm. Thoroughly wash your hands after installing, handling, cleaning, or otherwise touching this product.

**WARNING** -To comply with the N. E. C. and Underwriters Laboratories requirements, when installed outdoors or in wet locations, the edge of the wall plate that comes in contact with the mounting surface must be sealed with a latex waterproof caulking to prevent water from entering the outlet box.

**CAUTION** - All glass is fragile. Use caution when handling glass component(s) and/or lamp(s).

## **TOOLS REQUIRED**

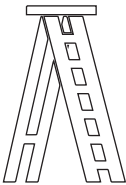

Ladder

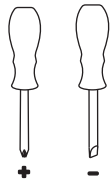

Screwdriver

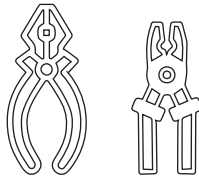

Pliers/Wire Strippers



Safety Goggles



Electrical Tape

# Exploded

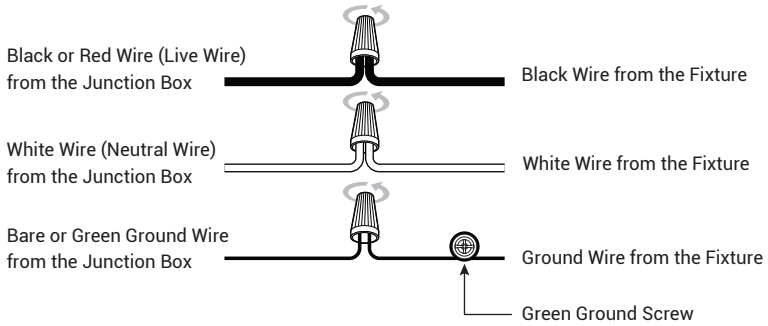
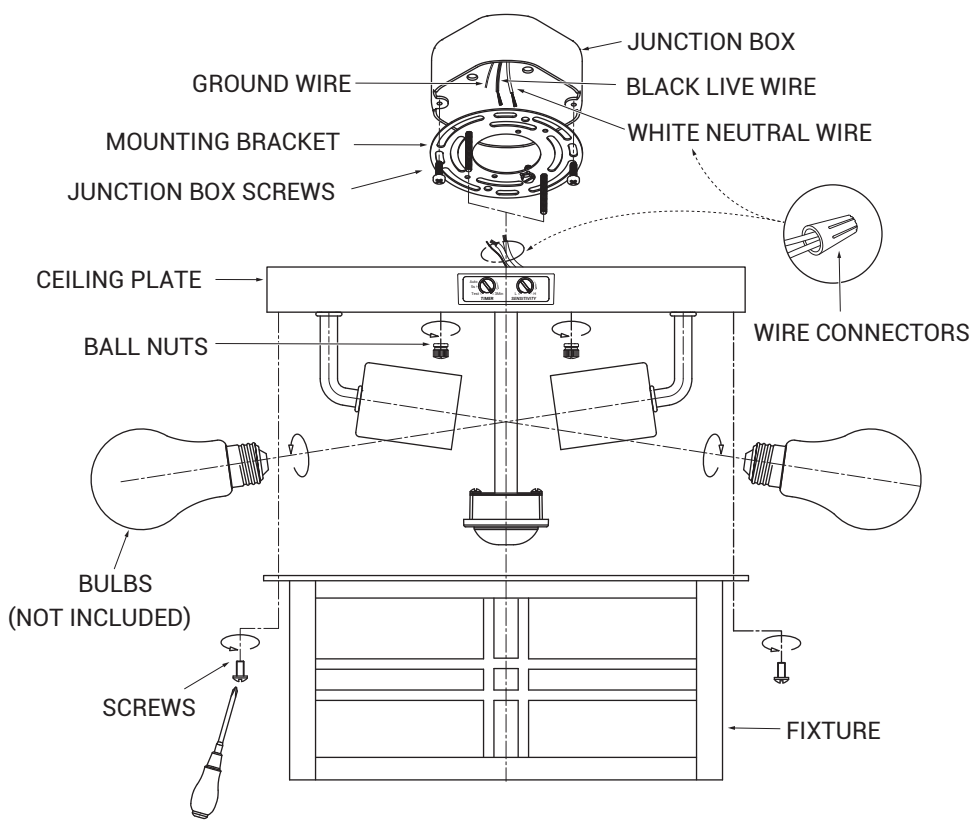

Electrical Tape (not included)

# Function And Operation

Note: When power is first applied, the light will stay on for approximately 15 seconds to allow the circuit to stabilize. Screw down the lamp body mounting nut, remove the lamp body and adjust the infrared sensor knob to achieve 3 main functions (see Fig.3).

	TEST MODE	AUTO MODE
Works at	Day & Night	Night only
Activated by	Motions	Motions
On Time	Motion is detected	Motion is detected
Shut-off delay	5Sec.	5Sec.~3Min.

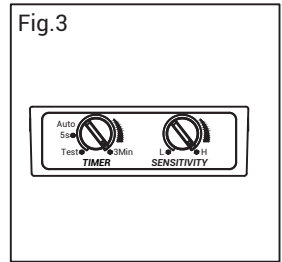

## 1. TEST MODE (Daytime and Nighttime Operation)

The light will turn on when motion is detected and stay on as long as the motion is continuing. The light will turn off approximately 5 seconds after motion is no longer detected.

## 2. AUTO MODE (Nighttime Operation Only)

The light will turn on when motion is detected and stay on as long as the motion is continuing. When the motion stops, the light will remain on for the predetermined time set (5 to 180 seconds), and then turn off.

## 3. Manual Override Mode (Nighttime Operation Only, 5.5-Hours Auto Reset)

When the TIMER control knob is set within the Auto area (between "5S" and "3min"), the sensor automatically enters Auto mode. To control the light from inside the home, activate Manual Override Mode by toggling the wall switch OFF and ON within 2 seconds. The light will turn on and stay on for approximately 5.5 hours, then the Manual Override Mode will automatically reset to the original Auto Mode settings. Or simply switch the power off and then on again in the same manner. (See Fig.4)

	Manual Override Mode
Works at	Night only
Activated by	Wall switch
On Time	Within 2 seconds
Shut-off Delay	5.5 hours

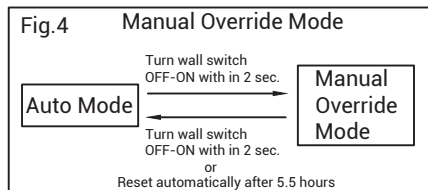

## Testing And Setting

---

- When installed at a height of 10 to 13 ft at 20 °C, the lantern offers an investigation radius ranging from 10 to 35 ft (with a ±5-foot variance). As the ambient temperature decreases, the sensitivity increases. Consider adjusting the settings again during seasonal changes.
- In Test Mode, the light will stay on for 5 seconds each time motion is detected. Set the shut-off delay time only when the light is in Auto Mode.
- The sensor is more sensitive to motions across its detection path rather than to those towards it directly. Walking at a normal pace across the detection area ensures an accurate setting of the desired detection distance.

## Sensitivity

---

- The "Sensitivity" switch is factory-set to "H" (max. detection radius range: 8M).
- Sensitivity switch: detection radius range from Hi (8M) to Lo (3M).
- The detection range can reach the coverage of 360 degrees.
- The sensor will be more sensitive to motion across its detection path than to motion directly towards it.

## Care And Maintenance

---

- To clean, turn off and wipe with a damp soft cloth; do not use detergent or abrasives for cleaning.

# Troubleshooting

PROBLEM	POSSIBLE CAUSE	CORRECTIVE ACTION
Light does not come on at night when motion is detected.	<ol style="list-style-type: none"><li>1. Fixture is not powered.</li><li>2. Another light source is causing the securitylight to think it is daytime.</li><li>3. Loose wiring inside electrical box.</li></ol>	<ol style="list-style-type: none"><li>1. Check that circuit breaker and/or wall switchpower is on.</li><li>2. Turn off surrounding lights and/or re-aim the sensor head.</li><li>3. After powering off the fixture, reconnect any loose wiring.</li></ol>
Security light comes on for no apparent reason at night.	<ol style="list-style-type: none"><li>1. Light senses motion within the detection zone.</li></ol>	<ol style="list-style-type: none"><li>1. Ensure the sensor is not picking up abnormal activities such as street or sidewalk traffic, a heater or dryer vent, or a heated swimming pool, etc.</li><li>2. Test the motion sensor by covering the front curved lens with cardboard to block the view. If the light turns off, something in the detection zone is triggering the sensor. Reposition the motion sensor or adjust the sensitivity (detection distance) of the sensor.</li></ol>

For any questions or concern,  
please attach your Order ID and Name so that  
our professional customer service team help you within 24 hours.