

# VANITY

## ASSEMBLY INSTRUCTIONS

---

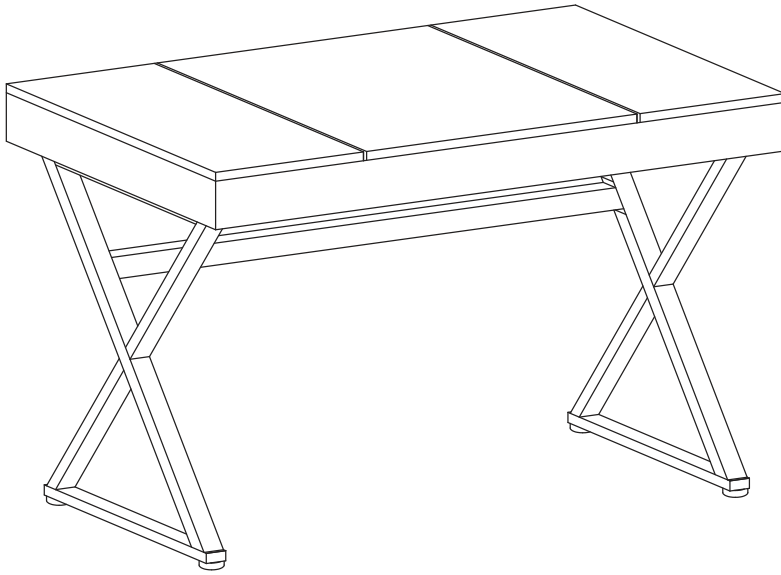

### **WARNING**

1. Do not use this product unless all screws and bolts are securely tightened.
2. Check that all screws and bolts are tight every three months or as needed.
3. Dispose of packing material properly. Do not use plastic cover as head covering. It may cause suffocation.
4. Do not use this product as a stepladder.
5. Use this product for its intended purpose only.
6. **Intended for residential use only.**

**LIMITED WARRANTY**

PARTS LIST

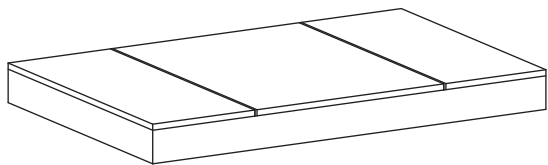

(A) Top (1 PC)

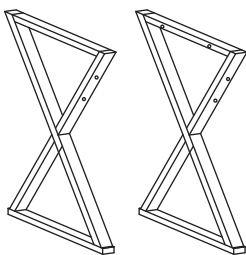

(B) Side Frame (2 PCS)

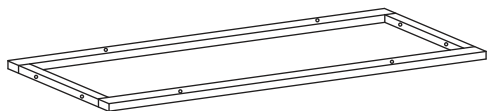

(C) Top Frame (1 PC)



(D) Cross Support (1 PC)

HARDWARE LIST

NO	DRAWING	DESCRIPTION	SIZE	QUANTITY
1		Short Screw	1/4" x 12mm	4 PCS
2		Long Screw	1/4" x 32mm	8 PCS
3		Leveler	M8 x 15mm	4 PCS
4		Allen Wrench		1 PC

## STEP 1

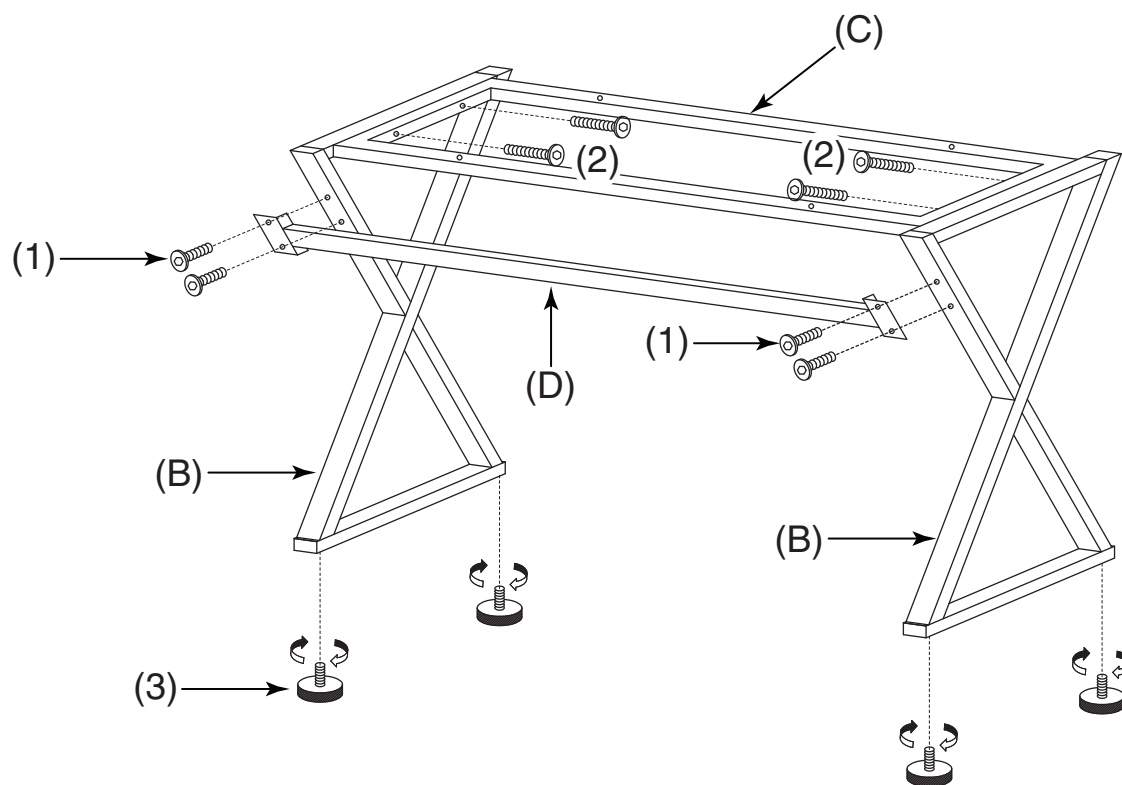

FULLY TIGHTEN SCREWS ALL USING ALLEN WRENCH (4).

## STEP 2

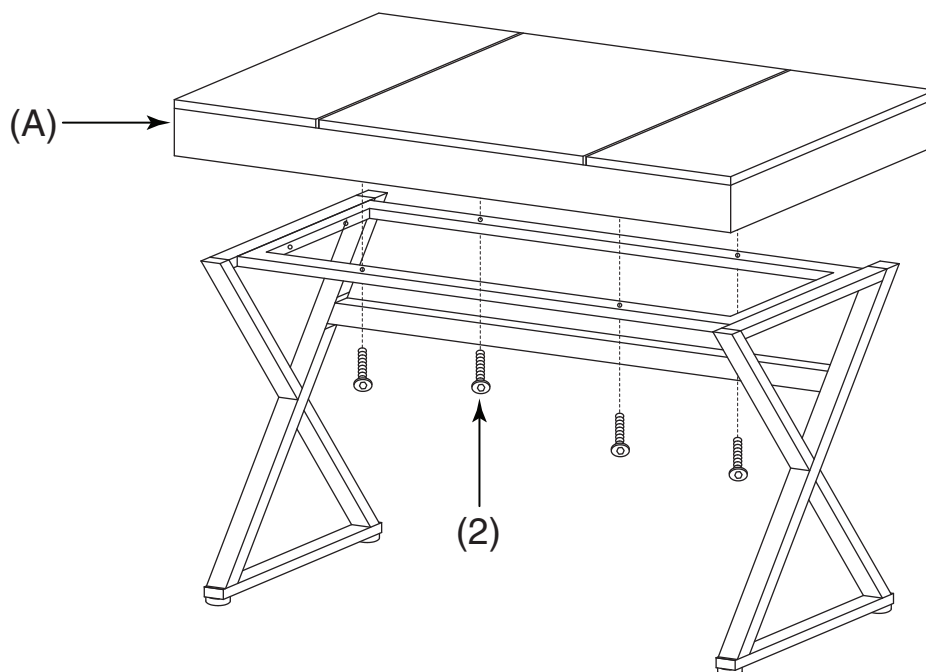

FULLY TIGHTEN ALL LONG SCREWS (2) USING ALLEN WRENCH (4).

## STEP 3

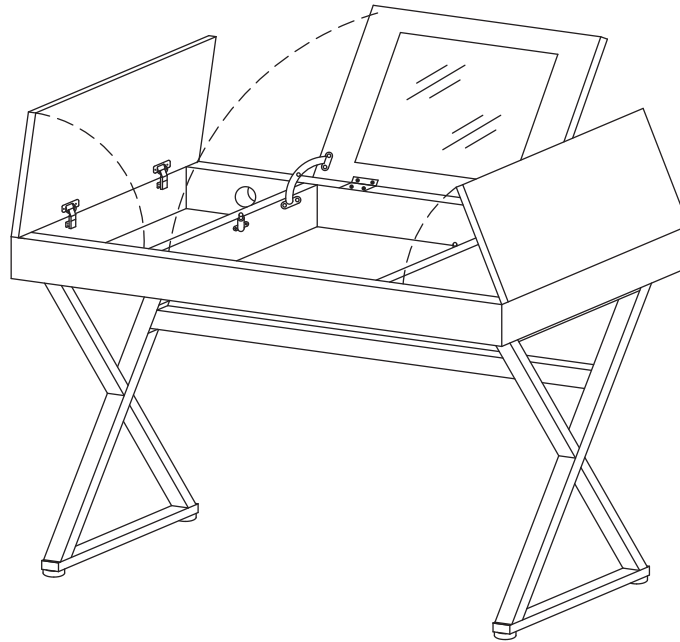

### ADJUSTING UNEVEN TABLE TOP

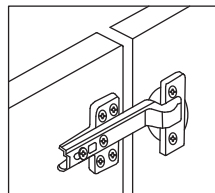

SET SCREW

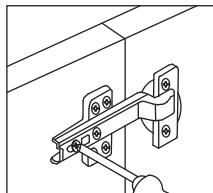

TIGHTEN SCREW

