

Installation instructions

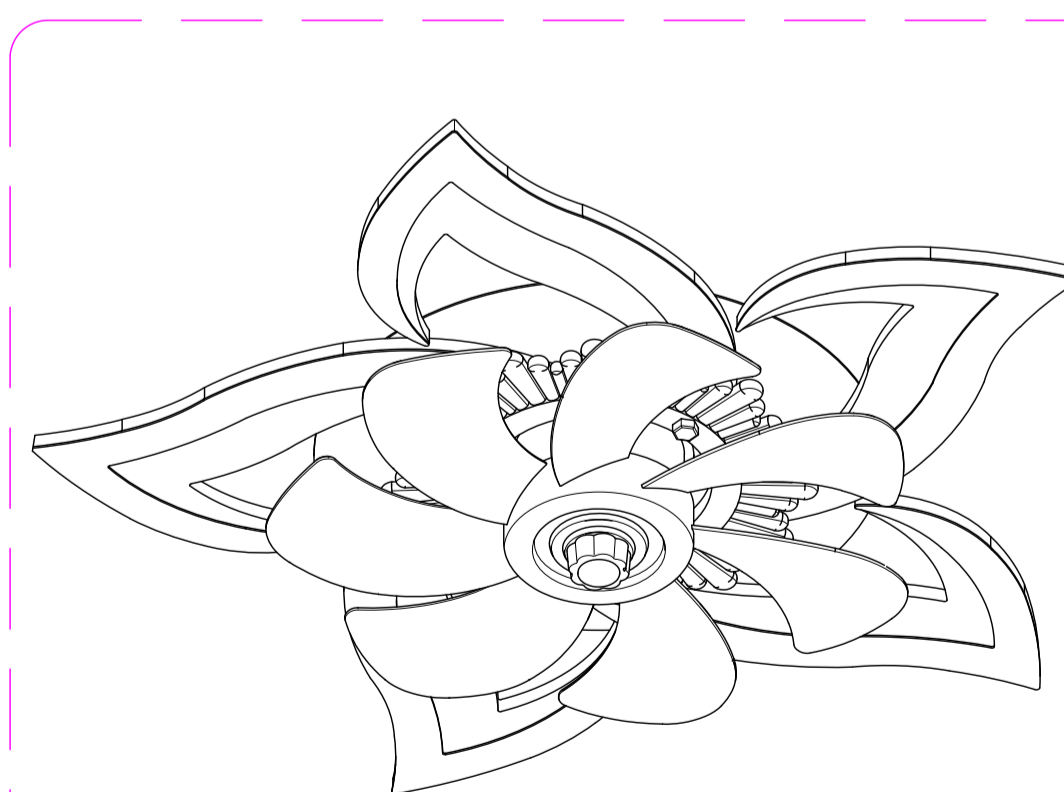

Effect picture after installation

This is the central point of the lamp

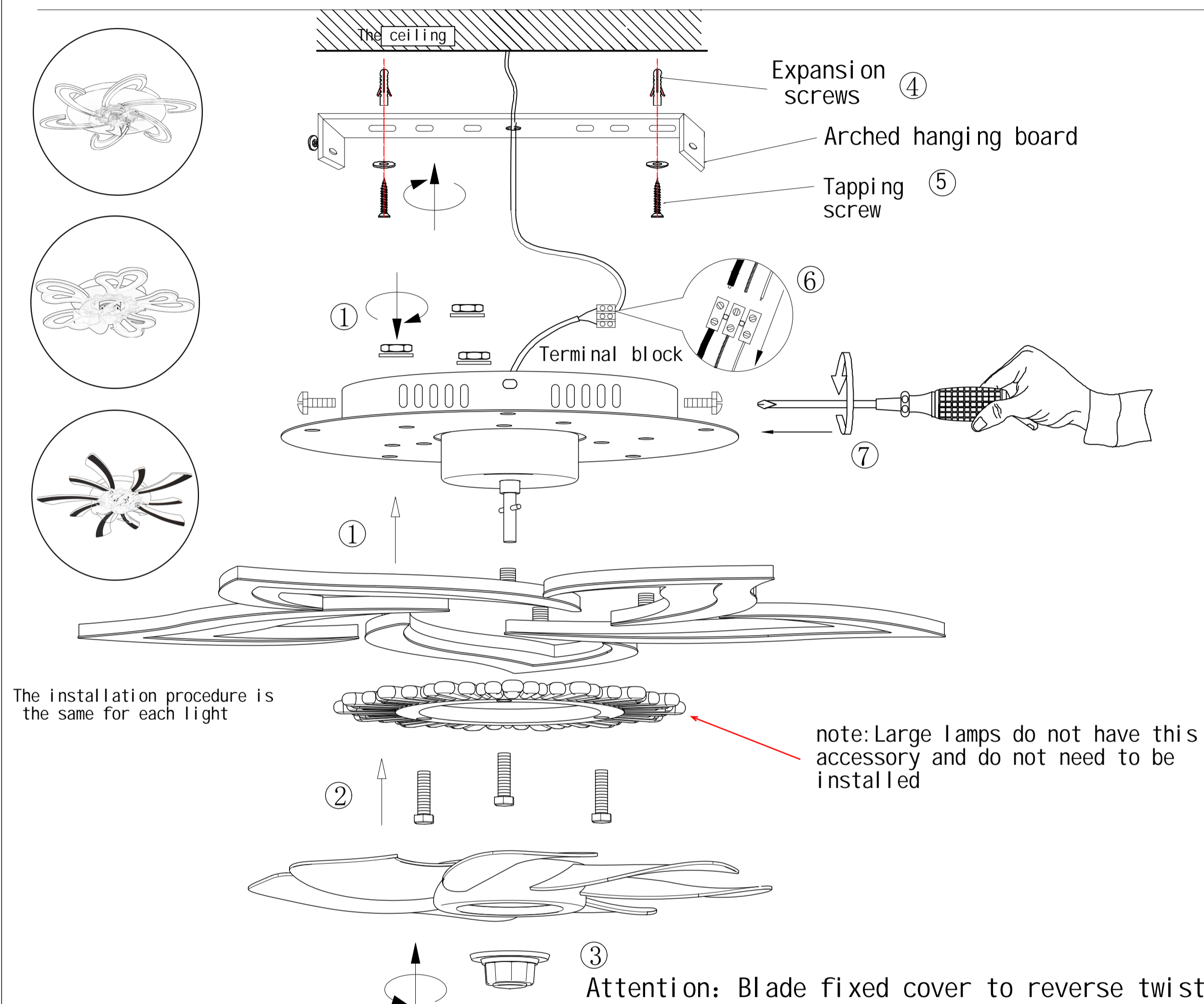
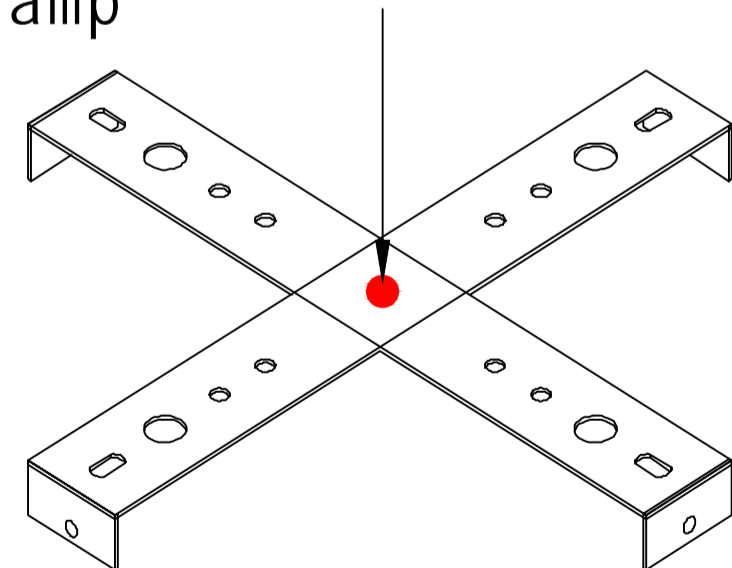

Schematic diagram of cross hanging plate

Thank you for purchasing our products.
Attention: for your safety, please entrust a professional person to install



- (1) : all power supply shall not exceed the specified range (rated voltage AC220V/AC110v, 50Hz, Support global voltage standard, can convert your country's standard voltage)
- (2) : do not install lamps in the unstable ceiling or open air;
- (3) : do not install lamps above high temperature objects or wet places;
- (4) : in order to ensure safety, if there is any problem with lamps, please entrust professional personnel to carry out maintenance;

Installation steps:

- (1) : before installation, the whole lamp shall be tested for lighting, and the appearance of the lamp shall be checked for damage
- (2) : fix the arched hanging board on the ceiling with expansion screws;
- (3) : when installing, please wear gloves to avoid damaging the surface of lamp body;
- (4) : take down the test wire outside the terminal block of the lamp body and connect it to the main line;

(L-live; N-null; \perp -earth)

- (5) : Lock the lamp body with screws and bow hanging plate (with a magnetic cross screwdriver)
- (6) : Please use the remote control according to another manual.

Please try to light up before installing



Before installing the lamp, please check whether the circuit is falling off or in poor contact. Please connect the wire first, and then power on for testing. After power on for testing, check if it is in good condition and then install it.