

# Electric Standing Desk

## Instruction Manual

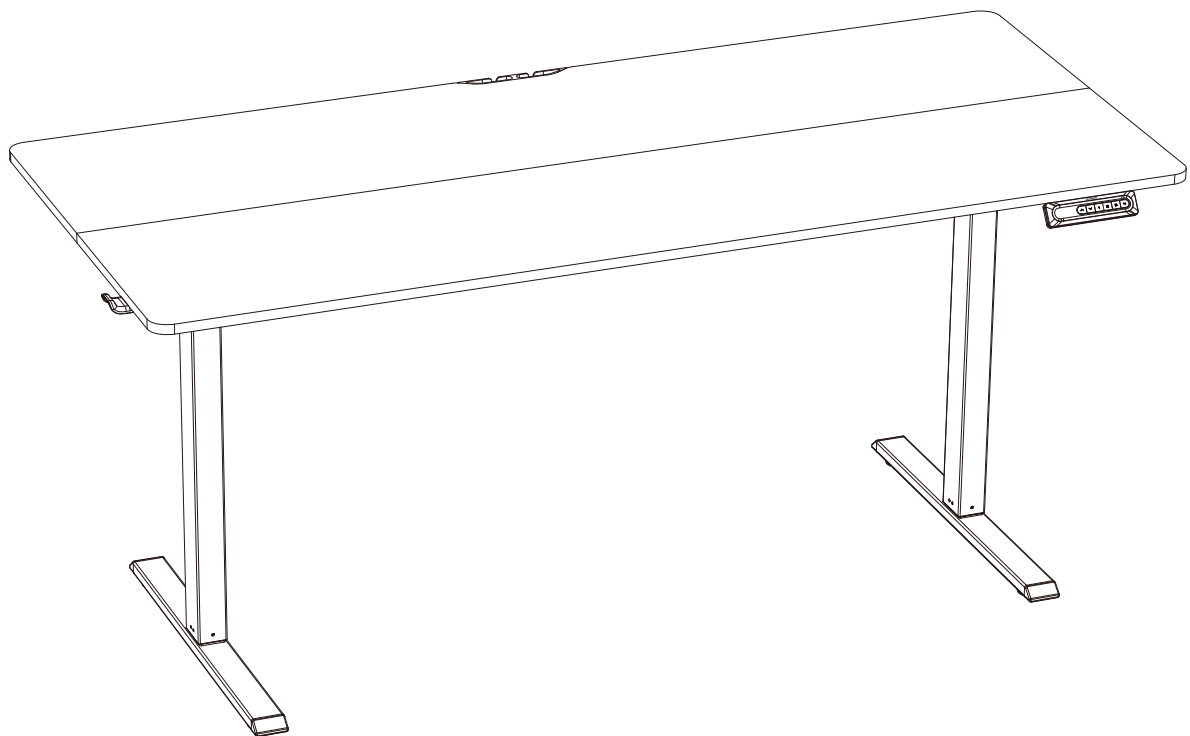

# Specifications



Height Adjustment Range  
27.9–46.8" (71–119cm)



Power Input  
100V–240V



Max. Speed  
18mm/s

# Tools Needed (Not Included)



Drill

OR



Phillips Screwdriver

# Step 1

## Supplied Parts and Hardware

**A** x 8



Bolt  
M6 x 30mm

**B** x 10



Bolt  
M6 x 10mm

**C** x 1



Allen Wrench  
5/32" (4mm)

**I** x 1



Wrench

**01** x 1



Crossbar

**02** x 1

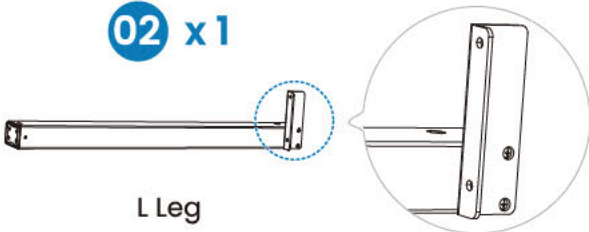

L Leg

**03** x 1

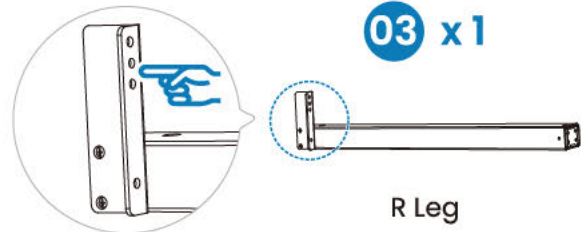

R Leg

**04** x 2



Leg Base

**05** x 2



Side Plate

**06** x 1



Transmission Rod

**07** x 1



Motor

## Step 2 Supplied Parts and Hardware

**D** x 8



Screw  
ST5 x 14mm

**E** x 3



Screw  
ST3.9 x 13mm

**F** x 4



Desktop Panel Connector

**G** x 6

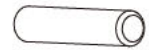

Wood Dowel Pin

**M1** x 2



Cam Bolt

**M2** x 2



Cam Lock

**08** x 1



Cable Organizer

**09** x 1



Desktop

## Step 3 Supplied Parts and Hardware

**D** x 16



Screw  
ST5 x 14mm

**10** x 2



Storage Hook

**11** x 1



Controller

## Step 4 Supplied Parts and Hardware

**H** x 4



Cable Clip

**12** x 1



Power Cable

Actual part  
may vary.

Not all hardware included in this package will be used.

### Contact Us

If you receive parts that are damaged, defective, or are missing parts, please contact us.

# Step 1 Assembling the Frame

L Leg End

Motor End

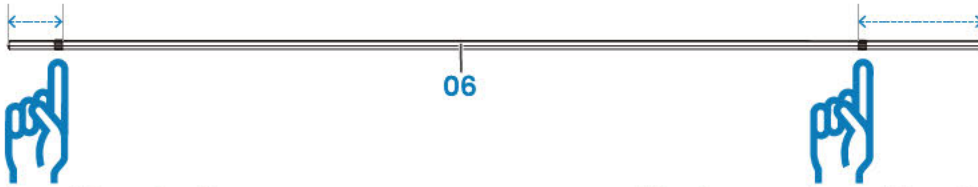

The bump is set back closer.

The bump is set back farther.

Insert the motor onto the transmission rod.

**Important:** Note the direction of the tab.

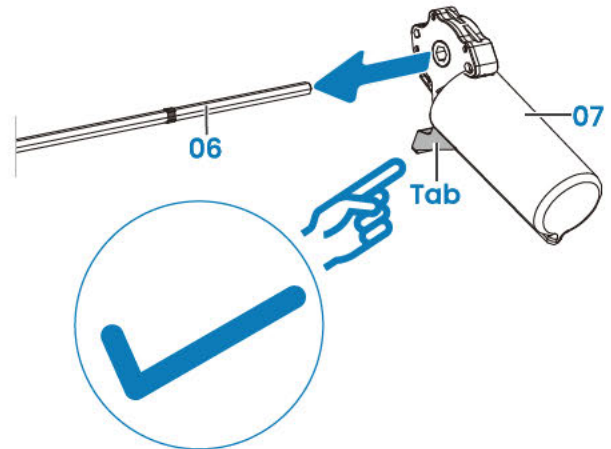
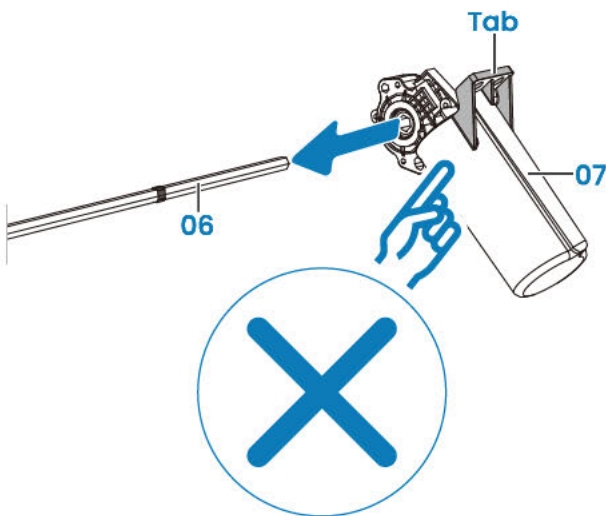

The bump is set back farther.

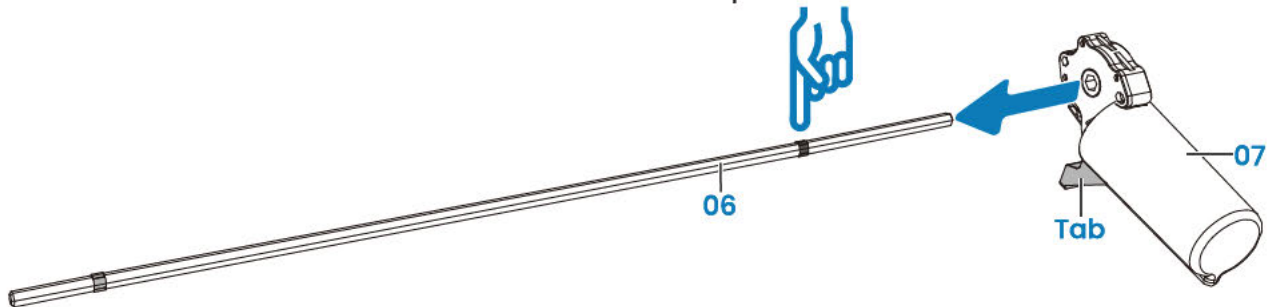

Insert the transmission rod with the motor into the R leg.

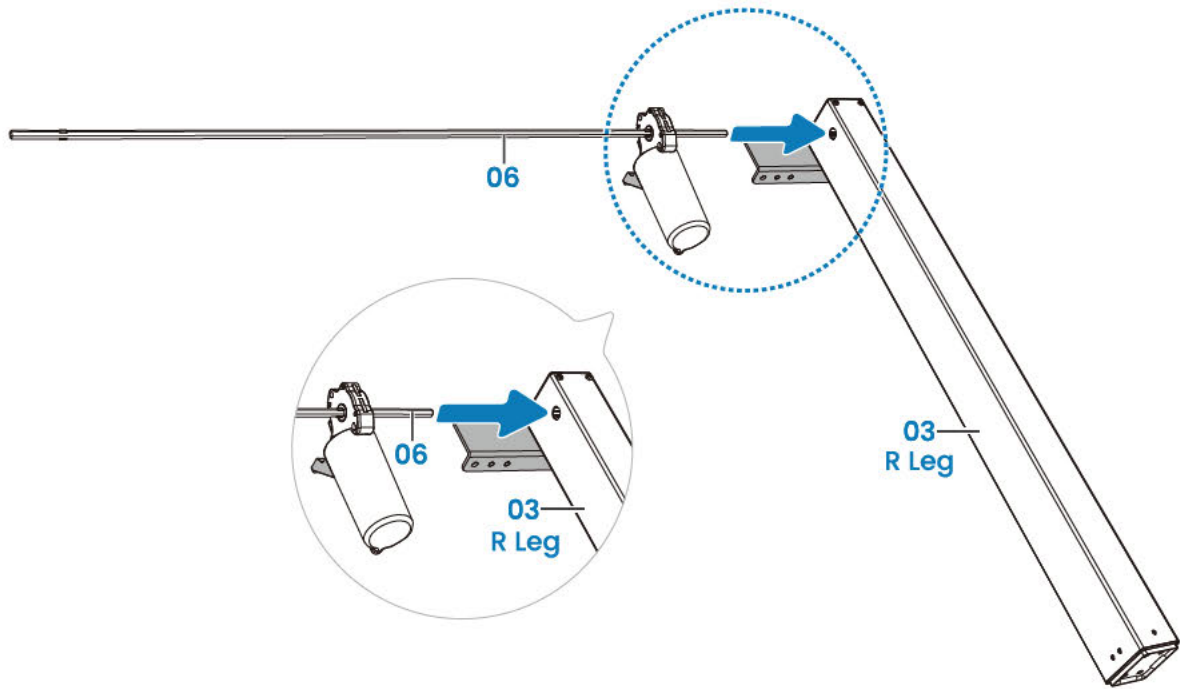

Insert the L leg onto the other end of the transmission rod.

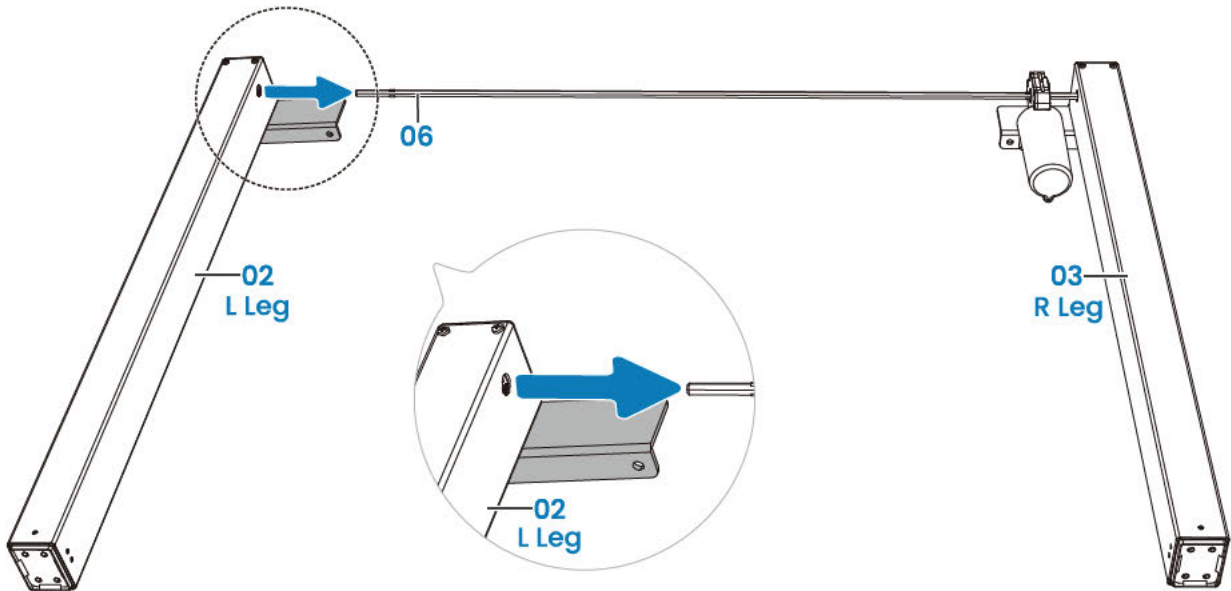

**Note:** If the transmission rod doesn't fit smoothly into the hole in the L leg, use the wrench to fine-tune the position.

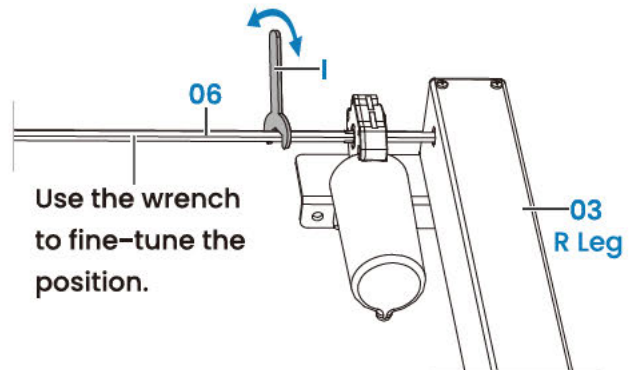

Carefully flip each leg over one by one.

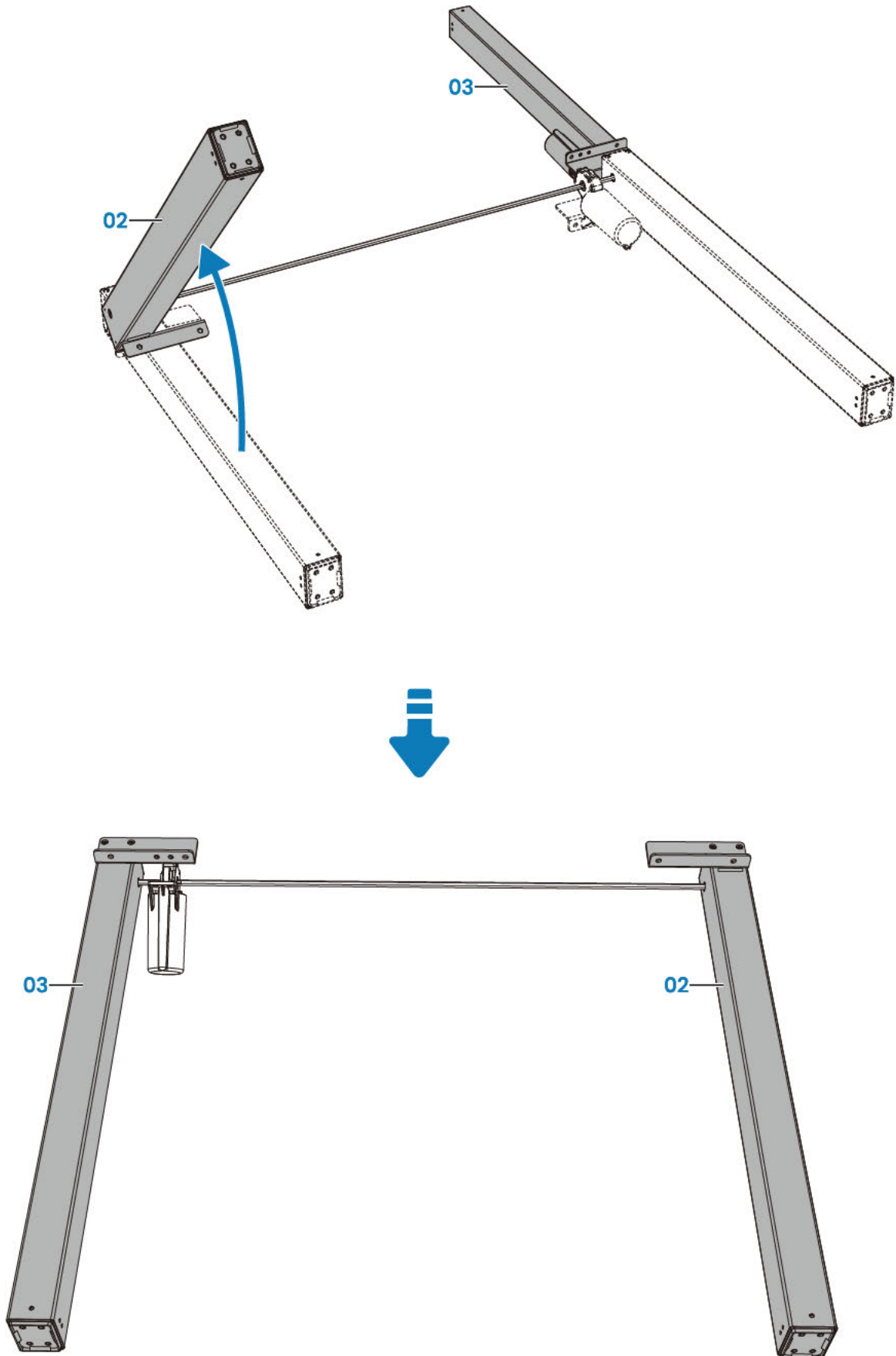

Secure the crossbar to the R leg, then to the L leg. If the holes in the crossbar and L leg are not aligned, adjust the L leg to align.

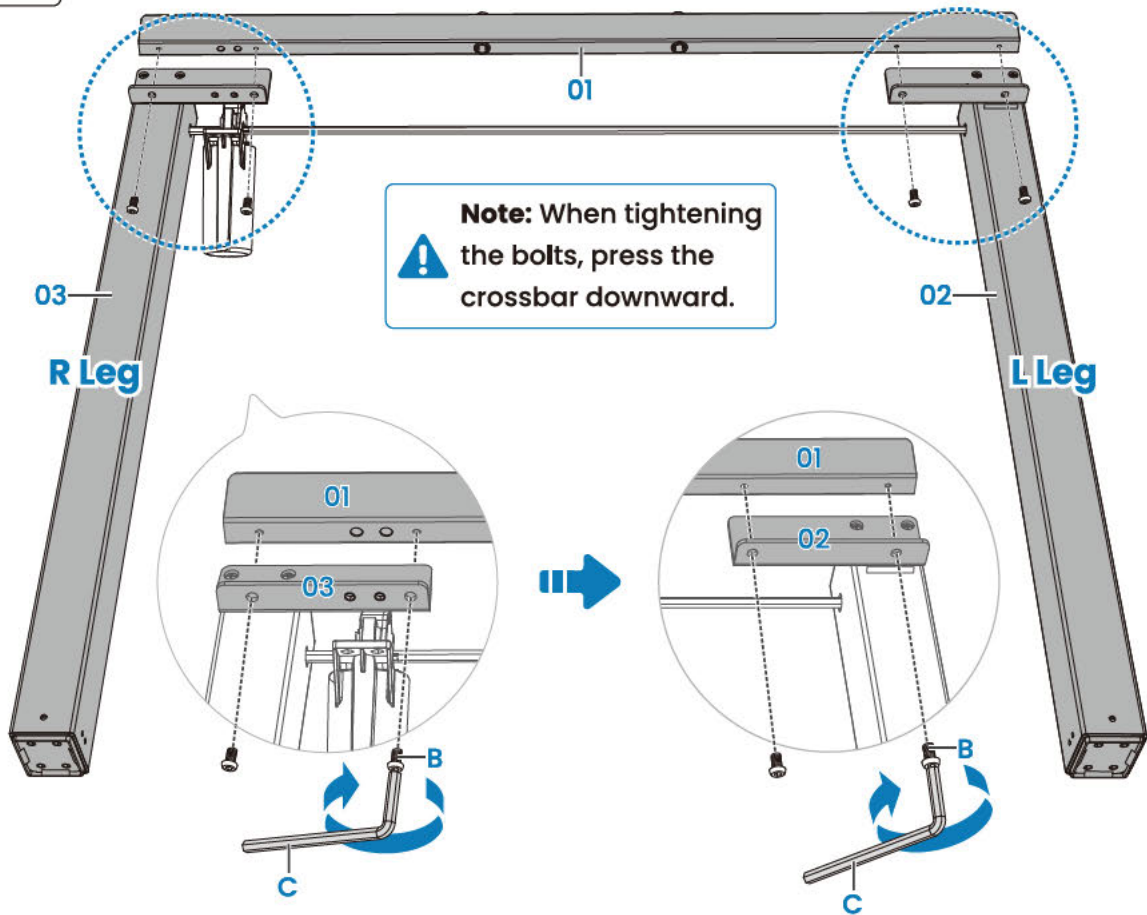

Secure the motor.

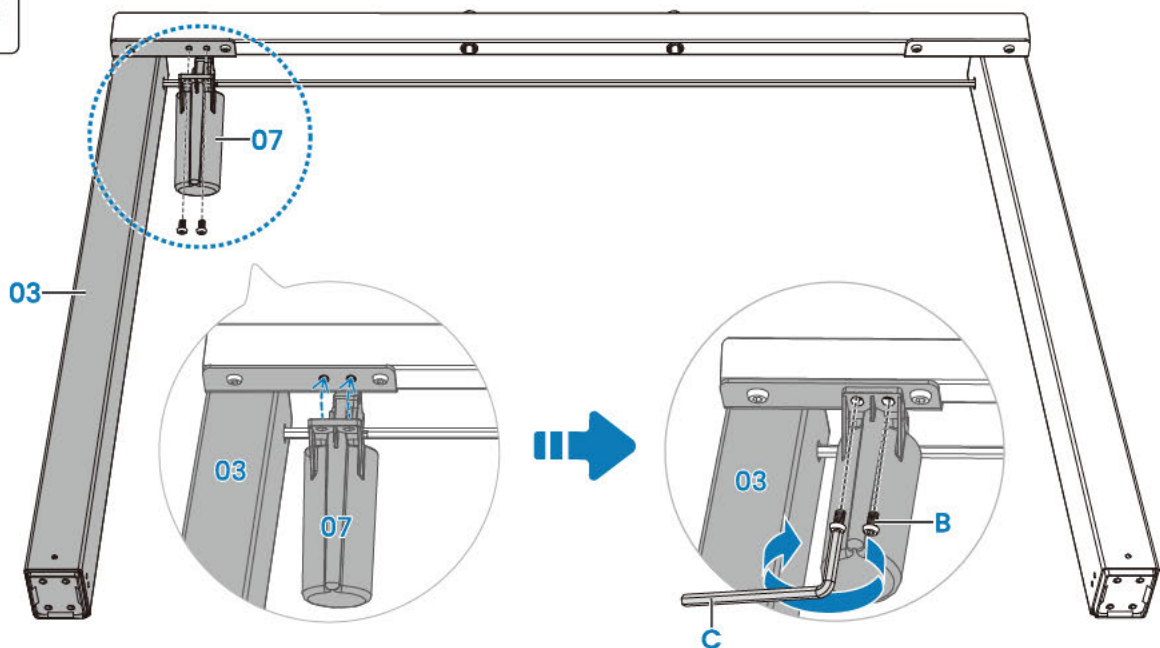



Ensure the rubber pads are attached to the frame. If any have fallen off, reattach them or use the spare rubber pads.

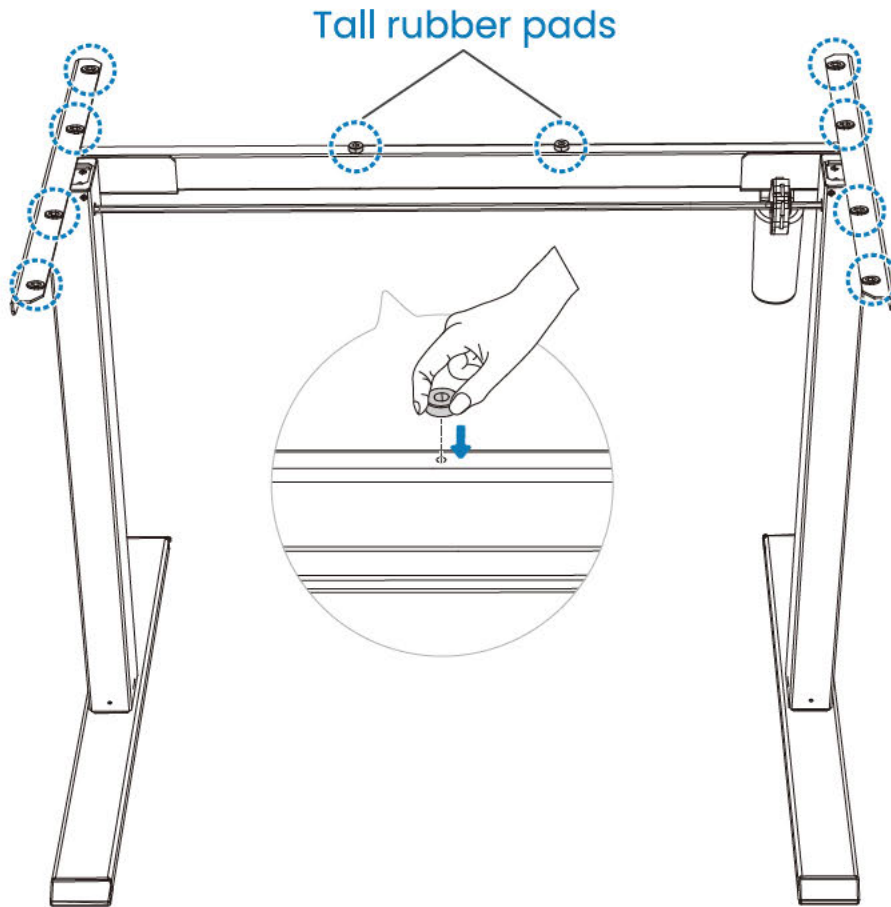

## Step 2 Assembling the Desktop



**Tip:**  indicate pre-drilled hole locations.

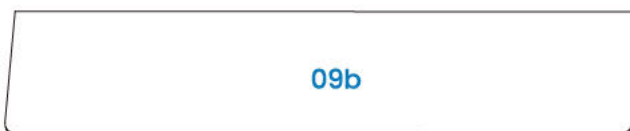

Top



Bottom

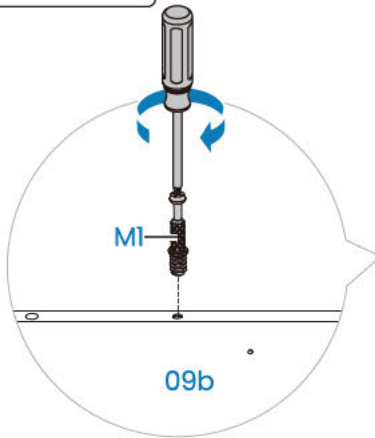
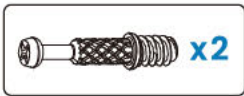

**Tip:** Start to thread the bolts in by hand before using a tool to tighten.



**not included**

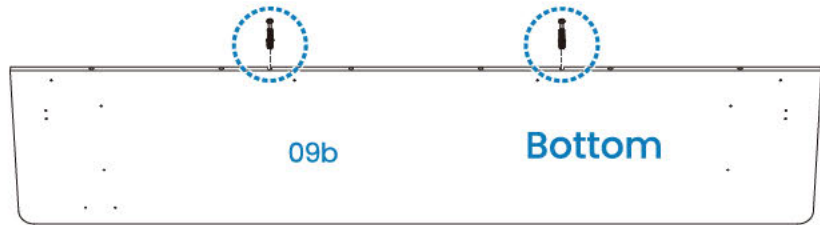

Assemble the desktop with the bottom of the panels facing up.

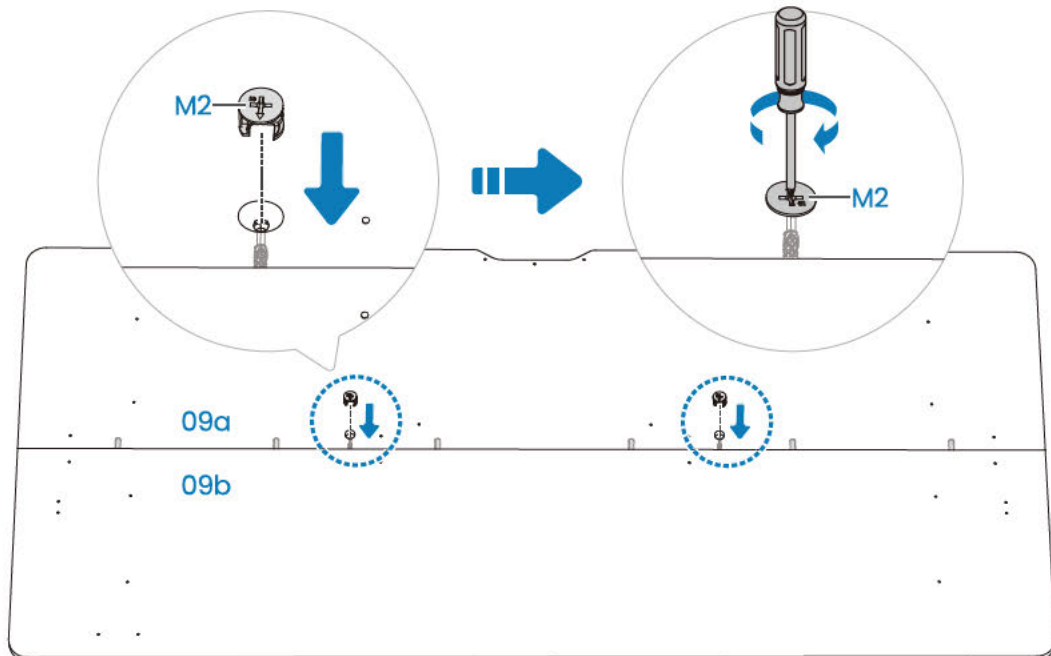
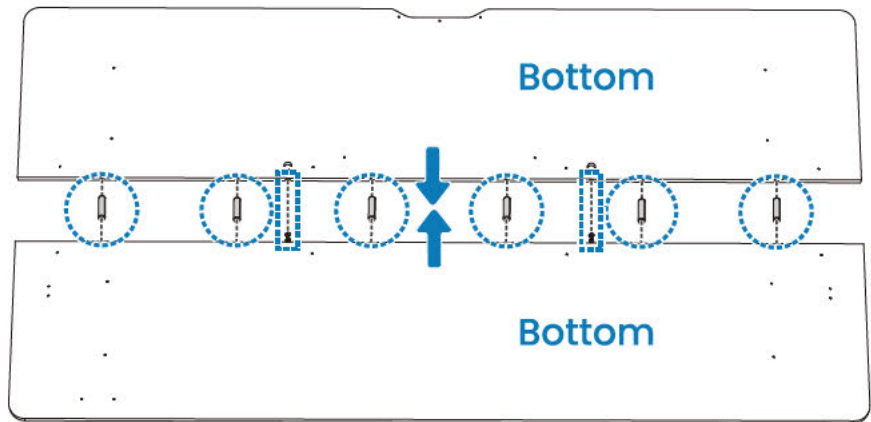
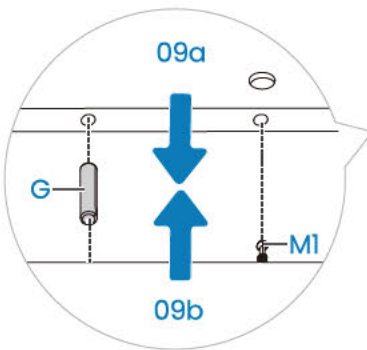



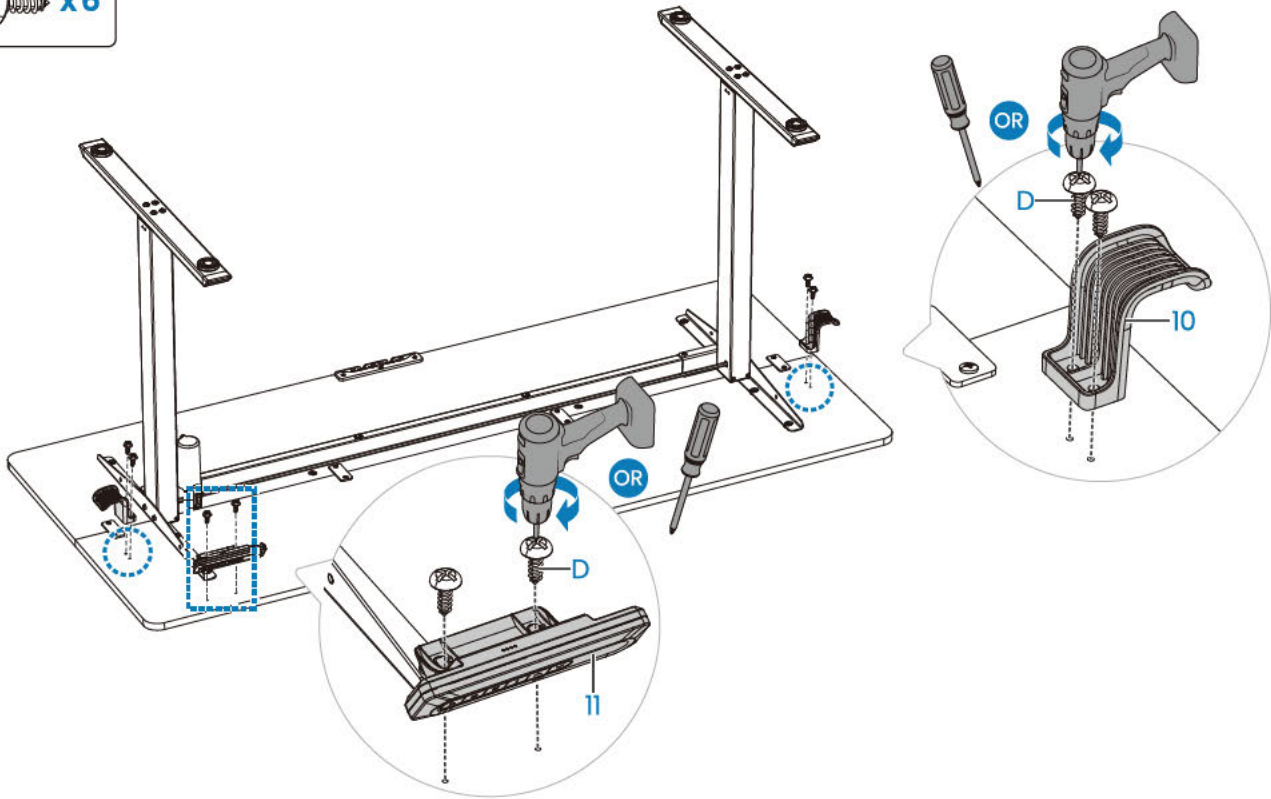

## Step 4 Connecting the Cables

**Tip:** An example of a cable clip layout is indicated below. However, the cable clips can be arranged according to your needs.

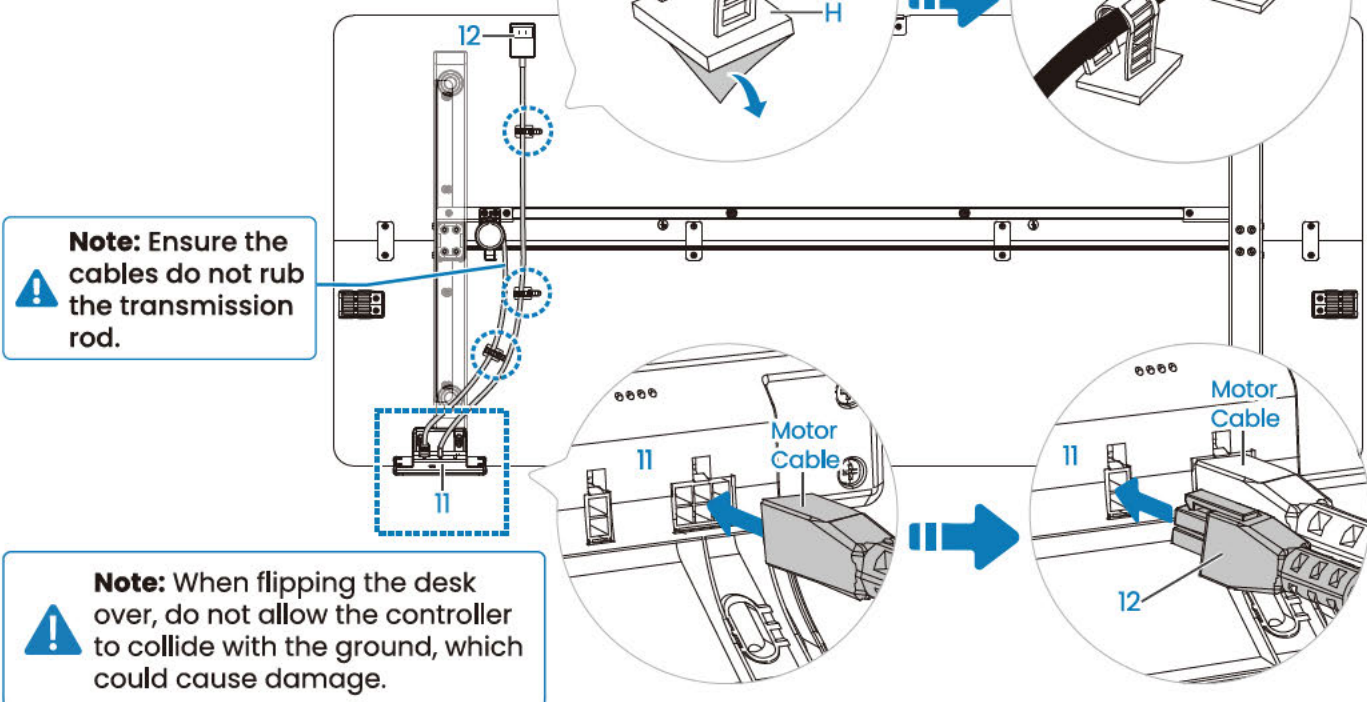

# Using the Controller

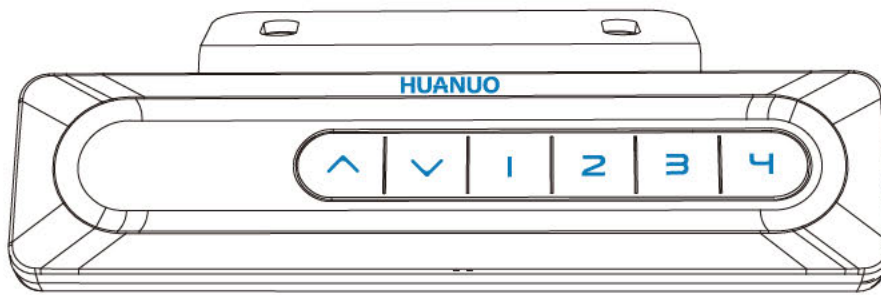

**Tip:** Reset before first use.

**Note:** Ensure that there are no obstacles when using the desk, that the desktop is not too close to the wall, and that all cables are long enough for the desk to move up and down freely. When the controller screen is off (power-saving mode), press any button to wake it before operating.

**Suggestion:** Set the most comfortable height when you sit down to **1** and the most comfortable height when you stand up to **2**. The other two presets can be set for another user or for other heights you want to use.

---

## Raise the Desk

Press the **^** button to raise the desk continuously until it reaches the highest position of 46.8" (119cm) or the button is released.

---

## Lower the Desk

Press the **v** button to lower the desk continuously until it reaches the lowest position of 27.9" (71cm) or the button is released.

---

## Save Height Settings

Four heights can be stored. Press and hold the **1 / 2 / 3 / 4** button for 3 seconds. The digital number will flash three times and the current height will be stored to that button.

## Select Height Setting 1

Press the **1** button. The desk will move to the height that was previously set for that button. Press any button to stop the desk.

---

## Select Height Setting 2

Press the **2** button. The desk will move to the height that was previously set for that button. Press any button to stop the desk.

---

## Select Height Setting 3

Press the **3** button. The desk will move to the height that was previously set for that button. Press any button to stop the desk.

---

## Select Height Setting 4

Press the **4** button. The desk will move to the height that was previously set for that button. Press any button to stop the desk.

Settings	
<b>Reset</b>	<ol style="list-style-type: none"><li>1. Press and hold the <input type="checkbox"/> button until the desk goes down to its lowest level, and then release the button.</li><li>2. Press and hold the <input type="checkbox"/> button for 5 seconds until the screen displays 'RST,' then release the button with 'RST' flashing.</li><li>3. Press and hold it again until the desk goes down to its lowest level and comes back up slightly. The screen will display current height again, then reset is complete.</li></ol> <p><b>Note:</b> It is recommended that you remove all items from the desktop before performing a reset.</p>
'RST' displays as <b>RST</b> on the screen.	
<b>Lock/Unlock</b>	Press and hold <b>1</b> and <b>2</b> buttons together for 3 seconds to turn the lock on. The screen will display 'LOC' and the buttons will be disabled. Repeat to turn the lock off.
<b>Change Display Height Units</b>	Press and hold <b>1</b> and <b>3</b> buttons together for 3 seconds to switch the display height unit. The default unit is imperial.

<p><b>Change Collision Detection Sensitivity</b></p>	<p>1. Press and hold <b>1</b> and <b>4</b> buttons together for 3 seconds and 'S02' will flash on the screen. The last digit displayed is the current sensitivity level, and the value range is 0–3 (0: off; 1–3: highest to lowest).</p> <p>2. Select other levels by pressing <b>▲</b> or <b>▼</b> button, then press and hold <b>1</b> and <b>4</b> buttons together for 3 seconds. The digits will stop flashing and the screen will display the current height again.</p> <p><b>Note:</b> Sensitivity is preset to Normal by the factory. However, sensitivity may be adjusted if needed.</p>
<p><b>Set/Clear Lowest Limit</b></p>	<p>1. To set the lowest height limit, press and hold <b>▼</b> and <b>1</b> buttons together for 3 seconds. The screen will display '-dO.' Whenever the desk reaches the lowest limit, the screen will display '-LO.'</p> <p>2. To clear the lowest height limit, move the desk down to the lowest height (screen displays '-LO'), then press <b>▼</b> and <b>1</b> buttons together for 3 seconds. '-dO' will flash on the screen and the limit will be cleared.</p>
<p><b>Set/Clear Highest Limit</b></p>	<p>1. To set the highest limit, press and hold <b>▲</b> and <b>1</b> buttons together for 3 seconds. The screen will display '-UP.'</p> <p>Whenever the desk reaches the highest limit, the screen will display '-HI.'</p> <p>2. To clear the highest limit, move the desk up to the highest level (screen displays '-HI'), then press <b>▲</b> and <b>1</b> buttons together for 3 seconds. '-UP' will flash on the screen and the limit will be cleared.</p>

## Troubleshooting

1. Please try resetting the desk if you have any issues including the following:
  - Abnormal operation.
  - The controller screen displays 'RST' (reset).
  - The controller screen displays error message E01–E08, but the motor cable is connected correctly.
2. If the controller screen displays 'HOT,' please wait 20 minutes for the motor to cool down before making any further height adjustment.

# Exceeding Expectations in Office Comfort & Productivity

