



Ceramic/Impressions®

Vitreous Top and Basin Bathroom Sink
K-2891-1

Features

- Vitreous China
- Integrated top and bowl
- With overflow
- Single faucet hole
- 49" (1245 mm) x 22-3/8" (568 mm)



Codes/Standards







ASME A112.19.2/CSA B45.1

KOHLER® One-Year Limited Warranty

See website for detailed warranty information.

Available Color/Finishes

Color tiles intended for reference only.

| Color | Code | Description |
|--|------|--------------------------|
|  | G81 | White Impressions |
|  | G82 | Dune Impressions |
|  | G83 | Biscuit Impressions |
|  | G85 | Sandbar Impressions |
|  | G86 | Cashmere Impressions |
|  | G88 | Thunder Grey Impressions |

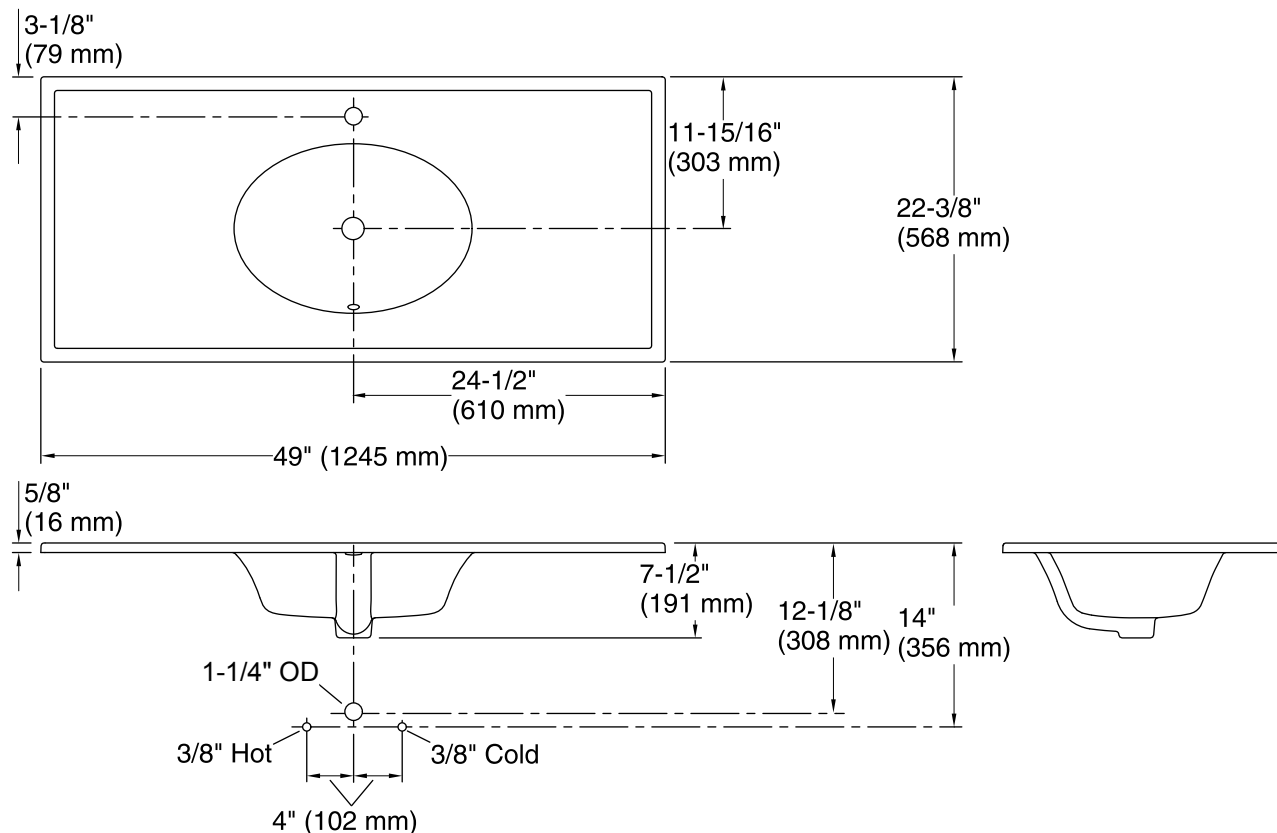

Technical Information

All product dimensions are nominal.

Bowl configuration: Single

Installation: ITB

Bowl area (Only): Length: 19" (483 mm)
Width: 13-3/8" (340 mm)
Bowl depth: 5-1/2" (140 mm)
Water depth: 4" (102 mm)

Number of deck holes: 1

Faucet hole(s): 1-3/8" (35 mm)

Drain hole: 1-3/4" (44 mm)

Notes

Install this product according to the installation instructions.

This sink is designed to be installed as an integrated vanity top to a KOHLER or standard vanity.