

ASSEMBLY INSTRUCTIONS

DIMENSIONS 78-60"W x 42"D x 30"H

DO NOT FULLY TIGHTEN BOLT UNTIL THE ENTIRE ITEM IS COMPLETELY ASSEMBLED

PART LIST

(A) Table Top (1pc)

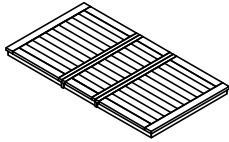

(B) Table Legs (2pcs)

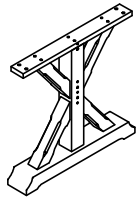

(C) Stretcher
Top (1pc)

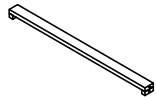

(D) Stretcher
bottom (1pc)

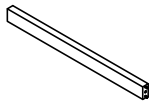

(E) Support
Stretcher (2pcs)

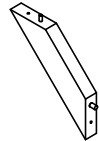

STEP 1

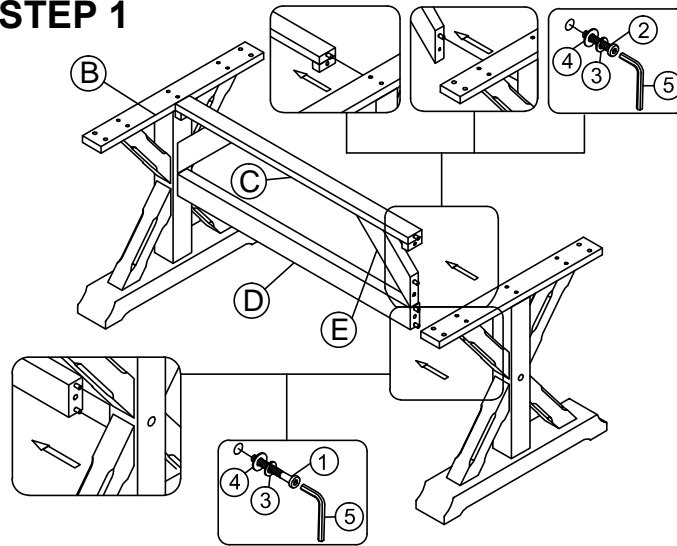

STEP 2

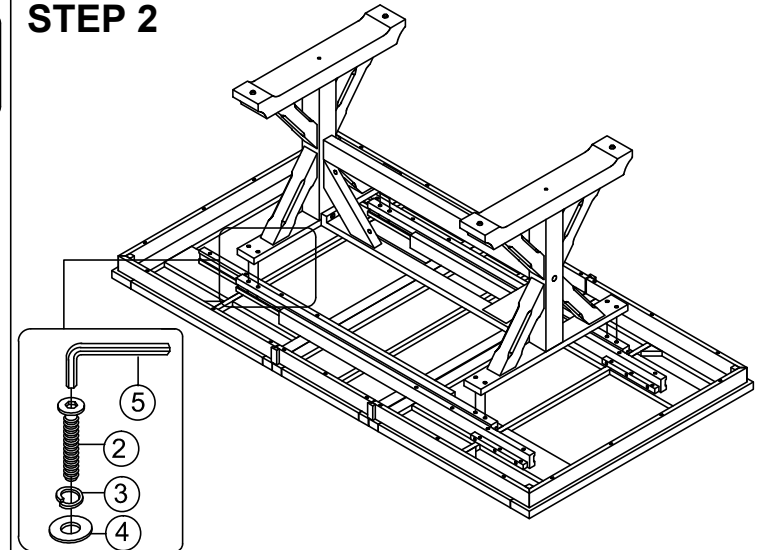

HARDWARE LIST

Long Bolt



(1) Ø5/16" x 75mm
(2 pcs)

Short Bolt



(2) Ø5/16" x 40mm
(14 pcs)

Spring Washer



(3) Ø5/16" x 13mm
(16 pcs)

Flat Washer



(4) Ø5/16" x 16mm
(16 pcs)

Allen key



(5) 4mm(1 pc)

STEP 3

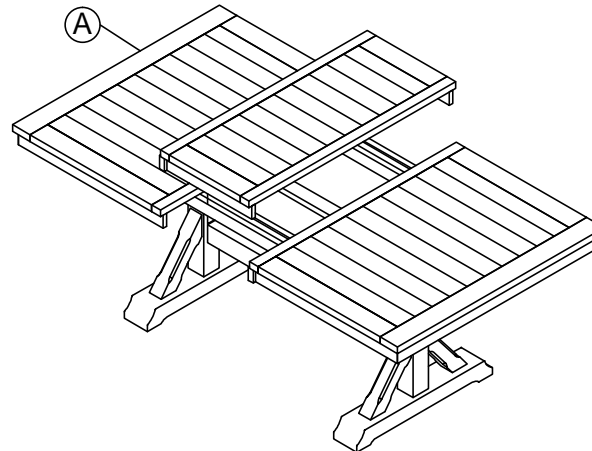

NOTE: IT WILL REQUIRE TWO PEOPLE TO TURN ASSEMBLED UNIT UPRIGHT.

Complete