

# Installation instructions

## Pantry and Workboard Faucets

2316100C-8

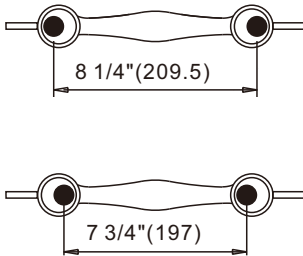
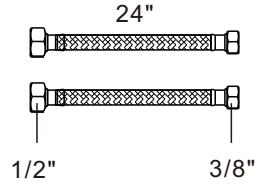
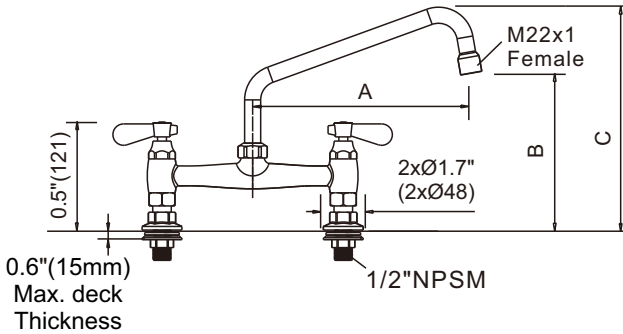

MODEL	A	B	C
2316100C-8	8" (200)	6.5" (165)	9.2" (234)
2316100C-10	10" (250)	7.5" (192)	10" (256)
2316100C-12	12" (300)	8" (200)	10.6" (270)
2316100C-14	14" (355)	8.5" (215)	11.2" (285)

8 inches adjustable center hole distance  
 Deck-mount faucet using a pair of G 1/2" female inlets with 2" flanges.  
 those inlets can adjust from 7 3/4" (197mm) to 8 1/4" (209.5),  
 allowing you to fit them directly onto your facility's water lines with ease.

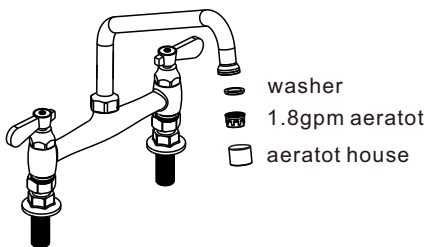

With 1.8 gpm are compliant with California water efficiency regulations, Complies with California Proposition 65 and with the Federal Safe Drinking Water Act.

In areas with extremely low water pressure causing the faucet water flow to be unsatisfactory, replace the 2.2 gpm aerator to improve the water flow in the faucet.

### 1

Remove the brass lock nut (4) from the thread rod(1) counter-clockwise, remove the washer (2) and washer (3)

### 2

Connect the two flanges (1) into the thread rod (2). Screw them tightly.

3

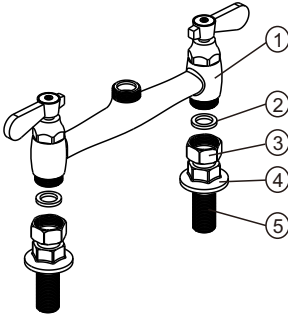

Connect the body (1) to the flanges (3), do remember the gaskets (2) inside. The two flanges (3) are adjustable inlets.

Unscrew the hexagon nut (4) on the flange (3), rotate the flange (3) to the right the distance and screw the hexagon thread back tightly.

You can adjust the distance from 7 3/4" to 8 1/4".

4

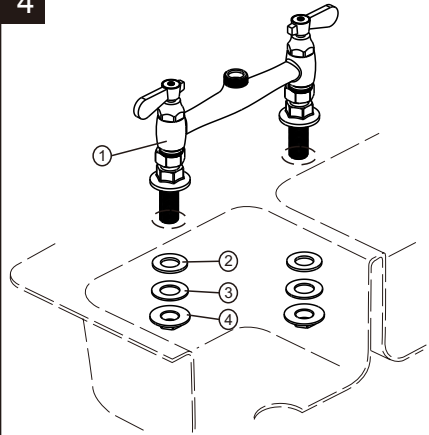

1. Slide faucet down through mounting hole on sink.

Option: If sink is uneven, use silicone under the gasket.

2. Place gasket (2) and SS304 gasket (3) over thread rod (1) under sink.

3. Screw hexagonal lock nut (4) on to mounting stud (1) and tighten.

5

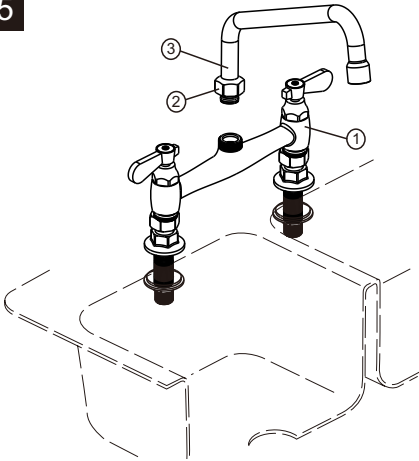

Put the swing nozzle (3) into the body (1), screw the nut (2).

6

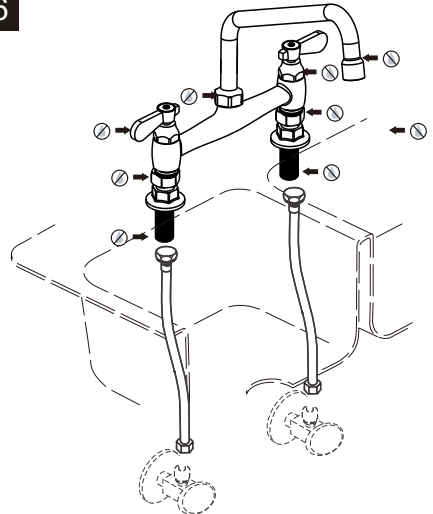

Attach waterlines, do not overtighten. Waterlines: 3/8" hot & cold hoses, If you need G1/2" hoses, please email us to buy 3/8" standard pipe connection G1/2" adapter included.

**FLUSH SYSTEM/CHECK FOR LEAKS.**

Turn on hot and cold water supplies and flush water lines for one minute.

Check all connections at arrows for leaks.

Retighten if necessary, but do not overtighten.