

(B1 & B2)

DROP LEAF TABLE

ASSEMBLY INSTRUCTIONS



ASSEMBLY TIPS :

1. Remove hardware from plastic bag and sort by size.
2. Please check to see that all hardware and part are present prior to start of assembly.
3. Please follow attached instruction in the same sequence as numbered to assure fast & easy assembly.

**Warning !**

1. Don't attempt to repair or modify parts that are broken or defective. Please contact the store immediately.
2. This product is for home use only and not intended for commercial establishment.

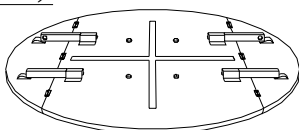
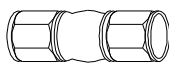
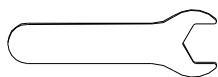
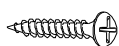
PARTS IDENTIFICATION:**B1 (BOX1)****AN****TABLE TOP****1PC****B2 (BOX2)****BN****EMPIRE COLUMN****1PC****CN****EMPIRE LEG****4PCS****DN****MOUNTING BAR****2PCS****HARDWARE IDENTIFICATION:****Z-B2 (BOX2) - HARDWARE PACK IS LOCATED IN (B2)****1****WRENCH****1PC****2****ALLEN WRENCH****1PC****3****BOLT****4PCS****4****SMALL LOCK WASHER****4PCS****5****SMALL FLAT WASHER****4PCS****6****HEX NUT****8PCS****7****BIG LOCK WASHER****8PCS****8****BIG FLAT WASHER****8PCS****9****LEVELER****4PCS****10****PAN HEAD SCREW****8PCS**

NOTE : PHILLIPS HEAD SCREW DRIVER IS REQUIRED IN THE ASSEMBLY PROCESS. HOWEVER, MANUFACTURER DOES NOT PROVIDE THIS ITEM.

STEP 1

1.1 Align and fasten empire leg (CN) to empire column (BN) using big flat washer (8), big lock washer (7) and hex nut (6) and tighten with wrench (1).

1.2 Screw in leveler (9) to empire leg (CN).

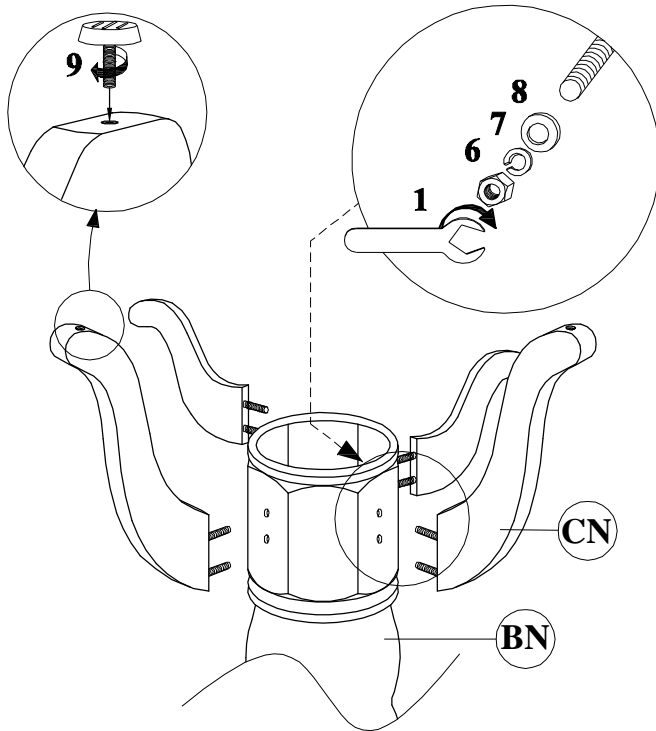

STEP 2

Align and fasten mounting bars (DN) to empire column (BN) using bolt (3), small lock washer (4) and small flat washer (5) and tighten with Allen wrench (2).

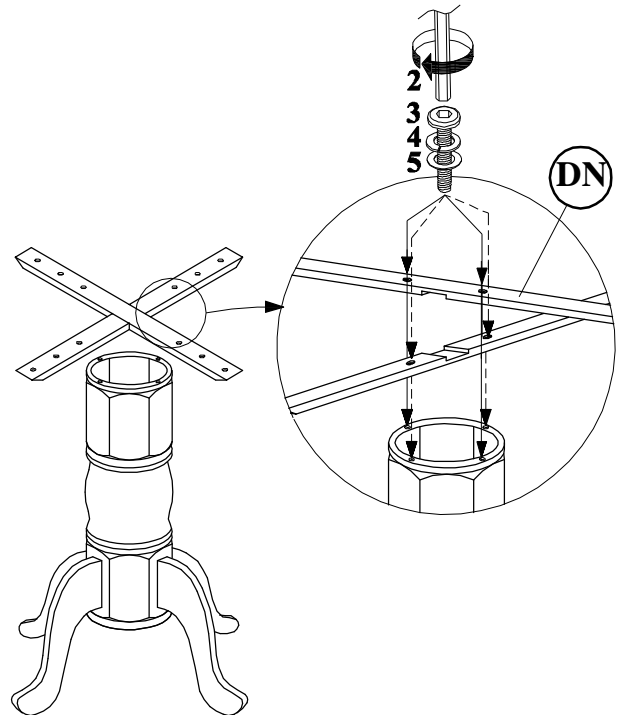

STEP 3

Place table top (AN) upside down on a soft surface. Align and position mounting bar (DN) onto the marking at the bottom of table top (AN). Then fasten using pan head screw (10) and tighten with Phillips head screw driver (Not Included).

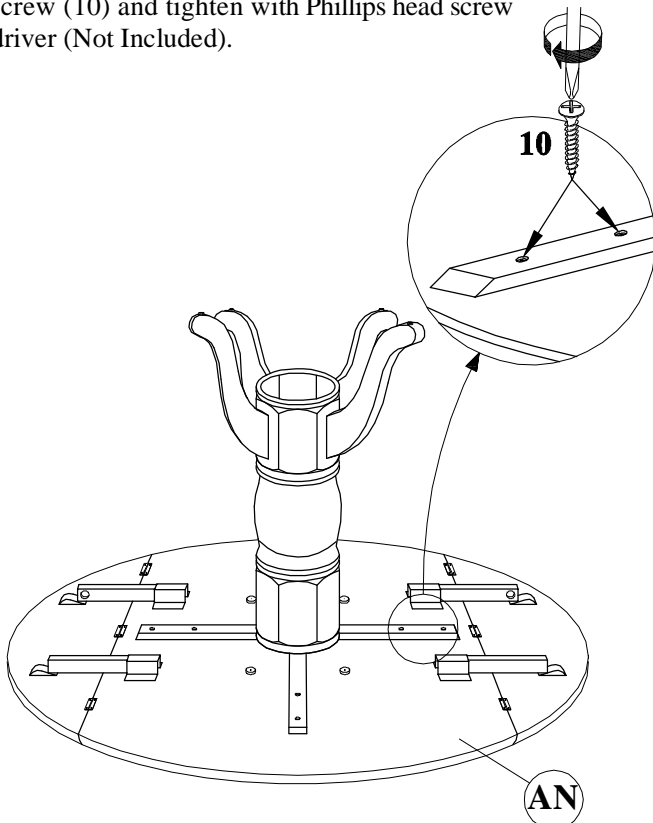

STEP 4

Flip table over using two people to lift and flip this table. Adjust leveler to touch the floor.

