

# CONSOLE TABLE

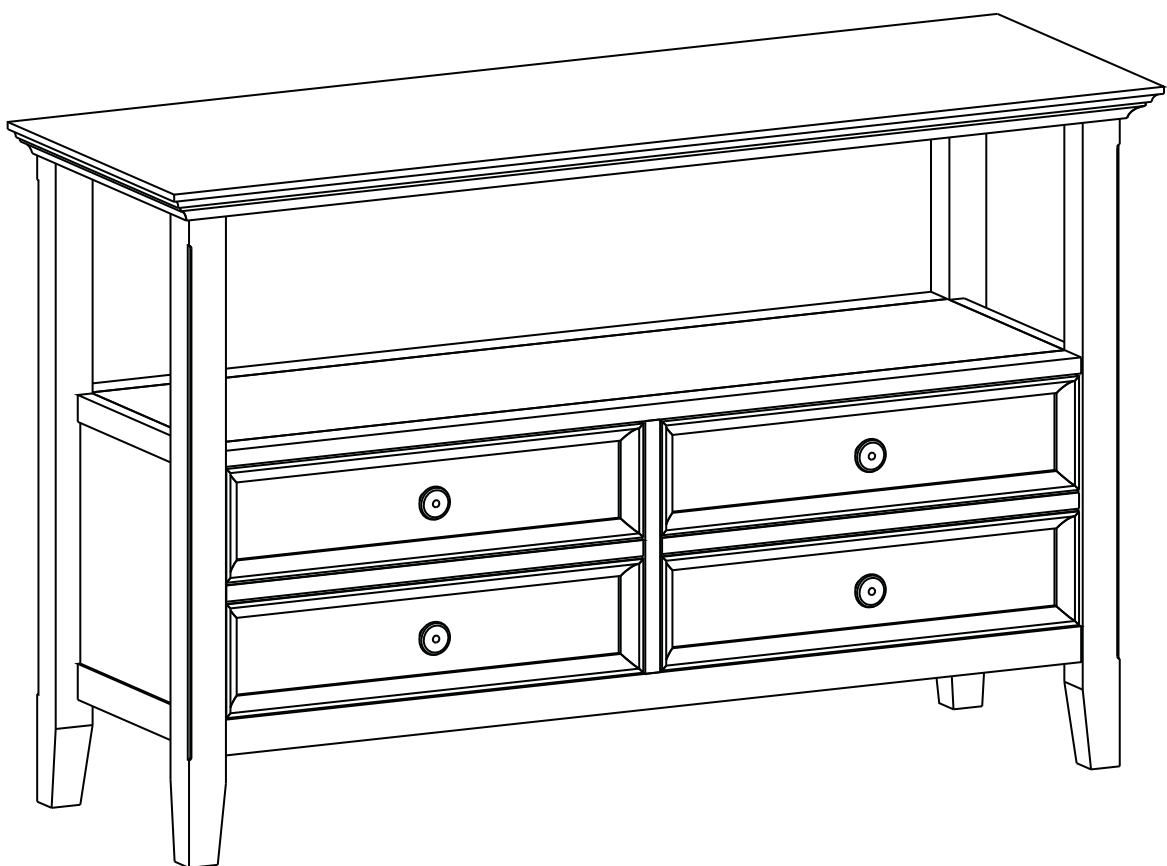

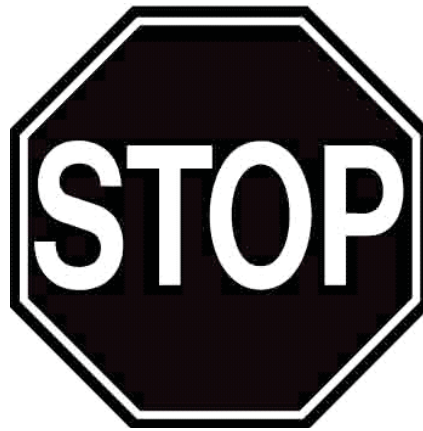

## **DO NOT RETURN**

**FOR REPLACEMENT PARTS OR OTHER INQUIRIES  
PLEASE CONTACT US**

**PLEASE ENSURE TO HAVE THE MODEL #  
FROM THE PACKAGING OR  
INSTRUCTION BOOKLET**

**IMPORTANT :** Please read this manual carefully before beginning assembly of this product. Keep this manual for future reference.

## SAFETY INFORMATION

Identify all the parts and hardware. Do not discard of the packaging until you have checked that you have all of the parts and hardware required. Hardware package may have spare parts.

**WARNING:** This item contains small parts which can be swallowed by children and pets. Keep children and pets away during assembly. To avoid danger of suffocation, always keep plastic bags away from children and pets.

We recommend that you assemble this unit on a carpeted floor to avoid scratches. We do not recommend the use of power tools for assembly as this could damage the unit. Only use manual tools.

May require 2 people for ease of assembly.

## CARE and MAINTENANCE

To clean, use a soft or slightly damp cloth, then wipe with a clean, dry cloth. Dust with soft dry cloth.

Do not use ammonia-based cleaning products, as they will damage the finish.

Do not leave liquids or damp cloths on this furniture.

To avoid dulling of the finish, do not place furniture in direct sunlight.

Please inspect and tighten all screws or bolts on a regular basis to ensure proper performance and safety of your item.

## PRE-ASSEMBLY INFORMATION

### PARTS DESCRIPTION

A

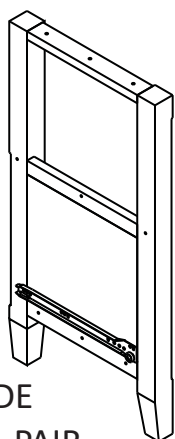

SIDE  
QTY 1 PAIR

B

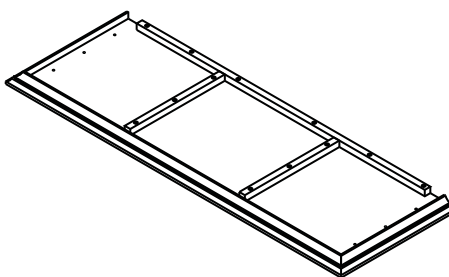

TOP  
QTY 1

C

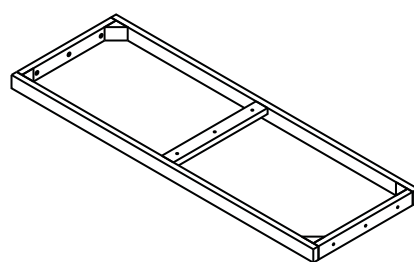

BOTTOM FRAME  
QTY 1

D

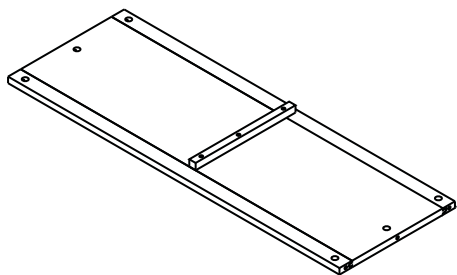

TOP SHELF  
QTY 1

E

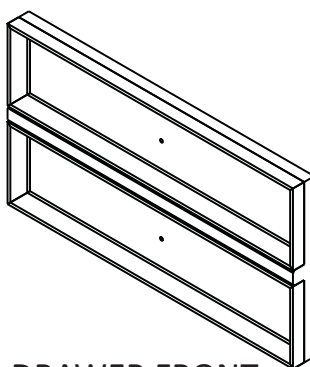

DRAWER FRONT  
QTY 2

F

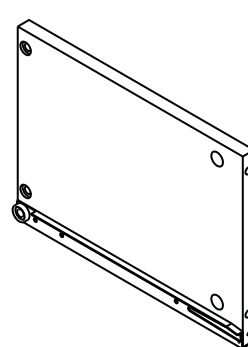

DRAWER SIDE  
QTY 2 PAIRS

G

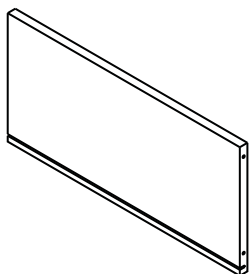

DRAWER BACK  
QTY 2

H

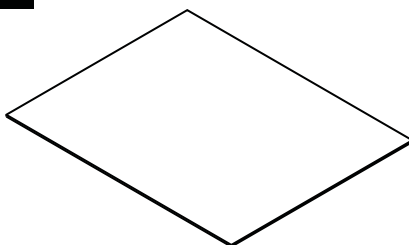

DRAWER BOTTOM  
QTY 2

I

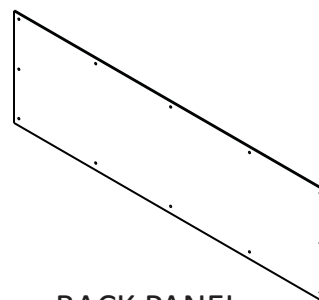

BACK PANEL  
QTY 1

J

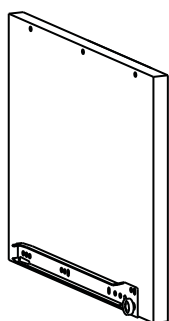

DIVIDER  
QTY 1

**NEED HELP?** For help with assembly or if you are missing a part,  
Please call customer service

# PRE-ASSEMBLY INFORMATION

## HARDWARE DESCRIPTION

1

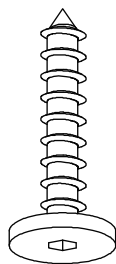

ALLEN KEY SCREW  
M6 X 30 mm  
QTY 26

2

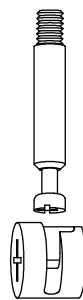

CAM LOCK PIN  
CAM LOCK  
QTY 14 SETS

3



ALLEN KEY  
QTY 1

4

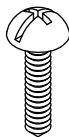

PHILLIPS SCREW  
ROUND HEAD  
M4 X 15mm  
QTY 12

5

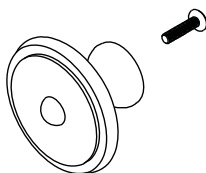

HANDLE  
QTY 4 SETS

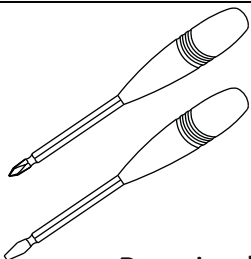

Required -  
Flathead screwdriver  
Phillips screwdriver  
**Not Included**

**NEED HELP?** For help with assembly or if you are missing a part,  
Please call customer service

## COMPONENTS – KEY DIAGRAM

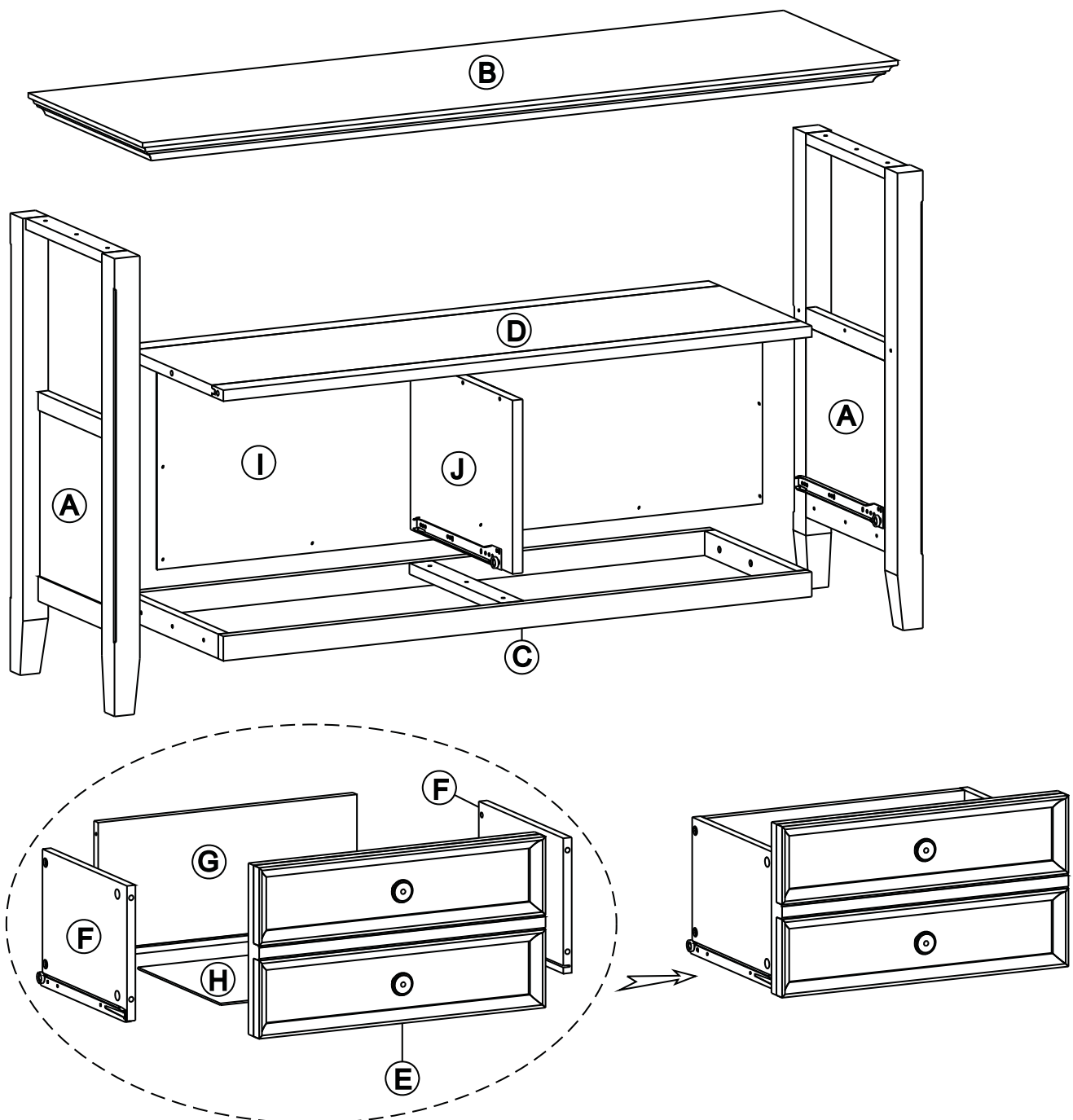

# ASSEMBLY

## STEP 1

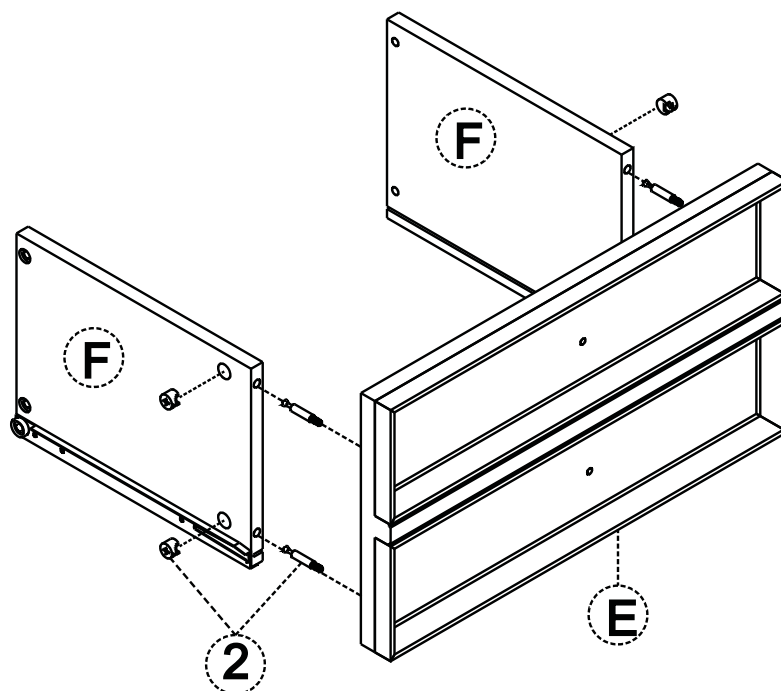

1. Attach 4 Cam Lock Pins (2) to back of Drawer Front (E).
2. Align Cam Lock Pins with pre-drilled holes and attach Drawer Sides (F).
3. Insert 2 Cam Lock (2) into pre-drilled holes on each Drawer Side (F).
4. Use flathead screwdriver to secure Cam Locks.

## STEP 2

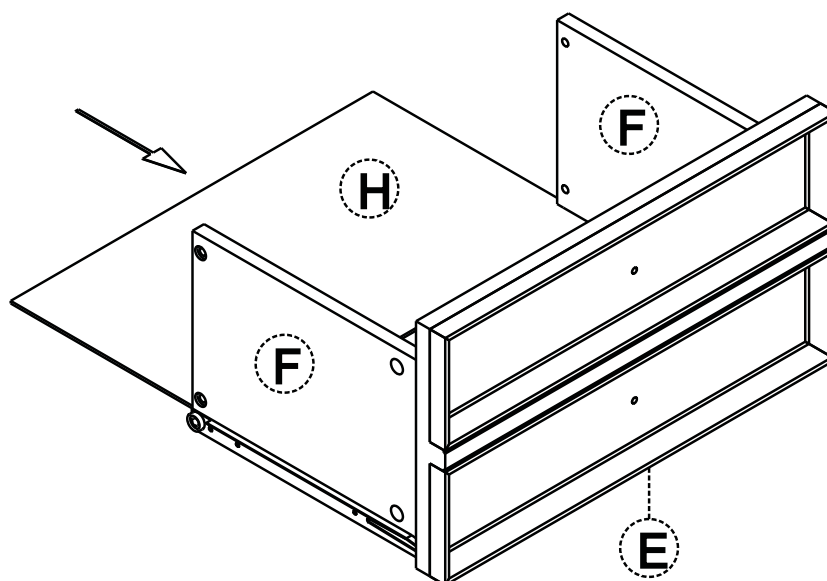

1. Slide Drawer Bottom (H) firmly into slots on Drawer Side (F) and Drawer Front (E).

## ASSEMBLY

### STEP 3

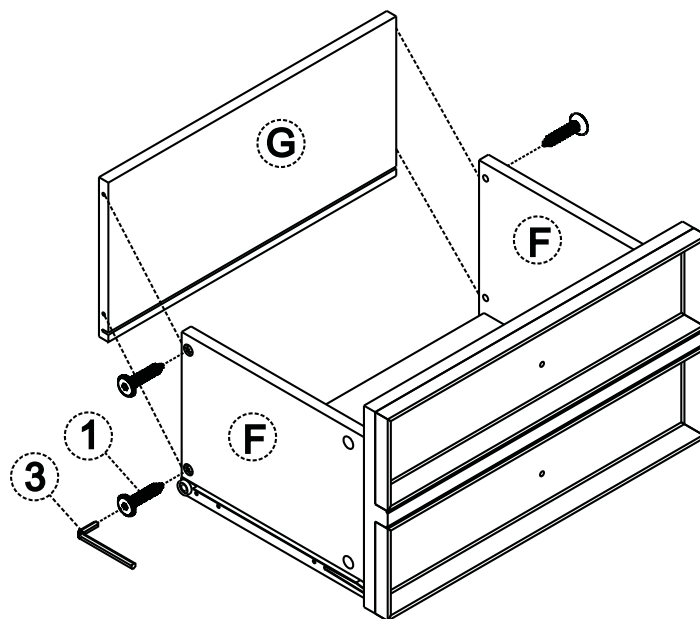

1. Align Drawer Back (G) with Drawer Bottom (H) and press firmly into slot .
2. Attach back using 2 Allen Key Screws (1) through pre-drilled holes on each side.
3. Use Allen Key (3) to tighten. Do not over tighten.

### STEP 4

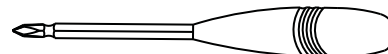
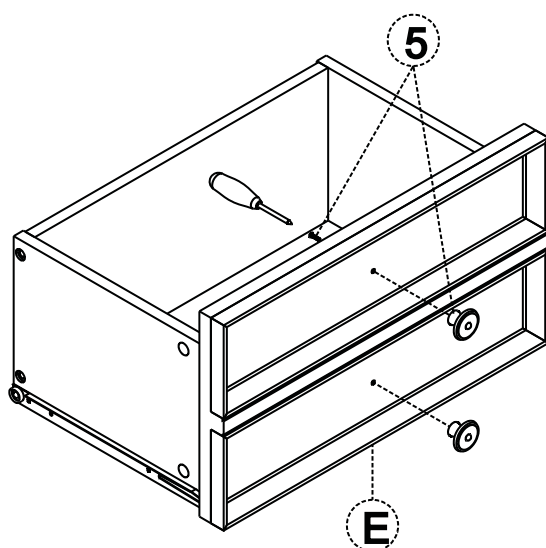

**NOTE:** The screwdriver is not included in the hardware pack.

1. Use Phillips screwdriver to attach Handle (5) to Drawer Front (E).

Repeat Step 1-4 for the second drawer.

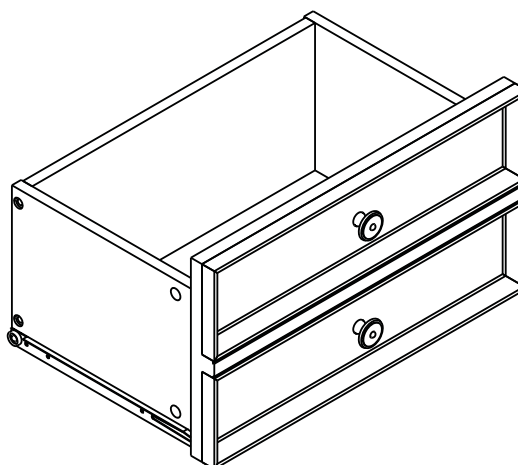



# ASSEMBLY

## STEP 5

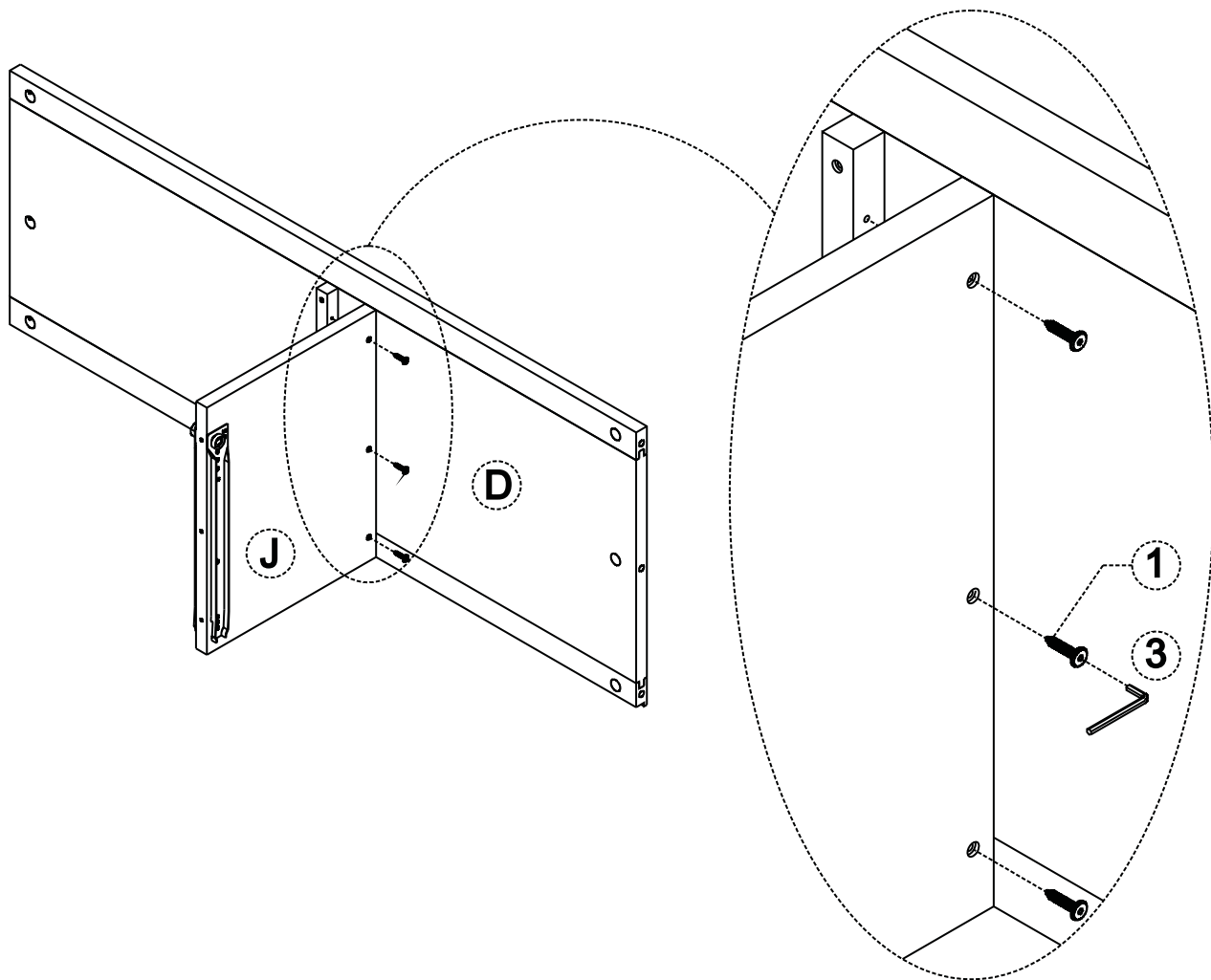

1. Insert 3 Allen Key Screws (1) into pre-drilled holes through the Divider (J) into bar on Top Shelf (D).
2. Use Allen Key (3) to tighten. Do not over-tighten.

## ASSEMBLY

### STEP 6

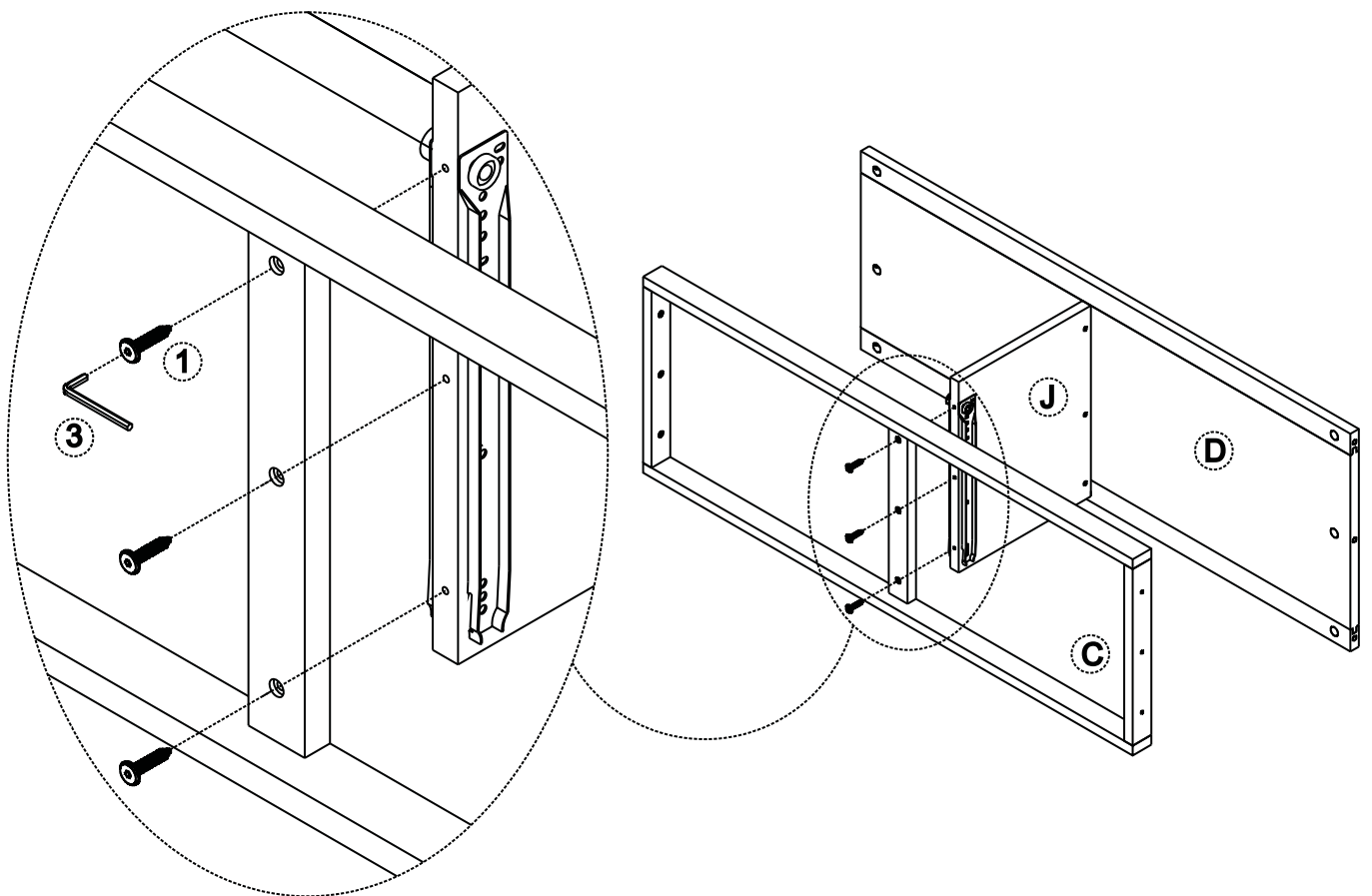

1. Insert 3 Allen Key Screws (1) into pre-drilled holes through centre of Bottom Frame (C) into Divider (J).
2. Use Allen key (3) to tighten. Do not over-tighten.

# ASSEMBLY

## STEP 7

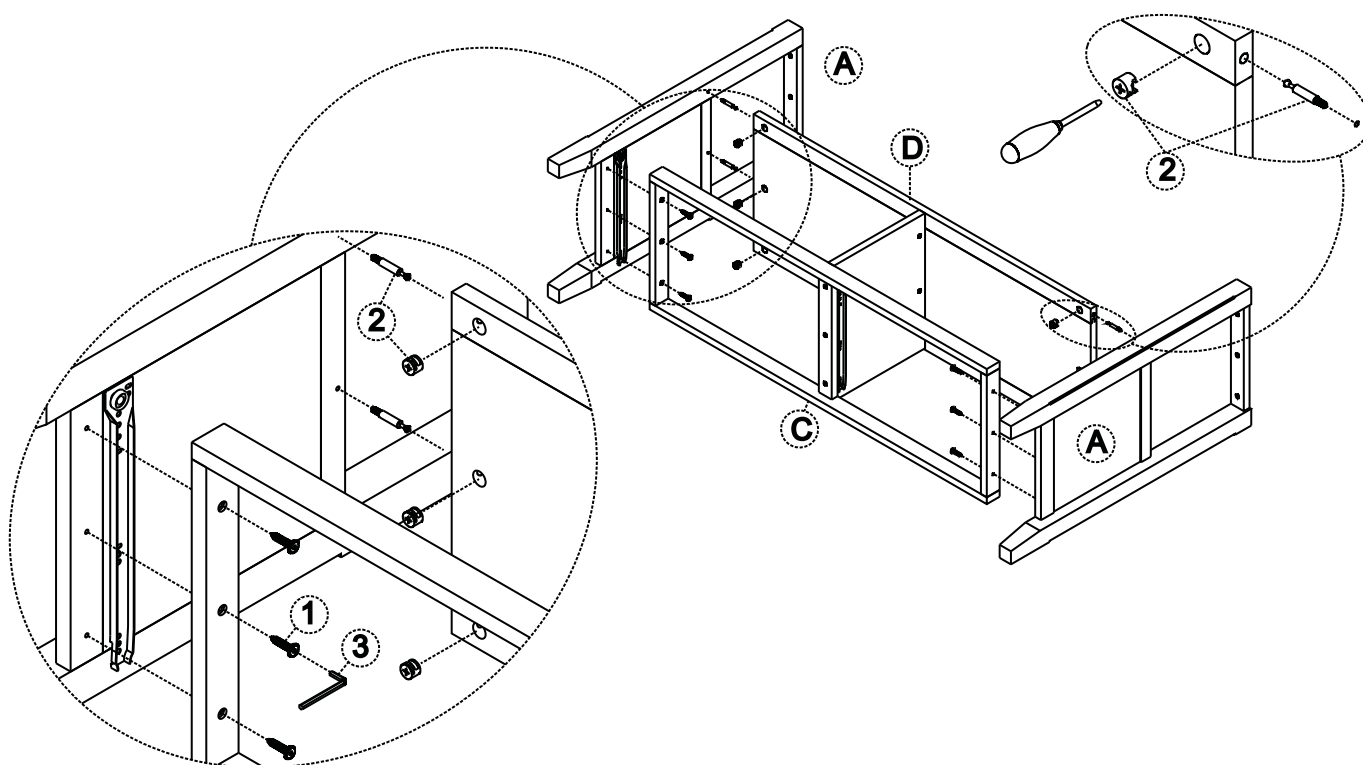

1. Attach 3 Cam Lock Pins (2) to each Side (A) using guide holes .
2. Align Cam Lock Pins with pre-drilled holes on Top Shelf (D) .
3. Insert 6 Cam Locks (2) into pre-drilled holes on Top Shelf (D) ( 3 / each Side) .
4. Use flathead screwdriver secure Cam Locks.
5. Insert 6 Allen Key Screws (1) into pre-drilled holes through centre Bottom Frame (C) into Side (A) (3 screws / each Side).
6. Use Allen Key (3) to tighten. Do not over-tighten.

## ASSEMBLY

### STEP 8

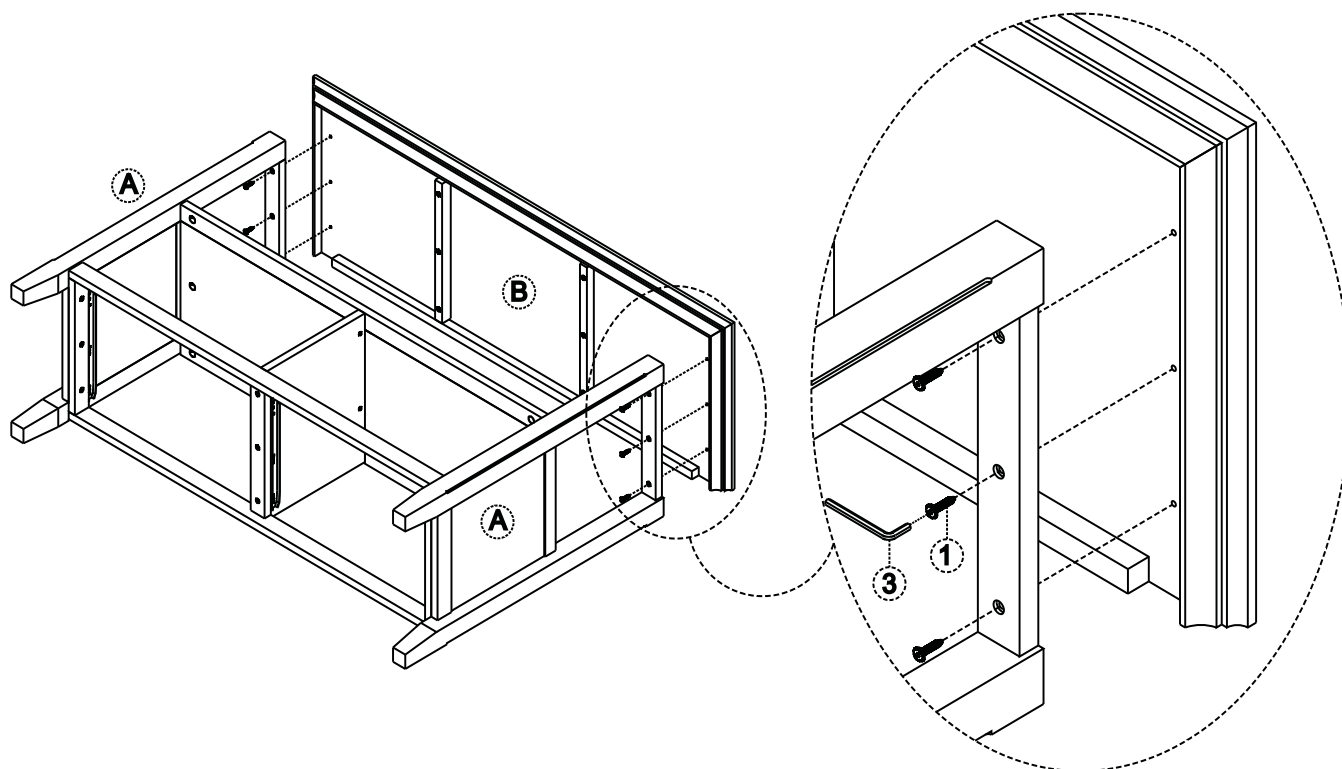

1. Insert 6 Allen Key Screws (1) into pre-drilled holes on Sides (A) into Top (B) ( 3 Screws / each Side ).
2. Use Allen Key (3) to tighten. Do not over tighten .

## ASSEMBLY

### STEP 9

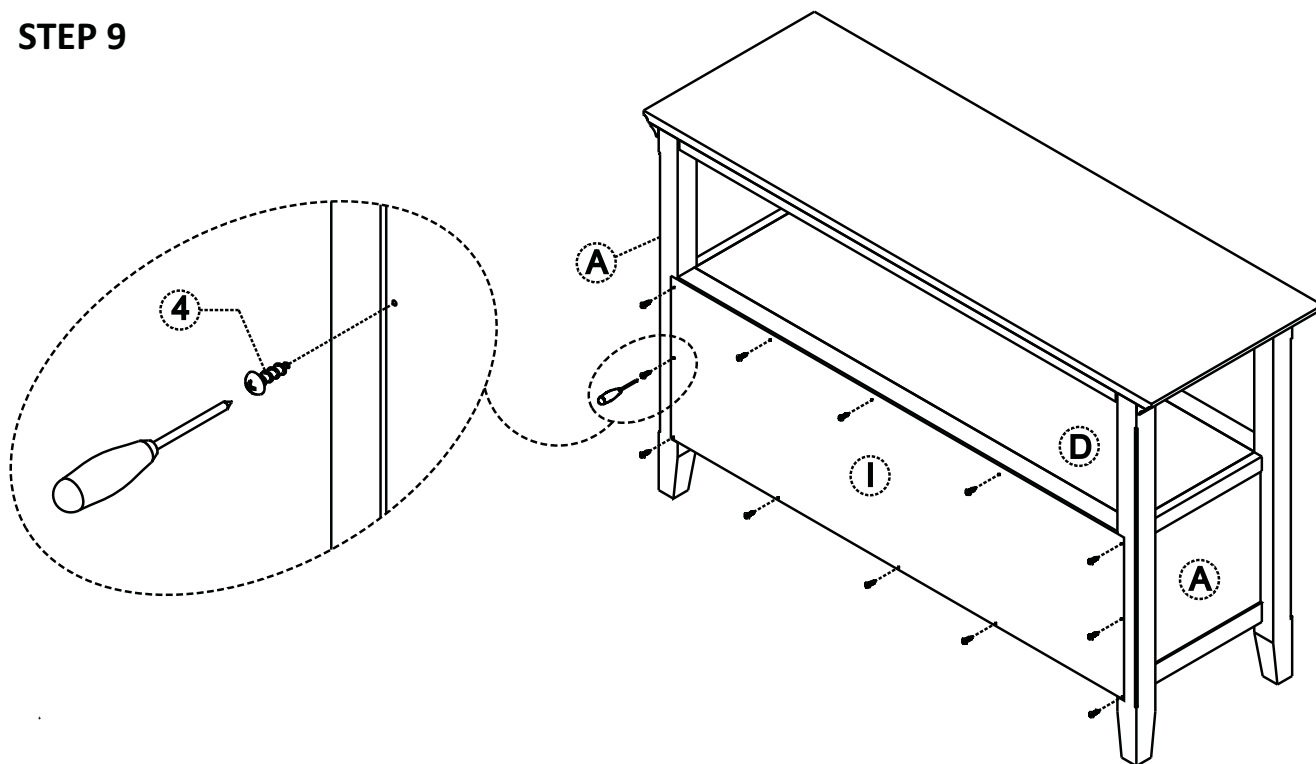

1. Attach Back Panel (I) to back frame of cabinet using Phillips Screws Round Head (4) into pre-drilled guide holes.
2. Use Phillips screwdriver to tighten screws. Do not over tighten.

### STEP 10

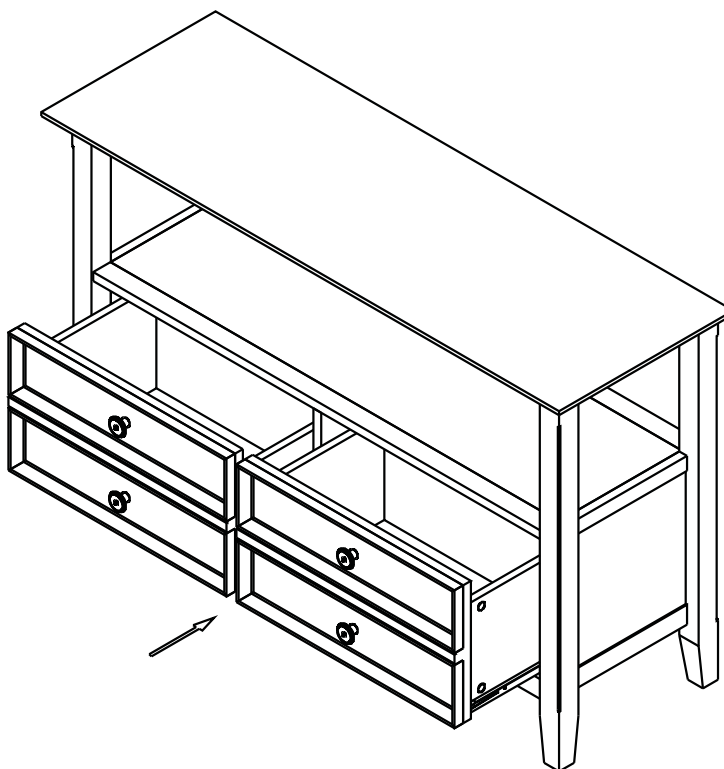

1. Insert assembled drawers into slides on assembled table.

## WARRANTY

Thank you for purchasing a product. These products have been made to demanding, high-quality standards and are guaranteed for domestic use against manufacturing faults for a period of 12 months from the date of purchase. This warranty does not affect your statutory rights.

In case of any malfunction of your product (failure, missing parts, etc.) please contact us at our toll free service line .

We reserve the right to repair or replace the defective product, at its discretion.

This product is guaranteed for 12 months if used for normal purposes. Any warranty is invalid if the product has been overloaded or subject to neglect, improper use or an attempted repair by other than an authorized agent. Heavy-duty or daily professional/commercial usage are not guaranteed.

Due to continuous product improvement, we reserve the right to change the product specifications without prior notice.

**PLEASE NOTE:** This item is hand-crafted and hand-finished with utmost care. As such, variations and imperfections should be expected and should be welcomed as the natural beauty of the wood.