

Rockport Desk

KEEP INSTRUCTIONS FOR FUTURE USE.

**FOR CUSTOMER SERVICE CALL
US. DO NOT CALL RETAILER OR RESELLER
FOR SERVICE AS THEY ARE NOT
AUTHORIZED TO RESOLVE ANY SERVICE
ISSUES.**

**FOR WARRANTY AND FEDERAL SAFETY
STANDARD COMPLIANCE CERTIFICATES,
PLEASE VISIT OUR WEBSITE**

ASSEMBLY ASSISTANCE

**IMPORTANT: Retain for future reference and
read carefully.**

We strive for the highest quality in our products
but occasionally a missing part or problem can
occur during assembly.

If any parts are missing, broken, or you need
assistance with assembly, DO NOT return the
product to your dealer. Go to our website or call
for assistance (Monday through Friday, 9:00
a.m.-4:00 p.m. Eastern Time). Please have the
model number and manufacture date available
when you call or write us.

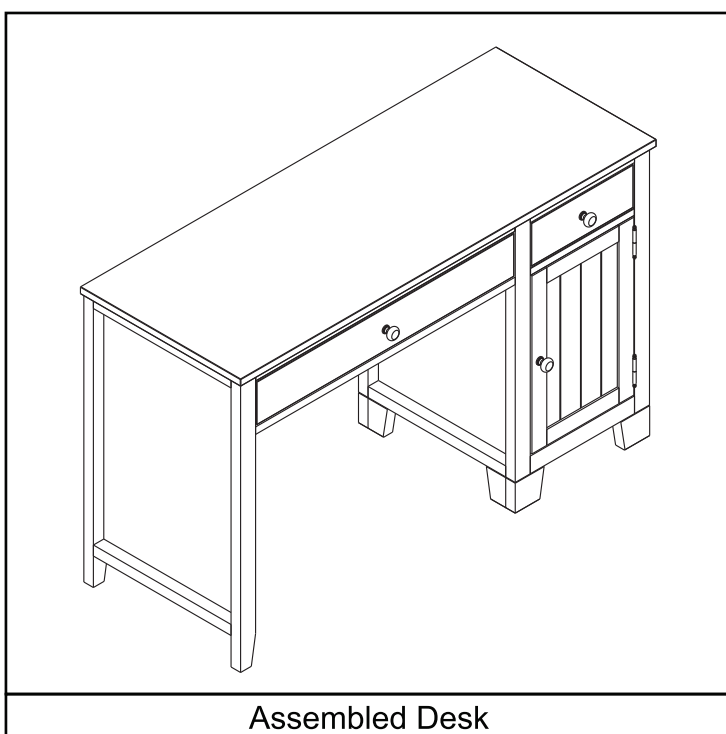

ASSEMBLY INSTRUCTIONS

- Adult assembly required.
- Read all instructions BEFORE assembly and USE of product.
- Unpack carton, remove packing materials, including polybag. Identify and check all parts.

Record the information for your product here:

Model number: _____

Manufacture date: _____

PO number: _____

PARTS LIST

| Part Description | Part Number | Quantity |
|-------------------------|-------------|----------|
| A. End Panel - Left | | 1 |
| B. Division | | 1 |
| C. End Panel - Right | | 1 |
| D. Back Panel | | 1 |
| E. Door | | 1 |
| F. Top Panel | | 1 |
| G. Lower Panel | | 1 |
| H. Shelf | | 1 |
| I. Top Back Rail | | 1 |
| J. Back Rail | | 1 |
| K. Top Front Rail | | 1 |
| L. Front Rail | | 1 |
| M. Small Front Rail | | 1 |
| N. Bottom Front Rail | | 1 |
| O. Small Top Front Rail | | 1 |
| P. Small Back Rail | | 1 |
| Q. Foot - Right | | 2 |
| R. Foot - Left | | 2 |
| S. Drawer Front | | 1 |
| T. Drawer Back | | 1 |
| U. Drawer Bottom | | 1 |
| V. Small Drawer Front | | 1 |
| W. Small Drawer Back | | 1 |
| X. Drawer Right Side | | 2 |
| Y. Drawer Left Side | | 2 |
| Z. Small Drawer Bottom | | 1 |
| AA. Dowel Ø8 | | 39 |
| BB. Dowel Ø6 | | 23 |
| CC. Flat Head Screw | | 56 |
| DD. Flat Head Screw | | 18 |
| EE. Flat Head Screw | | 10 |
| FF. Glides Screw | | 16 |
| GG. Metal Plate | | 1 |
| HH. Door Latch | | 1 |
| II. Metal Pin | | 4 |
| JJ. Glides | | 2 |
| KK. Knob | | 3 |
| LL. Knob Screw | | 3 |
| MM. Door Hinge | | 2 |

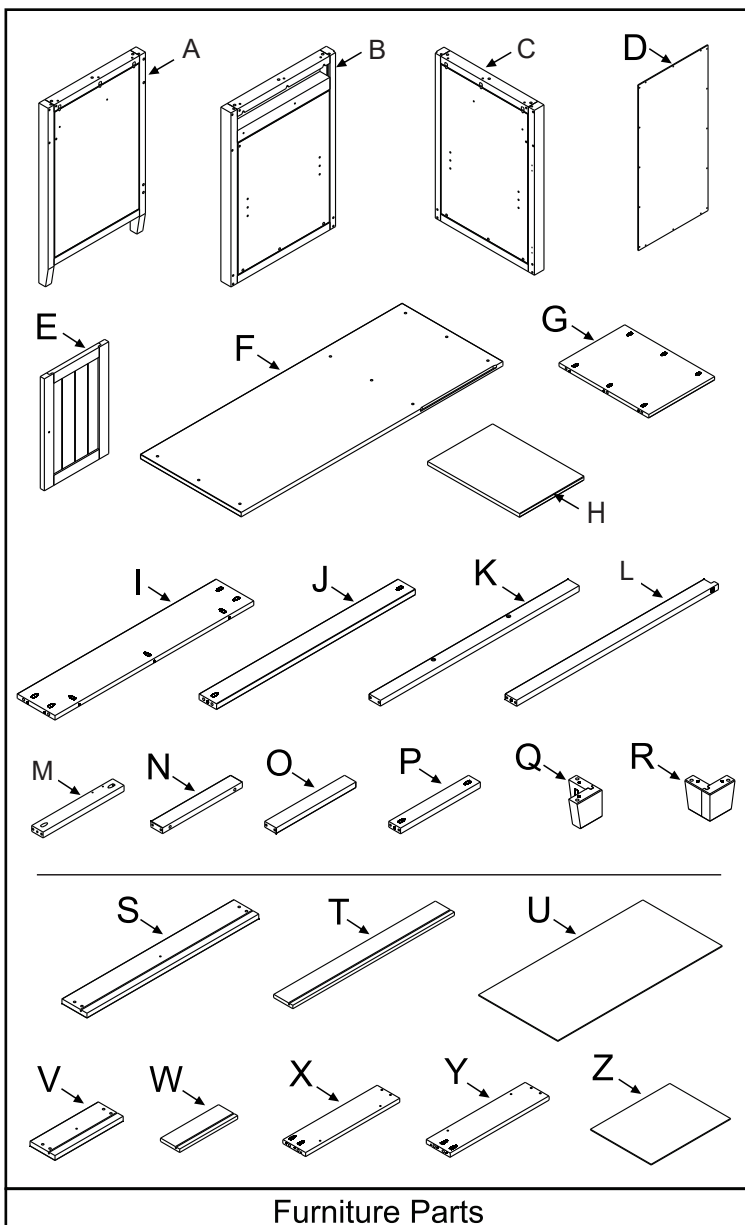

Furniture Parts

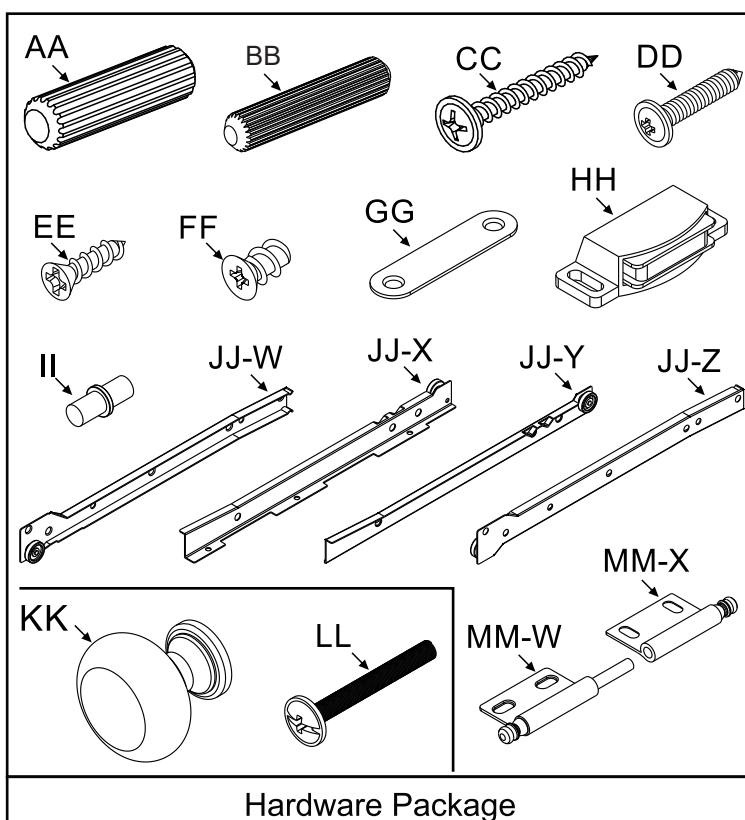

Hardware Package

PREPARATION

Carefully remove and lay out all hardware and parts.

Check quantities and match the parts list.

Construct case on an even flat floor.

Note: during the assembly process whenever using screws or bolts, check each with the parts list by letter and size identification.

Be sure to use the proper size specified in the assembly directions. If any parts are missing or broken or you need assistance with assembly.

DO NOT return your product to the dealer. Please identify the furniture by the model number identification stamped on the assembly when you call or write to Child Craft. Make note of all identification numbers and include this information with your request.

DO NOT Substitute Parts!

SUGGESTED TOOLS

#2 Medium Straight Screwdriver

STEP 1

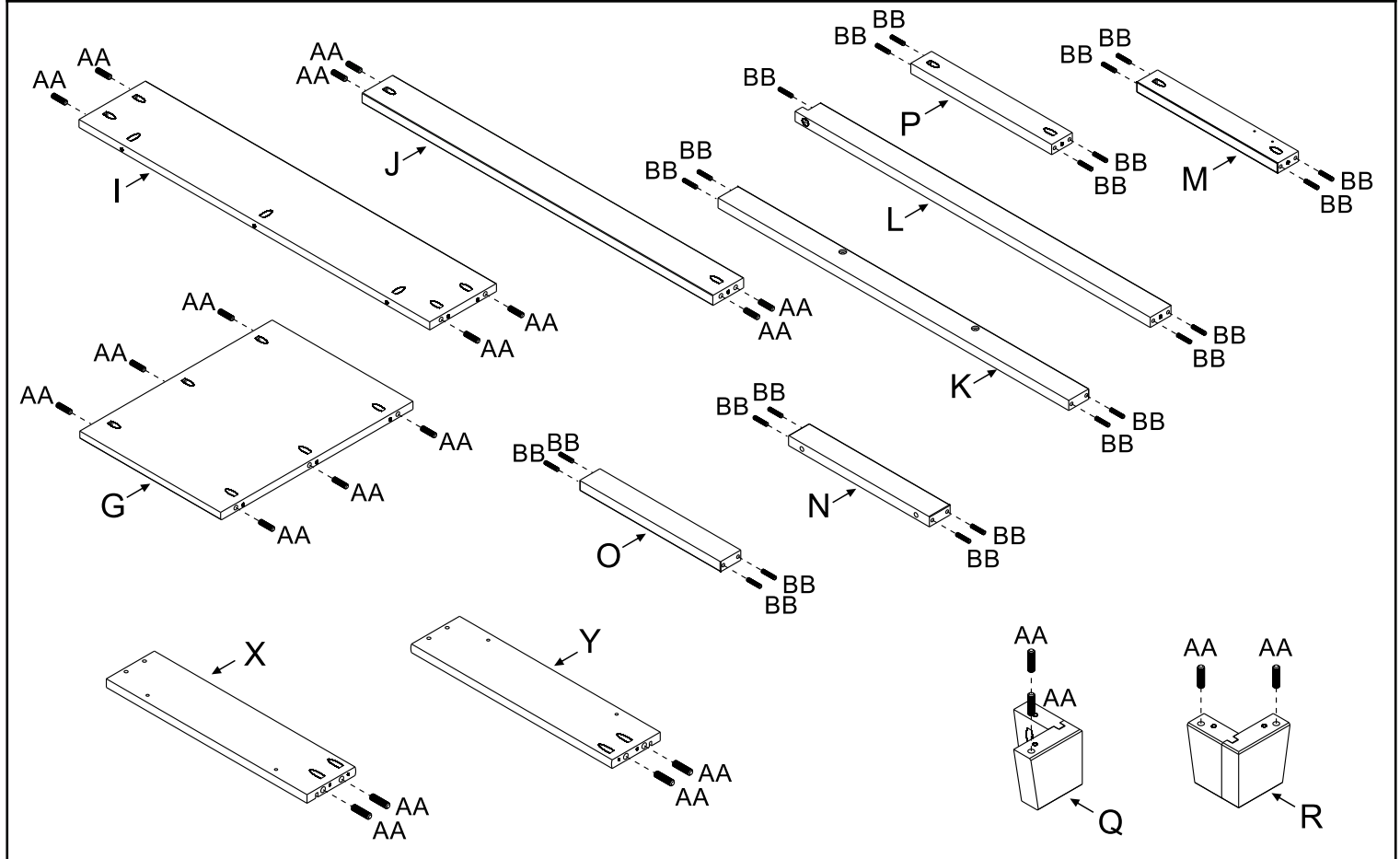

STEP 2

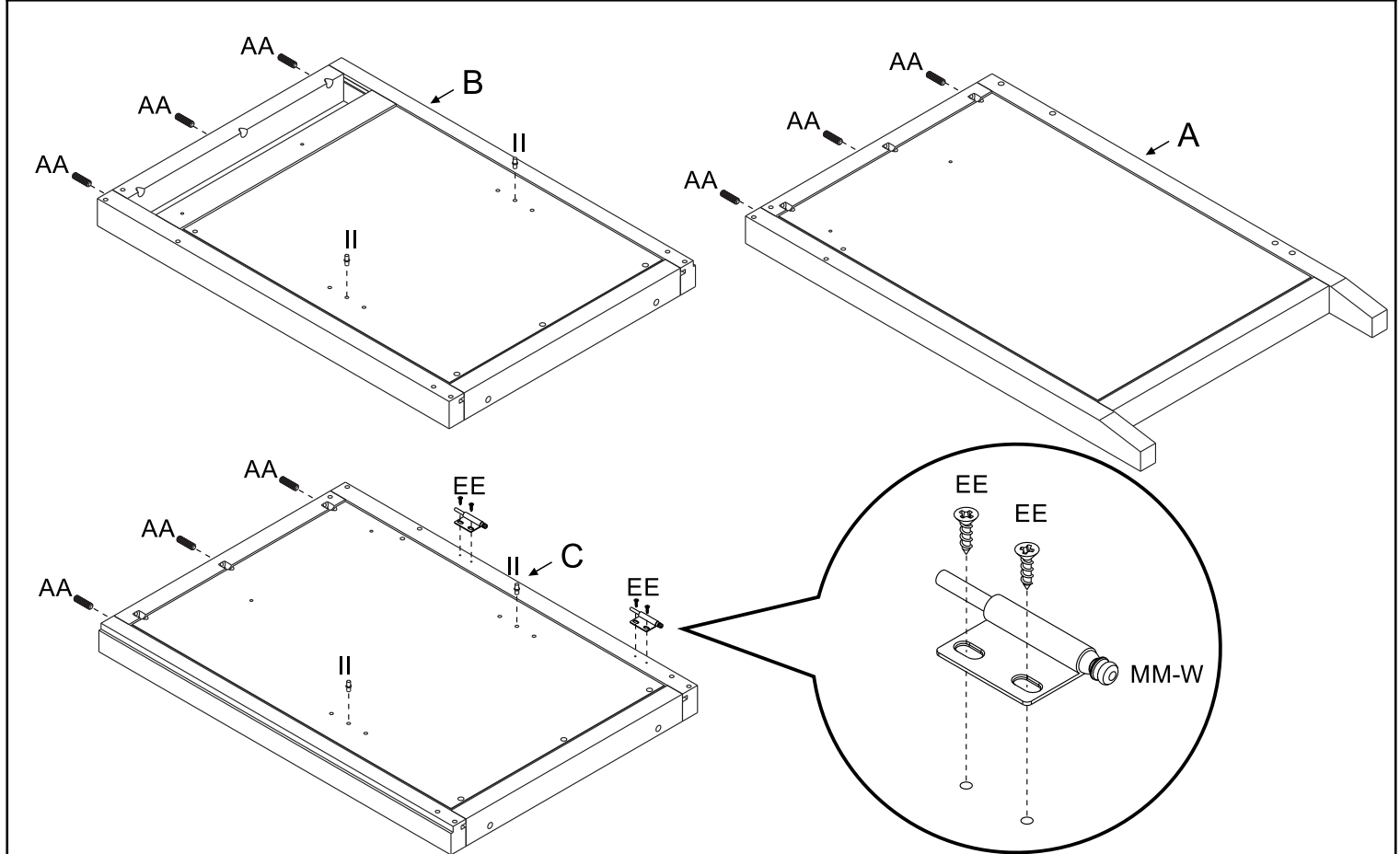

STEP 3

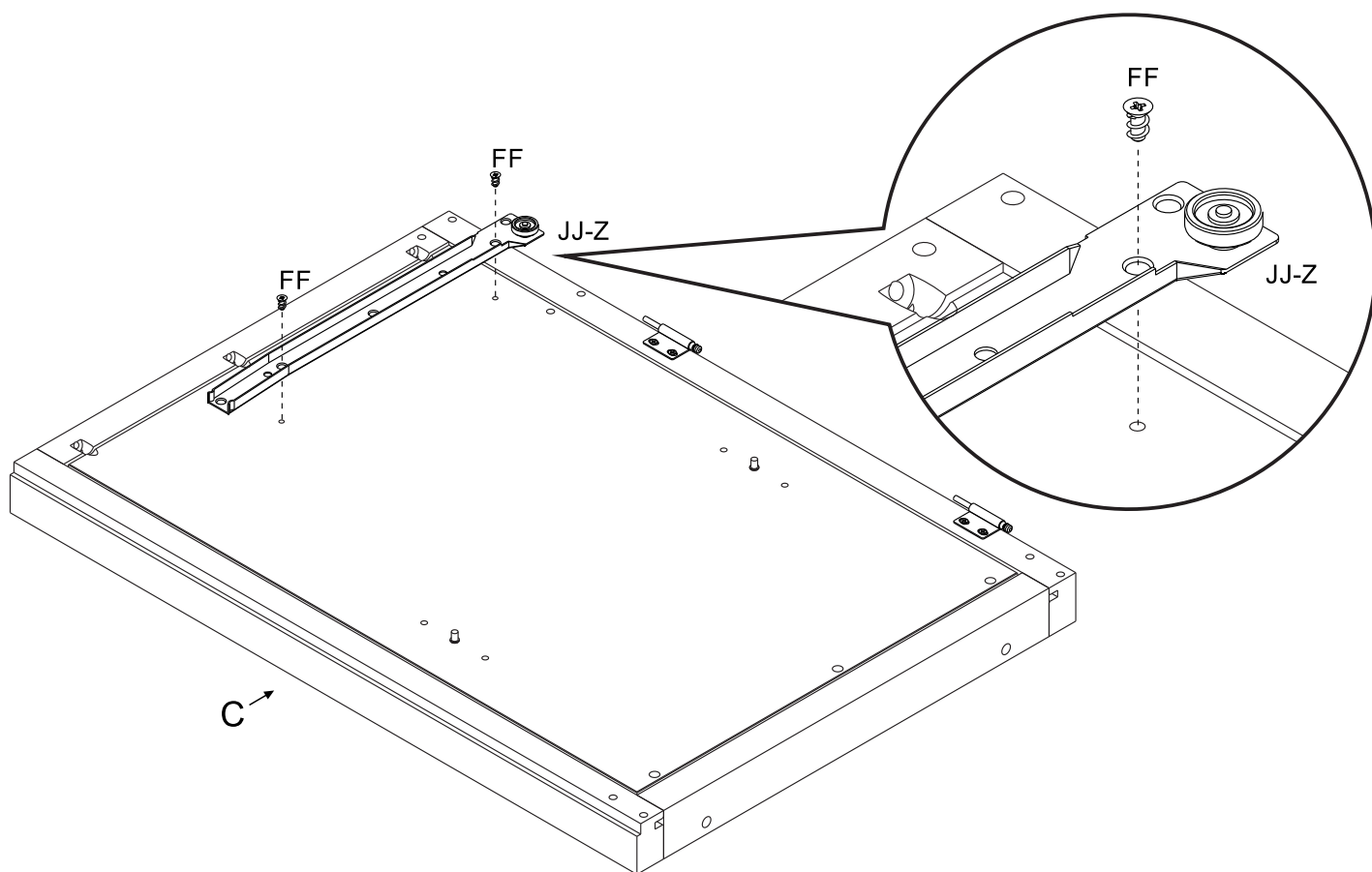

STEP 4

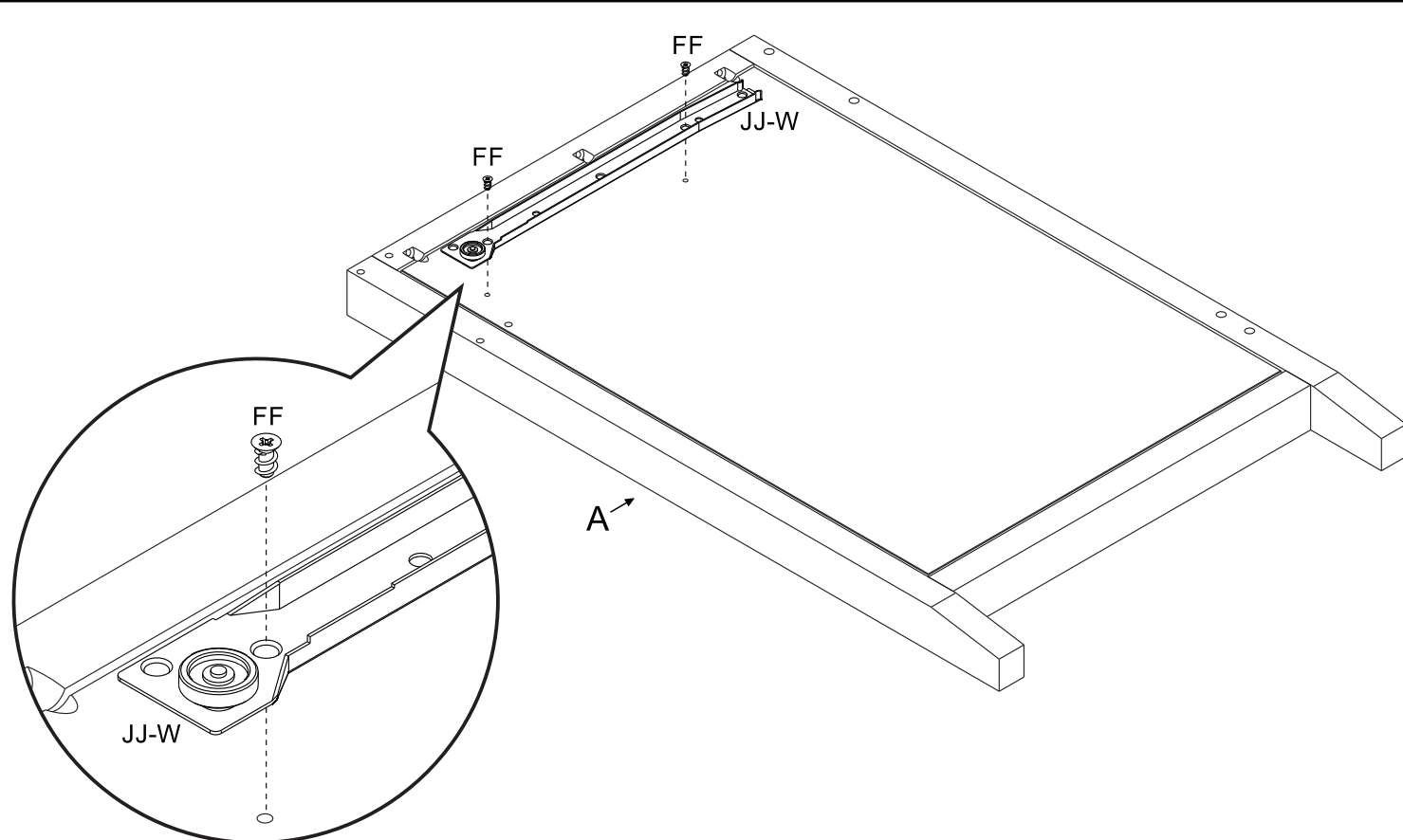

STEP 5

First

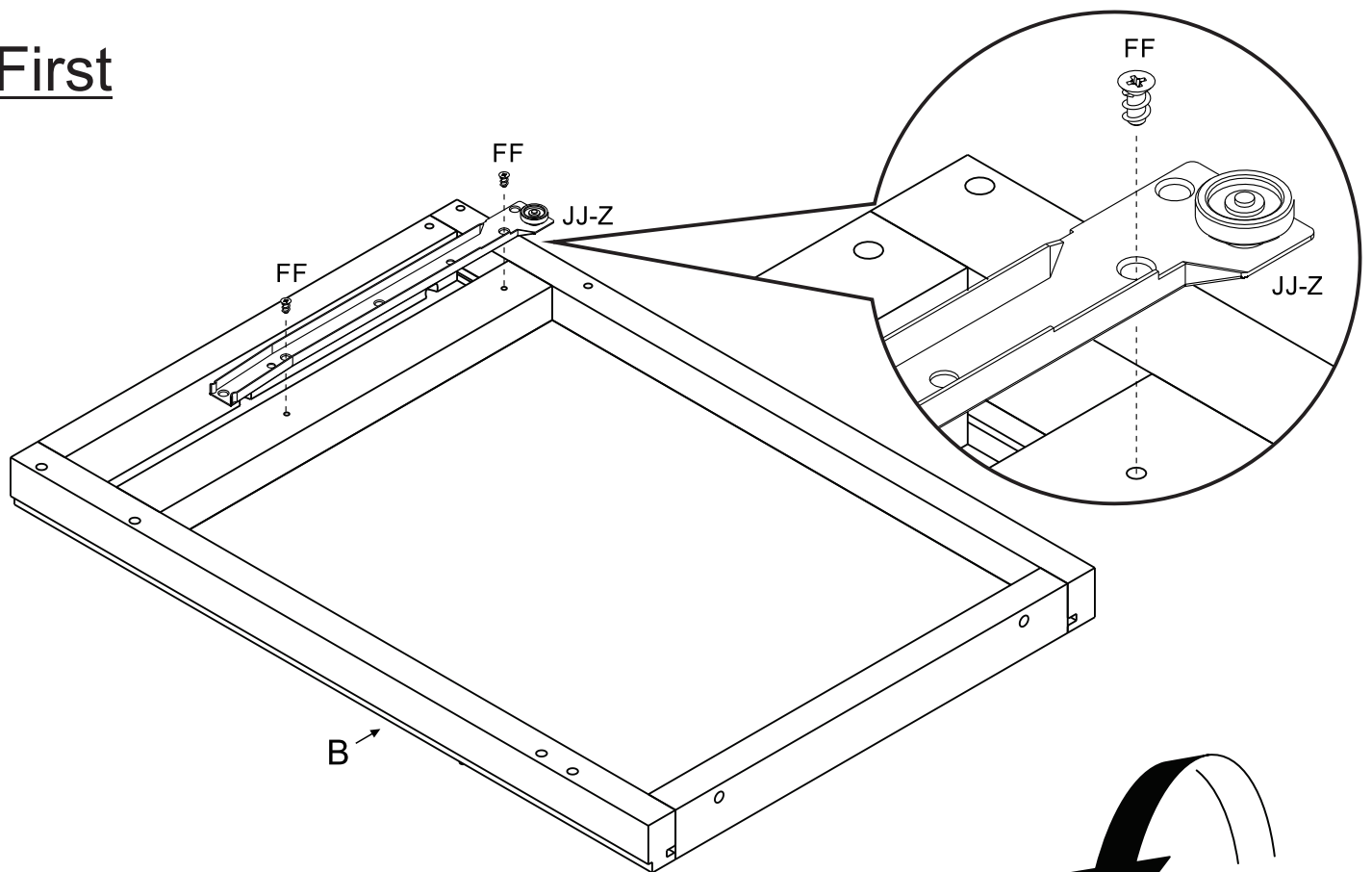

Second

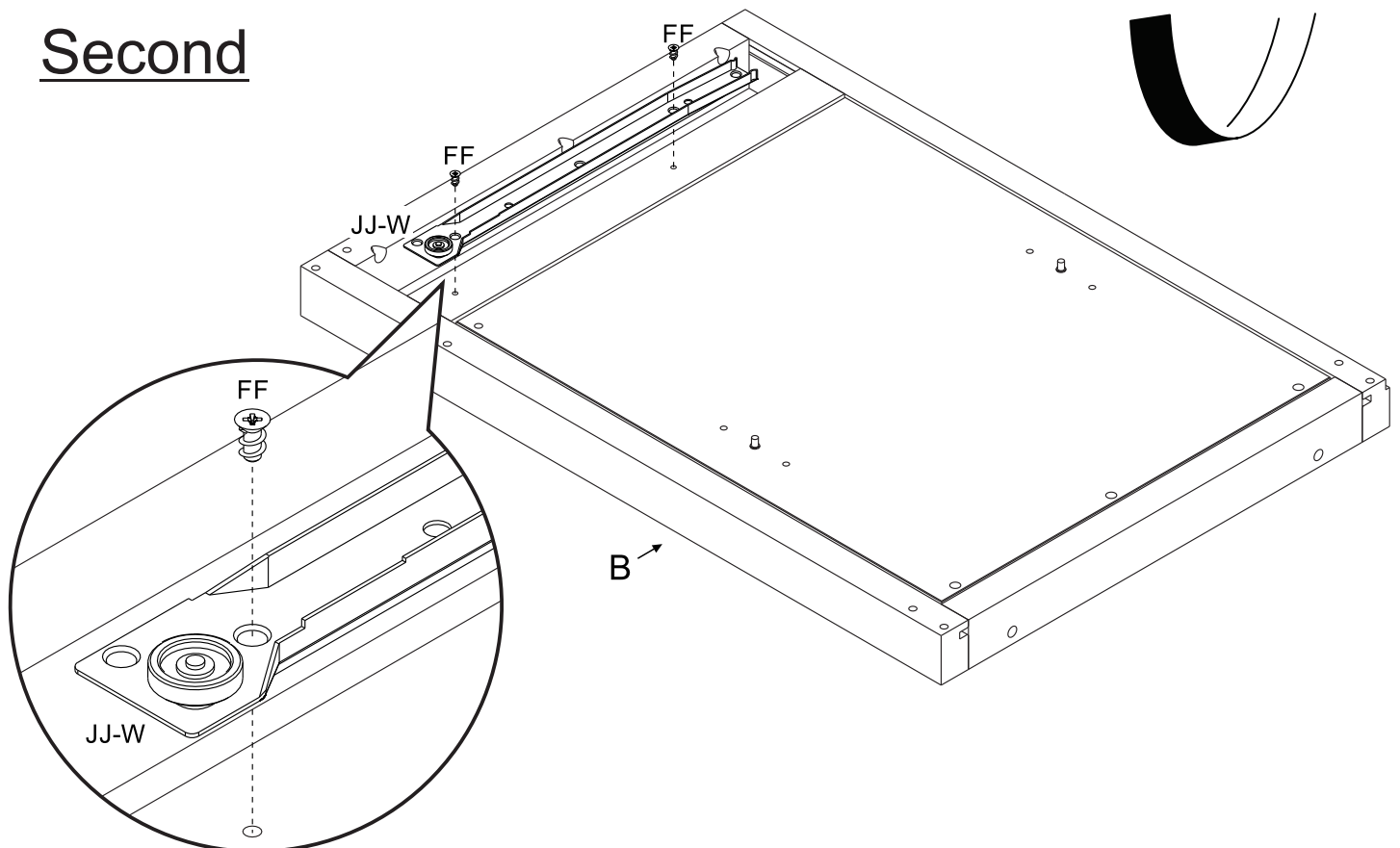

STEP 6

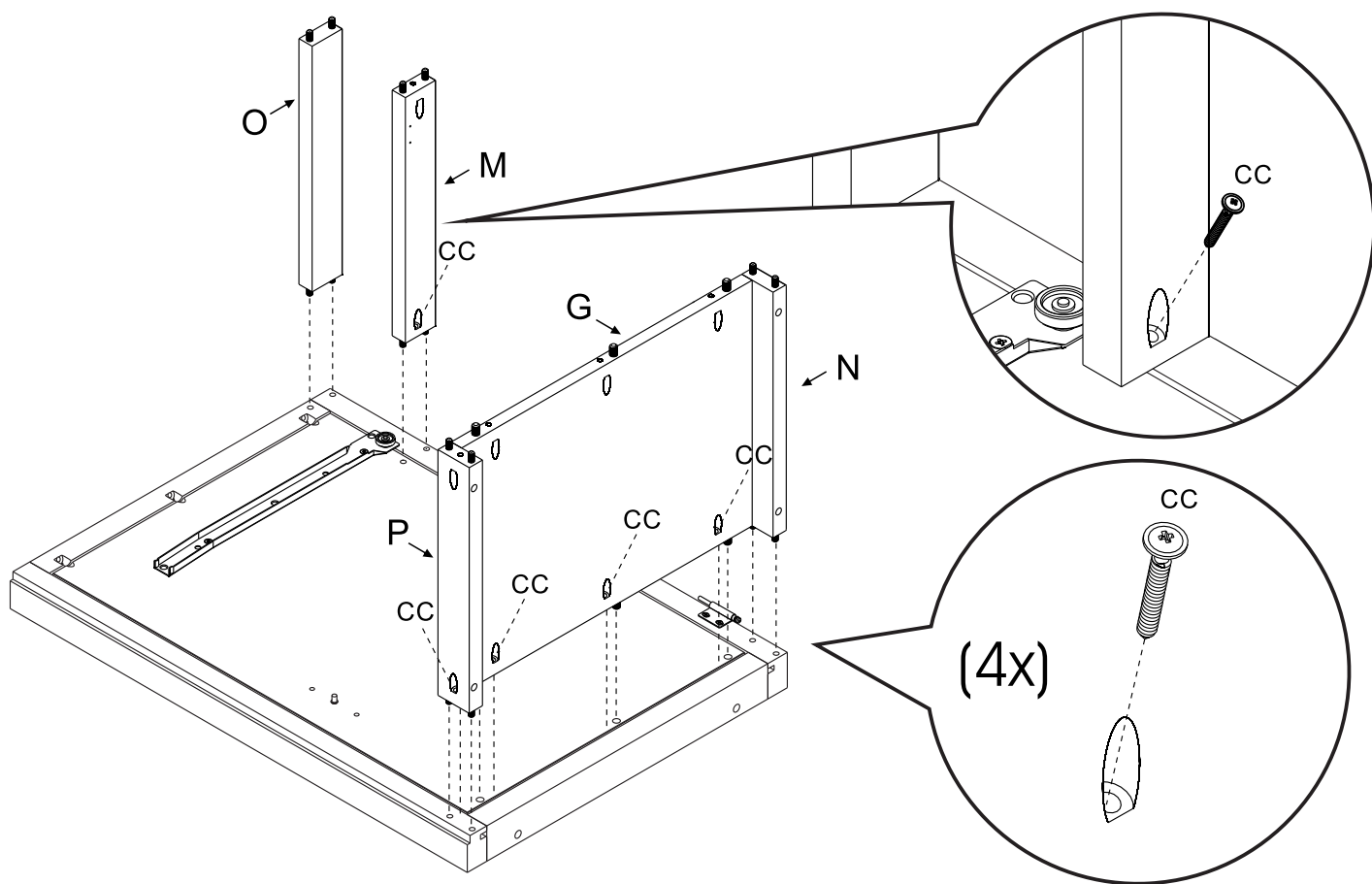

STEP 7

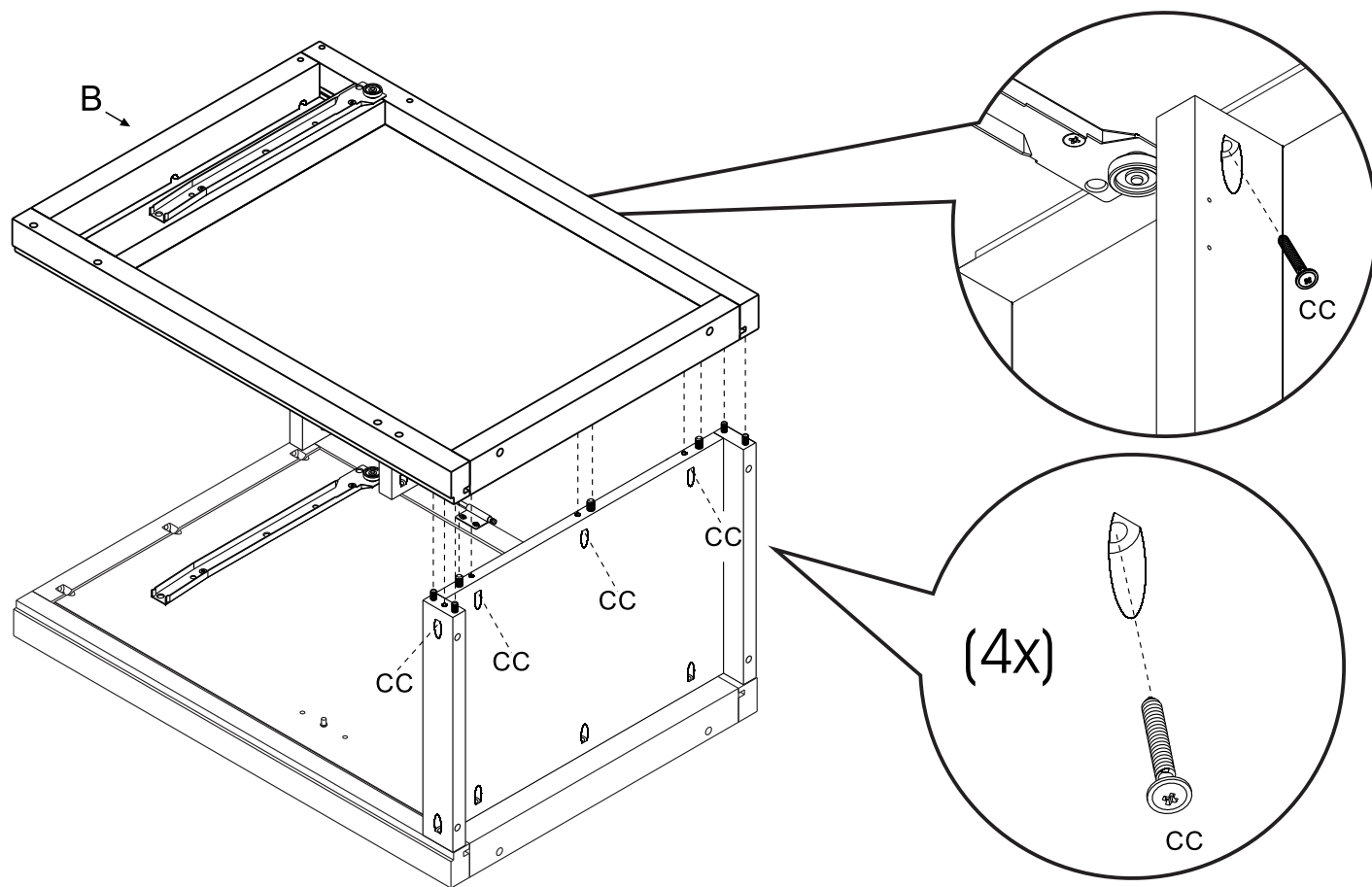

STEP 8

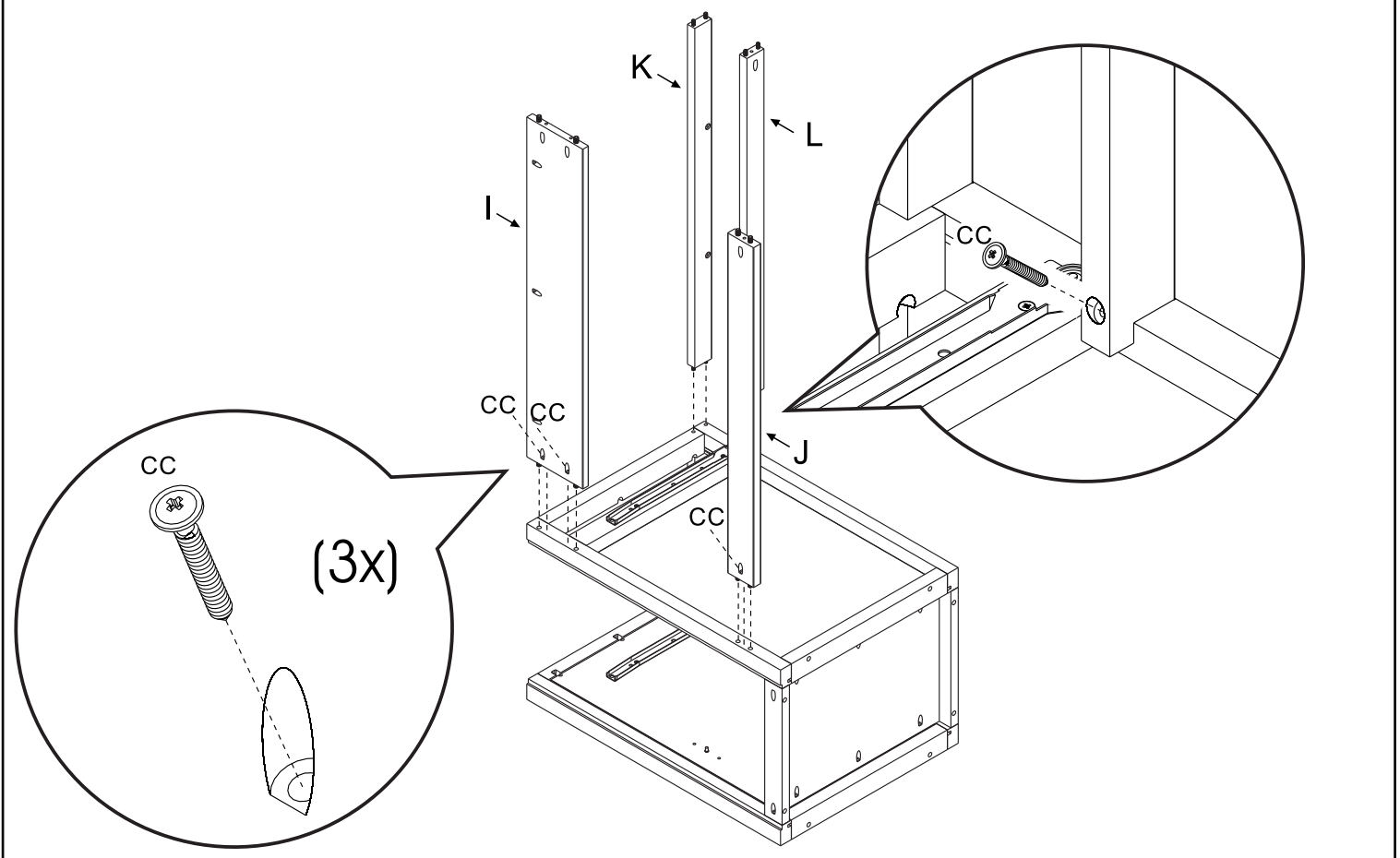

STEP 9

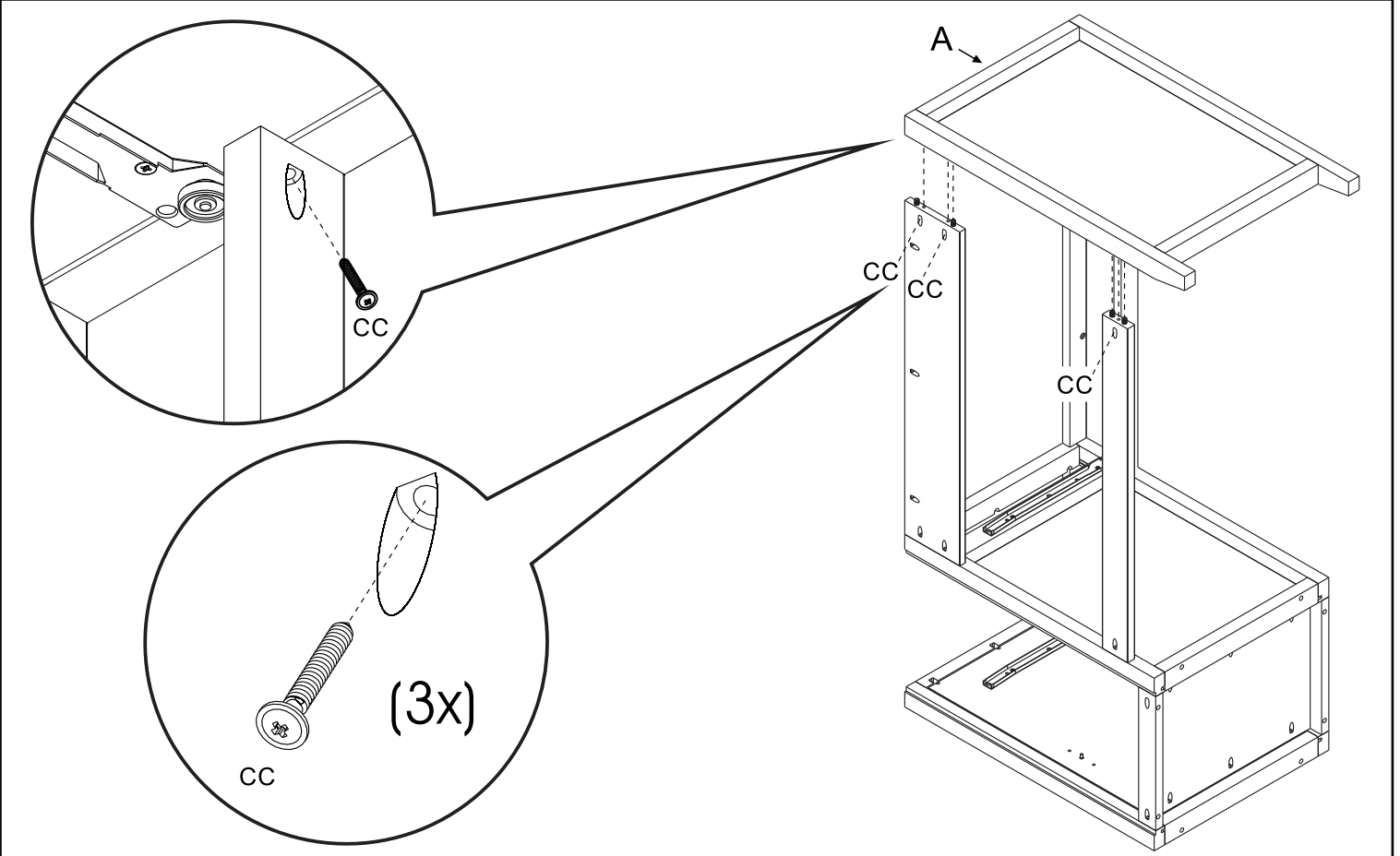

STEP 10

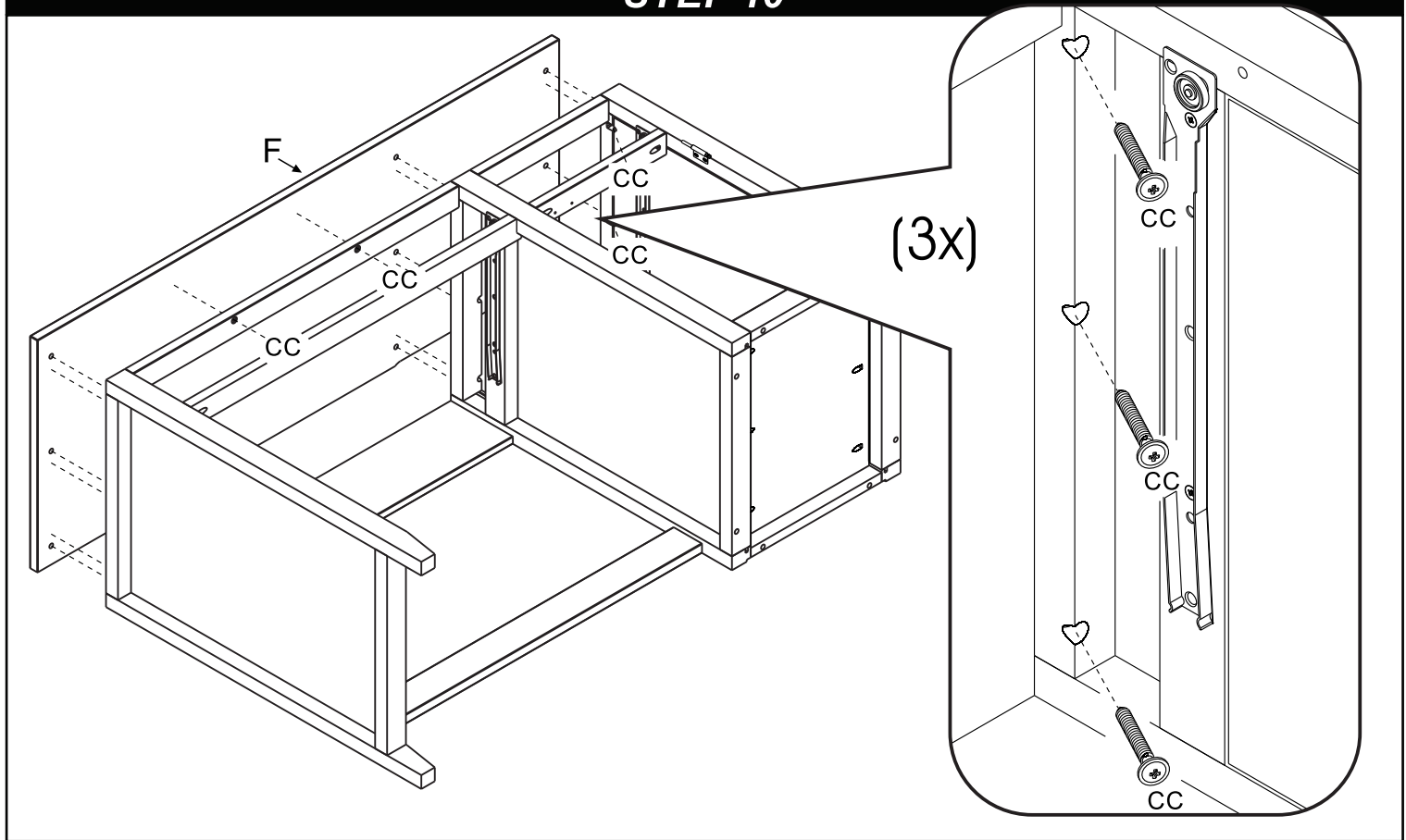

STEP 11

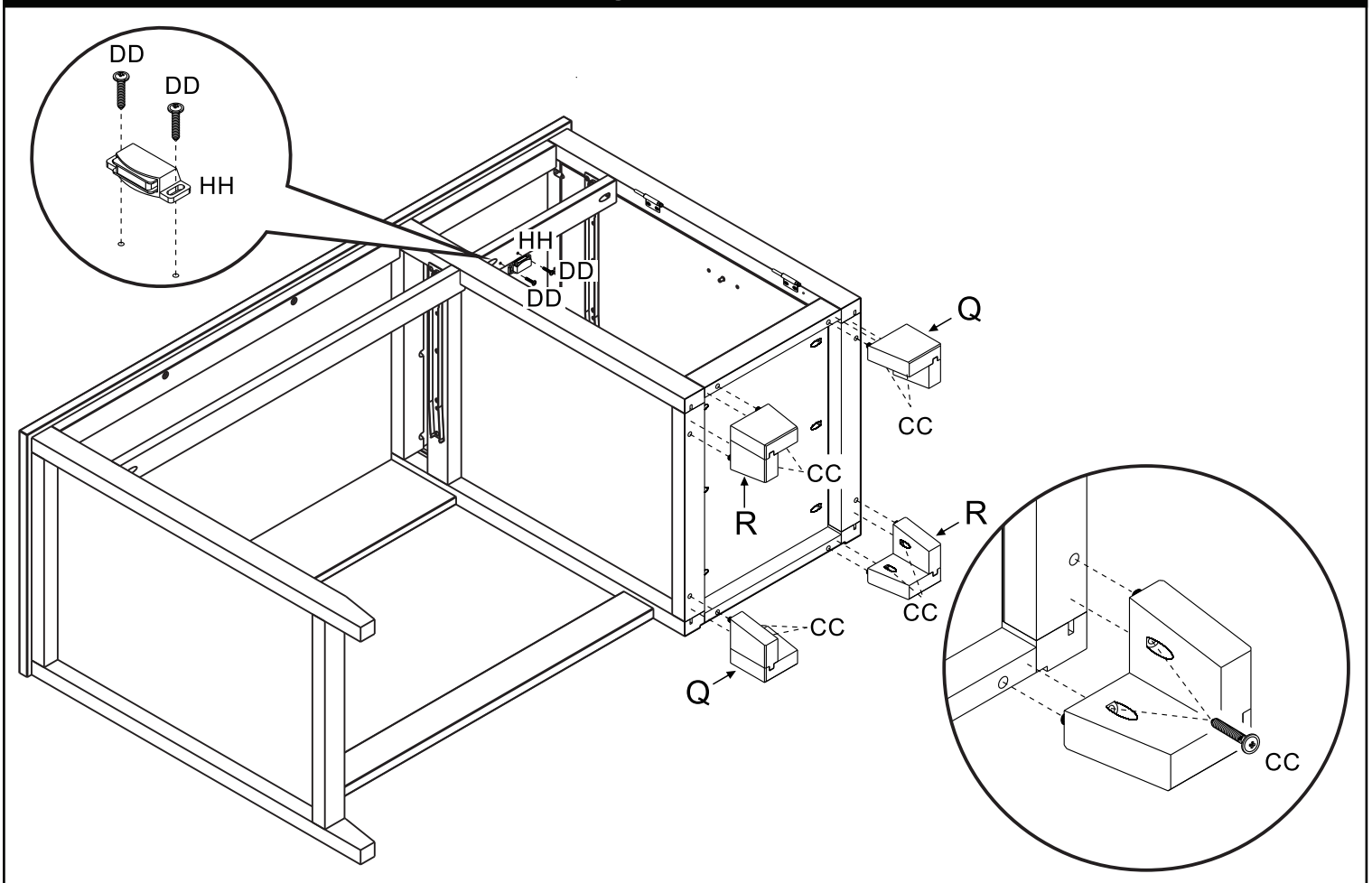

STEP 12

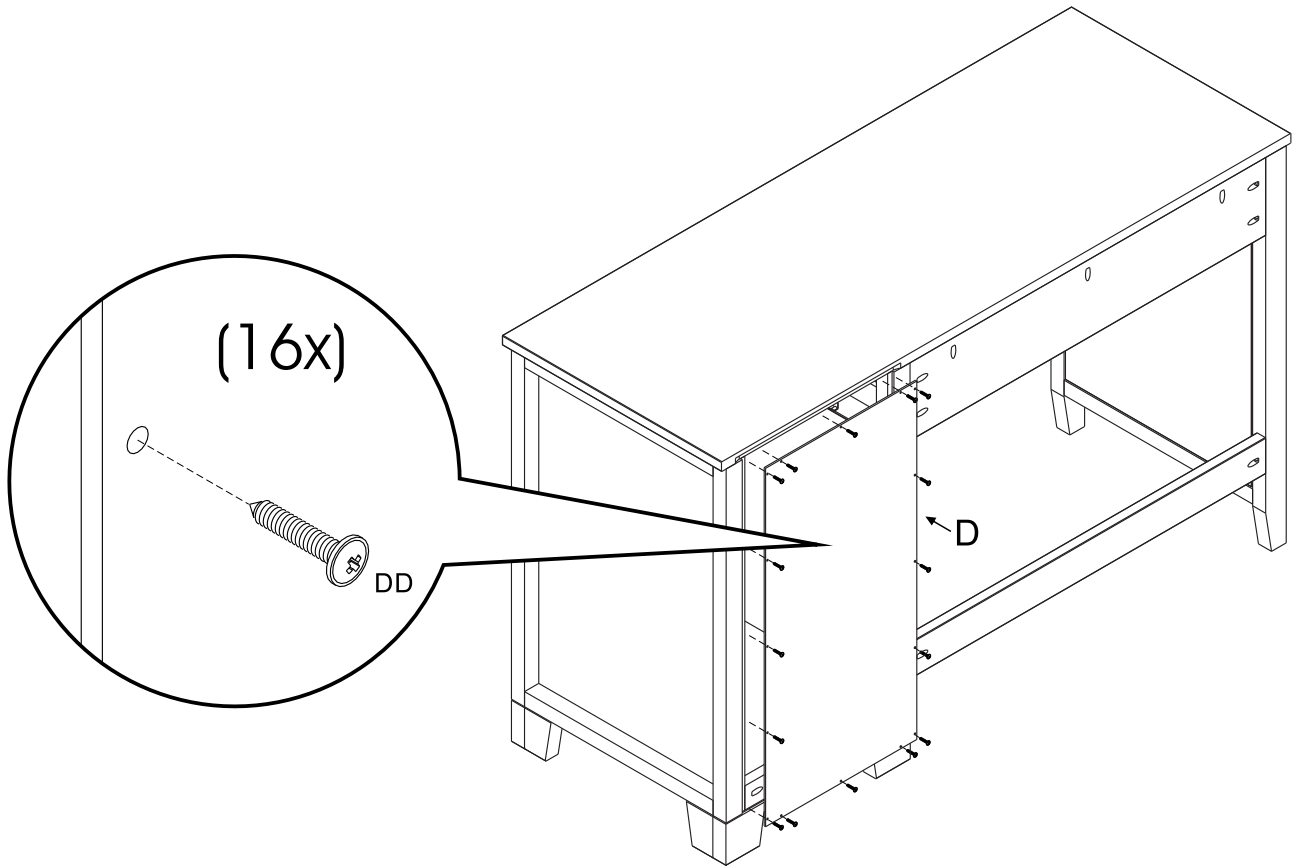

STEP 13

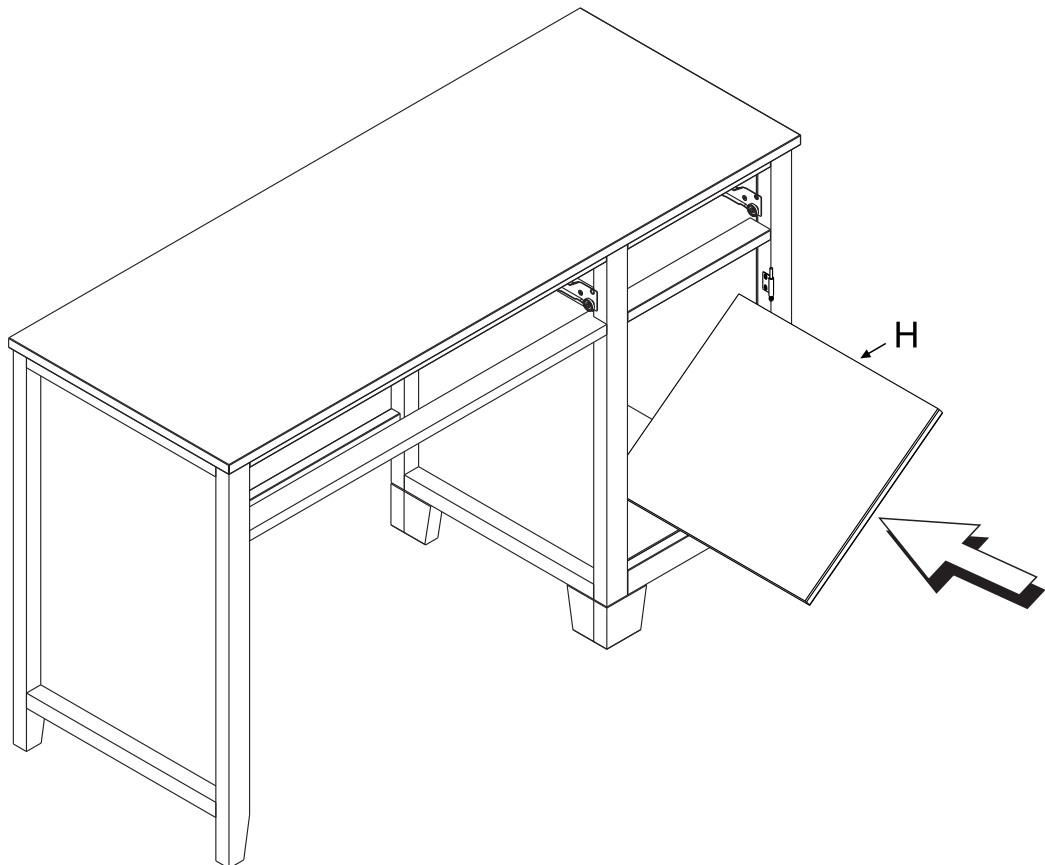

STEP 14

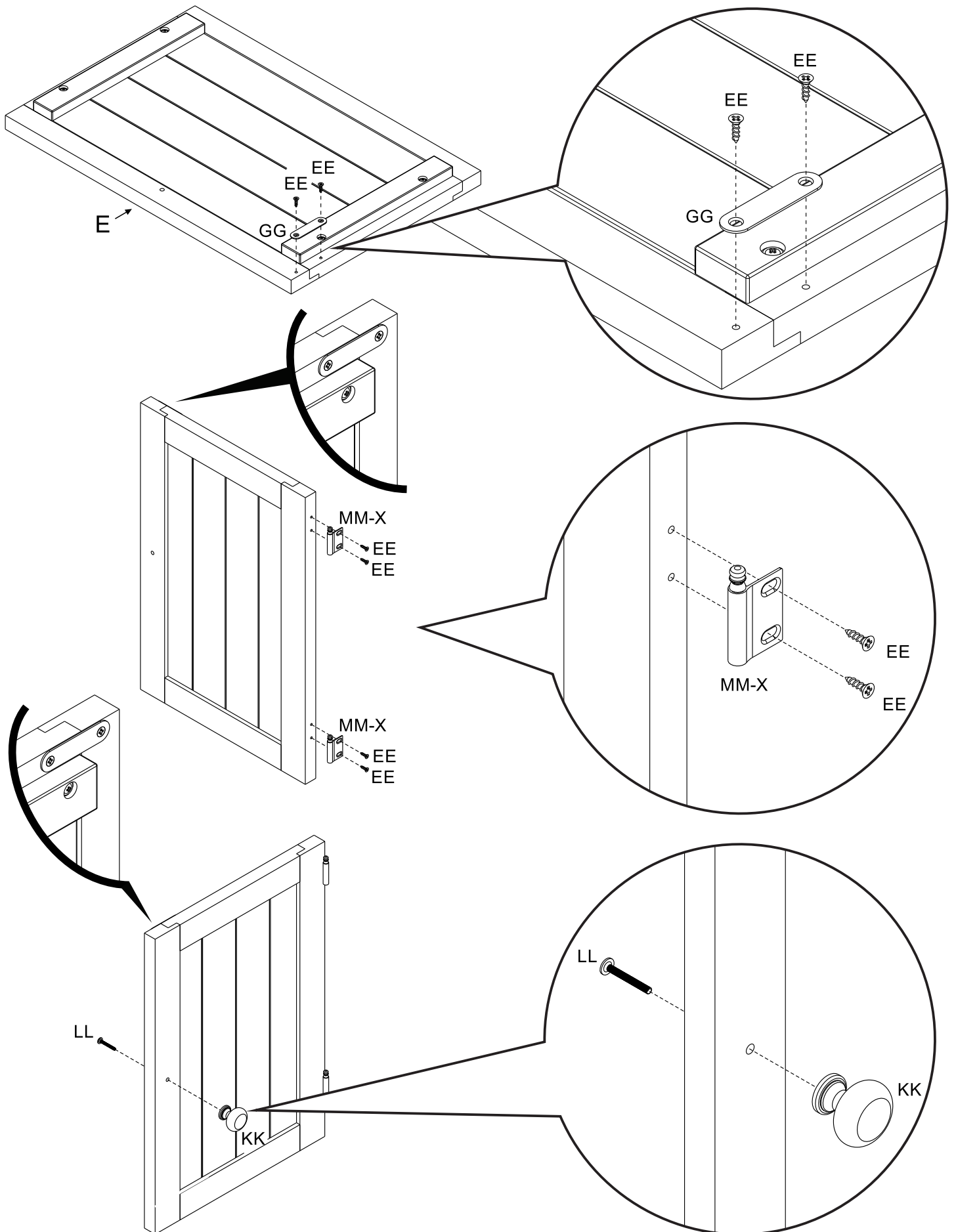

STEP 15

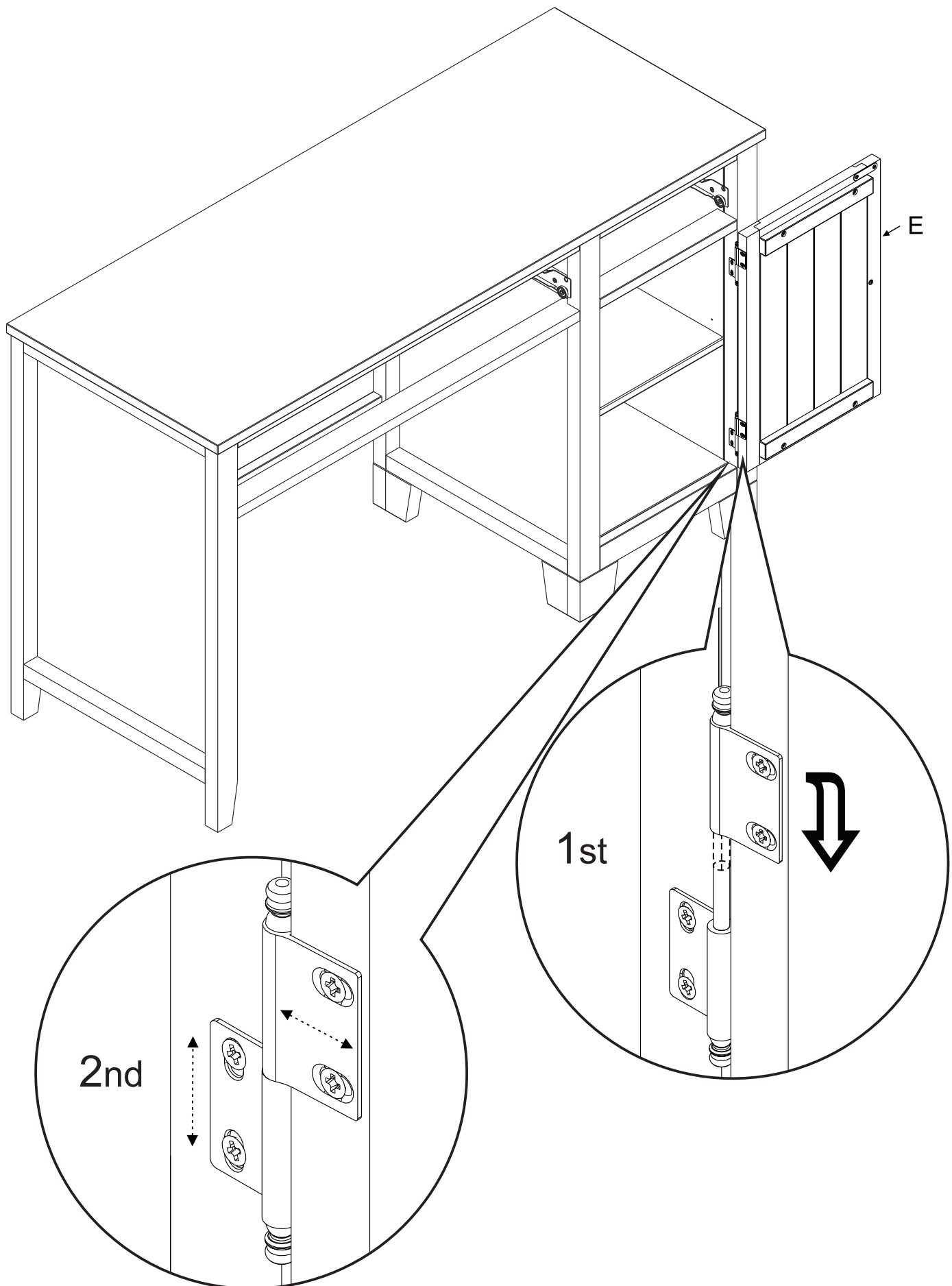

STEP 16

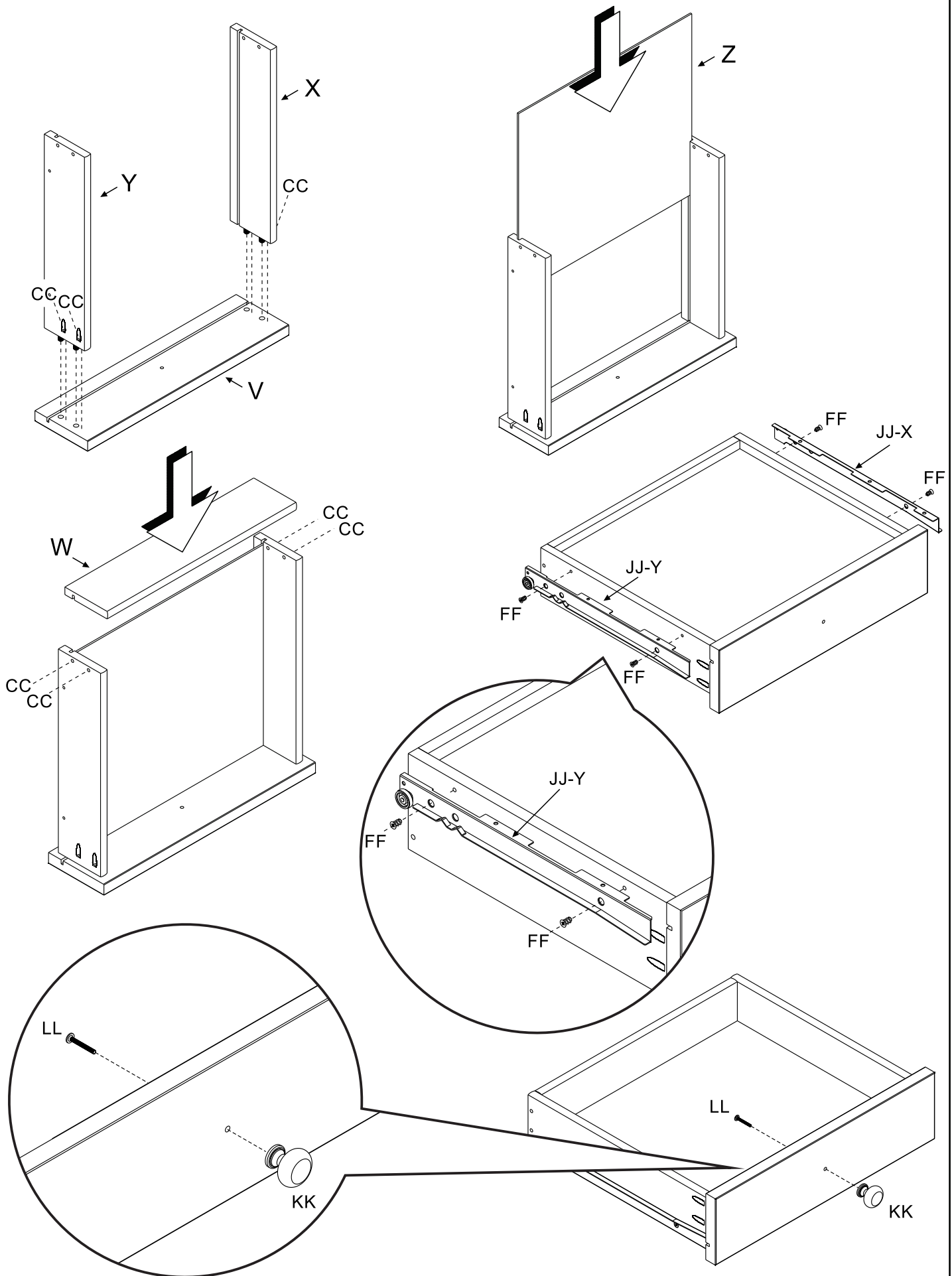

STEP 17

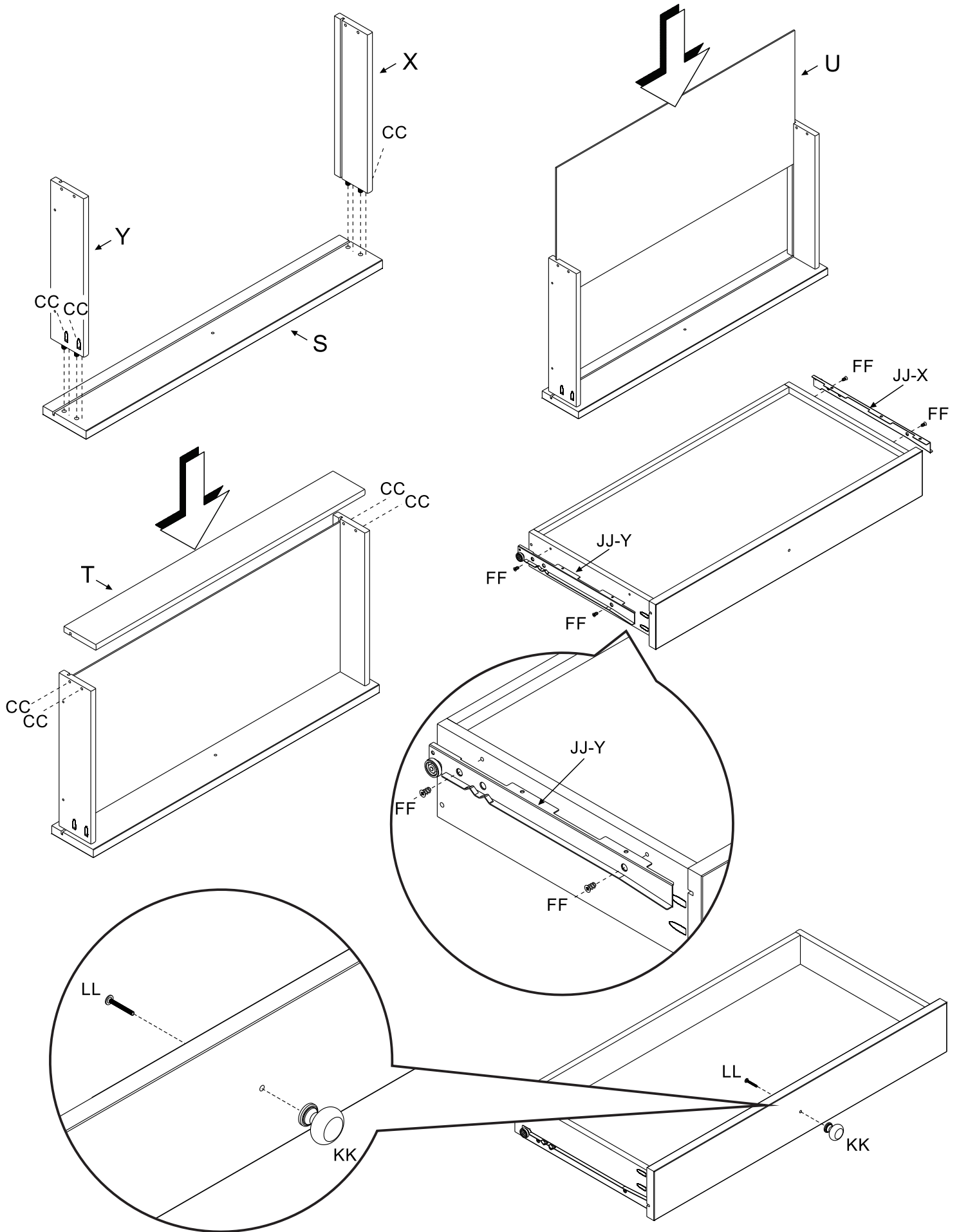

STEP 18

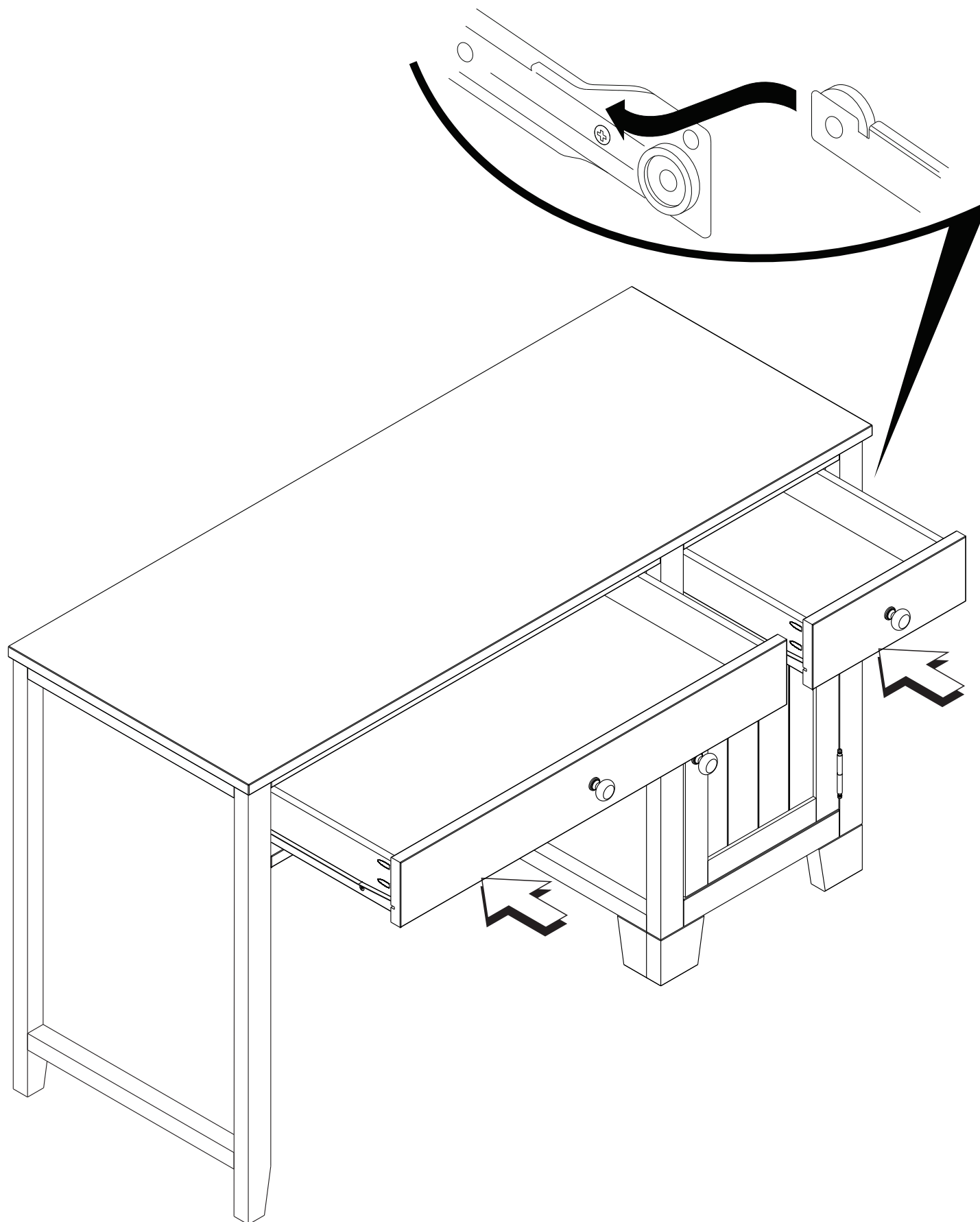

Maintenance Cleaning and Storage

MAINTENANCE:

Upon completion of the assembly, check to make sure all screws, bolts and connectors are tightened and secure.

Periodically check furniture for damaged hardware, loose joints, missing parts or sharp edges before and after assembly and frequently during use.

DO NOT use furniture if any parts are missing or broken.

If any parts are missing, broken or you need assistance DO NOT return furniture to your dealer.

Call Child Craft at 330.723.0599 and include model identification numbers recorded on page 1.

DO NOT substitute parts.

CLEANING:

Mix a mild solution of gentle dishwashing soap and water, apply to surface using a clean cloth lightly dampened in the solution. Rinse well with clear water using a soft clean cloth, then dry all surfaces with a soft dry cloth.

DO NOT use abrasive cleaners or any cleaners with harsh chemicals that would contact a child's skin, scouring pads, steel wool or coarse rags. This furniture should be treated the same as any fine furniture.

STORAGE:

When storing furniture use caution as extreme temperature or humidity changes could be harmful.

Use caution when a vaporizer is in use. Always aim vapor stream away from furniture as well as away from any wood furniture item.

After completing the assembly the user is advised to read and be aware of

ALL WARNINGS, CAUTIONS, CLEANING, STORAGE USE AND MAINTENANCE. Please store the complete set of assembly directions for future referral.