Instruction



NATURE INTERNATIONAL TRADING INC.
597 BEAVER CREEK CT, BRIGHTON, CO
80601.

Email Add: tfsservices@163.com

USER'S MANUAL

**kids table and chair set
ETC005**

KEEP INSTRUCTIONS FOR FUTURE USE

Read all instructions before assembling and using the product.

Never use this product if any parts are missing, damaged, or broken. Contact seller for replacement parts and instructional literature if needed. Never substitute parts.

Before You Start

Please read all instructions carefully and keep it for future reference.

General Security Warning

Caution: The Product is not suitable for the children under 3 years

Danger: Keep all small parts and packaging materials for this product away from babies and children, otherwise they may pose a choking hazard.

Danger: Lack of attachment may cause a risk of tipping.



WARNING:



CHOKING HAZARD -Small parts.

Not for children under 3 years.



WARNING:

Adult assembly required!

In unassembled state contain potentially hazardous small parts and sharp points,so please keep out of baby's reach.

Remove all Packaging, separate and count all parts and hardware.

Read through each step carefully and follow the proper order.

We recommend that, where possible, all items are assembled near to the area in which they will be placed in use, to avoid moving the product unnecessarily once assembled.

Ensure a secure surface during construction, and place the product always on a flat. steady and stable surface

IMPORTANT INFORMATION:

1. Before installing, please refer to the manual to check each part.
2. If you experience any issue during the installation, please reach out to our service team for assistance: tfservices@163.com

DIAGRAM OF SLIDE FITTINGS

① X1



② X4



③ X8



④ X 56



⑤ X4



⑥ X4



⑦ X4



⑧ X2



⑨ X2



⑩ X8



IMPORTANT INFORMATION:

1. Before installing, please refer to the manual to check each part.
2. If you experience any issue during the installation, please reach out to our service team for assistance: tfservices@163.com

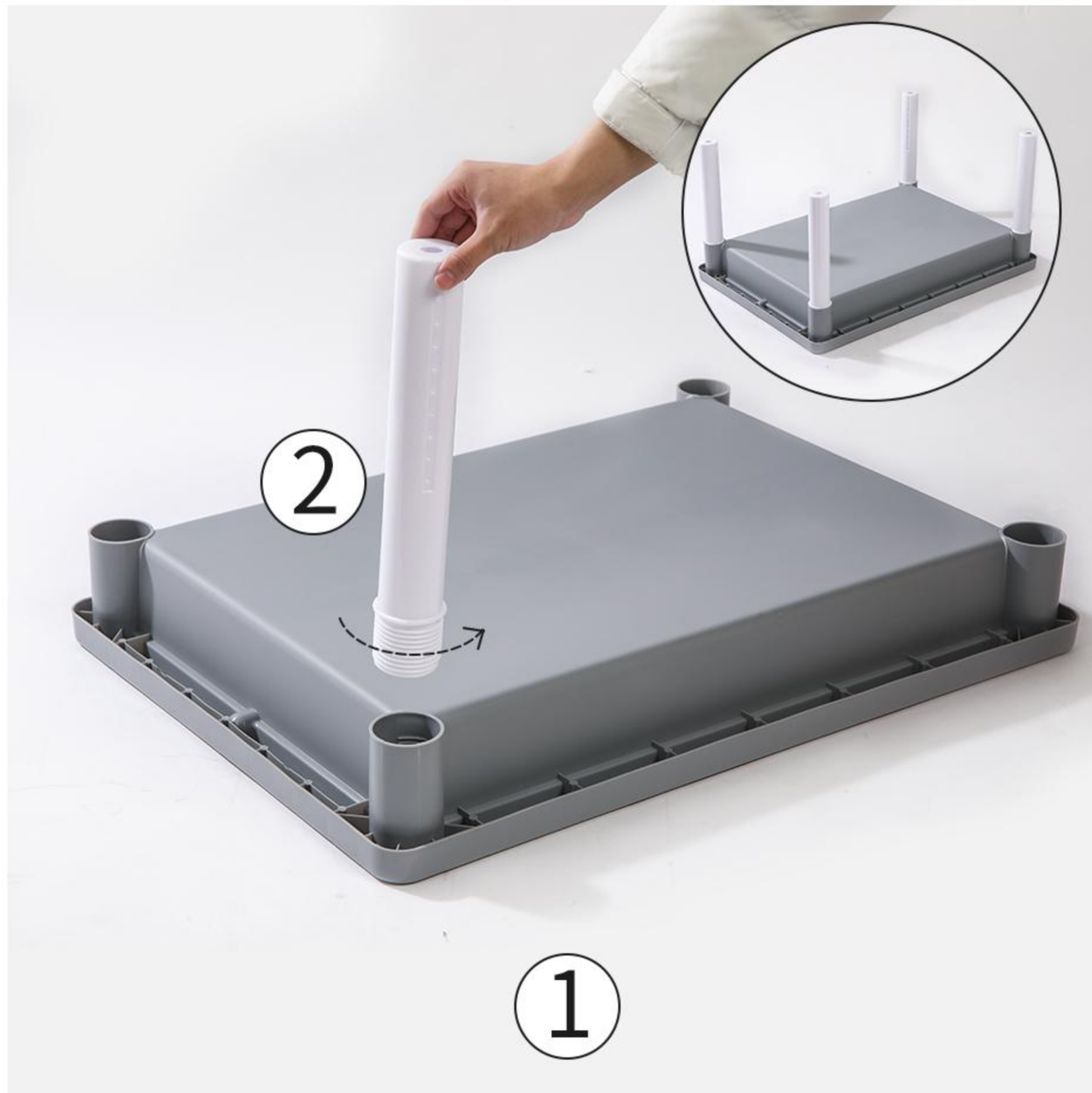

1 Install the white legs on the table top..

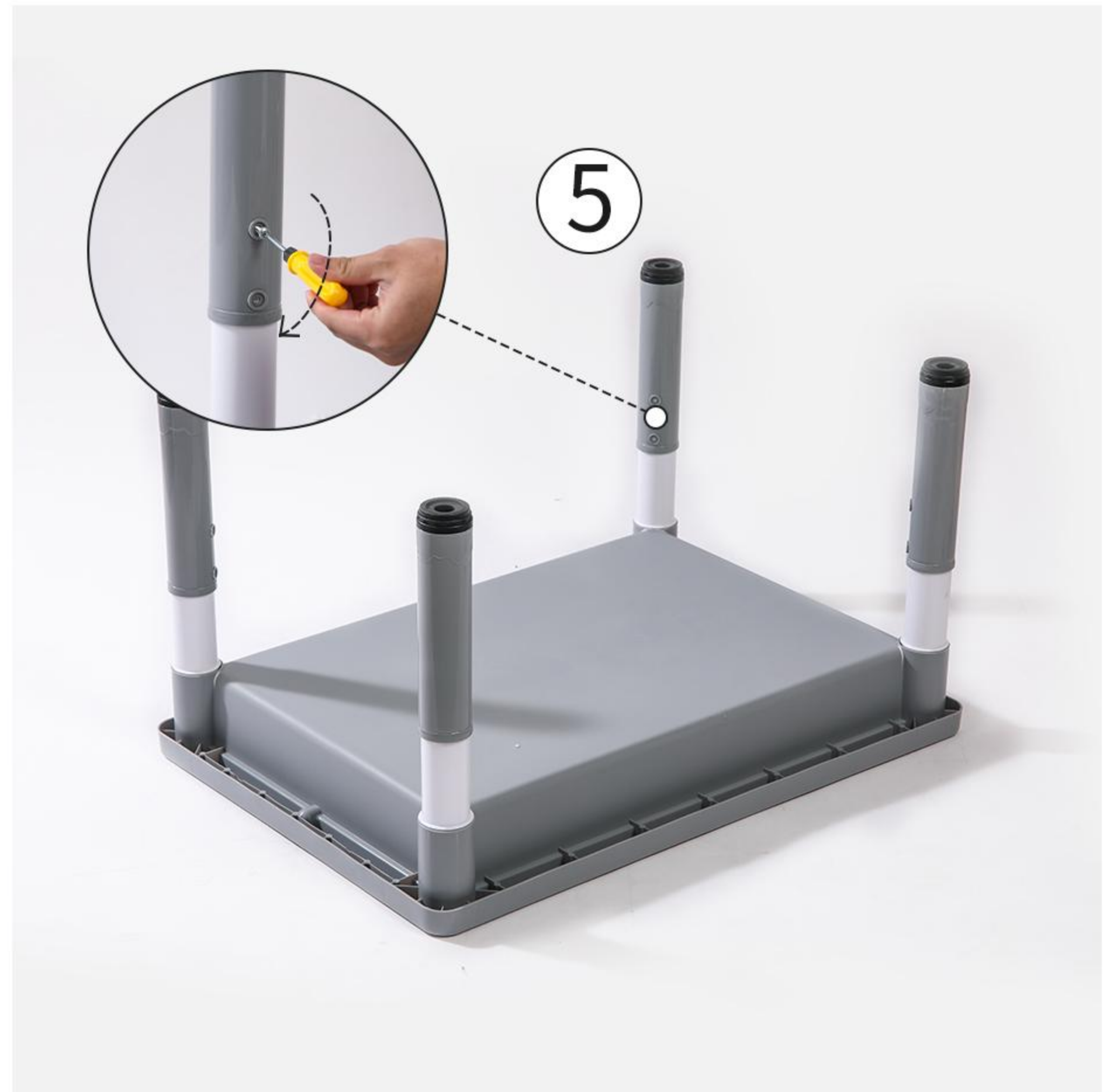

2 Install table legs at appropriate height.



3 Install desktop.



4 Complete table installation.

IMPORTANT INFORMATION:

1. Before installing, please refer to the manual to check each part.
2. If you experience any issue during the installation, please reach out to our service team for assistance: tfservices@163.com



5 Find the right height to hold the legs.



6 Install the cross bar (note the arrows).



7 Install the other leg frame.



8 Install chair seat plate.

IMPORTANT INFORMATION:

1. Before installing, please refer to the manual to check each part.
2. If you experience any issue during the installation, please reach out to our service team for assistance: tfservices@163.com



9 Secure the seat plate.



10 Mounting back.



11 Install the anti-slip rubber sleeve.



12 Completed.



AFTER-SALE SUPPORT

If you have any questions, please contact us via email (tfservices@163.com). We will be happy to serve you and guarantee a 100% satisfactory treatment plan.

 tfservices@163.com