



ZAER LTD. INTERNATIONAL

ASSEMBLY INSTRUCTIONS



ITEM NO.: ZR200777 12.5 ft. Long LG Iron Christmas Train with Cart and Lanterns "The North Pole Express"

Please read instructions thoroughly before assembling this product. Familiarize yourself with inventory of parts and the accompanying illustrations to ensure safe and proper assembly.

PARTS LIST

Part	Picture	Qty	Description	Part	Picture	Qty	Description
A1		1	BOTTOM 1	K2		2	SUPPORT FOR FOOT STEP
B2		1	BOTTOM 2	L3		10	WHEEL COVER
C3		1	BOTTOM 3	M4		2	SHORT CONNECTING ROD
D4		1	BOTTOM 4	N5		2	LONG CONNECTING ROD
E5		1	BOTTOM 5	O6		2	CYLINDER
F6		2	AXLE 1	P7		1	CART WALL (LEFT)
G7		3	AXLE 2	Q8		1	CART WALL (RIGHT)
H8		6	SMALL WHEEL	R9		1	CART WALL (FRONT)
I9		4	THE BIG WHEEL	S1		1	CART WALL (BACK)
J1		2	FOOT STEP	T2		1	CARRIAGE TOP



ZAER LTD. INTERNATIONAL

ASSEMBLY INSTRUCTIONS



ITEM NO.: ZR200777

Please read instructions thoroughly before assembling this product. Familiarize yourself with inventory of parts and the accompanying illustrations to ensure safe and proper assembly.

PARTS LIST

Part	Picture	Qty	Description	Part	Picture	Qty	Description
U3		1	CARRIAGE SIDE WALL	E4		1	BOILER PART 2
V4		1	CARRIAGE SIDE WALL	F5		2	PIPE
W5		4	WINDOW COVER	G6		4	LANTERN
X6		1	BACK SIDE OF THE CARRIAGE	H7		2	SUPPORT FOR BOILER
Y7		1	FRONT SIDE OF THE CARRIAGE	I8		14	NUT Φ8mm
Z8		1	CHIMNEY WITH LIGHT	J9		11	NUT Φ6mm
A9		1	CHIMNEY 1	K1		12	NUT Φ8mm
B1		1	BELL	L2		6	NUT Φ6mm
C2		1	CHIMNEY 2	M3		48	NUT Φ5mm
D3		1	BOILER PART 1	N4		6	SCREW Φ8mmX75mm
				O5		5	SCREW Φ8mmX50mm
				P6		14	SCREW Φ8mmX20mm
				Q7		11	SCREW Φ6mmX15mm
				R8		8	SPACER Φ20mm



ZAER LTD. INTERNATIONAL

ASSEMBLY INSTRUCTIONS



ITEM NO.: ZR200777

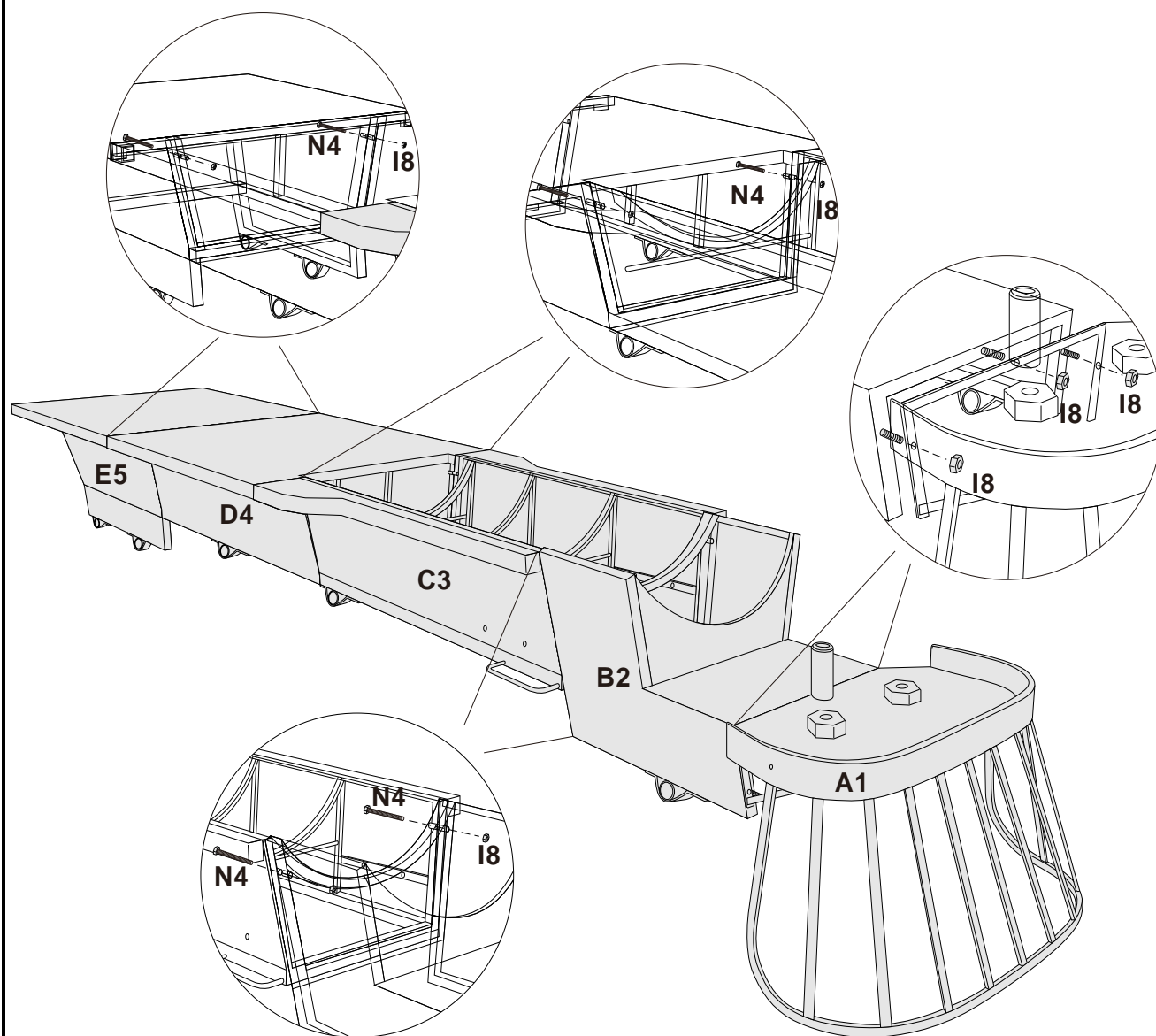

STEP 1: Locate and connect the Bottom Parts (A1/B2/C3/D4/E5) with corresponding Nuts (I8) and Screws (N4).



ZAER LTD. INTERNATIONAL

ASSEMBLY INSTRUCTIONS



ITEM NO.: ZR200777

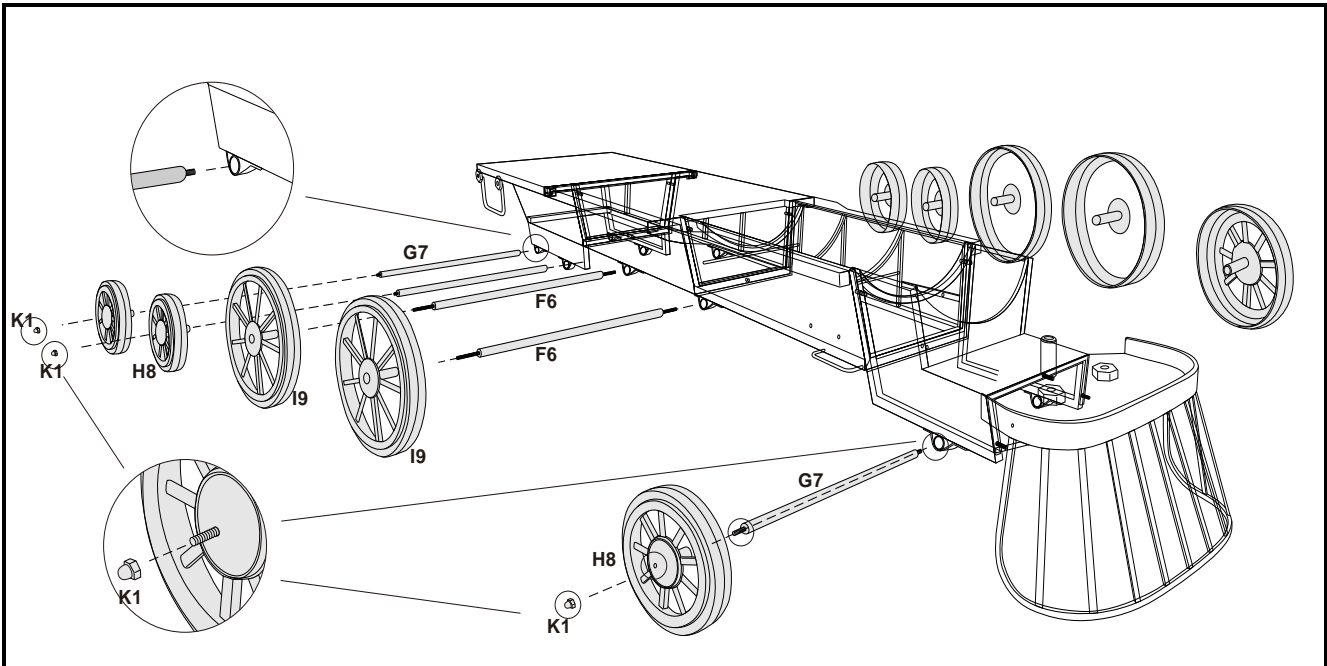

STEP 2: Insert Axles (F6/G7) to the Bottom Part created in previous step. Locate the six (6) Small Wheels (H8) and lock them to Axles (F6/G7) with corresponding Nuts (K1).

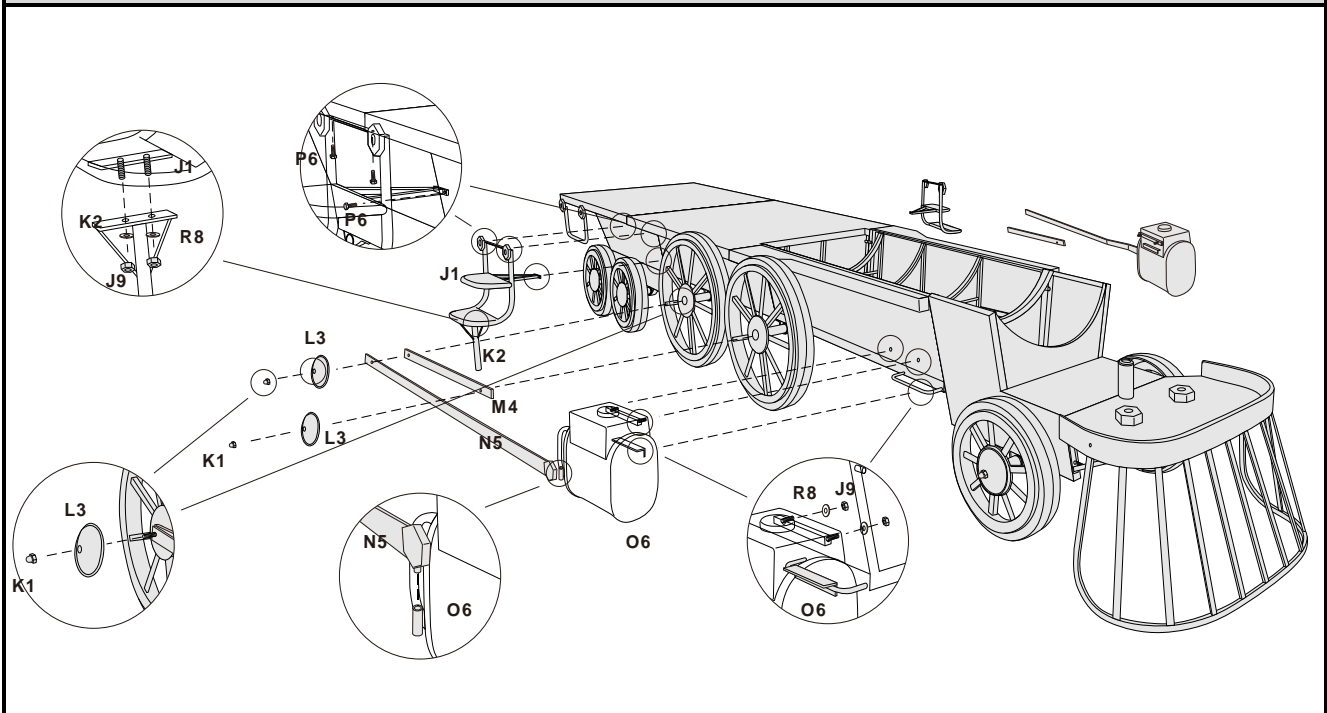

STEP 3: Lock Support for Foot Step (K2) to Foot Step (J1) with Nuts (J9) and Spacer (R8). Attach the assembled Foot Step (K2/J1/J9/R8) to the Bottom assembled in previous step with Screw (P6). Then attach and secure the Cylinder (O6) and Short & Long Connecting Rods (M4/N5) to the front of the Large Wheels (I9) and lock the Large Wheels (I9) to Wheel Cover (L3) with Nuts (K1).



ZAER LTD. INTERNATIONAL ASSEMBLY INSTRUCTIONS



ITEM NO.: ZR200777

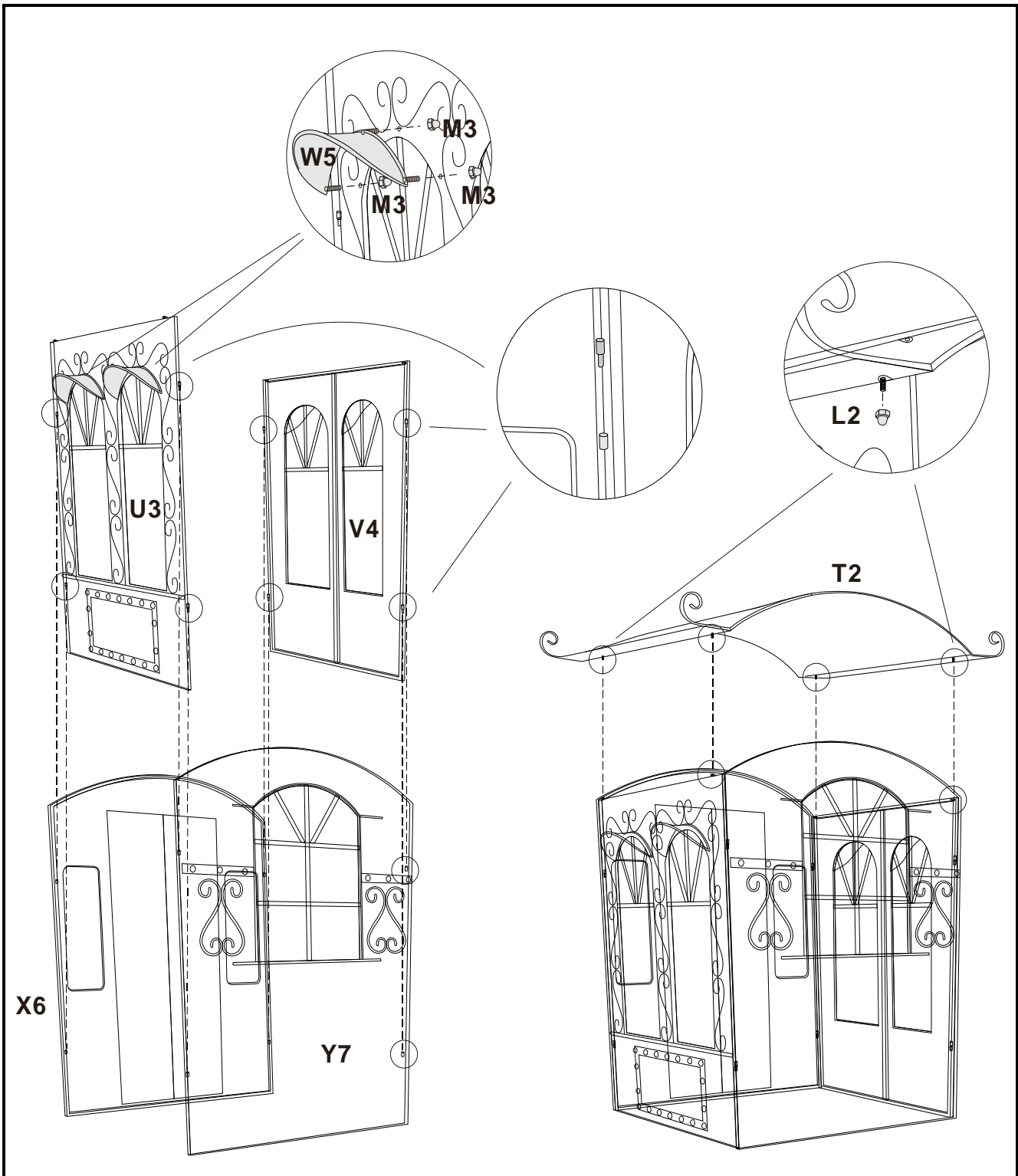

STEP 4: Locate and assemble the Carriage Side Walls (U3/V4/X6/Y7) and secure the Carriage Top (T2) to the assembled Side Walls (U3/V4/X6/Y7) using Nuts (L2). Then attach and lock the Window Covers (W5) with Nuts (M3).



ZAER LTD. INTERNATIONAL

ASSEMBLY INSTRUCTIONS



ITEM NO.: ZR200777

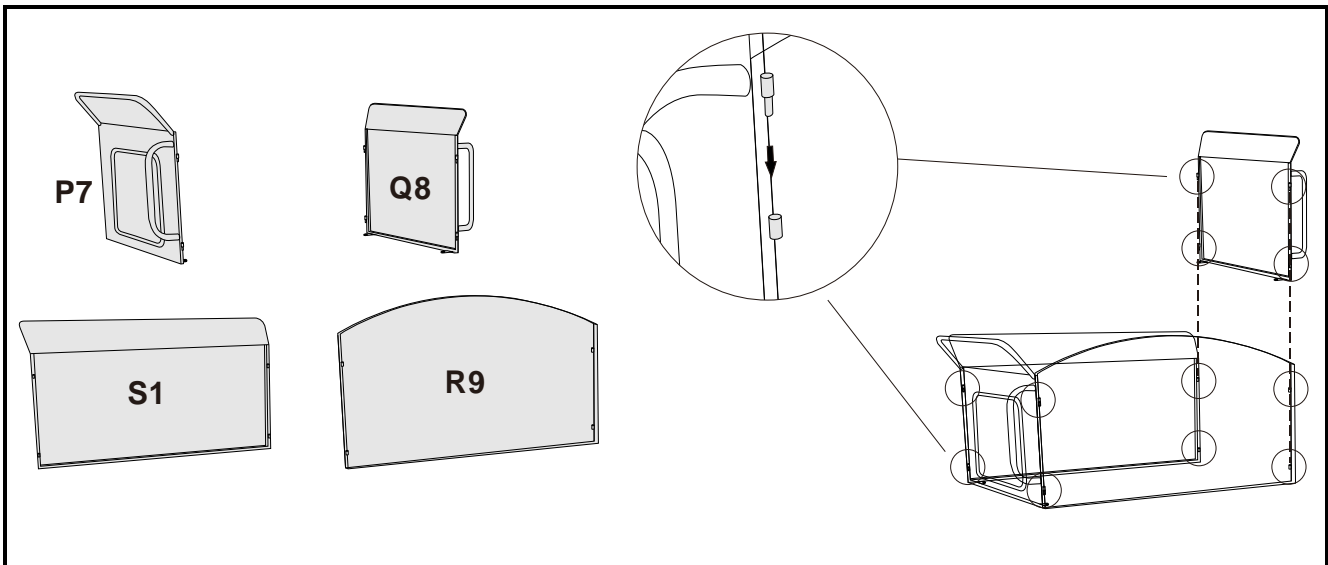

STEP 5: Locate Cart Walls (P7/Q8/R9/S1) and assemble the cart as shown above.

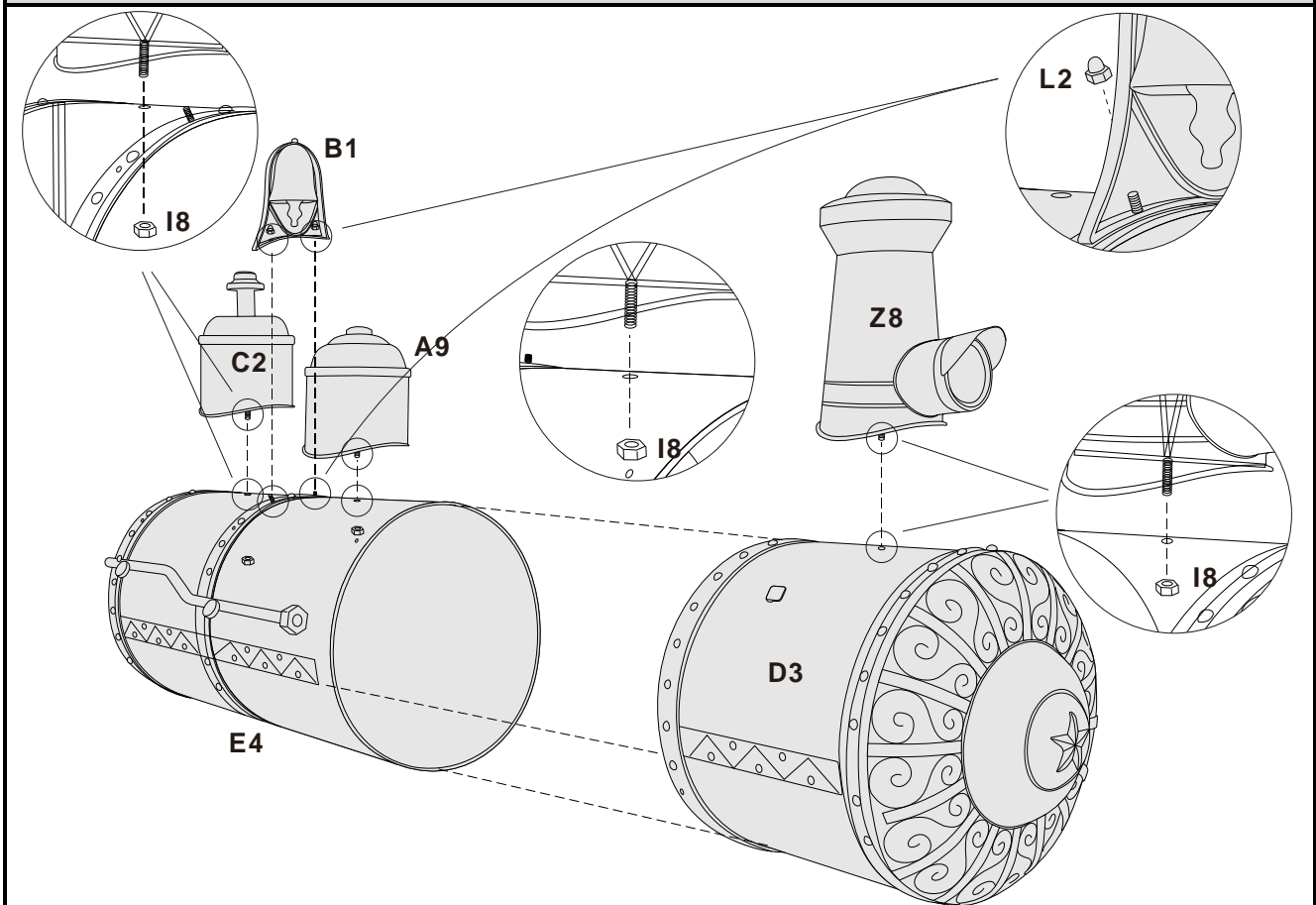

STEP 6: Locate Boiler Parts (A9/B1/C2/Z8) and assemble as shown with Nuts(I9/L2). Combine the Boiler Part 1 (D3) and Boiler Part 2 (E4).



ZAER LTD. INTERNATIONAL

ASSEMBLY INSTRUCTIONS



ITEM NO.: ZR200777

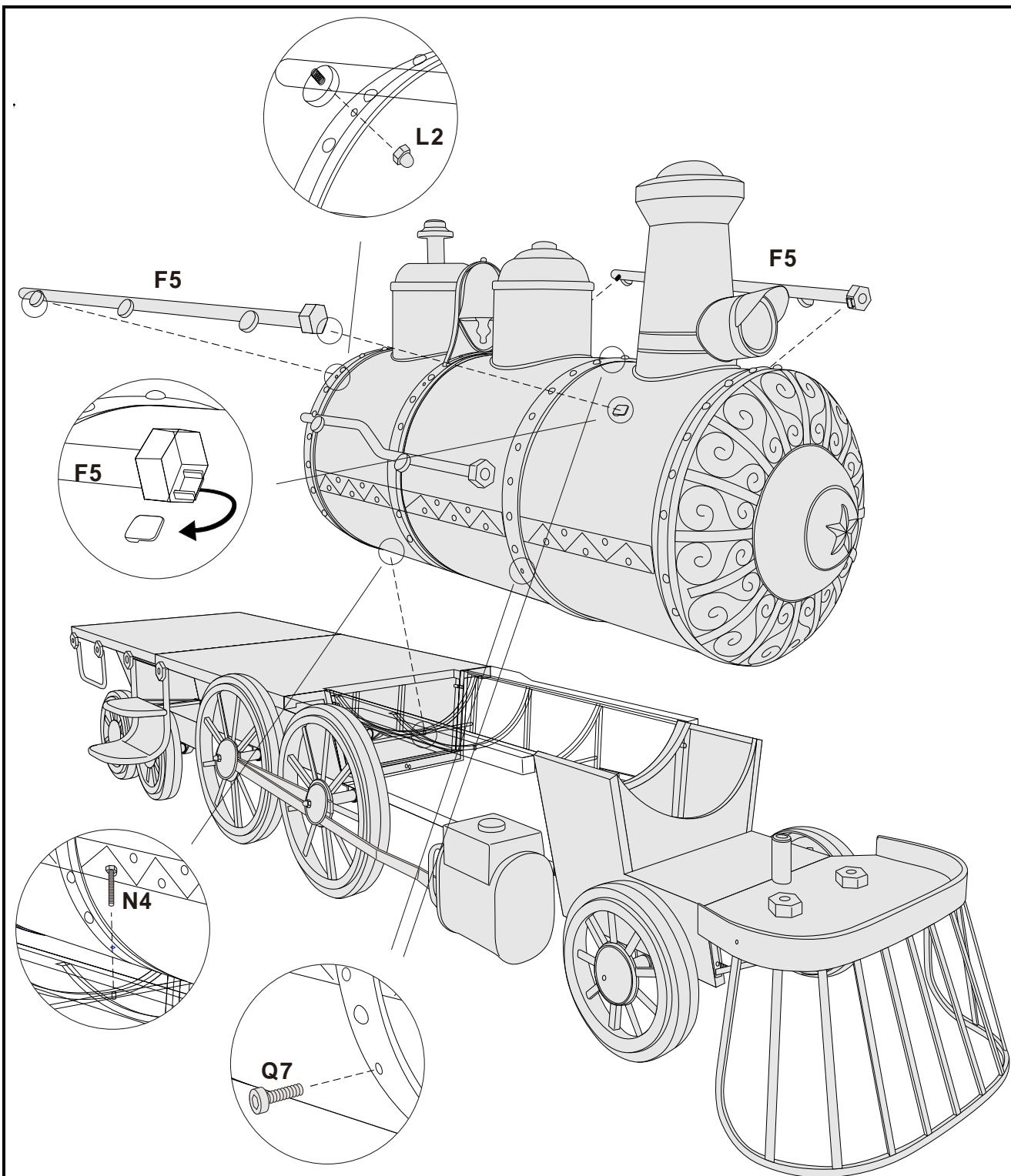

STEP 7: Secure the Boiler Parts (D3/E4) from STEP 6 with Screws (Q7). Locate Pipe (F5) and attach to the Boiler with Nuts (L2). Then attach the assembled Boiler to the Bottom (from STEP 3) with Screws (N4).



ZAER LTD. INTERNATIONAL

ASSEMBLY INSTRUCTIONS



ITEM NO.: ZR200777

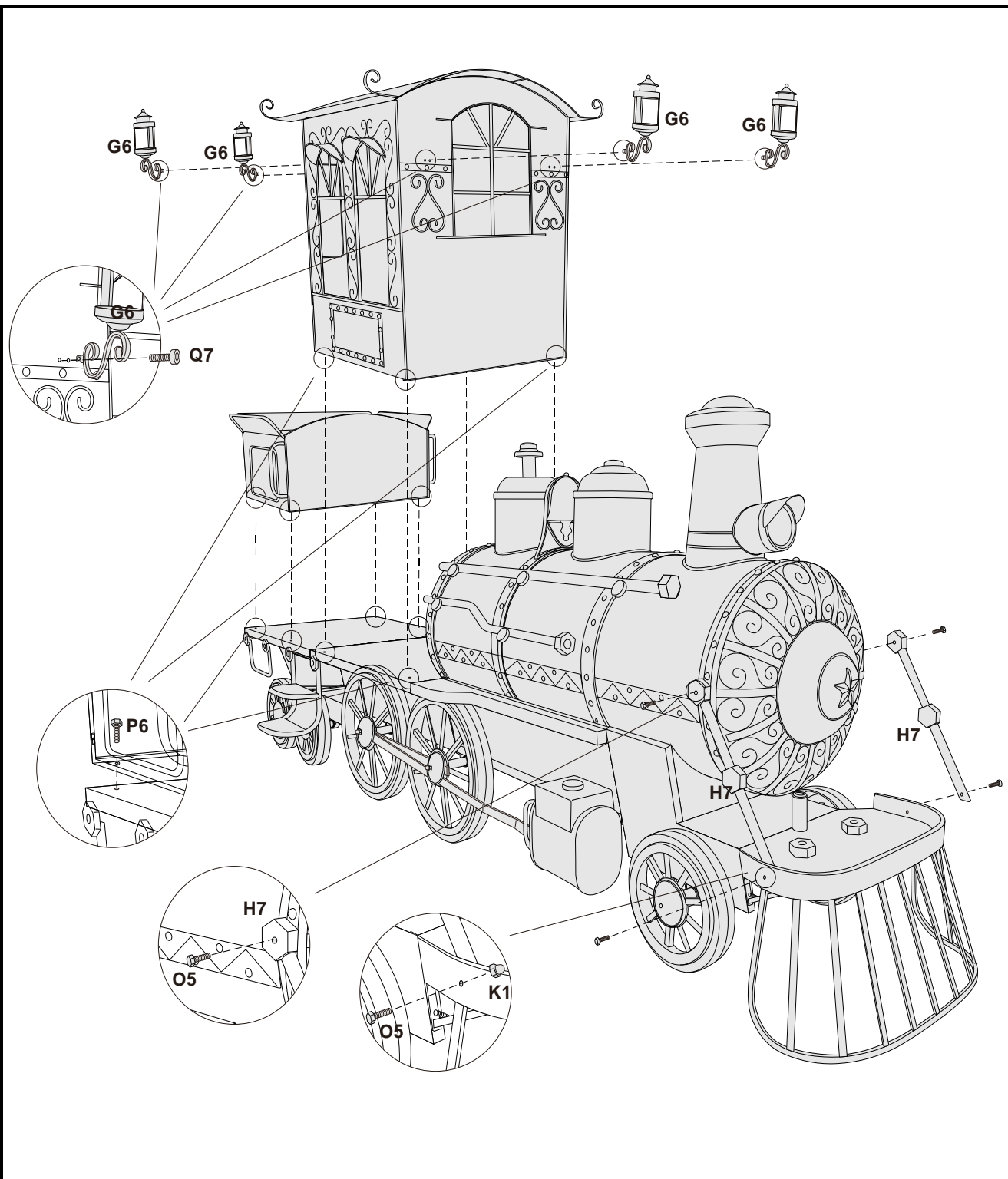

STEP 8: Locate and assemble the Supports (H7) to the front of the Boiler from previous step with Nuts (O5) and Screws (K1). Locate Lanterns (G6) and secure them to the Carriage (from STEP 4) with Nuts(Q7). Attach the Cart (STEP 5) and Carriage (STEP 4) to the assembled Bottom Part (STEP 3) with Nuts (P6).



ZAER LTD. INTERNATIONAL ASSEMBLY INSTRUCTIONS



ITEM NO.: ZR200777

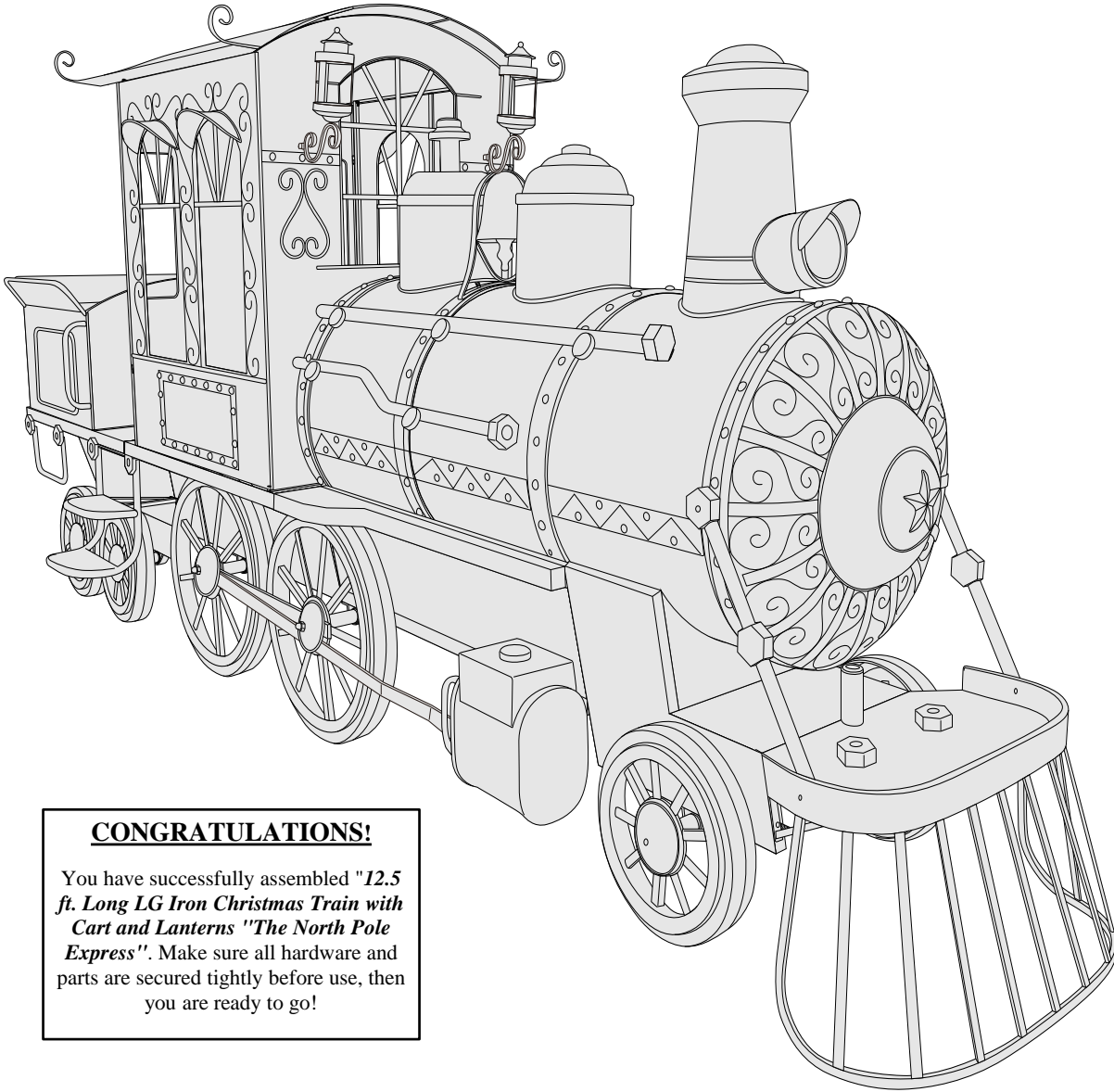

CONGRATULATIONS!

You have successfully assembled "12.5 ft. Long LG Iron Christmas Train with Cart and Lanterns 'The North Pole Express'". Make sure all hardware and parts are secured tightly before use, then you are ready to go!

IMPORTANT: Check all hardware for tightness before and during use!

This assembly requires FOUR (4) people and will take approximately THIRTY (30) minutes to complete.

Use and Care:

Safe for both indoor and outdoor use; year round. Clean with damp/dry cloth; use clear protective overspray (ex. Rustoleum) for added protection against potential fading and/or weatherization.

Zaer Ltd. International Warranty

Zaer Ltd. products have a 30 day warranty that begins once product is delivered. Questions/Comments: Call 215-766-2010 or email sales@zaerltd.com.

Visit www.ZaerLTD.com to shop our entire selection of wholesale home & garden decor!



**Not a retailer/wholesale buyer?*

Head over to www.Lesera.com for Zaer Ltd. products available direct to consumer!

Follow both Zaer Ltd. (Wholesale) and Lesera (Retail) on Social Media:

Zaer Ltd. Facebook/Instagram: @zaerltdinternational

Lesera Facebook/Instagram: @leserahg

