

IMPORTANT SAFEGUARDS

- Always plug the Power Cord directly into the wall outlet. **NEVER USE** this Unit with an extension cord of any kind. A short power-supply cord (or detachable power-supply cord) is provided to reduce the risk of becoming entangled in or tripping over a longer cord.
- Anyone who has not fully read and understood all operating and safety instructions contained in this manual is **NOT QUALIFIED TO OPERATE** or clean this appliance.
- If this Unit falls or accidentally becomes immersed in water, unplug it from the wall outlet immediately. **DO NOT REACH** into the water!
- DO NOT OPERATE** this appliance on an unstable surface.
- If this appliance begins to malfunction during use, immediately unplug the Cord. **DO NOT USE** or attempt to repair a malfunctioning appliance!
- If the appliance has a **POLARIZED PLUG** (one blade is wider than the other): This plug is intended to fit into a polarized outlet only one way. If the plug does not fit into the outlet, reverse the plug. If it still does not fit, contact an electrician. **DO NOT** attempt to modify the plug.

WARNING: Cancer and Reproductive Harm - www.P65Warnings.ca.gov

Caution

Hot surfaces: This appliance generates heat and escaping steam during use. Proper precautions must be taken to prevent the risk of personal injury, fires, and damage to property.

Electric Power

If the electrical circuit is overloaded with other appliances, your appliance may not operate properly. It should be operated on a dedicated electrical circuit.

SAVE THESE INSTRUCTIONS – FOR HOUSEHOLD USE ONLY

Important Notes

- DO NOT** keep small amounts of rice warm in the cooker for extended periods.
- If you have steamed other ingredients with the rice, the time stored at "WARM" should be kept to a minimum to avoid unpleasant aromas.
- When cooking a large quantity of rice, take extra care to add the correct quantity of water to avoid boiling over.

Care and Cleaning

BEFORE USING THE RICE COOKER FOR THE FIRST TIME, wash the inner bowl and lid with warm, soapy water. Rinse and dry thoroughly.

AFTER EACH USE:

- Unplug from power point before commencing cleaning.
- NEVER** place the body of the cooker in water or other liquid.
- The body should be cleaned by wiping the inside and outside surfaces with a damp soapy cloth and drying thoroughly.

- If water should accidentally enter the switch mechanism, power cord inlet socket, or spill onto the heating plate, allow to dry thoroughly before using the cooker again.
- The inner bowl lid may be washed in warm soapy water. Do not use abrasive cleaners or metal scouring pads. Scratching or denting the surface of the pan could result in poor contact with the heating plate.

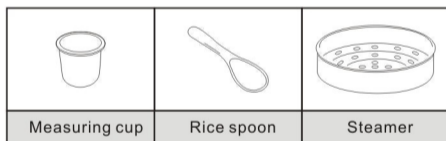

- Handle
- Vent hole
- Glass cover
- Cover button
- Outer shell
- "COOK" indicator
- "WARM" indicator
- Control button

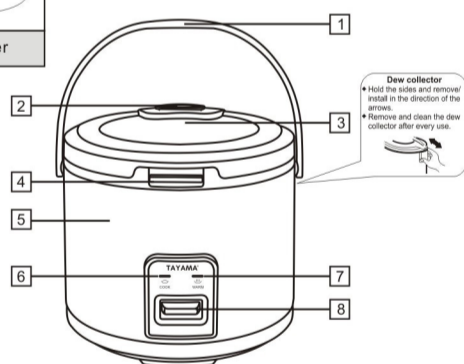

IMPORTANT SAFEGUARDS

When using electrical appliances, basic safety precautions should always be followed, including:

- Read and follow all instructions carefully.
- This appliance **IS NOT INTENDED** for use by persons with reduced physical, sensory, or mental capabilities or lack of experience and knowledge unless they are under the supervision of a responsible person or have been given proper instruction in using the appliance. This appliance is not intended for use by children.
- DO NOT TOUCH** hot surfaces. Use pot holders or oven mitts.
- To protect against electric shock, **DO NOT IMMERSE** or rinse cords or plugs in water or other liquids.
- UNPLUG FROM OUTLET** when not in use and before cleaning. **ALLOW TO COOL** before handling components.
- DO NOT OPERATE** any appliance with a damaged cord or plug or after the appliance malfunctions or has been damaged in any manner. If damage occurs, contact customer service.
- DO NOT USE** any attachments or utensils that were not recommended or supplied by the manufacturer. The use of attachments not recommended for use by the manufacturer may cause serious hazardous situations, including personal injury.
- DO NOT USE** outdoors.
- DO NOT LET** Power Cord hang over edge of table or counter or touch hot surfaces.
- DO NOT PLACE** on or near a hot gas or electric burner or in a heated oven.
- EXTREME CAUTION** must be used when moving an appliance containing hot contents.
- DO NOT USE** appliance for anything other than its intended use.
- This appliance cooks using extreme heat. Improper use **MAY RESULT IN** scalding injury.
- This appliance has been designed for use with a 120V electrical outlet only. **DO NOT USE** any other electrical outlet.
- The Unit generates high heat and steam during operation. All necessary precautions **MUST BE TAKEN TO AVOID** fire, burns, and other personal injury during operation.
- NEVER OPERATE** the unit near any flammable materials, such as dish towels, paper towels, curtains, or paper plates.

TAYAMA®

Automatic Rice Cooker & Warmer With Glass Lid

TGRC-180



INSTRUCTION MANUAL

Please read all instructions carefully before operating the appliance and keep for future reference.

Tayama Appliance USA Inc.
www.tayama-usa.com
EMAIL:support@tayama-usa.com

What Can The Rice Cooker Do?

Your new Rice Cooker can help you create an endless variety of taste-tempting and nutritious dishes, each one cooked to perfection. Apart from cooking rice just the way you like it - soft and fluffy or firm and tender, the Rice Cooker will steam fish, poultry, meat and vegetables and cook egg dishes, cakes and puddings.

Brown Rice
To cook brown rice in the Rice Cooker you must leave it to soak in cold water for at least an hour to soften. Drain and measure out the number of cups of rice and place in inner pan. Add 375 ml of water for the first cup of rice added and 250 ml for each additional cup of rice. Add 1 tablespoon butter as this will improve the texture of the rice. Follow procedure for cooking white rice. After the cooker switches to "WARM", allow the rice to stand for 20-25 minutes.

How To Use

- Cooking Rice** - using the measuring cup provided, measure out required quantity.
- Remember - one cup (150 grams) of uncooked rice makes about three cups of cooked rice.
- Before cooking, wash the rice thoroughly under cold running water to remove excess starch. Use a colander or fine sieve for this - **DO NOT** use the inner bowl of the cooker as you may scratch or indent it. If this occurs, improve contact with the heating plate may result in unsatisfactory cooking.
- Place the well-washed rice in the Inner bowl of the cooker. Ensure the heating plate is cool before commencing cooking.
- Rice to Water Ratio**-Generally is 1:1. Never exceed the MAX indicated water level. If you use 4 cups of rice, add 4 cups of water. By adding too much water you may cause the unit to boil over. Measuring cup provided.
- Taste and texture will vary depending on the quality of rice and length of time it is cooked. For a softer, fluffier rice add a little more water. For a firmer, crunchier rice add a little less water. For the first few times you may need to experiment to perfect the end result to your needs.
- Before placing the inner pan into the cooker, check that the heating plate and outside of the bowl are clean and dry. This is important to ensure proper contact between heating plate and inner bowl.
- Place the lid into position on the cooker.
- Push power cord into inlet socket on cooker, then plug it into the A.C. power supply. The "WARM" indicator lamp will light up.
- Press the automatic switch button to "START", "COOK" lamp will light up.
- When cooking is completed, the cooker will automatically switch to "WARM"-the "COOK" lamp will turn off and the "WARM" light will light up and will remain in keep warm state.
- Leaving the lid in position, the rice should be left to stand at "WARM" for 10 minutes before serving.
- Loosen the rice with included plastic spatula for fluffier and perfectly cooked rice.
- The "WARM" cycle is designed to continue, until the unit is unplugged. The rice can be kept in the unit on "WARM" for up to 5 hours. Beyond this time will cause loss of flavour, colour and nutrients.
- DO NOT** interfere with the automatic switch mechanism by preventing it from switching to the "WARM" cycle. **DO NOT** immediately press the switch again after it has begun the "WARM" cycle.
- After use, remove the plug from the wall socket and the power cord from the inlet socket of the cooker.
- Always clean the cooker thoroughly as soon as possible after each use.

NOTICE!

