

ASSEMBLY INSTRUCTIONS

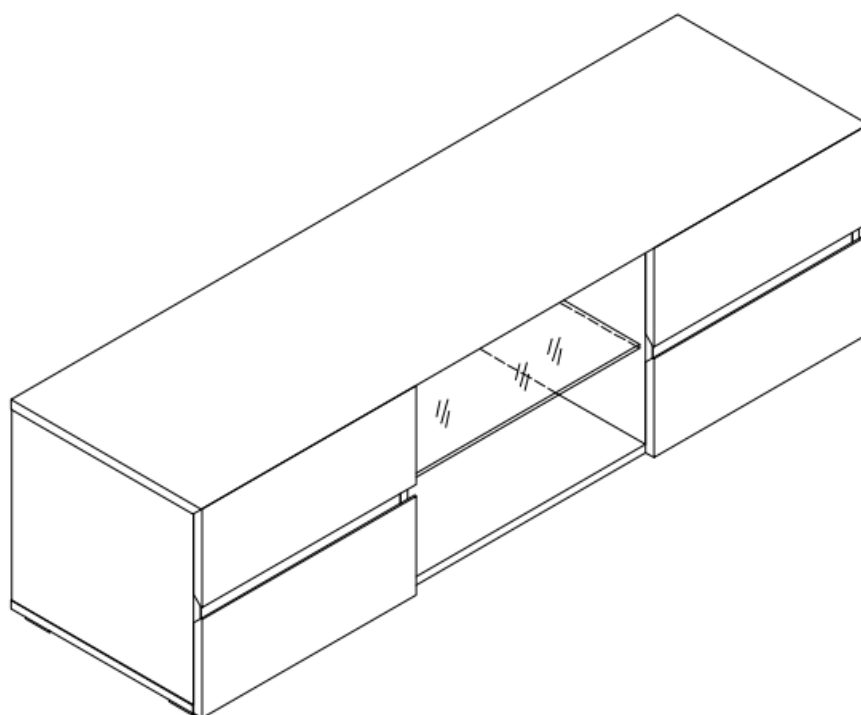

TVCONSOLE

ASSEMBLY INSTRUCTIONS

ASSEMBLY TIPS:

- 1. Remove hardware from box and sort by size.
- 2. Please check to see that all hardware and parts are present prior to start of assembly.
- 3. Please follow attached instructions in the same sequence as numbered to assure fast & easy assembly.



WARNING!

- 1. Don't attempt to repair or modify parts that are broken or defective. Please contact the store immediately.
- 2. This product is for home use only and not intended for commercial establishments.



ASSEMBLY TIME

90 MINUTES

PARTS IDENTIFICATION

A	TOP BOARD	1PC	H	RIGHT MIDDLE BOARD	1PC
B	BASE BOARD	1PC	I	WOOD RUNG	2PCS
C	BACK BOARD	1PC	J	LEG	5PCS
D	GLASS	1PC	K	UP FACE BOARD OF DRAWER	2PCS
E	RIGHT SIDE BOARD	1PC	L	DOWN FACE BOARD OF DRAWER	2PCS
F	LEFT SIDE BOARD	1PC	M	LEFT SIDE BOARD OF DRAWER	4PCS
G	LEFT MIDDLE BOARD	1PC	N	RIGHT SIDE BOARD OF DRAWER	4PCS
			O	BACK BOARD OF DRAWER	4PCS
			P	BASE BOARD OF DRAWER	4PCS

ASSEMBLY INSTRUCTIONS

Z HARDWARE IDENTIFICATION

1 BOLT

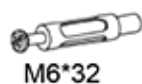

M6*32

36PCS

2 BOLT CAP



36PCS

3 WOOD PLUG



Ø8*30

20PCS

4 SCREW



M4*25

10PCS

5 SCREW



M4*35

16PCS

6 SLIDE RAIL



8PCS

7 SCREW



M3.5*12

48PCS

8 SHELF PIN



4SET

STEP 1

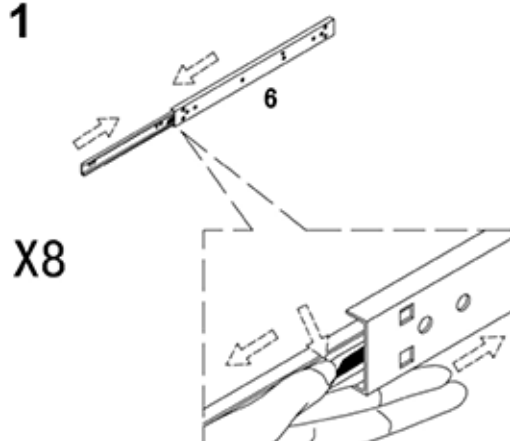

STEP 2

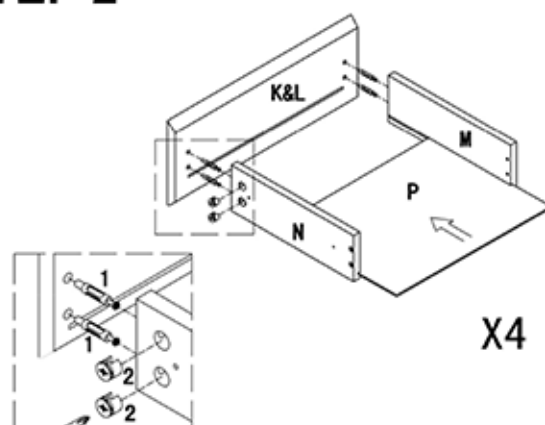

STEP 3

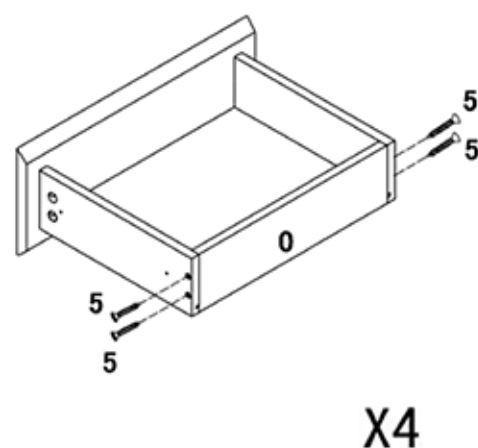

STEP 4

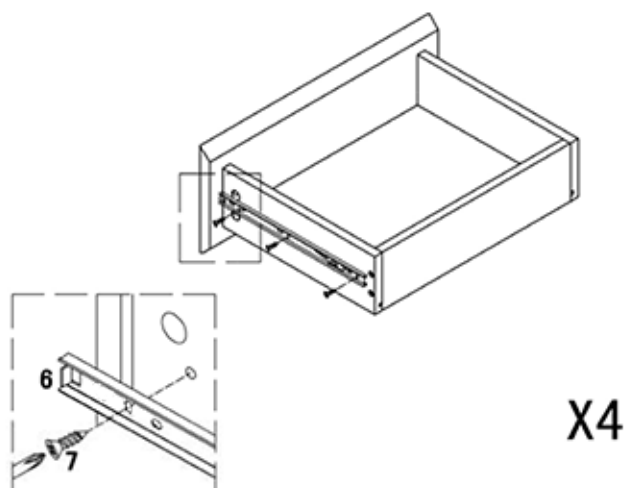

ASSEMBLY INSTRUCTIONS

STEP 5

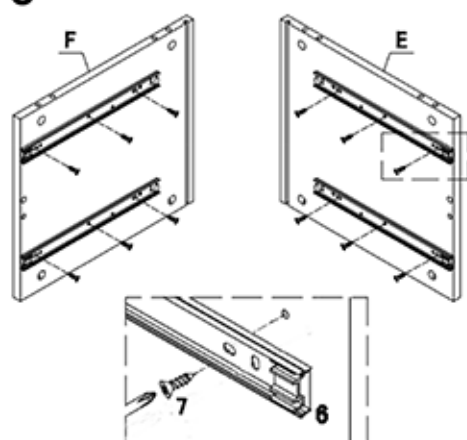

STEP 6

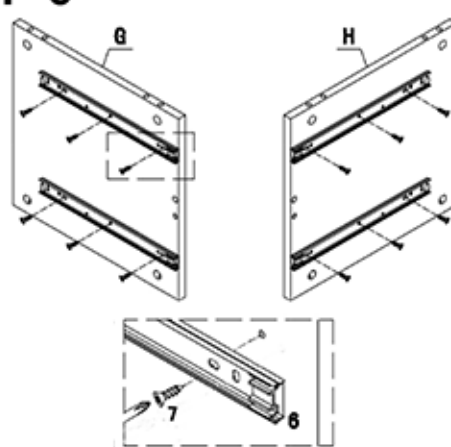

STEP 7

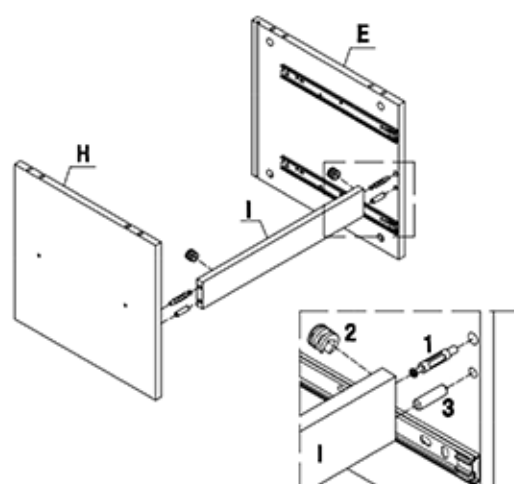

STEP 8

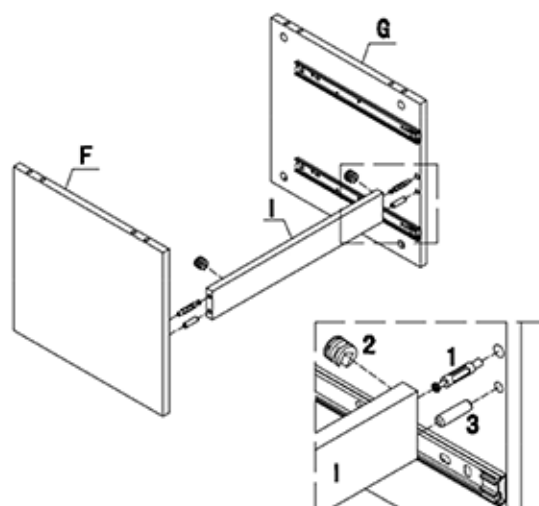

STEP 9

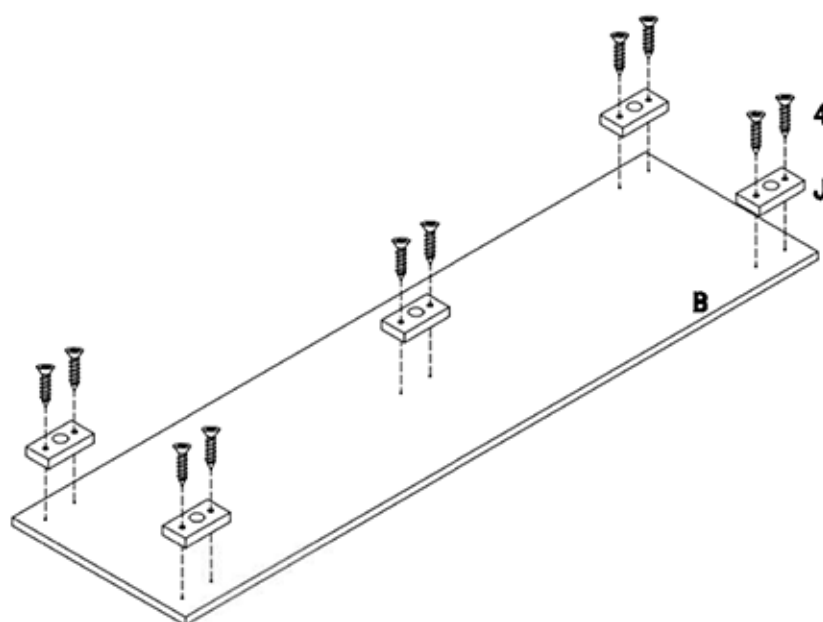

ASSEMBLY INSTRUCTIONS

STEP 10

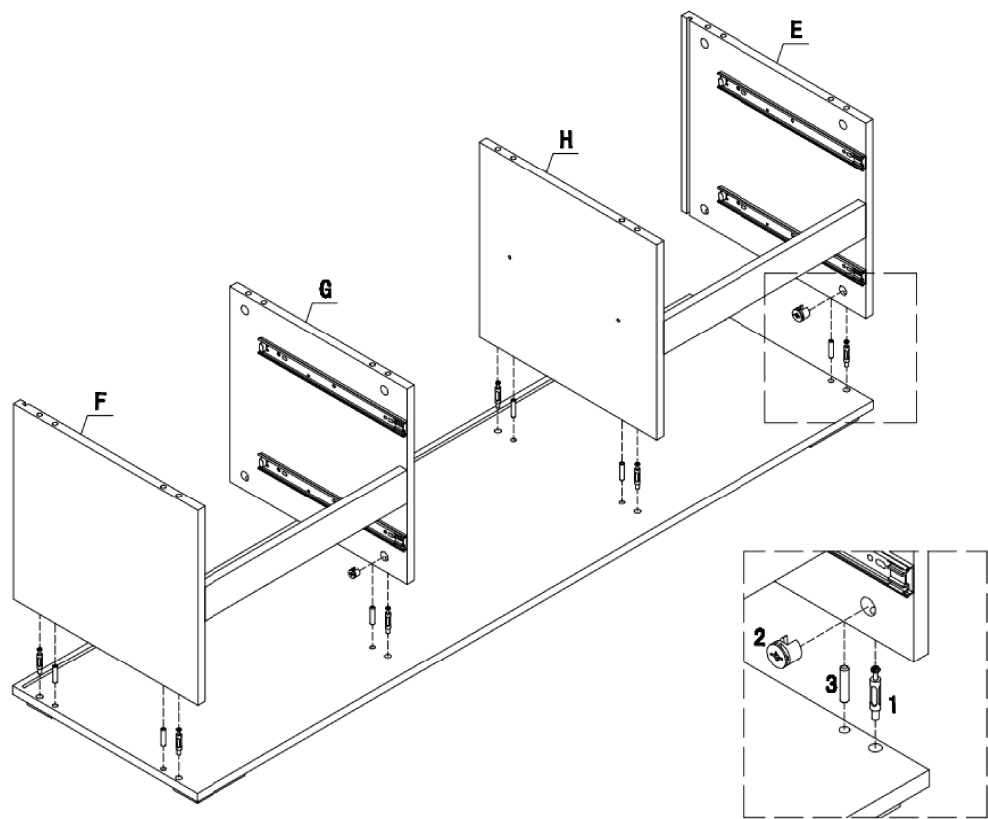

STEP 11

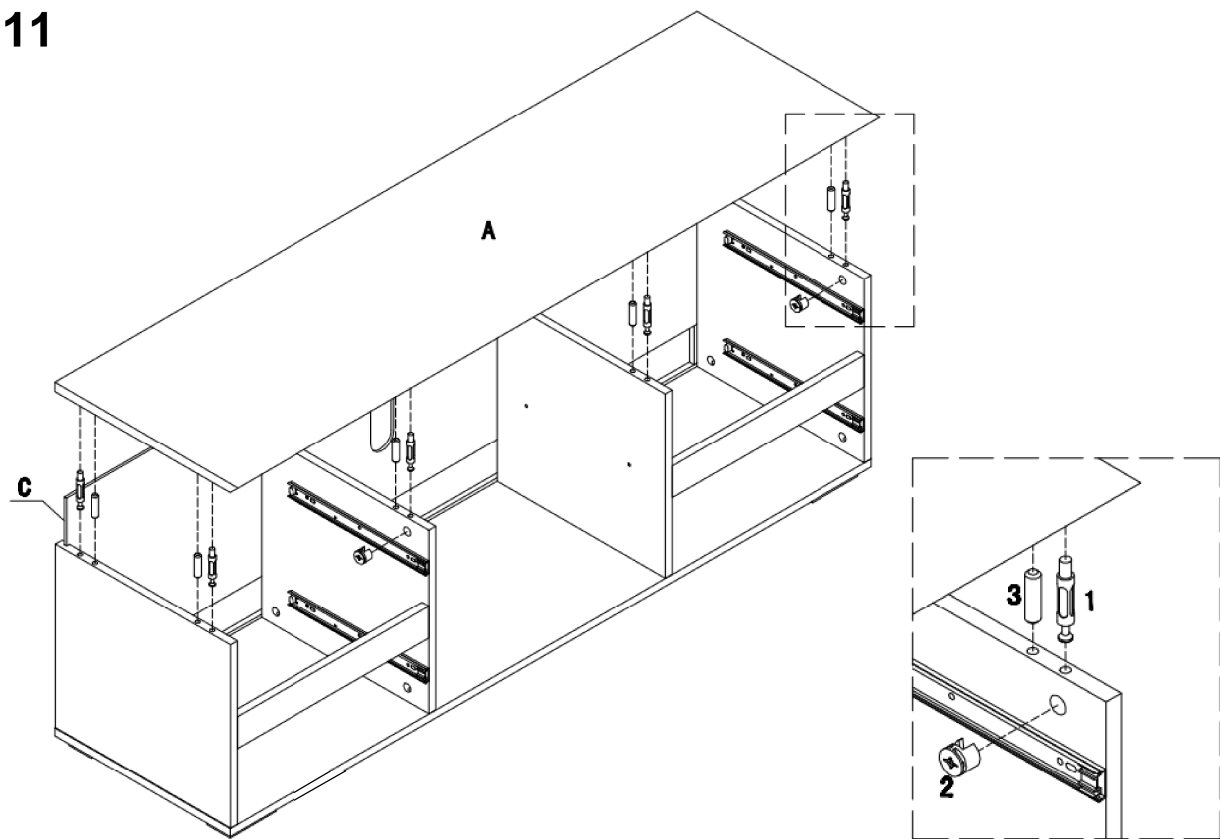

ASSEMBLY INSTRUCTIONS

STEP 12

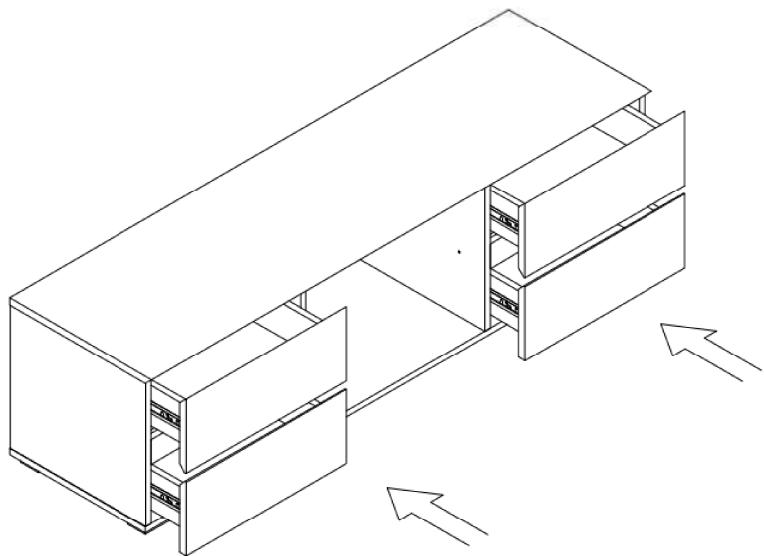

STEP 13

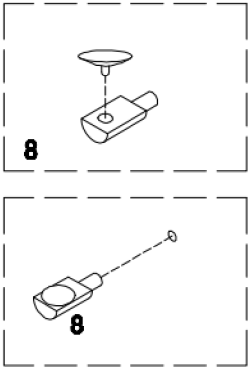
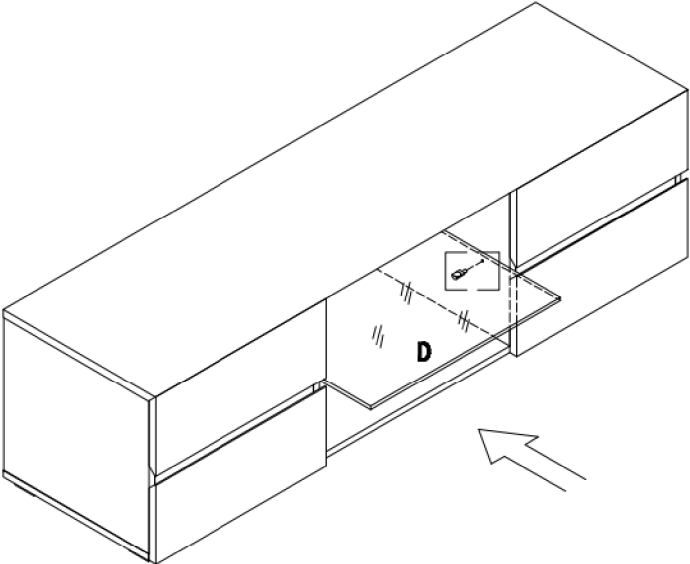

STEP 14

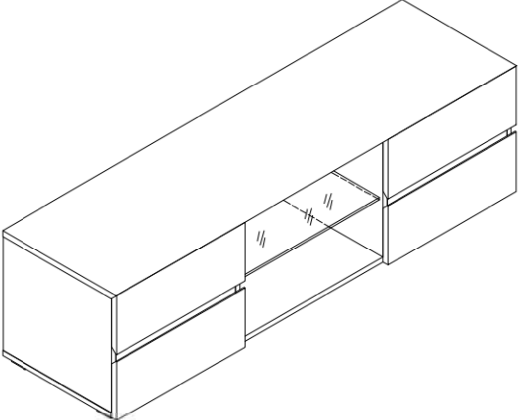

ASSEMBLY INSTRUCTIONS

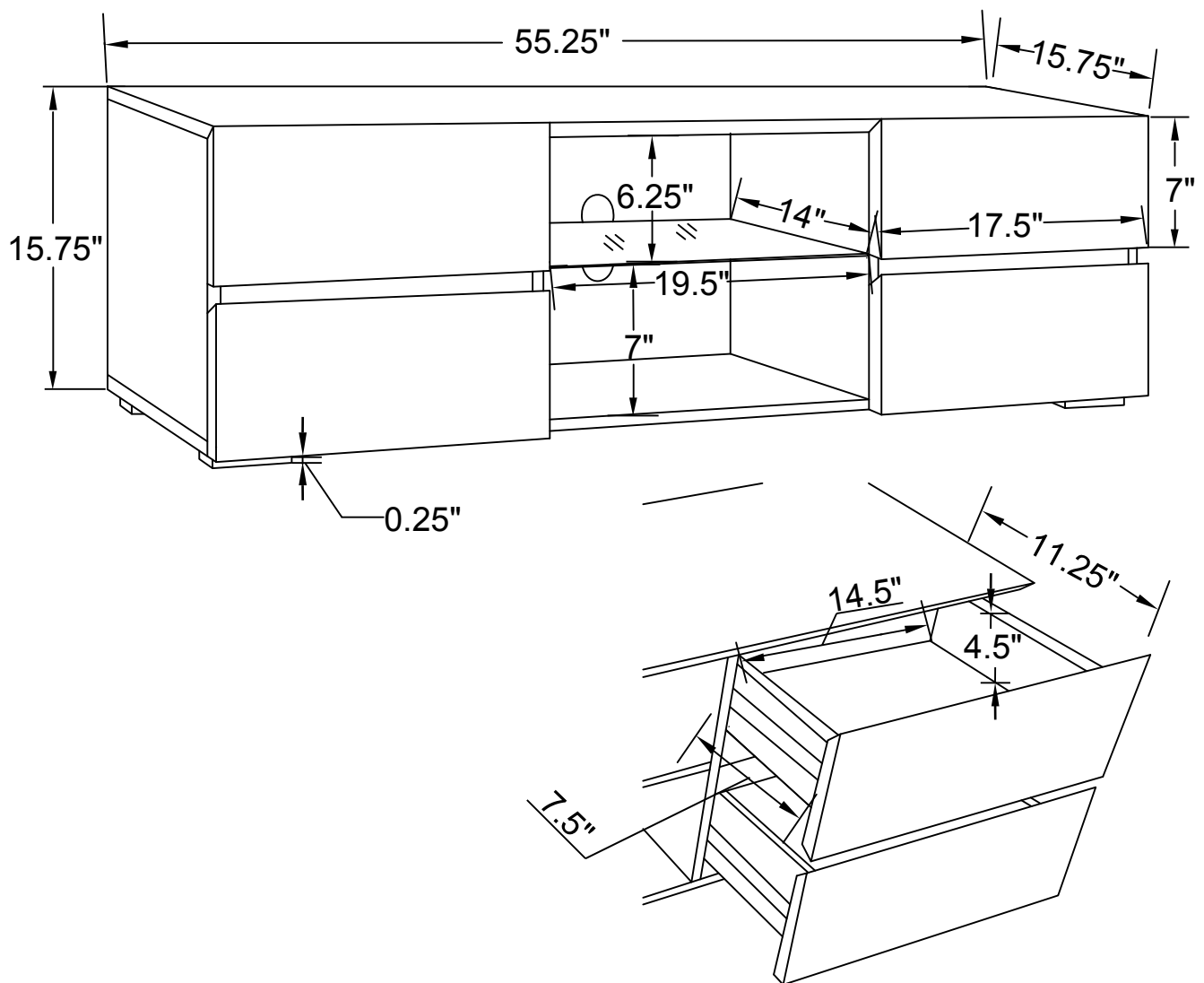

Note: Dimension tolerance $\pm 5\%$