

## Features

- Metal construction
- Wall-mount installation
- Diverter or non-diverter models
- 5/8" OD slip-fit or 1/2" NPT connection

## Codes/Standards Applicable

Specified model meets or exceeds the following:

- ASME A112.18.1/CSA B125.1

## WALL-MOUNT BATH SPOUT **K-5327** ALSO K-5328

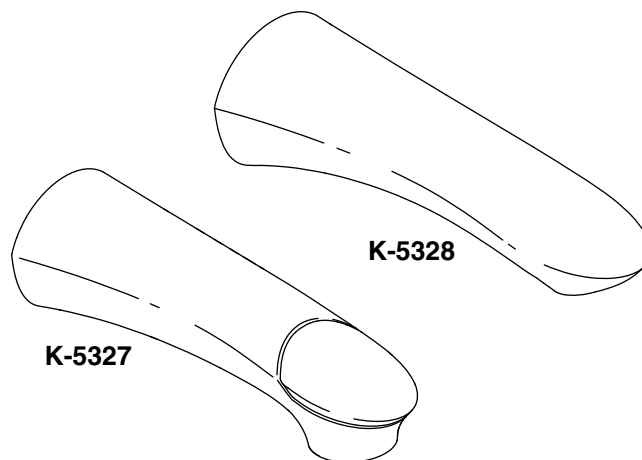

## Colors/Finishes

- CP: Polished Chrome
- Other: Refer to Price Book for additional colors/finishes

## Specified Model

Model	Description	Color/Finish	
K-5327	Wall-mount bath spout - with diverter	<input type="checkbox"/> CP	<input type="checkbox"/> Other ____
K-5328	Wall-mount bath spout - less diverter	<input type="checkbox"/> CP	<input type="checkbox"/> Other ____

## Product Specification

The wall-mount bath spout shall be of metal construction. Spout shall be available with or less diverter. Spout shall feature 5/8" OD slip-fit or 1/2" NPT connection. Wall-mount bath spout shall be K-\_\_\_\_\_-\_\_\_\_.

## Installation Notes

Install this product according to the installation guide.

For slip-fit spout, 5/8" OD tube must extend 5-9/16" (141 mm) beyond finished wall.

For threaded spout, 1/2" NPT pipe must extend 5-9/16" (141 mm) beyond finished wall.

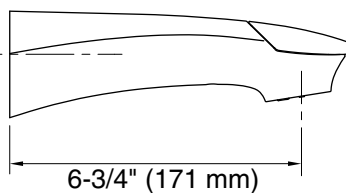

**K-5327**

Water supply tube must be centered with the hole.

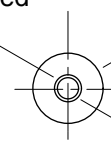

Ø 1-5/8" (41 mm)  
Max Hole in Wall

Water Supply Tube

For slip-fit spout, 5/8" OD tube must extend 5-9/16" (141 mm) beyond finished wall.

For threaded spout, 1/2" NPT pipe must extend 5-9/16" (141 mm) beyond finished wall.

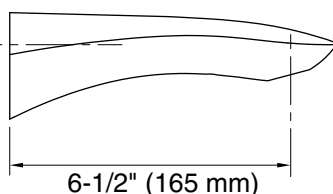

**K-5328**

Water supply tube must be centered with the hole.

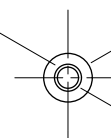

Ø 1-1/8" (29 mm)  
Max Hole in Wall

Water Supply Tube

## Product Diagram