



15 : 00

estimated
assembly time



1 or more

people required

Ok, let's
get started!



- Put on mood music!
- To prevent damage to product, use the clean side of package carton or rug as working surface.
- In the event of missing or damaged parts, delivery problems etc., please reach out to our team.
We will be happy to fix the problem!

care guide

- Clean regularly with a soft and dry cloth.
- To protect finish, avoid use of abrasive cleaners.
- Wipe up spills immediately. Please!



product
parts



(A)
Tabletop
x1

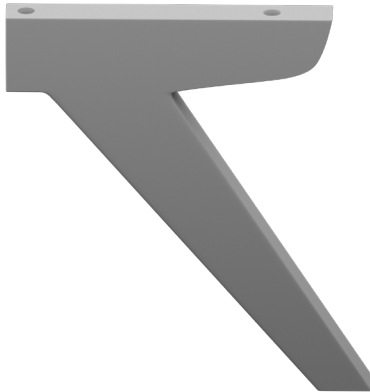

(B)
Table Legs
x3

what's included

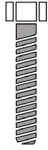

(C)-Bolt (8 x 70mm)
x3

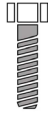

(D)-Bolt (8 x 50mm)
x3

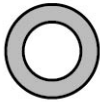

(E)- Washer (Ø8.5mm)
x6

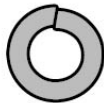

(F)-Lock Washer (Ø8.5mm)
x6

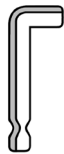

(G)- Allen Key
x1

RS Red Sticker

YS Yellow Sticker

GS Green Sticker

assembly instructions

Friendly Tip: Take a deep breath going in. This may be a tricky part, but nothing too overwhelming. Just follow these steps to the T and the outcome will be worth it!



step 1:

Turn the tabletop (A) upside down. Align the stickers on the table legs (B) with their counterparts on the tabletop (A).

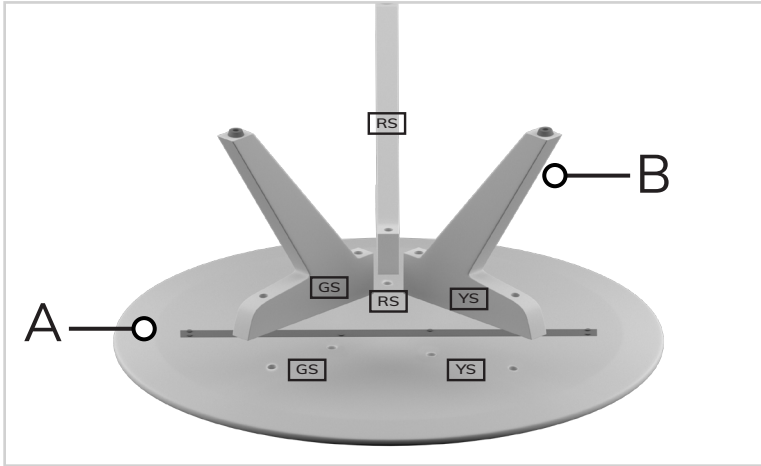

step 2:

Start by attaching any one table leg (B). Use bolt (C) for slot given on the inner side of the leg and bolt (D) on slot given at the outer side of the leg.

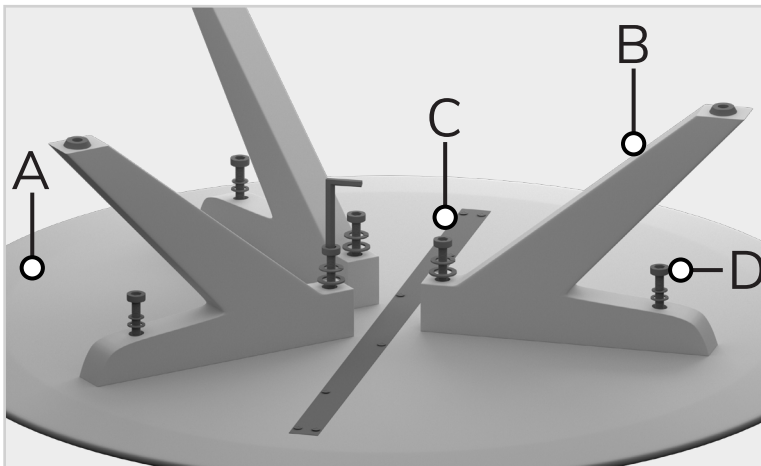

step 3:

Then, fix the leg in place using washer (E), lock washer (F), and bolt (D), in the sequence (E - F - D). Tighten all points using allen-key (G). Repeat the same steps for remaining legs.

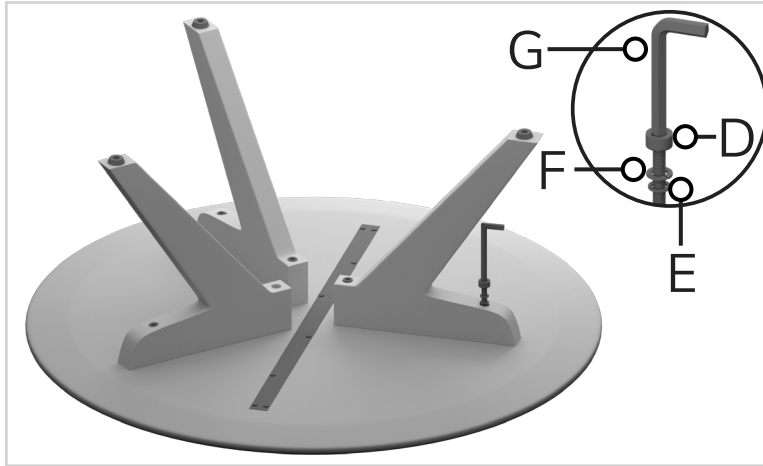



Voilà! Your table is now assembled and secure!

you've
got
a home
with us

