

# MODE® Premium Adjustable Rod Sets

## INSTALLATION FOR 36" TO 72" ROD WIDTHS:

- 1 Determine the placement of rod(s) using the Measuring Guide.
- 2 Measure and mark bracket locations above window, evenly spaced apart. Utilize a level to ensure the rod will be level on the wall.
- 3 Drill 5/16" diameter pilot hole in drywall (or 1/8" in stud) for all marked bracket locations.  
For drywall only: Hammer plastic anchor into pilot hole until flush.
- 4 For 36" to 60" rod widths, use two brackets. For 60" to 72" rod widths, use third bracket as needed for center support. Refer to Measuring Guide Diagram. Follow steps 4a. and 4b. below.
  - 4a Attach wall brackets A to wall using wall mounting screws. Hand tighten with screwdriver only to prevent screw head damage. (Fig. 1)
  - 4b Place rod brackets B onto wall brackets A. Adjust to desired projection and tighten using set screws. (Fig. 2)
- 5 Slide drapery panels or rings onto the telescoping rod and place rod into the rod cups on the installed brackets, spacing panels evenly between brackets. Tighten set screws to secure the rod. (Fig. 3)
- 6 Attach decorative finials onto each end of the rod. (Fig. 4)

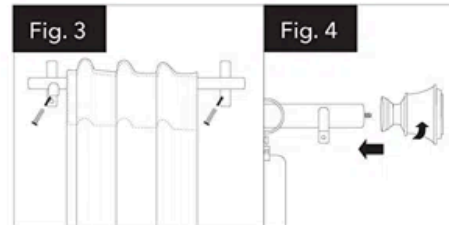
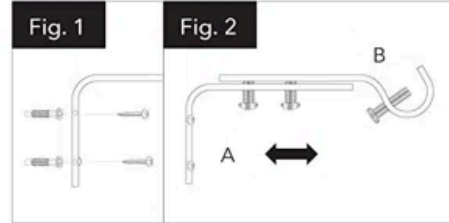

## TELESCOPING ROD ASSEMBLY

Be sure to attach the two rods so that the finial attaching screws are located on the outside as shown below.



Note: Adjust attached rods by pushing together as needed to match window length.