

Air Purifier

Instruction Manual

JHQ-D22-WT

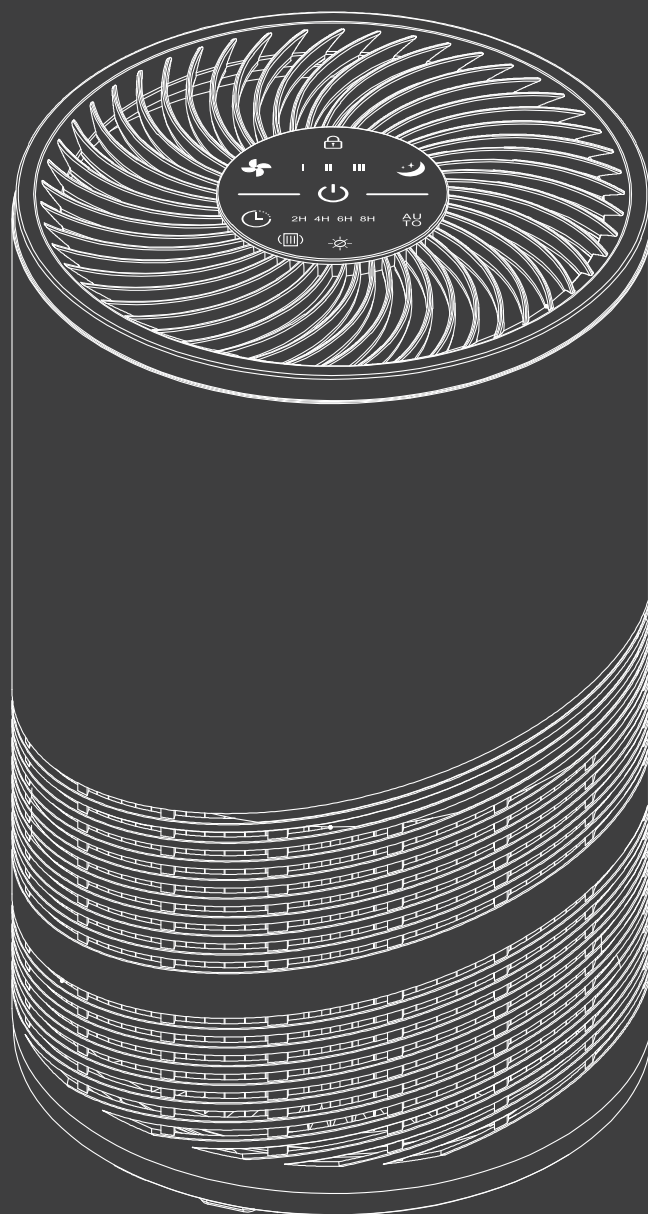

Catalog

1	Safety precautions	3-4
<hr/>		
2	Product introduction	5
	Removal and installation method of side cover plate	6
	Place of air purifier	6
	Install the filter	7
	Operation steps	7-8
	Understand the role of filters	9
	Integrating multiple functions into one	10
	Unique triple purification technology	10
<hr/>		
3	Usage method	11
	Function description of control panel	11
	Speed setting	12
	Sleep setting	12
	Child lock function	12
	Timing setting	12
	Reset function	12
	Turn off the screen function	12
	Turn on the purifier	13
	Manual mode	13
	Auto mode	13
<hr/>		
4	Maintenance and cleaning methods	14
	Clean air purifier	14
	Replace the filter screen	15
	Operation steps	15-16
	When idle for a long time	17
	Reference time for replacing filter screen	17
<hr/>		
5	Troubleshooting	18
	Warranty and service	18
<hr/>		
6	Other information	19
	Recycling	19
	Ordering parts or accessories	19
	Choose parts	19

1 Safety precautions

In order to avoid possible injury or financial loss to you or others, please pay attention to the following safety precautions.

If the power cord is damaged, in order to avoid danger, it must be repaired by the professional personnel of the manufacturer, its maintenance department or similar departments.



Warning



Wet hand
forbidden!

Do not touch the power plug with wet hands.

Otherwise, electric shock may be caused.



Unplug!

Before cleaning the electrical apparatus, make sure that the power supply has been disconnected.

Otherwise, the air purifier may run suddenly, Caused an electric shock accident.



Forbidden!

It is forbidden to use the specified value of power supply or linked equipment. Only 120V ~ AC power supply can be used.

The use of universal socket or equipment beyond the specified value may cause overheating and fire accidents.



Please plug the plug into the power socket before starting the air purifier.

If the plug is not fully inserted into the socket, it may cause electric shock and overheating, and even cause fire accident.

- Do not use damaged plugs or loose power outlets.



Forbidden!

Do not damage the power cord and socket.

When using the machine, do not bind the wires. Using the damaged wires may lead to electric shock, short circuit or fire accident.

- It is forbidden to cut, refit, over twist, twist, poke and pull wires, or place heavy objects on wires or sockets.



Please clean the power plug regularly.

If dust accumulates on the power plug, the insulation part of the plug may be damaged, resulting in a fire accident.

- Pull out the power plug and clean it with a dry cloth (do not use a wet cloth!).
- If the appliance is not used for a long time, the power plug should be removed.



Taking apart
is forbidden!

It is forbidden to disassemble or refit the air purifier without authorization.

Unauthorized disassembly or modification of electrical appliances may lead to electric shock, failure or fire accident.



Forbidden!

It is forbidden to place rods or other metal objects at the air outlet or opening.

Otherwise, it may touch the internal parts and cause electric shock or damage.

Warning

- If you need to move the product, please disconnect the power of the product first.
- Be sure to move the product slowly.
- Do not move the product by pulling the power cord.
- Do not move the machine while the product is in operation. If you need to move the machine, please turn off the power.

Warning

In case of any of the following conditions, please turn off the power of the machine immediately.

- If a switch does not work.
- If the circuit breaker works or the fuse burns out.
- If the power cord or plug is abnormally hot.
- If you find a burnt odor or abnormal sound or vibration.
- If there is any other abnormal phenomenon or fault.



Warning



Forbidden!

It is forbidden to use benzene or thinner and other solvents to clean the air purifier, so as to avoid contact with insecticide sprays.

Otherwise, the air purifier may break and cause damage, even short circuit, resulting in electric shock or fire accident.



Pull out the power plug, should hold the plug, should not pull the wire.

If the wire is pulled directly, it may cause short circuit, or damage the wire, leading to fire or electric shock.



Forbidden!

It is forbidden to use this air purifier in places with greasy particles.

For example, in the kitchen, the air purifier may break and cause damage.

- The air purifier shall not be used as ventilation or air extraction equipment.



Wetting
forbidden!

It is forbidden to use this air purifier in places with high temperature, humidity or wet body, such as bathroom.

The air purifier may leak electricity and cause electric shock or fire accident.



Forbidden!

It is forbidden to use the air purifier in the room with fumigation insecticides.

Chemical residues may accumulate in the unit and then be released from the air outlet, thus endangering health.

- After using insecticide, the room should be thoroughly ventilated before using the air purifier.



Keep away
from flame!

Do not let volatile substances or combustible materials, such as tobacco or sparks, float into the aircraft.

Otherwise, fire accidents may occur.



Wetting
forbidden!

Do not wet the fuselage.

Otherwise, electric shock and fire accidents may occur due to short circuit.

2 Product introduction

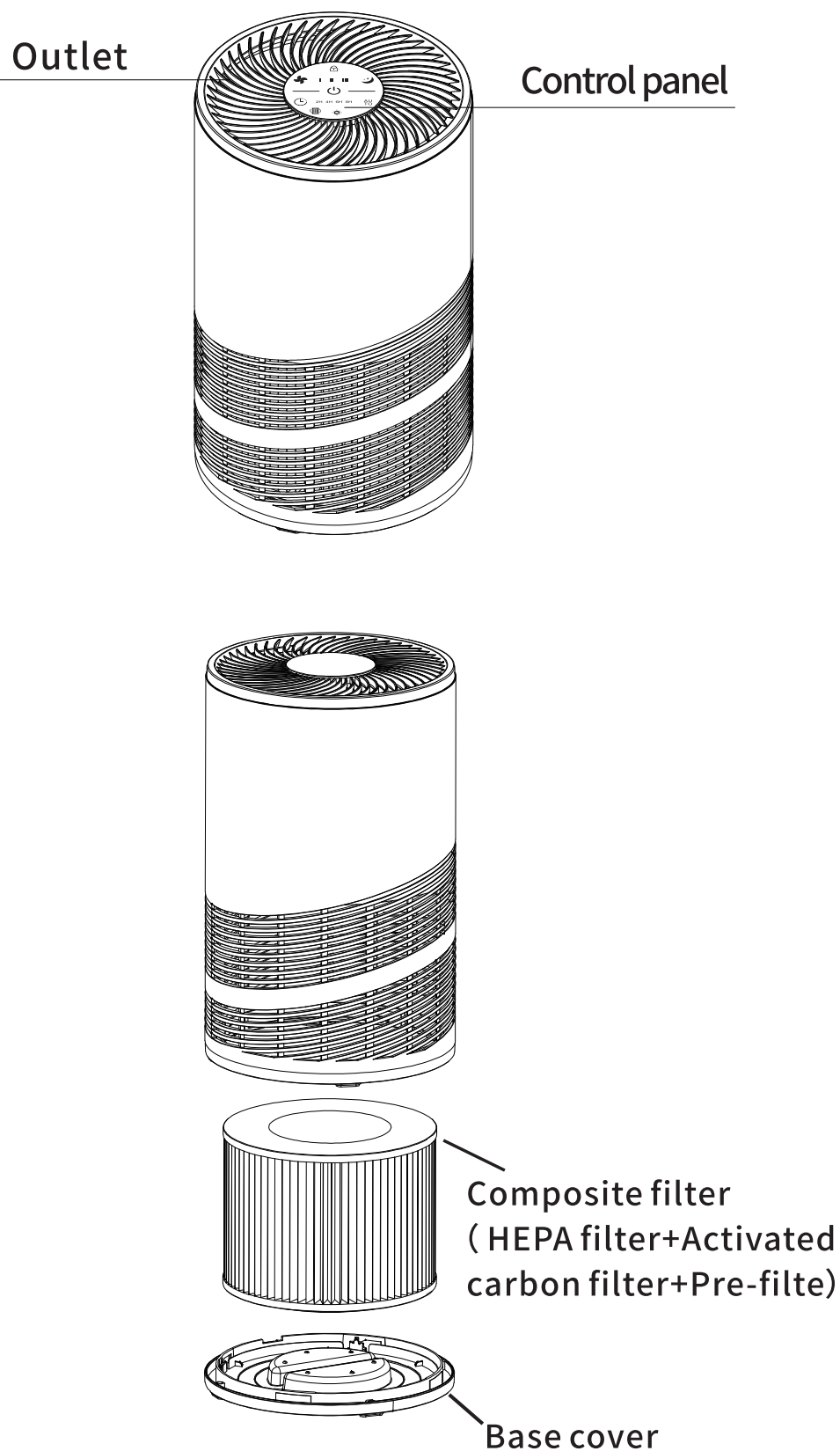

If there is any difference between the product picture and the real object, the real object shall prevail.

Removal and installation method of rear cover plate

1 Disassembly method of base

Holding the middle handle of the bottom cover and rotate it according to the indicator keys to unscrew the base.

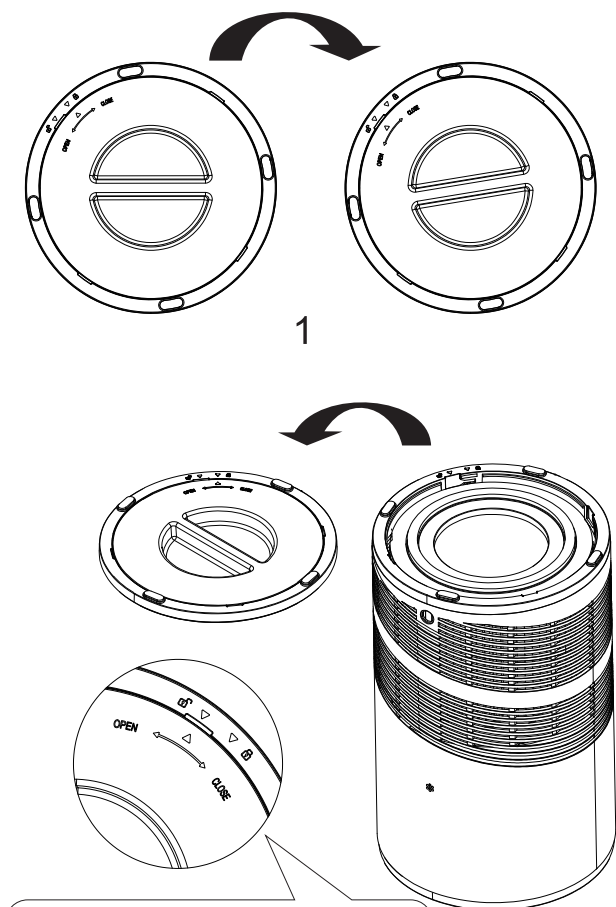

2

2 Installation method of base

Re install the base, holding the middle handle of the bottom cover, rotate the bottom cover according to the indicator key and tighten it.

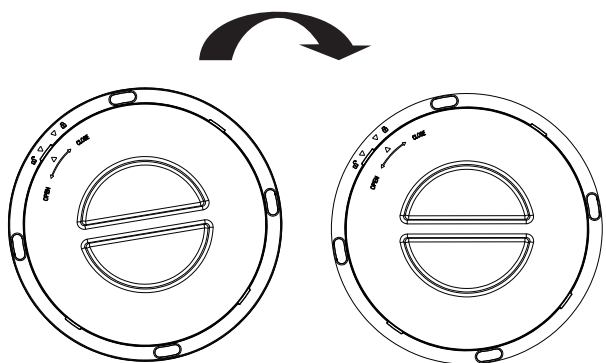

Place of air purifier

In order to achieve good air circulation effect in your room, make sure that the air inlet and outlet of the machine are not less than 20cm/7.8in away from the obstacles.

Please use at least 1m away from TV, radio and other electrical appliances.

Please do not plug the power plug into the same socket as the power plug of TV, radio and other electrical appliances.

Because the distance between the electrical appliances is too close, there is electromagnetic interference between them.

- If you use it in the same place for a long time, it will contaminate the wall around the host.
- Do not obstruct the air inlet and outlet to ensure adequate ventilation and maximum efficiency of the machine.

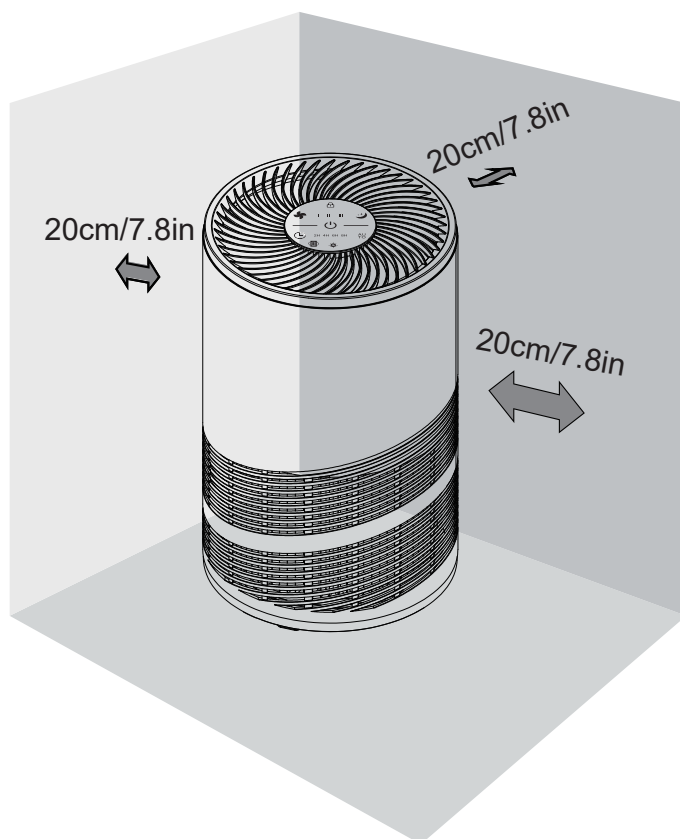

Install the filter

Information

This air purifier is equipped with a filter screen inside, but before using the product, be sure to remove the packaging of the filter screen. Please follow the instructions below to remove the filter and its package, and then put it back into the purifier.

⚡ Warning

- Ensure that the power plug is installed, repaired and transported when the power supply is disconnected.
- Do not operate the machine without filter.
- Remove the plastic packaging of the filter screen before use.

Operation steps

When using the air purifier for the first time, please follow the steps below to install the filter correctly.

- 1 Remove all packaging materials and place the machine on a dry, stable, level surface.

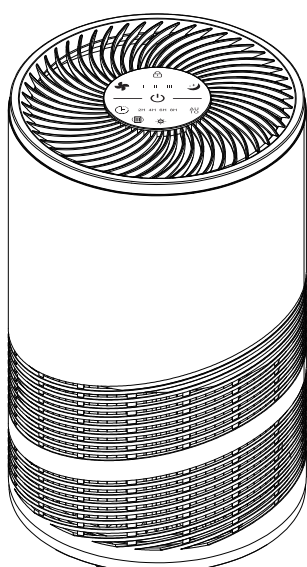

- 2 Press the bottom cover with your fingers, screw it out according to the unlocking direction, and take out the base upward at the same time.

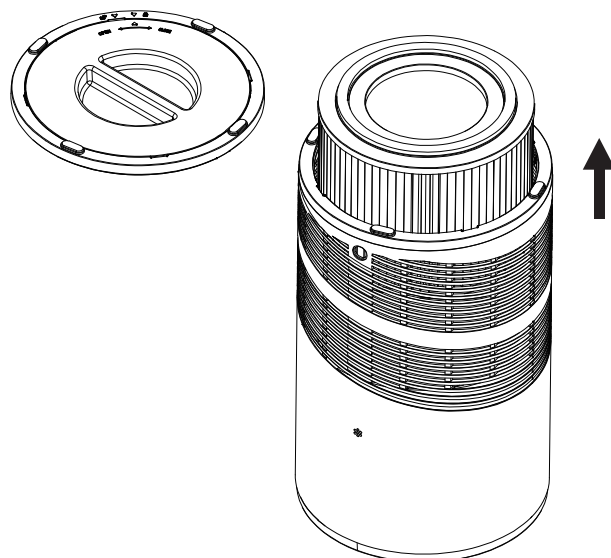

- 3 Remove the filter screen inside the purifier.

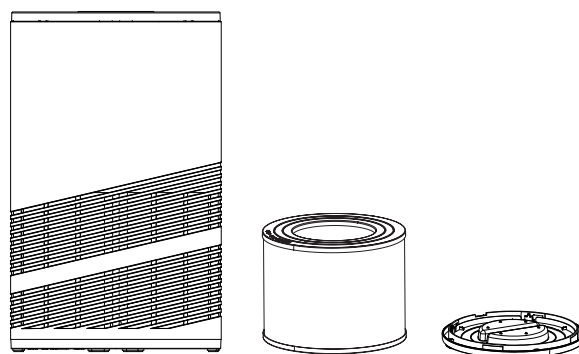

- 4 Remove the packing material from the filter screen.

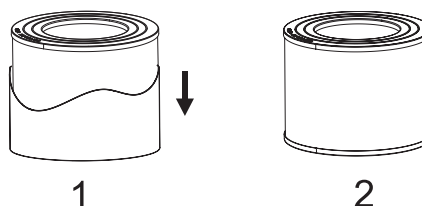

5 Put the filter back into the purifier

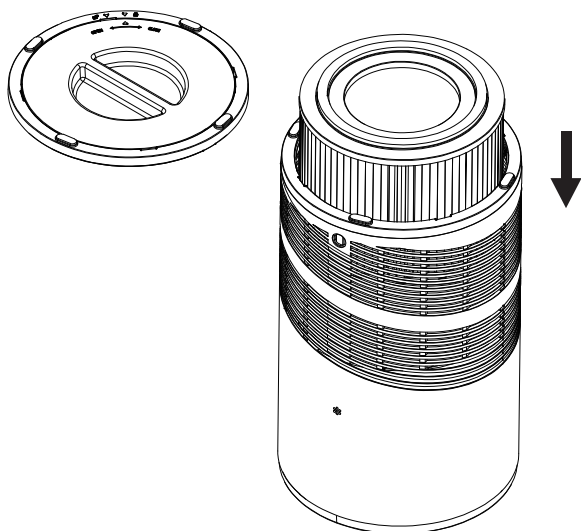

6 Grasp the middle handle of the bottom cover, follow the indicator keys, insert the bottom cover and tighten it.

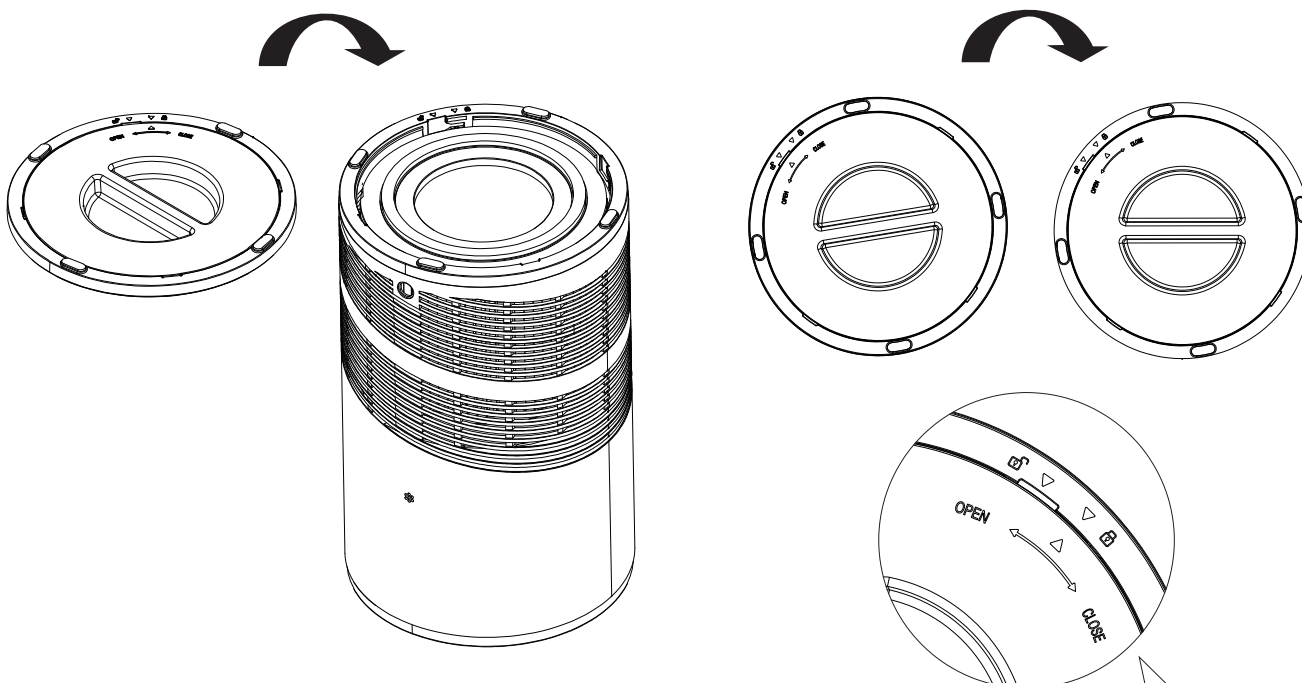

Tips

When installing the bottom cover, please install it carefully to prevent hand clamping.

When the indicator key on the bottom cover points to the closed state of the lock, the bottom cover is fixed intact.

Understand the role of filters

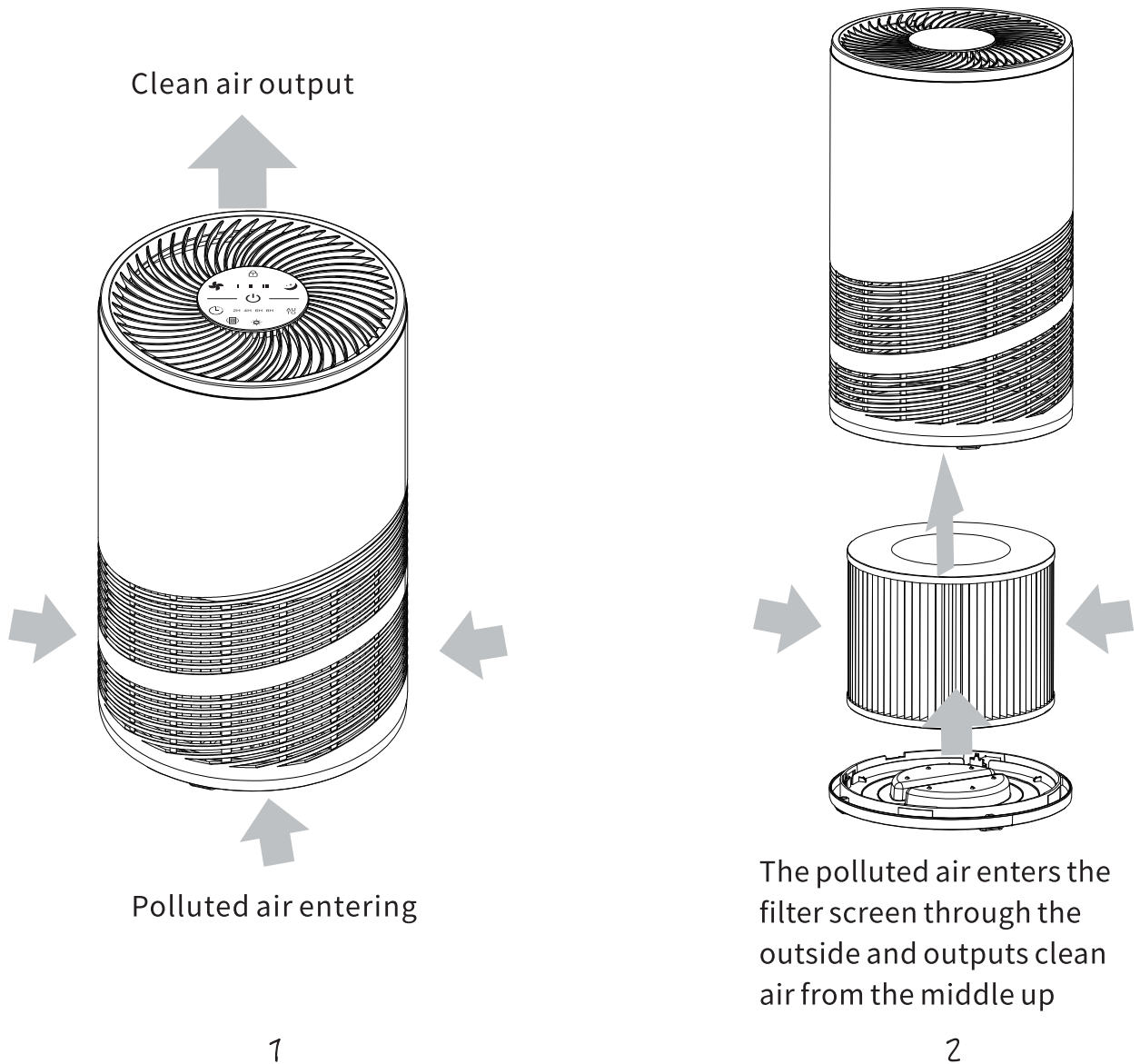

The picture is for reference only. If there is any difference between the real object and the picture, the real object shall prevail. Our company reserves the right to explain.

Integrating multiple functions into one

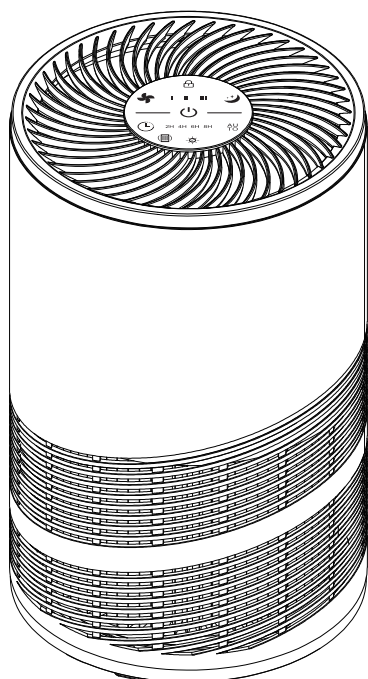

- Formaldehyde removal
- 4 speed switch (3 speed adjustable wind speed+sleep mode)
- Timer setting
- Prompt to replace the filter screen
- It is equipped with manual, sleep and child lock operation modes

Unique triple purification technology



The primary filter screen

Intercepts hair, fiber, large particles, dander, etc;

HEPA

Efficient removal of particulate matter such as filter, smoke and pollen.

High quality modified activated carbon

High quality activated carbon, modified by special proprietary technology, can effectively purify formaldehyde and other gas pollutants.

[note] high efficiency HEPA and high efficiency activated carbon are combined in the same filter screen.

3 Usage method

Function description of control panel

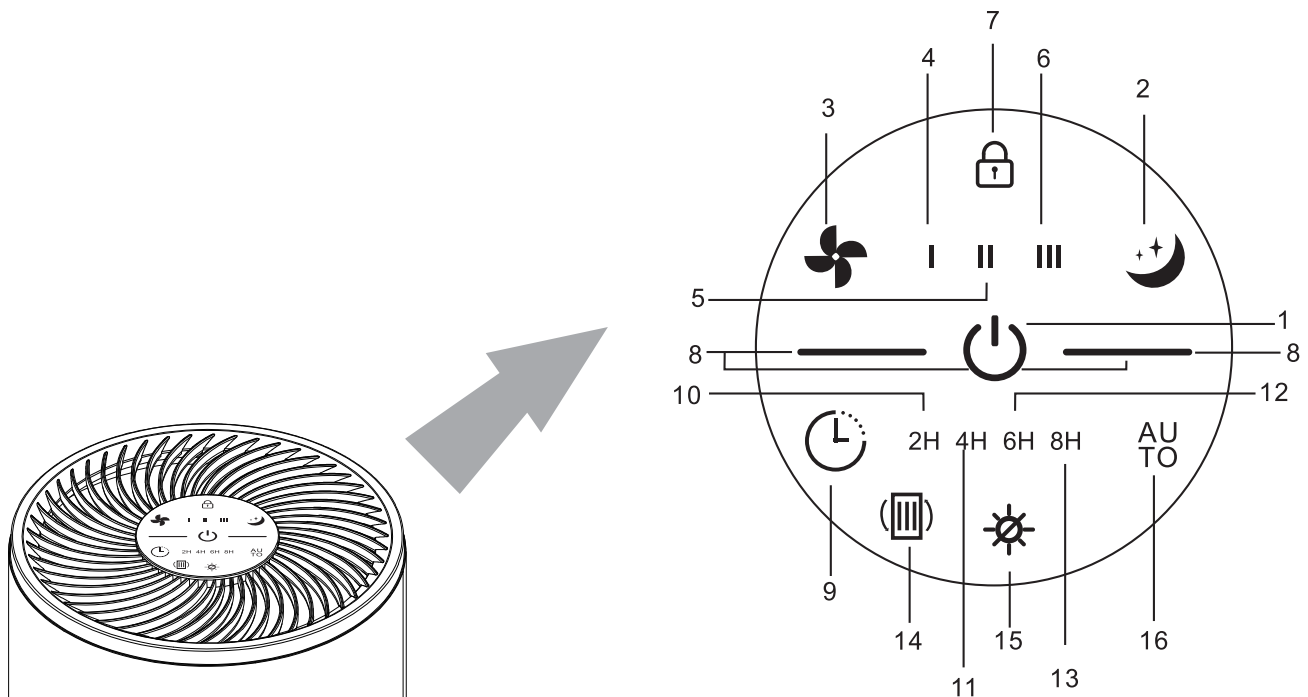

- 1 Power supply switch button
- 2 Sleep button
- 3 Speed button
- 4 1 speed wind speed indicator
- 5 2 speed wind speed indicator
- 6 3 speed wind speed indicator
- 7 Child lock button
- 8 PM2.5 indicator
- 9 Timer button
- 10 Timer 2 hours indicator
- 11 Timer 4 hours indicator
- 12 Timer 6 hours indicator
- 13 Timer 8 hours indicator
- 14 Reset button
- 15 Turn off the light button
- 16 Auto button

Speed setting

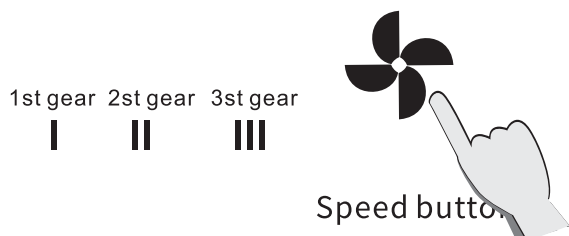

After turning on the power, press the wind speed button, a tone will sound, and the wind speed will cycle in the order of 1st gear, 2nd gear, and 3rd gear.

Sleep setting



Touch the sleep function button, except for the sleep button indicator light, all indicator lights show that all are off, and the wind speed runs in accordance with the sleep gear; After 10 seconds, the sleep indicator light goes off, press any key to exit the sleep mode formula, return to the manual first gear display.

Child lock function



Press and hold the child lock button for 3 seconds, the indicator light is on, and the child lock function is turned on. All keys except the child lock key are invalid. Press the child lock button again 3 seconds, the child lock button is unlocked, and all buttons are restored to use.

Timing setting



The timer can be selected at 2 hours according to user needs, Purify within 4 hours, 6 hours, and 8 hours.

Reset function

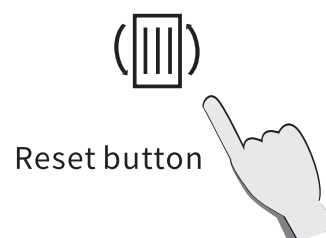

The machine continuously emits 10 rapid alarm sounds, and the indicator light flashes. The machine continues to work, reminding that the filter needs to be replaced. When replacing the filter, turn off the machine first, install the filter before turning it on, press and hold the filter reset button for 3 seconds, the filter indicator light goes off, and the same. When I heard a “ding” sound, the filter was reset successfully.

Turn off the screen function

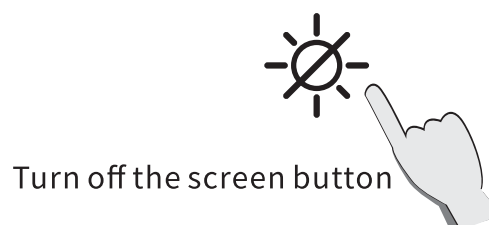

When the machine is running normally, press the off-screen button to turn off the screen indicator light. All indicator lights are off; turn off the lights after 10 seconds, press the finger. The indicator light is off, and all functions of the machine are operating normally.

Turn on the purifier

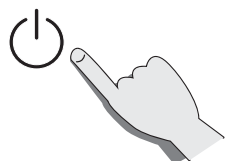

Plug in the power supply, the machine beeps loudly, and all the indicator lights are on, At the same time, the three-color light turns on the red light for 1 second, and then the green light turns on for 1 second, The blue light is on for 1 second, and then except for the switch button indicator light is fully on, the other all indicator lights are off and the machine enters standby state.

To turn off the product, press the on key again, turn off the product, and then unplug the product

Manual mode

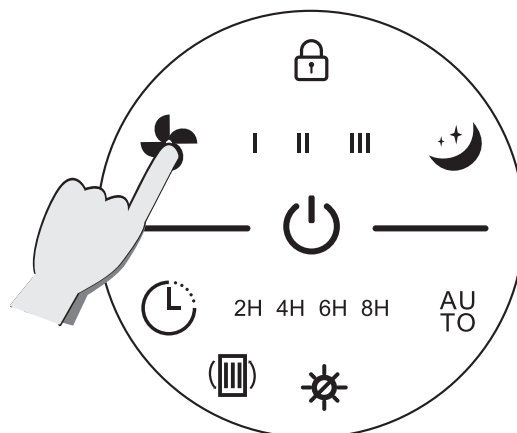

After turning on the power, press the wind speed button, a tone will sound, and the wind speed will be in 1 gear. cycle in sequence of 2 gears and 3 gears. After adjusting the wind speed gear, press the wind speed button. And the corresponding gear indicator lights are all on, and the sleep button indicator lights, The AUTO button indicator light is half on. The machine presses the adjusted wind speed one run straight.

Auto mode

Touch the AUTO gear button, the AUTO button indicator lights up, warm up in the mode, it works at 2 gears of wind speed. Wind speed and sleep button indicator light semi-bright. According to the air quality sensor, the air quality is automatically sensed choose wind speed: excellent-1 gear (blue), good-2 gear (green), Difference—3 gears (red), touch the automatic gear button again, and return Manual 1-speed display.

Air quality range	Air quality grade	Air quality indicator color
0~50	Excellent	Blue
51~150	Good	Green
≥151	Poor	Red

4 Maintenance and cleaning methods

Be sure to unplug the power plug before cleaning the product.

Do not immerse the product in water or any other liquid.

Do not use abrasive. Corrosive or flammable cleaners (example such as bleach or alcohol) clean any parts of this product.

The composite filter is not washable.



Clean air purifier

Clean the inside and outside of the purifier body regularly to prevent dust accumulation.

1. Use a soft dry cloth to wipe the dust off the purifier.
2. Clean the air inlet and outlet with a soft dry cloth.

Replace the filter screen

Information

When the reset button light flashes, remind the user to replace the filter



Reset

⚡ Attention

When the product is working, the indicator light for replacing the filter will flash, and the buzzer will sound "Ding, Ding" alarm to remind the user to replace the filter, but the purifier can still work normally.

⚡ Attention

Please shut down and unplug the power plug before replacing the filter. After replacing the filter, if the replacement indicator still flickers after starting the machine, please press the reset key for 3 seconds to reset the filter. The replacement indicator turns off and the filter reset is completed.

💬 Tips

Put the plastic filter into the machine before disassembly

Operation steps

- 1 The machine reminds that the filter needs to be replaced



Reset

- 2 Turn off the power, stop the purifier, and then unplug the power plug.

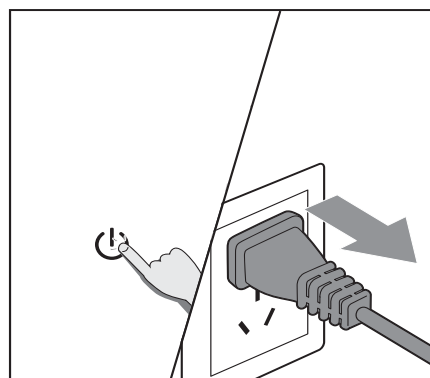

- 3 Press the bottom cover with your fingers, screw it out according to the unlocking direction, and take out the bottom cover upward at the same time.

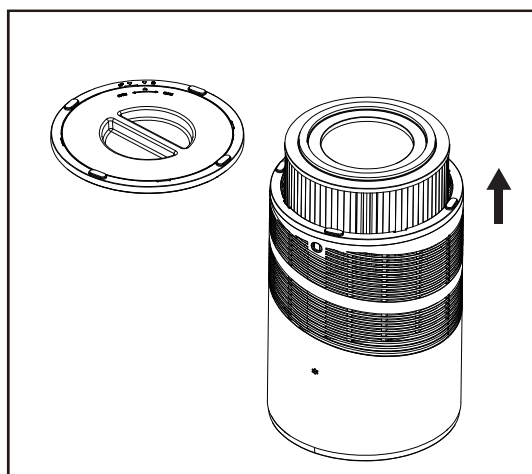

- 4 Remove the filter inside the purifier and replace it.

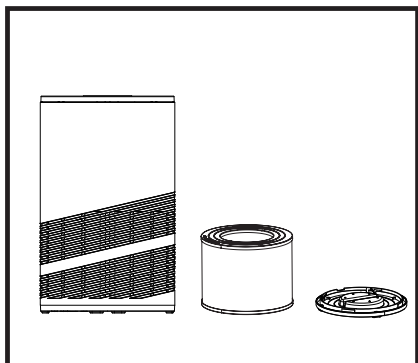

- 7 Put in the filter screen again, holding the middle handle of the bottom cover, rotate the bottom cover according to the indicator key and tighten it.

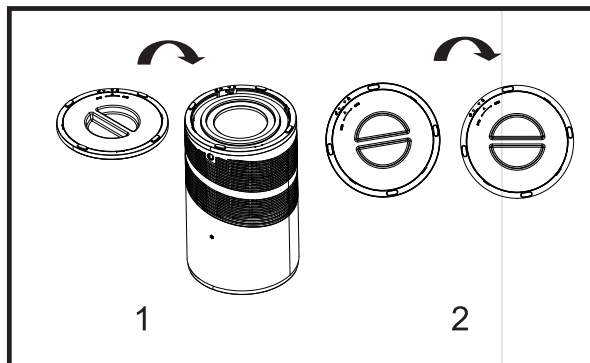

- 5 Remove the packing material from the new filter screen

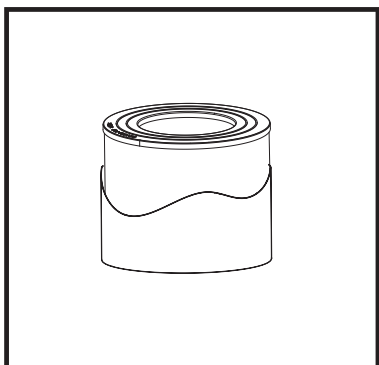

- 8 After replacing the filter, plug in the power plug and press the reset key for 3 seconds to reset the machine.

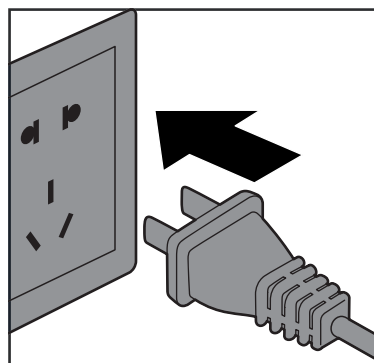

- 6 Put the filter back into the purifier.

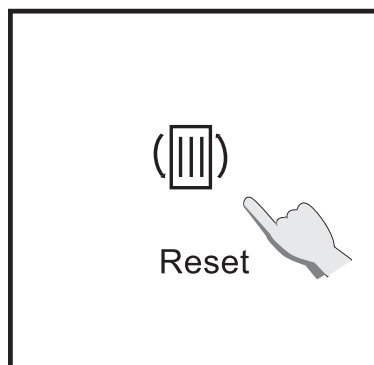
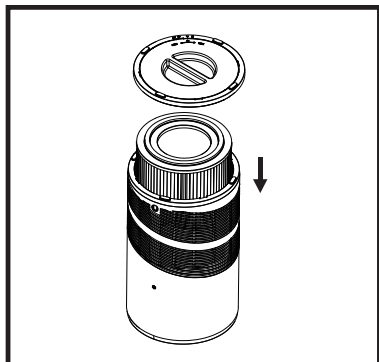

When idle for a long time

Pull off the power plug. (because standby mode also consumes power.) Dry the interior thoroughly.

Store the machine in a dry and ventilated place. (keeping the product flat or upside down may lead to product failure)

Reference time for replacing filter screen

The filter screen of this product is primary filter + HEPA + activated carbon filter. The filter screen cannot be washed and is damaged. Please do not press it hard. The general service life is six months

The above time is only a reference time, users can change it in advance according to the actual use environment.

Attention

Please shut down and cut off the power plug before replacing the filter

5 Troubleshooting

This chapter lists the common problems that may be encountered when using this product. If you are unable to solve the problem according to the information below, please contact the customer service center.

State	Possible causes	Possible solutions
The machine can't be started	The power plug is not in place	Pull out the power plug and plug in the power again
	The power plug or wire is damaged	Contact customer service center
Fan not working	The machine is not on	Plug in the power and turn on the machine again
	The motor is damaged	Contact customer service center
	Motor loose or foreign particles inside the machine	Contact customer service center
Poor purification performance or no optimal purification capacity	The filter was not replaced	Replace a new set of filter
	The air inlet or outlet of the machine is blocked	Contact customer service center
	The plastic package of the filter is not removed	Remove the plastic package of the filter screen for reuse
	There is no proper clearance or space around the machine to ventilate it	Make sure that the air inlet and outlet of the machine are not less than 50cm away from the obstacles
	There is no filter in the machine	Make sure that the filters are placed in the machine in the order indicated
	More than expected room coverage	Recheck whether the area of the used room is consistent with the specified area of the machine

Warranty and service

If you need information or have any questions, you can contact our customer service center.

6 Other information

Recycling



When discarding products, please do not stack them with general domestic waste. Please understand the local regulations on classifying mobile phone electronic or electrical products

Proper disposal of the product helps to avoid potential negative effects on the environment and human health

Ordering parts or accessories

If you need to replace parts or purchase additional parts, please contact your customer service center

Choose parts

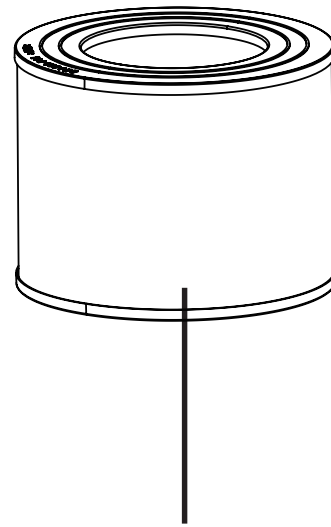

Pre-filter + HEPA + activated carbon composite filter screen

