

1. Install the arms ① on the plate ③ with lock nut & teeth lock washer ②.

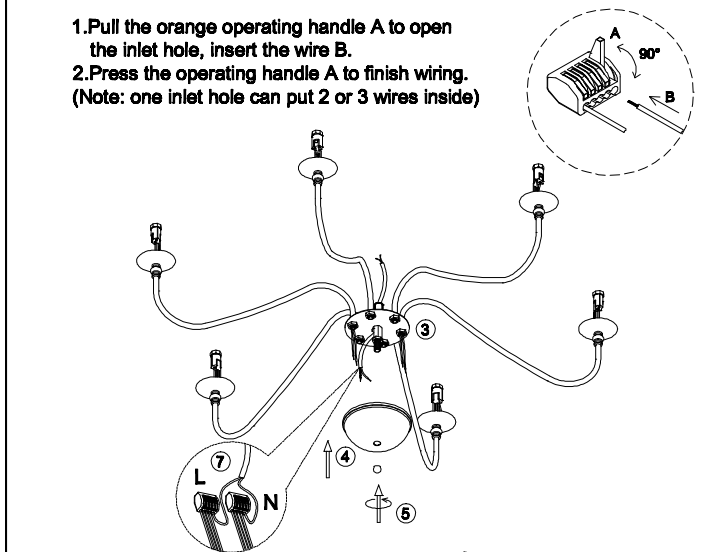

1. Pull the orange operating handle A to open the inlet hole, insert the wire B.
 2. Press the operating handle A to finish wiring. (Note: one inlet hole can put 2 or 3 wires inside)

2. Connect all the wires by parallel with connectors ⑦ (all live line-L use one connector, and neutral Line-N use another connector).
 3. Install the box ④ to the plate ③ with end cap ⑤.

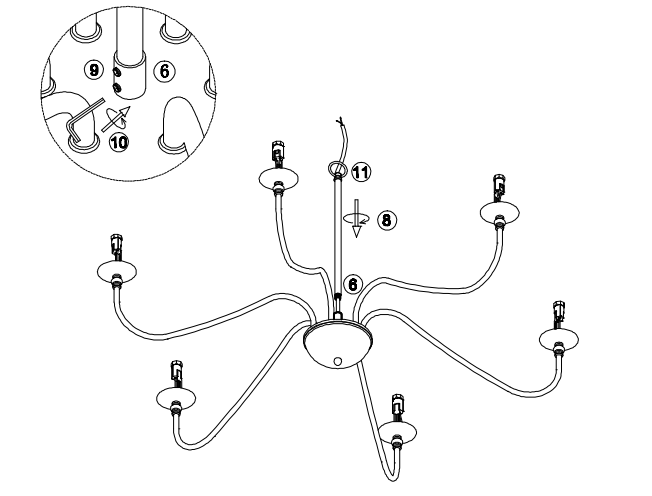

4. Let the wire go through the hanging tube ⑧, rotate to fasten the tube ⑧ to the connect tube ⑥, lock the tube ⑧ with grub screw ⑨ by rotate hex key ⑩.

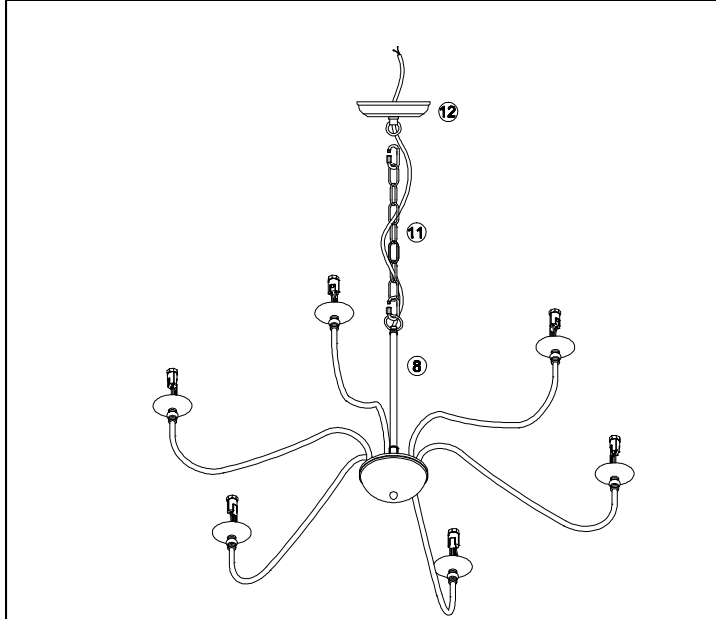

5. Connect the fixture ⑧ and the canopy ⑫ with chain ⑪, let the wire go through the chain ⑪.

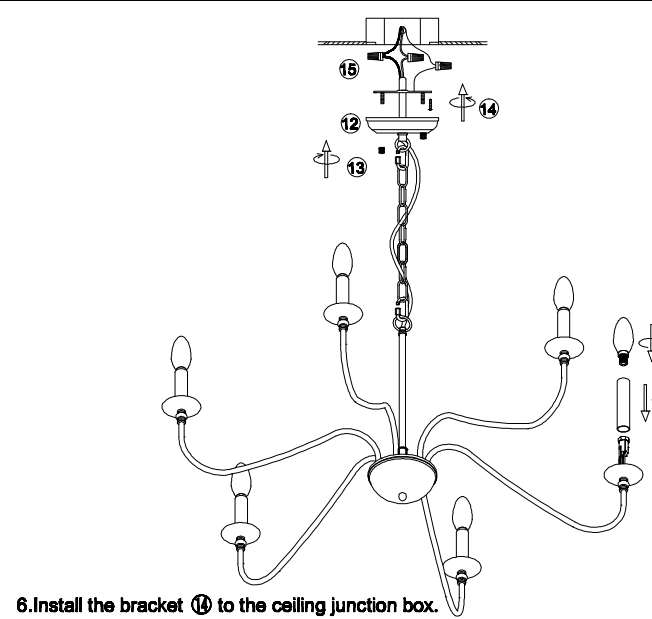

6. Install the bracket ⑭ to the ceiling junction box.
 7. Connect the wire ⑮ to your home line.
 8. Install the fixture on the bracket with cap nut ⑬.
 9. Put the cylinder tubes ⑯ on the lampholder and install the bulbs ⑰.

D0115/6/8
Please read carefully before installation!!!
Note : Please make sure that the electricity is powered off during installation !
Only a professional electrician should install this kind of product !