

# ET1628B ET1628W

Cylinder

## PROJECT INFORMATION:

Project Name: \_\_\_\_\_

FixtureType: \_\_\_\_\_

Date: \_\_\_\_\_

## DIMENSIONS

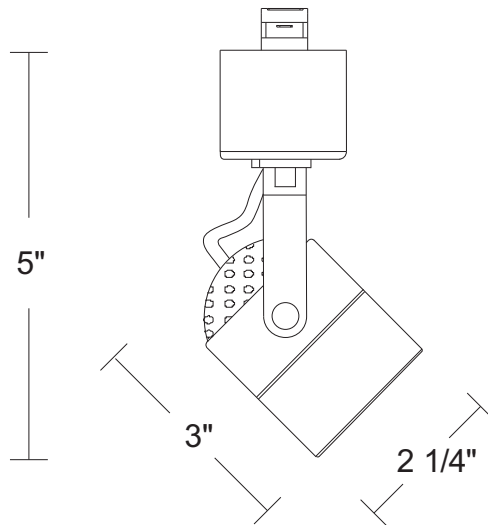

## PRODUCT SPECIFICATIONS

All track heads except HID have adjustable track adapter to allow for use with single circuit and double circuit tracks.

- Cylinder
- Metal Housing
- 90 degree vertical adjustment  
358 degree rotation
- Use with ELCO 120V Single or Double Circuit Track or 120V Monopoints

**Lamp:** 50W Max 120V MR16 GU10 LED/Halogen, (not included, by others)

**Socket:** MR16 GU10 included

**Dimensions:** Length: 3"  
Diameter: 2 1/4"  
Max. Extension: 5"

**Finish:** (B) Black, (W) White

**Labels:** U.L. listed

## CATALOG NUMBER

**Example:** ET1628B (Black)  
ET1628W (White)

